

Project: Wattenberg Field
Site: AA (Sec.22-T06N-R63W) Weld County, CO
Well: Wells Ranch AA22-625
Wellbore: Original Drilling
Design: APD - Rev 1

Northern Region Drilling - Working

Geodetic System: US State Plane 1983
Datum: North American Datum 1983
Ellipsoid: GRS 1980
Zone: Colorado Northern Zone
System Datum: Mean Sea Level

SECTION DETAILS

Sec	MD	Inc	Azi	TVD	+N/-S	+E/-W	Dleg	TFace	VSec	Target
1	0.0	0.00	0.00	0.0	0.0	0.0	0.00	0.00	0.0	
2	2500.0	0.00	0.00	2500.0	0.0	0.0	0.00	0.00	0.0	
3	2907.1	8.14	110.56	2905.7	-10.1	27.0	2.00	110.56	27.0	
4	3102.6	8.14	110.56	3099.3	-19.9	53.0	0.00	0.00	52.9	
5	3509.7	0.00	0.00	3505.0	-30.0	80.0	2.00	180.00	79.9	
6	6171.0	0.00	0.00	6166.3	-30.0	80.0	0.00	0.00	79.9	
7	7115.5	85.00	89.48	6800.5	-24.7	661.1	9.00	89.48	661.0	
8	7190.5	85.00	89.48	6807.0	-24.1	735.8	0.00	0.00	735.7	
9	7250.5	90.40	89.48	6809.4	-23.5	795.8	9.00	0.00	795.7	
10	11797.5	90.40	89.48	6777.7	17.6	5342.5	0.00	0.00	5342.5	Wells Ranch AA22-625 BHL 980'FSL, 235'FWL

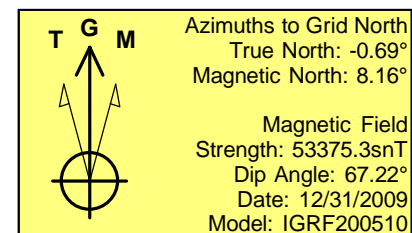
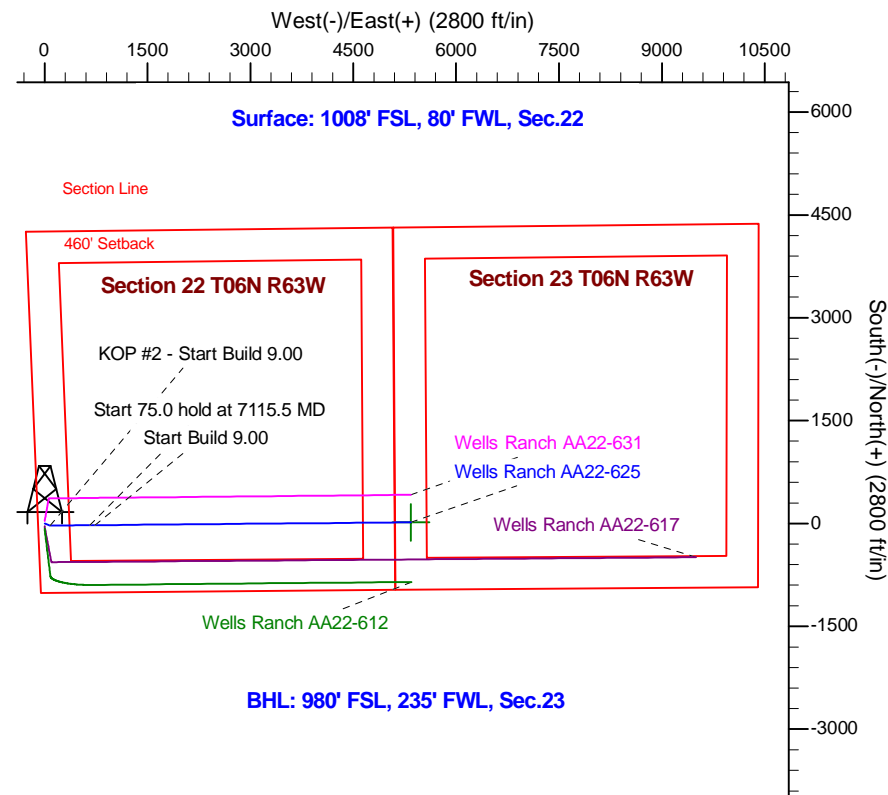
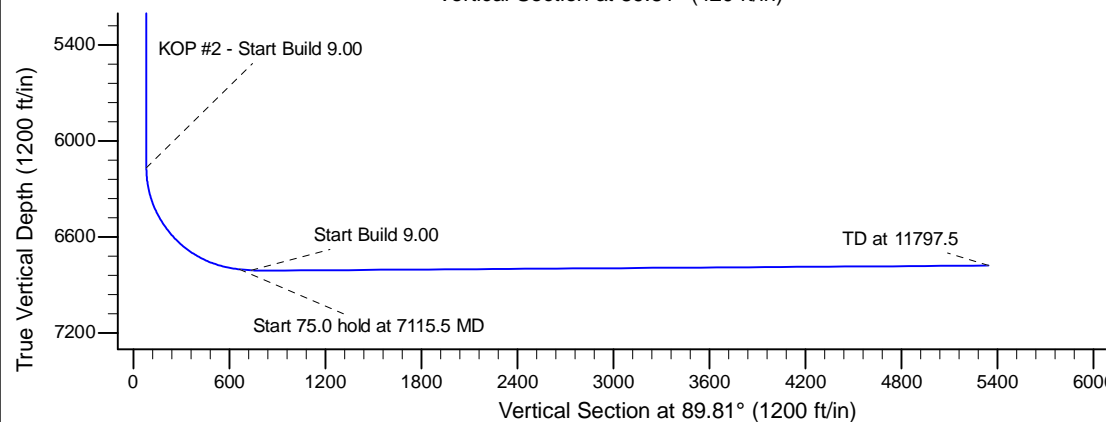
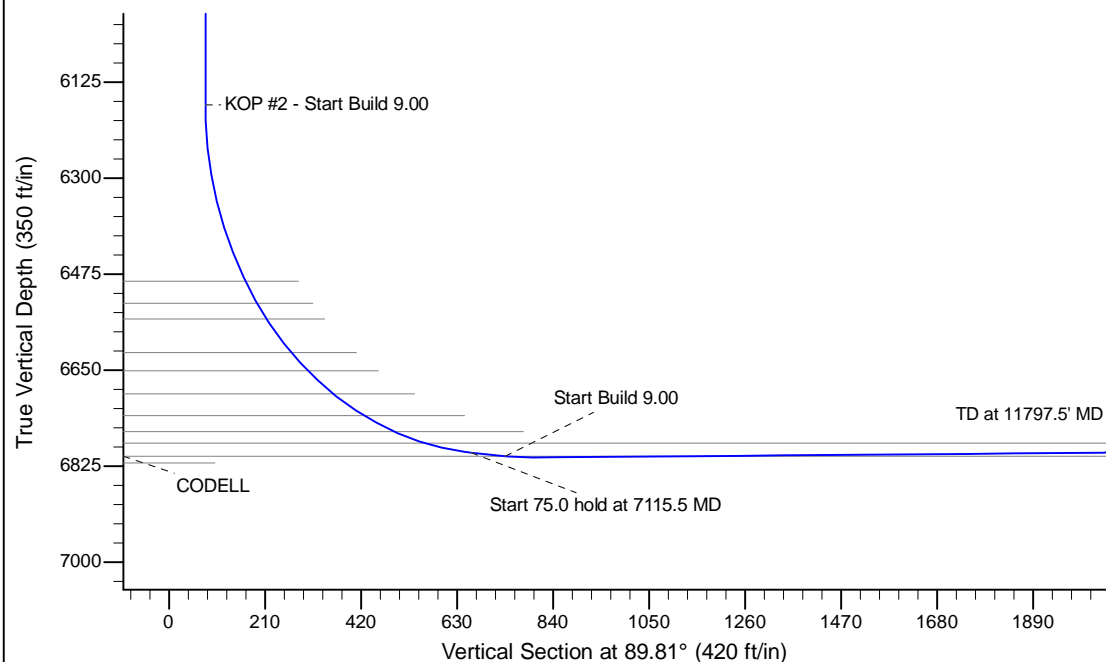

WELL DETAILS: Wells Ranch AA22-625					
Ground Level: 4745.0					
0.0	0.0	Northing	Easting	Latitude	Longitude
		1414991.20	3297159.01	40.467640	-104.431950
Plan: APD - Rev 1 (Wells Ranch AA22-625/Original Drilling)					
Created By: Shailey Jewell			Date: 11:03, December 02 2015		
Checked: _____			Date: _____		
Reviewed: _____			Date: _____		
Approved: _____			Date: _____		