

LEGEND:

- = 90° SYMBOL
- = PROPOSED WELLHEAD.
- = TOP OF PRODUCTION
- = TARGET BOTTOM HOLE.
- = SECTION CORNERS LOCATED.

2006 Alum. Cap,
0.6' Below Ground
Lat: 40.860678°
Long: 103.804117°

T10N, R57W, 6th P.M.

Target
Bottom Hole

S89°29'32"W - 2517.94' (Meas.)

S89°29'19"W - 2651.74' (Meas.)

2006 Alum. Cap,
0.9' Below Ground
Lat: 40.860736°
Long: 103.795017°

2006 Alum. Cap,
0.9' Below Ground
Lat: 40.860797°
Long: 103.785433°

NOTE:
THE PROPOSED TARGET BOTTOM HOLE FOR
THIS WELL IS LOCATED IN LOT 4 OF
SECTION 6, T10N, R57W, 6th P.M. AT 600'
FNL 161' FWL. IT BEARS N00°33'10"W
7269.14' FROM THE TOP OF PRODUCTION.

LOT 1

LOT 2

HORSETAIL #07E-0601

Elev. Graded Ground = 4925.3'

2006 Alum. Cap,
0.6' Below Ground
Lat: 40.853414°
Long: 103.804036°

LOT 3

2006 Alum. Cap,
0.1' Below Ground
Lat: 40.853497°
Long: 103.785283°

LINE TABLE

LINE	DIRECTION	LENGTH
L1	S85°20'37"W	569.66'

1917 Brass Cap,
Fence
Lat: 40.846147°
Long: 103.803839°

1917 Brass Cap,
0.2' High
Lat: 40.846172°
Long: 103.794694°

1917 Brass Cap,
0.4' High
Lat: 40.846200°
Long: 103.785111°

S89°44'57"W - 2530.51' (Meas.)

S89°45'37"W - 2652.58' (Meas.)

R
58
W

R
57
W

LOT 4

PDOP = 1.3



NAD 83 (TOP OF PRODUCTION)	NAD 83 (SURFACE LOCATION)
LATITUDE = 40°51'13.32" (40.853700)	LATITUDE = 40°51'13.77" (40.853825)
LONGITUDE = 103°48'12.33" (103.803425)	LONGITUDE = 103°48'04.94" (103.801372)
NAD 27 (TOP OF PRODUCTION)	NAD 27 (SURFACE LOCATION)
LATITUDE = 40°51'13.37" (40.853714)	LATITUDE = 40°51'13.82" (40.853839)
LONGITUDE = 103°48'10.52" (103.802922)	LONGITUDE = 103°48'03.13" (103.800869)

BASIS OF BEARINGS

BASIS OF BEARINGS IS A G.P.S. OBSERVATION

BASIS OF ELEVATION

SPOT ELEVATION LOCATED AT THE NORTHEAST CORNER OF SECTION 15, T9N, R58W, 6th P.M. TAKEN FROM THE GATEHOOK SPRING, QUADRANGLE, COLORADO, WELD COUNTY, 7.5 MINUTE QUAD (TOPOGRAPHIC MAP) PUBLISHED BY THE UNITED STATES DEPARTMENT OF THE INTERIOR, GEOLOGICAL SURVEY. SAID ELEVATION IS MARKED AS BEING 4679 FEET.

WHITING OIL & GAS CORP.

HORSETAIL #07E-0601 (SURFACE LOCATION)
LOT 2, SECTION 7, T10N, R57W, 6th P.M.
WELD COUNTY, COLORADO

SURVEYED BY: DALLAS NIELSEN, J.S.	DATE: 12-12-14
DRAWN BY: K.B.	DATE DRAWN: 07-31-14
SCALE: 1" = 1000'	REVISED: 12-01-15 M.O.E.

WELL LOCATION PLAT



UELS, LLC
Corporate Office * 85 South 200 East
Vernal, UT 84078 * (435) 789-1017



CERTIFICATE
THIS IS TO CERTIFY THAT THE ABOVE PLAT WAS PREPARED FROM FIELD NOTES OF ACTUAL SURVEYS MADE BY ME OR UNDER MY SUPERVISION AND THAT THE SAME ARE TRUE AND CORRECT TO THE BEST OF MY KNOWLEDGE AND BELIEF.

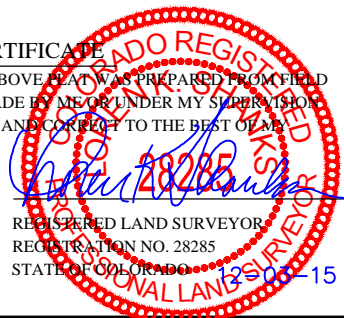

T10N, R57W, 6th P.M.

-
- Section 7, T10N, R57W, 6th P.M.**
- Lot 4 (Yellow):** Contains Target Bottom Hole. 1917 Brass Cap, 0.3' High. Lat: 40.875286°, Long: 103.804261°. N89°19'53"E - 2550.29' (Meas.).
- Lot 6 (Blue):** Contains Note: THE PROPOSED TARGET BOTTOM HOLE BEARS N00°33'10"W 7269.14' FROM THE TOP OF PRODUCTION WHICH IS LOCATED IN LOT 2 OF SECTION 7, T10N, R57W, 6th P.M. AT 2545' FNL 170' FWL.
- Section Boundaries:**
- Top: S89°25'02"W - 2686.24' (Meas.)
 - Bottom: S89°29'32"W - 2517.94' (Meas.) and S89°29'19"W - 2651.74' (Meas.)
 - Left: N00°23'04"W 2661.63' (Meas.) and N00°31'18"W - 2662.07' (Meas.)
 - Right: T11N T10N S00°18'29"W - 2675.90' (Meas.) and S00°13'16"W - 2658.78' (Meas.)
- Other Features:**
- 1917 Brass Cap, 0.4' High. Lat: 40.875436°, Long: 103.785333°
 - 1917 Brass Cap, 0.6' High. Lat: 40.868094°, Long: 103.785392°
 - 2006 Alum. Cap, 0.9' Below Ground. Lat: 40.860736°, Long: 103.795017°
 - 2006 Alum. Cap, 0.9' Below Ground. Lat: 40.860797°, Long: 103.785433°
- Top of Production:** Located at the bottom of the section, indicated by a diamond symbol.

NAD 83 (TARGET BOTTOM HOLE)
LATITUDE = 40°52'25.12" (40.873644)
LONGITUDE = 103°48'13.20" (103.803667)
NAD 27 (TARGET BOTTOM HOLE)
LATITUDE = 40°52'25.18" (40.873661)
LONGITUDE = 103°48'11.39" (103.803164)



THIS IS TO CERTIFY THAT THE ABOVE PLAT WAS PREPARED FROM FIELD NOTES OF ACTUAL SURVEYS MADE BY ME OR UNDER MY SUPERVISION, AND THAT THE SAME ARE TRUE AND CORRECT TO THE BEST OF MY KNOWLEDGE AND BELIEF.

REGISTERED LAND SURVEYOR
REGISTRATION NO. 28285
STATE OF COLORADO 12-03-15

SPOT ELEVATION LOCATED AT THE NORTHEAST CORNER OF SECTION 15, T9N, R58W, 6th P.M. TAKEN FROM THE GATEHOOK SPRING, QUADRANGLE, COLORADO, WELD COUNTY, 7.5 MINUTE QUAD (TOPOGRAPHIC MAP) PUBLISHED BY THE UNITED STATES DEPARTMENT OF THE INTERIOR, GEOLOGICAL SURVEY. SAID ELEVATION IS MARKED AS BEING 4679 FEET.

**HORSETAIL #07E-0601 (TARGET BOTTOM HOLE)
LOT 4, SECTION 6, T10N, R57W, 6th P.M.
WELD COUNTY, COLORADO**

SURVEYED BY: DALLAS NIELSEN, J.S.		DATE: 12-12-14
DRAWN BY: K.B.		DATE DRAWN: 07-31-14
SCALE: 1" = 1000'		REVISED: 12-01-15 M.O.E.

WELL LOCATION PLAT



UELS, LLC
Corporate Office * 85 South 200 East
Vernal, UT 84078 * (435) 789-1017

