

# JOHNSON TRUST 13-I PAD PAD LAYOUT

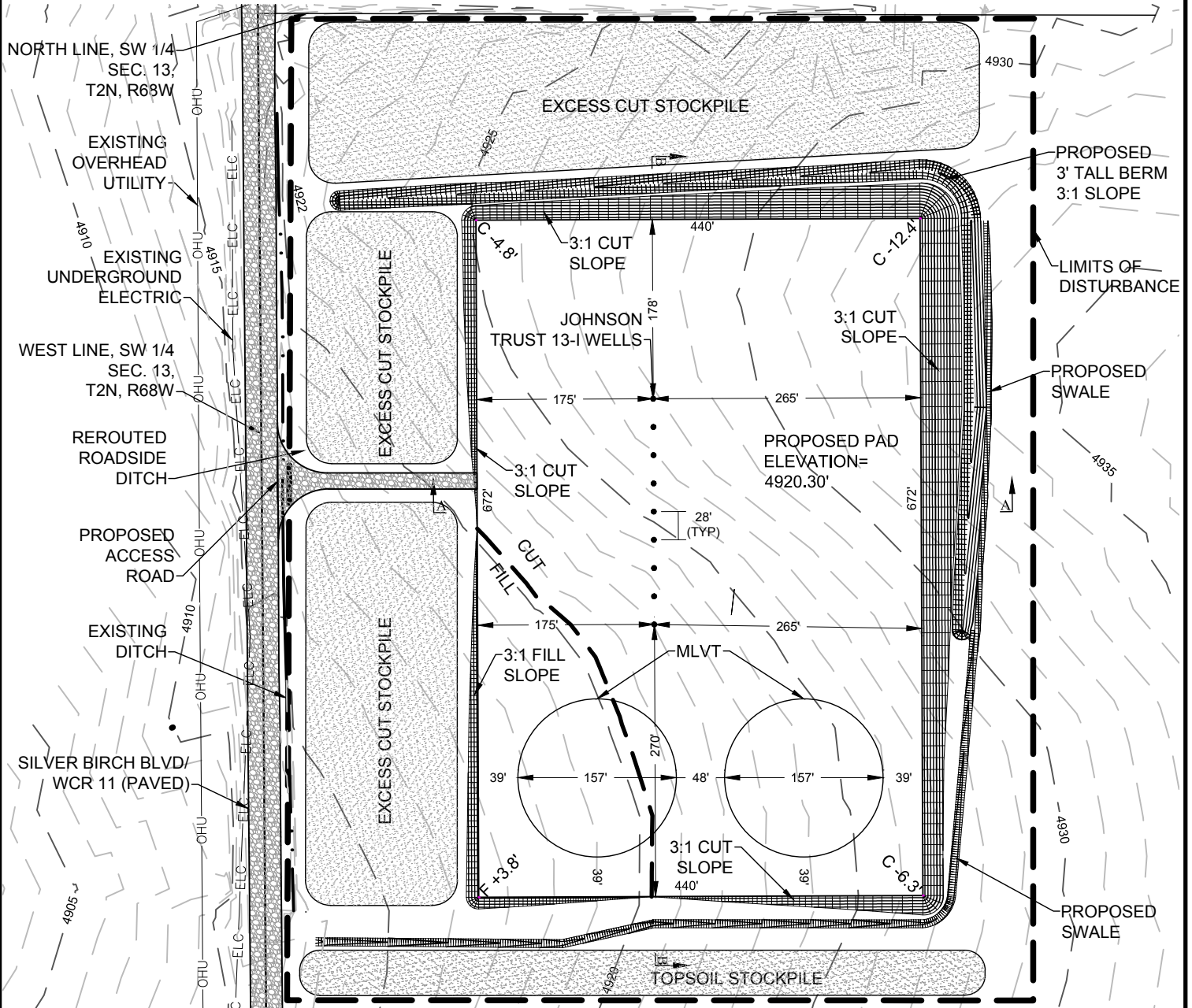

## NOTES:

1. A COMPLETE UTILITIES LOCATION IS RECOMMENDED BEFORE CONSTRUCTION.
2. GEOGRAPHIC POSITIONS/COORDINATES SHOWN HEREON ARE IN NAD83 DATUM.
3. EARTHWORK QUANTITIES ARE APPROXIMATE & FOR INFORMATION ONLY. 6" OF TOPSOIL HAS BEEN SUBTRACTED FROM EXISTING SURFACE PRIOR TO PERFORMING EARTHWORK CALCULATIONS.
4. STOCKPILES ARE ASSUMED TO BE 10' IN HEIGHT WITH 2:1 SIDE SLOPES.

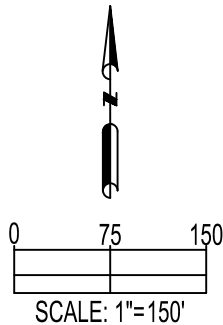

## SITE QUANTITIES

FINISHED GRADE ELEVATION	4920.30'
TOTAL CUT FOR WELL PAD	59,087 CY
FILL FOR WELL PAD	5,271 CY
10% FILL FACTOR	527 CY
TOTAL FILL	5,798 CY
NET EXCESS MATERIAL	53,289 CY
MATERIAL TO BE EXPORTED	0 CY
TOPSOIL FROM GRADED AREA	6,274 CY
TOTAL DISTURBANCE AREA	16.5 ACRES

PREPARED BY:



FIELD DATE:

03-18-15

DRAWING DATE:

10-20-15

BY:

WDW

CHECKED BY:

SWW

SITE NAME:

JOHNSON TRUST 13-I PAD

SURFACE LOCATION:

NW 1/4 SW 1/4, SEC. 13, T2N, R68W, 6TH P.M.  
WELD COUNTY, COLORADO

PREPARED FOR:



# JOHNSON TRUST 13-I PAD CROSS SECTIONS

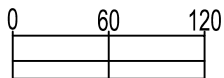
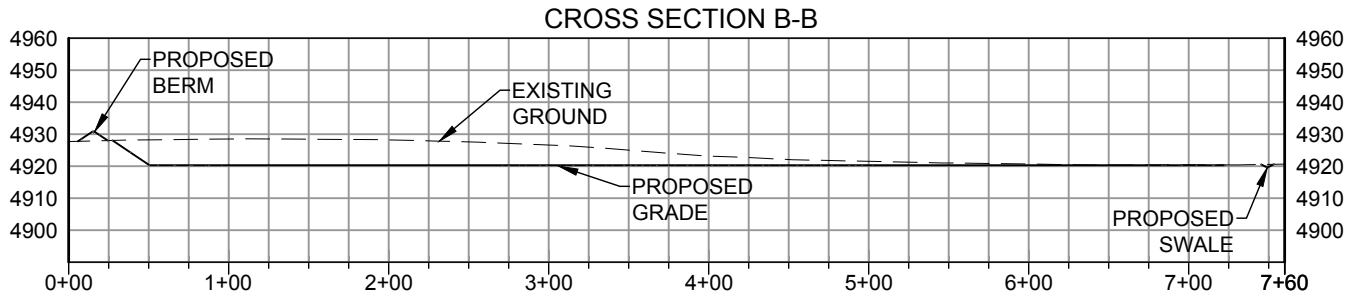
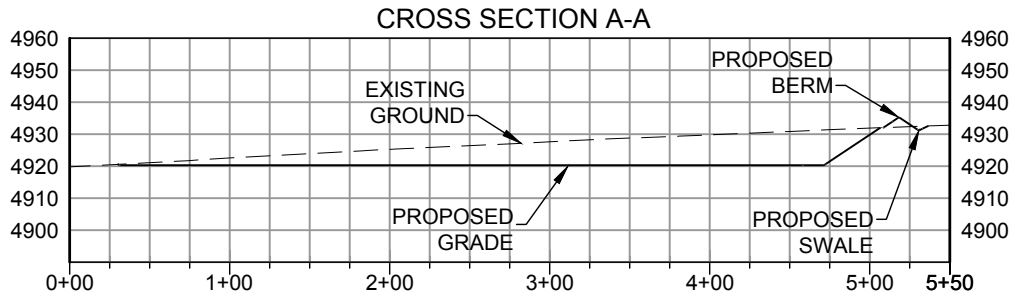

SCALE: 1"=120'  
VERT SCALE: 1"=60'

**NOTE:**

1. A COMPLETE UTILITIES LOCATION IS RECOMMENDED BEFORE CONSTRUCTION.
2. GEOGRAPHIC POSITIONS/COORDINATES SHOWN HEREON ARE IN NAD83 DATUM.

PREPARED BY:



FIELD DATE:

03-18-15

DRAWING DATE:

10-20-15

BY:

WDW

CHECKED BY:

SWW

SITE NAME:

JOHNSON TRUST 13-I PAD

SURFACE LOCATION:

NW 1/4 SW 1/4, SEC. 13, T2N, R68W, 6TH P.M.  
WELD COUNTY, COLORADO

PREPARED FOR:



# JOHNSON TRUST 13-I PAD PRODUCTION LAYOUT

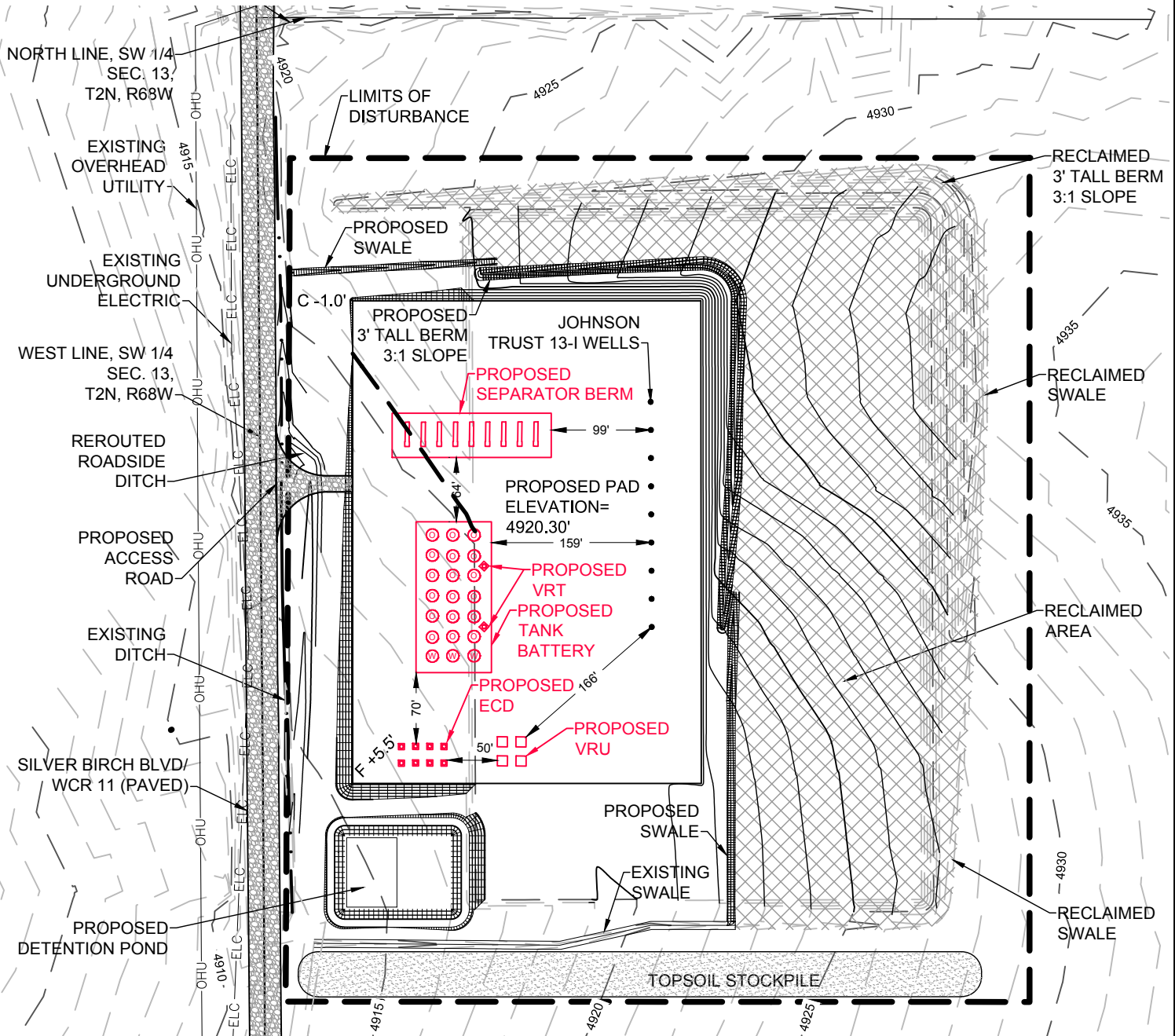

## NOTES:

1. A COMPLETE UTILITIES LOCATION IS RECOMMENDED BEFORE CONSTRUCTION.
2. GEOGRAPHIC POSITIONS/COORDINATES SHOWN HEREON ARE IN NAD83 DATUM.
3. EARTHWORK QUANTITIES ARE APPROXIMATE & FOR INFORMATION ONLY. 6" OF TOPSOIL HAS BEEN SUBTRACTED FROM EXISTING SURFACE PRIOR TO PERFORMING EARTHWORK CALCULATIONS.
4. STOCKPILES ARE ASSUMED TO BE 10' IN HEIGHT WITH 2:1 SIDE SLOPES.

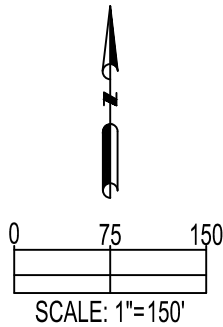

## SITE QUANTITIES

FINISHED GRADE ELEVATION	4920.30'
TOTAL CUT FOR PRODUCTION PAD	1,927 CY
FILL FOR PRODUCTION PAD	50,196 CY
10% FILL FACTOR	5,020 CY
TOTAL FILL	55,216 CY
NET FILL MATERIAL	53,289 CY
EXCESS CUT FROM DRILL PAD	53,289 CY
MATERIAL TO BE EXPORTED	0 CY
NET STOCKPILED CUT MATERIAL	0 CY
TOPSOIL FROM GRADED AREA	1,217 CY
TOTAL DISTURBANCE AREA	14.2 ACRES

PREPARED BY:



FIELD DATE:

03-18-15

DRAWING DATE:

10-20-15

BY:

WDW

CHECKED BY:

SWW

SITE NAME:

JOHNSON TRUST 13-I PAD

SURFACE LOCATION:

NW 1/4 SW 1/4, SEC. 13, T2N, R68W, 6TH P.M.  
WELD COUNTY, COLORADO

PREPARED FOR:

