



Washburn Land Surveying  
www.WashburnSurveying.com  
970-232-9645

# HYDROLOGY MAP

## CECIL'S KERSEY FARM 5N64W17B PAD

SECTION: 17  
TOWNSHIP: 5N  
RANGE: 64W  
6TH P.M.  
WELD COUNTY, CO

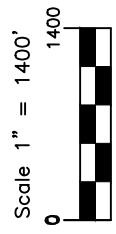
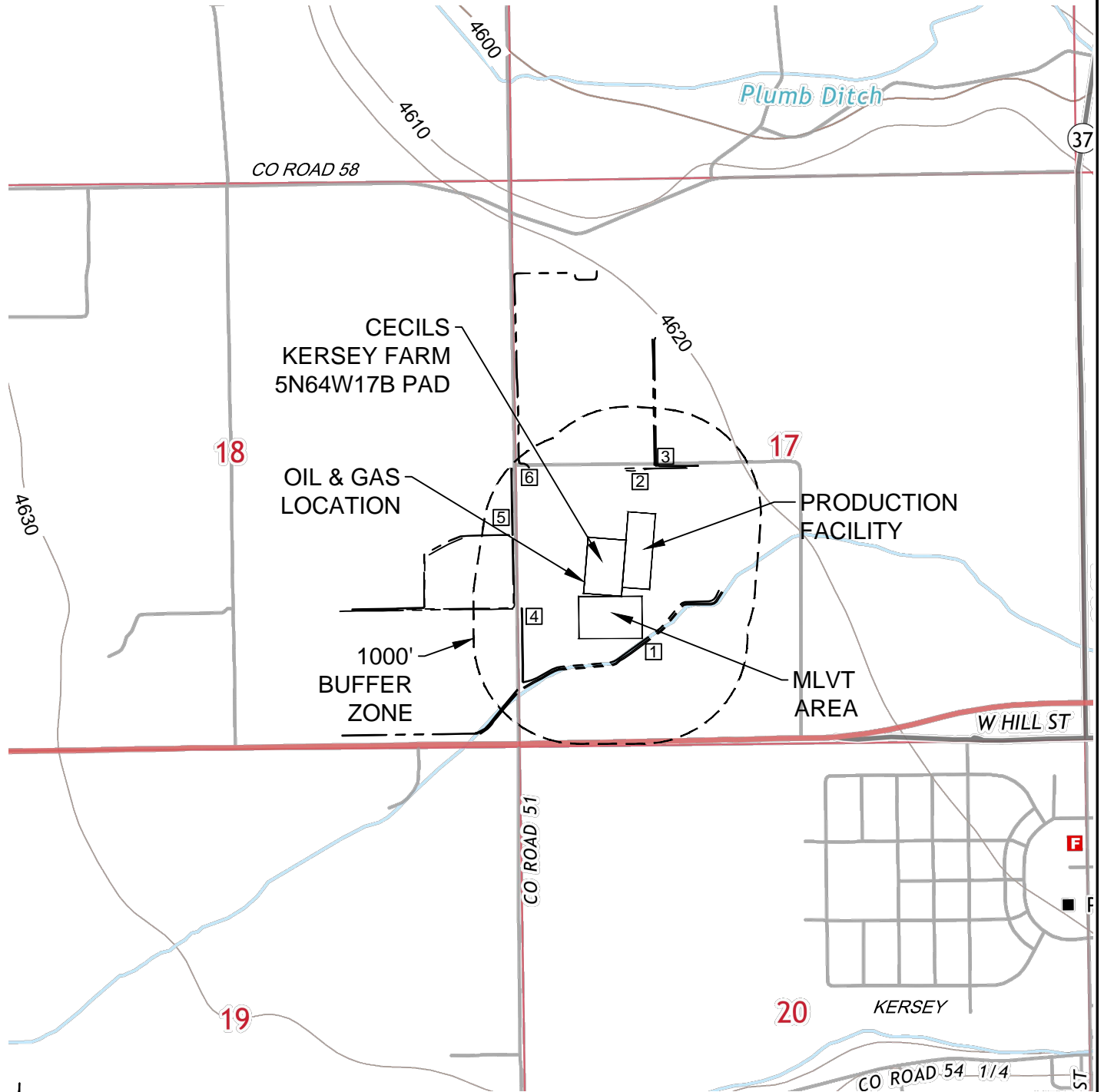

DISTANCES BELOW MEASURED FROM THE PROPOSED EDGE OF DISTURBANCE OF THE OIL AND GAS LOCATION

- 1 DITCH: 21' SE (NEAREST DOWN GRADIENT WATER FEATURE)
- 2 DITCH: 387' N
- 3 DITCH: 455' N
- 4 DITCH: 598' SW
- 5 DITCH: 711' W
- 6 DITCH: 866' NW