

Created By: Seth Burstad Date: 7-26-15



Magnetic Field
Strength: 52598.8snT
Dip Angle: 66.95°
Date: 8/5/2015
Model: BGGM2014

WELL DETAILS: Anschutz State 05-62-22-6457B2B

	GL 4680' & KB 16' @ 4696.00ft (Cade 25)	4680.00	
Northing	Easting	Latitude	Longitude
1383263.52	3329198.80	40° 22' 45.980 N	104° 19' 5.970 W

PROJECT DETAILS: Weld County, CO NAD 83

Geodetic System: US State Plane 1983
Datum: North American Datum 1983
Ellipsoid: GRS 1980
Zone: Colorado Northern Zone

System Datum: Mean Sea Level
Local North: True

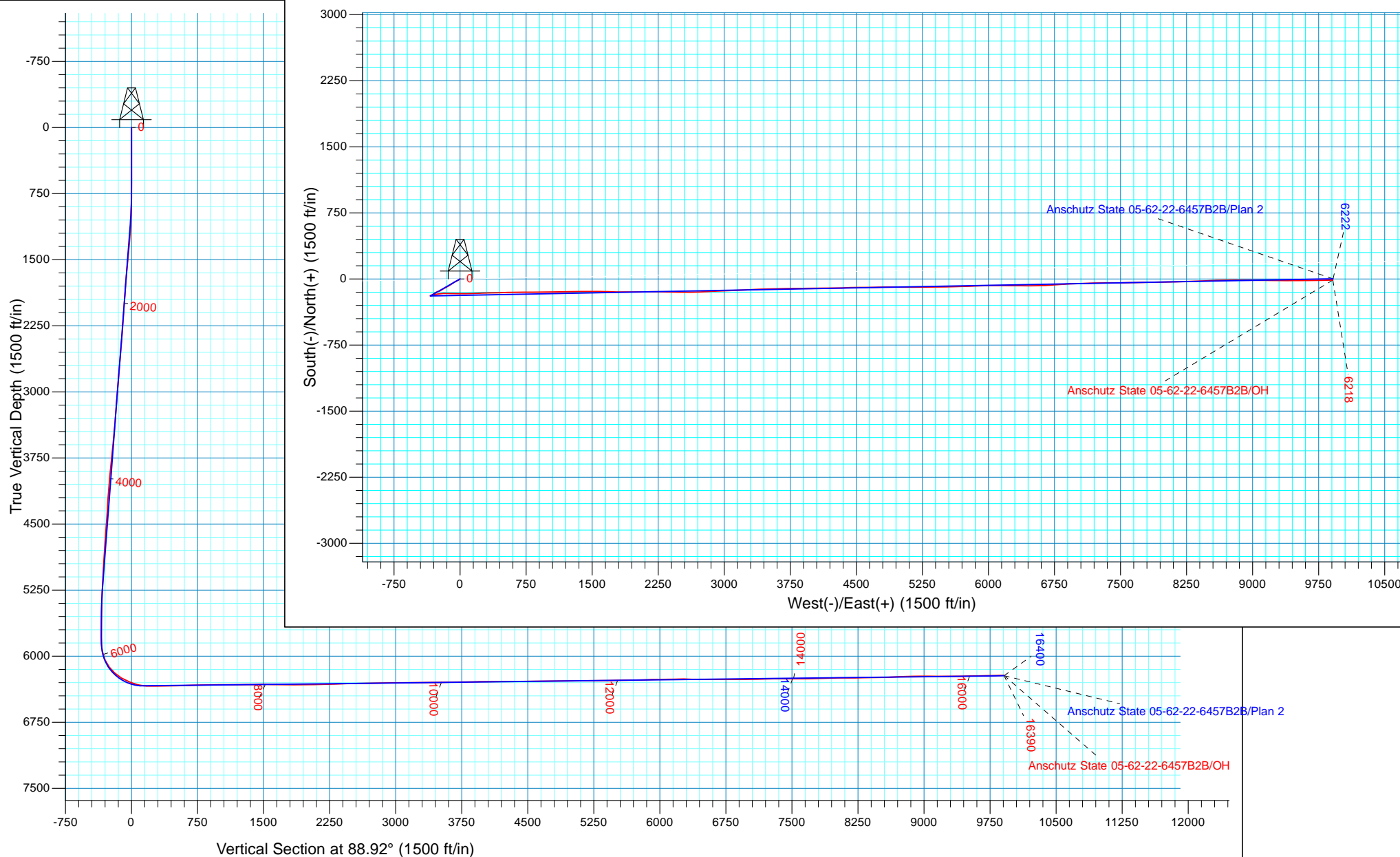



Bill Barrett Corporation

Bill Barrett Corp.

Weld County, CO NAD 83

Anschutz State 5-62-22_23 SWSW Pad

Anschutz State 05-62-22-6457B2B

OH

Design: OH

Standard Survey Report

12 September, 2015



Scientific Drilling

www.scientificdrilling.com



Company:	Bill Barrett Corp.	Local Co-ordinate Reference:	Well Anschutz State 05-62-22-6457B2B
Project:	Weld County, CO NAD 83	TVD Reference:	GL 4680' & KB 16' @ 4696.00ft (Cade 25)
Site:	Anschutz State 5-62-22_23 SWSW Pad	MD Reference:	GL 4680' & KB 16' @ 4696.00ft (Cade 25)
Well:	Anschutz State 05-62-22-6457B2B	North Reference:	True
Wellbore:	OH	Survey Calculation Method:	Minimum Curvature
Design:	OH	Database:	Casper District

Project	Weld County, CO NAD 83		
Map System:	US State Plane 1983	System Datum:	Mean Sea Level
Geo Datum:	North American Datum 1983		
Map Zone:	Colorado Northern Zone		

Site		Anschutz State 5-62-22_23 SWSW Pad			
Site Position:		Northing:	1,383,248.26 usft	Latitude:	40° 22' 45.829 N
From:	Lat/Long	Easting:	3,329,198.17 usft	Longitude:	104° 19' 5.981 W
Position Uncertainty:	0.00 ft	Slot Radius:	13.200 in	Grid Convergence:	0.76 °

Well	Anschutz State 05-62-22-6457B2B, 515' FSL 350' FWL Sec 22 T5N R62W					
Well Position	+N/-S	0.00 ft	Northing:	1,383,263.52 usft	Latitude:	40° 22' 45.980 N
	+E/-W	0.00 ft	Easting:	3,329,198.80 usft	Longitude:	104° 19' 5.970 W
Position Uncertainty		0.00 ft	Wellhead Elevation:	0.00 ft	Ground Level:	4,680.00 ft

Wellbore	OH				
Magnetics	Model Name	Sample Date	Declination (°)	Dip Angle (°)	Field Strength (nT)
	BGGM2014	8/5/2015	8.19	66.95	52,599

Design	OH				
Audit Notes:					
Version:	1.0	Phase:	ACTUAL	Tie On Depth:	0.00
Vertical Section:	Depth From (TVD) (ft)	+N/-S (ft)	+E/-W (ft)	Direction (°)	
	0.00	0.00	0.00	88.92	

Survey Program	Date	9/12/2015			
From (ft)	To (ft)	Survey (Wellbore)	Tool Name	Description	
800.00	6,600.00	Survey #1 - Vertical / Curve (OH)	SDI MWD	SDI MWD - Standard ver 1.0.1	
6,677.00	16,390.00	Survey #2 - Lateral (OH)	SDI MWD	SDI MWD - Standard ver 1.0.1	

Survey										
Measured Depth (ft)	Inclination (°)	Azimuth (°)	Vertical Depth (ft)	+N/-S (ft)	+E/-W (ft)	Vertical Section (ft)	Dogleg Rate (°/100ft)	Build Rate (°/100ft)	Turn Rate (°/100ft)	
0.00	0.00	0.00	0.00	0.00	0.00	0.00	0.00	0.00	0.00	
800.00	0.00	0.00	800.00	0.00	0.00	0.00	0.00	0.00	0.00	
Assumed Vertical										
889.00	0.87	253.28	889.00	-0.19	-0.65	-0.65	0.98	0.98	0.00	
First SDI MWD Survey										
982.00	2.10	236.32	981.96	-1.34	-2.74	-2.77	1.39	1.32	-18.24	
1,075.00	3.48	235.96	1,074.85	-3.87	-6.50	-6.57	1.48	1.48	-0.39	
1,168.00	5.11	236.40	1,167.59	-7.74	-12.29	-12.43	1.75	1.75	0.47	
1,260.00	5.29	234.03	1,259.21	-12.50	-19.13	-19.36	0.30	0.20	-2.58	

Company:	Bill Barrett Corp.	Local Co-ordinate Reference:	Well Anschutz State 05-62-22-6457B2B
Project:	Weld County, CO NAD 83	TVD Reference:	GL 4680' & KB 16' @ 4696.00ft (Cade 25)
Site:	Anschutz State 5-62-22_23 SWSW Pad	MD Reference:	GL 4680' & KB 16' @ 4696.00ft (Cade 25)
Well:	Anschutz State 05-62-22-6457B2B	North Reference:	True
Wellbore:	OH	Survey Calculation Method:	Minimum Curvature
Design:	OH	Database:	Casper District

Survey									
Measured Depth (ft)	Inclination (°)	Azimuth (°)	Vertical Depth (ft)	+N/-S (ft)	+E/-W (ft)	Vertical Section (ft)	Dogleg Rate (°/100ft)	Build Rate (°/100ft)	Turn Rate (°/100ft)
1,353.00	5.85	238.62	1,351.77	-17.48	-26.65	-26.97	0.77	0.60	4.94
1,445.00	6.03	244.45	1,443.28	-22.01	-35.01	-35.42	0.68	0.20	6.34
1,538.00	5.96	242.70	1,535.77	-26.33	-43.71	-44.20	0.21	-0.08	-1.88
1,630.00	5.52	244.16	1,627.31	-30.45	-51.94	-52.50	0.50	-0.48	1.59
1,723.00	5.11	244.84	1,719.91	-34.16	-59.71	-60.34	0.45	-0.44	0.73
1,814.00	4.54	247.76	1,810.58	-37.25	-66.71	-67.40	0.68	-0.63	3.21
1,907.00	5.06	232.69	1,903.26	-41.13	-73.38	-74.14	1.46	0.56	-16.20
2,000.00	5.55	231.49	1,995.86	-46.41	-80.16	-81.02	0.54	0.53	-1.29
2,092.00	5.37	231.73	2,087.44	-51.85	-87.02	-87.98	0.20	-0.20	0.26
2,182.00	4.44	235.74	2,177.11	-56.42	-93.21	-94.26	1.10	-1.03	4.46
2,275.00	4.82	240.90	2,269.81	-60.35	-99.60	-100.72	0.61	0.41	5.55
2,367.00	4.17	245.41	2,361.53	-63.62	-106.02	-107.20	0.80	-0.71	4.90
2,459.00	5.45	239.03	2,453.20	-67.26	-112.81	-114.05	1.51	1.39	-6.93
2,552.00	4.83	234.44	2,545.83	-71.81	-119.78	-121.11	0.80	-0.67	-4.94
2,644.00	5.87	239.32	2,637.43	-76.46	-126.97	-128.39	1.23	1.13	5.30
2,737.00	5.43	237.90	2,729.98	-81.22	-134.79	-136.30	0.50	-0.47	-1.53
2,830.00	6.07	237.35	2,822.51	-86.22	-142.66	-144.26	0.69	0.69	-0.59
2,925.00	5.75	242.42	2,917.00	-91.13	-151.11	-152.80	0.64	-0.34	5.34
3,021.00	5.07	241.67	3,012.57	-95.37	-159.10	-160.87	0.71	-0.71	-0.78
3,116.00	4.74	238.23	3,107.23	-99.43	-166.14	-167.98	0.47	-0.35	-3.62
3,211.00	5.00	248.65	3,201.89	-103.00	-173.33	-175.24	0.97	0.27	10.97
3,306.00	3.97	246.40	3,296.59	-105.82	-180.20	-182.16	1.10	-1.08	-2.37
3,400.00	5.24	235.82	3,390.29	-109.54	-186.73	-188.76	1.62	1.35	-11.26
3,495.00	6.50	237.09	3,484.79	-114.90	-194.83	-196.97	1.33	1.33	1.34
3,590.00	7.06	240.09	3,579.13	-120.73	-204.41	-206.65	0.70	0.59	3.16
3,685.00	7.27	235.51	3,673.38	-127.05	-214.42	-216.78	0.64	0.22	-4.82
3,780.00	6.93	240.62	3,767.66	-133.26	-224.37	-226.84	0.75	-0.36	5.38
3,876.00	6.40	250.21	3,863.01	-137.91	-234.45	-237.01	1.28	-0.55	9.99
3,971.00	4.55	248.57	3,957.57	-141.08	-242.94	-245.56	1.95	-1.95	-1.73
4,066.00	3.93	255.79	4,052.31	-143.26	-249.61	-252.26	0.86	-0.65	7.60
4,161.00	4.40	258.42	4,147.06	-144.79	-256.33	-259.02	0.53	0.49	2.77
4,256.00	4.44	247.49	4,241.78	-146.93	-263.30	-266.02	0.89	0.04	-11.51
4,352.00	4.12	243.75	4,337.51	-149.88	-269.83	-272.60	0.44	-0.33	-3.90
4,447.00	4.19	242.08	4,432.26	-153.01	-275.95	-278.79	0.15	0.07	-1.76
4,543.00	4.85	240.23	4,527.96	-156.67	-282.58	-285.48	0.70	0.69	-1.93
4,638.00	4.79	240.03	4,622.63	-160.65	-289.50	-292.48	0.07	-0.06	-0.21
4,733.00	5.03	235.77	4,717.28	-164.97	-296.38	-299.43	0.46	0.25	-4.48
4,828.00	5.11	232.69	4,811.91	-169.88	-303.19	-306.33	0.30	0.08	-3.24
4,924.00	4.71	234.71	4,907.56	-174.74	-309.80	-313.04	0.45	-0.42	2.10
5,019.00	3.89	234.27	5,002.29	-178.88	-315.60	-318.92	0.86	-0.86	-0.46
5,115.00	3.38	232.65	5,098.09	-182.50	-320.50	-323.88	0.54	-0.53	-1.69
5,210.00	2.77	237.47	5,192.96	-185.43	-324.66	-328.10	0.70	-0.64	5.07
5,305.00	2.96	234.82	5,287.84	-188.08	-328.60	-332.09	0.24	0.20	-2.79

Company:	Bill Barrett Corp.	Local Co-ordinate Reference:	Well Anschutz State 05-62-22-6457B2B
Project:	Weld County, CO NAD 83	TVD Reference:	GL 4680' & KB 16' @ 4696.00ft (Cade 25)
Site:	Anschutz State 5-62-22_23 SWSW Pad	MD Reference:	GL 4680' & KB 16' @ 4696.00ft (Cade 25)
Well:	Anschutz State 05-62-22-6457B2B	North Reference:	True
Wellbore:	OH	Survey Calculation Method:	Minimum Curvature
Design:	OH	Database:	Casper District

Survey									
Measured Depth (ft)	Inclination (°)	Azimuth (°)	Vertical Depth (ft)	+N/-S (ft)	+E/-W (ft)	Vertical Section (ft)	Dogleg Rate (°/100ft)	Build Rate (°/100ft)	Turn Rate (°/100ft)
5,401.00	2.32	233.67	5,383.74	-190.66	-332.19	-335.72	0.67	-0.67	-1.20
5,496.00	1.28	274.55	5,478.69	-191.71	-334.80	-338.35	1.67	-1.09	43.03
5,592.00	1.34	281.59	5,574.67	-191.40	-336.97	-340.51	0.18	0.06	7.33
5,686.00	1.34	263.25	5,668.64	-191.31	-339.13	-342.68	0.45	0.00	-19.51
5,780.00	0.43	190.00	5,762.63	-191.79	-340.29	-343.84	1.37	-0.97	-77.93
5,875.00	2.31	81.01	5,857.61	-191.84	-338.46	-342.01	2.61	1.98	-114.73
5,967.00	13.55	73.03	5,948.58	-188.39	-326.28	-329.77	12.25	12.22	-8.67
6,062.00	24.22	73.04	6,038.34	-179.44	-296.91	-300.24	11.23	11.23	0.01
6,157.00	35.17	80.84	6,120.77	-169.36	-251.10	-254.25	12.20	11.53	8.21
6,251.00	49.50	88.60	6,190.12	-164.15	-188.28	-191.34	16.20	15.24	8.26
6,347.00	58.84	92.27	6,246.27	-164.88	-110.56	-113.64	10.21	9.73	3.82
6,442.00	67.37	90.31	6,289.20	-166.74	-25.94	-29.07	9.16	8.98	-2.06
6,539.00	74.73	89.18	6,320.68	-166.31	65.74	62.59	7.67	7.59	-1.16
6,600.00	81.74	88.16	6,333.11	-164.92	125.40	122.27	11.61	11.49	-1.67
Last SDI MWD Curve Survey									
6,677.00	89.53	88.13	6,338.97	-162.43	202.08	198.98	10.12	10.12	-0.04
First SDI MWD Lateral Survey									
6,729.00	89.46	88.14	6,339.43	-160.74	254.05	250.98	0.14	-0.13	0.02
6,825.00	91.34	88.73	6,338.76	-158.12	350.01	346.97	2.05	1.96	0.61
6,920.00	91.11	88.51	6,336.73	-155.83	444.96	441.94	0.33	-0.24	-0.23
7,015.00	91.85	89.26	6,334.27	-153.98	539.91	536.91	1.11	0.78	0.79
7,110.00	92.51	88.94	6,330.66	-152.49	634.83	631.84	0.77	0.69	-0.34
7,206.00	90.91	89.39	6,327.80	-151.09	730.77	727.79	1.73	-1.67	0.47
7,300.00	90.00	89.66	6,327.05	-150.31	824.76	821.78	1.01	-0.97	0.29
7,395.00	90.67	88.45	6,326.49	-148.75	919.75	916.78	1.46	0.71	-1.27
7,489.00	91.24	89.61	6,324.93	-147.16	1,013.72	1,010.77	1.37	0.61	1.23
7,585.00	89.97	89.66	6,323.91	-146.54	1,109.71	1,106.75	1.32	-1.32	0.05
7,681.00	90.81	89.08	6,323.26	-145.49	1,205.70	1,202.74	1.06	0.88	-0.60
7,776.00	89.90	89.17	6,322.67	-144.04	1,300.69	1,297.74	0.96	-0.96	0.09
7,871.00	91.58	89.04	6,321.44	-142.55	1,395.66	1,392.73	1.77	1.77	-0.14
7,966.00	90.80	89.93	6,319.47	-141.70	1,490.64	1,487.70	1.25	-0.82	0.94
8,062.00	88.73	91.40	6,319.87	-142.81	1,586.62	1,583.65	2.64	-2.16	1.53
8,157.00	88.93	91.16	6,321.80	-144.94	1,681.58	1,678.55	0.33	0.21	-0.25
8,253.00	89.50	91.01	6,323.12	-146.75	1,777.55	1,774.47	0.61	0.59	-0.16
8,348.00	88.99	90.16	6,324.37	-147.72	1,872.54	1,869.42	1.04	-0.54	-0.89
8,444.00	90.97	89.56	6,324.41	-147.49	1,968.53	1,965.40	2.16	2.06	-0.63
8,539.00	91.88	90.04	6,322.04	-147.16	2,063.50	2,060.36	1.08	0.96	0.51
8,634.00	91.54	89.07	6,319.21	-146.42	2,158.45	2,155.31	1.08	-0.36	-1.02
8,729.00	90.74	90.56	6,317.32	-146.11	2,253.43	2,250.28	1.78	-0.84	1.57
8,825.00	92.35	90.60	6,314.73	-147.09	2,349.39	2,346.20	1.68	1.68	0.04
8,919.00	91.74	91.48	6,311.38	-148.79	2,443.31	2,440.07	1.14	-0.65	0.94
9,013.00	90.67	90.76	6,309.40	-150.63	2,537.27	2,533.98	1.37	-1.14	-0.77
9,109.00	91.17	88.61	6,307.86	-150.10	2,633.25	2,629.96	2.30	0.52	-2.24
9,204.00	91.24	88.31	6,305.86	-147.55	2,728.20	2,724.93	0.32	0.07	-0.32

Company:	Bill Barrett Corp.	Local Co-ordinate Reference:	Well Anschutz State 05-62-22-6457B2B
Project:	Weld County, CO NAD 83	TVD Reference:	GL 4680' & KB 16' @ 4696.00ft (Cade 25)
Site:	Anschutz State 5-62-22_23 SWSW Pad	MD Reference:	GL 4680' & KB 16' @ 4696.00ft (Cade 25)
Well:	Anschutz State 05-62-22-6457B2B	North Reference:	True
Wellbore:	OH	Survey Calculation Method:	Minimum Curvature
Design:	OH	Database:	Casper District

Survey										
Measured Depth (ft)	Inclination (°)	Azimuth (°)	Vertical Depth (ft)	+N/-S (ft)	+E/-W (ft)	Vertical Section (ft)	Dogleg Rate (°/100ft)	Build Rate (°/100ft)	Turn Rate (°/100ft)	
9,299.00	90.44	86.68	6,304.47	-143.40	2,823.09	2,819.89	1.91	-0.84	-1.72	
9,394.00	90.84	87.18	6,303.41	-138.31	2,917.95	2,914.82	0.67	0.42	0.53	
9,490.00	90.03	87.53	6,302.68	-133.88	3,013.84	3,010.78	0.92	-0.84	0.36	
9,585.00	91.24	88.22	6,301.62	-130.36	3,108.77	3,105.76	1.47	1.27	0.73	
9,680.00	90.67	86.98	6,300.04	-126.38	3,203.67	3,200.72	1.44	-0.60	-1.31	
9,776.00	90.60	87.06	6,298.98	-121.39	3,299.53	3,296.66	0.11	-0.07	0.08	
9,871.00	90.97	88.47	6,297.67	-117.68	3,394.45	3,391.63	1.53	0.39	1.48	
9,967.00	91.17	87.17	6,295.88	-114.03	3,490.36	3,487.59	1.37	0.21	-1.35	
10,063.00	90.13	89.52	6,294.79	-111.26	3,586.31	3,583.57	2.68	-1.08	2.45	
10,158.00	90.54	88.82	6,294.24	-109.88	3,681.30	3,678.57	0.85	0.43	-0.74	
10,253.00	91.64	88.69	6,292.43	-107.82	3,776.26	3,773.55	1.17	1.16	-0.14	
10,348.00	90.67	90.05	6,290.51	-106.78	3,871.23	3,868.53	1.76	-1.02	1.43	
10,443.00	90.50	89.31	6,289.54	-106.25	3,966.22	3,963.51	0.80	-0.18	-0.78	
10,535.00	90.57	89.41	6,288.69	-105.22	4,058.21	4,055.51	0.13	0.08	0.11	
10,627.00	90.03	89.85	6,288.20	-104.62	4,150.21	4,147.50	0.76	-0.59	0.48	
10,719.00	90.40	89.52	6,287.86	-104.12	4,242.20	4,239.49	0.54	0.40	-0.36	
10,812.00	90.13	88.22	6,287.43	-102.28	4,335.18	4,332.48	1.43	-0.29	-1.40	
10,905.00	90.37	87.27	6,287.02	-98.63	4,428.11	4,425.46	1.05	0.26	-1.02	
10,997.00	90.57	90.02	6,286.27	-96.45	4,520.07	4,517.45	3.00	0.22	2.99	
11,089.00	90.80	89.74	6,285.17	-96.26	4,612.06	4,609.43	0.39	0.25	-0.30	
11,182.00	90.91	89.11	6,283.78	-95.32	4,705.05	4,702.42	0.69	0.12	-0.68	
11,276.00	91.37	89.03	6,281.91	-93.80	4,799.02	4,796.40	0.50	0.49	-0.09	
11,368.00	90.27	89.87	6,280.59	-92.92	4,891.00	4,888.38	1.50	-1.20	0.91	
11,461.00	90.13	89.92	6,280.27	-92.75	4,984.00	4,981.37	0.16	-0.15	0.05	
11,554.00	90.30	90.08	6,279.92	-92.75	5,077.00	5,074.35	0.25	0.18	0.17	
11,646.00	90.77	89.92	6,279.06	-92.75	5,169.00	5,166.33	0.54	0.51	-0.17	
11,739.00	90.30	90.23	6,278.19	-92.87	5,261.99	5,259.31	0.61	-0.51	0.33	
11,831.00	90.74	89.99	6,277.36	-93.04	5,353.99	5,351.28	0.54	0.48	-0.26	
11,924.00	90.80	88.73	6,276.11	-92.00	5,446.97	5,444.27	1.36	0.06	-1.35	
12,016.00	91.07	88.38	6,274.61	-89.69	5,538.93	5,536.25	0.48	0.29	-0.38	
12,109.00	91.27	88.45	6,272.71	-87.11	5,631.87	5,629.23	0.23	0.22	0.08	
12,201.00	91.44	87.69	6,270.53	-84.02	5,723.80	5,721.19	0.85	0.18	-0.83	
12,293.00	91.68	87.80	6,268.03	-80.40	5,815.69	5,813.14	0.29	0.26	0.12	
12,386.00	91.18	88.89	6,265.71	-77.71	5,908.62	5,906.11	1.29	-0.54	1.17	
12,478.00	91.74	89.07	6,263.36	-76.08	6,000.58	5,998.08	0.64	0.61	0.20	
12,568.00	90.37	89.98	6,261.71	-75.33	6,090.55	6,088.05	1.83	-1.52	1.01	
12,661.00	91.78	90.10	6,259.96	-75.39	6,183.54	6,181.02	1.52	1.52	0.13	
12,753.00	88.83	90.97	6,259.47	-76.25	6,275.52	6,272.97	3.34	-3.21	0.95	
12,845.00	88.76	90.72	6,261.41	-77.61	6,367.49	6,364.89	0.28	-0.08	-0.27	
12,938.00	89.73	90.00	6,262.63	-78.19	6,460.48	6,457.86	1.30	1.04	-0.77	
13,030.00	89.23	88.48	6,263.47	-76.97	6,552.46	6,549.85	1.74	-0.54	-1.65	
13,123.00	90.20	87.79	6,263.93	-73.95	6,645.41	6,642.84	1.28	1.04	-0.74	
13,216.00	89.66	85.58	6,264.04	-68.57	6,738.25	6,735.76	2.45	-0.58	-2.38	

Company:	Bill Barrett Corp.	Local Co-ordinate Reference:	Well Anschutz State 05-62-22-6457B2B
Project:	Weld County, CO NAD 83	TVD Reference:	GL 4680' & KB 16' @ 4696.00ft (Cade 25)
Site:	Anschutz State 5-62-22_23 SWSW Pad	MD Reference:	GL 4680' & KB 16' @ 4696.00ft (Cade 25)
Well:	Anschutz State 05-62-22-6457B2B	North Reference:	True
Wellbore:	OH	Survey Calculation Method:	Minimum Curvature
Design:	OH	Database:	Casper District

Survey										
Measured Depth (ft)	Inclination (°)	Azimuth (°)	Vertical Depth (ft)	+N/-S (ft)	+E/-W (ft)	Vertical Section (ft)	Dogleg Rate (°/100ft)	Build Rate (°/100ft)	Turn Rate (°/100ft)	
13,310.00	90.47	86.25	6,263.94	-61.87	6,832.01	6,829.63	1.12	0.86	0.71	
13,403.00	90.50	87.25	6,263.15	-56.60	6,924.85	6,922.56	1.08	0.03	1.08	
13,494.00	90.94	88.69	6,262.00	-53.38	7,015.79	7,013.53	1.65	0.48	1.58	
13,587.00	90.94	87.59	6,260.48	-50.36	7,108.72	7,106.51	1.18	0.00	-1.18	
13,680.00	91.17	89.02	6,258.77	-47.61	7,201.67	7,199.49	1.56	0.25	1.54	
13,772.00	91.74	88.50	6,256.43	-45.62	7,293.61	7,291.46	0.84	0.62	-0.57	
13,865.00	89.43	89.87	6,255.48	-44.30	7,386.59	7,384.44	2.89	-2.48	1.47	
13,958.00	90.03	89.77	6,255.92	-44.01	7,479.59	7,477.43	0.65	0.65	-0.11	
14,050.00	89.77	89.54	6,256.08	-43.45	7,571.59	7,569.42	0.38	-0.28	-0.25	
14,143.00	91.24	88.39	6,255.26	-41.77	7,664.56	7,662.41	2.01	1.58	-1.24	
14,236.00	91.04	87.76	6,253.41	-38.65	7,757.49	7,755.39	0.71	-0.22	-0.68	
14,328.00	91.64	89.58	6,251.26	-36.51	7,849.44	7,847.36	2.08	0.65	1.98	
14,420.00	91.91	89.37	6,248.41	-35.67	7,941.39	7,939.31	0.37	0.29	-0.23	
14,513.00	91.11	89.36	6,245.96	-34.64	8,034.35	8,032.27	0.86	-0.86	-0.01	
14,606.00	89.73	87.35	6,245.28	-31.97	8,127.30	8,125.26	2.62	-1.48	-2.16	
14,698.00	90.87	89.57	6,244.79	-29.50	8,219.26	8,217.25	2.71	1.24	2.41	
14,791.00	90.77	88.97	6,243.46	-28.31	8,312.24	8,310.23	0.65	-0.11	-0.65	
14,884.00	90.57	87.05	6,242.38	-25.08	8,405.18	8,403.21	2.08	-0.22	-2.06	
14,976.00	90.54	87.15	6,241.48	-20.43	8,497.06	8,495.16	0.11	-0.03	0.11	
15,069.00	92.58	89.06	6,238.95	-17.36	8,589.96	8,588.11	3.00	2.19	2.05	
15,161.00	92.62	88.02	6,234.78	-15.01	8,681.83	8,680.01	1.13	0.04	-1.13	
15,253.00	91.84	89.11	6,231.20	-12.71	8,773.73	8,771.94	1.46	-0.85	1.18	
15,345.00	90.64	91.21	6,229.21	-12.97	8,865.71	8,863.89	2.63	-1.30	2.28	
15,440.00	91.24	91.66	6,227.65	-15.35	8,960.66	8,958.78	0.79	0.63	0.47	
15,533.00	89.30	90.84	6,227.21	-17.38	9,053.63	9,051.70	2.26	-2.09	-0.88	
15,626.00	89.30	90.16	6,228.35	-18.19	9,146.62	9,144.66	0.73	0.00	-0.73	
15,718.00	89.16	89.28	6,229.58	-17.74	9,238.61	9,236.64	0.97	-0.15	-0.96	
15,813.00	91.01	90.96	6,229.44	-17.94	9,333.60	9,331.61	2.63	1.95	1.77	
15,909.00	91.54	90.10	6,227.31	-18.83	9,429.58	9,427.55	1.05	0.55	-0.90	
16,004.00	91.71	89.97	6,224.61	-18.88	9,524.54	9,522.49	0.23	0.18	-0.14	
16,099.00	91.01	89.94	6,222.36	-18.81	9,619.51	9,617.45	0.74	-0.74	-0.03	
16,196.00	90.60	88.73	6,221.00	-17.68	9,716.49	9,714.43	1.32	-0.42	-1.25	
16,291.00	90.70	88.33	6,219.92	-15.25	9,811.45	9,809.42	0.43	0.11	-0.42	
16,327.00	91.54	88.89	6,219.21	-14.37	9,847.44	9,845.42	2.80	2.33	1.56	
Last SDI MWD Survey										
16,390.00	91.54	88.89	6,217.52	-13.15	9,910.40	9,908.39	0.00	0.00	0.00	
Projection to TD										

Company:	Bill Barrett Corp.	Local Co-ordinate Reference:	Well Anschutz State 05-62-22-6457B2B
Project:	Weld County, CO NAD 83	TVD Reference:	GL 4680' & KB 16' @ 4696.00ft (Cade 25)
Site:	Anschutz State 5-62-22_23 SWSW Pad	MD Reference:	GL 4680' & KB 16' @ 4696.00ft (Cade 25)
Well:	Anschutz State 05-62-22-6457B2B	North Reference:	True
Wellbore:	OH	Survey Calculation Method:	Minimum Curvature
Design:	OH	Database:	Casper District

Design Annotations				
Measured Depth (ft)	Vertical Depth (ft)	Local Coordinates		Comment
		+N/-S (ft)	+E/-W (ft)	
800.00	800.00	0.00	0.00	Assumed Vertical
889.00	889.00	-0.19	-0.65	First SDI MWD Survey
6,600.00	6,333.11	-164.92	125.40	Last SDI MWD Curve Survey
6,677.00	6,338.97	-162.43	202.08	First SDI MWD Lateral Survey
16,327.00	6,219.21	-14.37	9,847.44	Last SDI MWD Survey
16,390.00	6,217.52	-13.15	9,910.40	Projection to TD

Checked By: _____	Approved By: _____	Date: _____
-------------------	--------------------	-------------