

WELL DETAILS: Anschutz State 5-62-22-6457C2

PROJECT DETAILS: Weld County, CO NAD 83

Geodetic System: US State Plane 1983  
Datum: North American Datum 1983  
Ellipsoid: GRS 1980  
Zone: Colorado Northern Zone

System Datum: Mean Sea Level  
Local North: True

GL 4680' & KB 16' @ 4696.00ft (Cade 25) 4680.00  
Northing Easting Latitude Longitude  
1383278.82 3329198.59 40° 22' 46.131 N 104° 19' 5.970 W

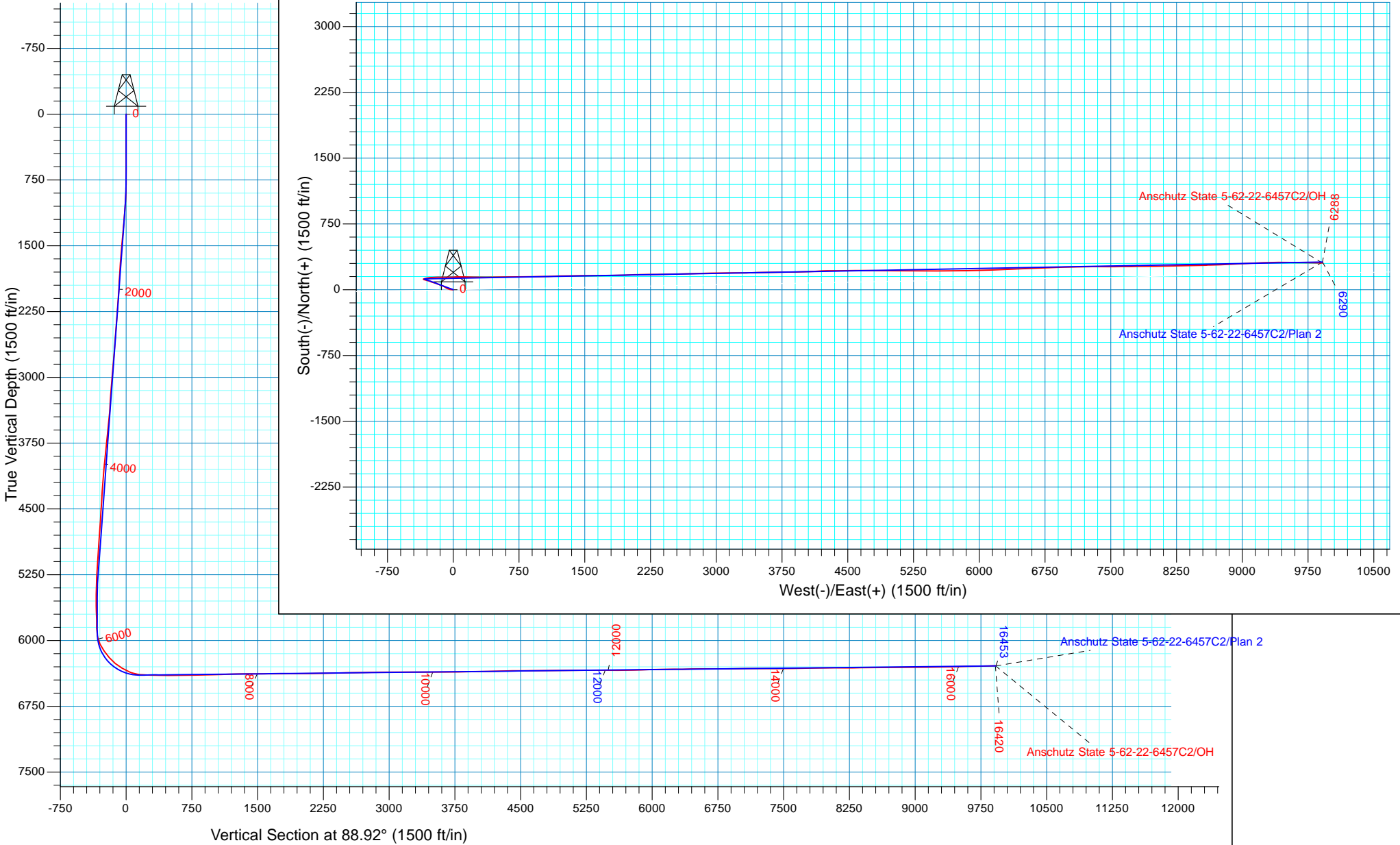



**Bill Barrett Corporation**

## **Bill Barrett Corp.**

Weld County, CO NAD 83

Anschutz State 5-62-22\_23 SWSW Pad

Anschutz State 5-62-22-6457C2

OH

Design: OH

## **Standard Survey Report**

03 September, 2015



**Scientific Drilling**

[www.scientificdrilling.com](http://www.scientificdrilling.com)



<b>Company:</b>	Bill Barrett Corp.	<b>Local Co-ordinate Reference:</b>	Well Anschutz State 5-62-22-6457C2
<b>Project:</b>	Weld County, CO NAD 83	<b>TVD Reference:</b>	GL 4680' & KB 16' @ 4696.00ft (Cade 25)
<b>Site:</b>	Anschutz State 5-62-22_23 SWSW Pad	<b>MD Reference:</b>	GL 4680' & KB 16' @ 4696.00ft (Cade 25)
<b>Well:</b>	Anschutz State 5-62-22-6457C2	<b>North Reference:</b>	True
<b>Wellbore:</b>	OH	<b>Survey Calculation Method:</b>	Minimum Curvature
<b>Design:</b>	OH	<b>Database:</b>	Casper District

<b>Project</b>	Weld County, CO NAD 83		
<b>Map System:</b>	US State Plane 1983	<b>System Datum:</b>	Mean Sea Level
<b>Geo Datum:</b>	North American Datum 1983		
<b>Map Zone:</b>	Colorado Northern Zone		

<b>Site</b>	Anschutz State 5-62-22_23 SWSW Pad		
<b>Site Position:</b>		<b>Northing:</b>	1,383,248.26 usft
<b>From:</b>	Lat/Long	<b>Easting:</b>	3,329,198.17 usft
<b>Position Uncertainty:</b>	0.00 ft	<b>Slot Radius:</b>	13.200 in
		<b>Latitude:</b>	40° 22' 45.829 N
		<b>Longitude:</b>	104° 19' 5.981 W
		<b>Grid Convergence:</b>	0.76 °

<b>Well</b>	Anschutz State 5-62-22-6457C2, 530' FSL 350' FWL Sec 22 T5N R62W		
<b>Well Position</b>	<b>+N/-S</b>	0.00 ft	<b>Latitude:</b> 40° 22' 46.131 N
	<b>+E/-W</b>	0.00 ft	<b>Longitude:</b> 104° 19' 5.970 W
<b>Position Uncertainty</b>	0.00 ft	<b>Wellhead Elevation:</b>	0.00 ft
		<b>Ground Level:</b>	4,680.00 ft

<b>Wellbore</b>	OH				
<b>Magnetics</b>	<b>Model Name</b>	<b>Sample Date</b>	<b>Declination (°)</b>	<b>Dip Angle (°)</b>	<b>Field Strength (nT)</b>
	BGGM2014	8/29/2015	8.18	66.95	52,590

<b>Design</b>	OH				
<b>Audit Notes:</b>					
<b>Version:</b>	1.0	<b>Phase:</b>	ACTUAL	<b>Tie On Depth:</b>	0.00
<b>Vertical Section:</b>	<b>Depth From (TVD) (ft)</b>	<b>+N/-S (ft)</b>	<b>+E/-W (ft)</b>	<b>Direction (°)</b>	
	0.00	0.00	0.00	88.92	

<b>Survey Program</b>	<b>Date</b>	9/3/2015			
<b>From (ft)</b>	<b>To (ft)</b>	<b>Survey (Wellbore)</b>	<b>Tool Name</b>	<b>Description</b>	
800.00	6,627.00	Survey #1 - Vertical / Curve (OH)	SDI MWD	SDI MWD - Standard ver 1.0.1	
6,732.00	16,420.00	Survey #2 - Lateral (OH)	SDI MWD	SDI MWD - Standard ver 1.0.1	

<b>Survey</b>										
<b>Measured Depth (ft)</b>	<b>Inclination (°)</b>	<b>Azimuth (°)</b>	<b>Vertical Depth (ft)</b>	<b>+N/-S (ft)</b>	<b>+E/-W (ft)</b>	<b>Vertical Section (ft)</b>	<b>Dogleg Rate (°/100ft)</b>	<b>Build Rate (°/100ft)</b>	<b>Turn Rate (°/100ft)</b>	
0.00	0.00	0.00	0.00	0.00	0.00	0.00	0.00	0.00	0.00	
800.00	0.00	0.00	800.00	0.00	0.00	0.00	0.00	0.00	0.00	
<b>Casing Assumed Vertical</b>										
889.00	1.47	260.74	888.99	-0.18	-1.13	-1.13	1.65	1.65	0.00	
<b>First SDI MWD Survey</b>										
982.00	3.09	274.60	981.91	-0.17	-4.80	-4.81	1.83	1.74	14.90	
1,074.00	4.67	270.94	1,073.70	0.09	-11.02	-11.02	1.74	1.72	-3.98	
1,167.00	5.06	274.52	1,166.37	0.47	-18.89	-18.88	0.53	0.42	3.85	
1,260.00	5.04	273.81	1,259.00	1.07	-27.06	-27.03	0.07	-0.02	-0.76	

<b>Company:</b>	Bill Barrett Corp.	<b>Local Co-ordinate Reference:</b>	Well Anschutz State 5-62-22-6457C2
<b>Project:</b>	Weld County, CO NAD 83	<b>TVD Reference:</b>	GL 4680' & KB 16' @ 4696.00ft (Cade 25)
<b>Site:</b>	Anschutz State 5-62-22_23 SWSW Pad	<b>MD Reference:</b>	GL 4680' & KB 16' @ 4696.00ft (Cade 25)
<b>Well:</b>	Anschutz State 5-62-22-6457C2	<b>North Reference:</b>	True
<b>Wellbore:</b>	OH	<b>Survey Calculation Method:</b>	Minimum Curvature
<b>Design:</b>	OH	<b>Database:</b>	Casper District

Survey									
Measured Depth (ft)	Inclination (°)	Azimuth (°)	Vertical Depth (ft)	+N/-S (ft)	+E/-W (ft)	Vertical Section (ft)	Dogleg Rate (°/100ft)	Build Rate (°/100ft)	Turn Rate (°/100ft)
Last SDI MWD Surface Survey									
1,352.00	5.32	278.47	1,350.63	1.96	-35.31	-35.27	0.55	0.30	5.07
1,445.00	5.61	287.65	1,443.21	3.98	-43.91	-43.82	0.99	0.31	9.87
1,537.00	5.16	290.79	1,534.80	6.81	-52.06	-51.92	0.58	-0.49	3.41
1,629.00	4.37	285.42	1,626.48	9.21	-59.30	-59.12	0.99	-0.86	-5.84
1,722.00	4.30	296.32	1,719.22	11.70	-65.85	-65.61	0.89	-0.08	11.72
1,814.00	4.20	304.11	1,810.97	15.11	-71.73	-71.43	0.64	-0.11	8.47
1,907.00	3.81	301.72	1,903.74	18.65	-77.17	-76.81	0.46	-0.42	-2.57
1,999.00	4.25	301.42	1,995.51	22.03	-82.68	-82.25	0.48	0.48	-0.33
2,091.00	4.82	299.42	2,087.22	25.71	-88.96	-88.46	0.64	0.62	-2.17
2,182.00	4.64	300.22	2,177.91	29.44	-95.47	-94.90	0.21	-0.20	0.88
2,274.00	4.04	300.54	2,269.65	32.96	-101.48	-100.84	0.65	-0.65	0.35
2,366.00	4.56	297.60	2,361.39	36.30	-107.51	-106.81	0.61	0.57	-3.20
2,458.00	5.72	290.58	2,453.02	39.61	-115.04	-114.28	1.43	1.26	-7.63
2,551.00	5.09	286.25	2,545.61	42.39	-123.34	-122.52	0.81	-0.68	-4.66
2,643.00	4.18	283.01	2,637.30	44.29	-130.53	-129.67	1.03	-0.99	-3.52
2,736.00	4.21	293.25	2,730.06	46.40	-136.97	-136.07	0.81	0.03	11.01
2,829.00	5.23	298.62	2,822.74	49.78	-143.82	-142.86	1.19	1.10	5.77
2,925.00	5.68	296.28	2,918.31	53.97	-151.92	-150.88	0.52	0.47	-2.44
3,020.00	5.35	291.34	3,012.87	57.67	-160.26	-159.15	0.61	-0.35	-5.20
3,115.00	4.69	288.45	3,107.50	60.51	-168.07	-166.90	0.74	-0.69	-3.04
3,210.00	4.59	292.91	3,202.19	63.22	-175.26	-174.04	0.39	-0.11	4.69
3,305.00	4.48	288.69	3,296.89	65.89	-182.28	-181.00	0.37	-0.12	-4.44
3,400.00	3.87	292.04	3,391.64	68.28	-188.76	-187.44	0.69	-0.64	3.53
3,495.00	5.25	289.73	3,486.34	70.95	-195.83	-194.45	1.47	1.45	-2.43
3,590.00	6.69	286.52	3,580.82	73.99	-205.22	-203.79	1.56	1.52	-3.38
3,684.00	6.93	286.19	3,674.16	77.13	-215.92	-214.43	0.26	0.26	-0.35
3,780.00	6.33	282.27	3,769.52	79.87	-226.65	-225.11	0.78	-0.63	-4.08
3,875.00	6.52	289.82	3,863.92	82.81	-236.84	-235.24	0.91	0.20	7.95
3,970.00	6.04	292.00	3,958.35	86.51	-246.55	-244.88	0.56	-0.51	2.29
4,066.00	5.06	297.05	4,053.90	90.33	-255.00	-253.26	1.14	-1.02	5.26
4,161.00	4.32	295.87	4,148.58	93.79	-261.96	-260.14	0.79	-0.78	-1.24
4,256.00	4.35	289.67	4,243.31	96.57	-268.57	-266.70	0.49	0.03	-6.53
4,352.00	3.73	290.91	4,339.07	98.91	-274.91	-273.00	0.65	-0.65	1.29
4,447.00	3.78	285.38	4,433.87	100.84	-280.82	-278.87	0.38	0.05	-5.82
4,543.00	3.83	277.78	4,529.66	102.11	-287.05	-285.07	0.53	0.05	-7.92
4,637.00	4.02	283.02	4,623.44	103.28	-293.37	-291.37	0.43	0.20	5.57
4,732.00	3.59	282.59	4,718.23	104.68	-299.51	-297.49	0.45	-0.45	-0.45
4,827.00	4.29	285.07	4,813.00	106.25	-305.85	-303.79	0.76	0.74	2.61
4,923.00	4.63	287.22	4,908.71	108.33	-313.02	-310.92	0.39	0.35	2.24
5,018.00	4.54	288.71	5,003.41	110.67	-320.24	-318.10	0.16	-0.09	1.57
5,114.00	3.24	285.54	5,099.18	112.62	-326.45	-324.27	1.37	-1.35	-3.30
5,210.00	3.89	290.23	5,195.00	114.47	-332.12	-329.91	0.74	0.68	4.89
5,306.00	2.71	302.56	5,290.84	116.82	-337.09	-334.83	1.43	-1.23	12.84

<b>Company:</b>	Bill Barrett Corp.	<b>Local Co-ordinate Reference:</b>	Well Anschutz State 5-62-22-6457C2
<b>Project:</b>	Weld County, CO NAD 83	<b>TVD Reference:</b>	GL 4680' & KB 16' @ 4696.00ft (Cade 25)
<b>Site:</b>	Anschutz State 5-62-22_23 SWSW Pad	<b>MD Reference:</b>	GL 4680' & KB 16' @ 4696.00ft (Cade 25)
<b>Well:</b>	Anschutz State 5-62-22-6457C2	<b>North Reference:</b>	True
<b>Wellbore:</b>	OH	<b>Survey Calculation Method:</b>	Minimum Curvature
<b>Design:</b>	OH	<b>Database:</b>	Casper District

Survey									
Measured Depth (ft)	Inclination (°)	Azimuth (°)	Vertical Depth (ft)	+N/-S (ft)	+E/-W (ft)	Vertical Section (ft)	Dogleg Rate (°/100ft)	Build Rate (°/100ft)	Turn Rate (°/100ft)
5,401.00	1.75	314.26	5,385.76	119.04	-340.02	-337.72	1.11	-1.01	12.32
5,497.00	0.91	330.44	5,481.74	120.73	-341.45	-339.11	0.95	-0.88	16.85
5,592.00	0.53	92.03	5,576.73	121.37	-341.38	-339.03	1.34	-0.40	127.99
5,686.00	1.19	90.01	5,670.72	121.35	-339.97	-337.62	0.70	0.70	-2.15
5,781.00	0.94	87.76	5,765.71	121.38	-338.21	-335.86	0.27	-0.26	-2.37
5,875.00	0.42	23.17	5,859.70	121.73	-337.30	-334.95	0.90	-0.55	-68.71
5,967.00	10.17	73.86	5,951.21	124.30	-329.34	-326.94	10.77	10.60	55.10
6,062.00	26.33	76.46	6,041.13	131.62	-300.61	-298.08	17.03	17.01	2.74
6,157.00	36.73	85.69	6,122.04	138.71	-251.64	-248.98	12.04	10.95	9.72
6,251.00	40.04	89.43	6,195.72	141.12	-193.36	-190.66	4.30	3.52	3.98
6,347.00	50.86	88.80	6,262.97	142.21	-125.05	-122.35	11.28	11.27	-0.66
6,442.00	58.77	88.62	6,317.67	143.97	-47.49	-44.77	8.33	8.33	-0.19
6,539.00	69.04	89.26	6,360.28	145.55	39.49	42.23	10.60	10.59	0.66
6,627.00	79.79	90.78	6,383.89	145.49	124.13	126.85	12.33	12.22	1.73
6,732.00	89.09	90.73	6,394.05	144.12	228.51	231.19	8.86	8.86	-0.05
First SDI MWD Lateral Survey									
6,828.00	88.86	90.79	6,395.76	142.85	324.49	327.12	0.25	-0.24	0.06
6,922.00	89.33	89.95	6,397.25	142.24	418.47	421.08	1.02	0.50	-0.89
7,018.00	89.36	89.16	6,398.35	142.98	514.46	517.06	0.82	0.03	-0.82
7,113.00	90.87	89.30	6,398.16	144.26	609.45	612.06	1.60	1.59	0.15
7,208.00	90.44	89.18	6,397.07	145.52	704.43	707.05	0.47	-0.45	-0.13
7,303.00	92.12	89.34	6,394.95	146.75	799.40	802.02	1.78	1.77	0.17
7,397.00	90.81	88.85	6,392.55	148.23	893.35	895.99	1.49	-1.39	-0.52
7,492.00	91.88	89.09	6,390.32	149.94	988.31	990.96	1.15	1.13	0.25
7,588.00	91.91	88.88	6,387.14	151.64	1,084.24	1,086.91	0.22	0.03	-0.22
7,684.00	92.09	88.80	6,383.79	153.58	1,180.17	1,182.85	0.21	0.19	-0.08
7,779.00	91.18	88.25	6,381.08	156.03	1,275.09	1,277.81	1.12	-0.96	-0.58
7,874.00	90.03	88.87	6,380.08	158.41	1,370.06	1,372.80	1.38	-1.21	0.65
7,969.00	90.77	90.08	6,379.41	159.28	1,465.05	1,467.79	1.49	0.78	1.27
8,065.00	89.30	89.00	6,379.35	160.05	1,561.04	1,563.78	1.90	-1.53	-1.13
8,160.00	89.66	89.03	6,380.22	161.69	1,656.02	1,658.78	0.38	0.38	0.03
8,256.00	91.01	91.05	6,379.66	161.62	1,752.01	1,754.75	2.53	1.41	2.10
8,350.00	90.64	89.91	6,378.30	160.83	1,846.00	1,848.70	1.27	-0.39	-1.21
8,447.00	89.46	87.42	6,378.22	163.09	1,942.96	1,945.69	2.84	-1.22	-2.57
8,542.00	89.43	86.56	6,379.14	168.08	2,037.83	2,040.63	0.91	-0.03	-0.91
8,637.00	91.08	88.71	6,378.72	172.00	2,132.74	2,135.60	2.85	1.74	2.26
8,732.00	91.65	89.61	6,376.45	173.39	2,227.70	2,230.57	1.12	0.60	0.95
8,828.00	92.99	89.84	6,372.57	173.85	2,323.62	2,326.48	1.42	1.40	0.24
8,922.00	91.65	88.41	6,368.76	175.29	2,417.52	2,420.40	2.08	-1.43	-1.52
9,016.00	90.10	89.00	6,367.33	177.41	2,511.49	2,514.38	1.76	-1.65	0.63
9,111.00	90.54	88.78	6,366.79	179.25	2,606.47	2,609.38	0.52	0.46	-0.23
9,207.00	91.14	88.18	6,365.39	181.80	2,702.42	2,705.37	0.88	0.63	-0.63
9,301.00	90.74	89.08	6,363.85	184.05	2,796.38	2,799.35	1.05	-0.43	0.96

<b>Company:</b>	Bill Barrett Corp.	<b>Local Co-ordinate Reference:</b>	Well Anschutz State 5-62-22-6457C2
<b>Project:</b>	Weld County, CO NAD 83	<b>TVD Reference:</b>	GL 4680' & KB 16' @ 4696.00ft (Cade 25)
<b>Site:</b>	Anschutz State 5-62-22_23 SWSW Pad	<b>MD Reference:</b>	GL 4680' & KB 16' @ 4696.00ft (Cade 25)
<b>Well:</b>	Anschutz State 5-62-22-6457C2	<b>North Reference:</b>	True
<b>Wellbore:</b>	OH	<b>Survey Calculation Method:</b>	Minimum Curvature
<b>Design:</b>	OH	<b>Database:</b>	Casper District

Survey										
Measured Depth (ft)	Inclination (°)	Azimuth (°)	Vertical Depth (ft)	+N/-S (ft)	+E/-W (ft)	Vertical Section (ft)	Dogleg Rate (°/100ft)	Build Rate (°/100ft)	Turn Rate (°/100ft)	
9,396.00	90.60	88.79	6,362.73	185.81	2,891.36	2,894.35	0.34	-0.15	-0.31	
9,493.00	91.38	88.11	6,361.06	188.43	2,988.31	2,991.33	1.07	0.80	-0.70	
9,588.00	89.50	89.56	6,360.33	190.37	3,083.28	3,086.32	2.50	-1.98	1.53	
9,683.00	89.66	89.82	6,361.03	190.88	3,178.27	3,181.31	0.32	0.17	0.27	
9,779.00	91.08	90.93	6,360.41	190.25	3,274.26	3,277.27	1.88	1.48	1.16	
9,874.00	89.63	88.29	6,359.82	190.90	3,369.25	3,372.25	3.17	-1.53	-2.78	
9,970.00	89.83	87.12	6,360.27	194.74	3,465.17	3,468.22	1.24	0.21	-1.22	
10,066.00	90.44	90.08	6,360.04	197.09	3,561.13	3,564.21	3.15	0.64	3.08	
10,160.00	90.34	90.05	6,359.40	196.98	3,655.13	3,658.19	0.11	-0.11	-0.03	
10,256.00	90.34	88.21	6,358.83	198.44	3,751.11	3,754.18	1.92	0.00	-1.92	
10,351.00	90.87	89.27	6,357.83	200.53	3,846.08	3,849.18	1.25	0.56	1.12	
10,446.00	90.87	88.55	6,356.39	202.33	3,941.05	3,944.17	0.76	0.00	-0.76	
10,537.00	91.28	87.18	6,354.68	205.72	4,031.97	4,035.13	1.57	0.45	-1.51	
10,629.00	91.38	87.43	6,352.54	210.05	4,123.84	4,127.07	0.29	0.11	0.27	
10,722.00	91.04	88.11	6,350.58	213.67	4,216.75	4,220.03	0.82	-0.37	0.73	
10,815.00	91.98	89.70	6,348.13	215.44	4,309.70	4,312.99	1.99	1.01	1.71	
10,907.00	90.75	89.74	6,345.94	215.89	4,401.67	4,404.96	1.34	-1.34	0.04	
10,999.00	90.75	88.78	6,344.73	217.08	4,493.65	4,496.95	1.04	0.00	-1.04	
11,092.00	89.87	89.57	6,344.23	218.42	4,586.64	4,589.94	1.27	-0.95	0.85	
11,186.00	90.22	90.18	6,344.16	218.62	4,680.64	4,683.93	0.75	0.37	0.65	
11,279.00	91.10	89.92	6,343.09	218.54	4,773.63	4,776.90	0.99	0.95	-0.28	
11,371.00	89.78	90.80	6,342.38	217.97	4,865.62	4,868.87	1.72	-1.43	0.96	
11,464.00	90.22	90.89	6,342.38	216.59	4,958.61	4,961.82	0.48	0.47	0.10	
11,557.00	91.01	91.24	6,341.38	214.87	5,051.59	5,054.74	0.93	0.85	0.38	
11,649.00	89.78	90.62	6,340.75	213.37	5,143.58	5,146.68	1.50	-1.34	-0.67	
11,742.00	90.31	90.01	6,340.67	212.86	5,236.57	5,239.65	0.87	0.57	-0.66	
11,834.00	91.10	90.53	6,339.54	212.43	5,328.56	5,331.62	1.03	0.86	0.57	
11,926.00	89.52	89.83	6,339.04	212.14	5,420.56	5,423.59	1.88	-1.72	-0.76	
12,019.00	89.60	89.04	6,339.76	213.06	5,513.55	5,516.59	0.85	0.09	-0.85	
12,111.00	89.78	89.48	6,340.26	214.24	5,605.54	5,608.58	0.52	0.20	0.48	
12,204.00	90.84	89.30	6,339.75	215.23	5,698.53	5,701.58	1.16	1.14	-0.19	
12,296.00	92.07	89.22	6,337.42	216.42	5,790.49	5,793.55	1.34	1.34	-0.09	
12,388.00	91.19	89.48	6,334.80	217.46	5,882.45	5,885.50	1.00	-0.96	0.28	
12,479.00	92.15	89.04	6,332.15	218.64	5,973.40	5,976.46	1.16	1.05	-0.48	
12,571.00	90.57	87.90	6,329.96	221.10	6,065.34	6,068.43	2.12	-1.72	-1.24	
12,663.00	91.45	87.63	6,328.34	224.68	6,157.25	6,160.40	1.00	0.96	-0.29	
12,755.00	88.99	87.81	6,327.99	228.34	6,249.17	6,252.37	2.68	-2.67	0.20	
12,848.00	90.57	87.72	6,328.35	231.97	6,342.10	6,345.35	1.70	1.70	-0.10	
12,940.00	92.15	87.81	6,326.16	235.56	6,434.00	6,437.30	1.72	1.72	0.10	
13,033.00	89.66	87.40	6,324.69	239.44	6,526.90	6,530.25	2.71	-2.68	-0.44	
13,126.00	90.92	87.37	6,324.22	243.68	6,619.80	6,623.22	1.36	1.35	-0.03	
13,220.00	89.25	87.72	6,324.08	247.71	6,713.71	6,717.19	1.82	-1.78	0.37	
13,313.00	90.66	88.07	6,324.16	251.13	6,806.65	6,810.17	1.56	1.52	0.38	

<b>Company:</b>	Bill Barrett Corp.	<b>Local Co-ordinate Reference:</b>	Well Anschutz State 5-62-22-6457C2
<b>Project:</b>	Weld County, CO NAD 83	<b>TVD Reference:</b>	GL 4680' & KB 16' @ 4696.00ft (Cade 25)
<b>Site:</b>	Anschutz State 5-62-22_23 SWSW Pad	<b>MD Reference:</b>	GL 4680' & KB 16' @ 4696.00ft (Cade 25)
<b>Well:</b>	Anschutz State 5-62-22-6457C2	<b>North Reference:</b>	True
<b>Wellbore:</b>	OH	<b>Survey Calculation Method:</b>	Minimum Curvature
<b>Design:</b>	OH	<b>Database:</b>	Casper District

Survey									
Measured Depth (ft)	Inclination (°)	Azimuth (°)	Vertical Depth (ft)	+N/-S (ft)	+E/-W (ft)	Vertical Section (ft)	Dogleg Rate (°/100ft)	Build Rate (°/100ft)	Turn Rate (°/100ft)
13,405.00	91.45	87.37	6,322.46	254.79	6,898.56	6,902.13	1.15	0.86	-0.76
13,497.00	90.04	88.86	6,321.27	257.81	6,990.49	6,994.11	2.23	-1.53	1.62
13,590.00	90.92	89.48	6,320.49	259.16	7,083.48	7,087.11	1.16	0.95	0.67
13,683.00	89.43	89.74	6,320.20	259.79	7,176.47	7,180.10	1.63	-1.60	0.28
13,775.00	90.84	90.11	6,319.99	259.91	7,268.47	7,272.08	1.58	1.53	0.40
13,868.00	88.81	89.30	6,320.27	260.39	7,361.46	7,365.06	2.35	-2.18	-0.87
13,960.00	90.04	89.57	6,321.19	261.30	7,453.45	7,457.05	1.37	1.34	0.29
14,053.00	90.75	89.48	6,320.55	262.07	7,546.45	7,550.05	0.77	0.76	-0.10
14,146.00	91.54	89.48	6,318.69	262.91	7,639.42	7,643.02	0.85	0.85	0.00
14,238.00	90.92	89.57	6,316.72	263.68	7,731.40	7,734.99	0.68	-0.67	0.10
14,330.00	91.80	88.95	6,314.54	264.86	7,823.36	7,826.97	1.17	0.96	-0.67
14,423.00	90.57	89.04	6,312.61	266.49	7,916.33	7,919.94	1.33	-1.32	0.10
14,516.00	89.96	89.04	6,312.18	268.05	8,009.31	8,012.94	0.66	-0.66	0.00
14,608.00	89.16	89.13	6,312.89	269.52	8,101.30	8,104.94	0.88	-0.87	0.10
14,700.00	91.01	90.89	6,312.75	269.50	8,193.29	8,196.91	2.78	2.01	1.91
14,793.00	89.87	86.58	6,312.04	271.56	8,286.24	8,289.89	4.79	-1.23	-4.63
14,886.00	91.71	88.51	6,310.76	275.54	8,379.14	8,382.84	2.87	1.98	2.08
14,979.00	90.84	88.95	6,308.69	277.60	8,472.09	8,475.82	1.05	-0.94	0.47
15,071.00	91.63	89.57	6,306.70	278.79	8,564.06	8,567.79	1.09	0.86	0.67
15,163.00	88.99	88.07	6,306.21	280.68	8,656.03	8,659.78	3.30	-2.87	-1.63
15,256.00	89.08	87.55	6,307.77	284.24	8,748.95	8,752.75	0.57	0.10	-0.56
15,350.00	89.96	87.55	6,308.56	288.26	8,842.86	8,846.72	0.94	0.94	0.00
15,443.00	90.22	87.02	6,308.41	292.66	8,935.75	8,939.68	0.63	0.28	-0.57
15,536.00	91.01	87.46	6,307.42	297.14	9,028.64	9,032.64	0.97	0.85	0.47
15,628.00	91.19	85.96	6,305.65	302.42	9,120.47	9,124.55	1.64	0.20	-1.63
15,721.00	91.01	88.25	6,303.86	307.11	9,213.33	9,217.48	2.47	-0.19	2.46
15,816.00	92.42	88.95	6,301.02	309.43	9,308.25	9,312.43	1.66	1.48	0.74
15,912.00	89.87	90.09	6,299.10	310.24	9,404.22	9,408.40	2.91	-2.66	1.19
16,007.00	91.01	90.62	6,298.37	309.65	9,499.21	9,503.36	1.32	1.20	0.56
16,103.00	91.10	90.09	6,296.61	309.05	9,595.19	9,599.32	0.56	0.09	-0.55
16,199.00	92.33	90.80	6,293.73	308.31	9,691.15	9,695.24	1.48	1.28	0.74
16,294.00	90.92	90.71	6,291.04	307.06	9,786.10	9,790.15	1.49	-1.48	-0.09
16,360.00	91.36	91.32	6,289.73	305.89	9,852.07	9,856.09	1.14	0.67	0.92
Last SDI MWD Survey									
16,420.00	91.36	91.32	6,288.30	304.51	9,912.04	9,916.02	0.00	0.00	0.00
Projection to TD									

Casing Points					
Measured Depth (ft)	Vertical Depth (ft)	Name	Casing Diameter (in)	Hole Diameter (in)	
13,683.00	6,320.20	Case15	7.000	7.000	

<b>Company:</b>	Bill Barrett Corp.	<b>Local Co-ordinate Reference:</b>	Well Anschutz State 5-62-22-6457C2
<b>Project:</b>	Weld County, CO NAD 83	<b>TVD Reference:</b>	GL 4680' & KB 16' @ 4696.00ft (Cade 25)
<b>Site:</b>	Anschutz State 5-62-22_23 SWSW Pad	<b>MD Reference:</b>	GL 4680' & KB 16' @ 4696.00ft (Cade 25)
<b>Well:</b>	Anschutz State 5-62-22-6457C2	<b>North Reference:</b>	True
<b>Wellbore:</b>	OH	<b>Survey Calculation Method:</b>	Minimum Curvature
<b>Design:</b>	OH	<b>Database:</b>	Casper District

Design Annotations				
Measured Depth (ft)	Vertical Depth (ft)	Local Coordinates		Comment
		+N/-S (ft)	+E/-W (ft)	
800.00	800.00	0.00	0.00	Casing Assumed Vertical
889.00	888.99	-0.18	-1.13	First SDI MWD Survey
1,260.00	1,259.00	1.07	-27.06	Last SDI MWD Surface Survey
6,732.00	6,394.05	144.12	228.51	First SDI MWD Lateral Survey
16,360.00	6,289.73	305.89	9,852.07	Last SDI MWD Survey
16,420.00	6,288.30	304.51	9,912.04	Projection to TD

Checked By: _____	Approved By: _____	Date: _____
-------------------	--------------------	-------------