

WELL DETAILS: Anschutz State 05-62-22-4956C2			
GL 4690' & KB 16' @ 4706.00ft (Cade 24)	4690.00		
Northing	Easting	Latitude	Longitude
1384806.58	3329099.95	40° 23' 1.240 N	104° 19' 6.982 W

PROJECT DETAILS: Weld County, CO NAD 83
Geodetic System: US State Plane 1983
Datum: North American Datum 1983
Ellipsoid: GRS 1980
Zone: Colorado Northern Zone
System Datum: Mean Sea Level
Local North: True

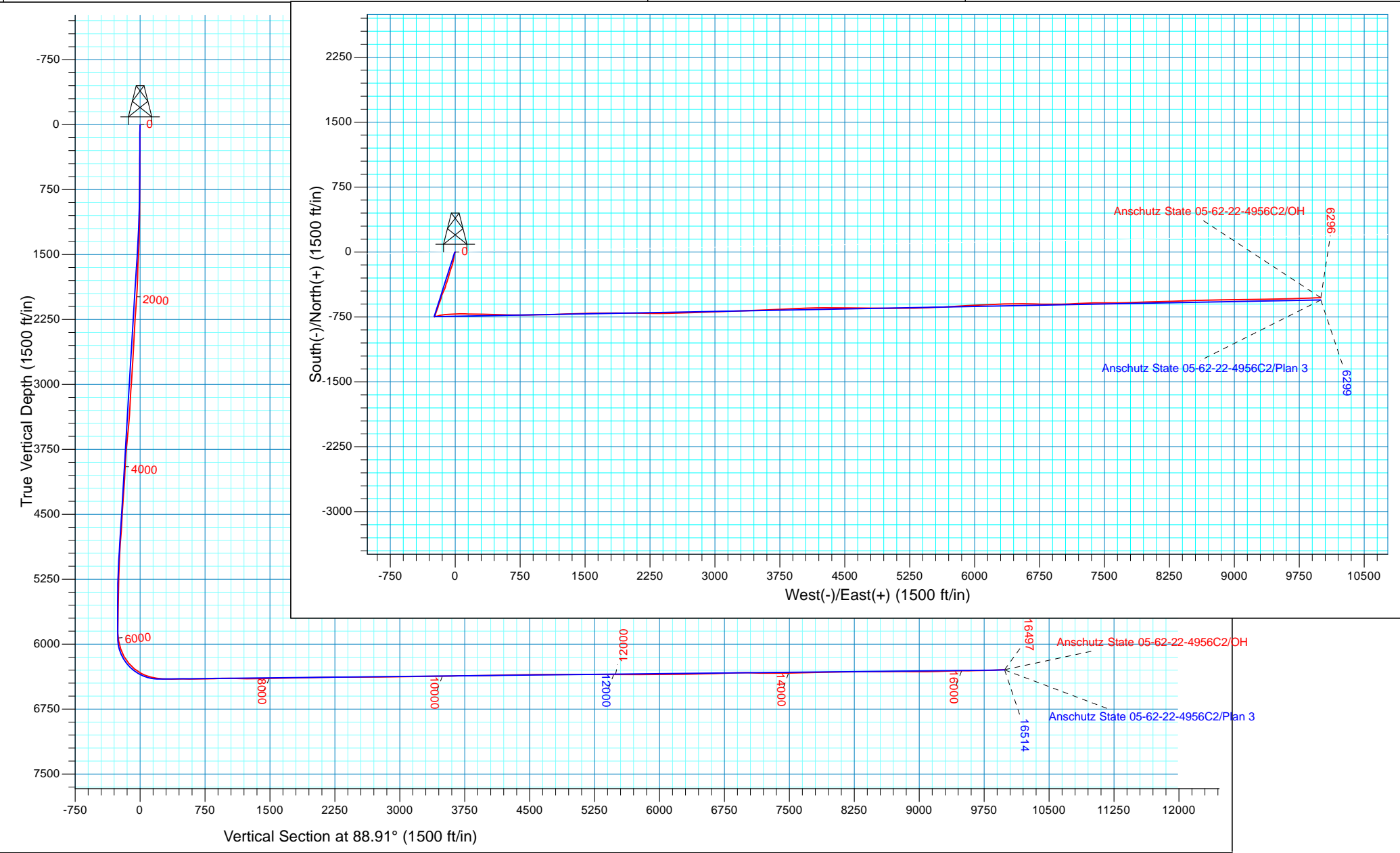



Bill Barrett Corporation

Bill Barrett Corp.

Weld County, CO NAD 83

Anschutz State 5-62-22 NWSW Pad

Anschutz State 05-62-22-4956C2

OH

Design: OH

Standard Survey Report

18 September, 2015



Scientific Drilling

www.scientificdrilling.com



Company:	Bill Barrett Corp.	Local Co-ordinate Reference:	Well Anschutz State 05-62-22-4956C2
Project:	Weld County, CO NAD 83	TVD Reference:	GL 4690' & KB 16' @ 4706.00ft (Cade 24)
Site:	Anschutz State 5-62-22 NWSW Pad	MD Reference:	GL 4690' & KB 16' @ 4706.00ft (Cade 24)
Well:	Anschutz State 05-62-22-4956C2	North Reference:	True
Wellbore:	OH	Survey Calculation Method:	Minimum Curvature
Design:	OH	Database:	Casper District

Project	Weld County, CO NAD 83		
Map System:	US State Plane 1983	System Datum:	Mean Sea Level
Geo Datum:	North American Datum 1983		
Map Zone:	Colorado Northern Zone		

Site		Anschutz State 5-62-22 NWSW Pad					
Site Position:		Northing:	1,384,806.64	usft	Latitude:	40° 23' 1.241 N	
From:	Lat/Long	Easting:	3,329,099.95	usft	Longitude:	104° 19' 6.982 W	
Position Uncertainty:	0.00	ft	Slot Radius:	13.200	in	Grid Convergence:	0.76 °

Well	Anschutz State 05-62-22-4956C2, 2060' FSL 250' FWL Sec 22 T5N R62W					
Well Position	+N/-S	0.00 ft	Northing:	1,384,806.58 usft	Latitude:	40° 23' 1.240 N
	+E/-W	0.00 ft	Easting:	3,329,099.95 usft	Longitude:	104° 19' 6.982 W
Position Uncertainty		0.00 ft	Wellhead Elevation:	0.00 ft	Ground Level:	4,690.00 ft

Wellbore	OH				
Magnetics	Model Name	Sample Date	Declination (°)	Dip Angle (°)	Field Strength (nT)
	BGGM2014	9/15/2015	8.18	66.95	52,586

Design	OH				
Audit Notes:					
Version:	1.0	Phase:	ACTUAL	Tie On Depth:	0.00
Vertical Section:	Depth From (TVD) (ft)	+N/-S (ft)	+E/-W (ft)	Direction (°)	
	0.00	0.00	0.00	88.91	

Survey Program	Date	9/18/2015			
From (ft)	To (ft)	Survey (Wellbore)	Tool Name	Description	
100.00	696.00	Survey #1 - Surface Gyro (OH)	NS-GYRO-MS	North sensing gyrocompassing m/s	
821.00	6,700.00	Survey #2 - Vertical / Curve (OH)	SDI MWD	SDI MWD - Standard ver 1.0.1	
6,795.00	16,497.00	Survey #3 - Lateral (OH)	SDI MWD	SDI MWD - Standard ver 1.0.1	

Survey										
Measured Depth (ft)	Inclination (°)	Azimuth (°)	Vertical Depth (ft)	+N/-S (ft)	+E/-W (ft)	Vertical Section (ft)	Dogleg Rate (°/100ft)	Build Rate (°/100ft)	Turn Rate (°/100ft)	
696.00	0.44	250.43	695.98	-2.35	-3.83	-3.88	0.12	0.03	-15.09	
Last Gyro Survey										
821.00	0.50	276.53	820.98	-2.45	-4.83	-4.87	0.18	0.05	20.88	
First SDI MWD Survey										
907.00	1.28	183.95	906.97	-3.37	-5.27	-5.33	1.62	0.91	-107.65	
993.00	2.93	173.40	992.91	-6.51	-5.08	-5.20	1.96	1.92	-12.27	
1,077.00	3.96	180.45	1,076.76	-11.54	-4.85	-5.07	1.32	1.23	8.39	
1,169.00	6.16	190.13	1,168.39	-19.58	-5.75	-6.12	2.56	2.39	10.52	

Company:	Bill Barrett Corp.	Local Co-ordinate Reference:	Well Anschutz State 05-62-22-4956C2
Project:	Weld County, CO NAD 83	TVD Reference:	GL 4690' & KB 16' @ 4706.00ft (Cade 24)
Site:	Anschutz State 5-62-22 NWSW Pad	MD Reference:	GL 4690' & KB 16' @ 4706.00ft (Cade 24)
Well:	Anschutz State 05-62-22-4956C2	North Reference:	True
Wellbore:	OH	Survey Calculation Method:	Minimum Curvature
Design:	OH	Database:	Casper District

Survey									
Measured Depth (ft)	Inclination (°)	Azimuth (°)	Vertical Depth (ft)	+N/-S (ft)	+E/-W (ft)	Vertical Section (ft)	Dogleg Rate (°/100ft)	Build Rate (°/100ft)	Turn Rate (°/100ft)
1,253.00	7.84	194.41	1,251.77	-29.56	-7.97	-8.53	2.09	2.00	5.10
1,341.00	9.44	193.83	1,338.76	-42.39	-11.19	-11.99	1.82	1.82	-0.66
1,433.00	10.32	191.56	1,429.40	-57.79	-14.64	-15.74	1.05	0.96	-2.47
1,524.00	10.73	191.99	1,518.87	-74.06	-18.03	-19.44	0.46	0.45	0.47
1,616.00	9.19	192.09	1,609.48	-89.62	-21.35	-23.05	1.67	-1.67	0.11
1,707.00	10.03	187.70	1,699.20	-104.58	-23.94	-25.92	1.22	0.92	-4.82
1,799.00	10.36	189.85	1,789.75	-120.67	-26.42	-28.71	0.55	0.36	2.34
1,891.00	9.77	193.86	1,880.34	-136.40	-29.71	-32.30	1.00	-0.64	4.36
1,982.00	10.12	198.41	1,969.97	-151.48	-34.08	-36.96	0.94	0.38	5.00
2,074.00	10.92	201.20	2,060.42	-167.27	-39.79	-42.96	1.03	0.87	3.03
2,165.00	11.62	200.40	2,149.67	-183.90	-46.10	-49.59	0.79	0.77	-0.88
2,257.00	10.58	200.03	2,239.95	-200.52	-52.22	-56.03	1.13	-1.13	-0.40
2,348.00	10.58	195.64	2,329.40	-216.41	-57.34	-61.44	0.89	0.00	-4.82
2,443.00	11.22	197.58	2,422.69	-233.62	-62.48	-66.91	0.78	0.67	2.04
2,537.00	10.08	194.15	2,515.07	-250.32	-67.25	-72.00	1.39	-1.21	-3.65
2,632.00	10.61	192.54	2,608.52	-266.92	-71.18	-76.25	0.64	0.56	-1.69
2,726.00	11.31	195.79	2,700.81	-284.23	-75.57	-80.96	0.99	0.74	3.46
2,822.00	11.33	199.71	2,794.94	-302.17	-81.31	-87.05	0.80	0.02	4.08
2,917.00	10.41	197.11	2,888.24	-319.16	-86.99	-93.04	1.10	-0.97	-2.74
3,011.00	10.39	201.10	2,980.69	-335.18	-92.54	-98.89	0.77	-0.02	4.24
3,105.00	10.49	200.52	3,073.14	-351.11	-98.59	-105.25	0.15	0.11	-0.62
3,200.00	10.84	195.67	3,166.50	-367.81	-104.03	-111.01	1.01	0.37	-5.11
3,295.00	11.01	193.46	3,259.78	-385.23	-108.55	-115.86	0.48	0.18	-2.33
3,390.00	11.25	198.82	3,352.99	-402.83	-113.66	-121.30	1.12	0.25	5.64
3,484.00	12.21	202.20	3,445.03	-420.71	-120.37	-128.35	1.26	1.02	3.60
3,578.00	13.46	203.91	3,536.68	-439.91	-128.56	-136.91	1.39	1.33	1.82
3,672.00	12.56	205.15	3,628.26	-459.17	-137.34	-146.05	1.00	-0.96	1.32
3,767.00	12.96	204.31	3,720.92	-478.23	-146.11	-155.18	0.46	0.42	-0.88
3,861.00	10.97	199.68	3,812.87	-496.26	-153.47	-162.88	2.35	-2.12	-4.93
3,956.00	10.45	193.24	3,906.22	-513.15	-158.48	-168.22	1.37	-0.55	-6.78
4,050.00	10.71	195.95	3,998.62	-529.85	-162.84	-172.89	0.60	0.28	2.88
4,145.00	10.58	197.69	4,091.99	-546.65	-167.91	-178.28	0.36	-0.14	1.83
4,240.00	10.43	200.33	4,185.40	-563.02	-173.55	-184.23	0.53	-0.16	2.78
4,335.00	10.80	202.39	4,278.77	-579.31	-179.93	-190.92	0.56	0.39	2.17
4,429.00	10.63	197.76	4,371.14	-595.71	-185.93	-197.23	0.93	-0.18	-4.93
4,524.00	10.17	198.29	4,464.57	-612.02	-191.23	-202.84	0.49	-0.48	0.56
4,619.00	11.25	194.71	4,557.92	-628.95	-196.22	-208.15	1.33	1.14	-3.77
4,713.00	11.29	199.43	4,650.11	-646.49	-201.61	-213.87	0.98	0.04	5.02
4,807.00	10.16	199.99	4,742.47	-662.96	-207.50	-220.08	1.21	-1.20	0.60
4,902.00	11.01	201.73	4,835.85	-679.26	-213.72	-226.61	0.96	0.89	1.83
4,996.00	9.96	200.97	4,928.28	-695.19	-219.96	-233.14	1.13	-1.12	-0.81
5,090.00	8.02	197.01	5,021.12	-709.06	-224.79	-238.23	2.17	-2.06	-4.21
5,185.00	5.91	195.29	5,115.41	-720.11	-228.01	-241.67	2.23	-2.22	-1.81

Company:	Bill Barrett Corp.	Local Co-ordinate Reference:	Well Anschutz State 05-62-22-4956C2
Project:	Weld County, CO NAD 83	TVD Reference:	GL 4690' & KB 16' @ 4706.00ft (Cade 24)
Site:	Anschutz State 5-62-22 NWSW Pad	MD Reference:	GL 4690' & KB 16' @ 4706.00ft (Cade 24)
Well:	Anschutz State 05-62-22-4956C2	North Reference:	True
Wellbore:	OH	Survey Calculation Method:	Minimum Curvature
Design:	OH	Database:	Casper District

Survey										
Measured Depth (ft)	Inclination (°)	Azimuth (°)	Vertical Depth (ft)	+N/-S (ft)	+E/-W (ft)	Vertical Section (ft)	Dogleg Rate (°/100ft)	Build Rate (°/100ft)	Turn Rate (°/100ft)	
5,280.00	5.29	197.94	5,209.96	-729.00	-230.65	-244.48	0.71	-0.65	2.79	
5,376.00	4.28	200.20	5,305.62	-736.57	-233.25	-247.22	1.07	-1.05	2.35	
5,470.00	3.34	195.17	5,399.41	-742.50	-235.18	-249.26	1.06	-1.00	-5.35	
5,565.00	1.61	217.21	5,494.32	-746.24	-236.71	-250.87	2.05	-1.82	23.20	
5,659.00	0.92	259.74	5,588.30	-747.42	-238.25	-252.43	1.19	-0.73	45.24	
5,754.00	0.60	298.92	5,683.29	-747.32	-239.44	-253.61	0.62	-0.34	41.24	
5,849.00	0.59	276.57	5,778.29	-747.02	-240.36	-254.53	0.24	-0.01	-23.53	
5,944.00	0.34	284.59	5,873.29	-746.90	-241.12	-255.28	0.27	-0.26	8.44	
6,037.00	10.52	82.12	5,965.78	-745.66	-232.95	-247.09	11.65	10.95	169.39	
6,132.00	19.45	72.78	6,057.47	-739.78	-209.20	-223.24	9.71	9.40	-9.83	
6,226.00	29.63	77.16	6,142.87	-729.95	-171.50	-185.35	10.99	10.83	4.66	
6,320.00	40.50	85.18	6,219.74	-722.20	-118.24	-131.95	12.54	11.56	8.53	
6,416.00	50.95	86.73	6,286.66	-717.44	-49.77	-63.40	10.95	10.89	1.61	
6,510.00	62.15	87.51	6,338.40	-713.54	28.44	14.86	11.93	11.91	0.83	
6,605.00	72.97	93.11	6,374.63	-714.18	116.07	102.46	12.62	11.39	5.89	
6,700.00	82.29	90.75	6,394.96	-717.27	208.70	195.02	10.11	9.81	-2.48	
Last SDI MWD Curve Survey										
6,795.00	88.56	89.92	6,402.54	-717.82	303.35	289.64	6.66	6.60	-0.87	
First SDI MWD Lateral Survey										
6,889.00	89.56	91.86	6,404.08	-719.28	397.32	383.57	2.32	1.06	2.06	
6,983.00	90.10	92.08	6,404.36	-722.51	491.27	477.43	0.62	0.57	0.23	
7,078.00	90.91	91.07	6,403.52	-725.12	586.22	572.32	1.36	0.85	-1.06	
7,172.00	91.17	90.92	6,401.81	-726.75	680.20	666.25	0.32	0.28	-0.16	
7,266.00	90.27	89.11	6,400.63	-726.78	774.18	760.22	2.15	-0.96	-1.93	
7,361.00	91.68	89.20	6,399.02	-725.37	869.16	855.20	1.49	1.48	0.09	
7,455.00	91.11	89.70	6,396.73	-724.47	963.12	949.17	0.81	-0.61	0.53	
7,550.00	89.19	88.86	6,396.48	-723.28	1,058.11	1,044.16	2.21	-2.02	-0.88	
7,644.00	88.52	88.66	6,398.36	-721.25	1,152.07	1,138.14	0.74	-0.71	-0.21	
7,738.00	90.07	88.17	6,399.51	-718.65	1,246.02	1,232.13	1.73	1.65	-0.52	
7,832.00	90.17	87.80	6,399.32	-715.34	1,339.96	1,326.11	0.41	0.11	-0.39	
7,926.00	91.07	87.51	6,398.30	-711.49	1,433.88	1,420.08	1.01	0.96	-0.31	
8,021.00	91.31	88.21	6,396.33	-707.95	1,528.79	1,515.05	0.78	0.25	0.74	
8,116.00	91.34	87.93	6,394.13	-704.75	1,623.71	1,610.01	0.30	0.03	-0.29	
8,210.00	90.74	90.31	6,392.42	-703.31	1,717.68	1,703.99	2.61	-0.64	2.53	
8,305.00	90.91	89.70	6,391.05	-703.31	1,812.67	1,798.96	0.67	0.18	-0.64	
8,400.00	90.97	90.77	6,389.50	-703.70	1,907.65	1,893.92	1.13	0.06	1.13	
8,495.00	91.54	91.68	6,387.42	-705.73	2,002.61	1,988.82	1.13	0.60	0.96	
8,589.00	91.31	91.15	6,385.08	-708.05	2,096.55	2,082.70	0.61	-0.24	-0.56	
8,684.00	91.11	90.69	6,383.07	-709.58	2,191.52	2,177.62	0.53	-0.21	-0.48	
8,778.00	90.20	89.26	6,382.00	-709.54	2,285.51	2,271.59	1.80	-0.97	-1.52	
8,872.00	91.34	89.44	6,380.73	-708.47	2,379.49	2,365.58	1.23	1.21	0.19	
8,967.00	89.77	88.78	6,379.81	-707.00	2,474.47	2,460.57	1.79	-1.65	-0.69	
9,061.00	90.00	88.22	6,380.00	-704.54	2,568.44	2,554.57	0.64	0.24	-0.60	
9,155.00	89.73	88.74	6,380.22	-702.04	2,662.40	2,648.57	0.62	-0.29	0.55	

Company:	Bill Barrett Corp.	Local Co-ordinate Reference:	Well Anschutz State 05-62-22-4956C2
Project:	Weld County, CO NAD 83	TVD Reference:	GL 4690' & KB 16' @ 4706.00ft (Cade 24)
Site:	Anschutz State 5-62-22 NWSW Pad	MD Reference:	GL 4690' & KB 16' @ 4706.00ft (Cade 24)
Well:	Anschutz State 05-62-22-4956C2	North Reference:	True
Wellbore:	OH	Survey Calculation Method:	Minimum Curvature
Design:	OH	Database:	Casper District

Survey									
Measured Depth (ft)	Inclination (°)	Azimuth (°)	Vertical Depth (ft)	+N/-S (ft)	+E/-W (ft)	Vertical Section (ft)	Dogleg Rate (°/100ft)	Build Rate (°/100ft)	Turn Rate (°/100ft)
9,250.00	89.63	88.01	6,380.75	-699.35	2,757.36	2,743.56	0.78	-0.11	-0.77
9,345.00	89.93	87.55	6,381.12	-695.67	2,852.29	2,838.54	0.58	0.32	-0.48
9,439.00	91.31	87.70	6,380.10	-691.77	2,946.20	2,932.51	1.48	1.47	0.16
9,533.00	91.64	87.14	6,377.68	-687.54	3,040.08	3,026.45	0.69	0.35	-0.60
9,627.00	92.11	88.70	6,374.61	-684.13	3,133.96	3,120.38	1.73	0.50	1.66
9,722.00	90.50	89.05	6,372.44	-682.27	3,228.91	3,215.35	1.73	-1.69	0.37
9,816.00	90.23	87.63	6,371.84	-679.55	3,322.87	3,309.34	1.54	-0.29	-1.51
9,911.00	90.40	87.65	6,371.32	-675.63	3,417.79	3,404.32	0.18	0.18	0.02
10,006.00	90.67	87.43	6,370.44	-671.56	3,512.70	3,499.29	0.37	0.28	-0.23
10,100.00	91.44	87.45	6,368.70	-667.36	3,606.59	3,593.24	0.82	0.82	0.02
10,195.00	90.67	87.67	6,366.96	-663.32	3,701.48	3,688.19	0.84	-0.81	0.23
10,290.00	90.60	87.00	6,365.90	-658.90	3,796.37	3,783.15	0.71	-0.07	-0.71
10,384.00	90.64	87.96	6,364.89	-654.77	3,890.28	3,877.12	1.02	0.04	1.02
10,475.00	90.50	86.93	6,363.98	-650.71	3,981.18	3,968.08	1.14	-0.15	-1.13
10,567.00	91.24	88.32	6,362.58	-646.90	4,073.09	4,060.04	1.71	0.80	1.51
10,659.00	91.91	88.24	6,360.05	-644.14	4,165.01	4,152.00	0.73	0.73	-0.09
10,751.00	91.54	90.62	6,357.28	-643.22	4,256.96	4,243.95	2.62	-0.40	2.59
10,842.00	90.37	90.63	6,355.77	-644.22	4,347.94	4,334.90	1.29	-1.29	0.01
10,934.00	90.50	90.29	6,355.07	-644.95	4,439.93	4,426.86	0.40	0.14	-0.37
11,025.00	90.84	90.49	6,354.01	-645.57	4,530.92	4,517.82	0.43	0.37	0.22
11,117.00	90.47	90.48	6,352.95	-646.35	4,622.91	4,609.78	0.40	-0.40	-0.01
11,208.00	90.47	90.24	6,352.21	-646.92	4,713.91	4,700.75	0.26	0.00	-0.26
11,300.00	90.10	89.93	6,351.75	-647.06	4,805.91	4,792.73	0.52	-0.40	-0.34
11,392.00	90.44	90.63	6,351.32	-647.51	4,897.91	4,884.70	0.85	0.37	0.76
11,483.00	90.54	91.05	6,350.54	-648.84	4,988.89	4,975.65	0.47	0.11	0.46
11,575.00	90.54	90.98	6,349.67	-650.47	5,080.87	5,067.58	0.08	0.00	-0.08
11,667.00	89.23	89.09	6,349.86	-650.53	5,172.87	5,159.56	2.50	-1.42	-2.05
11,759.00	89.63	88.94	6,350.77	-648.95	5,264.85	5,251.55	0.46	0.43	-0.16
11,851.00	89.66	88.27	6,351.34	-646.71	5,356.82	5,343.55	0.73	0.03	-0.73
11,942.00	89.56	87.04	6,351.96	-642.99	5,447.74	5,434.52	1.36	-0.11	-1.35
12,033.00	89.90	87.80	6,352.39	-638.89	5,538.64	5,525.49	0.91	0.37	0.84
12,125.00	91.17	87.57	6,351.53	-635.17	5,630.56	5,617.46	1.40	1.38	-0.25
12,217.00	91.04	87.68	6,349.76	-631.36	5,722.47	5,709.42	0.19	-0.14	0.12
12,308.00	88.99	85.74	6,349.73	-626.14	5,813.31	5,800.35	3.10	-2.25	-2.13
12,400.00	89.97	86.60	6,350.57	-619.99	5,905.10	5,892.23	1.42	1.07	0.93
12,491.00	89.23	86.61	6,351.20	-614.61	5,995.93	5,983.16	0.81	-0.81	0.01
12,583.00	89.80	86.17	6,351.98	-608.81	6,087.75	6,075.07	0.78	0.62	-0.48
12,675.00	90.97	88.14	6,351.36	-604.25	6,179.63	6,167.01	2.49	1.27	2.14
12,766.00	91.31	87.81	6,349.55	-601.03	6,270.55	6,257.98	0.52	0.37	-0.36
12,858.00	90.57	89.12	6,348.04	-598.57	6,362.50	6,349.97	1.64	-0.80	1.42
12,949.00	91.75	90.38	6,346.20	-598.17	6,453.48	6,440.93	1.90	1.30	1.38
13,041.00	91.11	90.26	6,343.90	-598.68	6,545.45	6,532.88	0.71	-0.70	-0.13
13,133.00	92.25	90.73	6,341.21	-599.48	6,637.41	6,624.80	1.34	1.24	0.51

Company:	Bill Barrett Corp.	Local Co-ordinate Reference:	Well Anschutz State 05-62-22-4956C2
Project:	Weld County, CO NAD 83	TVD Reference:	GL 4690' & KB 16' @ 4706.00ft (Cade 24)
Site:	Anschutz State 5-62-22 NWSW Pad	MD Reference:	GL 4690' & KB 16' @ 4706.00ft (Cade 24)
Well:	Anschutz State 05-62-22-4956C2	North Reference:	True
Wellbore:	OH	Survey Calculation Method:	Minimum Curvature
Design:	OH	Database:	Casper District

Survey										
Measured Depth (ft)	Inclination (°)	Azimuth (°)	Vertical Depth (ft)	+N/-S (ft)	+E/-W (ft)	Vertical Section (ft)	Dogleg Rate (°/100ft)	Build Rate (°/100ft)	Turn Rate (°/100ft)	
13,224.00	91.58	91.24	6,338.17	-601.04	6,728.34	6,715.69	0.93	-0.74	0.56	
13,316.00	91.75	90.20	6,335.49	-602.20	6,820.29	6,807.60	1.14	0.18	-1.13	
13,407.00	92.18	90.52	6,332.37	-602.77	6,911.24	6,898.52	0.59	0.47	0.35	
13,499.00	90.07	88.77	6,330.57	-602.20	7,003.21	6,990.49	2.98	-2.29	-1.90	
13,591.00	88.56	87.22	6,331.67	-598.98	7,095.14	7,082.46	2.35	-1.64	-1.68	
13,683.00	88.66	87.47	6,333.90	-594.72	7,187.01	7,174.40	0.29	0.11	0.27	
13,775.00	89.00	87.40	6,335.78	-590.60	7,278.90	7,266.35	0.38	0.37	-0.08	
13,867.00	89.16	88.53	6,337.25	-587.34	7,370.83	7,358.33	1.24	0.17	1.23	
13,958.00	91.75	91.24	6,336.53	-587.15	7,461.81	7,449.29	4.12	2.85	2.98	
14,049.00	91.34	89.64	6,334.08	-587.85	7,552.77	7,540.22	1.81	-0.45	-1.76	
14,140.00	91.17	89.30	6,332.08	-587.01	7,643.75	7,631.20	0.42	-0.19	-0.37	
14,232.00	90.71	88.24	6,330.57	-585.04	7,735.71	7,723.18	1.26	-0.50	-1.15	
14,324.00	91.92	88.32	6,328.46	-582.28	7,827.65	7,815.15	1.32	1.32	0.09	
14,415.00	92.38	87.57	6,325.05	-579.02	7,918.52	7,906.07	0.97	0.51	-0.82	
14,507.00	90.84	88.54	6,322.46	-575.90	8,010.43	7,998.02	1.98	-1.67	1.05	
14,599.00	90.40	88.35	6,321.47	-573.40	8,102.39	8,090.02	0.52	-0.48	-0.21	
14,690.00	90.27	88.44	6,320.94	-570.85	8,193.35	8,181.01	0.17	-0.14	0.10	
14,782.00	91.58	88.01	6,319.45	-568.00	8,285.29	8,272.99	1.50	1.42	-0.47	
14,874.00	90.50	88.93	6,317.78	-565.54	8,377.24	8,364.97	1.54	-1.17	1.00	
14,965.00	89.56	87.25	6,317.73	-562.51	8,468.19	8,455.96	2.12	-1.03	-1.85	
15,057.00	90.13	87.80	6,317.98	-558.54	8,560.10	8,547.93	0.86	0.62	0.60	
15,148.00	89.77	89.04	6,318.06	-556.03	8,651.06	8,638.92	1.42	-0.40	1.36	
15,240.00	90.97	89.47	6,317.47	-554.83	8,743.05	8,730.92	1.39	1.30	0.47	
15,331.00	89.19	87.81	6,317.34	-552.67	8,834.02	8,821.91	2.67	-1.96	-1.82	
15,422.00	90.13	88.51	6,317.88	-549.75	8,924.97	8,912.90	1.29	1.03	0.77	
15,514.00	89.50	89.43	6,318.18	-548.10	9,016.95	9,004.90	1.21	-0.68	1.00	
15,605.00	90.64	90.38	6,318.07	-547.95	9,107.95	9,095.88	1.63	1.25	1.04	
15,699.00	91.61	88.94	6,316.22	-547.39	9,201.93	9,189.85	1.85	1.03	-1.53	
15,792.00	92.69	89.27	6,312.73	-545.94	9,294.85	9,282.78	1.21	1.16	0.35	
15,887.00	90.87	89.26	6,309.78	-544.72	9,389.79	9,377.73	1.92	-1.92	-0.01	
15,981.00	90.67	88.45	6,308.52	-542.84	9,483.76	9,471.72	0.89	-0.21	-0.86	
16,076.00	90.34	88.27	6,307.68	-540.12	9,578.72	9,566.71	0.40	-0.35	-0.19	
16,170.00	90.67	88.51	6,306.85	-537.48	9,672.68	9,660.71	0.43	0.35	0.26	
16,265.00	91.21	88.26	6,305.29	-534.81	9,767.63	9,755.69	0.63	0.57	-0.26	
16,360.00	92.21	88.43	6,302.46	-532.06	9,862.55	9,850.64	1.07	1.05	0.18	
16,439.00	92.99	88.00	6,298.88	-529.61	9,941.43	9,929.55	1.13	0.99	-0.54	
Last SDI MWD Survey										
16,497.00	92.99	88.00	6,295.85	-527.58	9,999.31	9,987.47	0.00	0.00	0.00	
Projection to TD										

Company:	Bill Barrett Corp.	Local Co-ordinate Reference:	Well Anschutz State 05-62-22-4956C2
Project:	Weld County, CO NAD 83	TVD Reference:	GL 4690' & KB 16' @ 4706.00ft (Cade 24)
Site:	Anschutz State 5-62-22 NWSW Pad	MD Reference:	GL 4690' & KB 16' @ 4706.00ft (Cade 24)
Well:	Anschutz State 05-62-22-4956C2	North Reference:	True
Wellbore:	OH	Survey Calculation Method:	Minimum Curvature
Design:	OH	Database:	Casper District

Casing Points					
Measured Depth (ft)	Vertical Depth (ft)	Name		Casing Diameter (in)	Hole Diameter (in)
15,514.00	6,318.18	Case15		7.000	7.000

Design Annotations					
Measured Depth (ft)	Vertical Depth (ft)	Local Coordinates		Comment	
		+N/-S (ft)	+E/-W (ft)		
100.00	100.00	-0.35	-0.14	First Gyro Survey	
696.00	695.98	-2.35	-3.83	Last Gyro Survey	
821.00	820.98	-2.45	-4.83	First SDI MWD Survey	
6,700.00	6,394.96	-717.27	208.70	Last SDI MWD Curve Survey	
6,795.00	6,402.54	-717.82	303.35	First SDI MWD Lateral Survey	
16,439.00	6,298.88	-529.61	9,941.43	Last SDI MWD Survey	
16,497.00	6,295.85	-527.58	9,999.31	Projection to TD	

Checked By: _____	Approved By: _____	Date: _____
-------------------	--------------------	-------------