

Plan: Plan 3 (Anschutz State 05-62-22-4841B2/OH)
Created By: Seth Burstad Date: 7-26-15



Azimuths to True North  
Magnetic North:  $8.19^\circ$

Magnetic Field  
Strength: 52601.7snT  
Dip Angle: 66.95°  
Date: 8/3/2015  
Model: BGGM2014

WELL DETAILS: Anschutz State 05-62-22-4841B2				PROJECT DETAILS: Weld County, CO NAD 83	
GL 4690' & KB 16' @ 4706.00ft (Cade 24)    4690.00 Northing                      Easting                      Latitude                      Longitude 1384821.52                      3329099.75                      40° 23' 1.388 N                      104° 19' 6.982 W				Geodetic System: US State Plane 1983 Datum: North American Datum 1983 Ellipsoid: GRS 1980 Zone: Colorado Northern Zone  System Datum: Mean Sea Level Local North: True	

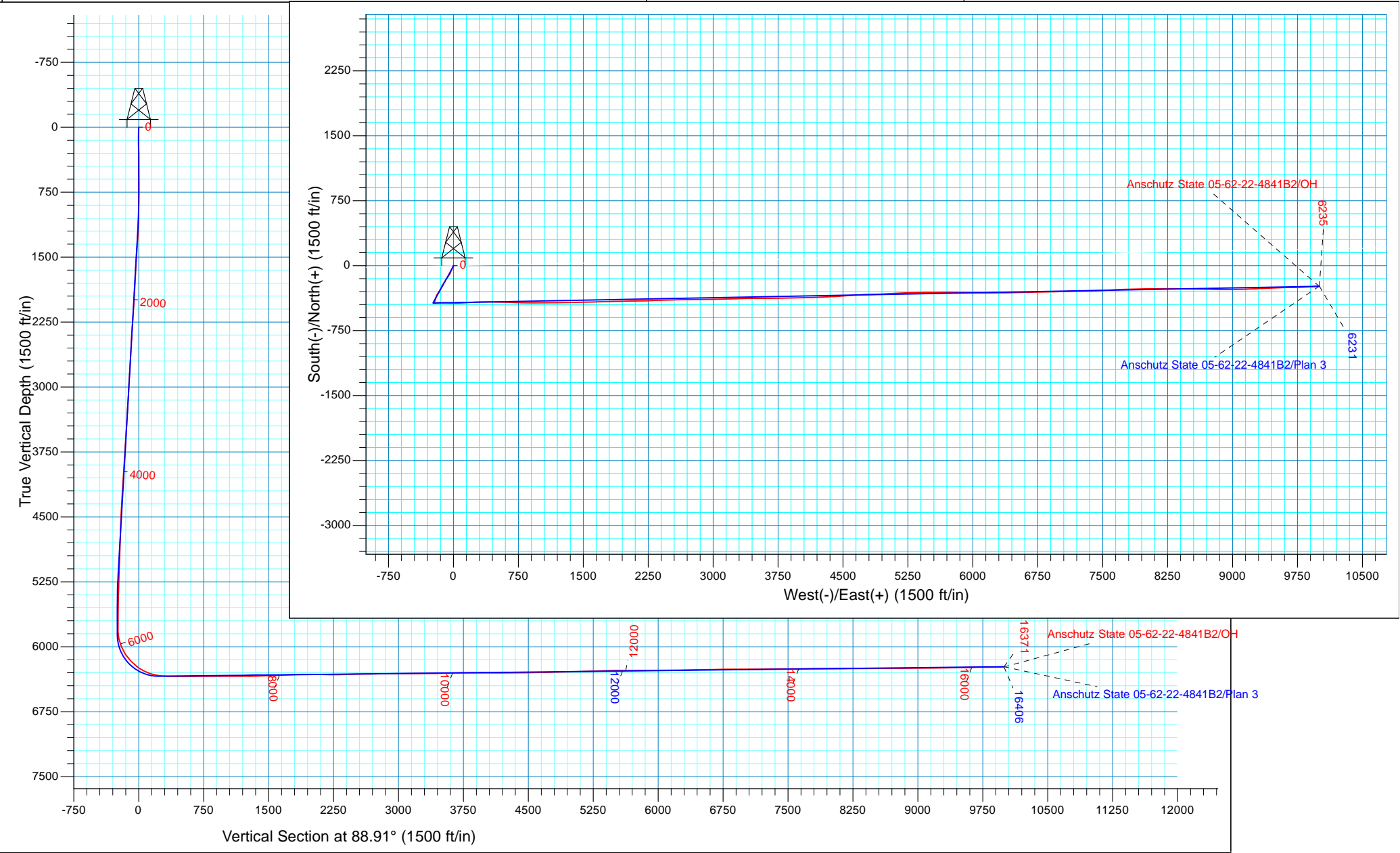



**Bill Barrett Corporation**

## **Bill Barrett Corp.**

Weld County, CO NAD 83

Anschutz State 5-62-22 NWSW Pad

Anschutz State 05-62-22-4841B2

OH

Design: OH

## **Standard Survey Report**

09 September, 2015



**Scientific Drilling**

[www.scientificdrilling.com](http://www.scientificdrilling.com)



<b>Company:</b>	Bill Barrett Corp.	<b>Local Co-ordinate Reference:</b>	Well Anschutz State 05-62-22-4841B2
<b>Project:</b>	Weld County, CO NAD 83	<b>TVD Reference:</b>	GL 4690' & KB 16' @ 4706.00ft (Cade 24)
<b>Site:</b>	Anschutz State 5-62-22 NWSW Pad	<b>MD Reference:</b>	GL 4690' & KB 16' @ 4706.00ft (Cade 24)
<b>Well:</b>	Anschutz State 05-62-22-4841B2	<b>North Reference:</b>	True
<b>Wellbore:</b>	OH	<b>Survey Calculation Method:</b>	Minimum Curvature
<b>Design:</b>	OH	<b>Database:</b>	Casper District

<b>Project</b>	Weld County, CO NAD 83		
<b>Map System:</b>	US State Plane 1983	<b>System Datum:</b>	Mean Sea Level
<b>Geo Datum:</b>	North American Datum 1983		
<b>Map Zone:</b>	Colorado Northern Zone		

<b>Site</b>	Anschutz State 5-62-22 NWSW Pad		
<b>Site Position:</b>		<b>Northing:</b>	1,384,806.64 usft
<b>From:</b>	Lat/Long	<b>Easting:</b>	3,329,099.95 usft
<b>Position Uncertainty:</b>	0.00 ft	<b>Slot Radius:</b>	13.200 in
		<b>Latitude:</b>	40° 23' 1.241 N
		<b>Longitude:</b>	104° 19' 6.982 W
		<b>Grid Convergence:</b>	0.76 °

<b>Well</b>	Anschutz State 05-62-22-4841B2, 2075' FSL 250' FWL Sec 22 T5N R62W		
<b>Well Position</b>	<b>+N/-S</b>	0.00 ft	<b>Northing:</b> 1,384,821.53 usft
	<b>+E/-W</b>	0.00 ft	<b>Easting:</b> 3,329,099.75 usft
<b>Position Uncertainty</b>	0.00 ft	<b>Wellhead Elevation:</b>	0.00 ft
		<b>Latitude:</b>	40° 23' 1.388 N
		<b>Longitude:</b>	104° 19' 6.982 W
		<b>Ground Level:</b>	4,690.00 ft

<b>Wellbore</b>	OH				
<b>Magnetics</b>	<b>Model Name</b>	<b>Sample Date</b>	<b>Declination (°)</b>	<b>Dip Angle (°)</b>	<b>Field Strength (nT)</b>
	BGGM2014	8/3/2015	8.19	66.95	52,602

<b>Design</b>	OH				
<b>Audit Notes:</b>					
<b>Version:</b>	1.0	<b>Phase:</b>	ACTUAL	<b>Tie On Depth:</b>	0.00
<b>Vertical Section:</b>	<b>Depth From (TVD) (ft)</b>	<b>+N/-S (ft)</b>	<b>+E/-W (ft)</b>	<b>Direction (°)</b>	
	0.00	0.00	0.00	88.91	

<b>Survey Program</b>	<b>Date</b>	9/9/2015			
<b>From (ft)</b>	<b>To (ft)</b>	<b>Survey (Wellbore)</b>	<b>Tool Name</b>	<b>Description</b>	
100.00	679.00	Survey #1 - Surface Gyro (OH)	NS-GYRO-MS	North sensing gyrocompassing m/s	
882.00	6,888.00	Survey #2 - Vertical / Curve (OH)	SDI MWD	SDI MWD - Standard ver 1.0.1	
6,982.00	16,371.00	Survey #3 - Lateral (OH)	SDI MWD	SDI MWD - Standard ver 1.0.1	

<b>Survey</b>										
	<b>Measured Depth (ft)</b>	<b>Inclination (°)</b>	<b>Azimuth (°)</b>	<b>Vertical Depth (ft)</b>	<b>+N/-S (ft)</b>	<b>+E/-W (ft)</b>	<b>Vertical Section (ft)</b>	<b>Dogleg Rate (°/100ft)</b>	<b>Build Rate (°/100ft)</b>	<b>Turn Rate (°/100ft)</b>
	679.00	0.49	54.14	678.99	1.12	1.77	1.79	0.17	0.01	19.54
	<b>Last Gyro Survey</b>									
	882.00	0.92	198.59	881.98	0.09	1.95	1.95	0.66	0.21	71.16
	<b>First SDI MWD Survey</b>									
	974.00	2.38	205.85	973.94	-2.33	0.88	0.84	1.60	1.59	7.89
	1,066.00	4.02	207.57	1,065.80	-6.91	-1.44	-1.57	1.79	1.78	1.87
	1,157.00	5.76	206.91	1,156.46	-13.81	-4.98	-5.25	1.91	1.91	-0.73
	1,249.00	7.32	206.30	1,247.86	-23.18	-9.67	-10.11	1.70	1.70	-0.66

<b>Company:</b>	Bill Barrett Corp.	<b>Local Co-ordinate Reference:</b>	Well Anschutz State 05-62-22-4841B2
<b>Project:</b>	Weld County, CO NAD 83	<b>TVD Reference:</b>	GL 4690' & KB 16' @ 4706.00ft (Cade 24)
<b>Site:</b>	Anschutz State 5-62-22 NWSW Pad	<b>MD Reference:</b>	GL 4690' & KB 16' @ 4706.00ft (Cade 24)
<b>Well:</b>	Anschutz State 05-62-22-4841B2	<b>North Reference:</b>	True
<b>Wellbore:</b>	OH	<b>Survey Calculation Method:</b>	Minimum Curvature
<b>Design:</b>	OH	<b>Database:</b>	Casper District

Survey									
Measured Depth (ft)	Inclination (°)	Azimuth (°)	Vertical Depth (ft)	+N/-S (ft)	+E/-W (ft)	Vertical Section (ft)	Dogleg Rate (°/100ft)	Build Rate (°/100ft)	Turn Rate (°/100ft)
1,341.00	8.04	205.63	1,339.04	-34.24	-15.05	-15.70	0.79	0.78	-0.73
1,433.00	8.30	205.09	1,430.10	-46.05	-20.65	-21.52	0.29	0.28	-0.59
1,524.00	8.29	204.84	1,520.15	-57.95	-26.19	-27.29	0.04	-0.01	-0.27
1,616.00	7.68	203.28	1,611.26	-69.62	-31.41	-32.73	0.70	-0.66	-1.70
1,707.00	7.21	198.59	1,701.49	-80.62	-35.63	-37.16	0.84	-0.52	-5.15
1,799.00	6.39	210.15	1,792.85	-90.52	-40.04	-41.76	1.73	-0.89	12.57
1,891.00	5.66	208.71	1,884.34	-98.92	-44.79	-46.67	0.81	-0.79	-1.57
1,982.00	5.84	214.10	1,974.88	-106.69	-49.54	-51.57	0.63	0.20	5.92
2,074.00	6.58	215.55	2,066.34	-114.86	-55.23	-57.41	0.82	0.80	1.58
2,165.00	6.04	210.09	2,156.79	-123.24	-60.67	-63.00	0.89	-0.59	-6.00
2,257.00	6.15	218.97	2,248.27	-131.26	-66.19	-68.68	1.03	0.12	9.65
2,348.00	6.68	217.09	2,338.70	-139.28	-72.45	-75.09	0.63	0.58	-2.07
2,443.00	5.58	213.10	2,433.16	-147.55	-78.30	-81.10	1.24	-1.16	-4.20
2,537.00	6.28	212.53	2,526.65	-155.72	-83.56	-86.51	0.75	0.74	-0.61
2,632.00	5.16	208.68	2,621.18	-163.84	-88.41	-91.51	1.25	-1.18	-4.05
2,726.00	5.52	210.05	2,714.77	-171.47	-92.70	-95.95	0.41	0.38	1.46
2,822.00	6.97	214.73	2,810.20	-180.25	-98.33	-101.74	1.60	1.51	4.88
2,917.00	5.99	217.56	2,904.59	-188.92	-104.64	-108.21	1.08	-1.03	2.98
3,011.00	5.11	211.51	2,998.15	-196.37	-109.82	-113.53	1.12	-0.94	-6.44
3,105.00	5.77	210.57	3,091.73	-204.01	-114.41	-118.27	0.71	0.70	-1.00
3,200.00	5.72	215.15	3,186.25	-211.99	-119.56	-123.57	0.49	-0.05	4.82
3,295.00	6.43	214.55	3,280.72	-220.25	-125.30	-129.47	0.75	0.75	-0.63
3,390.00	6.99	205.60	3,375.07	-229.84	-130.82	-135.17	1.25	0.59	-9.42
3,484.00	6.94	203.40	3,468.38	-240.21	-135.55	-140.09	0.29	-0.05	-2.34
3,578.00	8.12	202.86	3,561.56	-251.54	-140.38	-145.14	1.26	1.26	-0.57
3,672.00	8.05	208.44	3,654.63	-263.45	-146.09	-151.08	0.84	-0.07	5.94
3,767.00	8.12	211.45	3,748.69	-275.02	-152.76	-157.97	0.45	0.07	3.17
3,861.00	7.93	208.63	3,841.77	-286.37	-159.33	-164.75	0.46	-0.20	-3.00
3,956.00	7.27	209.95	3,935.93	-297.33	-165.47	-171.10	0.72	-0.69	1.39
4,050.00	6.51	210.00	4,029.25	-307.10	-171.11	-176.92	0.81	-0.81	0.05
4,145.00	6.44	209.54	4,123.65	-316.40	-176.43	-182.41	0.09	-0.07	-0.48
4,240.00	5.61	217.27	4,218.12	-324.73	-181.87	-188.01	1.22	-0.87	8.14
4,335.00	5.97	217.64	4,312.64	-332.34	-187.69	-193.98	0.38	0.38	0.39
4,429.00	6.46	204.99	4,406.09	-341.00	-192.91	-199.37	1.54	0.52	-13.46
4,524.00	5.64	200.50	4,500.56	-350.22	-196.81	-203.43	1.00	-0.86	-4.73
4,619.00	6.36	198.22	4,595.04	-359.59	-200.09	-206.89	0.80	0.76	-2.40
4,713.00	6.23	196.62	4,688.47	-369.42	-203.17	-210.16	0.23	-0.14	-1.70
4,807.00	6.41	196.13	4,781.90	-379.35	-206.09	-213.27	0.20	0.19	-0.52
4,902.00	6.86	197.43	4,876.26	-389.86	-209.26	-216.64	0.50	0.47	1.37
4,996.00	5.86	195.66	4,969.68	-399.84	-212.24	-219.81	1.08	-1.06	-1.88
5,090.00	4.99	201.04	5,063.26	-408.27	-215.00	-222.73	1.07	-0.93	5.72
5,185.00	4.23	201.61	5,157.95	-415.39	-217.78	-225.64	0.80	-0.80	0.60
5,280.00	4.22	204.44	5,252.70	-421.83	-220.51	-228.50	0.22	-0.01	2.98

<b>Company:</b>	Bill Barrett Corp.	<b>Local Co-ordinate Reference:</b>	Well Anschutz State 05-62-22-4841B2
<b>Project:</b>	Weld County, CO NAD 83	<b>TVD Reference:</b>	GL 4690' & KB 16' @ 4706.00ft (Cade 24)
<b>Site:</b>	Anschutz State 5-62-22 NWSW Pad	<b>MD Reference:</b>	GL 4690' & KB 16' @ 4706.00ft (Cade 24)
<b>Well:</b>	Anschutz State 05-62-22-4841B2	<b>North Reference:</b>	True
<b>Wellbore:</b>	OH	<b>Survey Calculation Method:</b>	Minimum Curvature
<b>Design:</b>	OH	<b>Database:</b>	Casper District

Survey										
Measured Depth (ft)	Inclination (°)	Azimuth (°)	Vertical Depth (ft)	+N/-S (ft)	+E/-W (ft)	Vertical Section (ft)	Dogleg Rate (°/100ft)	Build Rate (°/100ft)	Turn Rate (°/100ft)	
5,376.00	3.57	215.39	5,348.48	-427.48	-223.71	-231.80	1.03	-0.68	11.41	
5,470.00	2.23	218.70	5,442.35	-431.29	-226.54	-234.71	1.44	-1.43	3.52	
5,565.00	0.96	222.93	5,537.31	-433.32	-228.24	-236.44	1.34	-1.34	4.45	
5,659.00	0.57	225.18	5,631.31	-434.22	-229.11	-237.33	0.42	-0.41	2.39	
5,754.00	0.72	216.94	5,726.30	-435.03	-229.80	-238.04	0.19	0.16	-8.67	
5,849.00	0.32	201.53	5,821.30	-435.76	-230.26	-238.51	0.44	-0.42	-16.22	
5,944.00	14.45	81.51	5,915.30	-434.24	-218.57	-226.79	15.38	14.87	-126.34	
6,037.00	22.10	81.55	6,003.55	-429.95	-189.75	-197.89	8.23	8.23	0.04	
6,132.00	33.71	91.25	6,087.40	-427.90	-145.54	-153.65	13.09	12.22	10.21	
6,226.00	43.68	91.29	6,160.67	-429.20	-86.86	-95.01	10.61	10.61	0.04	
6,320.00	51.17	92.92	6,224.23	-431.80	-17.74	-25.96	8.07	7.97	1.73	
6,416.00	62.37	88.29	6,276.77	-432.44	62.39	54.15	12.34	11.67	-4.82	
6,510.00	72.54	86.30	6,312.77	-428.29	148.99	140.82	10.99	10.82	-2.12	
6,586.00	80.44	86.01	6,330.51	-423.33	222.66	214.57	10.40	10.39	-0.38	
6,699.00	88.62	89.53	6,341.27	-418.99	334.95	326.92	7.87	7.24	3.12	
6,794.00	89.23	90.76	6,343.05	-419.23	429.93	421.88	1.45	0.64	1.29	
6,888.00	89.26	91.74	6,344.29	-421.28	523.90	515.79	1.04	0.03	1.04	
Last SDI MWD Curve Survey										
6,982.00	90.67	91.35	6,344.35	-423.81	617.86	609.69	1.56	1.50	-0.41	
First SDI MWD Lateral Survey										
7,077.00	90.84	92.08	6,343.10	-426.65	712.81	704.56	0.79	0.18	0.77	
7,171.00	90.03	91.66	6,342.39	-429.72	806.76	798.44	0.97	-0.86	-0.45	
7,265.00	90.47	89.46	6,341.98	-430.64	900.74	892.39	2.39	0.47	-2.34	
7,360.00	90.34	90.42	6,341.30	-430.54	995.74	987.37	1.02	-0.14	1.01	
7,454.00	89.50	88.69	6,341.43	-429.81	1,089.73	1,081.36	2.05	-0.89	-1.84	
7,549.00	90.97	88.79	6,341.05	-427.72	1,184.71	1,176.36	1.55	1.55	0.11	
7,643.00	89.97	89.48	6,340.27	-426.30	1,278.69	1,270.35	1.29	-1.06	0.73	
7,737.00	91.34	88.88	6,339.20	-424.96	1,372.67	1,364.34	1.59	1.46	-0.64	
7,831.00	91.18	89.82	6,337.13	-423.89	1,466.64	1,458.31	1.01	-0.17	1.00	
7,925.00	92.05	87.72	6,334.48	-421.88	1,560.58	1,552.27	2.42	0.93	-2.23	
8,020.00	94.10	87.81	6,329.39	-418.18	1,655.36	1,647.11	2.16	2.16	0.09	
8,115.00	91.58	88.50	6,324.68	-415.12	1,750.19	1,741.98	2.75	-2.65	0.73	
8,209.00	91.81	88.78	6,321.90	-412.89	1,844.12	1,835.93	0.39	0.24	0.30	
8,304.00	89.97	89.12	6,320.42	-411.15	1,939.09	1,930.92	1.97	-1.94	0.36	
8,399.00	90.17	89.19	6,320.31	-409.75	2,034.08	2,025.92	0.22	0.21	0.07	
8,494.00	88.72	89.51	6,321.23	-408.67	2,129.07	2,120.91	1.56	-1.53	0.34	
8,588.00	89.43	87.32	6,322.75	-406.07	2,223.01	2,214.89	2.45	0.76	-2.33	
8,683.00	90.97	87.43	6,322.41	-401.72	2,317.91	2,309.85	1.63	1.62	0.12	
8,777.00	91.81	88.66	6,320.13	-398.52	2,411.82	2,403.81	1.58	0.89	1.31	
8,872.00	91.95	88.62	6,317.02	-396.26	2,506.75	2,498.76	0.15	0.15	-0.04	
8,966.00	90.30	88.93	6,315.17	-394.25	2,600.70	2,592.73	1.79	-1.76	0.33	
9,060.00	89.50	89.23	6,315.34	-392.74	2,694.69	2,686.73	0.91	-0.85	0.32	
9,154.00	91.38	89.11	6,314.61	-391.38	2,788.67	2,780.72	2.00	2.00	-0.13	
9,249.00	91.58	89.49	6,312.16	-390.22	2,883.63	2,875.69	0.45	0.21	0.40	

<b>Company:</b>	Bill Barrett Corp.	<b>Local Co-ordinate Reference:</b>	Well Anschutz State 05-62-22-4841B2
<b>Project:</b>	Weld County, CO NAD 83	<b>TVD Reference:</b>	GL 4690' & KB 16' @ 4706.00ft (Cade 24)
<b>Site:</b>	Anschutz State 5-62-22 NWSW Pad	<b>MD Reference:</b>	GL 4690' & KB 16' @ 4706.00ft (Cade 24)
<b>Well:</b>	Anschutz State 05-62-22-4841B2	<b>North Reference:</b>	True
<b>Wellbore:</b>	OH	<b>Survey Calculation Method:</b>	Minimum Curvature
<b>Design:</b>	OH	<b>Database:</b>	Casper District

Survey									
Measured Depth (ft)	Inclination (°)	Azimuth (°)	Vertical Depth (ft)	+N/-S (ft)	+E/-W (ft)	Vertical Section (ft)	Dogleg Rate (°/100ft)	Build Rate (°/100ft)	Turn Rate (°/100ft)
9,344.00	90.03	88.90	6,310.83	-388.89	2,978.61	2,970.68	1.75	-1.63	-0.62
9,438.00	90.17	88.83	6,310.66	-387.03	3,072.59	3,064.68	0.17	0.15	-0.07
9,533.00	90.34	88.71	6,310.24	-384.99	3,167.57	3,159.67	0.22	0.18	-0.13
9,626.00	89.87	88.24	6,310.07	-382.51	3,260.54	3,252.67	0.71	-0.51	-0.51
9,721.00	90.84	88.99	6,309.48	-380.22	3,355.51	3,347.67	1.29	1.02	0.79
9,815.00	91.31	89.36	6,307.72	-378.86	3,449.48	3,441.65	0.64	0.50	0.39
9,910.00	92.02	90.14	6,304.96	-378.45	3,544.44	3,536.60	1.11	0.75	0.82
10,005.00	90.70	88.49	6,302.70	-377.31	3,639.40	3,631.56	2.22	-1.39	-1.74
10,099.00	90.07	88.85	6,302.07	-375.13	3,733.37	3,725.56	0.77	-0.67	0.38
10,195.00	90.27	89.93	6,301.79	-374.11	3,829.36	3,821.55	1.14	0.21	1.13
10,289.00	90.17	89.89	6,301.42	-373.96	3,923.36	3,915.54	0.11	-0.11	-0.04
10,383.00	88.93	88.87	6,302.16	-372.94	4,017.35	4,009.53	1.71	-1.32	-1.09
10,475.00	89.73	87.21	6,303.24	-369.80	4,109.29	4,101.51	2.00	0.87	-1.80
10,567.00	91.04	87.72	6,302.62	-365.73	4,201.19	4,193.47	1.53	1.42	0.55
10,659.00	89.90	87.47	6,301.87	-361.87	4,293.11	4,285.45	1.27	-1.24	-0.27
10,751.00	89.63	86.64	6,302.24	-357.14	4,384.98	4,377.40	0.95	-0.29	-0.90
10,842.00	91.51	86.40	6,301.34	-351.62	4,475.81	4,468.31	2.08	2.07	-0.26
10,933.00	91.48	86.04	6,298.96	-345.62	4,566.58	4,559.18	0.40	-0.03	-0.40
11,025.00	91.85	86.71	6,296.29	-339.81	4,658.35	4,651.05	0.83	0.40	0.73
11,116.00	89.87	87.31	6,294.92	-335.06	4,749.22	4,741.98	2.27	-2.18	0.66
11,208.00	91.55	89.50	6,293.78	-332.50	4,841.16	4,833.96	3.00	1.83	2.38
11,300.00	90.37	86.82	6,292.24	-329.55	4,933.09	4,925.93	3.18	-1.28	-2.91
11,391.00	91.82	87.43	6,290.50	-324.98	5,023.96	5,016.87	1.73	1.59	0.67
11,483.00	91.78	86.63	6,287.61	-320.22	5,115.79	5,108.77	0.87	-0.04	-0.87
11,575.00	91.92	87.85	6,284.64	-315.79	5,207.63	5,200.68	1.33	0.15	1.33
11,667.00	91.58	88.08	6,281.83	-312.53	5,299.53	5,292.63	0.45	-0.37	0.25
11,759.00	92.59	89.31	6,278.49	-310.43	5,391.44	5,384.56	1.73	1.10	1.34
11,850.00	91.34	88.93	6,275.37	-309.03	5,482.38	5,475.51	1.44	-1.37	-0.42
11,941.00	90.54	89.80	6,273.87	-308.03	5,573.36	5,566.49	1.30	-0.88	0.96
12,033.00	87.88	89.69	6,275.14	-307.62	5,665.34	5,658.46	2.89	-2.89	-0.12
12,125.00	89.90	90.90	6,276.92	-308.09	5,757.32	5,750.41	2.56	2.20	1.32
12,216.00	90.71	90.87	6,276.44	-309.50	5,848.30	5,841.36	0.89	0.89	-0.03
12,308.00	90.64	90.95	6,275.36	-310.96	5,940.28	5,933.29	0.12	-0.08	0.09
12,399.00	91.71	91.08	6,273.49	-312.57	6,031.25	6,024.21	1.18	1.18	0.14
12,491.00	90.64	90.21	6,271.60	-313.60	6,123.22	6,116.15	1.50	-1.16	-0.95
12,582.00	90.84	90.00	6,270.43	-313.77	6,214.21	6,207.12	0.32	0.22	-0.23
12,674.00	91.78	89.77	6,268.32	-313.59	6,306.19	6,299.08	1.05	1.02	-0.25
12,765.00	90.23	88.85	6,266.73	-312.49	6,397.17	6,390.06	1.98	-1.70	-1.01
12,857.00	91.34	89.01	6,265.47	-310.77	6,489.14	6,482.05	1.22	1.21	0.17
12,949.00	90.40	88.94	6,264.07	-309.13	6,581.11	6,574.04	1.02	-1.02	-0.08
13,041.00	91.61	89.44	6,262.46	-307.83	6,673.09	6,666.02	1.42	1.32	0.54
13,132.00	89.36	88.17	6,261.69	-305.93	6,764.06	6,757.01	2.84	-2.47	-1.40
13,223.00	90.40	88.41	6,261.88	-303.21	6,855.01	6,848.01	1.17	1.14	0.26

<b>Company:</b>	Bill Barrett Corp.	<b>Local Co-ordinate Reference:</b>	Well Anschutz State 05-62-22-4841B2
<b>Project:</b>	Weld County, CO NAD 83	<b>TVD Reference:</b>	GL 4690' & KB 16' @ 4706.00ft (Cade 24)
<b>Site:</b>	Anschutz State 5-62-22 NWSW Pad	<b>MD Reference:</b>	GL 4690' & KB 16' @ 4706.00ft (Cade 24)
<b>Well:</b>	Anschutz State 05-62-22-4841B2	<b>North Reference:</b>	True
<b>Wellbore:</b>	OH	<b>Survey Calculation Method:</b>	Minimum Curvature
<b>Design:</b>	OH	<b>Database:</b>	Casper District

Survey									
Measured Depth (ft)	Inclination (°)	Azimuth (°)	Vertical Depth (ft)	+N/-S (ft)	+E/-W (ft)	Vertical Section (ft)	Dogleg Rate (°/100ft)	Build Rate (°/100ft)	Turn Rate (°/100ft)
13,315.00	89.83	88.69	6,261.69	-300.89	6,946.98	6,940.00	0.69	-0.62	0.30
13,407.00	91.28	89.04	6,260.80	-299.06	7,038.96	7,032.00	1.62	1.58	0.38
13,499.00	90.34	88.62	6,259.50	-297.19	7,130.93	7,123.99	1.12	-1.02	-0.46
13,591.00	90.03	88.52	6,259.20	-294.89	7,222.90	7,215.98	0.35	-0.34	-0.11
13,683.00	90.50	88.51	6,258.78	-292.51	7,314.87	7,307.98	0.51	0.51	-0.01
13,774.00	89.56	87.60	6,258.73	-289.42	7,405.81	7,398.97	1.44	-1.03	-1.00
13,866.00	92.35	88.79	6,257.20	-286.52	7,497.74	7,490.94	3.30	3.03	1.29
13,957.00	90.24	86.56	6,255.14	-282.83	7,588.64	7,581.88	3.37	-2.32	-2.45
14,048.00	90.17	86.96	6,254.82	-277.68	7,679.49	7,672.82	0.45	-0.08	0.44
14,140.00	90.81	87.13	6,254.03	-272.94	7,771.36	7,764.77	0.72	0.70	0.18
14,232.00	89.73	89.11	6,253.60	-269.92	7,863.31	7,856.75	2.45	-1.17	2.15
14,323.00	90.27	89.28	6,253.60	-268.65	7,954.30	7,947.75	0.62	0.59	0.19
14,415.00	89.80	89.72	6,253.54	-267.84	8,046.29	8,039.74	0.70	-0.51	0.48
14,506.00	90.47	89.58	6,253.33	-267.29	8,137.29	8,130.73	0.75	0.74	-0.15
14,598.00	90.27	90.02	6,252.73	-266.97	8,229.29	8,222.72	0.53	-0.22	0.48
14,690.00	90.64	90.22	6,252.00	-267.16	8,321.29	8,314.70	0.46	0.40	0.22
14,782.00	90.13	90.87	6,251.38	-268.03	8,413.28	8,406.66	0.90	-0.55	0.71
14,873.00	91.11	90.17	6,250.40	-268.86	8,504.27	8,497.61	1.32	1.08	-0.77
14,965.00	90.27	90.83	6,249.29	-269.66	8,596.26	8,589.57	1.16	-0.91	0.72
15,056.00	89.93	91.55	6,249.13	-271.55	8,687.24	8,680.50	0.87	-0.37	0.79
15,148.00	89.97	93.10	6,249.21	-275.28	8,779.16	8,772.33	1.69	0.04	1.68
15,239.00	89.13	90.56	6,249.93	-278.19	8,870.10	8,863.20	2.94	-0.92	-2.79
15,330.00	89.33	87.78	6,251.15	-276.87	8,961.07	8,954.18	3.06	0.22	-3.05
15,421.00	92.18	87.73	6,249.95	-273.31	9,051.99	9,045.15	3.13	3.13	-0.05
15,512.00	91.51	88.89	6,247.02	-270.63	9,142.90	9,136.09	1.47	-0.74	1.27
15,604.00	90.74	88.31	6,245.21	-268.38	9,234.85	9,228.07	1.05	-0.84	-0.63
15,698.00	90.07	87.31	6,244.55	-264.79	9,328.78	9,322.05	1.28	-0.71	-1.06
15,792.00	91.98	86.99	6,242.87	-260.11	9,422.64	9,415.99	2.06	2.03	-0.34
15,886.00	91.82	88.43	6,239.75	-256.36	9,516.51	9,509.91	1.54	-0.17	1.53
15,981.00	89.93	88.81	6,238.30	-254.07	9,611.47	9,604.90	2.03	-1.99	0.40
16,076.00	90.64	88.40	6,237.83	-251.76	9,706.44	9,699.89	0.86	0.75	-0.43
16,170.00	90.40	87.89	6,236.97	-248.72	9,800.39	9,793.88	0.60	-0.26	-0.54
16,264.00	90.77	87.61	6,236.02	-245.03	9,894.31	9,887.86	0.49	0.39	-0.30
16,313.00	90.74	87.30	6,235.37	-242.85	9,943.26	9,936.84	0.64	-0.06	-0.63
Last SDI MWD Survey									
16,371.00	90.74	87.30	6,234.62	-240.12	10,001.19	9,994.81	0.00	0.00	0.00
Projection to TD									

<b>Company:</b>	Bill Barrett Corp.	<b>Local Co-ordinate Reference:</b>	Well Anschutz State 05-62-22-4841B2
<b>Project:</b>	Weld County, CO NAD 83	<b>TVD Reference:</b>	GL 4690' & KB 16' @ 4706.00ft (Cade 24)
<b>Site:</b>	Anschutz State 5-62-22 NWSW Pad	<b>MD Reference:</b>	GL 4690' & KB 16' @ 4706.00ft (Cade 24)
<b>Well:</b>	Anschutz State 05-62-22-4841B2	<b>North Reference:</b>	True
<b>Wellbore:</b>	OH	<b>Survey Calculation Method:</b>	Minimum Curvature
<b>Design:</b>	OH	<b>Database:</b>	Casper District

Casing Points					
Measured Depth (ft)	Vertical Depth (ft)	Name		Casing Diameter (in)	Hole Diameter (in)
14,598.00	6,252.73	Case15		7.000	7.000

Design Annotations					
Measured Depth (ft)	Vertical Depth (ft)	Local Coordinates		Comment	
		+N/-S (ft)	+E/-W (ft)		
100.00	100.00	-0.02	-0.08	First Gyro Survey	
679.00	678.99	1.12	1.77	Last Gyro Survey	
882.00	881.98	0.09	1.95	First SDI MWD Survey	
6,888.00	6,344.29	-421.28	523.90	Last SDI MWD Curve Survey	
6,982.00	6,344.35	-423.81	617.86	First SDI MWD Lateral Survey	
16,313.00	6,235.37	-242.85	9,943.26	Last SDI MWD Survey	
16,371.00	6,234.62	-240.12	10,001.19	Projection to TD	

Checked By: _____	Approved By: _____	Date: _____
-------------------	--------------------	-------------