

WELL DETAILS: Anschutz State 05-62-22-3340B2				PROJECT DETAILS: Weld County, CO NAD 83	
GL 4690' & KB 16' @ 4706.00ft (Cade 24)		4690.00		Geodetic System: US State Plane 1983	
Northing	Easting	Latitude	Longitude	Datum: North American Datum 1983	
1384851.02	3329100.19	40° 23' 1.679 N	104° 19' 6.971 W	Ellipsoid: GRS 1980	
				Zone: Colorado Northern Zone	
				System Datum: Mean Sea Level	
				Local North: True	
				Created By: Seth Burstad	Date: 7-26-15

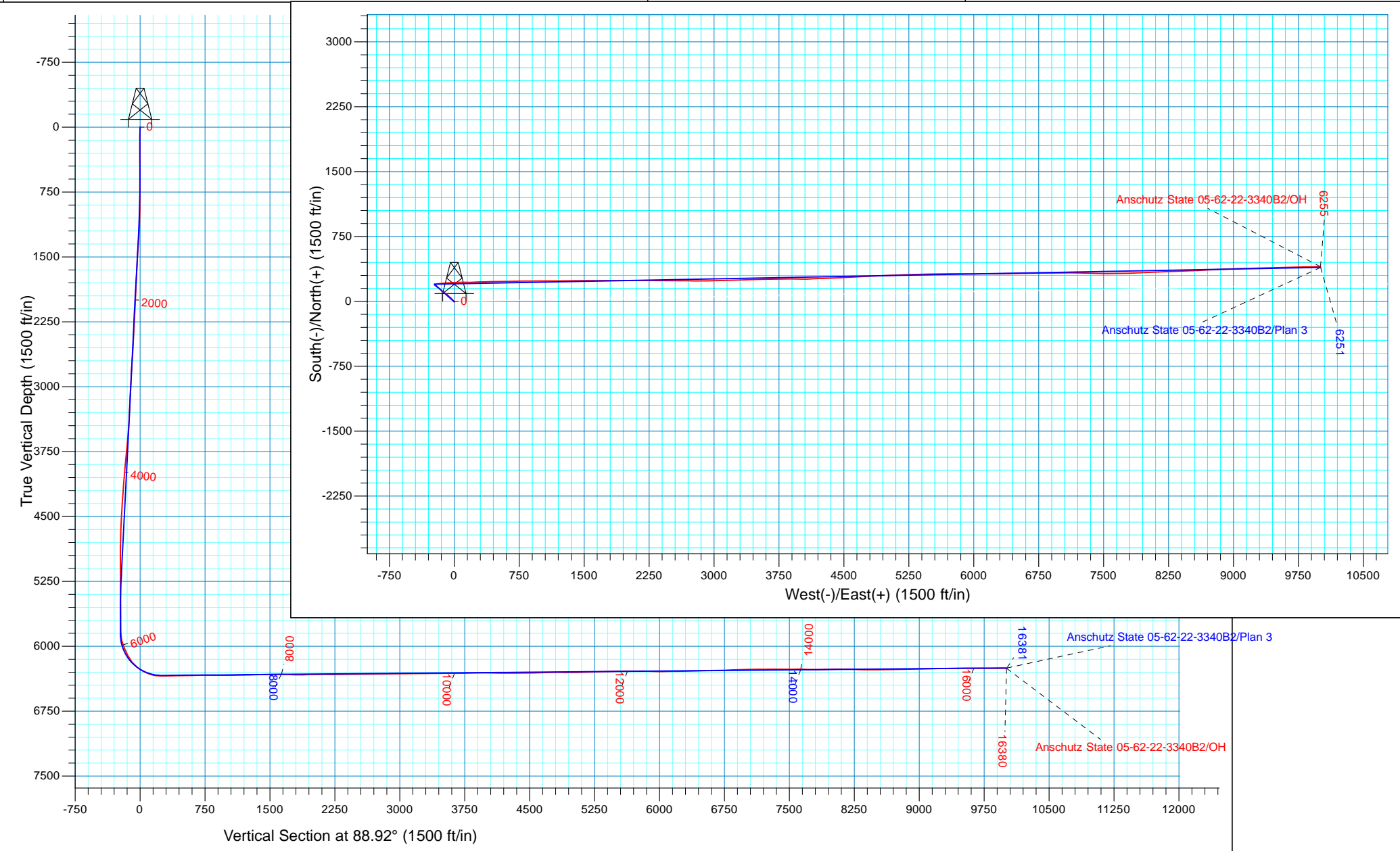



**Bill Barrett Corporation**

## **Bill Barrett Corp.**

Weld County, CO NAD 83

Anschutz State 5-62-22 NWSW Pad

Anschutz State 05-62-22-3340B2

OH

Design: OH

## **Standard Survey Report**

24 August, 2015



**Scientific Drilling**

[www.scientificdrilling.com](http://www.scientificdrilling.com)



<b>Company:</b>	Bill Barrett Corp.	<b>Local Co-ordinate Reference:</b>	Well Anschutz State 05-62-22-3340B2
<b>Project:</b>	Weld County, CO NAD 83	<b>TVD Reference:</b>	GL 4690' & KB 16' @ 4706.00ft (Cade 24)
<b>Site:</b>	Anschutz State 5-62-22 NWSW Pad	<b>MD Reference:</b>	GL 4690' & KB 16' @ 4706.00ft (Cade 24)
<b>Well:</b>	Anschutz State 05-62-22-3340B2	<b>North Reference:</b>	True
<b>Wellbore:</b>	OH	<b>Survey Calculation Method:</b>	Minimum Curvature
<b>Design:</b>	OH	<b>Database:</b>	Casper District

<b>Project</b>	Weld County, CO NAD 83		
<b>Map System:</b>	US State Plane 1983	<b>System Datum:</b>	Mean Sea Level
<b>Geo Datum:</b>	North American Datum 1983		
<b>Map Zone:</b>	Colorado Northern Zone		

Site		Anschutz State 5-62-22 NWSW Pad					
Site Position:		Northing:	1,384,806.64	usft	Latitude:	40° 23' 1.241 N	
From:	Lat/Long	Easting:	3,329,099.95	usft	Longitude:	104° 19' 6.982 W	
Position Uncertainty:	0.00	ft	Slot Radius:	13.200	in	Grid Convergence:	0.76 °

Well	Anschutz State 05-62-22-3340B2, 2015' FSL 250' FWL Sec 22 T5N R62W					
Well Position	+N/-S	0.00 ft	Northing:	1,384,851.02 usft	Latitude:	40° 23' 1.679 N
	+E/-W	0.00 ft	Easting:	3,329,100.19 usft	Longitude:	104° 19' 6.971 W
Position Uncertainty		0.00 ft	Wellhead Elevation:	0.00 ft	Ground Level:	4,690.00 ft

<b>Wellbore</b>	OH				
<b>Magnetics</b>	<b>Model Name</b>	<b>Sample Date</b>	<b>Declination (°)</b>	<b>Dip Angle (°)</b>	<b>Field Strength (nT)</b>
	BGGM2014	8/19/2015	8.18	66.95	52,596

<b>Design</b>	OH				
<b>Audit Notes:</b>					
<b>Version:</b>	1.0	<b>Phase:</b>	ACTUAL	<b>Tie On Depth:</b>	0.00
<b>Vertical Section:</b>	<b>Depth From (TVD) (ft)</b>	<b>+N/-S (ft)</b>	<b>+E/-W (ft)</b>	<b>Direction (°)</b>	
	0.00	0.00	0.00	88.92	

<b>Survey Program</b>	<b>Date</b>	8/24/2015			
<b>From (ft)</b>	<b>To (ft)</b>	<b>Survey (Wellbore)</b>	<b>Tool Name</b>	<b>Description</b>	
100.00	700.00	Survey #1 - Surface Gyro (OH)	NS-GYRO-MS	North sensing gyrocompassing m/s	
884.00	6,566.00	Survey #2 - Vertical / Curve (OH)	SDI MWD	SDI MWD - Standard ver 1.0.1	
6,695.00	16,380.00	Survey #3 - Lateral (OH)	SDI MWD	SDI MWD - Standard ver 1.0.1	

<b>Survey</b>									
<b>Measured Depth (ft)</b>	<b>Inclination (°)</b>	<b>Azimuth (°)</b>	<b>Vertical Depth (ft)</b>	<b>+N/-S (ft)</b>	<b>+E/-W (ft)</b>	<b>Vertical Section (ft)</b>	<b>Dogleg Rate (°/100ft)</b>	<b>Build Rate (°/100ft)</b>	<b>Turn Rate (°/100ft)</b>
700.00	0.06	231.98	699.99	-3.19	-1.03	-1.09	0.35	-0.32	58.13
<b>Last Gyro Survey</b>									
884.00	0.09	6.45	883.99	-3.11	-1.09	-1.14	0.08	0.02	73.08
<b>First SDI MWD Survey</b>									
976.00	1.50	337.36	975.98	-1.93	-1.54	-1.58	1.55	1.53	-31.62
1,068.00	3.66	329.28	1,067.88	1.71	-3.50	-3.47	2.38	2.35	-8.78
1,159.00	4.71	319.40	1,158.63	7.04	-7.42	-7.29	1.40	1.15	-10.86
1,251.00	5.10	313.24	1,250.30	12.71	-12.86	-12.61	0.71	0.42	-6.70

<b>Company:</b>	Bill Barrett Corp.	<b>Local Co-ordinate Reference:</b>	Well Anschutz State 05-62-22-3340B2
<b>Project:</b>	Weld County, CO NAD 83	<b>TVD Reference:</b>	GL 4690' & KB 16' @ 4706.00ft (Cade 24)
<b>Site:</b>	Anschutz State 5-62-22 NWSW Pad	<b>MD Reference:</b>	GL 4690' & KB 16' @ 4706.00ft (Cade 24)
<b>Well:</b>	Anschutz State 05-62-22-3340B2	<b>North Reference:</b>	True
<b>Wellbore:</b>	OH	<b>Survey Calculation Method:</b>	Minimum Curvature
<b>Design:</b>	OH	<b>Database:</b>	Casper District

Survey									
Measured Depth (ft)	Inclination (°)	Azimuth (°)	Vertical Depth (ft)	+N/-S (ft)	+E/-W (ft)	Vertical Section (ft)	Dogleg Rate (°/100ft)	Build Rate (°/100ft)	Turn Rate (°/100ft)
1,343.00	5.38	314.64	1,341.91	18.55	-18.90	-18.55	0.33	0.30	1.52
1,435.00	5.56	314.84	1,433.49	24.72	-25.13	-24.66	0.20	0.20	0.22
1,526.00	5.37	315.50	1,524.08	30.86	-31.24	-30.66	0.22	-0.21	0.73
1,618.00	3.79	314.96	1,615.78	36.08	-36.41	-35.73	1.72	-1.72	-0.59
1,709.00	3.39	313.27	1,706.61	40.05	-40.50	-39.74	0.45	-0.44	-1.86
1,801.00	3.20	314.13	1,798.45	43.71	-44.32	-43.49	0.21	-0.21	0.93
1,893.00	4.40	310.66	1,890.25	47.79	-48.84	-47.94	1.33	1.30	-3.77
1,984.00	4.06	308.84	1,981.00	52.09	-54.00	-53.01	0.40	-0.37	-2.00
2,075.00	3.99	308.64	2,071.78	56.08	-58.98	-57.92	0.08	-0.08	-0.22
2,167.00	3.91	313.39	2,163.56	60.24	-63.76	-62.62	0.37	-0.09	5.16
2,259.00	3.56	324.34	2,255.36	64.71	-67.71	-66.48	0.86	-0.38	11.90
2,351.00	4.30	324.08	2,347.15	69.83	-71.40	-70.07	0.80	0.80	-0.28
2,445.00	4.27	309.02	2,440.89	74.89	-76.18	-74.76	1.19	-0.03	-16.02
2,540.00	3.59	310.06	2,535.66	79.03	-81.21	-79.70	0.72	-0.72	1.09
2,634.00	4.46	300.13	2,629.43	82.75	-86.62	-85.05	1.18	0.93	-10.56
2,729.00	4.65	297.53	2,724.13	86.39	-93.23	-91.59	0.30	0.20	-2.74
2,824.00	4.57	295.22	2,818.83	89.78	-100.07	-98.36	0.21	-0.08	-2.43
2,919.00	3.78	294.39	2,913.57	92.69	-106.35	-104.58	0.83	-0.83	-0.87
3,013.00	3.53	317.42	3,007.39	96.10	-111.13	-109.29	1.57	-0.27	24.50
3,107.00	4.10	317.18	3,101.18	100.69	-115.37	-113.45	0.61	0.61	-0.26
3,203.00	2.98	316.97	3,196.99	105.03	-119.40	-117.40	1.17	-1.17	-0.22
3,297.00	3.78	312.82	3,290.83	108.93	-123.34	-121.27	0.89	0.85	-4.41
3,392.00	4.70	308.39	3,385.57	113.47	-128.69	-126.53	1.03	0.97	-4.66
3,486.00	5.55	309.30	3,479.19	118.74	-135.23	-132.96	0.91	0.90	0.97
3,581.00	5.91	307.55	3,573.72	124.63	-142.66	-140.29	0.42	0.38	-1.84
3,675.00	6.57	307.12	3,667.16	130.83	-150.78	-148.29	0.70	0.70	-0.46
3,769.00	6.56	306.39	3,760.54	137.26	-159.39	-156.78	0.09	-0.01	-0.78
3,864.00	6.56	306.53	3,854.92	143.71	-168.12	-165.39	0.02	0.00	0.15
3,958.00	6.45	308.14	3,948.32	150.17	-176.59	-173.73	0.23	-0.12	1.71
4,053.00	6.24	309.82	4,042.73	156.77	-184.75	-181.77	0.30	-0.22	1.77
4,147.00	5.38	306.82	4,136.25	162.68	-192.20	-189.10	0.97	-0.91	-3.19
4,242.00	5.21	305.12	4,230.84	167.83	-199.30	-196.10	0.24	-0.18	-1.79
4,337.00	5.08	307.99	4,325.46	172.90	-206.14	-202.85	0.30	-0.14	3.02
4,431.00	4.51	308.37	4,419.13	177.76	-212.32	-208.93	0.61	-0.61	0.40
4,526.00	3.71	308.02	4,513.89	181.97	-217.67	-214.20	0.84	-0.84	-0.37
4,621.00	3.30	304.97	4,608.71	185.43	-222.33	-218.80	0.47	-0.43	-3.21
4,715.00	2.78	314.94	4,702.58	188.59	-226.16	-222.57	0.79	-0.55	10.61
4,810.00	1.90	326.52	4,797.50	191.53	-228.66	-225.01	1.05	-0.93	12.19
4,904.00	0.84	347.12	4,891.47	193.50	-229.67	-225.99	1.23	-1.13	21.91
4,999.00	0.54	5.11	4,986.46	194.63	-229.79	-226.08	0.39	-0.32	18.94
5,093.00	0.40	52.07	5,080.46	195.27	-229.49	-225.77	0.42	-0.15	49.96
5,187.00	0.77	13.88	5,174.46	196.08	-229.08	-225.34	0.55	0.39	-40.63
5,282.00	0.60	2.93	5,269.45	197.20	-228.90	-225.14	0.23	-0.18	-11.53

<b>Company:</b>	Bill Barrett Corp.	<b>Local Co-ordinate Reference:</b>	Well Anschutz State 05-62-22-3340B2
<b>Project:</b>	Weld County, CO NAD 83	<b>TVD Reference:</b>	GL 4690' & KB 16' @ 4706.00ft (Cade 24)
<b>Site:</b>	Anschutz State 5-62-22 NWSW Pad	<b>MD Reference:</b>	GL 4690' & KB 16' @ 4706.00ft (Cade 24)
<b>Well:</b>	Anschutz State 05-62-22-3340B2	<b>North Reference:</b>	True
<b>Wellbore:</b>	OH	<b>Survey Calculation Method:</b>	Minimum Curvature
<b>Design:</b>	OH	<b>Database:</b>	Casper District

Survey										
Measured Depth (ft)	Inclination (°)	Azimuth (°)	Vertical Depth (ft)	+N/-S (ft)	+E/-W (ft)	Vertical Section (ft)	Dogleg Rate (°/100ft)	Build Rate (°/100ft)	Turn Rate (°/100ft)	
5,378.00	0.66	22.22	5,365.44	198.21	-228.67	-224.89	0.23	0.06	20.09	
5,472.00	0.51	42.19	5,459.44	199.03	-228.18	-224.39	0.27	-0.16	21.24	
5,567.00	0.34	45.77	5,554.44	199.54	-227.70	-223.89	0.18	-0.18	3.77	
5,661.00	0.34	102.71	5,648.43	199.67	-227.22	-223.42	0.34	0.00	60.57	
5,756.00	0.46	105.85	5,743.43	199.50	-226.58	-222.78	0.13	0.13	3.31	
5,851.00	1.12	92.61	5,838.42	199.36	-225.29	-221.49	0.72	0.69	-13.94	
5,945.00	12.90	82.50	5,931.56	200.69	-213.93	-210.11	12.55	12.53	-10.76	
6,039.00	23.44	81.09	6,020.74	204.97	-184.97	-181.08	11.22	11.21	-1.50	
6,133.00	25.93	89.46	6,106.17	208.06	-145.93	-141.98	4.56	2.65	8.90	
6,228.00	38.90	84.48	6,186.22	211.14	-95.25	-91.25	13.93	13.65	-5.24	
6,322.00	54.90	84.30	6,250.23	217.84	-27.16	-23.05	17.02	17.02	-0.19	
6,417.00	63.26	91.10	6,299.05	220.89	54.13	58.29	10.72	8.80	7.16	
6,512.00	75.75	89.30	6,332.25	220.64	142.94	147.07	13.27	13.15	-1.89	
6,566.00	86.07	87.35	6,340.77	222.21	196.16	200.32	19.44	19.11	-3.61	
Last SDI MWD Curve Survey										
6,695.00	92.12	88.76	6,342.80	226.58	325.01	329.22	4.82	4.69	1.09	
First SDI MWD Lateral Survey										
6,790.00	91.34	89.23	6,339.94	228.25	419.95	424.18	0.96	-0.82	0.49	
6,884.00	90.37	87.99	6,338.53	230.53	513.91	518.16	1.67	-1.03	-1.32	
6,978.00	91.58	88.61	6,336.93	233.32	607.85	612.14	1.45	1.29	0.66	
7,073.00	91.21	89.58	6,334.62	234.82	702.81	707.11	1.09	-0.39	1.02	
7,167.00	88.59	89.05	6,334.78	235.94	796.80	801.10	2.84	-2.79	-0.56	
7,261.00	89.63	90.02	6,336.24	236.70	890.78	895.08	1.51	1.11	1.03	
7,356.00	90.20	89.67	6,336.39	236.96	985.78	990.07	0.70	0.60	-0.37	
7,450.00	90.97	89.63	6,335.43	237.53	1,079.77	1,084.06	0.82	0.82	-0.04	
7,545.00	91.71	89.44	6,333.20	238.30	1,174.74	1,179.02	0.80	0.78	-0.20	
7,639.00	90.87	89.59	6,331.09	239.10	1,268.71	1,272.99	0.91	-0.89	0.16	
7,733.00	91.98	89.54	6,328.75	239.81	1,362.68	1,366.96	1.18	1.18	-0.05	
7,827.00	90.87	89.85	6,326.41	240.31	1,456.65	1,460.92	1.23	-1.18	0.33	
7,921.00	90.57	89.91	6,325.23	240.51	1,550.64	1,554.90	0.33	-0.32	0.06	
8,016.00	88.66	90.15	6,325.87	240.46	1,645.63	1,649.87	2.03	-2.01	0.25	
8,111.00	88.05	89.72	6,328.60	240.57	1,740.59	1,744.82	0.79	-0.64	-0.45	
8,205.00	90.81	89.52	6,329.53	241.19	1,834.58	1,838.80	2.94	2.94	-0.21	
8,300.00	90.91	88.75	6,328.11	242.63	1,929.56	1,933.79	0.82	0.11	-0.81	
8,395.00	90.94	90.54	6,326.57	243.21	2,024.54	2,028.76	1.88	0.03	1.88	
8,490.00	89.90	90.36	6,325.88	242.47	2,119.53	2,123.72	1.11	-1.09	-0.19	
8,584.00	89.50	89.77	6,326.37	242.36	2,213.53	2,217.70	0.76	-0.43	-0.63	
8,679.00	90.34	90.01	6,326.50	242.54	2,308.53	2,312.69	0.92	0.88	0.25	
8,773.00	91.51	91.45	6,324.98	241.35	2,402.50	2,406.63	1.97	1.24	1.53	
8,867.00	90.20	90.34	6,323.58	239.88	2,496.48	2,500.56	1.83	-1.39	-1.18	
8,962.00	91.21	90.52	6,322.41	239.17	2,591.47	2,595.51	1.08	1.06	0.19	
9,056.00	91.21	90.32	6,320.43	238.48	2,685.44	2,689.46	0.21	0.00	-0.21	
9,150.00	91.07	90.35	6,318.56	237.93	2,779.42	2,783.41	0.15	-0.15	0.03	
9,245.00	89.83	89.18	6,317.81	238.32	2,874.42	2,878.40	1.79	-1.31	-1.23	

<b>Company:</b>	Bill Barrett Corp.	<b>Local Co-ordinate Reference:</b>	Well Anschutz State 05-62-22-3340B2
<b>Project:</b>	Weld County, CO NAD 83	<b>TVD Reference:</b>	GL 4690' & KB 16' @ 4706.00ft (Cade 24)
<b>Site:</b>	Anschutz State 5-62-22 NWSW Pad	<b>MD Reference:</b>	GL 4690' & KB 16' @ 4706.00ft (Cade 24)
<b>Well:</b>	Anschutz State 05-62-22-3340B2	<b>North Reference:</b>	True
<b>Wellbore:</b>	OH	<b>Survey Calculation Method:</b>	Minimum Curvature
<b>Design:</b>	OH	<b>Database:</b>	Casper District

Survey									
Measured Depth (ft)	Inclination (°)	Azimuth (°)	Vertical Depth (ft)	+N/-S (ft)	+E/-W (ft)	Vertical Section (ft)	Dogleg Rate (°/100ft)	Build Rate (°/100ft)	Turn Rate (°/100ft)
9,340.00	89.76	89.06	6,318.15	239.78	2,969.40	2,973.40	0.15	-0.07	-0.13
9,433.00	90.44	88.24	6,317.99	241.97	3,062.38	3,066.39	1.15	0.73	-0.88
9,528.00	91.11	88.35	6,316.70	244.79	3,157.33	3,161.38	0.71	0.71	0.12
9,622.00	91.31	88.51	6,314.72	247.37	3,251.27	3,255.35	0.27	0.21	0.17
9,716.00	91.38	88.60	6,312.51	249.74	3,345.21	3,349.33	0.12	0.07	0.10
9,811.00	89.66	88.84	6,311.65	251.86	3,440.18	3,444.32	1.83	-1.81	0.25
9,906.00	89.76	88.27	6,312.13	254.26	3,535.15	3,539.31	0.61	0.11	-0.60
10,001.00	90.37	88.33	6,312.02	257.07	3,630.11	3,634.31	0.65	0.64	0.06
10,095.00	90.74	88.07	6,311.11	260.03	3,724.06	3,728.30	0.48	0.39	-0.28
10,190.00	91.34	90.62	6,309.39	261.11	3,819.03	3,823.27	2.76	0.63	2.68
10,285.00	91.41	91.32	6,307.11	259.50	3,913.98	3,918.18	0.74	0.07	0.74
10,379.00	88.62	90.03	6,307.08	258.40	4,007.97	4,012.13	3.27	-2.97	-1.37
10,469.00	88.79	87.58	6,309.12	260.27	4,097.92	4,102.10	2.73	0.19	-2.72
10,562.00	89.80	87.84	6,310.26	263.99	4,190.84	4,195.07	1.12	1.09	0.28
10,654.00	89.83	87.91	6,310.56	267.40	4,282.77	4,287.05	0.08	0.03	0.08
10,745.00	91.31	88.00	6,309.65	270.65	4,373.71	4,378.03	1.63	1.63	0.10
10,837.00	90.54	86.64	6,308.17	274.95	4,465.59	4,469.98	1.70	-0.84	-1.48
10,929.00	90.77	87.13	6,307.12	279.95	4,557.45	4,561.92	0.59	0.25	0.53
11,020.00	91.34	87.27	6,305.44	284.39	4,648.32	4,652.86	0.64	0.63	0.15
11,112.00	91.71	87.57	6,302.99	288.53	4,740.20	4,744.79	0.52	0.40	0.33
11,203.00	89.90	87.24	6,301.71	292.65	4,831.09	4,835.75	2.02	-1.99	-0.36
11,295.00	89.36	86.88	6,302.31	297.37	4,922.97	4,927.70	0.71	-0.59	-0.39
11,387.00	90.50	87.72	6,302.42	301.70	5,014.86	5,019.66	1.54	1.24	0.91
11,478.00	91.41	88.09	6,300.90	305.03	5,105.79	5,110.63	1.08	1.00	0.41
11,570.00	91.91	88.08	6,298.24	308.10	5,197.70	5,202.58	0.54	0.54	-0.01
11,662.00	91.95	87.75	6,295.14	311.45	5,289.59	5,294.52	0.36	0.04	-0.36
11,754.00	91.75	89.00	6,292.17	314.06	5,381.50	5,386.46	1.38	-0.22	1.36
11,845.00	90.74	88.86	6,290.19	315.75	5,472.46	5,477.44	1.12	-1.11	-0.15
11,937.00	91.55	88.84	6,288.36	317.60	5,564.42	5,569.42	0.88	0.88	-0.02
12,028.00	90.13	89.18	6,287.02	319.17	5,655.40	5,660.41	1.60	-1.56	0.37
12,120.00	89.70	89.47	6,287.16	320.26	5,747.39	5,752.41	0.56	-0.47	0.32
12,211.00	89.19	90.40	6,288.04	320.36	5,838.38	5,843.39	1.17	-0.56	1.02
12,303.00	87.58	90.28	6,290.63	319.81	5,930.34	5,935.32	1.75	-1.75	-0.13
12,395.00	90.34	89.98	6,292.30	319.61	6,022.32	6,027.27	3.02	3.00	-0.33
12,486.00	91.85	90.54	6,290.56	319.19	6,113.30	6,118.23	1.77	1.66	0.62
12,578.00	90.50	89.00	6,288.68	319.56	6,205.27	6,210.19	2.23	-1.47	-1.67
12,669.00	91.24	88.78	6,287.29	321.32	6,296.25	6,301.18	0.85	0.81	-0.24
12,761.00	91.14	89.54	6,285.38	322.67	6,388.21	6,393.16	0.83	-0.11	0.83
12,852.00	91.58	89.29	6,283.22	323.60	6,479.18	6,484.13	0.56	0.48	-0.27
12,944.00	91.41	88.69	6,280.82	325.22	6,571.14	6,576.10	0.68	-0.18	-0.65
13,036.00	90.67	89.15	6,279.15	326.96	6,663.11	6,668.08	0.95	-0.80	0.50
13,127.00	92.75	89.87	6,276.44	327.73	6,754.06	6,759.03	2.42	2.29	0.79
13,219.00	92.76	89.52	6,272.02	328.22	6,845.95	6,850.92	0.38	0.01	-0.38

<b>Company:</b>	Bill Barrett Corp.	<b>Local Co-ordinate Reference:</b>	Well Anschutz State 05-62-22-3340B2
<b>Project:</b>	Weld County, CO NAD 83	<b>TVD Reference:</b>	GL 4690' & KB 16' @ 4706.00ft (Cade 24)
<b>Site:</b>	Anschutz State 5-62-22 NWSW Pad	<b>MD Reference:</b>	GL 4690' & KB 16' @ 4706.00ft (Cade 24)
<b>Well:</b>	Anschutz State 05-62-22-3340B2	<b>North Reference:</b>	True
<b>Wellbore:</b>	OH	<b>Survey Calculation Method:</b>	Minimum Curvature
<b>Design:</b>	OH	<b>Database:</b>	Casper District

Survey									
Measured Depth (ft)	Inclination (°)	Azimuth (°)	Vertical Depth (ft)	+N/-S (ft)	+E/-W (ft)	Vertical Section (ft)	Dogleg Rate (°/100ft)	Build Rate (°/100ft)	Turn Rate (°/100ft)
13,310.00	90.74	89.70	6,269.24	328.84	6,936.90	6,941.86	2.23	-2.22	0.20
13,402.00	90.74	89.28	6,268.05	329.66	7,028.89	7,033.85	0.46	0.00	-0.46
13,494.00	90.74	90.13	6,266.86	330.14	7,120.88	7,125.84	0.92	0.00	0.92
13,586.00	90.07	91.12	6,266.21	329.13	7,212.87	7,217.79	1.30	-0.73	1.08
13,678.00	90.47	91.57	6,265.78	326.97	7,304.84	7,309.71	0.65	0.43	0.49
13,770.00	89.36	91.27	6,265.91	324.69	7,396.81	7,401.62	1.25	-1.21	-0.33
13,861.00	90.54	90.76	6,265.99	323.08	7,487.80	7,492.55	1.41	1.30	-0.56
13,953.00	89.87	90.49	6,265.66	322.08	7,579.79	7,584.51	0.79	-0.73	-0.29
14,044.00	88.69	88.41	6,266.81	322.95	7,670.77	7,675.50	2.63	-1.30	-2.29
14,135.00	88.42	88.14	6,269.10	325.69	7,761.70	7,766.46	0.42	-0.30	-0.30
14,227.00	90.50	87.69	6,269.97	329.04	7,853.63	7,858.44	2.31	2.26	-0.49
14,318.00	92.15	87.56	6,267.86	332.81	7,944.52	7,949.39	1.82	1.81	-0.14
14,410.00	90.74	87.48	6,265.54	336.79	8,036.41	8,041.33	1.54	-1.53	-0.09
14,502.00	89.36	88.33	6,265.46	340.15	8,128.34	8,133.31	1.76	-1.50	0.92
14,593.00	88.86	88.05	6,266.88	343.02	8,219.29	8,224.29	0.63	-0.55	-0.31
14,685.00	88.08	87.42	6,269.33	346.66	8,311.18	8,316.24	1.09	-0.85	-0.68
14,777.00	89.13	87.03	6,271.57	351.11	8,403.04	8,408.17	1.22	1.14	-0.42
14,869.00	90.81	88.26	6,271.62	354.89	8,494.96	8,500.14	2.26	1.83	1.34
14,960.00	90.40	88.19	6,270.66	357.71	8,585.91	8,591.13	0.46	-0.45	-0.08
15,052.00	91.41	87.21	6,269.21	361.40	8,677.82	8,683.09	1.53	1.10	-1.07
15,143.00	90.81	86.72	6,267.44	366.22	8,768.68	8,774.02	0.85	-0.66	-0.54
15,235.00	91.14	87.42	6,265.88	370.92	8,860.54	8,865.96	0.84	0.36	0.76
15,326.00	91.68	87.04	6,263.64	375.32	8,951.41	8,956.89	0.73	0.59	-0.42
15,417.00	91.17	88.55	6,261.37	378.82	9,042.31	9,047.84	1.75	-0.56	1.66
15,508.00	91.44	88.13	6,259.30	381.45	9,133.25	9,138.82	0.55	0.30	-0.46
15,600.00	90.57	89.15	6,257.69	383.63	9,225.21	9,230.80	1.46	-0.95	1.11
15,694.00	91.17	88.56	6,256.26	385.51	9,319.18	9,324.79	0.90	0.64	-0.63
15,787.00	89.90	88.59	6,255.39	387.82	9,412.14	9,417.78	1.37	-1.37	0.03
15,882.00	90.27	88.44	6,255.25	390.29	9,507.11	9,512.78	0.42	0.39	-0.16
15,976.00	90.03	88.09	6,255.00	393.13	9,601.07	9,606.77	0.45	-0.26	-0.37
16,071.00	90.03	88.15	6,254.95	396.25	9,696.01	9,701.76	0.06	0.00	0.06
16,165.00	89.83	88.71	6,255.07	398.82	9,789.98	9,795.76	0.63	-0.21	0.60
16,260.00	89.90	89.90	6,255.29	399.98	9,884.97	9,890.75	1.25	0.07	1.25
16,323.00	90.13	88.62	6,255.28	400.79	9,947.96	9,953.75	2.06	0.37	-2.03
Last SDI MWD Survey									
16,380.00	90.13	88.62	6,255.15	402.16	10,004.95	10,010.75	0.00	0.00	0.00
Projection to TD									

<b>Company:</b>	Bill Barrett Corp.	<b>Local Co-ordinate Reference:</b>	Well Anschutz State 05-62-22-3340B2
<b>Project:</b>	Weld County, CO NAD 83	<b>TVD Reference:</b>	GL 4690' & KB 16' @ 4706.00ft (Cade 24)
<b>Site:</b>	Anschutz State 5-62-22 NWSW Pad	<b>MD Reference:</b>	GL 4690' & KB 16' @ 4706.00ft (Cade 24)
<b>Well:</b>	Anschutz State 05-62-22-3340B2	<b>North Reference:</b>	True
<b>Wellbore:</b>	OH	<b>Survey Calculation Method:</b>	Minimum Curvature
<b>Design:</b>	OH	<b>Database:</b>	Casper District

Casing Points					
Measured Depth (ft)	Vertical Depth (ft)	Name		Casing Diameter (in)	Hole Diameter (in)
16,380.00	6,255.15	Case15		7.000	7.000

Design Annotations					
Measured Depth (ft)	Vertical Depth (ft)	Local Coordinates		Comment	
		+N/-S (ft)	+E/-W (ft)		
100.00	100.00	-0.04	-0.11	First Gyro Survey	
700.00	699.99	-3.19	-1.03	Last Gyro Survey	
884.00	883.99	-3.11	-1.09	First SDI MWD Survey	
6,566.00	6,340.77	222.21	196.16	Last SDI MWD Curve Survey	
6,695.00	6,342.80	226.58	325.01	First SDI MWD Lateral Survey	
16,323.00	6,255.28	400.79	9,947.96	Last SDI MWD Survey	
16,380.00	6,255.15	402.16	10,004.95	Projection to TD	

Checked By: _____	Approved By: _____	Date: _____
-------------------	--------------------	-------------