

# KERR-MCGEE OIL & GAS ONSHORE LP (WA)

Location: COLORADO Slot: SLOT#06 CARTER 14N-33HZ (825'FNL & 1470'FWL, SEC.33)  
Field: WELD COUNTY (UTM/TRUE NORTH) Well: CARTER 14N-33HZ  
Facility: SEC.33-T2N-R66W Wellbore: CARTER 14N-33HZ PWB

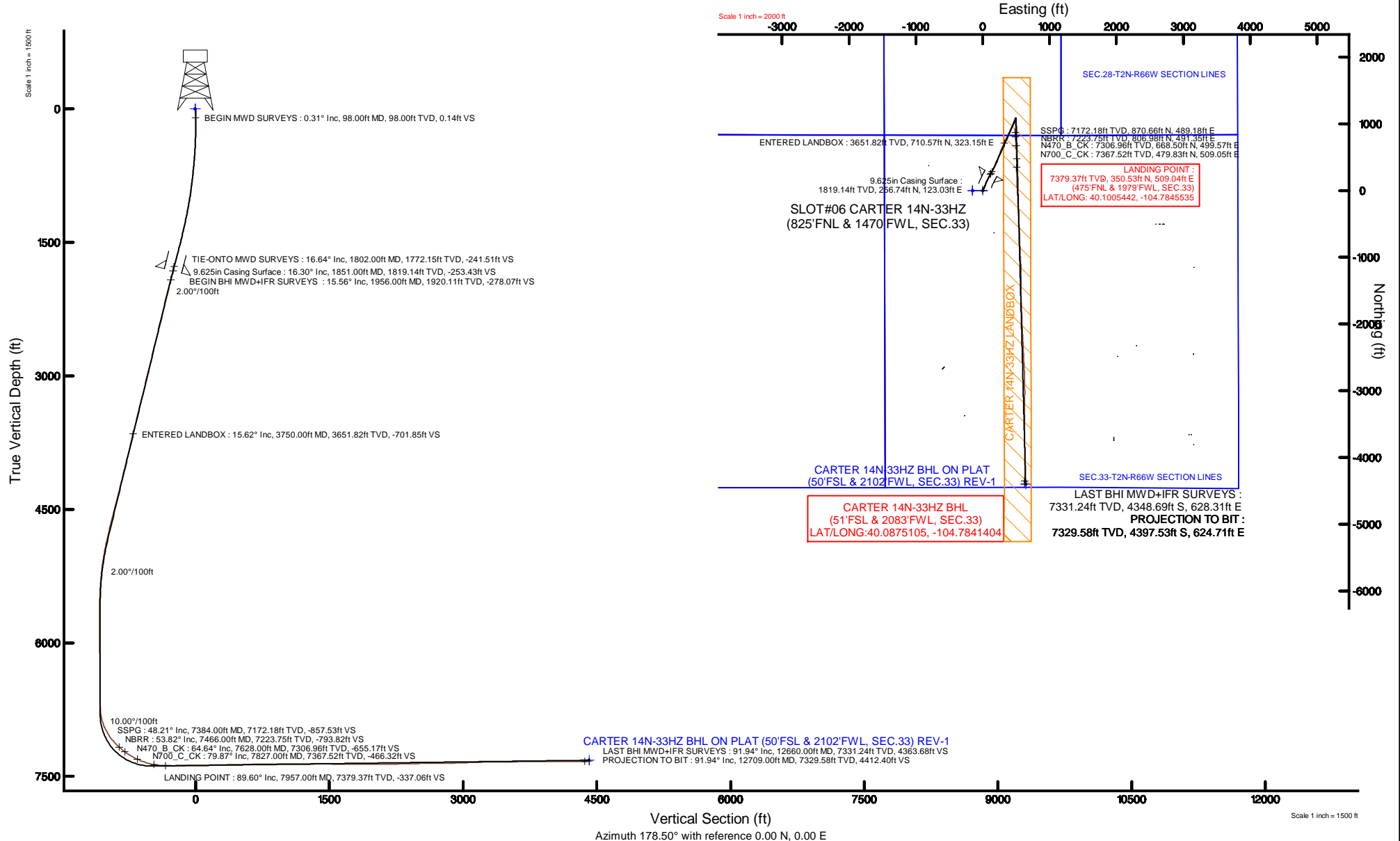



# Actual Wellpath Report

CARTER 14N-33HZ AWP

Page 1 of 6



## REFERENCE WELLPATH IDENTIFICATION

Operator	KERR-MCGEE OIL & GAS ONSHORE LP (WA)	Slot	SLOT#06 CARTER 14N-33HZ (825'FNL & 1470'FWL, SEC.33)
Area	COLORADO	Well	CARTER 14N-33HZ
Field	WELD COUNTY (UTM/TRUE NORTH)	Wellbore	CARTER 14N-33HZ AWB <12709>
Facility	SEC.33-T2N-R66W		

## REPORT SETUP INFORMATION

Projection System	NAD83 / UTM Zone 13 North, US feet	Software System	WellArchitect® 4.0.0
North Reference	True	User	Amarcar
Scale	0.999604	Report Generated	25/Sep/2015 at 14:10
Convergence at slot	0.14° East	Database/Source file	KERR MCGEE UTM/CARTER_14N-33HZ_AWB__12709_.xml

## WELLPATH LOCATION

	Local coordinates		Grid coordinates		Geographic coordinates	
	North[ft]	East[ft]	Easting[US ft]	Northing[US ft]	Latitude	Longitude
Slot Location	-373.39	805.39	1700156.12	14563067.33	40°05'58.495"N	104°47'10.943"W
Facility Reference Pt			1699350.17	14563438.66	40°06'02.185"N	104°47'21.307"W
Field Reference Pt			1698235.31	14552047.82	40°04'09.600"N	104°47'36.000"W

## WELLPATH DATUM

Calculation method	Minimum curvature	XTREME 23 (16'KB) (RKB) to Facility Vertical Datum	4975.00ft
Horizontal Reference Pt	Slot	XTREME 23 (16'KB) (RKB) to Mean Sea Level	4975.00ft
Vertical Reference Pt	XTREME 23 (16'KB) (RKB)	XTREME 23 (16'KB) (RKB) to Mud Line at Slot (SLOT#06 CARTER 14N-33HZ (825'FNL & 1470'FWL, SEC.33))	4975.00ft
MD Reference Pt	XTREME 23 (16'KB) (RKB)	Section Origin	N 0.00, E 0.00 ft
Field Vertical Reference	Mean Sea Level	Section Azimuth	178.50°

## REFERENCE WELLPATH IDENTIFICATION

Operator	KERR-MCGEE OIL & GAS ONSHORE LP (WA)	Slot	SLOT#06 CARTER 14N-33HZ (825'FNL & 1470'FWL, SEC.33)
Area	COLORADO	Well	CARTER 14N-33HZ
Field	WELD COUNTY (UTM/TRUE NORTH)	Wellbore	CARTER 14N-33HZ AWB <12709>
Facility	SEC.33-T2N-R66W		

## WELLPATH DATA (141 stations) † = interpolated/extrapolated station

MD [ft]	Inclination [°]	Azimuth [°]	TVD [ft]	Vert Sect [ft]	North [ft]	East [ft]	Latitude	Longitude	DLS [°/100ft]	Comments
0.00†	0.000	127.860	0.00	0.00	0.00	0.00	40°05'58.495"N	104°47'10.943"W	0.00	
16.00	0.000	127.860	16.00	0.00	0.00	0.00	40°05'58.495"N	104°47'10.943"W	0.00	
98.00	0.310	127.860	98.00	0.14	-0.14	0.18	40°05'58.494"N	104°47'10.941"W	0.38	BEGIN MWD SURVEYS
189.00	0.470	79.970	189.00	0.24	-0.22	0.74	40°05'58.493"N	104°47'10.934"W	0.38	
280.00	1.070	44.460	279.99	-0.40	0.45	1.70	40°05'58.499"N	104°47'10.921"W	0.81	
375.00	2.840	30.080	374.93	-3.03	3.12	3.50	40°05'58.526"N	104°47'10.898"W	1.92	
470.00	3.410	27.310	469.79	-7.51	7.67	5.98	40°05'58.571"N	104°47'10.866"W	0.62	
565.00	5.190	23.420	564.52	-13.88	14.12	8.98	40°05'58.635"N	104°47'10.827"W	1.90	
660.00	6.580	24.360	659.02	-22.67	23.02	12.93	40°05'58.723"N	104°47'10.777"W	1.47	
755.00	6.830	26.210	753.37	-32.57	33.05	17.67	40°05'58.822"N	104°47'10.716"W	0.35	
881.00	8.520	24.260	878.23	-47.61	48.28	24.82	40°05'58.972"N	104°47'10.624"W	1.36	
977.00	9.060	21.400	973.11	-60.98	61.80	30.50	40°05'59.106"N	104°47'10.551"W	0.72	
1103.00	11.160	20.020	1097.14	-81.46	82.50	38.29	40°05'59.310"N	104°47'10.450"W	1.68	
1198.00	12.370	20.160	1190.14	-99.47	100.69	44.95	40°05'59.490"N	104°47'10.365"W	1.27	
1293.00	13.520	22.400	1282.73	-119.08	120.51	52.69	40°05'59.686"N	104°47'10.265"W	1.32	
1388.00	14.530	27.540	1374.90	-139.66	141.34	62.43	40°05'59.892"N	104°47'10.140"W	1.69	
1483.00	16.350	26.280	1466.47	-161.91	163.90	73.86	40°06'00.115"N	104°47'09.993"W	1.95	
1578.00	16.940	25.940	1557.49	-186.02	188.34	85.84	40°06'00.356"N	104°47'09.838"W	0.63	
1673.00	16.590	28.890	1648.45	-210.00	212.66	98.44	40°06'00.597"N	104°47'09.676"W	0.97	
1768.00	16.350	29.120	1739.55	-233.21	236.21	111.50	40°06'00.829"N	104°47'09.508"W	0.26	
1802.00	16.640	29.300	1772.15	-241.51	244.64	116.21	40°06'00.913"N	104°47'09.448"W	0.87	TIE-ONTO MWD SURVEYS
1956.00	15.560	29.940	1920.11	-278.07	281.77	137.31	40°06'01.279"N	104°47'09.176"W	0.71	BEGIN BHI MWD+IFR SURVEYS
2051.00	14.620	27.550	2011.83	-299.42	303.44	149.22	40°06'01.494"N	104°47'09.023"W	1.19	
2146.00	16.070	28.670	2103.45	-321.27	325.61	161.07	40°06'01.713"N	104°47'08.870"W	1.56	
2241.00	15.940	27.650	2194.76	-344.03	348.70	173.43	40°06'01.941"N	104°47'08.711"W	0.33	
2336.00	15.190	26.760	2286.28	-366.38	371.37	185.09	40°06'02.165"N	104°47'08.561"W	0.83	
2431.00	14.800	24.500	2378.04	-388.25	393.52	195.73	40°06'02.384"N	104°47'08.424"W	0.74	
2527.00	16.140	24.810	2470.56	-411.23	416.79	206.41	40°06'02.614"N	104°47'08.287"W	1.40	
2622.00	15.450	22.780	2561.98	-434.61	440.44	216.85	40°06'02.848"N	104°47'08.152"W	0.93	
2717.00	14.320	21.350	2653.79	-456.97	463.05	226.03	40°06'03.071"N	104°47'08.034"W	1.25	
2813.00	13.550	20.040	2746.96	-478.37	484.68	234.21	40°06'03.285"N	104°47'07.929"W	0.87	
2908.00	14.090	18.180	2839.21	-499.61	506.12	241.63	40°06'03.497"N	104°47'07.834"W	0.74	
3003.00	15.150	19.170	2931.14	-522.11	528.83	249.31	40°06'03.721"N	104°47'07.735"W	1.15	
3098.00	14.620	18.940	3022.95	-544.96	551.90	257.28	40°06'03.949"N	104°47'07.632"W	0.56	
3194.00	14.120	19.550	3115.94	-567.24	574.39	265.13	40°06'04.171"N	104°47'07.531"W	0.54	
3289.00	14.940	19.730	3207.90	-589.47	596.84	273.14	40°06'04.393"N	104°47'07.428"W	0.86	
3384.00	16.010	24.030	3299.46	-612.71	620.33	282.61	40°06'04.625"N	104°47'07.306"W	1.65	
3480.00	16.590	24.800	3391.60	-636.94	644.87	293.75	40°06'04.868"N	104°47'07.163"W	0.64	
3575.00	14.750	22.350	3483.07	-660.16	668.37	304.04	40°06'05.100"N	104°47'07.030"W	2.06	
3669.00	15.560	24.820	3573.80	-682.41	690.88	313.88	40°06'05.322"N	104°47'06.904"W	1.10	
3750.00†	15.619	25.555	3651.82	-701.85	710.57	323.15	40°06'05.517"N	104°47'06.785"W	0.25	ENTERED LANDBOX
3765.00	15.630	25.690	3666.27	-705.45	714.22	324.89	40°06'05.553"N	104°47'06.762"W	0.25	
3860.00	13.690	24.560	3758.17	-726.93	735.98	335.12	40°06'05.768"N	104°47'06.630"W	2.06	
3955.00	15.280	26.250	3850.15	-748.11	757.43	345.33	40°06'05.980"N	104°47'06.499"W	1.73	
4050.00	15.340	23.270	3941.78	-770.60	780.20	355.83	40°06'06.205"N	104°47'06.364"W	0.83	

## REFERENCE WELLPATH IDENTIFICATION

Operator	KERR-MCGEE OIL & GAS ONSHORE LP (WA)	Slot	SLOT#06 CARTER 14N-33HZ (825'FNL & 1470'FWL, SEC.33)
Area	COLORADO	Well	CARTER 14N-33HZ
Field	WELD COUNTY (UTM/TRUE NORTH)	Wellbore	CARTER 14N-33HZ AWP <12709>
Facility	SEC.33-T2N-R66W		

## WELLPATH DATA (141 stations) † = interpolated/extrapolated station

MD [ft]	Inclination [°]	Azimuth [°]	TVD [ft]	Vert Sect [ft]	North [ft]	East [ft]	Latitude	Longitude	DLS [°/100ft]	Comments
4146.00	14.780	21.780	4034.48	-793.38	803.24	365.39	40°06'06.433"N	104°47'06.241"W	0.71	
4241.00	15.970	27.420	4126.08	-815.95	826.09	375.90	40°06'06.659"N	104°47'06.106"W	2.01	
4336.00	16.950	27.050	4217.19	-839.55	850.03	388.22	40°06'06.895"N	104°47'05.947"W	1.04	
4431.00	15.930	25.410	4308.30	-863.34	874.14	400.11	40°06'07.133"N	104°47'05.794"W	1.18	
4526.00	14.210	23.540	4400.03	-885.53	896.60	410.36	40°06'07.355"N	104°47'05.662"W	1.88	
4622.00	15.650	24.610	4492.79	-907.84	919.18	420.46	40°06'07.578"N	104°47'05.532"W	1.53	
4717.00	16.290	24.650	4584.12	-931.30	942.94	431.35	40°06'07.813"N	104°47'05.392"W	0.67	
4812.00	15.280	23.810	4675.54	-954.58	966.50	441.96	40°06'08.046"N	104°47'05.255"W	1.09	
4907.00	14.510	23.440	4767.35	-976.68	988.87	451.75	40°06'08.267"N	104°47'05.129"W	0.82	
5003.00	13.760	22.570	4860.44	-998.01	1010.45	460.92	40°06'08.480"N	104°47'05.011"W	0.81	
5098.00	11.300	20.790	4953.17	-1016.94	1029.59	468.56	40°06'08.669"N	104°47'04.913"W	2.62	
5193.00	9.990	18.820	5046.53	-1033.28	1046.09	474.52	40°06'08.833"N	104°47'04.836"W	1.43	
5288.00	7.720	18.410	5140.40	-1047.01	1059.95	479.20	40°06'08.969"N	104°47'04.776"W	2.39	
5384.00	5.950	17.570	5235.71	-1057.78	1070.81	482.73	40°06'09.077"N	104°47'04.731"W	1.85	
5479.00	4.760	15.960	5330.29	-1066.19	1079.29	485.31	40°06'09.161"N	104°47'04.698"W	1.26	
5574.00	3.020	23.370	5425.07	-1072.22	1085.38	487.38	40°06'09.221"N	104°47'04.671"W	1.90	
5670.00	1.090	51.230	5521.01	-1075.07	1088.27	489.10	40°06'09.249"N	104°47'04.649"W	2.21	
5765.00	0.950	44.700	5615.99	-1076.16	1089.40	490.36	40°06'09.261"N	104°47'04.633"W	0.19	
5860.00	0.560	32.830	5710.98	-1077.09	1090.35	491.16	40°06'09.270"N	104°47'04.622"W	0.44	
5956.00	0.000	8.360	5806.98	-1077.48	1090.74	491.42	40°06'09.274"N	104°47'04.619"W	0.58	
6051.00	0.280	190.490	5901.98	-1077.25	1090.51	491.37	40°06'09.272"N	104°47'04.620"W	0.29	
6146.00	0.650	178.770	5996.98	-1076.49	1089.75	491.34	40°06'09.264"N	104°47'04.620"W	0.40	
6242.00	1.230	176.250	6092.97	-1074.91	1088.17	491.42	40°06'09.248"N	104°47'04.619"W	0.61	
6337.00	1.280	182.660	6187.94	-1072.83	1086.10	491.44	40°06'09.228"N	104°47'04.619"W	0.16	
6432.00	0.150	311.000	6282.94	-1071.86	1085.12	491.30	40°06'09.218"N	104°47'04.621"W	1.45	
6528.00	0.300	324.970	6378.93	-1072.15	1085.41	491.06	40°06'09.221"N	104°47'04.624"W	0.17	
6623.00	0.460	350.030	6473.93	-1072.74	1085.99	490.85	40°06'09.227"N	104°47'04.626"W	0.24	
6719.00	0.480	326.070	6569.93	-1073.46	1086.70	490.56	40°06'09.234"N	104°47'04.630"W	0.20	
6813.00	1.960	194.570	6663.91	-1072.25	1085.47	489.93	40°06'09.222"N	104°47'04.638"W	2.45	
6909.00	3.710	169.470	6759.80	-1067.60	1080.83	490.09	40°06'09.176"N	104°47'04.636"W	2.19	
7004.00	13.690	172.400	6853.58	-1053.35	1066.63	492.14	40°06'09.036"N	104°47'04.610"W	10.51	
7099.00	22.990	179.290	6943.67	-1023.55	1036.86	493.86	40°06'08.741"N	104°47'04.588"W	10.04	
7195.00	31.930	184.340	7028.78	-979.46	992.71	492.17	40°06'08.305"N	104°47'04.609"W	9.62	
7290.00	40.820	181.710	7105.20	-923.35	936.51	489.34	40°06'07.750"N	104°47'04.646"W	9.50	
7384.00†	48.211	178.758	7172.18	-857.53	870.66	489.18	40°06'07.099"N	104°47'04.648"W	8.16	SSPG
7385.00	48.290	178.730	7172.85	-856.79	869.92	489.19	40°06'07.092"N	104°47'04.648"W	8.16	
7466.00†	53.822	177.392	7223.75	-793.82	806.98	491.35	40°06'06.470"N	104°47'04.620"W	6.95	NBRR
7480.00	54.780	177.180	7231.91	-782.45	795.63	491.89	40°06'06.357"N	104°47'04.613"W	6.95	
7576.00	60.740	176.350	7283.10	-701.33	714.60	496.49	40°06'05.557"N	104°47'04.554"W	6.25	
7628.00†	64.637	176.007	7306.96	-655.17	668.50	499.57	40°06'05.101"N	104°47'04.514"W	7.52	N470_B_CK
7671.00	67.860	175.740	7324.28	-615.86	629.25	502.41	40°06'04.713"N	104°47'04.478"W	7.52	
7766.00	75.200	177.790	7354.36	-525.86	539.36	507.45	40°06'03.825"N	104°47'04.413"W	7.99	
7827.00†	79.867	179.131	7367.52	-466.32	479.83	509.05	40°06'03.237"N	104°47'04.392"W	7.95	N700_C_CK
7861.00	82.470	179.860	7372.74	-432.73	446.24	509.34	40°06'02.905"N	104°47'04.388"W	7.95	
7957.00	89.600	180.500	7379.37	-337.06	350.53	509.04	40°06'01.959"N	104°47'04.392"W	7.46	LANDING POINT

## REFERENCE WELLPATH IDENTIFICATION

Operator	KERR-MCGEE OIL & GAS ONSHORE LP (WA)	Slot	SLOT#06 CARTER 14N-33HZ (825'FNL & 1470'FWL, SEC.33)
Area	COLORADO	Well	CARTER 14N-33HZ
Field	WELD COUNTY (UTM/TRUE NORTH)	Wellbore	CARTER 14N-33HZ AWB <12709>
Facility	SEC.33-T2N-R66W		

## WELLPATH DATA (141 stations)

MD [ft]	Inclination [°]	Azimuth [°]	TVD [ft]	Vert Sect [ft]	North [ft]	East [ft]	Latitude	Longitude	DLS [°/100ft]	Comments
8052.00	88.490	179.180	7380.96	-242.10	255.55	509.30	40°06'01.020"N	104°47'04.389"W	1.82	
8147.00	91.290	178.270	7381.14	-147.12	160.59	511.42	40°06'00.082"N	104°47'04.362"W	3.10	
8243.00	91.230	177.230	7379.03	-51.15	64.68	515.19	40°05'59.134"N	104°47'04.313"W	1.08	
8338.00	90.950	177.170	7377.22	43.81	-30.19	519.83	40°05'58.197"N	104°47'04.254"W	0.30	
8433.00	90.930	177.170	7375.66	138.77	-125.06	524.51	40°05'57.259"N	104°47'04.193"W	0.02	
8528.00	91.170	177.180	7373.92	233.73	-219.93	529.20	40°05'56.322"N	104°47'04.133"W	0.25	
8623.00	91.910	177.240	7371.37	328.67	-314.78	533.82	40°05'55.384"N	104°47'04.074"W	0.78	
8718.00	91.230	177.210	7368.77	423.61	-409.63	538.42	40°05'54.447"N	104°47'04.015"W	0.72	
8814.00	90.490	177.370	7367.33	519.58	-505.51	542.95	40°05'53.499"N	104°47'03.956"W	0.79	
8909.00	91.170	176.940	7365.95	614.54	-600.38	547.67	40°05'52.562"N	104°47'03.896"W	0.85	
9005.00	90.890	178.570	7364.22	710.51	-696.29	551.43	40°05'51.614"N	104°47'03.847"W	1.72	
9100.00	91.360	178.070	7362.36	805.50	-791.23	554.21	40°05'50.676"N	104°47'03.811"W	0.72	
9195.00	89.810	177.630	7361.39	900.48	-886.16	557.78	40°05'49.738"N	104°47'03.766"W	1.70	
9290.00	89.570	176.990	7361.90	995.46	-981.05	562.24	40°05'48.800"N	104°47'03.708"W	0.72	
9385.00	89.050	176.470	7363.05	1090.41	-1075.89	567.65	40°05'47.863"N	104°47'03.639"W	0.77	
9480.00	90.740	178.010	7363.22	1185.38	-1170.77	572.23	40°05'46.925"N	104°47'03.580"W	2.41	
9576.00	91.350	179.900	7361.47	1281.35	-1266.73	573.98	40°05'45.977"N	104°47'03.557"W	2.07	
9671.00	90.890	180.330	7359.61	1376.30	-1361.72	573.79	40°05'45.038"N	104°47'03.560"W	0.66	
9767.00	89.050	180.020	7359.66	1472.25	-1457.71	573.50	40°05'44.090"N	104°47'03.563"W	1.94	
9862.00	89.200	179.460	7361.11	1567.22	-1552.70	573.93	40°05'43.151"N	104°47'03.558"W	0.61	
9957.00	89.080	179.050	7362.54	1662.20	-1647.68	575.16	40°05'42.212"N	104°47'03.542"W	0.45	
10053.00	88.490	177.490	7364.58	1758.17	-1743.61	578.06	40°05'41.264"N	104°47'03.505"W	1.74	
10148.00	90.800	178.210	7365.16	1853.16	-1838.53	581.62	40°05'40.326"N	104°47'03.459"W	2.55	
10243.00	91.420	178.190	7363.32	1948.14	-1933.47	584.61	40°05'39.388"N	104°47'03.421"W	0.65	
10338.00	89.690	176.690	7362.40	2043.11	-2028.36	588.85	40°05'38.450"N	104°47'03.366"W	2.41	
10433.00	89.850	176.870	7362.78	2138.07	-2123.21	594.18	40°05'37.513"N	104°47'03.297"W	0.25	
10528.00	91.600	177.190	7361.58	2233.02	-2218.07	599.11	40°05'36.576"N	104°47'03.234"W	1.87	
10624.00	92.060	177.210	7358.52	2328.95	-2313.91	603.79	40°05'35.629"N	104°47'03.174"W	0.48	
10719.00	90.460	177.720	7356.43	2423.91	-2408.79	607.99	40°05'34.691"N	104°47'03.120"W	1.77	
10814.00	90.890	177.290	7355.31	2518.89	-2503.69	612.13	40°05'33.753"N	104°47'03.067"W	0.64	
10909.00	90.740	176.040	7353.96	2613.83	-2598.52	617.66	40°05'32.816"N	104°47'02.996"W	1.33	
11004.00	90.400	178.330	7353.01	2708.79	-2693.40	622.32	40°05'31.878"N	104°47'02.936"W	2.44	
11100.00	90.490	177.870	7352.27	2804.79	-2789.34	625.50	40°05'30.930"N	104°47'02.895"W	0.49	
11195.00	91.600	179.470	7350.53	2899.77	-2884.29	627.71	40°05'29.992"N	104°47'02.866"W	2.05	
11290.00	92.250	179.250	7347.34	2994.70	-2979.23	628.77	40°05'29.054"N	104°47'02.853"W	0.72	
11385.00	91.480	180.790	7344.25	3089.61	-3074.18	628.73	40°05'28.115"N	104°47'02.853"W	1.81	
11480.00	91.970	180.590	7341.39	3184.50	-3169.13	627.59	40°05'27.177"N	104°47'02.868"W	0.56	
11575.00	90.460	180.450	7339.38	3279.42	-3264.10	626.73	40°05'26.239"N	104°47'02.879"W	1.60	
11669.00	90.430	180.810	7338.65	3373.35	-3358.09	625.70	40°05'25.310"N	104°47'02.892"W	0.38	
11765.00	90.400	181.070	7337.95	3469.26	-3454.08	624.12	40°05'24.361"N	104°47'02.913"W	0.27	
11859.00	91.290	179.250	7336.57	3563.20	-3548.06	623.86	40°05'23.432"N	104°47'02.916"W	2.16	
11955.00	91.200	178.700	7334.48	3659.18	-3644.02	625.58	40°05'22.484"N	104°47'02.894"W	0.58	
12050.00	91.080	178.850	7332.59	3754.16	-3738.98	627.61	40°05'21.546"N	104°47'02.868"W	0.20	
12145.00	89.480	179.540	7332.13	3849.15	-3833.97	628.94	40°05'20.607"N	104°47'02.851"W	1.83	
12241.00	89.170	178.190	7333.26	3945.14	-3929.94	630.84	40°05'19.659"N	104°47'02.826"W	1.44	

## REFERENCE WELLPATH IDENTIFICATION

Operator	KERR-MCGEE OIL & GAS ONSHORE LP (WA)	Slot	SLOT#06 CARTER 14N-33HZ (825'FNL & 1470'FWL, SEC.33)
Area	COLORADO	Well	CARTER 14N-33HZ
Field	WELD COUNTY (UTM/TRUE NORTH)	Wellbore	CARTER 14N-33HZ AWB <12709>
Facility	SEC.33-T2N-R66W		

## WELLPATH DATA (141 stations)

MD [ft]	Inclination [°]	Azimuth [°]	TVD [ft]	Vert Sect [ft]	North [ft]	East [ft]	Latitude	Longitude	DLS [°/100ft]	Comments
12336.00	90.550	179.520	7333.49	4040.13	-4024.92	632.74	40°05'18.720"N	104°47'02.802"W	2.02	
12431.00	89.230	178.660	7333.67	4135.12	-4119.90	634.25	40°05'17.781"N	104°47'02.783"W	1.66	
12526.00	90.650	180.790	7333.77	4230.09	-4214.89	634.70	40°05'16.843"N	104°47'02.777"W	2.69	
12621.00	91.140	183.690	7332.29	4324.87	-4309.80	630.99	40°05'15.905"N	104°47'02.825"W	3.10	
12660.00	91.940	184.210	7331.24	4363.68	-4348.69	628.31	40°05'15.520"N	104°47'02.859"W	2.45	LAST BHI MWD+IFR SURVEYS
12709.00	91.940	184.210	7329.58	4412.40	-4397.53	624.71	40°05'15.038"N	104°47'02.905"W	0.00	PROJECTION TO BIT

## HOLE & CASING SECTIONS - Ref Wellbore: CARTER 14N-33HZ AWB <12709> Ref Wellpath: CARTER 14N-33HZ AWP

String/Diameter	Start MD [ft]	End MD [ft]	Interval [ft]	Start TVD [ft]	End TVD [ft]	Start N/S [ft]	Start E/W [ft]	End N/S [ft]	End E/W [ft]
13.5in Open Hole	16.00	1861.00	1845.00	16.00	1828.74	0.00	0.00	259.18	124.41
9.625in Casing Surface	16.00	1851.00	1835.00	16.00	1819.14	0.00	0.00	256.74	123.03
7.875in Open Hole	1861.00	12709.00	10848.00	1828.74	7329.58	259.18	124.41	-4397.53	624.71

## TARGETS

Name	TVD [ft]	North [ft]	East [ft]	Grid East [US ft]	Grid North [US ft]	Latitude	Longitude	Shape
SEC.28-T2N-R66W SECTION LINES	0.00	0.38	-149.93	1700006.25	14563067.36	40°05'58.499"N	104°47'12.872"W	polygon
SEC.32-T2N-R66W SECTION LINES	0.00	0.38	-149.93	1700006.25	14563067.36	40°05'58.499"N	104°47'12.872"W	polygon
SEC.33-T2N-R66W SECTION LINES	0.00	0.38	-149.93	1700006.25	14563067.36	40°05'58.499"N	104°47'12.872"W	polygon
CARTER 14N-33HZ BHL ON PLAT (50'FSL & 2102'FWL, SEC.33) REV-1	7319.00	-4398.08	643.29	1700809.71	14558672.56	40°05'15.032"N	104°47'02.666"W	point
CARTER 14N-33HZ LANDBOX	7319.00	0.00	0.00	1700156.12	14563067.33	40°05'58.495"N	104°47'10.943"W	polygon
SEC.29-T2N-R66W SECTION LINES	7524.00	5793.98	-3831.30	1696312.45	14568849.79	40°06'55.749"N	104°48'00.257"W	polygon

## WELLPATH COMPOSITION - Ref Wellbore: CARTER 14N-33HZ AWB <12709> Ref Wellpath: CARTER 14N-33HZ AWP

Start MD [ft]	End MD [ft]	Positional Uncertainty Model	Log Name/Comment	Wellbore
16.00	1802.00	Custom APC_ISCWSA REV 2 MWD	SCIENTIFIC DRILLING MWD SURVEYS <98-1802>	CARTER 14N-33HZ AWB <12709>
1802.00	12660.00	Custom APC_ISCWSA REV 2 MWD+IFR1+SC (approximation)	BHI MWD+IFR SURVES 7.875" <1956-12660>	CARTER 14N-33HZ AWB <12709>
12660.00	12709.00	Blind Drilling (std)	Projection to bit	CARTER 14N-33HZ AWB <12709>



# Actual Wellpath Report

CARTER 14N-33HZ AWP

Page 6 of 6



## REFERENCE WELLPATH IDENTIFICATION

Operator	KERR-MCGEE OIL & GAS ONSHORE LP (WA)	Slot	SLOT#06 CARTER 14N-33HZ (825'FNL & 1470'FWL, SEC.33)
Area	COLORADO	Well	CARTER 14N-33HZ
Field	WELD COUNTY (UTM/TRUE NORTH)	Wellbore	CARTER 14N-33HZ AWB <12709>
Facility	SEC.33-T2N-R66W		

## WELLPATH COMMENTS

MD [ft]	Inclination [°]	Azimuth [°]	TVD [ft]	Comment
98.00	0.310	127.860	98.00	BEGIN MWD SURVEYS
1802.00	16.640	29.300	1772.15	TIE-ONTO MWD SURVEYS
1956.00	15.560	29.940	1920.11	BEGIN BHI MWD+IFR SURVEYS
3750.00	15.619	25.555	3651.82	ENTERED LANDBOX
7384.00	48.211	178.758	7172.18	SSPG
7466.00	53.822	177.392	7223.75	NBRR
7628.00	64.637	176.007	7306.96	N470_B_CK
7827.00	79.867	179.131	7367.52	N700_C_CK
7957.00	89.600	180.500	7379.37	LANDING POINT
12660.00	91.940	184.210	7331.24	LAST BHI MWD+IFR SURVEYS
12709.00	91.940	184.210	7329.58	PROJECTION TO BIT