

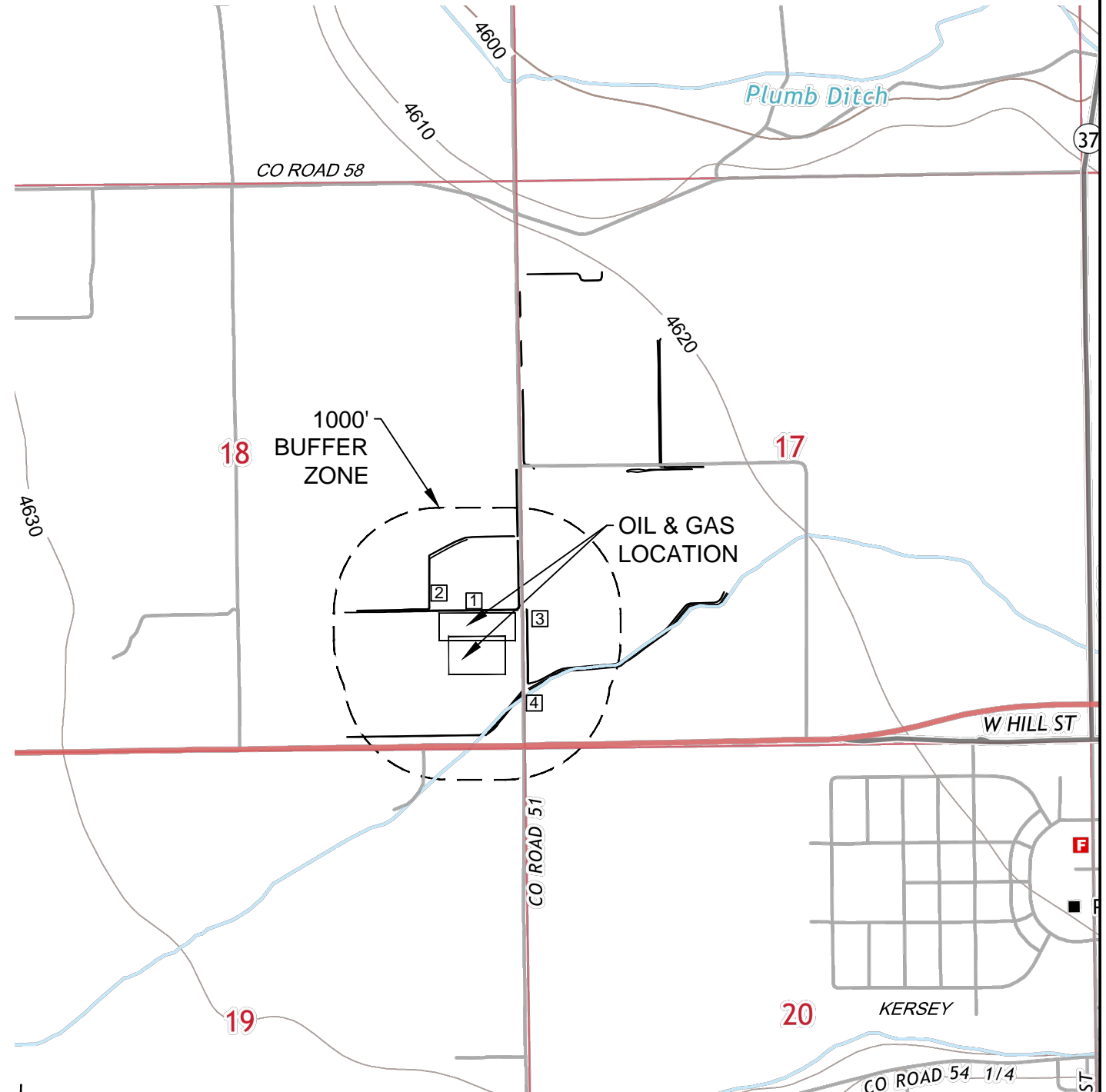

Washburn Land Surveying
www.WashburnSurveying.com
970-232-9645

HYDROLOGY MAP GILLHAM 5N64W18XY PAD

SECTION: 18
TOWNSHIP: 5N
RANGE: 64W
6TH P.M.
WELD COUNTY, CO



DISTANCES BELOW MEASURED FROM THE PROPOSED EDGE OF
DISTURBANCE OF THE OIL AND GAS LOCATION

- 1 DITCH: 19' N (NEAREST DOWN GRADIENT WATER FEATURE)
- 2 DITCH: 103' NW
- 3 DITCH: 107' E
- 4 DITCH: 228' SE