

PAD GRADING PLAN

SECTION 20, TOWNSHIP 9 NORTH, RANGE 56 WEST, 6TH P.M.

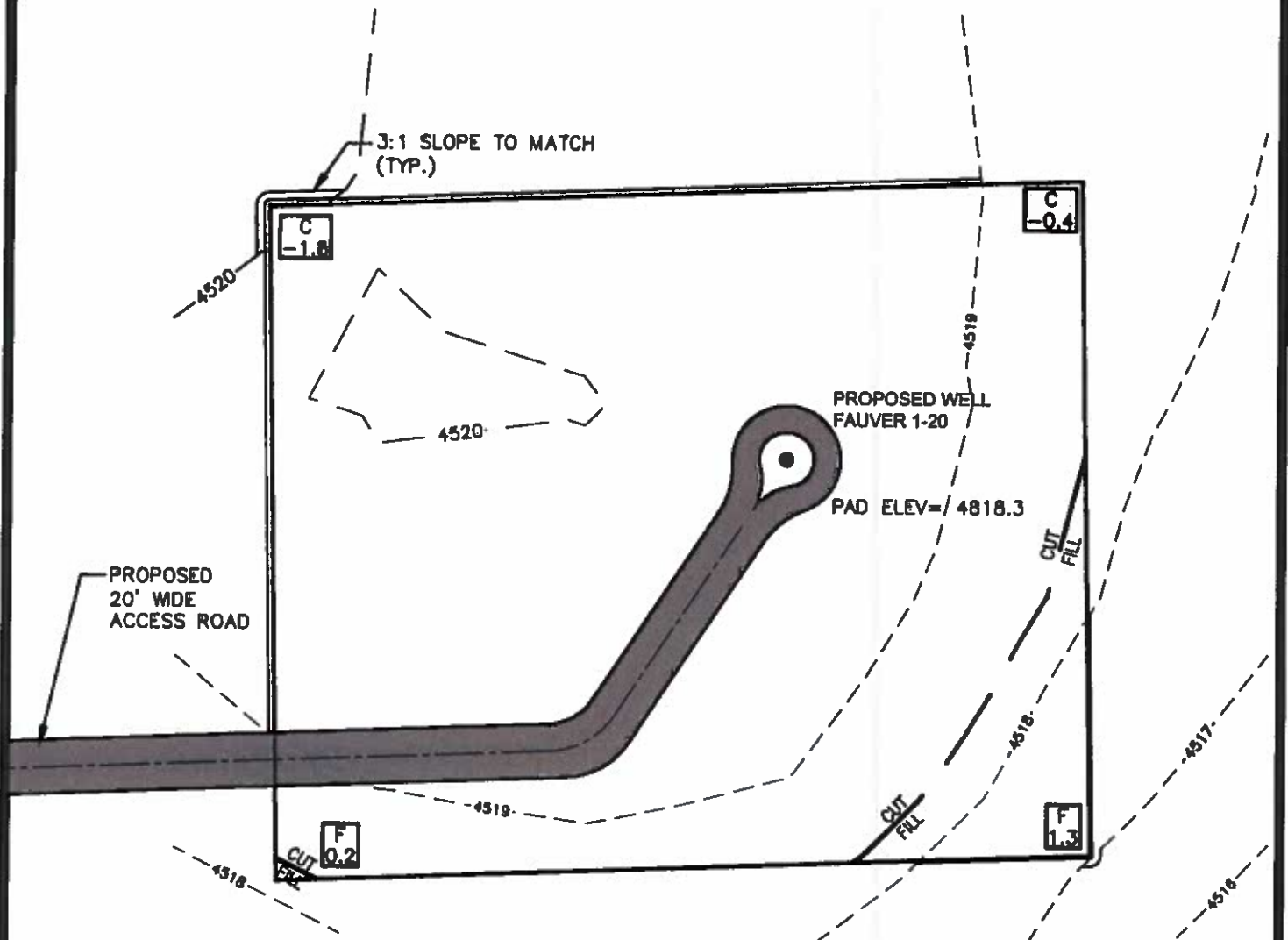

LEGEND

- 4681 --- EXISTING CONTOUR LINE
- PROPOSED CONTOUR LINE
- PROPOSED WELL
- C
0.0 DEPTH OF CUT (C) OR FILL (F)

QUANTITIES

TOPSOIL (12") = 2776 CU.YD.
 TOTAL CUT = 750 CU.YD.
 TOTAL FILL = 713 CU.YD.
 NET CUT = 37 CU.YD.

NOTES:

1. THIS EXHIBIT IS INTENDED ONLY TO DEPICT EARTHWORK QUANTITIES, AND IS NOT TO BE USED FOR ANY OTHER PURPOSE.
2. ELEVATIONS BASED ON GPS GRID OBSERVATION AT THE PROPOSED WELL LOCATIONS

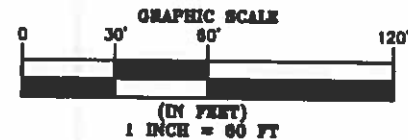

SURVEYING AND MAPPING LLC (SAM)
 555 Zeng St, Suite 210
 Lakewood CO, 80228
 Ph: (303) 988-5852
 Fax: (303) 988-2185
 EMAIL: SAM@SAM.BIZ

FAUVER #1-20 (VERTICAL)

LOCATION:

SEC. 20, T9N, R56W, 6TH P.M.
 WELD COUNTY, COLORADO

DRAWN BY:
 JAH

CHECKED BY:
 T. CARLSON

SHEET No.
 1 OF 1

FIELD DATE

NA

EXHIBIT DATE
 09/22/2015

SCALE:
 1" = 60'

PROJ. No.
 35209

Dwg. No.
 FAUVER #1-20 GRADING PLAN.dwg