

# Great Western Operating Company, LLC

**Location** Colorado  
**Field** Wattenberg  
**Installation** Kodak North

**Slot** Slot SG - Kodak North FD 27-182HN  
**Well** Kodak North FD 27-182HN  
**Wellbore** Kodak North FD 27-182HN (PWB)

Created by admin  
Date plotted 4-Nov-2015

Plot reference is Kodak North FD 27-182HN (PWB).  
Ref wellpath is Kodak North FD 27-182HN (PWP#1).  
Coordinates are in Feet reference Slot SG - Kodak North FD 27-182HN.  
True Vertical Depths are reference Rig Datum.  
Measured Depths are reference Rig Datum.  
Rig Datum: Planned Datum #1  
Rig Datum to Mean Sea Level: 4776.30 ft.  
Plot North is aligned to TRUE North.

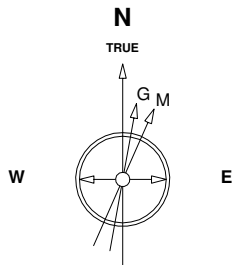

5-Mar-2015  
IGRF Model [1900.0-2020.0] Dip: 66.94 deg Field: 52675.2 nT  
Lat: N40 27 32.4396 Long: W104 51 49.7592 Elev: 4760.10 ft  
Magnetic North is 8.51 deg East of TRUE North  
To correct azimuth from Magnetic to TRUE add 8.51 deg

Scale 1 cm = 400 ft

East (Feet) ->

-9600 -8800 -8000 -7200 -6400 -5600 -4800 -4000 -3200 -2400 -1600 -800 0 800 1600

3200

2400

1600

800

0

-800

-1600

-2400

-3200

-4000

-4800

<- North(Feet)

Scale 1 cm = 400 ft

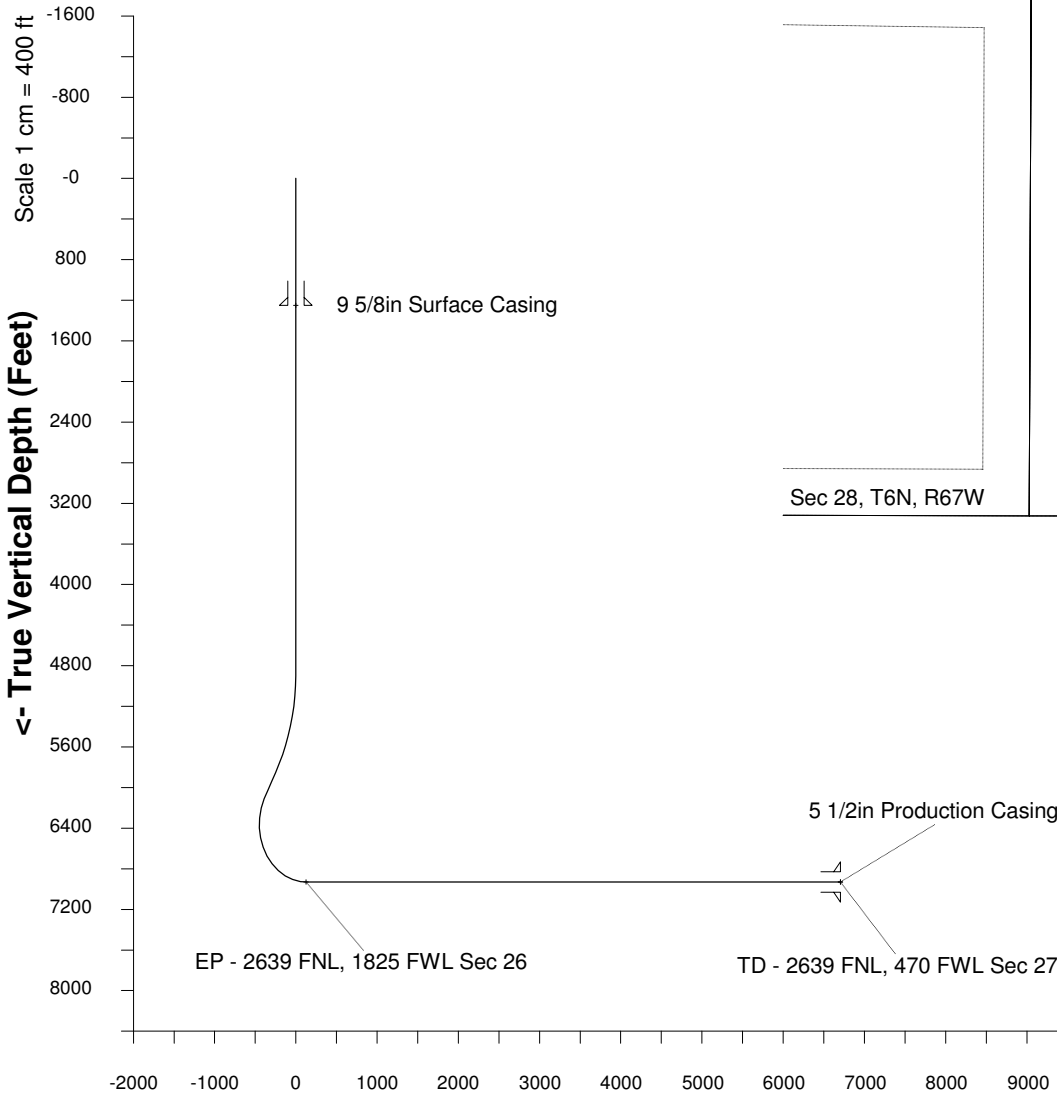

Scale 1 cm = 500 ft

Vertical Section (Feet) ->

Azimuth 267.46 with reference 0.00 N, 0.00 E from Slot SG - Kodak North FD 27-182HN

## WELL PROFILE DATA

Point	MD	Inc	Azi	TVD	North	East	deg/100ft	V. Sect
Tie on	16.20	0.00	0.00	16.20	S 0.00	W 0.00		-0.00
KOP	4876.00	0.00	108.62	4876.00	S 0.00	W 0.00	0.00	-0.00
End of Build	5877.94	30.06	108.62	5832.61	S 82.02	E 243.39	9.84	-239.52
End of Hold	6186.22	30.06	108.62	6099.43	S 131.34	E 389.72	0.00	-383.52
Target EP - 2...Sec 26	7369.42	90.00	269.91	6930.00	S 286.35	W 114.42	32.81	126.98
T.D. & Target TD ... 27	13951.66	90.00	269.91	6930.00	S 296.73	W 6696.65	0.00	6703.22