

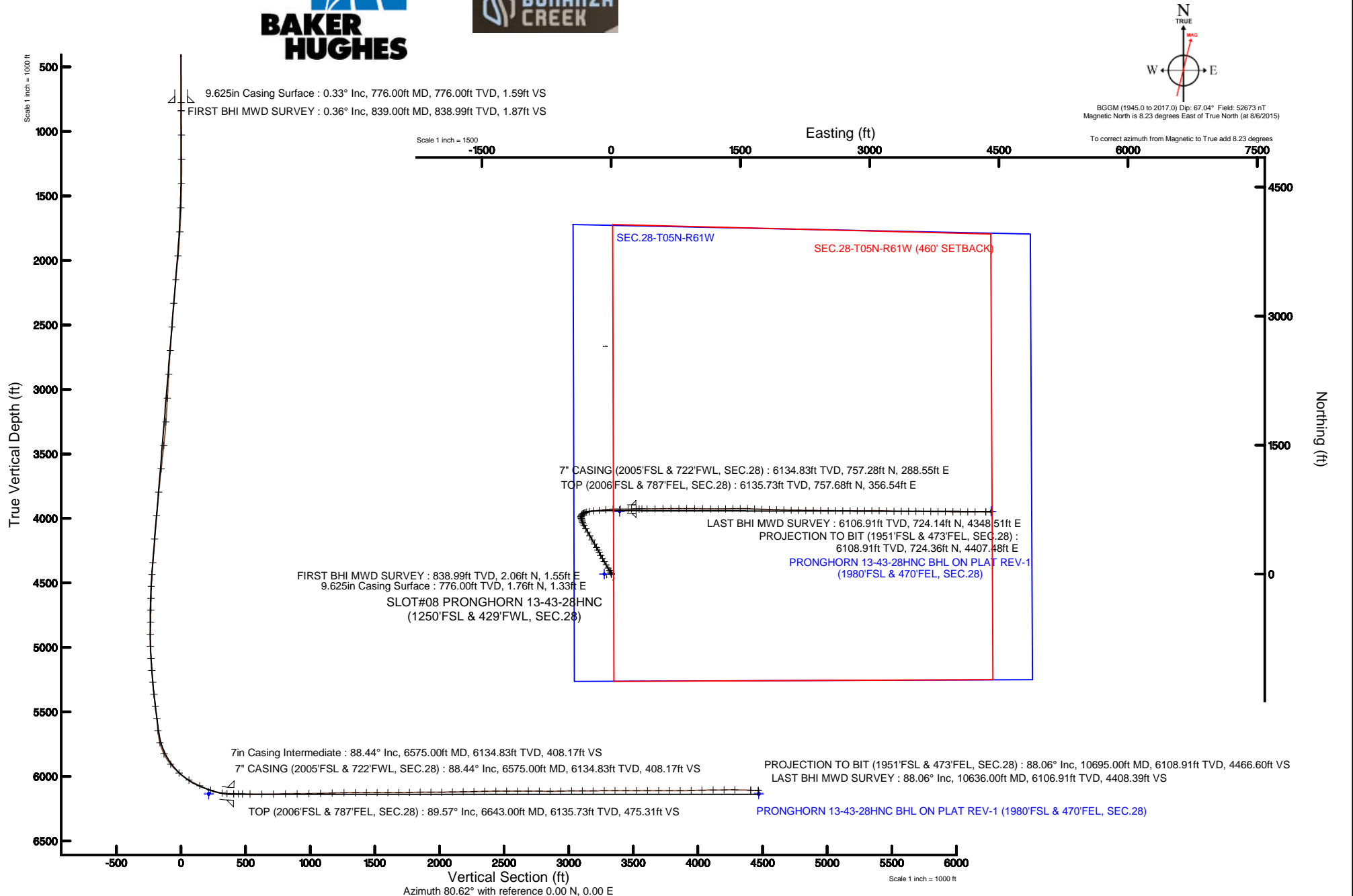

True vertical depths are referenced to XTREME 20 (17.2KB) (RKB)	Grid System: NAD83 / Lambert Colorado SP, Northern Zone (501), US feet
Measured depths are referenced to XTREME 20 (17.2KB) (RKB)	North Reference: True north
XTREME 20 (17.2KB) (RKB) to Mean Sea Level: 4614.2 feet	Scale: True distance
Mean Sea Level to Mud line (At Slot: SLOT#08 PRONGHORN 13-43-28HNC (1250'FSL & 429'FWL, SEC.28): 0 feet	Depths are in feet
Coordinates are in feet referenced to Slot	Created by: ingmajm on 10/30/2015

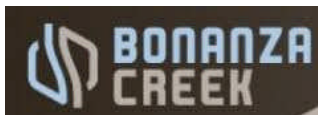



Actual Wellpath Report

PRONGHORN 13-43-28HNC AWP

Page 1 of 5



REFERENCE WELLPATH IDENTIFICATION

Operator	BONANZA CREEK OIL COMPANY	Slot	SLOT#08 PRONGHORN 13-43-28HNC (1250'FSL & 429'FWL, SEC.28)
Area	COLORADO	Well	PRONGHORN 13-43-28HNC
Field	WELD COUNTY	Wellbore	PRONGHORN 13-43-28HNC AWB
Facility	SEC.28-T5N-R61W		

REPORT SETUP INFORMATION

Projection System	NAD83 / Lambert Colorado SP, Northern Zone (501), US feet	Software System	WellArchitect® 4.1.1
North Reference	True	User	Ingmjmr
Scale	0.999959	Report Generated	10/30/2015 at 9:59:27 AM
Convergence at slot	0.83° East	Database/Source file	WA_DEN_Denver_Defn/PRONGHORN_13-43-28HNC_AWB.xml

WELLPATH LOCATION

	Local coordinates		Grid coordinates		Geographic coordinates	
	North[ft]	East[ft]	Easting[US ft]	Northing[US ft]	Latitude	Longitude
Slot Location	-2648.54	47.37	3356077.93	1379472.45	40°22'04.836"N	104°13'19.380"W
Facility Reference Pt			3355992.41	1382119.92	40°22'31.008"N	104°13'19.992"W
Field Reference Pt			3335925.10	1457282.25	40°34'56.460"N	104°17'26.016"W

WELLPATH DATUM

Calculation method	Minimum curvature	XTREME 20 (17.2'KB) (RKB) to Facility Vertical Datum	4614.20ft
Horizontal Reference Pt	Slot	XTREME 20 (17.2'KB) (RKB) to Mean Sea Level	4614.20ft
Vertical Reference Pt	XTREME 20 (17.2'KB) (RKB)	XTREME 20 (17.2'KB) (RKB) to Mud Line at Slot (SLOT#08 PRONGHORN 13-43-28HNC (1250'FSL & 429'FWL, SEC.28))	4614.20ft
MD Reference Pt	XTREME 20 (17.2'KB) (RKB)	Section Origin	N 0.00, E 0.00 ft
Field Vertical Reference	Mean Sea Level	Section Azimuth	80.62°



Actual Wellpath Report

PRONGHORN 13-43-28HNC AWP

Page 2 of 5



REFERENCE WELLPATH IDENTIFICATION

Operator	BONANZA CREEK OIL COMPANY	Slot	SLOT#08 PRONGHORN 13-43-28HNC (1250'FSL & 429'FWL, SEC.28)
Area	COLORADO	Well	PRONGHORN 13-43-28HNC
Field	WELD COUNTY	Wellbore	PRONGHORN 13-43-28HNC AWB
Facility	SEC.28-T5N-R61W		

WELLPATH DATA (95 stations) † = interpolated/extrapolated station

MD [ft]	Inclination [°]	Azimuth [°]	TVD [ft]	Vert Sect [ft]	North [ft]	East [ft]	DLS [°/100ft]	Comments
0.00†	0.000	37.020	0.00	0.00	0.00	0.00	0.00	
17.20	0.000	37.020	17.20	0.00	0.00	0.00	0.00	
839.00	0.360	37.020	838.99	1.87	2.06	1.55	0.04	FIRST BHI MWD SURVEY
1028.00	0.420	59.150	1027.99	2.94	2.89	2.51	0.09	
1216.00	0.370	55.620	1215.99	4.14	3.59	3.60	0.03	
1405.00	3.330	338.890	1404.88	3.57	9.05	2.13	1.73	
1593.00	5.520	329.800	1592.31	-0.75	21.96	-4.39	1.22	
1781.00	8.890	328.760	1778.79	-9.37	42.21	-16.48	1.79	
1970.00	12.470	326.180	1964.49	-23.26	71.65	-35.41	1.91	
2159.00	13.490	328.920	2148.66	-39.85	107.49	-58.15	0.63	
2347.00	13.210	329.900	2331.58	-55.55	144.85	-80.24	0.19	
2535.00	12.940	331.570	2514.71	-70.02	181.95	-101.04	0.25	
2724.00	12.930	331.640	2698.91	-83.80	219.16	-121.16	0.01	
2911.00	10.270	334.310	2882.08	-95.28	252.60	-138.33	1.45	
3099.00	9.110	328.970	3067.40	-105.48	280.46	-153.26	0.78	
3287.00	11.910	332.360	3252.23	-117.05	310.41	-169.94	1.52	
3475.00	16.530	328.670	3434.42	-133.13	350.46	-192.86	2.50	
3664.00	17.470	329.430	3615.16	-153.43	397.85	-221.27	0.51	
3853.00	16.320	332.000	3796.00	-172.16	445.73	-248.16	0.73	
4041.00	14.020	328.400	3977.44	-189.21	488.45	-272.50	1.32	
4228.00	14.030	332.210	4158.87	-204.93	527.80	-294.94	0.49	
4417.00	11.690	331.300	4343.12	-218.50	564.87	-314.82	1.24	
4511.00	12.410	333.800	4435.05	-224.57	582.28	-323.85	0.95	
4605.00	12.230	340.220	4526.89	-229.29	600.71	-331.68	1.47	
4699.00	10.420	343.850	4619.05	-232.08	618.25	-337.41	2.07	
4793.00	8.850	345.540	4711.72	-233.73	633.42	-341.58	1.70	
4887.00	7.680	340.530	4804.75	-235.47	646.34	-345.48	1.46	
4981.00	6.800	342.690	4898.00	-237.33	657.58	-349.23	0.98	
5075.00	6.430	0.490	4991.38	-237.20	668.15	-350.84	2.21	
5169.00	7.580	30.640	5084.71	-232.31	678.76	-347.64	4.04	
5263.00	6.150	25.520	5178.03	-225.44	688.63	-342.31	1.65	
5356.00	6.550	41.500	5270.47	-218.47	697.10	-336.65	1.94	
5450.00	6.670	63.020	5363.86	-209.11	703.60	-328.23	2.62	
5544.00	7.380	68.830	5457.16	-197.99	708.25	-317.73	1.07	
5638.00	6.060	68.900	5550.51	-187.22	712.22	-307.47	1.40	
5732.00	4.770	71.020	5644.09	-178.51	715.28	-299.15	1.39	
5827.00	14.180	73.230	5737.68	-163.04	719.93	-284.24	9.91	
5921.00	26.140	77.950	5825.77	-130.82	727.60	-252.85	12.83	
6016.00	39.020	84.950	5905.68	-79.86	734.64	-202.36	14.11	
6110.00	49.800	83.720	5972.73	-14.32	741.19	-137.01	11.50	
6204.00	58.750	83.700	6027.56	61.81	749.54	-61.23	9.52	
6298.00	65.110	87.800	6071.79	144.34	755.60	21.42	7.78	
6391.00	71.080	90.170	6106.47	229.66	757.09	107.65	6.84	
6484.00	81.250	90.830	6128.68	318.50	756.29	197.82	10.96	
6523.00	86.890	88.750	6132.71	356.78	756.43	236.60	15.40	



Actual Wellpath Report

PRONGHORN 13-43-28HNC AWP

Page 3 of 5



REFERENCE WELLPATH IDENTIFICATION

Operator	BONANZA CREEK OIL COMPANY	Slot	SLOT#08 PRONGHORN 13-43-28HNC (1250'FSL & 429'FWL, SEC.28)
Area	COLORADO	Well	PRONGHORN 13-43-28HNC
Field	WELD COUNTY	Wellbore	PRONGHORN 13-43-28HNC AWB
Facility	SEC.28-T5N-R61W		

WELLPATH DATA (95 stations) † = interpolated/extrapolated station

MD [ft]	Inclination [°]	Azimuth [°]	TVD [ft]	Vert Sect [ft]	North [ft]	East [ft]	DLS [°/100ft]	Comments
6575.00†	88.438	89.371	6134.83	408.17	757.28	288.55	3.21	7" CASING (2005'FSL & 722'FWL, SEC.28)
6611.00	89.510	89.800	6135.47	443.72	757.55	324.54	3.21	
6643.00†	89.573	89.710	6135.73	475.31	757.68	356.54	0.34	TOP (2006'FSL & 787'FEL, SEC.28)
6703.00	89.690	89.540	6136.11	534.57	758.07	416.53	0.34	
6795.00	89.320	89.270	6136.91	625.49	759.03	508.53	0.50	
6887.00	91.110	89.770	6136.56	716.38	759.80	600.52	2.02	
6980.00	91.110	89.910	6134.76	808.16	760.06	693.50	0.15	
7072.00	89.570	89.490	6134.22	899.00	760.54	785.49	1.74	
7164.00	91.450	90.410	6133.40	989.77	760.62	877.49	2.28	
7255.00	91.390	90.060	6131.14	1079.46	760.25	968.46	0.39	
7347.00	92.100	90.610	6128.34	1170.10	759.71	1060.41	0.98	
7439.00	90.680	90.260	6126.11	1260.72	759.01	1152.38	1.59	
7530.00	89.810	89.370	6125.72	1350.55	759.31	1243.38	1.37	
7615.00	90.400	90.820	6125.56	1434.39	759.17	1328.37	1.84	
7699.00	89.750	87.800	6125.45	1517.41	760.18	1412.36	3.68	
7784.00	90.120	89.930	6125.55	1601.53	761.86	1497.34	2.54	
7869.00	90.090	91.940	6125.40	1685.15	760.47	1582.32	2.36	
7953.00	91.750	92.490	6124.05	1767.42	757.23	1666.24	2.08	
8038.00	91.050	91.630	6121.97	1850.70	754.17	1751.16	1.30	
8122.00	89.850	91.930	6121.31	1933.11	751.57	1835.12	1.47	
8207.00	90.250	91.820	6121.24	2016.47	748.78	1920.07	0.49	
8292.00	91.170	91.880	6120.18	2099.83	746.04	2005.02	1.08	
8377.00	90.370	90.960	6119.04	2183.32	743.93	2089.98	1.43	
8462.00	91.570	90.890	6117.60	2266.93	742.56	2174.96	1.41	
8547.00	91.380	91.190	6115.41	2350.50	741.02	2259.92	0.42	
8634.00	90.770	90.250	6113.78	2436.14	739.93	2346.89	1.29	
8719.00	89.850	90.030	6113.32	2519.96	739.72	2431.89	1.11	
8805.00	90.340	90.930	6113.18	2604.69	739.00	2517.89	1.19	
8890.00	90.250	91.670	6112.74	2688.21	737.07	2602.86	0.88	
8975.00	88.490	89.230	6113.68	2771.95	736.40	2687.85	3.54	
9060.00	90.180	90.160	6114.66	2855.87	736.86	2772.83	2.27	
9144.00	91.350	90.000	6113.54	2938.72	736.74	2856.83	1.41	
9229.00	91.080	90.000	6111.74	3022.57	736.74	2941.81	0.32	
9313.00	89.630	89.320	6111.22	3105.52	737.24	3025.80	1.91	
9398.00	90.090	91.100	6111.43	3189.32	736.92	3110.80	2.16	
9485.00	91.240	92.280	6110.42	3274.70	734.36	3197.75	1.89	
9570.00	89.750	91.380	6109.68	3358.07	731.65	3282.70	2.05	
9655.00	89.480	89.930	6110.25	3441.76	730.67	3367.69	1.74	
9741.00	90.500	90.980	6110.27	3526.49	729.99	3453.68	1.70	
9826.00	89.540	89.000	6110.24	3610.35	730.01	3538.68	2.59	
9913.00	90.860	92.200	6109.93	3696.02	729.09	3625.66	3.98	
9998.00	89.320	90.430	6109.80	3779.54	727.14	3710.63	2.76	
10083.00	90.310	90.760	6110.08	3863.25	726.26	3795.63	1.23	
10168.00	91.420	90.530	6108.79	3946.94	725.30	3880.61	1.33	
10254.00	91.310	90.550	6106.74	4031.63	724.49	3966.58	0.13	



Actual Wellpath Report

PRONGHORN 13-43-28HNC AWP

Page 4 of 5



REFERENCE WELLPATH IDENTIFICATION

Operator	BONANZA CREEK OIL COMPANY	Slot	SLOT#08 PRONGHORN 13-43-28HNC (1250'FSL & 429'FWL, SEC.28)
Area	COLORADO	Well	PRONGHORN 13-43-28HNC
Field	WELD COUNTY	Wellbore	PRONGHORN 13-43-28HNC AWB
Facility	SEC.28-T5N-R61W		

WELLPATH DATA (95 stations)

MD [ft]	Inclination [°]	Azimuth [°]	TVD [ft]	Vert Sect [ft]	North [ft]	East [ft]	DLS [°/100ft]	Comments
10342.00	90.680	90.960	6105.22	4118.24	723.34	4054.56	0.85	
10427.00	90.550	89.770	6104.30	4202.01	722.79	4139.55	1.41	
10511.00	89.510	89.480	6104.26	4284.97	723.34	4223.55	1.29	
10636.00	88.060	89.790	6106.91	4408.39	724.14	4348.51	1.19	LAST BHI MWD SURVEY
10695.00	88.060	89.790	6108.91	4466.60	724.36	4407.48	0.00	PROJECTION TO BIT (1951'FSL & 473'FEL, SEC.28)

HOLE & CASING SECTIONS

- Ref Wellbore: PRONGHORN 13-43-28HNC AWB Ref Wellpath: PRONGHORN 13-43-28HNC AWP

String/Diameter	Start MD [ft]	End MD [ft]	Interval [ft]	Start TVD [ft]	End TVD [ft]	Start N/S [ft]	Start E/W [ft]	End N/S [ft]	End E/W [ft]
9.625in Casing Surface	17.20	776.00	758.80	17.20	776.00	0.00	0.00	1.76	1.33
8.75in Open Hole	776.00	6575.00	5799.00	776.00	6134.83	1.76	1.33	757.28	288.55
7in Casing Intermediate	17.20	6575.00	6557.80	17.20	6134.83	0.00	0.00	757.28	288.55
6.125in Open Hole	6575.00	10695.00	4120.00	6134.83	6108.91	757.28	288.55	724.36	4407.48

TARGETS

Name	TVD [ft]	North [ft]	East [ft]	Grid East [US ft]	Grid North [US ft]	Latitude	Longitude	Shape
SEC.28-T05N-R61W	2.00	0.00	-80.81	3355997.14	1379471.29	40°22'04.836"N	104°13'20.424"W	polygon
PRONGHORN 13-43-28HNC BHL ON PLAT (1980'FSL & 470'FEL, SEC.28)	6130.20	729.01	4410.96	3360477.74	1380264.92	40°22'12.036"N	104°12'22.392"W	point
PRONGHORN 13-43-28HNC ENTRY POINT	6130.20	728.62	97.53	3356164.95	1380202.37	40°22'12.036"N	104°13'18.120"W	point
PRONGHORN 13-43-28HNC BHL ON PLAT REV-1 (1980'FSL & 470'FEL, SEC.28)	6139.00	729.01	4410.96	3360477.74	1380264.92	40°22'12.036"N	104°12'22.392"W	point
PRONGHORN 13-43-28HNC ENTRY POINT REV-1	6139.00	728.62	97.53	3356164.95	1380202.37	40°22'12.036"N	104°13'18.120"W	point
SEC.28-T05N-R61W (460' SETBACK)	6147.00	0.00	-80.81	3355997.14	1379471.29	40°22'04.836"N	104°13'20.424"W	polygon

WELLPATH COMPOSITION - Ref Wellbore: PRONGHORN 13-43-28HNC AWB Ref Wellpath: PRONGHORN 13-43-28HNC AWP

Start MD [ft]	End MD [ft]	Positional Uncertainty Model	Log Name/Comment	Wellbore
17.20	6523.00	NaviTrak (Standard)	BHI MWD/NAVITRAK (STD) 8.75" HOLE <839-6523>	PRONGHORN 13-43-28HNC AWB
6523.00	10636.00	NaviTrak (Standard)	BHI MWD/NAVITRAK (STD) 6.125" HOLE <6611-10636>	PRONGHORN 13-43-28HNC AWB
10636.00	10695.00	Blind Drilling (std)	Projection to bit	PRONGHORN 13-43-28HNC AWB



Actual Wellpath Report

PRONGHORN 13-43-28HNC AWP

Page 5 of 5



REFERENCE WELLPATH IDENTIFICATION			
Operator	BONANZA CREEK OIL COMPANY	Slot	SLOT#08 PRONGHORN 13-43-28HNC (1250'FSL & 429'FWL, SEC.28)
Area	COLORADO	Well	PRONGHORN 13-43-28HNC
Field	WELD COUNTY	Wellbore	PRONGHORN 13-43-28HNC AWB
Facility	SEC.28-T5N-R61W		

WELLPATH COMMENTS				
MD [ft]	Inclination [°]	Azimuth [°]	TVD [ft]	Comment
839.00	0.360	37.020	838.99	FIRST BHI MWD SURVEY
6575.00	88.438	89.371	6134.83	7" CASING (2005'FSL & 722'FWL, SEC.28)
6643.00	89.573	89.710	6135.73	TOP (2006'FSL & 787'FEL, SEC.28)
10636.00	88.060	89.790	6106.91	LAST BHI MWD SURVEY
10695.00	88.060	89.790	6108.91	PROJECTION TO BIT (1951'FSL & 473'FEL, SEC.28)