



received 10/29/2015
Project 5645
Document 2213101

Kerr-McGee Oil & Gas Onshore LP
1099 18th Street, Suite 1800
Denver, Colorado 80202
720-929-6000 Fax 720-929-7000

October 29, 2015

Mr. Peter Gintautas
Environmental Protection Specialist
Colorado Oil and Gas Conservation Commission
1120 Lincoln Street, Suite 801
Denver, Colorado 80203

**Re: Groundwater Monitoring Program Modification Request
HSR-MJ Farms 11, 12, 13, 14-7, Hildbrandt Pooling GU #1
COGCC Remediation No. 5645
NESW 7-T3N-R67W**

Dear Mr. Gintautas:

Kerr-McGee Oil and Gas Onshore LP (Kerr-McGee) is hereby requesting a modification to the groundwater monitoring program for former HSR-MJ Farms 11, 12, 13, 14-7, Hildbrandt Pooling GU #1 tank battery (Site).

BACKGROUND

On January 13, 2010, field crews were upgrading the production facility and encountered petroleum hydrocarbon impacted soil associated with abandoned tank battery lines. The petroleum hydrocarbon impacted soil was excavated. Groundwater was encountered in the excavation at approximately 14 feet below ground surface. Approximately 340 cubic yards of petroleum hydrocarbon impacted soil were removed from the excavation. Approximately 330 barrels of impacted groundwater were removed from the excavation using a vacuum truck. Prior to backfilling, ten gallons of MicroBlaze[®] were applied to the groundwater and exposed smear zone soils in the open excavation. Between May 2010 and March 2015, a total of 46 groundwater monitoring wells were installed at the Site to define the extent and magnitude of dissolved phase petroleum hydrocarbon plume. Groundwater monitoring has been conducted on a quarterly basis since May 2010.

MONITORING PROGRAM MODIFICATION REQUEST

A total of 23 quarterly groundwater monitoring events have been conducted at the Site. Based on the analytical results to date, Kerr-McGee believes the plume can be fully delineated and monitored without sampling all 46 monitoring wells every quarter. Therefore, we are requesting a reduction in the frequency of monitoring for the following 19 monitoring wells. Under the revised sampling plan, monitoring wells MW02, MW03R, MW05R, MW06R, MW07R, MW08, MW09R, MW12, MW14, MW18, MW19, MW23, MW27, MW28, MW30, MW31, MW37, MW40, and MW43 would not be sampled during the first, second, and fourth quarter monitoring events. All the monitoring wells on the Site would be sampled annually during the third quarter

monitoring event. In addition, we are requesting that monitoring well MW34 be permanently removed from the groundwater monitoring program, as point of compliance can be achieved without monitoring this well, which has recorded compliant BTEX concentrations for consecutive quarters since being installed. At a minimum, all the Site monitoring wells, excluding MW34, will be sampled for four consecutive quarters prior to requesting a no further action status.

A Site Map showing the general site layout, third quarter 2015 benzene analytical data, and the monitoring wells proposed for sampling modification is provided as Figure 1. The groundwater analytical results are summarized in Table 1. A table summarizing the proposed/revised sampling plan for this Site is provided as Table 2.

Feel free to contact me at 970-515-1161 if you have any questions regarding this information.

Sincerely,

Kerr-McGee Oil & Gas Onshore LP



Phillip Hamlin
Senior HSE Representative

Attachments

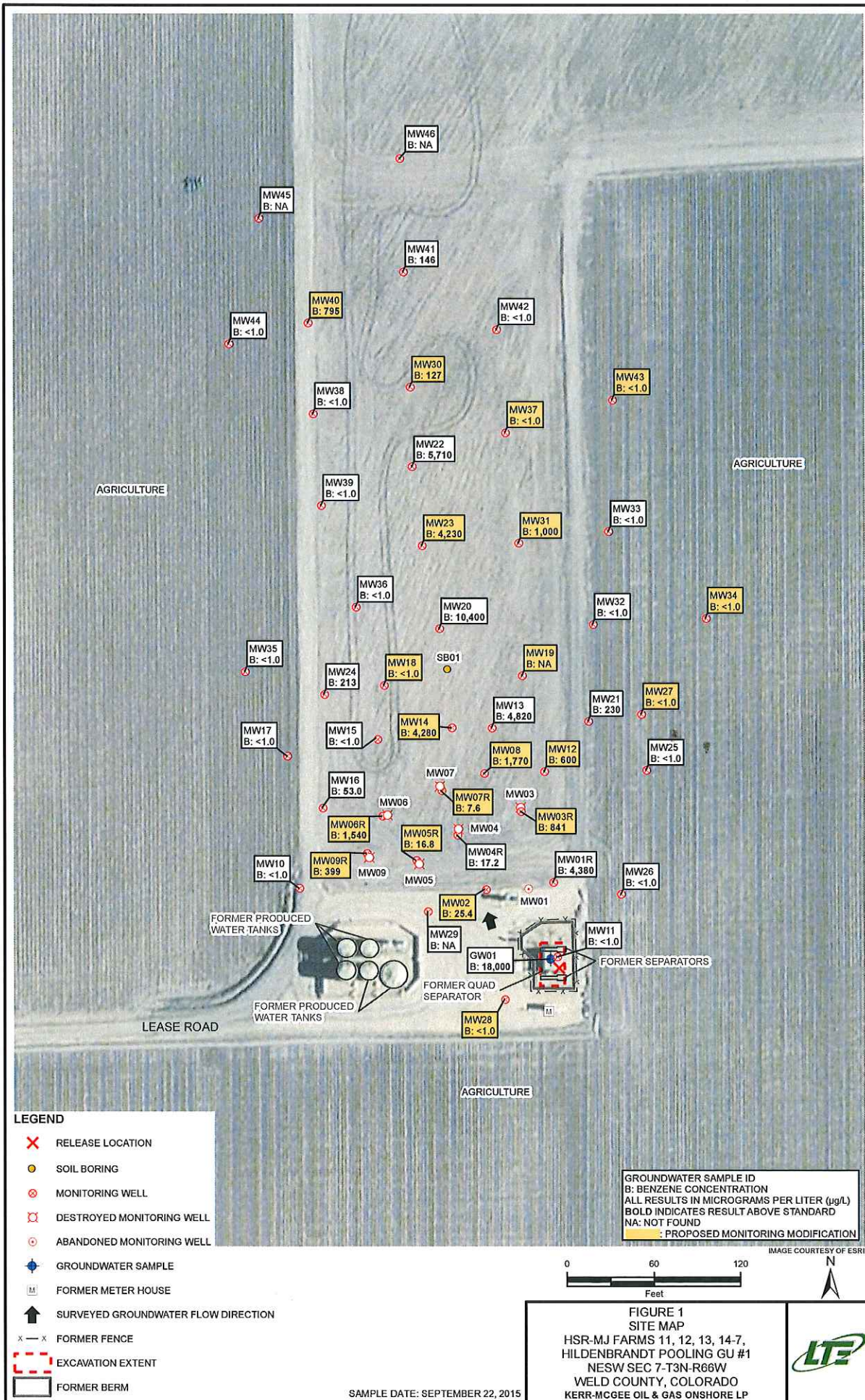

- LEGEND**
- RELEASE LOCATION
 - SOIL BORING
 - MONITORING WELL
 - DESTROYED MONITORING WELL
 - ABANDONED MONITORING WELL
 - GROUNDWATER SAMPLE
 - FORMER METER HOUSE
 - SURVEYED GROUNDWATER FLOW DIRECTION
 - FORMER FENCE
 - EXCAVATION EXTENT
 - FORMER BERM

GROUNDWATER SAMPLE ID
 B: BENZENE CONCENTRATION
 ALL RESULTS IN MICROGRAMS PER LITER (µg/L)
 BOLD INDICATES RESULT ABOVE STANDARD
 NA: NOT FOUND
 PROPOSED MONITORING MODIFICATION



FIGURE 1
SITE MAP
 HSR-MJ FARMS 11, 12, 13, 14-7,
 HILDENBRANDT POOLING GU #1
 NESW SEC 7-T3N-R66W
 WELD COUNTY, COLORADO
 KERR-MCGEE OIL & GAS ONSHORE LP



SAMPLE DATE: SEPTEMBER 22, 2015

**TABLE 1
GROUNDWATER ANALYTICAL AND FIELD RESULTS
HSR-MJ FARMS 11,12,13,14-7, HILDENBRANDT POOLING GU #1**

**WELD COUNTY, COLORADO
KERR-MCGEE OIL & GAS ONSHORE LP**

Well Name	Date	Benzene (ug/L)	Toluene (ug/L)	Ethylbenzene (ug/L)	Xylenes (ug/L)	Depth Water/ (Product Thickness) (ft bgs)	Relative GW Elev. (ft)	
GW01	01/19/2010	18000	25000	540	7600	NM	NA	
MW01	06/15/2010	7600	14000	650	10000	15.05	82.03	
	09/01/2010	19000	20000	440	5900	13.69	83.39	
	12/06/2010	29000	31000	730	12000	14.69	82.39	
	03/03/2011	8100	10000	430	7900	15.58	81.50	
	06/02/2011	1400	1700	280	3300	15.28	81.80	
	09/06/2011	9500	8900	450	7200	12.56	84.52	
	12/05/2011	12000	8700	540	8100	13.07	84.01	
	03/14/2012	2000	1800	240	4500	13.03	84.05	
	06/14/2012	2900	250	570	8600	9.76	87.32	
	09/14/2012	4400	4100	590	7400	15.55	81.53	
	12/11/2012	3700	14	750	11000	15.67	81.41	
	03/06/2013	Product - Not Sampled					17.78 (0.90)	79.30
	06/21/2013	Product - Not Sampled					16.48 (0.07)	80.60
	09/24/2013	2000	3900	470	7800	14.88	82.20	
	12/02/2013	Product - Not Sampled					14.33 (0.01)	82.75
	12/06/2013	Surveyed - Not Sampled					14.52	82.61
	03/22/2014	2210	539	552	6670	15.62	81.46	
	MW01 destroyed as of 4/28/2014							
MW01R	12/22/2014	6510	1240	813	10200	13.85	NA	
	03/18/2015	3260	37.7	612	8190	14.57	NA	
	06/17/2015	2750	153	607	8660	13.86	NA	
	09/22/2015	4380	<20.0	619	7420	12.86	NA	
MW02	06/15/2010	2000	1600	49	940	14.88	81.95	
	09/01/2010	760	28	5.9	150	13.54	83.29	
	12/06/2010	520	15	11	170	14.51	82.32	
	03/03/2011	1000	86	25	1400	15.45	81.38	
	06/02/2011	940	65	58	700	15.13	81.70	
	09/06/2011	2200	180	54	460	12.41	84.42	
	12/05/2011	13000	8400	540	8000	12.92	83.91	
	03/14/2012	400	62	88	800	12.94	83.89	
	06/14/2012	1600	8.9	97	1300	9.95	86.88	
	09/14/2012	830	440	140	1300	15.39	81.44	
	12/11/2012	1400	<1.0	130	1800	15.46	81.37	



TABLE 1 (Continued)
GROUNDWATER ANALYTICAL AND FIELD RESULTS
HSR-MJ FARMS 11,12,13,14-7, HILDENBRANDT POOLING GU #1

WELD COUNTY, COLORADO
KERR-MCGEE OIL & GAS ONSHORE LP

Well Name	Date	Benzene (ug/L)	Toluene (ug/L)	Ethylbenzene (ug/L)	Xylenes (ug/L)	Depth Water/ (Product Thickness) (ft bgs)	Relative GW Elev. (ft)	
MW02	03/06/2013	Product - Not Sampled					17.38 (0.75)	79.45
	06/21/2013	Product - Not Sampled					16.28 (0.05)	80.55
	09/24/2013	950	1400	340	5100		14.68	82.15
	12/02/2013	440	288	230	2910		14.12	82.71
	12/06/2013	Surveyed - Not Sampled					14.31	82.57
	03/22/2014	151	<10.0	119	1630		15.43	81.40
	07/15/2014	121	<10.0	216	1990		10.95	85.93
	09/30/2014	Inaccessible - Not Sampled					Inaccessible	NA
	12/22/2014	Damaged - Not Sampled					14.14	86.32
	03/18/2015	64.6	<1.0	174	1410		14.85	85.61
	06/17/2015	25.6	<10.0	128	1220		14.12	NA
	09/22/2015	25.4	<10.0	127	1010		PVC Blocked	NA
	MW03	05/09/2013	2100	940	390	3900		15.61
06/21/2013		3500	1700	240	3200		14.85	80.43
09/24/2013		2800	570	170	2400		13.30	81.98
12/02/2013		2590	122	156	1680		12.64	82.64
12/06/2013		Surveyed - Not Sampled					12.91	82.46
03/22/2014		3010	<20.0	134	1370		16.97	80.31
07/15/2014		887	<20.0	92.6	1650		10.55	84.82
09/30/2014		Inaccessible - Not Sampled					Inaccessible	NA
		MW03 destroyed as of 7/15/2014						
MW03R	12/22/2014	6380	70.1	565	7560		13.32	86.39
	03/18/2015	5250	13.8	354	4090		14.01	85.70
	04/06/2015	Surveyed - Not Sampled					14.02	85.65
	06/17/2015	1220	<4.0	47.3	1000		13.29	86.38
	09/22/2015	841	<10.0	66.8	525		12.30	87.37
MW04	05/09/2013	280	150	77	850		15.45	77.88
	06/21/2013	Product - Not Sampled					14.90 (0.30)	80.17
	09/24/2013	170	15	65	820		13.00	82.07
	12/02/2013	Product - Not Sampled					12.48 (0.01)	82.59
	12/06/2013	Surveyed - Not Sampled					12.89	82.43
	03/22/2014	Damaged - Not Sampled					PVC Blocked	NA
		MW04 destroyed as of 7/15/2014						
MW04R	12/22/2014	4.8	<1.0	53.1	323		13.72	NA



TABLE 1 (Continued)
GROUNDWATER ANALYTICAL AND FIELD RESULTS
HSR-MJ FARMS 11,12,13,14-7, HILDENBRANDT POOLING GU #1

WELD COUNTY, COLORADO
KERR-MCGEE OIL & GAS ONSHORE LP

Well Name	Date	Benzene (ug/L)	Toluene (ug/L)	Ethylbenzene (ug/L)	Xylenes (ug/L)	Depth Water/ (Product Thickness) (ft bgs)	Relative GW Elev. (ft)	
MW04R	03/18/2015	4.1	<1.0	41.5	316	14.46	NA	
	06/17/2015	3.3	<1.0	10.8	71.4	13.74	NA	
	09/22/2015	17.2	<1.0	<1.0	2.7	12.73	NA	
MW05	05/09/2013	62	<1.0	180	1600	15.40	78.36	
	06/21/2013	57	2.0	48	470	14.60	80.49	
	09/24/2013	12	<1.0	18	73	13.20	81.89	
	12/02/2013	9.1	<1.0	13.7	71.6	12.49	82.60	
	12/06/2013	Surveyed - Not Sampled					12.83	82.48
	03/22/2014	6.0	<1.0	14.9	105	13.75	81.34	
	MW05 destroyed as of 7/15/2014							
MW05R	12/22/2014	50.2	<1.0	68.3	405	13.67	86.35	
	04/06/2015	Surveyed - Not Sampled					14.39	85.63
	06/17/2015	26.6	<1.0	69.3	628	13.60	86.42	
	09/22/2015	16.8	<4.0	85.9	578	12.63	87.39	
MW06	05/17/2013	2200	<1.0	130	2000	15.55	79.61	
	06/21/2013	1700	1.5	54	540	15.00	80.31	
	09/24/2013	380	<1.0	22	240	13.35	81.96	
	12/02/2013	274	<2.0	15.8	217	12.81	82.50	
	12/06/2013	Surveyed - Not Sampled					13.05	82.36
	03/22/2014	308	<1.0	6.9	47.6	14.09	81.22	
	MW06 destroyed as of 7/15/2014							
MW06R	12/22/2014	788	<1.0	95.4	1180	13.47	NA	
	03/18/2015	917	<1.0	59.9	842	14.10	NA	
	06/17/2015	874	<1.0	18.3	172	13.42	NA	
	09/22/2015	1540	<4.0	50.4	363	12.49	NA	
MW07	05/17/2013	1200	1400	290	4000	15.35	79.54	
	06/21/2013	340	84	84	600	14.80	80.19	
	09/24/2013	75	3.2	6.3	42	13.00	81.99	
	12/02/2013	182	2.9	13.1	116	12.48	82.51	
	12/06/2013	Surveyed - Not Sampled					12.89	82.38
	03/22/2014	109	<2.0	<2.0	12.1	15.76	81.23	
	MW07 destroyed as of 7/15/2014							
MW07R	12/22/2014	806	3.8	372	5630	13.31	NA	
	03/18/2015	489	<20.0	418	5600	13.99	NA	



TABLE 1 (Continued)
GROUNDWATER ANALYTICAL AND FIELD RESULTS
HSR-MJ FARMS 11,12,13,14-7, HILDENBRANDT POOLING GU #1

WELD COUNTY, COLORADO
KERR-MCGEE OIL & GAS ONSHORE LP

Well Name	Date	Benzene (ug/L)	Toluene (ug/L)	Ethylbenzene (ug/L)	Xylenes (ug/L)	Depth Water/ (Product Thickness) (ft bgs)	Relative GW Elev. (ft)	
MW07R	06/17/2015	25.0	<1.0	1.4	5.6	13.08	NA	
	09/22/2015	7.6	<1.0	5.4	28.9	12.33	NA	
MW08	05/17/2013	4700	2000	130	2000	15.55	79.77	
	06/21/2013	Product - Not Sampled					14.90 (0.25)	80.17
	09/24/2013	Product - Not Sampled					13.08 (0.03)	81.99
	12/02/2013	2520	13.8	93.4	750	12.54	82.53	
	12/06/2013	Surveyed - Not Sampled					12.77	82.39
	03/22/2014	5190	<1.0	<1.0	17.8	13.83	81.24	
	07/15/2014	344	<50.0	<50.0	712	10.49	84.67	
	09/30/2014	Inaccessible - Not Sampled					Inaccessible	NA
	12/22/2014	3480	26.3	61.9	940	10.20	84.96	
	03/18/2015	2550	<20.0	21.8	357	10.89	84.27	
	06/17/2015	764	<10.0	<10.0	<10.0	11.19	NA	
	09/22/2015	1770	5.2	24.4	237	9.23	NA	
MW09	05/17/2013	1500	150	170	1900	16.05	79.60	
	06/21/2013	2500	120	190	2600	15.08	80.37	
	09/24/2013	2300	4.6	110	2100	13.40	82.05	
	12/02/2013	3390	2.1	241	2920	12.87	82.58	
	12/06/2013	Surveyed - Not Sampled					13.15	82.43
	03/22/2014	794	<20.0	50.2	230	14.16	81.29	
	MW09 destroyed as of 7/15/2014							
MW09R	12/22/2014	1430	26.0	88.9	763	13.80	NA	
	03/18/2015	620	3.2	79.8	84.9	14.47	NA	
	06/17/2015	394	<1.0	68.5	25.8	13.78	NA	
	09/22/2015	399	<1.0	79.1	51.3	12.80	NA	
MW10	12/22/2014	<1.0	<1.0	<1.0	<1.0	13.79	NA	
	03/18/2015	<1.0	<1.0	<1.0	<1.0	14.41	NA	
	06/17/2015	<1.0	<1.0	<1.0	<1.0	13.74	NA	
	09/22/2015	<1.0	<1.0	<1.0	<1.0	12.79	NA	
MW11	12/22/2014	<1.0	<1.0	97.6	2010	13.83	86.55	
	03/18/2015	<1.0	<1.0	5.9	80.6	14.53	85.85	
	04/06/2015	Surveyed - Not Sampled					14.50	85.80
	06/17/2015	<1.0	<1.0	<1.0	3.6	13.75	86.55	



TABLE 1 (Continued)
GROUNDWATER ANALYTICAL AND FIELD RESULTS
HSR-MJ FARMS 11,12,13,14-7, HILDENBRANDT POOLING GU #1

WELD COUNTY, COLORADO
KERR-MCGEE OIL & GAS ONSHORE LP

Well Name	Date	Benzene (ug/L)	Toluene (ug/L)	Ethylbenzene (ug/L)	Xylenes (ug/L)	Depth Water/ (Product Thickness) (ft bgs)	Relative GW Elev. (ft)	
MW11	09/22/2015	<1.0	<1.0	<1.0	3.3	12.76	87.54	
MW12	12/22/2014	2700	1000	420	5140	13.58	NA	
	03/18/2015	2520	314	330	3840	14.11	NA	
	06/17/2015	1200	7.6	155	1280	13.62	NA	
	09/22/2015	600	<10.0	177	1210	12.55	NA	
MW13	12/22/2014	7160	476	294	4490	13.11	NA	
	03/18/2015	6620	6.4	71.0	840	13.81	NA	
	06/17/2015	5240	<1.0	21.5	209	13.11	NA	
	09/22/2015	4820	<20.0	<20.0	<20.0	12.06	NA	
MW14	12/22/2014	2410	<1.0	113	3000	13.20	NA	
	03/18/2015	2230	<20.0	91.4	1420	13.86	NA	
	06/17/2015	469	<1.0	15.0	140	13.17	NA	
	09/22/2015	4280	<4.0	29.0	351	13.14	NA	
MW15	12/22/2014	298	<1.0	3.2	184	13.47	NA	
	03/18/2015	314	<1.0	1.2	40.1	14.12	NA	
	06/17/2015	273	<1.0	4.5	29.9	13.43	NA	
	09/22/2015	<1.0	<1.0	<1.0	<1.0	12.57	NA	
MW16	03/18/2015	844	<50.0	417	7080	14.40	NA	
	06/17/2015	286	<1.0	169	1370	13.72	NA	
	09/22/2015	53.0	<10.0	23.2	210	12.72	NA	
MW17	02/19/2015	<1.0	<1.0	<1.0	3.7	14.07	85.66	
	03/18/2015	<1.0	<1.0	<1.0	<1.0	14.20	85.53	
	04/06/2015	Surveyed - Not Sampled					14.34	85.46
	06/17/2015	<1.0	<1.0	<1.0	<1.0	12.66	87.14	
	09/22/2015	<1.0	<1.0	<1.0	<1.0	12.62	87.18	
MW18	02/19/2015	<1.0	<1.0	<1.0	<1.0	13.88	NA	
	03/18/2015	<1.0	<1.0	<1.0	<1.0	14.03	NA	
	06/17/2015	<1.0	<1.0	<1.0	<1.0	13.38	NA	
	09/22/2015	<1.0	<1.0	<1.0	<1.0	12.30	NA	
MW19	03/18/2015	7590	38.8	557	972	13.45	85.45	
	04/06/2015	Surveyed - Not Sampled					13.94	85.44
	06/17/2015	6520	<1.0	147	1950	13.22	86.16	
	09/22/2015	Not Found - Not Sampled					Not Found	NA



TABLE 1 (Continued)
GROUNDWATER ANALYTICAL AND FIELD RESULTS
HSR-MJ FARMS 11,12,13,14-7, HILDENBRANDT POOLING GU #1

WELD COUNTY, COLORADO
KERR-MCGEE OIL & GAS ONSHORE LP

Well Name	Date	Benzene (ug/L)	Toluene (ug/L)	Ethylbenzene (ug/L)	Xylenes (ug/L)	Depth Water/ (Product Thickness) (ft bgs)	Relative GW Elev. (ft)	
MW20	03/18/2015	10500	1080	338	4580	13.49	NA	
	06/17/2015	4830	<1.0	104	975	12.81	NA	
	09/22/2015	10400	<20.0	83.6	1080	11.70	NA	
MW21	03/18/2015	679	<20.0	341	4330	13.70	NA	
	06/17/2015	216	<1.0	113	1140	12.99	NA	
	09/22/2015	230	<10.0	114	1150	11.99	NA	
MW22	02/19/2015	6460	<1.0	4.3	115	13.82	NA	
	03/18/2015	7320	<1.0	20.0	408	14.02	NA	
	06/17/2015	2850	<1.0	2.8	<1.0	14.33	NA	
	09/22/2015	5710	<10.0	<10.0	23.2	12.19	NA	
MW23	02/19/2015	5150	<1.0	5.6	<1.0	13.84	85.51	
	03/18/2015	5680	<1.0	12.6	102	13.98	85.37	
	04/06/2015	Surveyed - Not Sampled					13.99	85.31
	06/17/2015	1050	<1.0	2.2	<1.0	13.28	86.02	
	09/22/2015	4230	<10.0	<10.0	<10.0	12.19	87.11	
MW24	02/19/2015	1520	<1.0	4.2	139	14.71	NA	
	03/18/2015	2480	<1.0	6.6	10.7	14.85	NA	
	06/17/2015	1470	<1.0	5.5	4.0	14.22	NA	
	09/22/2015	213	<10.0	<10.0	<10.0	13.15	NA	
MW25	02/19/2015	<1.0	<1.0	<1.0	<1.0	13.86	NA	
	03/18/2015	<1.0	<1.0	<1.0	<1.0	14.00	NA	
	06/17/2015	<1.0	<1.0	<1.0	<1.0	13.30	NA	
	09/22/2015	<1.0	<1.0	<1.0	<1.0	12.28	NA	
MW26	02/19/2015	<1.0	<1.0	<1.0	<1.0	14.05	NA	
	03/18/2015	<1.0	<1.0	<1.0	<1.0	14.20	NA	
	06/17/2015	<1.0	<1.0	<1.0	<1.0	13.50	NA	
	09/22/2015	<1.0	<1.0	<1.0	<1.0	12.52	NA	
MW27	02/19/2015	<1.0	<1.0	<1.0	<1.0	13.44	85.73	
	03/18/2015	<1.0	<1.0	<1.0	<1.0	13.59	85.58	
	04/06/2015	Surveyed - Not Sampled					14.23	85.51
	06/17/2015	<1.0	<1.0	<1.0	<1.0	13.47	86.27	
	09/22/2015	<1.0	<1.0	<1.0	<1.0	12.42	87.32	
MW28	02/19/2015	<1.0	<1.0	<1.0	<1.0	14.52	NA	



TABLE 1 (Continued)
GROUNDWATER ANALYTICAL AND FIELD RESULTS
HSR-MJ FARMS 11,12,13,14-7, HILDENBRANDT POOLING GU #1

WELD COUNTY, COLORADO
KERR-MCGEE OIL & GAS ONSHORE LP

Well Name	Date	Benzene (ug/L)	Toluene (ug/L)	Ethylbenzene (ug/L)	Xylenes (ug/L)	Depth Water/ (Product Thickness) (ft bgs)	Relative GW Elev. (ft)
MW28	03/18/2015	<1.0	<1.0	<1.0	<1.0	14.68	NA
	06/17/2015	<1.0	<1.0	<1.0	<1.0	13.96	NA
	09/22/2015	<1.0	<1.0	<1.0	<1.0	12.99	NA
MW29	03/18/2015	3.2	<1.0	32.0	92.6	14.23	NA
	06/17/2015	1.4	<1.0	2.5	15.2	13.49	NA
	09/22/2015	Not Found - Not Sampled				Not Found	NA
MW30	02/20/2015	1730	<1.0	1.2	<1.0	NM	NA
	03/18/2015	4030	<1.0	3.6	146	13.31	NA
	06/17/2015	5500	<1.0	3.6	4.2	12.69	NA
	09/22/2015	127	<20.0	<20.0	<20.0	11.61	NA
MW31	02/20/2015	2830	<1.0	182	1030	NM	NA
	03/18/2015	2030	<1.0	60.7	83.1	13.50	NA
	06/17/2015	1610	<1.0	39.4	7.1	12.84	NA
	09/22/2015	1000	<10.0	36.1	24.7	11.82	NA
MW32	02/20/2015	<1.0	<1.0	154	770	NM	NA
	03/18/2015	<1.0	<1.0	90.4	971	13.99	NA
	06/17/2015	<1.0	<1.0	19.6	164	13.31	NA
	09/22/2015	<1.0	<1.0	12.4	94.2	12.19	NA
MW33	02/20/2015	<1.0	<1.0	<1.0	<1.0	NM	NA
	03/18/2015	<1.0	<1.0	<1.0	<1.0	14.02	85.40
	04/06/2015	Surveyed - Not Sampled				14.48	85.32
	06/17/2015	<1.0	<1.0	<1.0	<1.0	13.74	86.06
	09/22/2015	<1.0	<1.0	<1.0	<1.0	12.62	87.18
MW34	02/20/2015	<1.0	<1.0	<1.0	<1.0	NM	NA
	03/18/2015	<1.0	<1.0	<1.0	<1.0	13.34	NA
	06/17/2015	<1.0	<1.0	<1.0	<1.0	12.65	NA
	09/22/2015	<1.0	<1.0	<1.0	<1.0	11.55	NA
MW35	02/20/2015	<1.0	<1.0	<1.0	<1.0	NM	NA
	03/18/2015	<1.0	<1.0	<1.0	<1.0	13.57	NA
	06/17/2015	<1.0	<1.0	<1.0	<1.0	12.94	NA
	09/22/2015	<1.0	<1.0	<1.0	<1.0	11.90	NA
MW36	02/20/2015	<1.0	<1.0	<1.0	<1.0	NM	NA
	03/18/2015	<1.0	<1.0	<1.0	<1.0	13.75	NA



TABLE 1 (Continued)
GROUNDWATER ANALYTICAL AND FIELD RESULTS
HSR-MJ FARMS 11,12,13,14-7, HILDENBRANDT POOLING GU #1

WELD COUNTY, COLORADO
KERR-MCGEE OIL & GAS ONSHORE LP

Well Name	Date	Benzene (ug/L)	Toluene (ug/L)	Ethylbenzene (ug/L)	Xylenes (ug/L)	Depth Water/ (Product Thickness) (ft bgs)	Relative GW Elev. (ft)
MW36	06/17/2015	6.7	<1.0	<1.0	<1.0	13.11	NA
	09/22/2015	<1.0	<1.0	<1.0	<1.0	12.02	NA
MW37	03/18/2015	30.2	<1.0	10.5	4.4	13.59	85.29
	04/06/2015	Surveyed - Not Sampled				14.00	85.23
	06/17/2015	67.8	<1.0	12.8	70.5	13.29	85.94
	09/22/2015	<1.0	<1.0	<1.0	<1.0	12.15	87.08
MW38	03/18/2015	16.7	<1.0	2.6	22.5	14.26	85.16
	04/06/2015	Surveyed - Not Sampled				14.68	85.10
	06/17/2015	<1.0	<1.0	<1.0	<1.0	13.99	85.79
	09/22/2015	<1.0	<1.0	<1.0	<1.0	12.92	86.86
MW39	03/18/2015	<1.0	<1.0	<1.0	<1.0	14.31	NA
	06/17/2015	2.8	<1.0	<1.0	<1.0	13.68	NA
	09/22/2015	<1.0	<1.0	<1.0	<1.0	9.50	NA
MW40	03/18/2015	184	<1.0	<1.0	<1.0	14.24	NA
	06/17/2015	<1.0	<1.0	<1.0	<1.0	13.60	NA
	09/22/2015	795	<1.0	<1.0	<1.0	12.49	NA
MW41	03/18/2015	214	<1.0	<1.0	1.5	13.45	NA
	06/17/2015	3610	<1.0	4.6	10.2	12.83	NA
	09/22/2015	146	<1.0	<1.0	6.6	11.70	NA
MW42	03/18/2015	<1.0	<1.0	<1.0	<1.0	13.60	NA
	06/17/2015	1.1	<1.0	<1.0	<1.0	12.92	NA
	09/22/2015	<1.0	<1.0	<1.0	<1.0	11.76	NA
MW43	03/23/2015	<1.0	<1.0	<1.0	<1.0	13.57	NA
	06/17/2015	<1.0	<1.0	<1.0	<1.0	13.57	NA
	09/22/2015	<1.0	<1.0	<1.0	<1.0	12.40	NA
MW44	03/23/2015	<1.0	<1.0	<1.0	<1.0	13.57	NA
	06/17/2015	17.8	<1.0	<1.0	<1.0	12.93	NA
	09/22/2015	<1.0	<1.0	<1.0	<1.0	11.79	NA
MW45	03/23/2015	<1.0	<1.0	<1.0	<1.0	14.18	84.28
	04/06/2015	Surveyed - Not Sampled				13.95	84.86
	06/17/2015	<1.0	<1.0	<1.0	<1.0	13.27	85.54
	09/22/2015	Not Found - Not Sampled				Not Found	NA
MW46	03/23/2015	<1.0	<1.0	<1.0	<1.0	13.29	85.21



TABLE 1 (Continued)
GROUNDWATER ANALYTICAL AND FIELD RESULTS
HSR-MJ FARMS 11,12,13,14-7, HILDENBRANDT POOLING GU #1

WELD COUNTY, COLORADO
KERR-MCGEE OIL & GAS ONSHORE LP

Well Name	Date	Benzene (ug/L)	Toluene (ug/L)	Ethylbenzene (ug/L)	Xylenes (ug/L)	Depth Water/ (Product Thickness) (ft bgs)	Relative GW Elev. (ft)
MW46	04/06/2015	Surveyed - Not Sampled				13.94	84.86
	06/17/2015	366	<1.0	<1.0	<1.0	13.23	85.57
	09/22/2015	Not Found - Not Sampled				Not Found	NA
SB01GW	02/11/2015	12500	7590	915	13500	NM	NA
CGWQS		5	1000	700	1400		

Notes: ug/L - micrograms per Liter
ft bgs - feet below ground surface
GW - Groundwater

Elev. - Elevation
Bold numbers indicate result exceeded standard.
< - less than

NA - Not Analyzed/Not Available
NM - Not Measured
CGWQS - Colorado Groundwater Quality Standards



Table 2
Groundwater Monitoring Plan
HSR-MJ Farms 11, 12, 13, 14-7, Hildenbrandt Pooling GU #1
Weld County, Colorado
Kerr-McGee Oil Gas Onshore LP

Sample Frequency	Number of Wells	Well IDs
Monitoring Wells To Be Sampled Annually in Third Quarter Only	19	MW02, MW03R, MW05R, MW06R, MW07R MW08, MW09R, MW12, MW14, MW18, MW19, MW23, MW27, MW28, MW30, MW31, MW37, MW40, and MW43
Monitoring Wells To Be Sampled Quarterly	26	MW01R, MW04R, MW10, MW11, MW13, MW15, MW16, MW17, MW20, MW21, MW22, MW24, MW25, MW26, MW29, MW32, MW33, MW35, MW36, MW38, MW39, MW41, MW42, MW44, MW45, MW46
Monitoring Well To Be Removed From Monitoring	1	MW34