

FRANE SURVEYING INC.

Physical Address: 34834 Annie Cir.
Mail to: Box 2372, Elizabeth, CO 80107
Ph. 303-243-0037
www.franesurveying.com

Job # 027-15 Hair 15-45 #1-14

Frane Surveying Inc., has in accordance with a request from **Angus Natural Resources LLC** has determined the location of **Hair 15-45 #1-14** to be **2314 feet FNL**, and **2325 feet FEL**, (90° off Section lines) of **SECTION 1**, Township **15s**, Range **45w** of the 6th Principal Meridian, **Cheyenne County**, Colorado.

Date: Staked on 09/10/15 drawn on 09/14/2015

Re: Staked by Elijah Frane
Drawn: Drawn by Elijah Frane

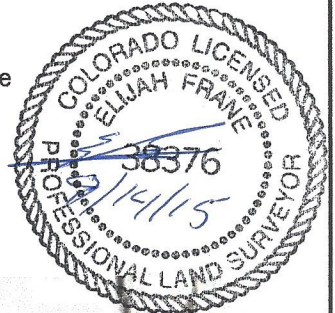

500' Location Drawing

