

# FRANE SURVEYING INC.

Physical Address: 34834 Annie Cir.  
Mail to: Box 2372, Elizabeth, CO 80107  
Ph. 303-243-0037  
www.franesurveying.com

Job # 027-15 Hair 15-45 #1-14

Frane Surveying Inc., has in accordance with a request from **Angus Natural Resources LLC** has determined the location of **Hair 15-45 #1-14** to be **2314 feet FNL**, and **2325 feet FEL**, (90° off Section lines) of **SECTION 1**, Township **15s**, Range **45w** of the 6th Principal Meridian, **Cheyenne County**, Colorado.

Date: Staked on 09/10/15 drawn on 09/14/2015

Re: Staked by Elijah Frane  
Drawn: Drawn by Elijah Frane

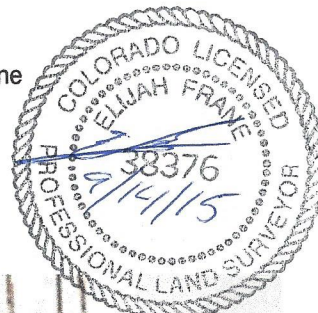

## 1000' Hydrology Map

There is an indicated surface water area approximately 819' North of the proposed well pad at its closest point.

Angus Natural Resources LLC  
NE1/4 Sec. 14/15s/45w  
Hair 15-45 #1-14  
Cheyenne, Co. Colorado

