



Lat40°, Inc. 6250 W. 10th Street, Unit 2, Greeley, CO 970-515-5294

HYDROLOGY MAP

LITZENBERGER PAD

SECTION: 8
TOWNSHIP: 3N
RANGE: 68W
6TH. P.M.
WELD COUNTY, CO

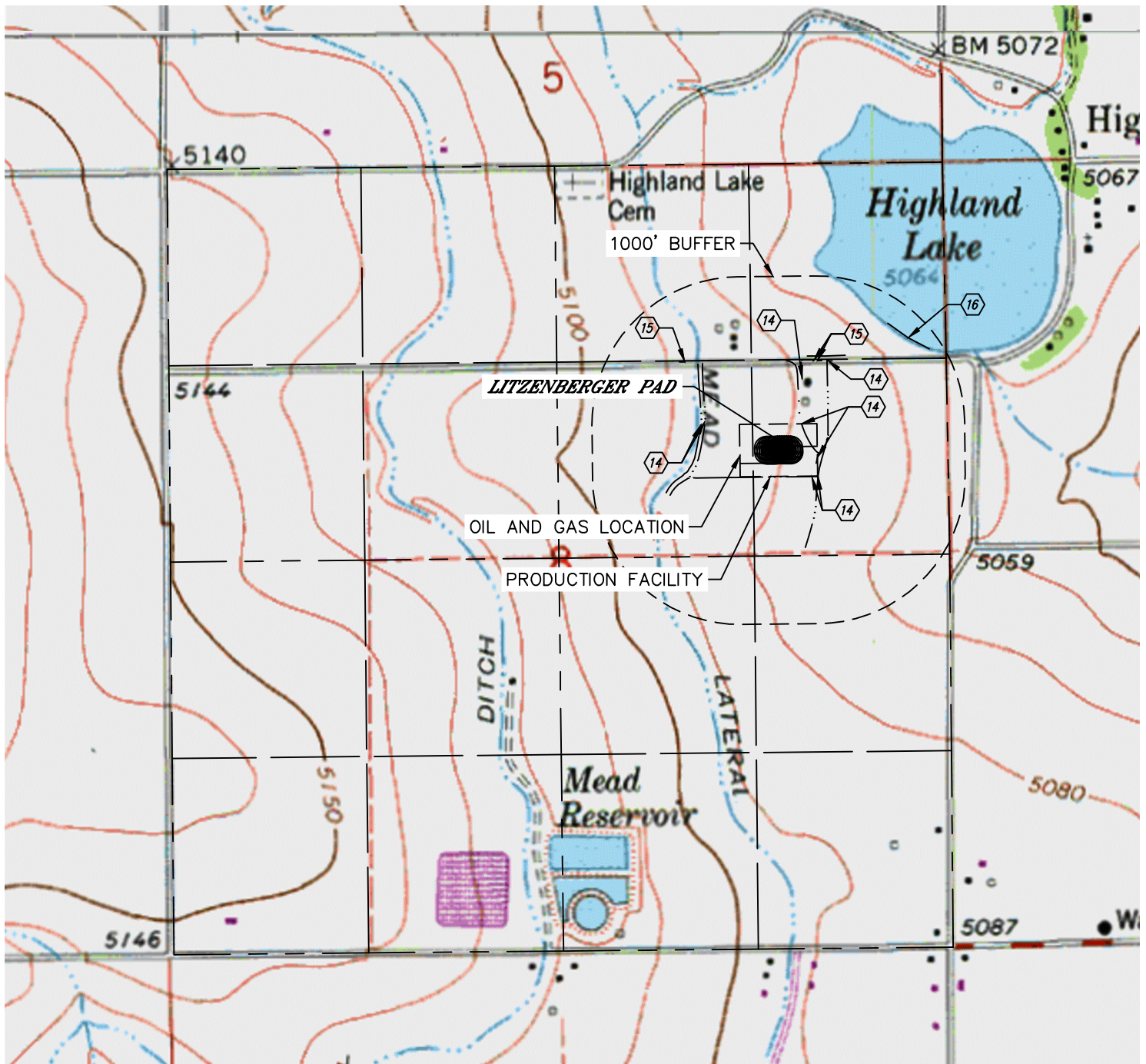

DISTANCES MEASURED FROM EDGE OF OIL AND GAS LOCATION.

- ⑭ DITCH 2-0' (INSIDE OIL AND GAS LOCATION), 3' E, 4' S, 237' & 262' NW, 304' N, 435' NE
- ⑮ BARROW DITCH 424', 426', 458' N, 563' NW
- ⑯ LAKE 848' NE

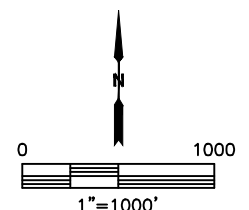

DATE: 6/4/2015
PROJECT#: 2015065