

BONANZA CREEK OIL COMPANY

Location: COLORADO Slot: SLOT#08 STATE ANTELOPE 12-42-2HNB (1400'FNL & 373'FWL, SEC.02)
Field: WELD COUNTY Well: STATE ANTELOPE 12-42-2HNB
Facility: SEC.02-T5N-R62W Wellbore: STATE ANTELOPE 12-42-2HNB PWB

Plot reference wellpath is STATE ANTELOPE 12-42-2HNB PWP (REV-A.0)

True vertical depths are referenced to XTREME 22 (17'KB) (RKB)	Grid System: NAD83 / Lambert Colorado SP, Northern Zone (601), US feet
Measured depths are referenced to XTREME 22 (17'KB) (RKB)	North Reference: True north
XTREME 22 (17'KB) (RKB) to Mean Sea Level: 4664 feet	Scale: True distance
Mean Sea Level to Mud line (At Slot: SLOT#08 STATE ANTELOPE 12-42-2HNB (1400'FNL & 373'FWL, SEC.02)): 0 feet	Depths are in feet
Coordinates are in feet referenced to Slot	Created by: ingnjmvr on 10/16/2015

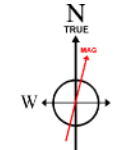

BGGM (1945.0 to 2017.0) Dip: 67.08° Field: 52700.8 nT
Magnetic North is 8.29 degrees East of True North (at 7/14/2015)

To correct azimuth from Magnetic to True add 8.29 degrees

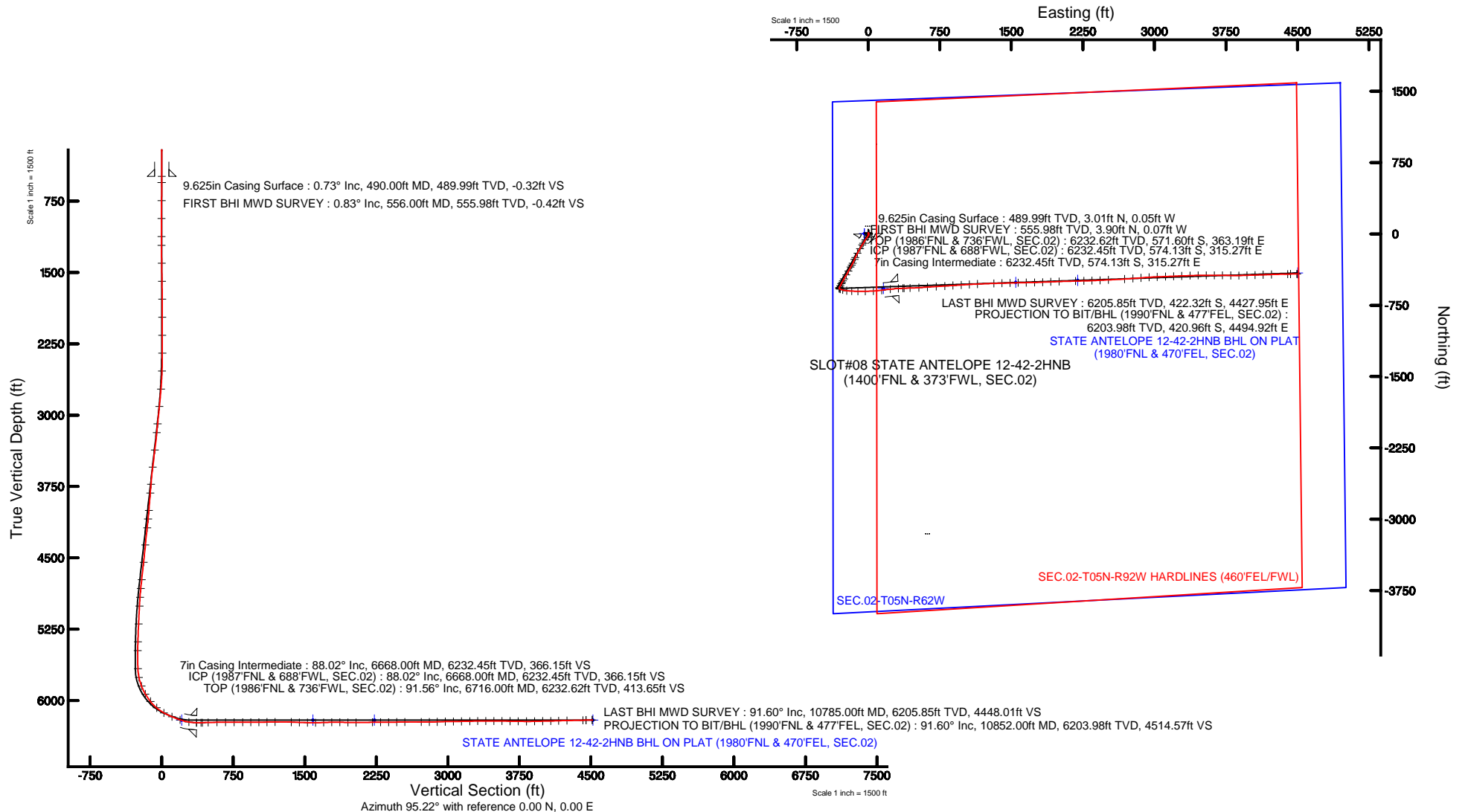



Actual Wellpath Report

STATE ANTELOPE 12-42-2HNB AWP

Page 1 of 5



REFERENCE WELLPATH IDENTIFICATION

Operator	BONANZA CREEK OIL COMPANY	Slot	SLOT#08 STATE ANTELOPE 12-42-2HNB (1400'FNL & 373'FWL, SEC.02)
Area	COLORADO	Well	STATE ANTELOPE 12-42-2HNB
Field	WELD COUNTY	Wellbore	STATE ANTELOPE 12-42-2HNB AWB
Facility	SEC.02-T5N-R62W		

REPORT SETUP INFORMATION

Projection System	NAD83 / Lambert Colorado SP, Northern Zone (501), US feet	Software System	WellArchitect® 4.1.1
North Reference	True	User	Ingmjmr
Scale	0.999962	Report Generated	10/16/2015 at 8:46:49 AM
Convergence at slot	0.78° East	Database/Source file	WA_DEN_Denver_Defn/STATE_ANTELOPE_12-42-2HNB_AWB.xml

WELLPATH LOCATION

	Local coordinates		Grid coordinates		Geographic coordinates	
	North[ft]	East[ft]	Easting[US ft]	Northing[US ft]	Latitude	Longitude
Slot Location	3152.05	-641.96	3334402.90	1402818.98	40°25'58.519"N	104°17'55.306"W
Facility Reference Pt			3335087.55	1399676.06	40°25'27.372"N	104°17'47.004"W
Field Reference Pt			3335925.10	1457282.25	40°34'56.460"N	104°17'26.016"W

WELLPATH DATUM

Calculation method	Minimum curvature	XTREME 22 (17'KB) (RKB) to Facility Vertical Datum	4664.00ft
Horizontal Reference Pt	Slot	XTREME 22 (17'KB) (RKB) to Mean Sea Level	4664.00ft
Vertical Reference Pt	XTREME 22 (17'KB) (RKB)	XTREME 22 (17'KB) (RKB) to Mud Line at Slot (SLOT#08 STATE ANTELOPE 12-42-2HNB (1400'FNL & 373'FWL, SEC.02))	4664.00ft
MD Reference Pt	XTREME 22 (17'KB) (RKB)	Section Origin	N 0.00, E 0.00 ft
Field Vertical Reference	Mean Sea Level	Section Azimuth	95.22°



Actual Wellpath Report

STATE ANTELOPE 12-42-2HNB AWP

Page 2 of 5



REFERENCE WELLPATH IDENTIFICATION

Operator	BONANZA CREEK OIL COMPANY	Slot	SLOT#08 STATE ANTELOPE 12-42-2HNB (1400'FNL & 373'FWL, SEC.02)
Area	COLORADO	Well	STATE ANTELOPE 12-42-2HNB
Field	WELD COUNTY	Wellbore	STATE ANTELOPE 12-42-2HNB AWB
Facility	SEC.02-T5N-R62W		

WELLPATH DATA (92 stations) † = interpolated/extrapolated station

MD [ft]	Inclination [°]	Azimuth [°]	TVD [ft]	Vert Sect [ft]	North [ft]	East [ft]	DLS [°/100ft]	Comments
0.00†	0.000	359.010	0.00	0.00	0.00	0.00	0.00	
17.00	0.000	359.010	17.00	0.00	0.00	0.00	0.00	
556.00	0.830	359.010	555.98	-0.42	3.90	-0.07	0.15	FIRST BHI MWD SURVEY
744.00	0.850	351.820	743.96	-0.89	6.65	-0.29	0.06	
933.00	0.820	348.270	932.94	-1.61	9.36	-0.76	0.03	
1123.00	0.240	10.010	1122.93	-1.97	11.08	-0.97	0.32	
1216.00	0.370	57.250	1215.93	-1.72	11.43	-0.68	0.29	
1404.00	1.300	147.400	1403.91	0.07	9.97	0.97	0.72	
1593.00	1.620	142.420	1592.85	3.19	6.04	3.76	0.18	
1781.00	0.620	177.400	1780.82	5.14	2.92	5.43	0.62	
1970.00	0.560	167.560	1969.81	5.56	1.00	5.67	0.06	
2160.00	0.480	147.420	2159.80	6.33	-0.58	6.30	0.10	
2348.00	2.330	189.100	2347.74	6.55	-5.02	6.12	1.06	
2537.00	4.330	210.070	2536.41	3.29	-14.99	1.94	1.22	
2728.00	9.560	215.900	2725.95	-7.84	-34.09	-10.99	2.76	
2914.00	11.960	211.980	2908.67	-24.40	-62.95	-30.25	1.35	
3102.00	13.550	211.920	3092.02	-43.08	-98.17	-52.22	0.85	
3196.00	12.100	210.180	3183.67	-52.18	-116.04	-62.99	1.60	
3384.00	16.500	210.570	3365.81	-71.94	-156.07	-86.49	2.34	
3573.00	16.650	208.950	3546.95	-94.33	-202.88	-113.24	0.26	
3759.00	14.450	203.260	3726.14	-112.25	-247.52	-135.31	1.44	
3854.00	14.320	203.660	3818.17	-119.64	-269.17	-144.71	0.17	
4042.00	12.500	206.150	4001.03	-134.27	-308.74	-163.00	1.02	
4136.00	14.820	209.060	4092.37	-142.76	-328.38	-173.33	2.57	
4230.00	15.300	209.300	4183.14	-152.68	-349.70	-185.24	0.51	
4417.00	13.530	207.580	4364.25	-171.08	-390.61	-207.44	0.97	
4605.00	15.290	210.310	4546.33	-189.96	-431.51	-230.13	1.00	
4794.00	14.070	209.630	4729.15	-210.02	-472.99	-254.07	0.65	
4889.00	13.440	210.360	4821.43	-219.49	-492.56	-265.36	0.69	
4983.00	11.040	207.700	4913.29	-227.57	-509.95	-275.07	2.62	
5078.00	8.800	203.030	5006.86	-233.28	-524.70	-282.14	2.50	
5267.00	6.630	210.660	5194.15	-242.39	-547.39	-293.36	1.27	
5455.00	4.260	205.280	5381.28	-249.45	-563.04	-301.88	1.29	
5549.00	4.270	196.300	5475.03	-251.32	-569.56	-304.35	0.71	
5738.00	2.190	113.160	5663.79	-249.23	-577.74	-303.00	2.41	
5832.00	11.500	109.840	5757.02	-238.43	-581.63	-292.52	9.91	
5926.00	21.640	105.670	5847.00	-212.25	-589.51	-266.95	10.85	
6020.00	30.730	98.030	5931.29	-171.12	-597.57	-226.38	10.30	
6114.00	38.200	91.630	6008.76	-118.03	-601.76	-173.45	8.82	
6208.00	50.240	90.870	6076.01	-52.76	-603.14	-108.03	12.82	
6301.00	60.150	89.670	6129.02	23.22	-603.45	-31.77	10.71	
6395.00	68.240	86.490	6169.92	107.09	-600.54	52.72	9.13	
6489.00	70.950	83.050	6202.70	193.71	-592.49	140.43	4.48	
6584.00	81.830	83.450	6225.02	283.90	-581.66	231.99	11.46	
6668.00†	88.019	86.204	6232.45	366.15	-574.13	315.27	8.06	CP (1987'FNL & 688'FWL, SEC.02)



Actual Wellpath Report

STATE ANTELOPE 12-42-2HNB AWP

Page 3 of 5



REFERENCE WELLPATH IDENTIFICATION

Operator	BONANZA CREEK OIL COMPANY	Slot	SLOT#08 STATE ANTELOPE 12-42-2HNB (1400'FNL & 373'FWL, SEC.02)
Area	COLORADO	Well	STATE ANTELOPE 12-42-2HNB
Field	WELD COUNTY	Wellbore	STATE ANTELOPE 12-42-2HNB AWB
Facility	SEC.02-T5N-R62W		

WELLPATH DATA (92 stations) † = interpolated/extrapolated station

MD [ft]	Inclination [°]	Azimuth [°]	TVD [ft]	Vert Sect [ft]	North [ft]	East [ft]	DLS [°/100ft]	Comments
6716.00†	91.558	87.764	6232.62	413.65	-571.60	363.19	8.06	TOP (1986'FNL & 736'FWL, SEC.02)
6730.00	92.590	88.220	6232.12	427.53	-571.11	377.18	8.06	
6791.00	91.130	88.430	6230.14	488.05	-569.33	438.12	2.42	
6883.00	91.460	86.470	6228.06	579.18	-565.24	530.00	2.16	
6974.00	90.030	86.630	6226.88	669.13	-559.76	620.82	1.58	
7066.00	89.750	86.250	6227.05	760.06	-554.05	712.64	0.51	
7157.00	90.460	86.360	6226.89	849.96	-548.19	803.45	0.79	
7242.00	89.780	86.260	6226.71	933.93	-542.71	888.28	0.81	
7329.00	89.960	86.540	6226.90	1019.90	-537.25	975.10	0.38	
7415.00	91.140	86.520	6226.08	1104.91	-532.05	1060.94	1.37	
7500.00	90.860	87.350	6224.60	1189.01	-527.50	1145.81	1.03	
7671.00	88.190	88.310	6226.01	1358.57	-521.03	1316.66	1.66	
7756.00	87.750	88.430	6229.02	1442.91	-518.61	1401.57	0.54	
7842.00	88.970	88.660	6231.49	1528.29	-516.43	1487.51	1.44	
7927.00	90.420	88.610	6231.94	1612.73	-514.40	1572.48	1.71	
8012.00	91.850	88.780	6230.25	1697.16	-512.47	1657.44	1.69	
8098.00	91.730	88.690	6227.57	1782.57	-510.57	1743.38	0.17	
8183.00	88.180	87.620	6227.63	1866.91	-507.84	1828.32	4.36	
8269.00	88.680	87.960	6229.99	1952.16	-504.52	1914.22	0.70	
8355.00	90.120	87.820	6230.89	2037.45	-501.35	2000.15	1.68	
8529.00	91.600	88.720	6228.28	2210.14	-496.10	2174.05	1.00	
8615.00	90.220	88.760	6226.91	2295.58	-494.21	2260.02	1.61	
8700.00	89.910	87.620	6226.82	2379.94	-491.53	2344.97	1.39	
8786.00	90.860	87.400	6226.24	2465.16	-487.79	2430.89	1.13	
8872.00	90.460	87.510	6225.25	2550.37	-483.97	2516.80	0.48	
9044.00	89.510	86.240	6225.29	2720.55	-474.60	2688.54	0.92	
9130.00	90.620	86.070	6225.20	2805.47	-468.83	2774.34	1.31	
9215.00	91.890	85.640	6223.34	2889.32	-462.69	2859.10	1.58	
9301.00	91.170	86.220	6221.04	2974.16	-456.59	2944.85	1.07	
9386.00	90.220	87.890	6220.01	3058.29	-452.22	3029.73	2.26	
9473.00	91.600	87.690	6218.63	3144.55	-448.86	3116.65	1.60	
9559.00	91.050	87.560	6216.64	3229.77	-445.30	3202.55	0.66	
9644.00	90.860	88.030	6215.22	3314.05	-442.03	3287.47	0.60	
9730.00	90.520	87.730	6214.19	3399.34	-438.85	3373.41	0.53	
9815.00	88.950	89.650	6214.58	3483.78	-436.91	3458.38	2.92	
9900.00	89.960	89.370	6215.39	3568.35	-436.18	3543.37	1.23	
9986.00	88.690	90.150	6216.40	3653.95	-435.82	3629.36	1.73	
10071.00	89.160	90.580	6217.99	3738.63	-436.36	3714.35	0.75	
10157.00	89.810	91.040	6218.77	3824.38	-437.58	3800.33	0.93	
10242.00	91.140	89.270	6218.06	3909.04	-437.81	3885.32	2.60	
10328.00	91.410	87.980	6216.15	3994.44	-435.74	3971.28	1.53	
10413.00	91.040	88.260	6214.33	4078.77	-432.96	4056.21	0.55	
10498.00	91.820	87.960	6212.21	4163.09	-430.15	4141.14	0.98	
10584.00	91.180	88.250	6209.96	4248.40	-427.31	4227.06	0.82	
10754.00	91.100	88.810	6206.58	4417.21	-422.95	4396.97	0.33	



Actual Wellpath Report

STATE ANTELOPE 12-42-2HNB AWP

Page 4 of 5



REFERENCE WELLPATH IDENTIFICATION

Operator	BONANZA CREEK OIL COMPANY	Slot	SLOT#08 STATE ANTELOPE 12-42-2HNB (1400'FNL & 373'FWL, SEC.02)
Area	COLORADO	Well	STATE ANTELOPE 12-42-2HNB
Field	WELD COUNTY	Wellbore	STATE ANTELOPE 12-42-2HNB AWB
Facility	SEC.02-T5N-R62W		

WELLPATH DATA (92 stations)

MD [ft]	Inclination [°]	Azimuth [°]	TVD [ft]	Vert Sect [ft]	North [ft]	East [ft]	DLS [°/100ft]	Comments
10785.00	91.600	88.840	6205.85	4448.01	-422.32	4427.95	1.62	LAST BHI MWD SURVEY
10852.00	91.600	88.840	6203.98	4514.57	-420.96	4494.92	0.00	PROJECTION TO BIT/BHL (1990'FNL & 477'FEL, SEC.02)

HOLE & CASING SECTIONS

- Ref Wellbore: STATE ANTELOPE 12-42-2HNB AWB Ref Wellpath: STATE ANTELOPE 12-42-2HNB AWP

String/Diameter	Start MD [ft]	End MD [ft]	Interval [ft]	Start TVD [ft]	End TVD [ft]	Start N/S [ft]	Start E/W [ft]	End N/S [ft]	End E/W [ft]
9.625in Casing Surface	17.00	490.00	473.00	17.00	489.99	0.00	0.00	3.01	-0.05
8.75in Open Hole	490.00	6685.00	6195.00	489.99	6232.85	3.01	-0.05	-573.08	332.23
7in Casing Intermediate	17.00	6668.00	6651.00	17.00	6232.45	0.00	0.00	-574.13	315.27
6.125in Open Hole	6685.00	10852.00	4167.00	6232.85	6203.98	-573.08	332.23	-420.96	4494.92

TARGETS

Name	TVD [ft]	North [ft]	East [ft]	Grid East [US ft]	Grid North [US ft]	Latitude	Longitude	Shape
SEC.02-T05N-R62W	2.00	1.09	-39.78	3334363.11	1402819.53	40°25'58.530"N	104°17'55.820"W	polygon
STATE ANTELOPE 12-42-2HNB BHL ON PLAT (1980'FNL & 470'FEL, SEC.02)	6205.00	-410.54	4502.14	3338910.00	1402469.48	40°25'54.458"N	104°16'57.086"W	point
STATE ANTELOPE 12-42-2HNB EP (1980'FNL & 531'FEL, SEC.02)	6205.00	-573.79	158.41	3334569.05	1402247.41	40°25'52.849"N	104°17'53.257"W	point
STATE ANTELOPE 12-42-2HNB TARGET 1 (300' PRIOR)	6205.00	-510.42	1545.88	3335955.49	1402329.57	40°25'53.475"N	104°17'35.315"W	point
STATE ANTELOPE 12-42-2HNB TARGET 2 (150' AFTER)	6205.00	-488.47	2195.57	3336604.79	1402360.32	40°25'53.691"N	104°17'26.914"W	point
SEC.02-T05N-R92W HARDLINES (460'FEL/FWL)	6207.00	1.09	-39.78	3334363.11	1402819.53	40°25'58.530"N	104°17'55.820"W	polygon
Ex.Grace State #2-1 200'R	6925.00	908.84	3420.96	3337811.10	1403774.04	40°26'07.498"N	104°17'11.065"W	circle

WELLPATH COMPOSITION - Ref Wellbore: STATE ANTELOPE 12-42-2HNB AWB Ref Wellpath: STATE ANTELOPE 12-42-2HNB AWP

Start MD [ft]	End MD [ft]	Positional Uncertainty Model	Log Name/Comment	Wellbore
17.00	6584.00	NaviTrak (Standard)	BHI MWD/NAVITRAK (STD) 8.75" HOLE <556-6584>	STATE ANTELOPE 12-42-2HNB AWB
6584.00	10785.00	NaviTrak (Standard)	BHI MWD/NAVITRAK (STD) 6.125" HOLE <6730-10785>	STATE ANTELOPE 12-42-2HNB AWB
10785.00	10852.00	Blind Drilling (std)	Projection to bit	STATE ANTELOPE 12-42-2HNB AWB



Actual Wellpath Report

STATE ANTELOPE 12-42-2HNB AWP

Page 5 of 5



REFERENCE WELLPATH IDENTIFICATION

Operator	BONANZA CREEK OIL COMPANY	Slot	SLOT#08 STATE ANTELOPE 12-42-2HNB (1400'FNL & 373'FWL, SEC.02)
Area	COLORADO	Well	STATE ANTELOPE 12-42-2HNB
Field	WELD COUNTY	Wellbore	STATE ANTELOPE 12-42-2HNB AWB
Facility	SEC.02-T5N-R62W		

WELLPATH COMMENTS

MD [ft]	Inclination [°]	Azimuth [°]	TVD [ft]	Comment
556.00	0.830	359.010	555.98	FIRST BHI MWD SURVEY
6668.00	88.019	86.204	6232.45	ICP (1987'FNL & 688'FWL, SEC.02)
6716.00	91.558	87.764	6232.62	TOP (1986'FNL & 736'FWL, SEC.02)
10785.00	91.600	88.840	6205.85	LAST BHI MWD SURVEY
10852.00	91.600	88.840	6203.98	PROJECTION TO BIT/BHL (1990'FNL & 477'FWL, SEC.02)