



August 26, 2015

Mr. Matt Lepore, Director  
Colorado Oil and Gas Conservation Commission  
1120 Lincoln Street, Suite 801  
Denver, Colorado 80203

7535 Hilltop Circle  
Denver, CO 80221  
[www.petro-fs.com](http://www.petro-fs.com)

**RE: COGCC Rule 318A.e.: Proposed Spacing Unit  
Wilkinson E-12HC Well: SWSW Section 1, Township 6 North, Range 65 West  
Weld County, Colorado**

Dear Mr. Lepore:

Bayswater Exploration & Production, LLC (Bayswater) is planning to drill the above referenced well in accordance with the provisions set out in Colorado Oil and Gas Conservation Commission (COGCC) Rule 318A.e. Bayswater's Proposed Spacing Unit consists of:

S½SW¼ of Section 1, Township 6 North, Range 65 West  
W½ of Section 12, Township 6 North, Range 65 West  
Containing 400.00 acres, more or less

Bayswater is not the only owner within the Proposed Spacing Unit and has provided notice to the remaining owners, as required by COGCC Rule 318A.e.(6). Copies of the required notification letters are on file at Bayswater's office. The required thirty (30) day notice period has elapsed absent the receipt by Bayswater of any objection to their proposal by the owners within the Proposed Spacing Unit for the subject well.

Enclosed is the Proposed Spacing Unit Exhibit to assist in your review and approval of Bayswater's proposed Application for Permit to Drill for the Wilkinson E-12HC Well. Many thanks for your attention to this matter.

Respectfully,

Jennifer Grosshans  
Regulatory Analyst  
Agent for Bayswater Exploration & Production, LLC

:jg

Enclosure: Proposed Spacing Unit Exhibit

*We are what we repeatedly do. Excellence, then, is not an act, but a habit.*

*-Aristotle*

**WILKINSON 1-P PAD  
PROPOSED 318A.e. SPACING UNIT  
SEC. 1: S2SW4  
SEC. 12: W2**

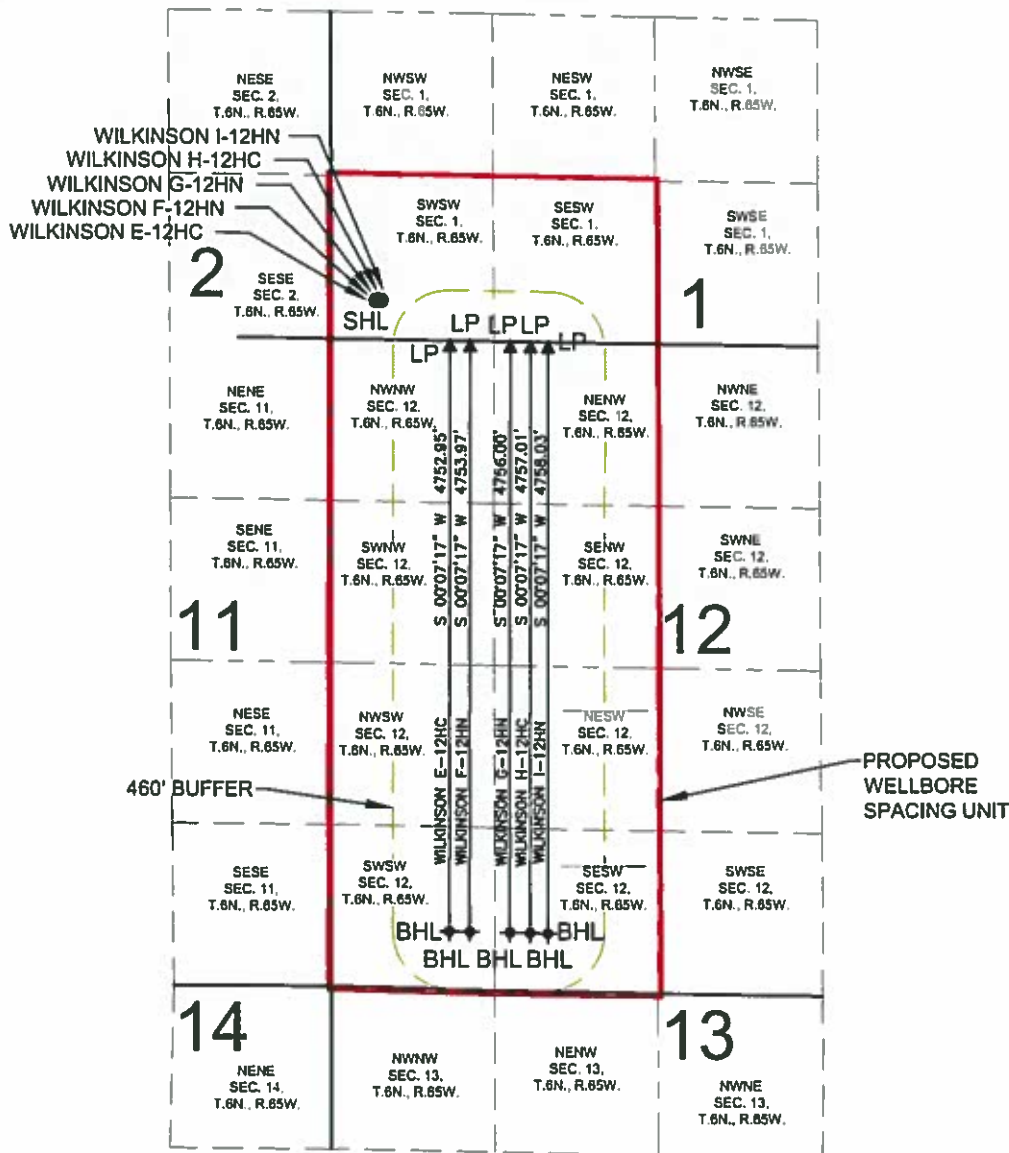

**WELL WILKINSON E-12HC TO BE LOCATED 316' FSL AND 360' FWL, SEC. 1, T6N, R65W**  
**WELL WILKINSON F-12HN TO BE LOCATED 316' FSL AND 375' FWL, SEC. 1, T6N, R65W**  
**WELL WILKINSON G-12HN TO BE LOCATED 316' FSL AND 390' FWL, SEC. 1, T6N, R65W**  
**WELL WILKINSON H-12HC TO BE LOCATED 316' FSL AND 405' FWL, SEC. 1, T6N, R65W**  
**WELL WILKINSON I-12HN TO BE LOCATED 316' FSL AND 420' FWL, SEC. 1, T6N, R65W**

**LEGEND**

● = PROPOSED WELL  
 ▲ = LANDING POINT  
 ✦ = BOTTOM HOLE  
 SHL = SURFACE HOLE  
 LP = LANDING POINT  
 BHL = BOTTOM HOLE

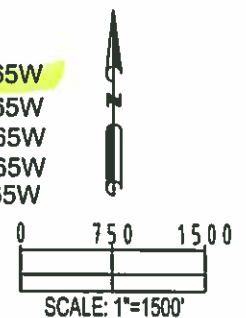

PREPARED BY

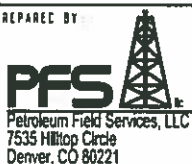

FIELD DATE:

06-23-15

DRAWING DATE:

07-14-15

BY

CSG

CHECKED BY:

MDC

SITE NAME:

WILKINSON 1-P PAD

SURFACE LOCATION:

SW 1/4 SW 1/4, SEC. 1, T6N, R65W, 6TH P.M.

WELD COUNTY, COLORADO

PREPARED FOR:

