

THOMAS 16-C PAD LOCATION DRAWING

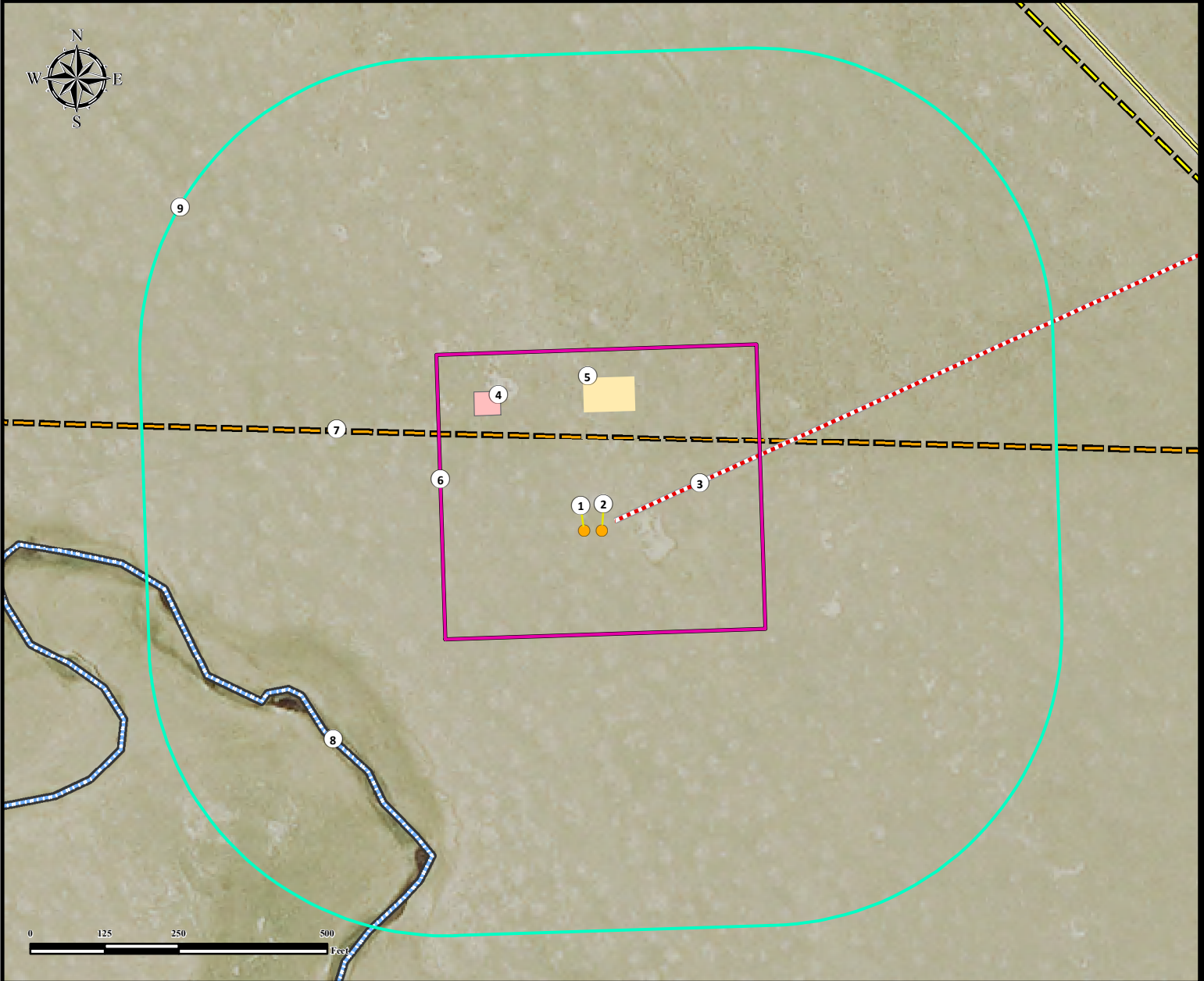

1. Proposed Well THOMAS EAST 1.
2. Proposed Well THOMAS EAST 2.
3. Proposed Access Road.
4. Proposed Separator Pad.
5. Proposed Tank Battery.
6. Operational Disturbance Area.
7. Fence is ±160' N.
8. Spring Creek is ±545' SW.
9. 500' Radius.

Legend

- | | | |
|------------------------|-----------------------|-------------|
| Proposed Well | Disturbance Area | Powerline |
| 500' Radius | Proposed Tank Battery | Public Road |
| Proposed Separator Pad | Proposed Access Road | Creek |
| | Fence | |

Measured from Nearest Well or Facility

Building -	±1693' E
Building Unit -	±1734' E
Surface Water (Creek) -	±545' SW
Public Road - (CR 17)	±966' NE
Prop. Line (THOMAS RANCH LLC)	±98' N
Utility (Power Line) -	±929' NE
Railroad -	±5280' S

Measured from Nearest Well

Water Well - ±2899' SE Permit: 266166	SWL = 0' Receipt: 0543955
Water Well - ±3971' NE Permit: 63540	SWL = 10' Receipt: 9065011

Reference Location

**** THOMAS EAST 1 ****
 Lat: 40.840446°
 Long: -104.891594° (NAD83)
 Elevation: 5587 Feet
 345' FNL & 1336' FEL
 PDOP: 1.3
 Operator: Ben Hardenbergh

Disturbance Acreage:

5.95 Acres Drilling Operations
 2.97 Acres Interim Reclaim

Current Surface Use: Rangeland
 Future Surface Use: Rangeland



FIELD DATE:
03-27-15

DRAWING DATE:
04-27-15

BY:
CSG

CHECKED BY:
FMB

SITE NAME:
THOMAS 16-C PAD

SURFACE LOCATION:
NW1/4 NE1/4, SEC. 16, T10N, R67W, 6TH P.M.
WELD COUNTY, COLORADO

PREPARED FOR:

