

FRANE SURVEYING INC.

Physical Address: 34834 Annie Cir.
Mail to: Box 2372, Elizabeth, CO 80107
Ph. 303-243-0037
www.franesurveying.com

Job # 026-15 Stevens 15-45 #1-1

Frane Surveying Inc., has in accordance with a request from Angus Natural Resources LLC has determined the location of Stevens 15-45 #1-1 to be 1951 feet FNL, and 1110 feet FEL, (90° off Section lines) of SECTION 1, Township 15s, Range 45w of the 6th Principal Meridian, Cheyenne County, Colorado.

Date: Staked on 09/10/15 drawn on 09/14/2015

Re: Staked by Elijah Frane
Drawn: Drawn by Elijah Frane

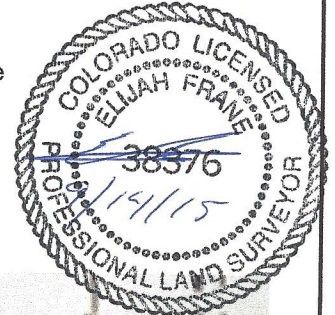

500' Location Drawing

