



September 22, 2015

Mr. Matt Lepore, Director
Colorado Oil and Gas Conservation Commission
1120 Lincoln Street
Suite 801
Denver, CO 80203

RE: COGCC Rule 318A.e.: Proposed Wellbore Spacing Unit
SRC Vista 44-2C
S/2 Section 2 Township 4N Range 68 West
Weld County, Colorado

Dear Mr. Lepore,

Synergy Resources Corporation (SRC) is planning to drill the above referenced well in accordance with the provisions set out in COGCC Rule 318A.e. Synergy's proposed wellbore spacing unit consists of:

SRC Vista 44-2C
S/2 Section 2 Township 4N Range 68 West
Spacing Unit 320 Acres

Synergy is not the only owner within the proposed wellbore spacing unit and has provided notice to the remaining owner(s) within this spacing unit, as required by COGCC Rule 318A.e. (6). Copies of the required notification letters are on file at Synergy's office. The required thirty (30) day notice period has elapsed absent the receipt by Synergy of any objection to their proposal by the owner(s) within the proposed spacing unit for the subject well.

Enclosed is the Proposed Spacing Unit Plat to assist in your review and approval of Synergy's proposed Application for Permit to Drill (APD) for SRC Vista 44-2C well. Synergy respectfully requests the COGCC to review the enclosed information and approve the requested exception location waiver and APD for SRC Vista 44-2C.

Thank you,

A handwritten signature in black ink, appearing to read 'Erin Ekblad', written in a cursive style.

Erin Ekblad
Manager of Regulatory Affairs
Synergy Resources Corporation

Attachment: Proposed Spacing Unit Plats

WELL BORE SPACING UNIT

SRC VISTA 44-2C

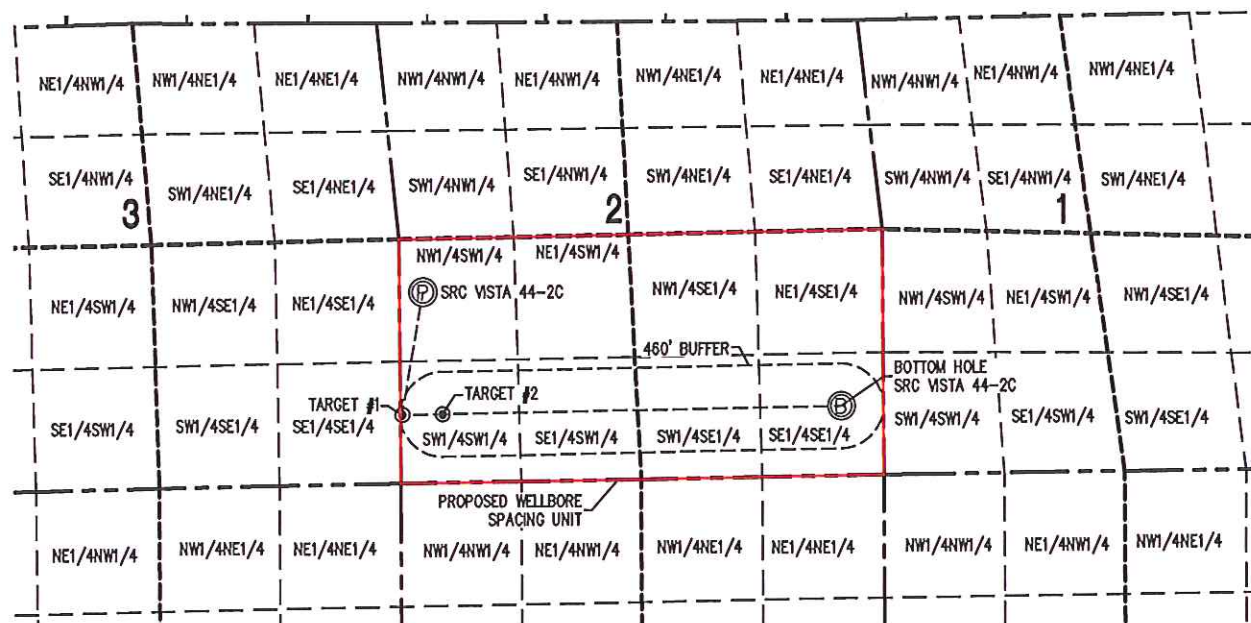
SECTION 2
TOWNSHIP 4 NORTH
RANGE 68 WEST

SURFACE HOLE:
 LATITUDE: 40.341173' N
 LONGITUDE: 104.978905' W
 BOTTOM HOLE:
 LATITUDE: 40.337691' N
 LONGITUDE: 104.962435' W

TARGET #1:
 LATITUDE: 40.337538' N
 LONGITUDE: 104.979722' W
 TARGET #2:
 LATITUDE: 40.337553' N
 LONGITUDE: 104.978144' W

NOTES:

- 1) THIS SKETCH DOES NOT REPRESENT A BOUNDARY SURVEY.
- 2) THE DATUM FOR THE LATITUDES AND LONGITUDES ON THIS SKETCH IS NAD83.

