

Garden Creek 512-1807H

Surface Location

NAD 1927 (NADCON CONUS) Colorado North 501

Ground Elevation: 5225.0 WELL @ 5250.0usft (Original Well Elev)

Northing	Easting	Latitude	Longitude
579038.71	2313636.00	40° 55' 2.453 N	104° 21' 54.790 W

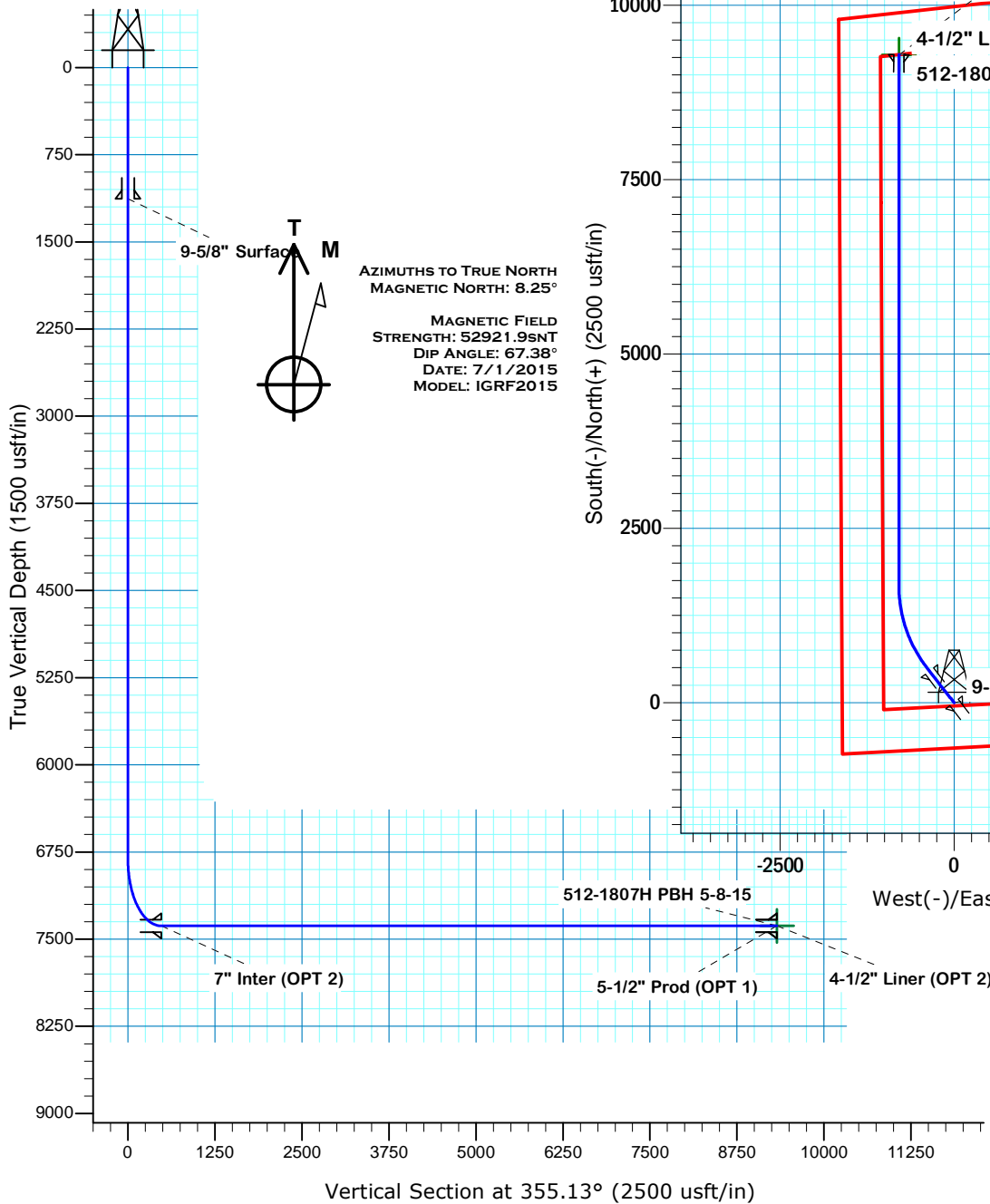

Project: DJ - Hereford Ranch
 Site: Garden Creek 18 SESW Pad
 Well: Garden Creek 512-1807H
 Planner: M.Thompson
 9:07, July 01 2015

SECTION DETAILS

Sec	MD	Inc	Azi	TVD	+N/-S	+E/-W	Dleg	TFace	Vsect	Target
1	0.0	0.00	0.00	0.0	0.0	0.0	0.00	0.00	0.0	
2	6813.0	0.00	0.00	6813.0	0.0	0.0	0.00	0.00	0.0	
3	7713.0	90.00	322.00	7386.0	451.5	-352.7	10.00	322.00	479.8	
4	7770.0	90.00	322.00	7386.0	496.4	-387.8	0.00	0.00	527.6	
5	9036.7	90.00	0.00	7386.0	1672.3	-792.7	3.00	90.00	1733.6	512-1807H PBH 5-8-15
6	16656.2	90.00	0.00	7386.0	9291.8	-792.5	0.00	0.00	9325.5	512-1807H PBH 5-8-15

TARGET DETAILS

Name	TVD	+N/-S	+E/-W	Northing	Easting	Latitude	Longitude	Shape
512-1807H PBH 5-8-15	7386.0	9291.8	-792.5	588319.61	2312724.68	40° 56' 34.262 N	104° 22' 5.116 W	Point

Denver Division- Colorado

**DJ - Hereford Ranch
Garden Creek 18 SESW Pad
Garden Creek 512-1807H**

Wellbore #1

Plan: APD Plan (Plat 5-8-15)

Standard Planning Report

01 July, 2015

EOG Resources, Inc.

Planning Report

Database:	EDM_DENVER	Local Co-ordinate Reference:	Well Garden Creek 512-1807H
Company:	Denver Division- Colorado	TVD Reference:	WELL @ 5250.0usft (Original Well Elev)
Project:	DJ - Hereford Ranch	MD Reference:	WELL @ 5250.0usft (Original Well Elev)
Site:	Garden Creek 18 SESW Pad	North Reference:	True
Well:	Garden Creek 512-1807H	Survey Calculation Method:	Minimum Curvature
Wellbore:	Wellbore #1		
Design:	APD Plan (Plat 5-8-15)		

Project	DJ - Hereford Ranch, Weld County		
Map System:	US State Plane 1927 (Exact solution)	System Datum:	Mean Sea Level
Geo Datum:	NAD 1927 (NADCON CONUS)		
Map Zone:	Colorado North 501		

Site	Garden Creek 18 SESW Pad		
Site Position:		Northing:	579,038.71 usft
From:	Map	Easting:	2,313,636.00 usft
Position Uncertainty:	0.0 usft	Slot Radius:	13-3/16 "
		Latitude:	40° 55' 2.453 N
		Longitude:	104° 21' 54.790 W
		Grid Convergence:	0.73 °

Well	Garden Creek 512-1807H		
Well Position	+N/-S	0.0 usft	Northing: 579,038.71 usft
	+E/-W	0.0 usft	Easting: 2,313,636.00 usft
Position Uncertainty	0.0 usft	Wellhead Elevation:	0.0 usft
		Latitude:	40° 55' 2.453 N
		Longitude:	104° 21' 54.790 W
		Ground Level:	5,225.0 usft

Wellbore	Wellbore #1				
Magnetics	Model Name	Sample Date	Declination (°)	Dip Angle (°)	Field Strength (nT)
	IGRF2015	7/1/2015	8.25	67.38	52,922

Design	APD Plan (Plat 5-8-15)			
Audit Notes:				
Version:	Phase:	PROTOTYPE	Tie On Depth:	0.0
Vertical Section:	Depth From (TVD) (usft)	+N/-S (usft)	+E/-W (usft)	Direction (°)
	0.0	0.0	0.0	355.13

Plan Sections										
Measured Depth (usft)	Inclination (°)	Azimuth (°)	Vertical Depth (usft)	+N/-S (usft)	+E/-W (usft)	Dogleg Rate (°/100usft)	Build Rate (°/100usft)	Turn Rate (°/100usft)	TFO (°)	Target
0.0	0.00	0.00	0.0	0.0	0.0	0.00	0.00	0.00	0.00	
6,813.0	0.00	0.00	6,813.0	0.0	0.0	0.00	0.00	0.00	0.00	
7,713.0	90.00	322.00	7,386.0	451.5	-352.7	10.00	10.00	0.00	322.00	
7,770.0	90.00	322.00	7,386.0	496.4	-387.8	0.00	0.00	0.00	0.00	
9,036.7	90.00	0.00	7,386.0	1,672.3	-792.7	3.00	0.00	3.00	90.00	512-1807H PBH 5-8-'
16,656.2	90.00	0.00	7,386.0	9,291.8	-792.5	0.00	0.00	0.00	0.00	512-1807H PBH 5-8-'

EOG Resources, Inc.

Planning Report

Database:	EDM_DENVER	Local Co-ordinate Reference:	Well Garden Creek 512-1807H
Company:	Denver Division- Colorado	TVD Reference:	WELL @ 5250.0usft (Original Well Elev)
Project:	DJ - Hereford Ranch	MD Reference:	WELL @ 5250.0usft (Original Well Elev)
Site:	Garden Creek 18 SESW Pad	North Reference:	True
Well:	Garden Creek 512-1807H	Survey Calculation Method:	Minimum Curvature
Wellbore:	Wellbore #1		
Design:	APD Plan (Plat 5-8-15)		

Planned Survey									
Measured Depth (usft)	Inclination (°)	Azimuth (°)	Vertical Depth (usft)	+N/-S (usft)	+E/-W (usft)	Vertical Section (usft)	Dogleg Rate (°/100usft)	Build Rate (°/100usft)	Turn Rate (°/100usft)
0.0	0.00	0.00	0.0	0.0	0.0	0.0	0.00	0.00	0.00
100.0	0.00	0.00	100.0	0.0	0.0	0.0	0.00	0.00	0.00
200.0	0.00	0.00	200.0	0.0	0.0	0.0	0.00	0.00	0.00
300.0	0.00	0.00	300.0	0.0	0.0	0.0	0.00	0.00	0.00
400.0	0.00	0.00	400.0	0.0	0.0	0.0	0.00	0.00	0.00
500.0	0.00	0.00	500.0	0.0	0.0	0.0	0.00	0.00	0.00
600.0	0.00	0.00	600.0	0.0	0.0	0.0	0.00	0.00	0.00
700.0	0.00	0.00	700.0	0.0	0.0	0.0	0.00	0.00	0.00
800.0	0.00	0.00	800.0	0.0	0.0	0.0	0.00	0.00	0.00
900.0	0.00	0.00	900.0	0.0	0.0	0.0	0.00	0.00	0.00
1,000.0	0.00	0.00	1,000.0	0.0	0.0	0.0	0.00	0.00	0.00
1,100.0	0.00	0.00	1,100.0	0.0	0.0	0.0	0.00	0.00	0.00
1,130.0	0.00	0.00	1,130.0	0.0	0.0	0.0	0.00	0.00	0.00
9-5/8" Surface									
1,200.0	0.00	0.00	1,200.0	0.0	0.0	0.0	0.00	0.00	0.00
1,300.0	0.00	0.00	1,300.0	0.0	0.0	0.0	0.00	0.00	0.00
1,400.0	0.00	0.00	1,400.0	0.0	0.0	0.0	0.00	0.00	0.00
1,500.0	0.00	0.00	1,500.0	0.0	0.0	0.0	0.00	0.00	0.00
1,600.0	0.00	0.00	1,600.0	0.0	0.0	0.0	0.00	0.00	0.00
1,700.0	0.00	0.00	1,700.0	0.0	0.0	0.0	0.00	0.00	0.00
1,800.0	0.00	0.00	1,800.0	0.0	0.0	0.0	0.00	0.00	0.00
1,900.0	0.00	0.00	1,900.0	0.0	0.0	0.0	0.00	0.00	0.00
2,000.0	0.00	0.00	2,000.0	0.0	0.0	0.0	0.00	0.00	0.00
2,100.0	0.00	0.00	2,100.0	0.0	0.0	0.0	0.00	0.00	0.00
2,200.0	0.00	0.00	2,200.0	0.0	0.0	0.0	0.00	0.00	0.00
2,300.0	0.00	0.00	2,300.0	0.0	0.0	0.0	0.00	0.00	0.00
2,400.0	0.00	0.00	2,400.0	0.0	0.0	0.0	0.00	0.00	0.00
2,500.0	0.00	0.00	2,500.0	0.0	0.0	0.0	0.00	0.00	0.00
2,600.0	0.00	0.00	2,600.0	0.0	0.0	0.0	0.00	0.00	0.00
2,700.0	0.00	0.00	2,700.0	0.0	0.0	0.0	0.00	0.00	0.00
2,800.0	0.00	0.00	2,800.0	0.0	0.0	0.0	0.00	0.00	0.00
2,900.0	0.00	0.00	2,900.0	0.0	0.0	0.0	0.00	0.00	0.00
3,000.0	0.00	0.00	3,000.0	0.0	0.0	0.0	0.00	0.00	0.00
3,100.0	0.00	0.00	3,100.0	0.0	0.0	0.0	0.00	0.00	0.00
3,200.0	0.00	0.00	3,200.0	0.0	0.0	0.0	0.00	0.00	0.00
3,300.0	0.00	0.00	3,300.0	0.0	0.0	0.0	0.00	0.00	0.00
3,400.0	0.00	0.00	3,400.0	0.0	0.0	0.0	0.00	0.00	0.00
3,500.0	0.00	0.00	3,500.0	0.0	0.0	0.0	0.00	0.00	0.00
3,600.0	0.00	0.00	3,600.0	0.0	0.0	0.0	0.00	0.00	0.00
3,700.0	0.00	0.00	3,700.0	0.0	0.0	0.0	0.00	0.00	0.00
3,800.0	0.00	0.00	3,800.0	0.0	0.0	0.0	0.00	0.00	0.00
3,900.0	0.00	0.00	3,900.0	0.0	0.0	0.0	0.00	0.00	0.00
4,000.0	0.00	0.00	4,000.0	0.0	0.0	0.0	0.00	0.00	0.00
4,100.0	0.00	0.00	4,100.0	0.0	0.0	0.0	0.00	0.00	0.00
4,200.0	0.00	0.00	4,200.0	0.0	0.0	0.0	0.00	0.00	0.00
4,300.0	0.00	0.00	4,300.0	0.0	0.0	0.0	0.00	0.00	0.00
4,400.0	0.00	0.00	4,400.0	0.0	0.0	0.0	0.00	0.00	0.00
4,500.0	0.00	0.00	4,500.0	0.0	0.0	0.0	0.00	0.00	0.00
4,600.0	0.00	0.00	4,600.0	0.0	0.0	0.0	0.00	0.00	0.00
4,700.0	0.00	0.00	4,700.0	0.0	0.0	0.0	0.00	0.00	0.00
4,800.0	0.00	0.00	4,800.0	0.0	0.0	0.0	0.00	0.00	0.00
4,900.0	0.00	0.00	4,900.0	0.0	0.0	0.0	0.00	0.00	0.00
5,000.0	0.00	0.00	5,000.0	0.0	0.0	0.0	0.00	0.00	0.00
5,100.0	0.00	0.00	5,100.0	0.0	0.0	0.0	0.00	0.00	0.00

EOG Resources, Inc.

Planning Report

Database:	EDM_DENVER	Local Co-ordinate Reference:	Well Garden Creek 512-1807H
Company:	Denver Division- Colorado	TVD Reference:	WELL @ 5250.0usft (Original Well Elev)
Project:	DJ - Hereford Ranch	MD Reference:	WELL @ 5250.0usft (Original Well Elev)
Site:	Garden Creek 18 SESW Pad	North Reference:	True
Well:	Garden Creek 512-1807H	Survey Calculation Method:	Minimum Curvature
Wellbore:	Wellbore #1		
Design:	APD Plan (Plat 5-8-15)		

Planned Survey									
Measured Depth (usft)	Inclination (°)	Azimuth (°)	Vertical Depth (usft)	+N/-S (usft)	+E/-W (usft)	Vertical Section (usft)	Dogleg Rate (°/100usft)	Build Rate (°/100usft)	Turn Rate (°/100usft)
5,200.0	0.00	0.00	5,200.0	0.0	0.0	0.0	0.00	0.00	0.00
5,300.0	0.00	0.00	5,300.0	0.0	0.0	0.0	0.00	0.00	0.00
5,400.0	0.00	0.00	5,400.0	0.0	0.0	0.0	0.00	0.00	0.00
5,500.0	0.00	0.00	5,500.0	0.0	0.0	0.0	0.00	0.00	0.00
5,600.0	0.00	0.00	5,600.0	0.0	0.0	0.0	0.00	0.00	0.00
5,700.0	0.00	0.00	5,700.0	0.0	0.0	0.0	0.00	0.00	0.00
5,800.0	0.00	0.00	5,800.0	0.0	0.0	0.0	0.00	0.00	0.00
5,900.0	0.00	0.00	5,900.0	0.0	0.0	0.0	0.00	0.00	0.00
6,000.0	0.00	0.00	6,000.0	0.0	0.0	0.0	0.00	0.00	0.00
6,100.0	0.00	0.00	6,100.0	0.0	0.0	0.0	0.00	0.00	0.00
6,200.0	0.00	0.00	6,200.0	0.0	0.0	0.0	0.00	0.00	0.00
6,300.0	0.00	0.00	6,300.0	0.0	0.0	0.0	0.00	0.00	0.00
6,400.0	0.00	0.00	6,400.0	0.0	0.0	0.0	0.00	0.00	0.00
6,500.0	0.00	0.00	6,500.0	0.0	0.0	0.0	0.00	0.00	0.00
6,600.0	0.00	0.00	6,600.0	0.0	0.0	0.0	0.00	0.00	0.00
6,700.0	0.00	0.00	6,700.0	0.0	0.0	0.0	0.00	0.00	0.00
6,800.0	0.00	0.00	6,800.0	0.0	0.0	0.0	0.00	0.00	0.00
6,813.0	0.00	0.00	6,813.0	0.0	0.0	0.0	0.00	0.00	0.00
6,900.0	8.70	322.00	6,899.7	5.2	-4.1	5.5	10.00	10.00	0.00
7,000.0	18.70	322.00	6,996.7	23.8	-18.6	25.3	10.00	10.00	0.00
7,100.0	28.70	322.00	7,088.1	55.5	-43.3	58.9	10.00	10.00	0.00
7,200.0	38.70	322.00	7,171.2	99.1	-77.5	105.4	10.00	10.00	0.00
7,300.0	48.70	322.00	7,243.4	153.5	-119.9	163.1	10.00	10.00	0.00
7,400.0	58.70	322.00	7,302.6	216.9	-169.5	230.6	10.00	10.00	0.00
7,500.0	68.70	322.00	7,346.8	287.5	-224.6	305.5	10.00	10.00	0.00
7,600.0	78.70	322.00	7,374.9	363.0	-283.6	385.8	10.00	10.00	0.00
7,700.0	88.70	322.00	7,385.8	441.3	-344.7	469.0	10.00	10.00	0.00
7,713.0	90.00	322.00	7,386.0	451.5	-352.7	479.8	10.00	10.00	0.00
7" Inter (OPT 2)									
7,770.0	90.00	322.00	7,386.0	496.4	-387.8	527.6	0.00	0.00	0.00
7,800.0	90.00	322.90	7,386.0	520.2	-406.1	552.8	3.00	0.00	3.00
7,900.0	90.00	325.90	7,386.0	601.5	-464.3	638.8	3.00	0.00	3.00
8,000.0	90.00	328.90	7,386.0	685.7	-518.2	727.3	3.00	0.00	3.00
8,100.0	90.00	331.90	7,386.0	772.7	-567.6	818.1	3.00	0.00	3.00
8,200.0	90.00	334.90	7,386.0	862.1	-612.4	911.0	3.00	0.00	3.00
8,300.0	90.00	337.90	7,386.0	953.7	-652.4	1,005.7	3.00	0.00	3.00
8,400.0	90.00	340.90	7,386.0	1,047.3	-687.6	1,101.9	3.00	0.00	3.00
8,500.0	90.00	343.90	7,386.0	1,142.6	-717.8	1,199.5	3.00	0.00	3.00
8,600.0	90.00	346.90	7,386.0	1,239.4	-743.0	1,298.0	3.00	0.00	3.00
8,700.0	90.00	349.90	7,386.0	1,337.3	-763.1	1,397.3	3.00	0.00	3.00
8,800.0	90.00	352.90	7,386.0	1,436.2	-778.1	1,497.1	3.00	0.00	3.00
8,900.0	90.00	355.90	7,386.0	1,535.7	-787.8	1,597.1	3.00	0.00	3.00
9,000.0	90.00	358.90	7,386.0	1,635.6	-792.4	1,697.0	3.00	0.00	3.00
9,036.7	90.00	0.00	7,386.0	1,672.3	-792.7	1,733.6	3.00	0.00	3.00
9,100.0	90.00	0.00	7,386.0	1,735.6	-792.7	1,796.7	0.00	0.00	0.00
9,200.0	90.00	0.00	7,386.0	1,835.6	-792.7	1,896.3	0.00	0.00	0.00
9,300.0	90.00	0.00	7,386.0	1,935.6	-792.7	1,995.9	0.00	0.00	0.00
9,400.0	90.00	0.00	7,386.0	2,035.6	-792.7	2,095.6	0.00	0.00	0.00
9,500.0	90.00	0.00	7,386.0	2,135.6	-792.7	2,195.2	0.00	0.00	0.00
9,600.0	90.00	0.00	7,386.0	2,235.6	-792.7	2,294.8	0.00	0.00	0.00
9,700.0	90.00	0.00	7,386.0	2,335.6	-792.7	2,394.5	0.00	0.00	0.00
9,800.0	90.00	0.00	7,386.0	2,435.6	-792.7	2,494.1	0.00	0.00	0.00
9,900.0	90.00	0.00	7,386.0	2,535.6	-792.7	2,593.8	0.00	0.00	0.00

EOG Resources, Inc.

Planning Report

Database:	EDM_DENVER	Local Co-ordinate Reference:	Well Garden Creek 512-1807H
Company:	Denver Division- Colorado	TVD Reference:	WELL @ 5250.0usft (Original Well Elev)
Project:	DJ - Hereford Ranch	MD Reference:	WELL @ 5250.0usft (Original Well Elev)
Site:	Garden Creek 18 SESW Pad	North Reference:	True
Well:	Garden Creek 512-1807H	Survey Calculation Method:	Minimum Curvature
Wellbore:	Wellbore #1		
Design:	APD Plan (Plat 5-8-15)		

Planned Survey									
Measured Depth (usft)	Inclination (°)	Azimuth (°)	Vertical Depth (usft)	+N/-S (usft)	+E/-W (usft)	Vertical Section (usft)	Dogleg Rate (°/100usft)	Build Rate (°/100usft)	Turn Rate (°/100usft)
10,000.0	90.00	0.00	7,386.0	2,635.6	-792.7	2,693.4	0.00	0.00	0.00
10,100.0	90.00	0.00	7,386.0	2,735.6	-792.7	2,793.0	0.00	0.00	0.00
10,200.0	90.00	0.00	7,386.0	2,835.6	-792.7	2,892.7	0.00	0.00	0.00
10,300.0	90.00	0.00	7,386.0	2,935.6	-792.7	2,992.3	0.00	0.00	0.00
10,400.0	90.00	0.00	7,386.0	3,035.6	-792.7	3,092.0	0.00	0.00	0.00
10,500.0	90.00	0.00	7,386.0	3,135.6	-792.7	3,191.6	0.00	0.00	0.00
10,600.0	90.00	0.00	7,386.0	3,235.6	-792.7	3,291.2	0.00	0.00	0.00
10,700.0	90.00	0.00	7,386.0	3,335.6	-792.7	3,390.9	0.00	0.00	0.00
10,800.0	90.00	0.00	7,386.0	3,435.6	-792.7	3,490.5	0.00	0.00	0.00
10,900.0	90.00	0.00	7,386.0	3,535.6	-792.7	3,590.1	0.00	0.00	0.00
11,000.0	90.00	0.00	7,386.0	3,635.6	-792.7	3,689.8	0.00	0.00	0.00
11,100.0	90.00	0.00	7,386.0	3,735.6	-792.6	3,789.4	0.00	0.00	0.00
11,200.0	90.00	0.00	7,386.0	3,835.6	-792.6	3,889.1	0.00	0.00	0.00
11,300.0	90.00	0.00	7,386.0	3,935.6	-792.6	3,988.7	0.00	0.00	0.00
11,400.0	90.00	0.00	7,386.0	4,035.6	-792.6	4,088.3	0.00	0.00	0.00
11,500.0	90.00	0.00	7,386.0	4,135.6	-792.6	4,188.0	0.00	0.00	0.00
11,600.0	90.00	0.00	7,386.0	4,235.6	-792.6	4,287.6	0.00	0.00	0.00
11,700.0	90.00	0.00	7,386.0	4,335.6	-792.6	4,387.2	0.00	0.00	0.00
11,800.0	90.00	0.00	7,386.0	4,435.6	-792.6	4,486.9	0.00	0.00	0.00
11,900.0	90.00	0.00	7,386.0	4,535.6	-792.6	4,586.5	0.00	0.00	0.00
12,000.0	90.00	0.00	7,386.0	4,635.6	-792.6	4,686.2	0.00	0.00	0.00
12,100.0	90.00	0.00	7,386.0	4,735.6	-792.6	4,785.8	0.00	0.00	0.00
12,200.0	90.00	0.00	7,386.0	4,835.6	-792.6	4,885.4	0.00	0.00	0.00
12,300.0	90.00	0.00	7,386.0	4,935.6	-792.6	4,985.1	0.00	0.00	0.00
12,400.0	90.00	0.00	7,386.0	5,035.6	-792.6	5,084.7	0.00	0.00	0.00
12,500.0	90.00	0.00	7,386.0	5,135.6	-792.6	5,184.3	0.00	0.00	0.00
12,600.0	90.00	0.00	7,386.0	5,235.6	-792.6	5,284.0	0.00	0.00	0.00
12,700.0	90.00	0.00	7,386.0	5,335.6	-792.6	5,383.6	0.00	0.00	0.00
12,800.0	90.00	0.00	7,386.0	5,435.6	-792.6	5,483.3	0.00	0.00	0.00
12,900.0	90.00	0.00	7,386.0	5,535.6	-792.6	5,582.9	0.00	0.00	0.00
13,000.0	90.00	0.00	7,386.0	5,635.6	-792.6	5,682.5	0.00	0.00	0.00
13,100.0	90.00	0.00	7,386.0	5,735.6	-792.6	5,782.2	0.00	0.00	0.00
13,200.0	90.00	0.00	7,386.0	5,835.6	-792.6	5,881.8	0.00	0.00	0.00
13,300.0	90.00	0.00	7,386.0	5,935.6	-792.6	5,981.5	0.00	0.00	0.00
13,400.0	90.00	0.00	7,386.0	6,035.6	-792.6	6,081.1	0.00	0.00	0.00
13,500.0	90.00	0.00	7,386.0	6,135.6	-792.6	6,180.7	0.00	0.00	0.00
13,600.0	90.00	0.00	7,386.0	6,235.6	-792.6	6,280.4	0.00	0.00	0.00
13,700.0	90.00	0.00	7,386.0	6,335.6	-792.6	6,380.0	0.00	0.00	0.00
13,800.0	90.00	0.00	7,386.0	6,435.6	-792.6	6,479.6	0.00	0.00	0.00
13,900.0	90.00	0.00	7,386.0	6,535.6	-792.6	6,579.3	0.00	0.00	0.00
14,000.0	90.00	0.00	7,386.0	6,635.6	-792.6	6,678.9	0.00	0.00	0.00
14,100.0	90.00	0.00	7,386.0	6,735.6	-792.6	6,778.6	0.00	0.00	0.00
14,200.0	90.00	0.00	7,386.0	6,835.6	-792.6	6,878.2	0.00	0.00	0.00
14,300.0	90.00	0.00	7,386.0	6,935.6	-792.6	6,977.8	0.00	0.00	0.00
14,400.0	90.00	0.00	7,386.0	7,035.6	-792.5	7,077.5	0.00	0.00	0.00
14,500.0	90.00	0.00	7,386.0	7,135.6	-792.5	7,177.1	0.00	0.00	0.00
14,600.0	90.00	0.00	7,386.0	7,235.6	-792.5	7,276.7	0.00	0.00	0.00
14,700.0	90.00	0.00	7,386.0	7,335.6	-792.5	7,376.4	0.00	0.00	0.00
14,800.0	90.00	0.00	7,386.0	7,435.6	-792.5	7,476.0	0.00	0.00	0.00
14,900.0	90.00	0.00	7,386.0	7,535.6	-792.5	7,575.7	0.00	0.00	0.00
15,000.0	90.00	0.00	7,386.0	7,635.6	-792.5	7,675.3	0.00	0.00	0.00
15,100.0	90.00	0.00	7,386.0	7,735.6	-792.5	7,774.9	0.00	0.00	0.00
15,200.0	90.00	0.00	7,386.0	7,835.6	-792.5	7,874.6	0.00	0.00	0.00
15,300.0	90.00	0.00	7,386.0	7,935.6	-792.5	7,974.2	0.00	0.00	0.00

EOG Resources, Inc.

Planning Report

Database:	EDM_DENVER	Local Co-ordinate Reference:	Well Garden Creek 512-1807H
Company:	Denver Division- Colorado	TVD Reference:	WELL @ 5250.0usft (Original Well Elev)
Project:	DJ - Hereford Ranch	MD Reference:	WELL @ 5250.0usft (Original Well Elev)
Site:	Garden Creek 18 SESW Pad	North Reference:	True
Well:	Garden Creek 512-1807H	Survey Calculation Method:	Minimum Curvature
Wellbore:	Wellbore #1		
Design:	APD Plan (Plat 5-8-15)		

Planned Survey										
Measured Depth (usft)	Inclination (°)	Azimuth (°)	Vertical Depth (usft)	+N/-S (usft)	+E/-W (usft)	Vertical Section (usft)	Dogleg Rate (°/100usft)	Build Rate (°/100usft)	Turn Rate (°/100usft)	
15,400.0	90.00	0.00	7,386.0	8,035.6	-792.5	8,073.9	0.00	0.00	0.00	
15,500.0	90.00	0.00	7,386.0	8,135.6	-792.5	8,173.5	0.00	0.00	0.00	
15,600.0	90.00	0.00	7,386.0	8,235.6	-792.5	8,273.1	0.00	0.00	0.00	
15,700.0	90.00	0.00	7,386.0	8,335.6	-792.5	8,372.8	0.00	0.00	0.00	
15,800.0	90.00	0.00	7,386.0	8,435.6	-792.5	8,472.4	0.00	0.00	0.00	
15,900.0	90.00	0.00	7,386.0	8,535.6	-792.5	8,572.0	0.00	0.00	0.00	
16,000.0	90.00	0.00	7,386.0	8,635.6	-792.5	8,671.7	0.00	0.00	0.00	
16,100.0	90.00	0.00	7,386.0	8,735.6	-792.5	8,771.3	0.00	0.00	0.00	
16,200.0	90.00	0.00	7,386.0	8,835.6	-792.5	8,871.0	0.00	0.00	0.00	
16,300.0	90.00	0.00	7,386.0	8,935.6	-792.5	8,970.6	0.00	0.00	0.00	
16,400.0	90.00	0.00	7,386.0	9,035.6	-792.5	9,070.2	0.00	0.00	0.00	
16,500.0	90.00	0.00	7,386.0	9,135.6	-792.5	9,169.9	0.00	0.00	0.00	
16,600.0	90.00	0.00	7,386.0	9,235.6	-792.5	9,269.5	0.00	0.00	0.00	
16,656.2	90.00	0.00	7,386.0	9,291.8	-792.5	9,325.5	0.00	0.00	0.00	
5-1/2" Prod (OPT 1) - 4-1/2" Liner (OPT 2)										

Design Targets										
Target Name	Dip Angle (°)	Dip Dir. (°)	TVD (usft)	+N/-S (usft)	+E/-W (usft)	Northing (usft)	Easting (usft)	Latitude		Longitude
- hit/miss target										
- Shape										
512-1807H PBH 5-8-15	0.00	0.00	7,386.0	9,291.8	-792.5	588,319.61	2,312,724.68	40° 56' 34.262 N		104° 22' 5.116 W
- plan misses target center by 0.1usft at 16656.2usft MD (7386.0 TVD, 9291.8 N, -792.5 E)										
- Point										

Casing Points					
Measured Depth (usft)	Vertical Depth (usft)	Name	Casing Diameter (")	Hole Diameter (")	
1,130.0	1,130.0	9-5/8" Surface	9-5/8	13-1/2	
7,713.0	7,386.0	7" Inter (OPT 2)	7	8-3/4	
16,656.2	7,386.0	5-1/2" Prod (OPT 1)	5-1/2	8-3/4	
16,656.2	7,386.0	4-1/2" Liner (OPT 2)	4-1/2	6	