

Pit Cross-Sections BOYD FARMS 32-28

Frane Surveying of Elizabeth, Colorado, in accordance with a request from **Duncan Oil Inc.**, has determined the location of **BOYD FARMS 32-28** to be **2450 feet FNL**, and **2200 feet FEL** (90° off Section lines) of Section **28**, Township **6s**, Range **54w** of the 6th Principal Meridian, **Lincoln County**, Colorado.

Date: Staked on 08/13/15 drawn on 08/17/15.

Re: Staked by Elijah Frane

Drawn: Drawn by Elijah Frane

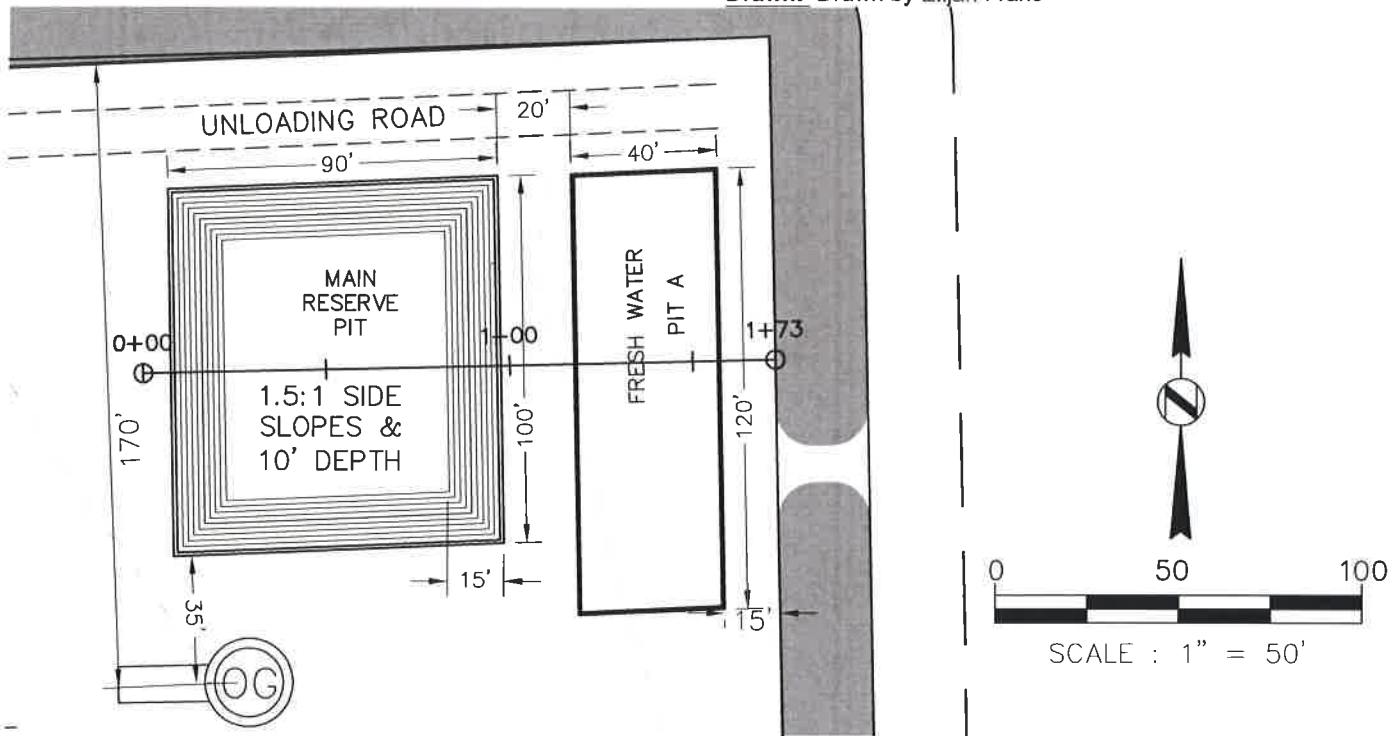

5296 RESERVE PIT CROSS-SECTION 5296

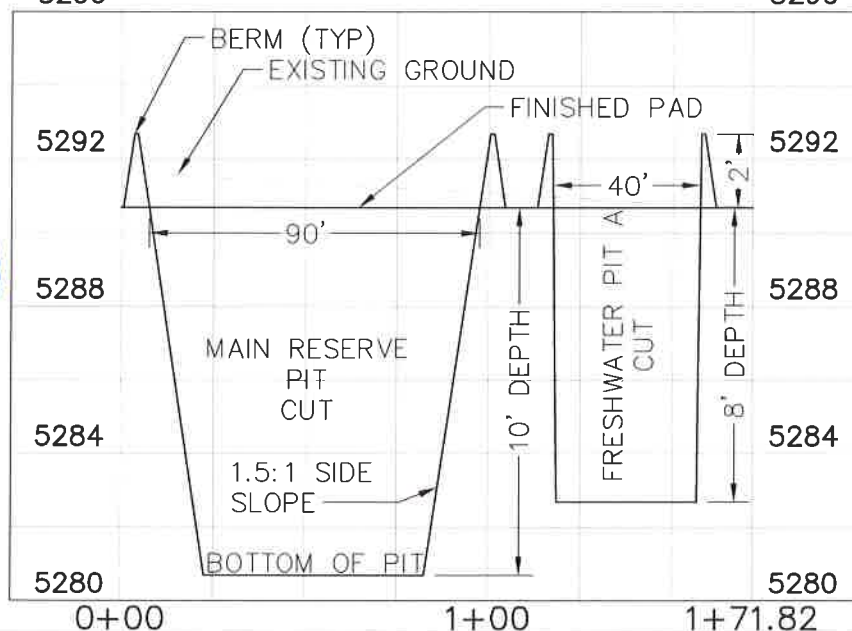

SCALES:
1"=50' HORIZ.
1"=5' VERT.

