

MEADER 5-N PAD HYDROLOGY MAP

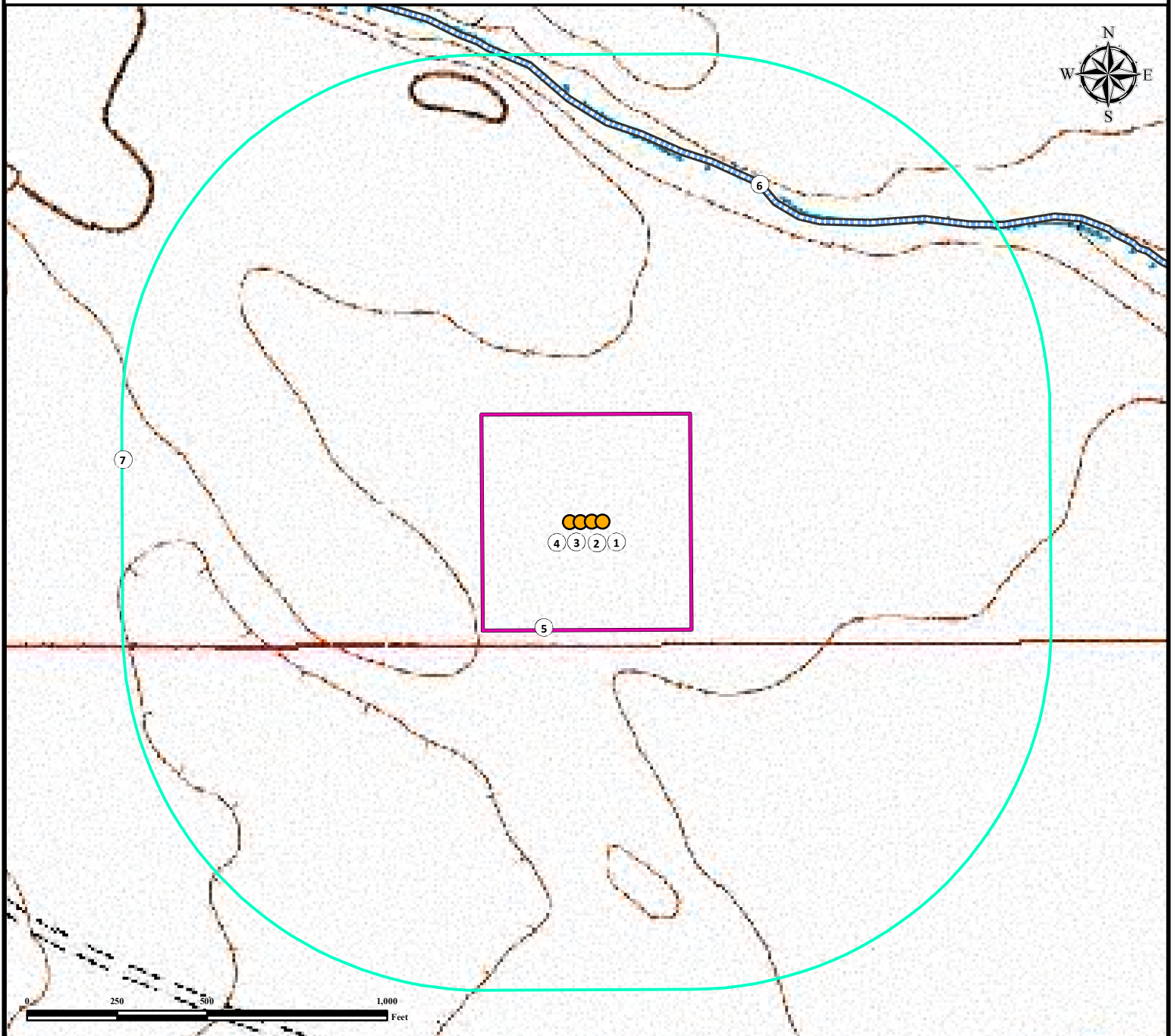

All measurements are made from the closest edge of disturbance area.

1. Proposed Well MEADER 1.
2. Proposed Well MEADER 2.
3. Proposed Well MEADER 3.
4. Proposed Well MEADER 4.
5. Operational Disturbance Area.
6. Intermittent Stream is 626' NE.
7. 1000' Radius.

Legend



Proposed Well



Disturbance Area



Intermittent Stream



1000' Radius



FIELD DATE:

06-24-15

DRAWING DATE:

07-21-15

BY:

CSG

CHECKED BY:

FMB

SITE NAME:

MEADER 5-N PAD

SURFACE LOCATION:

SE1/4 SW1/4 SEC. 5, T11N, R63W, 6TH P.M.

WELD COUNTY, COLORADO

PREPARED FOR:

