

**T11N**

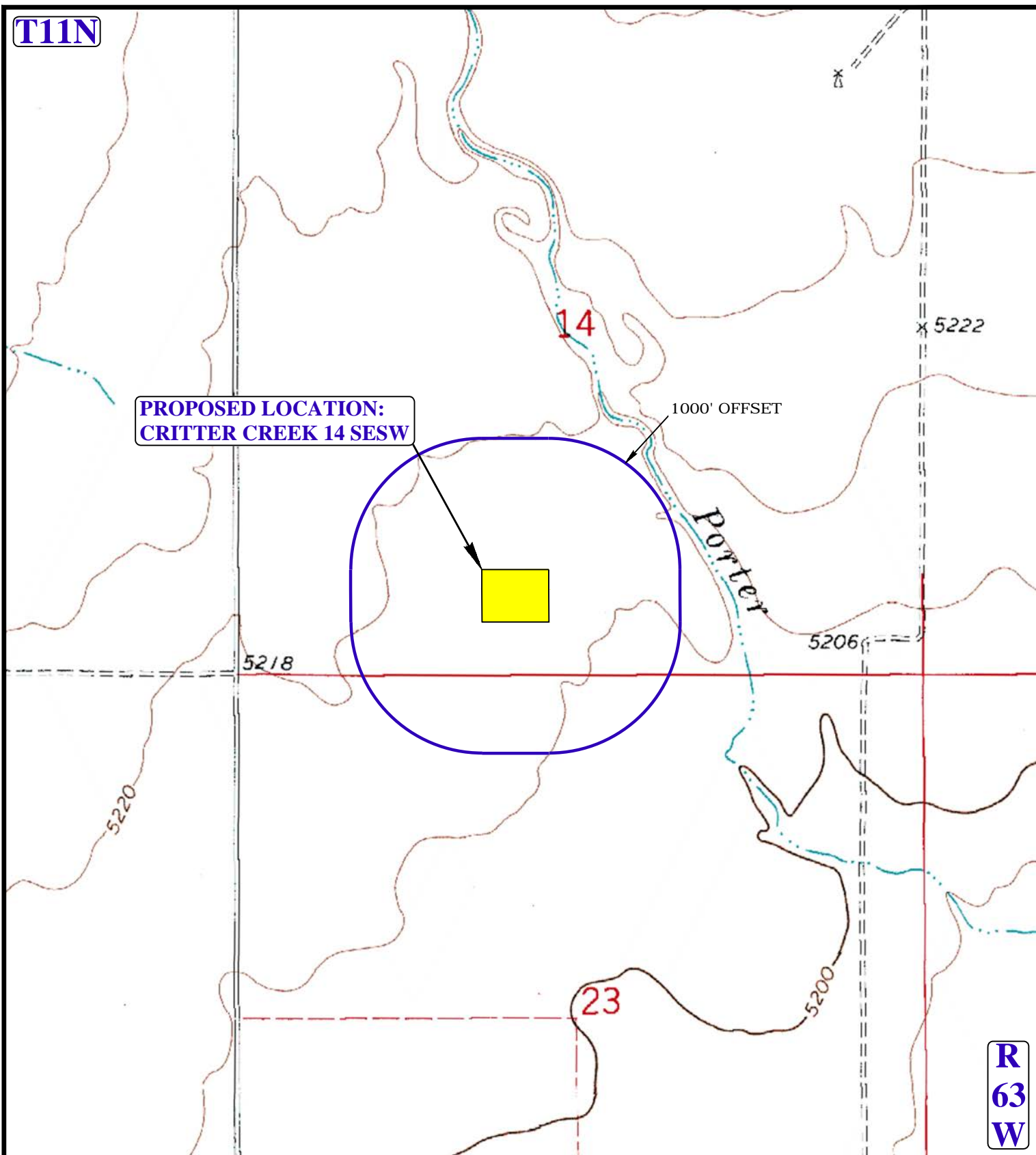

**R  
63  
W**

**LEGEND:**

- 1000' OFFSET BOUNDARY
- WATER WELLS



**EOG RESOURCES, INC.**

**CRITTER CREEK 14 SESW  
SE 1/4 SW 1/4, SECTION 14, T11N, R63W, 6th P.M.  
WELD COUNTY, COLORADO**

DRAWN BY: C.M.F.

DATE DRAWN: 04-08-15

SCALE: 1" = 1000'

REVISED: 00-00-00

**HYDROLOGY MAP**

**TOPO W**



**UELS, LLC**  
Corporate Office \* 85 South 200 East  
Vernal, UT 84078 \* (435) 789-1017