

Critter Creek 520-1426H

Surface Location			
NAD 1927 (NADCON CONUS) Colorado North 501			
Ground Elevation: 5213.0 RKB @ 5238.0usft (KB GL+25')			
Northing	Easting	Latitude	Longitude
578798.10	2303643.28	40° 55' 1.320 N	104° 24' 4.973 W

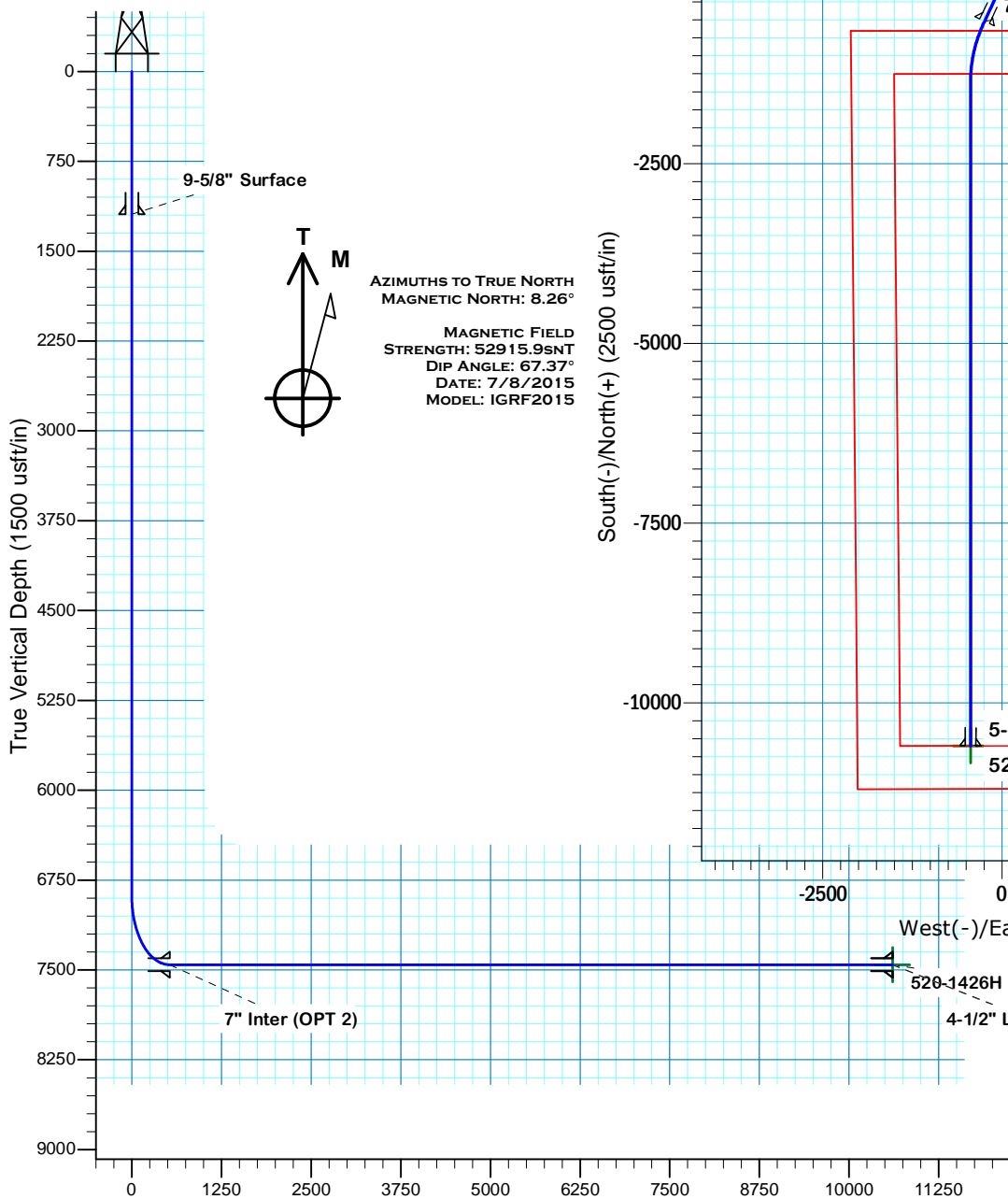

AZIMUTHS TO TRUE NORTH
 MAGNETIC NORTH: 8.26°
 MAGNETIC FIELD
 STRENGTH: 52915.9sNT
 DIP ANGLE: 67.37°
 DATE: 7/8/2015
 MODEL: IGRF2015

Project: DJ - Hereford Ranch
 Site: Critter Creek C14 SESW Pad
 Well: Critter Creek 520-1426H
 Planner: M.Thompson
 15:08, July 09 2015

SECTION DETAILS

Sec	MD	Inc	Azi	TVD	+N/-S	+E/-W	Dleg	TFace	Vsect	Target
1	0.0	0.00	0.00	0.0	0.0	0.0	0.00	0.00	0.0	
2	6884.0	0.00	0.00	6884.0	0.0	0.0	0.00	0.00	0.0	
3	7784.0	90.00	205.00	7457.0	-519.3	-242.1	10.00	205.00	528.8	
4	7824.0	90.00	205.00	7457.0	-555.5	-259.0	0.00	0.00	565.8	
5	8657.2	90.00	180.00	7457.0	-1362.6	-438.0	3.00	-90.00	1379.5	520-1426H PBH 4-17-15
6	17893.8	90.00	180.00	7457.0	-10599.1	-438.5	0.00	0.00	10608.2	520-1426H PBH 4-17-15

TARGET DETAILS

Name	TVD	+N/-S	+E/-W	Northing	Easting	Latitude	Longitude	Shape
520-1426H PBH 4-17-15	7457.0	-10599.1	-438.5	568194.34	2303336.15	40° 53' 16.592 N	104° 24' 10.682 W	Point

Denver Division- Colorado

**DJ - Hereford Ranch
Crittter Creek C14 SESW Pad
Crittter Creek 520-1426H**

OH

Plan: APD Plan (Plat 4-17-15)

Standard Planning Report

09 July, 2015

EOG Resources, Inc.

Planning Report

Database:	EDM_DENVER	Local Co-ordinate Reference:	Well Critter Creek 520-1426H
Company:	Denver Division- Colorado	TVD Reference:	RKB @ 5238.0usft (KB GL+25')
Project:	DJ - Hereford Ranch	MD Reference:	RKB @ 5238.0usft (KB GL+25')
Site:	Critter Creek C14 SESW Pad	North Reference:	True
Well:	Critter Creek 520-1426H	Survey Calculation Method:	Minimum Curvature
Wellbore:	OH		
Design:	APD Plan (Plat 4-17-15)		

Project	DJ - Hereford Ranch, Weld County		
Map System:	US State Plane 1927 (Exact solution)	System Datum:	Mean Sea Level
Geo Datum:	NAD 1927 (NADCON CONUS)		
Map Zone:	Colorado North 501		

Site	Critter Creek C14 SESW Pad		
Site Position:		Northing:	578,750.00 usft
From:	Map	Easting:	2,303,550.00 usft
Position Uncertainty:	0.0 usft	Slot Radius:	13-3/16 "
		Latitude:	40° 55' 0.856 N
		Longitude:	104° 24' 6.196 W
		Grid Convergence:	0.71 °

Well	Critter Creek 520-1426H		
Well Position	+N/-S	46.9 usft	Northing:
	+E/-W	93.9 usft	Easting:
Position Uncertainty	0.0 usft		Wellhead Elevation:
			Latitude:
			Longitude:
			Ground Level:

Wellbore	OH				
Magnetics	Model Name	Sample Date	Declination	Dip Angle	Field Strength
			(°)	(°)	(nT)
	IGRF2015	7/8/2015	8.26	67.37	52,916

Design	APD Plan (Plat 4-17-15)			
Audit Notes:				
Version:	Phase:	PROTOTYPE	Tie On Depth:	0.0
Vertical Section:	Depth From (TVD)	+N/-S	+E/-W	Direction
	(usft)	(usft)	(usft)	(°)
	0.0	0.0	0.0	182.37

Plan Sections										
Measured	Inclination	Azimuth	Vertical	+N/-S	+E/-W	Dogleg	Build	Turn	TFO	Target
Depth	(°)	(°)	Depth	(usft)	(usft)	Rate	Rate	Rate	(°)	
(usft)			(usft)			(°/100usft)	(°/100usft)	(°/100usft)		
0.0	0.00	0.00	0.0	0.0	0.0	0.00	0.00	0.00	0.00	
6,884.0	0.00	0.00	6,884.0	0.0	0.0	0.00	0.00	0.00	0.00	
7,784.0	90.00	205.00	7,457.0	-519.3	-242.1	10.00	10.00	0.00	205.00	
7,824.0	90.00	205.00	7,457.0	-555.5	-259.0	0.00	0.00	0.00	0.00	
8,657.2	90.00	180.00	7,457.0	-1,362.6	-438.0	3.00	0.00	-3.00	-90.00	520-1426H PBH 4-17
17,893.8	90.00	180.00	7,457.0	-10,599.1	-438.5	0.00	0.00	0.00	0.00	520-1426H PBH 4-17

EOG Resources, Inc.

Planning Report

Database:	EDM_DENVER	Local Co-ordinate Reference:	Well Critter Creek 520-1426H
Company:	Denver Division- Colorado	TVD Reference:	RKB @ 5238.0usft (KB GL+25')
Project:	DJ - Hereford Ranch	MD Reference:	RKB @ 5238.0usft (KB GL+25')
Site:	Critter Creek C14 SESW Pad	North Reference:	True
Well:	Critter Creek 520-1426H	Survey Calculation Method:	Minimum Curvature
Wellbore:	OH		
Design:	APD Plan (Plat 4-17-15)		

Planned Survey									
Measured Depth (usft)	Inclination (°)	Azimuth (°)	Vertical Depth (usft)	+N/-S (usft)	+E/-W (usft)	Vertical Section (usft)	Dogleg Rate (°/100usft)	Build Rate (°/100usft)	Turn Rate (°/100usft)
0.0	0.00	0.00	0.0	0.0	0.0	0.0	0.00	0.00	0.00
100.0	0.00	0.00	100.0	0.0	0.0	0.0	0.00	0.00	0.00
200.0	0.00	0.00	200.0	0.0	0.0	0.0	0.00	0.00	0.00
300.0	0.00	0.00	300.0	0.0	0.0	0.0	0.00	0.00	0.00
400.0	0.00	0.00	400.0	0.0	0.0	0.0	0.00	0.00	0.00
500.0	0.00	0.00	500.0	0.0	0.0	0.0	0.00	0.00	0.00
600.0	0.00	0.00	600.0	0.0	0.0	0.0	0.00	0.00	0.00
700.0	0.00	0.00	700.0	0.0	0.0	0.0	0.00	0.00	0.00
800.0	0.00	0.00	800.0	0.0	0.0	0.0	0.00	0.00	0.00
900.0	0.00	0.00	900.0	0.0	0.0	0.0	0.00	0.00	0.00
1,000.0	0.00	0.00	1,000.0	0.0	0.0	0.0	0.00	0.00	0.00
1,100.0	0.00	0.00	1,100.0	0.0	0.0	0.0	0.00	0.00	0.00
1,191.0	0.00	0.00	1,191.0	0.0	0.0	0.0	0.00	0.00	0.00
9-5/8" Surface									
1,200.0	0.00	0.00	1,200.0	0.0	0.0	0.0	0.00	0.00	0.00
1,300.0	0.00	0.00	1,300.0	0.0	0.0	0.0	0.00	0.00	0.00
1,400.0	0.00	0.00	1,400.0	0.0	0.0	0.0	0.00	0.00	0.00
1,500.0	0.00	0.00	1,500.0	0.0	0.0	0.0	0.00	0.00	0.00
1,600.0	0.00	0.00	1,600.0	0.0	0.0	0.0	0.00	0.00	0.00
1,700.0	0.00	0.00	1,700.0	0.0	0.0	0.0	0.00	0.00	0.00
1,800.0	0.00	0.00	1,800.0	0.0	0.0	0.0	0.00	0.00	0.00
1,900.0	0.00	0.00	1,900.0	0.0	0.0	0.0	0.00	0.00	0.00
2,000.0	0.00	0.00	2,000.0	0.0	0.0	0.0	0.00	0.00	0.00
2,100.0	0.00	0.00	2,100.0	0.0	0.0	0.0	0.00	0.00	0.00
2,200.0	0.00	0.00	2,200.0	0.0	0.0	0.0	0.00	0.00	0.00
2,300.0	0.00	0.00	2,300.0	0.0	0.0	0.0	0.00	0.00	0.00
2,400.0	0.00	0.00	2,400.0	0.0	0.0	0.0	0.00	0.00	0.00
2,500.0	0.00	0.00	2,500.0	0.0	0.0	0.0	0.00	0.00	0.00
2,600.0	0.00	0.00	2,600.0	0.0	0.0	0.0	0.00	0.00	0.00
2,700.0	0.00	0.00	2,700.0	0.0	0.0	0.0	0.00	0.00	0.00
2,800.0	0.00	0.00	2,800.0	0.0	0.0	0.0	0.00	0.00	0.00
2,900.0	0.00	0.00	2,900.0	0.0	0.0	0.0	0.00	0.00	0.00
3,000.0	0.00	0.00	3,000.0	0.0	0.0	0.0	0.00	0.00	0.00
3,100.0	0.00	0.00	3,100.0	0.0	0.0	0.0	0.00	0.00	0.00
3,200.0	0.00	0.00	3,200.0	0.0	0.0	0.0	0.00	0.00	0.00
3,300.0	0.00	0.00	3,300.0	0.0	0.0	0.0	0.00	0.00	0.00
3,400.0	0.00	0.00	3,400.0	0.0	0.0	0.0	0.00	0.00	0.00
3,500.0	0.00	0.00	3,500.0	0.0	0.0	0.0	0.00	0.00	0.00
3,600.0	0.00	0.00	3,600.0	0.0	0.0	0.0	0.00	0.00	0.00
3,700.0	0.00	0.00	3,700.0	0.0	0.0	0.0	0.00	0.00	0.00
3,800.0	0.00	0.00	3,800.0	0.0	0.0	0.0	0.00	0.00	0.00
3,900.0	0.00	0.00	3,900.0	0.0	0.0	0.0	0.00	0.00	0.00
4,000.0	0.00	0.00	4,000.0	0.0	0.0	0.0	0.00	0.00	0.00
4,100.0	0.00	0.00	4,100.0	0.0	0.0	0.0	0.00	0.00	0.00
4,200.0	0.00	0.00	4,200.0	0.0	0.0	0.0	0.00	0.00	0.00
4,300.0	0.00	0.00	4,300.0	0.0	0.0	0.0	0.00	0.00	0.00
4,400.0	0.00	0.00	4,400.0	0.0	0.0	0.0	0.00	0.00	0.00
4,500.0	0.00	0.00	4,500.0	0.0	0.0	0.0	0.00	0.00	0.00
4,600.0	0.00	0.00	4,600.0	0.0	0.0	0.0	0.00	0.00	0.00
4,700.0	0.00	0.00	4,700.0	0.0	0.0	0.0	0.00	0.00	0.00
4,800.0	0.00	0.00	4,800.0	0.0	0.0	0.0	0.00	0.00	0.00
4,900.0	0.00	0.00	4,900.0	0.0	0.0	0.0	0.00	0.00	0.00
5,000.0	0.00	0.00	5,000.0	0.0	0.0	0.0	0.00	0.00	0.00
5,100.0	0.00	0.00	5,100.0	0.0	0.0	0.0	0.00	0.00	0.00

EOG Resources, Inc.

Planning Report

Database:	EDM_DENVER	Local Co-ordinate Reference:	Well Critter Creek 520-1426H
Company:	Denver Division- Colorado	TVD Reference:	RKB @ 5238.0usft (KB GL+25')
Project:	DJ - Hereford Ranch	MD Reference:	RKB @ 5238.0usft (KB GL+25')
Site:	Critter Creek C14 SESW Pad	North Reference:	True
Well:	Critter Creek 520-1426H	Survey Calculation Method:	Minimum Curvature
Wellbore:	OH		
Design:	APD Plan (Plat 4-17-15)		

Planned Survey									
Measured Depth (usft)	Inclination (°)	Azimuth (°)	Vertical Depth (usft)	+N/-S (usft)	+E/-W (usft)	Vertical Section (usft)	Dogleg Rate (°/100usft)	Build Rate (°/100usft)	Turn Rate (°/100usft)
5,200.0	0.00	0.00	5,200.0	0.0	0.0	0.0	0.00	0.00	0.00
5,300.0	0.00	0.00	5,300.0	0.0	0.0	0.0	0.00	0.00	0.00
5,400.0	0.00	0.00	5,400.0	0.0	0.0	0.0	0.00	0.00	0.00
5,500.0	0.00	0.00	5,500.0	0.0	0.0	0.0	0.00	0.00	0.00
5,600.0	0.00	0.00	5,600.0	0.0	0.0	0.0	0.00	0.00	0.00
5,700.0	0.00	0.00	5,700.0	0.0	0.0	0.0	0.00	0.00	0.00
5,800.0	0.00	0.00	5,800.0	0.0	0.0	0.0	0.00	0.00	0.00
5,900.0	0.00	0.00	5,900.0	0.0	0.0	0.0	0.00	0.00	0.00
6,000.0	0.00	0.00	6,000.0	0.0	0.0	0.0	0.00	0.00	0.00
6,100.0	0.00	0.00	6,100.0	0.0	0.0	0.0	0.00	0.00	0.00
6,200.0	0.00	0.00	6,200.0	0.0	0.0	0.0	0.00	0.00	0.00
6,300.0	0.00	0.00	6,300.0	0.0	0.0	0.0	0.00	0.00	0.00
6,400.0	0.00	0.00	6,400.0	0.0	0.0	0.0	0.00	0.00	0.00
6,500.0	0.00	0.00	6,500.0	0.0	0.0	0.0	0.00	0.00	0.00
6,600.0	0.00	0.00	6,600.0	0.0	0.0	0.0	0.00	0.00	0.00
6,700.0	0.00	0.00	6,700.0	0.0	0.0	0.0	0.00	0.00	0.00
6,800.0	0.00	0.00	6,800.0	0.0	0.0	0.0	0.00	0.00	0.00
6,884.0	0.00	0.00	6,884.0	0.0	0.0	0.0	0.00	0.00	0.00
6,900.0	1.60	205.00	6,900.0	-0.2	-0.1	0.2	10.00	10.00	0.00
7,000.0	11.60	205.00	6,999.2	-10.6	-4.9	10.8	10.00	10.00	0.00
7,100.0	21.60	205.00	7,094.9	-36.5	-17.0	37.1	10.00	10.00	0.00
7,200.0	31.60	205.00	7,184.2	-77.0	-35.9	78.4	10.00	10.00	0.00
7,300.0	41.60	205.00	7,264.4	-131.0	-61.1	133.4	10.00	10.00	0.00
7,400.0	51.60	205.00	7,333.0	-196.7	-91.7	200.4	10.00	10.00	0.00
7,500.0	61.60	205.00	7,388.0	-272.3	-127.0	277.3	10.00	10.00	0.00
7,600.0	71.60	205.00	7,427.7	-355.4	-165.7	361.9	10.00	10.00	0.00
7,700.0	81.60	205.00	7,450.8	-443.4	-206.8	451.6	10.00	10.00	0.00
7,784.0	90.00	205.00	7,457.0	-519.3	-242.1	528.8	10.00	10.00	0.00
7" Inter (OPT 2)									
7,800.0	90.00	205.00	7,457.0	-533.8	-248.9	543.6	0.00	0.00	0.00
7,824.0	90.00	205.00	7,457.0	-555.5	-259.0	565.8	0.00	0.00	0.00
7,900.0	90.00	202.72	7,457.0	-625.0	-289.8	636.5	3.00	0.00	-3.00
8,000.0	90.00	199.72	7,457.0	-718.2	-326.0	731.1	3.00	0.00	-3.00
8,100.0	90.00	196.72	7,457.0	-813.2	-357.2	827.3	3.00	0.00	-3.00
8,200.0	90.00	193.72	7,457.0	-909.7	-383.5	924.8	3.00	0.00	-3.00
8,300.0	90.00	190.72	7,457.0	-1,007.4	-404.7	1,023.3	3.00	0.00	-3.00
8,400.0	90.00	187.72	7,457.0	-1,106.1	-420.7	1,122.6	3.00	0.00	-3.00
8,500.0	90.00	184.72	7,457.0	-1,205.5	-431.5	1,222.3	3.00	0.00	-3.00
8,600.0	90.00	181.72	7,457.0	-1,305.3	-437.1	1,322.3	3.00	0.00	-3.00
8,657.2	90.00	180.00	7,457.0	-1,362.6	-438.0	1,379.5	3.00	0.00	-3.00
8,700.0	90.00	180.00	7,457.0	-1,405.3	-438.0	1,422.2	0.00	0.00	0.00
8,800.0	90.00	180.00	7,457.0	-1,505.3	-438.0	1,522.2	0.00	0.00	0.00
8,900.0	90.00	180.00	7,457.0	-1,605.3	-438.0	1,622.1	0.00	0.00	0.00
9,000.0	90.00	180.00	7,457.0	-1,705.3	-438.0	1,722.0	0.00	0.00	0.00
9,100.0	90.00	180.00	7,457.0	-1,805.3	-438.0	1,821.9	0.00	0.00	0.00
9,200.0	90.00	180.00	7,457.0	-1,905.3	-438.0	1,921.8	0.00	0.00	0.00
9,300.0	90.00	180.00	7,457.0	-2,005.3	-438.0	2,021.7	0.00	0.00	0.00
9,400.0	90.00	180.00	7,457.0	-2,105.3	-438.0	2,121.6	0.00	0.00	0.00
9,500.0	90.00	180.00	7,457.0	-2,205.3	-438.0	2,221.6	0.00	0.00	0.00
9,600.0	90.00	180.00	7,457.0	-2,305.3	-438.0	2,321.5	0.00	0.00	0.00
9,700.0	90.00	180.00	7,457.0	-2,405.3	-438.0	2,421.4	0.00	0.00	0.00
9,800.0	90.00	180.00	7,457.0	-2,505.3	-438.0	2,521.3	0.00	0.00	0.00
9,900.0	90.00	180.00	7,457.0	-2,605.3	-438.1	2,621.2	0.00	0.00	0.00

EOG Resources, Inc.

Planning Report

Database:	EDM_DENVER	Local Co-ordinate Reference:	Well Critter Creek 520-1426H
Company:	Denver Division- Colorado	TVD Reference:	RKB @ 5238.0usft (KB GL+25')
Project:	DJ - Hereford Ranch	MD Reference:	RKB @ 5238.0usft (KB GL+25')
Site:	Critter Creek C14 SESW Pad	North Reference:	True
Well:	Critter Creek 520-1426H	Survey Calculation Method:	Minimum Curvature
Wellbore:	OH		
Design:	APD Plan (Plat 4-17-15)		

Planned Survey									
Measured Depth (usft)	Inclination (°)	Azimuth (°)	Vertical Depth (usft)	+N/-S (usft)	+E/-W (usft)	Vertical Section (usft)	Dogleg Rate (°/100usft)	Build Rate (°/100usft)	Turn Rate (°/100usft)
10,000.0	90.00	180.00	7,457.0	-2,705.3	-438.1	2,721.1	0.00	0.00	0.00
10,100.0	90.00	180.00	7,457.0	-2,805.3	-438.1	2,821.0	0.00	0.00	0.00
10,200.0	90.00	180.00	7,457.0	-2,905.3	-438.1	2,921.0	0.00	0.00	0.00
10,300.0	90.00	180.00	7,457.0	-3,005.3	-438.1	3,020.9	0.00	0.00	0.00
10,400.0	90.00	180.00	7,457.0	-3,105.3	-438.1	3,120.8	0.00	0.00	0.00
10,500.0	90.00	180.00	7,457.0	-3,205.3	-438.1	3,220.7	0.00	0.00	0.00
10,600.0	90.00	180.00	7,457.0	-3,305.3	-438.1	3,320.6	0.00	0.00	0.00
10,700.0	90.00	180.00	7,457.0	-3,405.3	-438.1	3,420.5	0.00	0.00	0.00
10,800.0	90.00	180.00	7,457.0	-3,505.3	-438.1	3,520.4	0.00	0.00	0.00
10,900.0	90.00	180.00	7,457.0	-3,605.3	-438.1	3,620.4	0.00	0.00	0.00
11,000.0	90.00	180.00	7,457.0	-3,705.3	-438.1	3,720.3	0.00	0.00	0.00
11,100.0	90.00	180.00	7,457.0	-3,805.3	-438.1	3,820.2	0.00	0.00	0.00
11,200.0	90.00	180.00	7,457.0	-3,905.3	-438.1	3,920.1	0.00	0.00	0.00
11,300.0	90.00	180.00	7,457.0	-4,005.3	-438.1	4,020.0	0.00	0.00	0.00
11,400.0	90.00	180.00	7,457.0	-4,105.3	-438.1	4,119.9	0.00	0.00	0.00
11,500.0	90.00	180.00	7,457.0	-4,205.3	-438.1	4,219.9	0.00	0.00	0.00
11,600.0	90.00	180.00	7,457.0	-4,305.3	-438.1	4,319.8	0.00	0.00	0.00
11,700.0	90.00	180.00	7,457.0	-4,405.3	-438.1	4,419.7	0.00	0.00	0.00
11,800.0	90.00	180.00	7,457.0	-4,505.3	-438.2	4,519.6	0.00	0.00	0.00
11,900.0	90.00	180.00	7,457.0	-4,605.3	-438.2	4,619.5	0.00	0.00	0.00
12,000.0	90.00	180.00	7,457.0	-4,705.3	-438.2	4,719.4	0.00	0.00	0.00
12,100.0	90.00	180.00	7,457.0	-4,805.3	-438.2	4,819.3	0.00	0.00	0.00
12,200.0	90.00	180.00	7,457.0	-4,905.3	-438.2	4,919.3	0.00	0.00	0.00
12,300.0	90.00	180.00	7,457.0	-5,005.3	-438.2	5,019.2	0.00	0.00	0.00
12,400.0	90.00	180.00	7,457.0	-5,105.3	-438.2	5,119.1	0.00	0.00	0.00
12,500.0	90.00	180.00	7,457.0	-5,205.3	-438.2	5,219.0	0.00	0.00	0.00
12,600.0	90.00	180.00	7,457.0	-5,305.3	-438.2	5,318.9	0.00	0.00	0.00
12,700.0	90.00	180.00	7,457.0	-5,405.3	-438.2	5,418.8	0.00	0.00	0.00
12,800.0	90.00	180.00	7,457.0	-5,505.3	-438.2	5,518.7	0.00	0.00	0.00
12,900.0	90.00	180.00	7,457.0	-5,605.3	-438.2	5,618.7	0.00	0.00	0.00
13,000.0	90.00	180.00	7,457.0	-5,705.3	-438.2	5,718.6	0.00	0.00	0.00
13,100.0	90.00	180.00	7,457.0	-5,805.3	-438.2	5,818.5	0.00	0.00	0.00
13,200.0	90.00	180.00	7,457.0	-5,905.3	-438.2	5,918.4	0.00	0.00	0.00
13,300.0	90.00	180.00	7,457.0	-6,005.3	-438.2	6,018.3	0.00	0.00	0.00
13,400.0	90.00	180.00	7,457.0	-6,105.3	-438.2	6,118.2	0.00	0.00	0.00
13,500.0	90.00	180.00	7,457.0	-6,205.3	-438.2	6,218.1	0.00	0.00	0.00
13,600.0	90.00	180.00	7,457.0	-6,305.3	-438.2	6,318.1	0.00	0.00	0.00
13,700.0	90.00	180.00	7,457.0	-6,405.3	-438.3	6,418.0	0.00	0.00	0.00
13,800.0	90.00	180.00	7,457.0	-6,505.3	-438.3	6,517.9	0.00	0.00	0.00
13,900.0	90.00	180.00	7,457.0	-6,605.3	-438.3	6,617.8	0.00	0.00	0.00
14,000.0	90.00	180.00	7,457.0	-6,705.3	-438.3	6,717.7	0.00	0.00	0.00
14,100.0	90.00	180.00	7,457.0	-6,805.3	-438.3	6,817.6	0.00	0.00	0.00
14,200.0	90.00	180.00	7,457.0	-6,905.3	-438.3	6,917.6	0.00	0.00	0.00
14,300.0	90.00	180.00	7,457.0	-7,005.3	-438.3	7,017.5	0.00	0.00	0.00
14,400.0	90.00	180.00	7,457.0	-7,105.3	-438.3	7,117.4	0.00	0.00	0.00
14,500.0	90.00	180.00	7,457.0	-7,205.3	-438.3	7,217.3	0.00	0.00	0.00
14,600.0	90.00	180.00	7,457.0	-7,305.3	-438.3	7,317.2	0.00	0.00	0.00
14,700.0	90.00	180.00	7,457.0	-7,405.3	-438.3	7,417.1	0.00	0.00	0.00
14,800.0	90.00	180.00	7,457.0	-7,505.3	-438.3	7,517.0	0.00	0.00	0.00
14,900.0	90.00	180.00	7,457.0	-7,605.3	-438.3	7,617.0	0.00	0.00	0.00
15,000.0	90.00	180.00	7,457.0	-7,705.3	-438.3	7,716.9	0.00	0.00	0.00
15,100.0	90.00	180.00	7,457.0	-7,805.3	-438.3	7,816.8	0.00	0.00	0.00
15,200.0	90.00	180.00	7,457.0	-7,905.3	-438.3	7,916.7	0.00	0.00	0.00
15,300.0	90.00	180.00	7,457.0	-8,005.3	-438.3	8,016.6	0.00	0.00	0.00

EOG Resources, Inc.

Planning Report

Database:	EDM_DENVER	Local Co-ordinate Reference:	Well Critter Creek 520-1426H
Company:	Denver Division- Colorado	TVD Reference:	RKB @ 5238.0usft (KB GL+25')
Project:	DJ - Hereford Ranch	MD Reference:	RKB @ 5238.0usft (KB GL+25')
Site:	Critter Creek C14 SESW Pad	North Reference:	True
Well:	Critter Creek 520-1426H	Survey Calculation Method:	Minimum Curvature
Wellbore:	OH		
Design:	APD Plan (Plat 4-17-15)		

Planned Survey										
Measured Depth (usft)	Inclination (°)	Azimuth (°)	Vertical Depth (usft)	+N/-S (usft)	+E/-W (usft)	Vertical Section (usft)	Dogleg Rate (°/100usft)	Build Rate (°/100usft)	Turn Rate (°/100usft)	
15,400.0	90.00	180.00	7,457.0	-8,105.3	-438.3	8,116.5	0.00	0.00	0.00	
15,500.0	90.00	180.00	7,457.0	-8,205.3	-438.3	8,216.4	0.00	0.00	0.00	
15,600.0	90.00	180.00	7,457.0	-8,305.3	-438.4	8,316.4	0.00	0.00	0.00	
15,700.0	90.00	180.00	7,457.0	-8,405.3	-438.4	8,416.3	0.00	0.00	0.00	
15,800.0	90.00	180.00	7,457.0	-8,505.3	-438.4	8,516.2	0.00	0.00	0.00	
15,900.0	90.00	180.00	7,457.0	-8,605.3	-438.4	8,616.1	0.00	0.00	0.00	
16,000.0	90.00	180.00	7,457.0	-8,705.3	-438.4	8,716.0	0.00	0.00	0.00	
16,100.0	90.00	180.00	7,457.0	-8,805.3	-438.4	8,815.9	0.00	0.00	0.00	
16,200.0	90.00	180.00	7,457.0	-8,905.3	-438.4	8,915.8	0.00	0.00	0.00	
16,300.0	90.00	180.00	7,457.0	-9,005.3	-438.4	9,015.8	0.00	0.00	0.00	
16,400.0	90.00	180.00	7,457.0	-9,105.3	-438.4	9,115.7	0.00	0.00	0.00	
16,500.0	90.00	180.00	7,457.0	-9,205.3	-438.4	9,215.6	0.00	0.00	0.00	
16,600.0	90.00	180.00	7,457.0	-9,305.3	-438.4	9,315.5	0.00	0.00	0.00	
16,700.0	90.00	180.00	7,457.0	-9,405.3	-438.4	9,415.4	0.00	0.00	0.00	
16,800.0	90.00	180.00	7,457.0	-9,505.3	-438.4	9,515.3	0.00	0.00	0.00	
16,900.0	90.00	180.00	7,457.0	-9,605.3	-438.4	9,615.2	0.00	0.00	0.00	
17,000.0	90.00	180.00	7,457.0	-9,705.3	-438.4	9,715.2	0.00	0.00	0.00	
17,100.0	90.00	180.00	7,457.0	-9,805.3	-438.4	9,815.1	0.00	0.00	0.00	
17,200.0	90.00	180.00	7,457.0	-9,905.3	-438.4	9,915.0	0.00	0.00	0.00	
17,300.0	90.00	180.00	7,457.0	-10,005.3	-438.4	10,014.9	0.00	0.00	0.00	
17,400.0	90.00	180.00	7,457.0	-10,105.3	-438.4	10,114.8	0.00	0.00	0.00	
17,500.0	90.00	180.00	7,457.0	-10,205.3	-438.5	10,214.7	0.00	0.00	0.00	
17,600.0	90.00	180.00	7,457.0	-10,305.3	-438.5	10,314.7	0.00	0.00	0.00	
17,700.0	90.00	180.00	7,457.0	-10,405.3	-438.5	10,414.6	0.00	0.00	0.00	
17,800.0	90.00	180.00	7,457.0	-10,505.3	-438.5	10,514.5	0.00	0.00	0.00	
17,893.8	90.00	180.00	7,457.0	-10,599.1	-438.5	10,608.2	0.00	0.00	0.00	
5-1/2" Prod (OPT 1) - 4-1/2" Liner (OPT 2)										

Design Targets										
Target Name	Dip Angle (°)	Dip Dir. (°)	TVD (usft)	+N/-S (usft)	+E/-W (usft)	Northing (usft)	Easting (usft)	Latitude	Longitude	
520-1426H PBH 4-17-15	0.00	0.00	7,457.0	-10,599.1	-438.5	568,194.34	2,303,336.15	40° 53' 16.592 N	104° 24' 10.682 W	
- hit/miss target										
- Shape										
- plan hits target center										
- Point										

Casing Points					
Measured Depth (usft)	Vertical Depth (usft)	Name	Casing Diameter (")	Hole Diameter (")	
1,191.0	1,191.0	9-5/8" Surface	9-5/8	13-1/2	
7,784.0	7,457.0	7" Inter (OPT 2)	7	8-3/4	
17,893.8	7,457.0	5-1/2" Prod (OPT 1)	5-1/2	8-3/4	
17,893.8	7,457.0	4-1/2" Liner (OPT 2)	4-1/2	6	