

# Critter Creek 567-1411H

Surface Location			
NAD 1927 (NADCON CONUS) Colorado North 501			
Ground Elevation: 5213.0 WELL @ 5238.0usft (Original Well Elev)			
Northing	Easting	Latitude	Longitude
578798.75	2303693.29	40° 55' 1.320 N	104° 24' 4.322 W

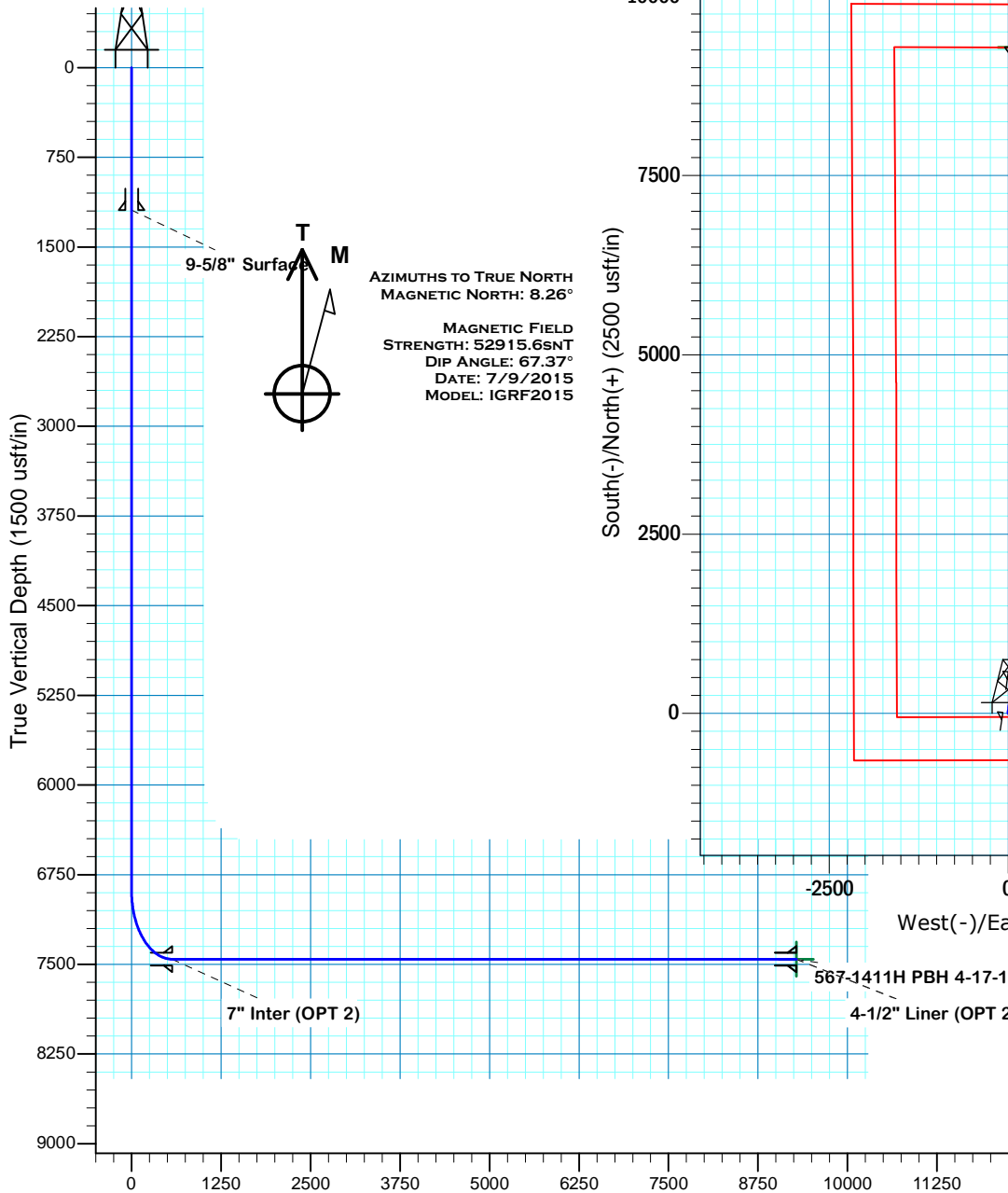

AZIMUTHS TO TRUE NORTH  
MAGNETIC NORTH: 8.26°

MAGNETIC FIELD  
STRENGTH: 52915.6sNT  
DIP ANGLE: 67.37°  
DATE: 7/9/2015  
MODEL: IGRF2015

Project: DJ - Hereford Ranch  
Site: Critter Creek C14 SESW Pad  
Well: Critter Creek 567-1411H  
Planner: M.Thompson  
15:16, July 09 2015

## SECTION DETAILS

Sec	MD	Inc	Azi	TVD	+N/-S	+E/-W	Dleg	TFace	Vsect	Target
1	0.0	0.00	0.00	0.0	0.0	0.0	0.00	0.00	0.0	
2	6884.0	0.00	0.00	6884.0	0.0	0.0	0.00	0.00	0.0	
3	7784.0	90.00	8.00	7457.0	567.4	79.7	10.00	8.00	568.2	
4	7799.0	90.00	8.00	7457.0	582.2	81.8	0.00	0.00	583.1	
5	8065.5	90.00	0.00	7457.0	847.9	100.4	3.00	-90.00	848.9	567-1411H PBH 4-17-15
6	16502.3	90.00	0.00	7457.0	9284.7	101.0	0.00	0.00	9285.2	567-1411H PBH 4-17-15

## TARGET DETAILS

Name	TVD	+N/-S	+E/-W	Northing	Easting	Latitude	Longitude	Shape
567-1411H PBH 4-17-15	7457.0	9284.7	101.0	588083.98	2303679.27	40° 56' 33.059 N	104° 24' 3.006 W	Point

# **Denver Division- Colorado**

**DJ - Hereford Ranch  
Crittter Creek C14 SESW Pad  
Crittter Creek 567-1411H**

**Wellbore #1**

**Plan: APD Plan (Plat 4-17-15)**

## **Standard Planning Report**

**09 July, 2015**

# EOG Resources, Inc.

## Planning Report

<b>Database:</b>	EDM_DENVER	<b>Local Co-ordinate Reference:</b>	Well Critter Creek 567-1411H
<b>Company:</b>	Denver Division- Colorado	<b>TVD Reference:</b>	WELL @ 5238.0usft (Original Well Elev)
<b>Project:</b>	DJ - Hereford Ranch	<b>MD Reference:</b>	WELL @ 5238.0usft (Original Well Elev)
<b>Site:</b>	Critter Creek C14 SESW Pad	<b>North Reference:</b>	True
<b>Well:</b>	Critter Creek 567-1411H	<b>Survey Calculation Method:</b>	Minimum Curvature
<b>Wellbore:</b>	Wellbore #1		
<b>Design:</b>	APD Plan (Plat 4-17-15)		

<b>Project</b>	DJ - Hereford Ranch, Weld County		
<b>Map System:</b>	US State Plane 1927 (Exact solution)	<b>System Datum:</b>	Mean Sea Level
<b>Geo Datum:</b>	NAD 1927 (NADCON CONUS)		
<b>Map Zone:</b>	Colorado North 501		

<b>Site</b>	Critter Creek C14 SESW Pad		
<b>Site Position:</b>		<b>Northing:</b>	578,750.00 usft
<b>From:</b>	Map	<b>Easting:</b>	2,303,550.00 usft
<b>Position Uncertainty:</b>	0.0 usft	<b>Slot Radius:</b>	13-3/16 "
		<b>Latitude:</b>	40° 55' 0.856 N
		<b>Longitude:</b>	104° 24' 6.196 W
		<b>Grid Convergence:</b>	0.71 °

<b>Well</b>	Critter Creek 567-1411H		
<b>Well Position</b>	<b>+N/-S</b>	47.0 usft	<b>Northing:</b>
	<b>+E/-W</b>	143.9 usft	<b>Easting:</b>
<b>Position Uncertainty</b>	0.0 usft	<b>Wellhead Elevation:</b>	0.0 usft
		<b>Latitude:</b>	40° 55' 1.320 N
		<b>Longitude:</b>	104° 24' 4.322 W
		<b>Ground Level:</b>	5,213.0 usft

<b>Wellbore</b>	Wellbore #1		
<b>Magnetics</b>	<b>Model Name</b>	<b>Sample Date</b>	<b>Declination</b>
			(°)
	IGRF2015	7/9/2015	8.26
			<b>Dip Angle</b>
			(°)
			67.37
			<b>Field Strength</b>
			(nT)
			52,916

<b>Design</b>	APD Plan (Plat 4-17-15)		
<b>Audit Notes:</b>			
<b>Version:</b>	<b>Phase:</b>	PROTOTYPE	<b>Tie On Depth:</b>
			0.0
<b>Vertical Section:</b>	<b>Depth From (TVD)</b>	<b>+N/-S</b>	<b>+E/-W</b>
	(usft)	(usft)	(usft)
	0.0	0.0	0.0
			<b>Direction</b>
			(°)
			0.62

<b>Plan Sections</b>										
<b>Measured</b>	<b>Inclination</b>	<b>Azimuth</b>	<b>Vertical</b>	<b>+N/-S</b>	<b>+E/-W</b>	<b>Dogleg</b>	<b>Build</b>	<b>Turn</b>	<b>TFO</b>	<b>Target</b>
<b>Depth</b>	(°)	(°)	<b>Depth</b>	(usft)	(usft)	<b>Rate</b>	<b>Rate</b>	<b>Rate</b>	(°)	
(usft)			(usft)			(°/100usft)	(°/100usft)	(°/100usft)		
0.0	0.00	0.00	0.0	0.0	0.0	0.00	0.00	0.00	0.00	
6,884.0	0.00	0.00	6,884.0	0.0	0.0	0.00	0.00	0.00	0.00	
7,784.0	90.00	8.00	7,457.0	567.4	79.7	10.00	10.00	0.00	8.00	
7,799.0	90.00	8.00	7,457.0	582.2	81.8	0.00	0.00	0.00	0.00	
8,065.5	90.00	0.00	7,457.0	847.9	100.4	3.00	0.00	-3.00	-90.00	567-1411H PBH 4-17-
16,502.3	90.00	0.00	7,457.0	9,284.7	101.0	0.00	0.00	0.00	0.00	567-1411H PBH 4-17-

# EOG Resources, Inc.

## Planning Report

<b>Database:</b>	EDM_DENVER	<b>Local Co-ordinate Reference:</b>	Well Critter Creek 567-1411H
<b>Company:</b>	Denver Division- Colorado	<b>TVD Reference:</b>	WELL @ 5238.0usft (Original Well Elev)
<b>Project:</b>	DJ - Hereford Ranch	<b>MD Reference:</b>	WELL @ 5238.0usft (Original Well Elev)
<b>Site:</b>	Critter Creek C14 SESW Pad	<b>North Reference:</b>	True
<b>Well:</b>	Critter Creek 567-1411H	<b>Survey Calculation Method:</b>	Minimum Curvature
<b>Wellbore:</b>	Wellbore #1		
<b>Design:</b>	APD Plan (Plat 4-17-15)		

Planned Survey									
Measured Depth (usft)	Inclination (°)	Azimuth (°)	Vertical Depth (usft)	+N/-S (usft)	+E/-W (usft)	Vertical Section (usft)	Dogleg Rate (°/100usft)	Build Rate (°/100usft)	Turn Rate (°/100usft)
0.0	0.00	0.00	0.0	0.0	0.0	0.0	0.00	0.00	0.00
100.0	0.00	0.00	100.0	0.0	0.0	0.0	0.00	0.00	0.00
200.0	0.00	0.00	200.0	0.0	0.0	0.0	0.00	0.00	0.00
300.0	0.00	0.00	300.0	0.0	0.0	0.0	0.00	0.00	0.00
400.0	0.00	0.00	400.0	0.0	0.0	0.0	0.00	0.00	0.00
500.0	0.00	0.00	500.0	0.0	0.0	0.0	0.00	0.00	0.00
600.0	0.00	0.00	600.0	0.0	0.0	0.0	0.00	0.00	0.00
700.0	0.00	0.00	700.0	0.0	0.0	0.0	0.00	0.00	0.00
800.0	0.00	0.00	800.0	0.0	0.0	0.0	0.00	0.00	0.00
900.0	0.00	0.00	900.0	0.0	0.0	0.0	0.00	0.00	0.00
1,000.0	0.00	0.00	1,000.0	0.0	0.0	0.0	0.00	0.00	0.00
1,100.0	0.00	0.00	1,100.0	0.0	0.0	0.0	0.00	0.00	0.00
1,191.0	0.00	0.00	1,191.0	0.0	0.0	0.0	0.00	0.00	0.00
9-5/8" Surface									
1,200.0	0.00	0.00	1,200.0	0.0	0.0	0.0	0.00	0.00	0.00
1,300.0	0.00	0.00	1,300.0	0.0	0.0	0.0	0.00	0.00	0.00
1,400.0	0.00	0.00	1,400.0	0.0	0.0	0.0	0.00	0.00	0.00
1,500.0	0.00	0.00	1,500.0	0.0	0.0	0.0	0.00	0.00	0.00
1,600.0	0.00	0.00	1,600.0	0.0	0.0	0.0	0.00	0.00	0.00
1,700.0	0.00	0.00	1,700.0	0.0	0.0	0.0	0.00	0.00	0.00
1,800.0	0.00	0.00	1,800.0	0.0	0.0	0.0	0.00	0.00	0.00
1,900.0	0.00	0.00	1,900.0	0.0	0.0	0.0	0.00	0.00	0.00
2,000.0	0.00	0.00	2,000.0	0.0	0.0	0.0	0.00	0.00	0.00
2,100.0	0.00	0.00	2,100.0	0.0	0.0	0.0	0.00	0.00	0.00
2,200.0	0.00	0.00	2,200.0	0.0	0.0	0.0	0.00	0.00	0.00
2,300.0	0.00	0.00	2,300.0	0.0	0.0	0.0	0.00	0.00	0.00
2,400.0	0.00	0.00	2,400.0	0.0	0.0	0.0	0.00	0.00	0.00
2,500.0	0.00	0.00	2,500.0	0.0	0.0	0.0	0.00	0.00	0.00
2,600.0	0.00	0.00	2,600.0	0.0	0.0	0.0	0.00	0.00	0.00
2,700.0	0.00	0.00	2,700.0	0.0	0.0	0.0	0.00	0.00	0.00
2,800.0	0.00	0.00	2,800.0	0.0	0.0	0.0	0.00	0.00	0.00
2,900.0	0.00	0.00	2,900.0	0.0	0.0	0.0	0.00	0.00	0.00
3,000.0	0.00	0.00	3,000.0	0.0	0.0	0.0	0.00	0.00	0.00
3,100.0	0.00	0.00	3,100.0	0.0	0.0	0.0	0.00	0.00	0.00
3,200.0	0.00	0.00	3,200.0	0.0	0.0	0.0	0.00	0.00	0.00
3,300.0	0.00	0.00	3,300.0	0.0	0.0	0.0	0.00	0.00	0.00
3,400.0	0.00	0.00	3,400.0	0.0	0.0	0.0	0.00	0.00	0.00
3,500.0	0.00	0.00	3,500.0	0.0	0.0	0.0	0.00	0.00	0.00
3,600.0	0.00	0.00	3,600.0	0.0	0.0	0.0	0.00	0.00	0.00
3,700.0	0.00	0.00	3,700.0	0.0	0.0	0.0	0.00	0.00	0.00
3,800.0	0.00	0.00	3,800.0	0.0	0.0	0.0	0.00	0.00	0.00
3,900.0	0.00	0.00	3,900.0	0.0	0.0	0.0	0.00	0.00	0.00
4,000.0	0.00	0.00	4,000.0	0.0	0.0	0.0	0.00	0.00	0.00
4,100.0	0.00	0.00	4,100.0	0.0	0.0	0.0	0.00	0.00	0.00
4,200.0	0.00	0.00	4,200.0	0.0	0.0	0.0	0.00	0.00	0.00
4,300.0	0.00	0.00	4,300.0	0.0	0.0	0.0	0.00	0.00	0.00
4,400.0	0.00	0.00	4,400.0	0.0	0.0	0.0	0.00	0.00	0.00
4,500.0	0.00	0.00	4,500.0	0.0	0.0	0.0	0.00	0.00	0.00
4,600.0	0.00	0.00	4,600.0	0.0	0.0	0.0	0.00	0.00	0.00
4,700.0	0.00	0.00	4,700.0	0.0	0.0	0.0	0.00	0.00	0.00
4,800.0	0.00	0.00	4,800.0	0.0	0.0	0.0	0.00	0.00	0.00
4,900.0	0.00	0.00	4,900.0	0.0	0.0	0.0	0.00	0.00	0.00
5,000.0	0.00	0.00	5,000.0	0.0	0.0	0.0	0.00	0.00	0.00
5,100.0	0.00	0.00	5,100.0	0.0	0.0	0.0	0.00	0.00	0.00

# EOG Resources, Inc.

## Planning Report

<b>Database:</b>	EDM_DENVER	<b>Local Co-ordinate Reference:</b>	Well Critter Creek 567-1411H
<b>Company:</b>	Denver Division- Colorado	<b>TVD Reference:</b>	WELL @ 5238.0usft (Original Well Elev)
<b>Project:</b>	DJ - Hereford Ranch	<b>MD Reference:</b>	WELL @ 5238.0usft (Original Well Elev)
<b>Site:</b>	Critter Creek C14 SESW Pad	<b>North Reference:</b>	True
<b>Well:</b>	Critter Creek 567-1411H	<b>Survey Calculation Method:</b>	Minimum Curvature
<b>Wellbore:</b>	Wellbore #1		
<b>Design:</b>	APD Plan (Plat 4-17-15)		

Planned Survey									
Measured Depth (usft)	Inclination (°)	Azimuth (°)	Vertical Depth (usft)	+N/-S (usft)	+E/-W (usft)	Vertical Section (usft)	Dogleg Rate (°/100usft)	Build Rate (°/100usft)	Turn Rate (°/100usft)
5,200.0	0.00	0.00	5,200.0	0.0	0.0	0.0	0.00	0.00	0.00
5,300.0	0.00	0.00	5,300.0	0.0	0.0	0.0	0.00	0.00	0.00
5,400.0	0.00	0.00	5,400.0	0.0	0.0	0.0	0.00	0.00	0.00
5,500.0	0.00	0.00	5,500.0	0.0	0.0	0.0	0.00	0.00	0.00
5,600.0	0.00	0.00	5,600.0	0.0	0.0	0.0	0.00	0.00	0.00
5,700.0	0.00	0.00	5,700.0	0.0	0.0	0.0	0.00	0.00	0.00
5,800.0	0.00	0.00	5,800.0	0.0	0.0	0.0	0.00	0.00	0.00
5,900.0	0.00	0.00	5,900.0	0.0	0.0	0.0	0.00	0.00	0.00
6,000.0	0.00	0.00	6,000.0	0.0	0.0	0.0	0.00	0.00	0.00
6,100.0	0.00	0.00	6,100.0	0.0	0.0	0.0	0.00	0.00	0.00
6,200.0	0.00	0.00	6,200.0	0.0	0.0	0.0	0.00	0.00	0.00
6,300.0	0.00	0.00	6,300.0	0.0	0.0	0.0	0.00	0.00	0.00
6,400.0	0.00	0.00	6,400.0	0.0	0.0	0.0	0.00	0.00	0.00
6,500.0	0.00	0.00	6,500.0	0.0	0.0	0.0	0.00	0.00	0.00
6,600.0	0.00	0.00	6,600.0	0.0	0.0	0.0	0.00	0.00	0.00
6,700.0	0.00	0.00	6,700.0	0.0	0.0	0.0	0.00	0.00	0.00
6,800.0	0.00	0.00	6,800.0	0.0	0.0	0.0	0.00	0.00	0.00
6,884.0	0.00	0.00	6,884.0	0.0	0.0	0.0	0.00	0.00	0.00
6,900.0	1.60	8.00	6,900.0	0.2	0.0	0.2	10.00	10.00	0.00
7,000.0	11.60	8.00	6,999.2	11.6	1.6	11.6	10.00	10.00	0.00
7,100.0	21.60	8.00	7,094.9	39.8	5.6	39.9	10.00	10.00	0.00
7,200.0	31.60	8.00	7,184.2	84.1	11.8	84.3	10.00	10.00	0.00
7,300.0	41.60	8.00	7,264.4	143.1	20.1	143.3	10.00	10.00	0.00
7,400.0	51.60	8.00	7,333.0	215.0	30.2	215.3	10.00	10.00	0.00
7,500.0	61.60	8.00	7,388.0	297.5	41.8	298.0	10.00	10.00	0.00
7,600.0	71.60	8.00	7,427.7	388.3	54.6	388.9	10.00	10.00	0.00
7,700.0	81.60	8.00	7,450.8	484.5	68.1	485.2	10.00	10.00	0.00
7,784.0	90.00	8.00	7,457.0	567.4	79.7	568.2	10.00	10.00	0.00
7" Inter (OPT 2)									
7,799.0	90.00	8.00	7,457.0	582.2	81.8	583.1	0.00	0.00	0.00
7,800.0	90.00	7.97	7,457.0	583.2	82.0	584.1	3.00	0.00	-3.00
7,900.0	90.00	4.97	7,457.0	682.6	93.2	683.6	3.00	0.00	-3.00
8,000.0	90.00	1.97	7,457.0	782.4	99.3	783.4	3.00	0.00	-3.00
8,065.5	90.00	0.00	7,457.0	847.9	100.4	848.9	3.00	0.00	-3.00
8,100.0	90.00	0.00	7,457.0	882.4	100.4	883.4	0.00	0.00	0.00
8,200.0	90.00	0.00	7,457.0	982.4	100.4	983.4	0.00	0.00	0.00
8,300.0	90.00	0.00	7,457.0	1,082.4	100.4	1,083.4	0.00	0.00	0.00
8,400.0	90.00	0.00	7,457.0	1,182.4	100.4	1,183.4	0.00	0.00	0.00
8,500.0	90.00	0.00	7,457.0	1,282.4	100.4	1,283.4	0.00	0.00	0.00
8,600.0	90.00	0.00	7,457.0	1,382.4	100.5	1,383.4	0.00	0.00	0.00
8,700.0	90.00	0.00	7,457.0	1,482.4	100.5	1,483.4	0.00	0.00	0.00
8,800.0	90.00	0.00	7,457.0	1,582.4	100.5	1,583.4	0.00	0.00	0.00
8,900.0	90.00	0.00	7,457.0	1,682.4	100.5	1,683.4	0.00	0.00	0.00
9,000.0	90.00	0.00	7,457.0	1,782.4	100.5	1,783.4	0.00	0.00	0.00
9,100.0	90.00	0.00	7,457.0	1,882.4	100.5	1,883.4	0.00	0.00	0.00
9,200.0	90.00	0.00	7,457.0	1,982.4	100.5	1,983.3	0.00	0.00	0.00
9,300.0	90.00	0.00	7,457.0	2,082.4	100.5	2,083.3	0.00	0.00	0.00
9,400.0	90.00	0.00	7,457.0	2,182.4	100.5	2,183.3	0.00	0.00	0.00
9,500.0	90.00	0.00	7,457.0	2,282.4	100.5	2,283.3	0.00	0.00	0.00
9,600.0	90.00	0.00	7,457.0	2,382.4	100.5	2,383.3	0.00	0.00	0.00
9,700.0	90.00	0.00	7,457.0	2,482.4	100.5	2,483.3	0.00	0.00	0.00
9,800.0	90.00	0.00	7,457.0	2,582.4	100.5	2,583.3	0.00	0.00	0.00
9,900.0	90.00	0.00	7,457.0	2,682.4	100.5	2,683.3	0.00	0.00	0.00

# EOG Resources, Inc.

## Planning Report

<b>Database:</b>	EDM_DENVER	<b>Local Co-ordinate Reference:</b>	Well Critter Creek 567-1411H
<b>Company:</b>	Denver Division- Colorado	<b>TVD Reference:</b>	WELL @ 5238.0usft (Original Well Elev)
<b>Project:</b>	DJ - Hereford Ranch	<b>MD Reference:</b>	WELL @ 5238.0usft (Original Well Elev)
<b>Site:</b>	Critter Creek C14 SESW Pad	<b>North Reference:</b>	True
<b>Well:</b>	Critter Creek 567-1411H	<b>Survey Calculation Method:</b>	Minimum Curvature
<b>Wellbore:</b>	Wellbore #1		
<b>Design:</b>	APD Plan (Plat 4-17-15)		

Planned Survey									
Measured Depth (usft)	Inclination (°)	Azimuth (°)	Vertical Depth (usft)	+N/-S (usft)	+E/-W (usft)	Vertical Section (usft)	Dogleg Rate (°/100usft)	Build Rate (°/100usft)	Turn Rate (°/100usft)
10,000.0	90.00	0.00	7,457.0	2,782.4	100.6	2,783.3	0.00	0.00	0.00
10,100.0	90.00	0.00	7,457.0	2,882.4	100.6	2,883.3	0.00	0.00	0.00
10,200.0	90.00	0.00	7,457.0	2,982.4	100.6	2,983.3	0.00	0.00	0.00
10,300.0	90.00	0.00	7,457.0	3,082.4	100.6	3,083.3	0.00	0.00	0.00
10,400.0	90.00	0.00	7,457.0	3,182.4	100.6	3,183.3	0.00	0.00	0.00
10,500.0	90.00	0.00	7,457.0	3,282.4	100.6	3,283.3	0.00	0.00	0.00
10,600.0	90.00	0.00	7,457.0	3,382.4	100.6	3,383.3	0.00	0.00	0.00
10,700.0	90.00	0.00	7,457.0	3,482.4	100.6	3,483.3	0.00	0.00	0.00
10,800.0	90.00	0.00	7,457.0	3,582.4	100.6	3,583.3	0.00	0.00	0.00
10,900.0	90.00	0.00	7,457.0	3,682.4	100.6	3,683.2	0.00	0.00	0.00
11,000.0	90.00	0.00	7,457.0	3,782.4	100.6	3,783.2	0.00	0.00	0.00
11,100.0	90.00	0.00	7,457.0	3,882.4	100.6	3,883.2	0.00	0.00	0.00
11,200.0	90.00	0.00	7,457.0	3,982.4	100.6	3,983.2	0.00	0.00	0.00
11,300.0	90.00	0.00	7,457.0	4,082.4	100.7	4,083.2	0.00	0.00	0.00
11,400.0	90.00	0.00	7,457.0	4,182.4	100.7	4,183.2	0.00	0.00	0.00
11,500.0	90.00	0.00	7,457.0	4,282.4	100.7	4,283.2	0.00	0.00	0.00
11,600.0	90.00	0.00	7,457.0	4,382.4	100.7	4,383.2	0.00	0.00	0.00
11,700.0	90.00	0.00	7,457.0	4,482.4	100.7	4,483.2	0.00	0.00	0.00
11,800.0	90.00	0.00	7,457.0	4,582.4	100.7	4,583.2	0.00	0.00	0.00
11,900.0	90.00	0.00	7,457.0	4,682.4	100.7	4,683.2	0.00	0.00	0.00
12,000.0	90.00	0.00	7,457.0	4,782.4	100.7	4,783.2	0.00	0.00	0.00
12,100.0	90.00	0.00	7,457.0	4,882.4	100.7	4,883.2	0.00	0.00	0.00
12,200.0	90.00	0.00	7,457.0	4,982.4	100.7	4,983.2	0.00	0.00	0.00
12,300.0	90.00	0.00	7,457.0	5,082.4	100.7	5,083.2	0.00	0.00	0.00
12,400.0	90.00	0.00	7,457.0	5,182.4	100.7	5,183.2	0.00	0.00	0.00
12,500.0	90.00	0.00	7,457.0	5,282.4	100.7	5,283.2	0.00	0.00	0.00
12,600.0	90.00	0.00	7,457.0	5,382.4	100.7	5,383.1	0.00	0.00	0.00
12,700.0	90.00	0.00	7,457.0	5,482.4	100.8	5,483.1	0.00	0.00	0.00
12,800.0	90.00	0.00	7,457.0	5,582.4	100.8	5,583.1	0.00	0.00	0.00
12,900.0	90.00	0.00	7,457.0	5,682.4	100.8	5,683.1	0.00	0.00	0.00
13,000.0	90.00	0.00	7,457.0	5,782.4	100.8	5,783.1	0.00	0.00	0.00
13,100.0	90.00	0.00	7,457.0	5,882.4	100.8	5,883.1	0.00	0.00	0.00
13,200.0	90.00	0.00	7,457.0	5,982.4	100.8	5,983.1	0.00	0.00	0.00
13,300.0	90.00	0.00	7,457.0	6,082.4	100.8	6,083.1	0.00	0.00	0.00
13,400.0	90.00	0.00	7,457.0	6,182.4	100.8	6,183.1	0.00	0.00	0.00
13,500.0	90.00	0.00	7,457.0	6,282.4	100.8	6,283.1	0.00	0.00	0.00
13,600.0	90.00	0.00	7,457.0	6,382.4	100.8	6,383.1	0.00	0.00	0.00
13,700.0	90.00	0.00	7,457.0	6,482.4	100.8	6,483.1	0.00	0.00	0.00
13,800.0	90.00	0.00	7,457.0	6,582.4	100.8	6,583.1	0.00	0.00	0.00
13,900.0	90.00	0.00	7,457.0	6,682.4	100.8	6,683.1	0.00	0.00	0.00
14,000.0	90.00	0.00	7,457.0	6,782.4	100.9	6,783.1	0.00	0.00	0.00
14,100.0	90.00	0.00	7,457.0	6,882.4	100.9	6,883.1	0.00	0.00	0.00
14,200.0	90.00	0.00	7,457.0	6,982.4	100.9	6,983.1	0.00	0.00	0.00
14,300.0	90.00	0.00	7,457.0	7,082.4	100.9	7,083.0	0.00	0.00	0.00
14,400.0	90.00	0.00	7,457.0	7,182.4	100.9	7,183.0	0.00	0.00	0.00
14,500.0	90.00	0.00	7,457.0	7,282.4	100.9	7,283.0	0.00	0.00	0.00
14,600.0	90.00	0.00	7,457.0	7,382.4	100.9	7,383.0	0.00	0.00	0.00
14,700.0	90.00	0.00	7,457.0	7,482.4	100.9	7,483.0	0.00	0.00	0.00
14,800.0	90.00	0.00	7,457.0	7,582.4	100.9	7,583.0	0.00	0.00	0.00
14,900.0	90.00	0.00	7,457.0	7,682.4	100.9	7,683.0	0.00	0.00	0.00
15,000.0	90.00	0.00	7,457.0	7,782.4	100.9	7,783.0	0.00	0.00	0.00
15,100.0	90.00	0.00	7,457.0	7,882.4	100.9	7,883.0	0.00	0.00	0.00
15,200.0	90.00	0.00	7,457.0	7,982.4	100.9	7,983.0	0.00	0.00	0.00
15,300.0	90.00	0.00	7,457.0	8,082.4	100.9	8,083.0	0.00	0.00	0.00

# EOG Resources, Inc.

## Planning Report

<b>Database:</b>	EDM_DENVER	<b>Local Co-ordinate Reference:</b>	Well Critter Creek 567-1411H
<b>Company:</b>	Denver Division- Colorado	<b>TVD Reference:</b>	WELL @ 5238.0usft (Original Well Elev)
<b>Project:</b>	DJ - Hereford Ranch	<b>MD Reference:</b>	WELL @ 5238.0usft (Original Well Elev)
<b>Site:</b>	Critter Creek C14 SESW Pad	<b>North Reference:</b>	True
<b>Well:</b>	Critter Creek 567-1411H	<b>Survey Calculation Method:</b>	Minimum Curvature
<b>Wellbore:</b>	Wellbore #1		
<b>Design:</b>	APD Plan (Plat 4-17-15)		

Planned Survey										
Measured Depth (usft)	Inclination (°)	Azimuth (°)	Vertical Depth (usft)	+N/-S (usft)	+E/-W (usft)	Vertical Section (usft)	Dogleg Rate (°/100usft)	Build Rate (°/100usft)	Turn Rate (°/100usft)	
15,400.0	90.00	0.00	7,457.0	8,182.4	101.0	8,183.0	0.00	0.00	0.00	
15,500.0	90.00	0.00	7,457.0	8,282.4	101.0	8,283.0	0.00	0.00	0.00	
15,600.0	90.00	0.00	7,457.0	8,382.4	101.0	8,383.0	0.00	0.00	0.00	
15,700.0	90.00	0.00	7,457.0	8,482.4	101.0	8,483.0	0.00	0.00	0.00	
15,800.0	90.00	0.00	7,457.0	8,582.4	101.0	8,583.0	0.00	0.00	0.00	
15,900.0	90.00	0.00	7,457.0	8,682.4	101.0	8,683.0	0.00	0.00	0.00	
16,000.0	90.00	0.00	7,457.0	8,782.4	101.0	8,782.9	0.00	0.00	0.00	
16,100.0	90.00	0.00	7,457.0	8,882.4	101.0	8,882.9	0.00	0.00	0.00	
16,200.0	90.00	0.00	7,457.0	8,982.4	101.0	8,982.9	0.00	0.00	0.00	
16,300.0	90.00	0.00	7,457.0	9,082.4	101.0	9,082.9	0.00	0.00	0.00	
16,400.0	90.00	0.00	7,457.0	9,182.4	101.0	9,182.9	0.00	0.00	0.00	
16,500.0	90.00	0.00	7,457.0	9,282.4	101.0	9,282.9	0.00	0.00	0.00	
16,502.3	90.00	0.00	7,457.0	9,284.7	101.0	9,285.2	0.00	0.00	0.00	
5-1/2" Prod (OPT 1) - 4-1/2" Liner (OPT 2)										

Design Targets										
Target Name	Dip Angle (°)	Dip Dir. (°)	TVD (usft)	+N/-S (usft)	+E/-W (usft)	Northing (usft)	Easting (usft)	Latitude	Longitude	
- hit/miss target										
- Shape										
567-1411H PBH 4-17-15	0.00	0.00	7,457.0	9,284.7	101.0	588,083.98	2,303,679.27	40° 56' 33.059 N	104° 24' 3.006 W	
- plan hits target center										
- Point										

Casing Points						
Measured Depth (usft)	Vertical Depth (usft)	Name	Casing Diameter (")	Hole Diameter (")		
1,191.0	1,191.0	9-5/8" Surface	9-5/8	13-1/2		
7,784.0	7,457.0	7" Inter (OPT 2)	7	8-3/4		
16,502.3	7,457.0	5-1/2" Prod (OPT 1)	5-1/2	8-3/4		
16,502.3	7,457.0	4-1/2" Liner (OPT 2)	4-1/2	6		