

Topographic map showing proposed access roads and leases. The map includes County Road 57, Private Road, Lease 10, and Lease 11. It also shows Guttersten State DD17-755 and Guttersten State DD08-785. A disturbed area is marked near the state leases. The map features contour lines, spot elevations, and various labels for roads and leases.



OG PROPOSED WELL

DATE: 06/30/2014  
JOB NO.: NE14302.1



# ACCESS ROAD MAP

GUTTERSEN STATE DD08-785 & GUTTERSEN STATE DD17-755 PADS

SECTION: 5

TOWNSHIP: 3N

RANGE: 63W

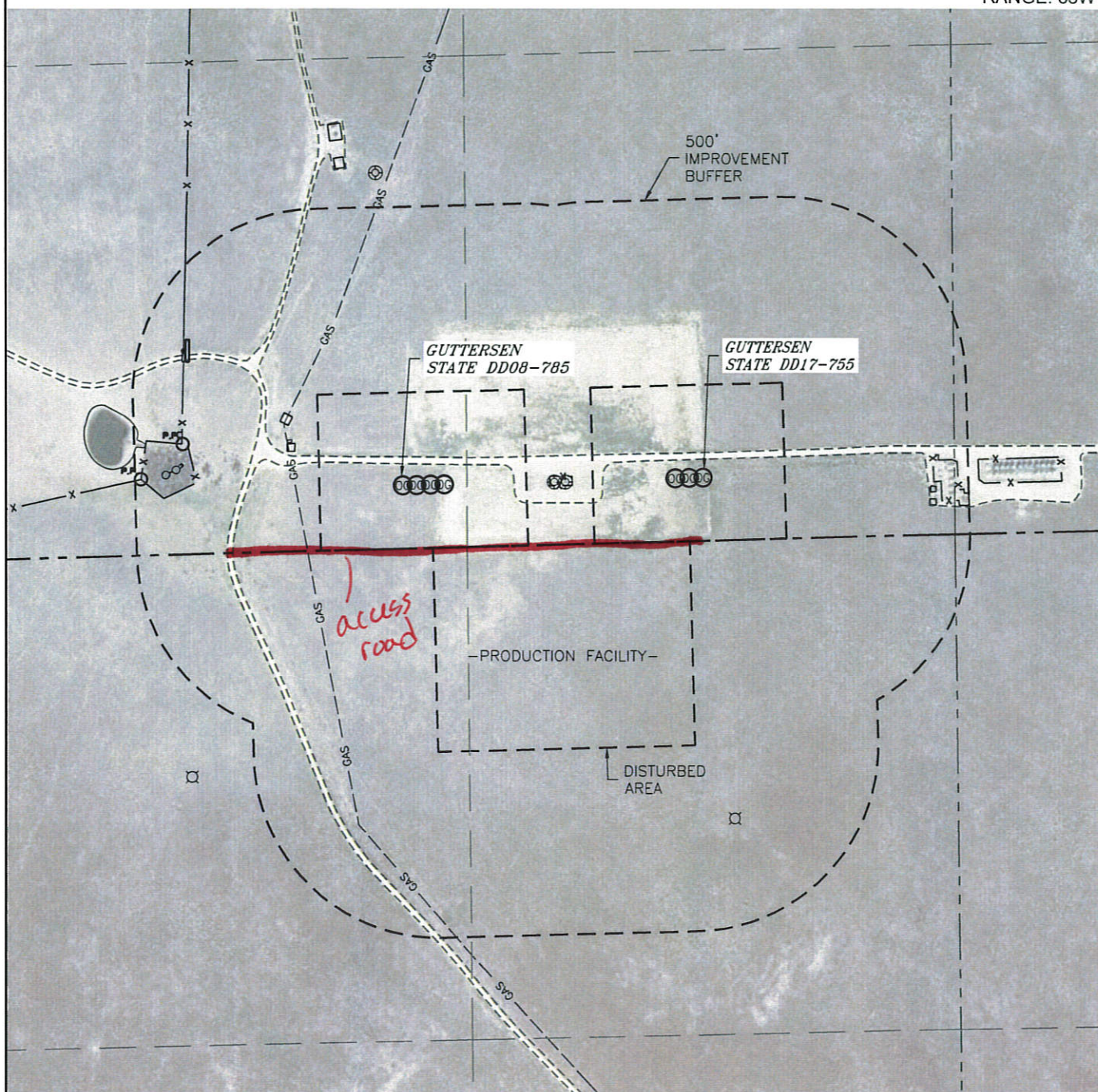

## NEAREST:

BUILDING	5280'+
BUILDING UNIT	5280'+
HIGH OCCUPANCY BUILDING UNIT	5280'+
DESIGNATED OUTSIDE ACTIVITY AREA	5280'+
PUBLIC ROAD (CR 57)	5280'+
ABOVE GROUND UTILITY	5280'+
RAILROAD	5280'+
PROPERTY LINE	0' N

(DISTANCES MEASURED FROM THE CENTER OF THE NEAREST PROPOSED WELL HEAD OR LIMITS OF THE PROPOSED PRODUCTION FACILITY CLOSEST TO THE REFERENCED CULTURAL ITEM)

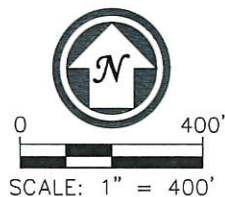

## LEGEND

- ⊗ PROPOSED WELL
- ⊙ EXISTING WELL
- ⊠ ABANDONED WELL

DATE: 06/17/2014  
JOB NO.: NE14302.1