

ROAD ACCESS MAP: NGL APOLLO 11

SECTION 18, TOWNSHIP 6 NORTH, RANGE 63 WEST, 6TH P.M. WELD COUNTY, COLORADO.

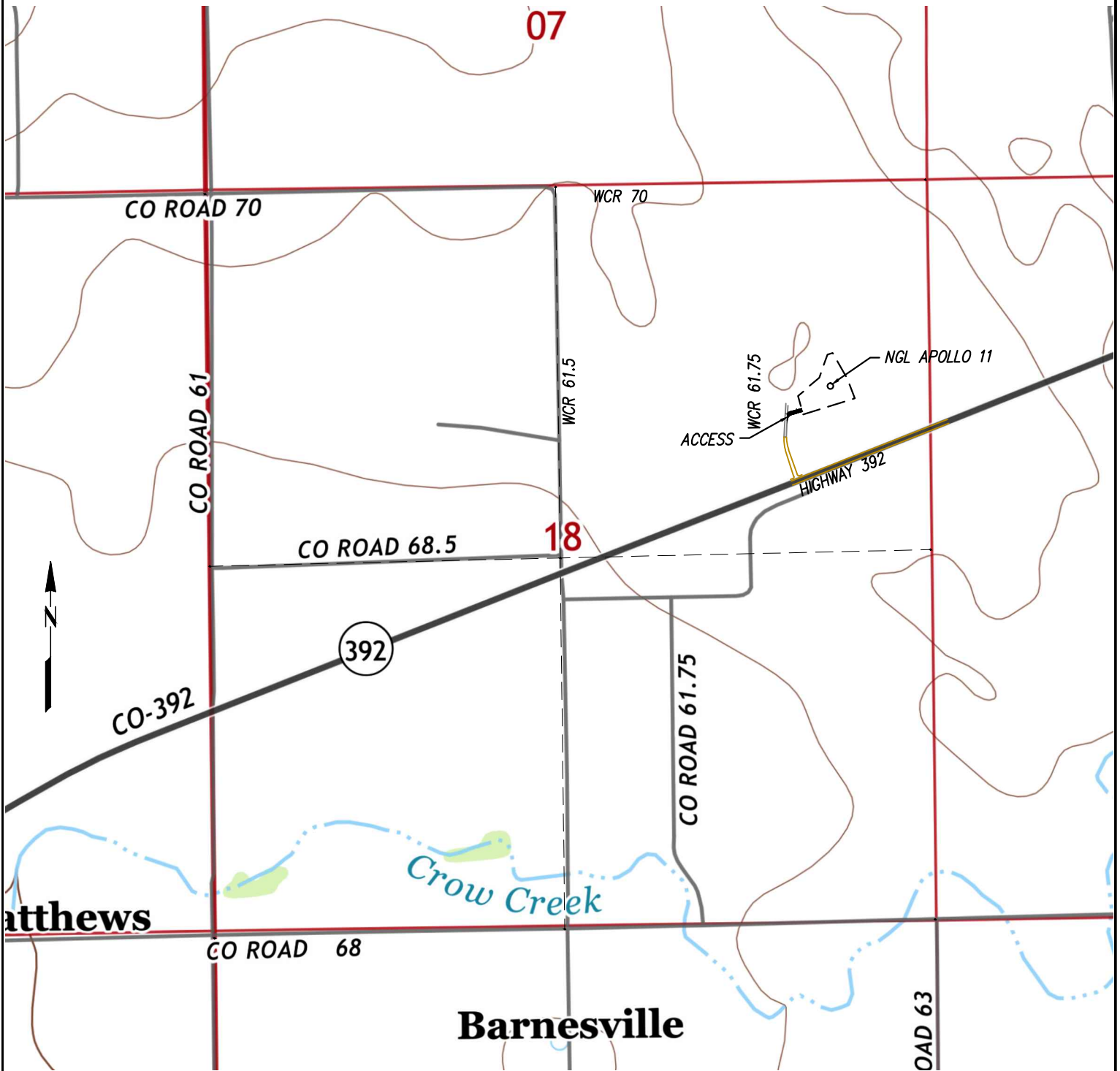

PREPARED FOR:

NGL WATER
SOLUTIONS DJ, LLC



Acklam, Inc.

ROAD ACCESS MAP - NGL APOLLO 11

DATE SURVEYED: 06/26/2015

DATE DRAFTED: 07/02/2015

DRAFTED BY: JAM CHECKED BY: SMF

JOB No. 155082 REVISED:

NGL APOLLO 11

1458' FNL & 699' FEL (SURFACE)

NOTICE: According to Colorado law you must commence any legal action based upon any defect in this survey within three years after you first discover such defect. In no event may any action based upon any defect in this survey be commenced more than ten years from the date of the certification shown hereon.