

HYDROLOGY MAP: NGL APOLLO 11

SECTION 18, TOWNSHIP 6 NORTH, RANGE 63 WEST, 6TH P.M. WELD COUNTY, COLORADO.

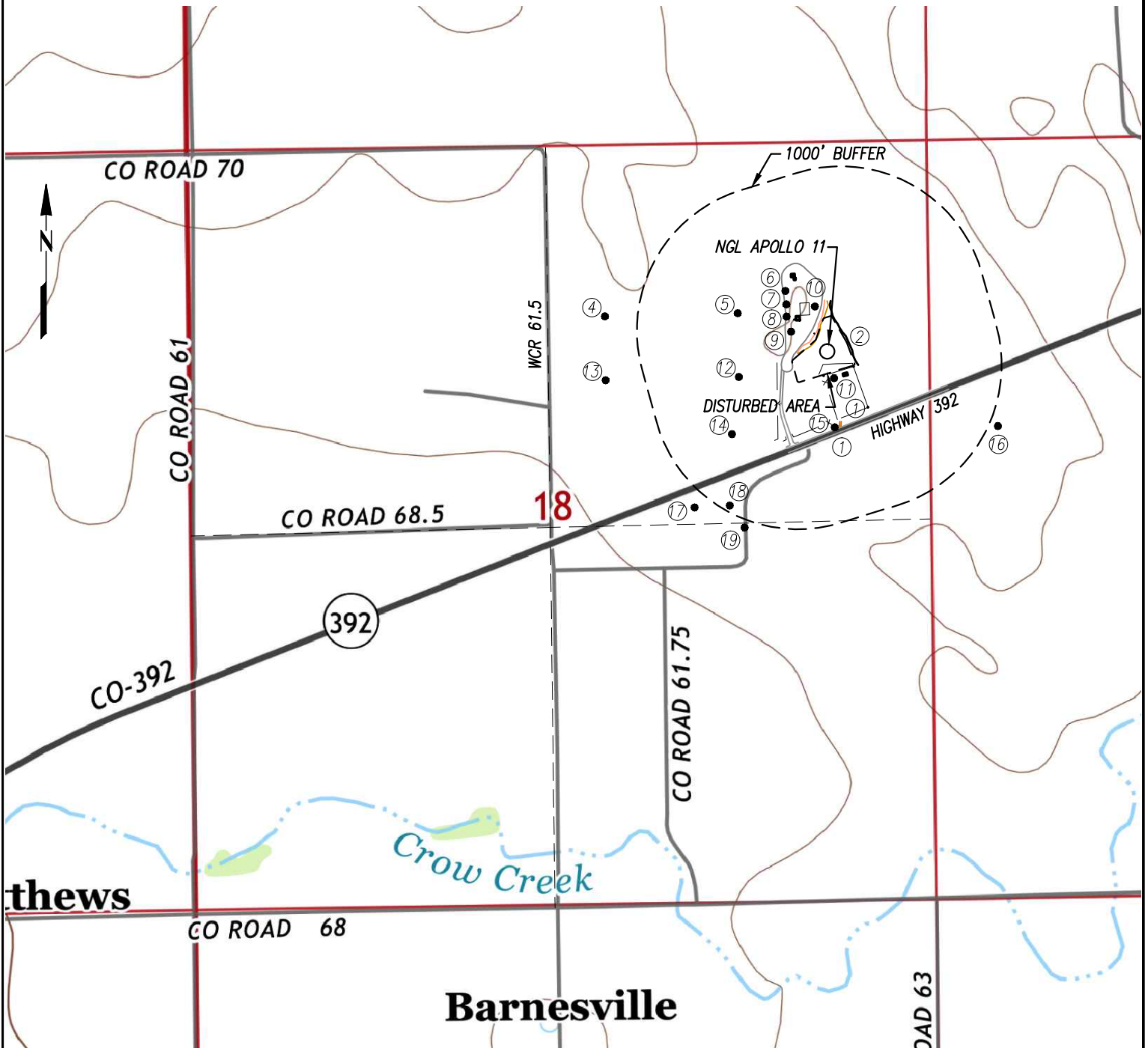

WATER:

- ① DITCH: 502' S, 594' S
- ② LOW WATER AREA: 163' E
- ③ POND: 2706' NE
- ④ WELL PERMIT 224009: 1564' NW
- ⑤ WELL PERMIT 224010: 675' NW
- ⑥ WELL PERMIT 282552: 512' NW
- ⑦ WELL PERMIT 282553: 432' NW
- ⑧ WELL PERMIT 282555: 371' NW

- ⑨ WELL PERMIT 282556: 285' NW
- ⑩ WELL PERMIT 282554: 324' N
- ⑪ WELL PERMIT 279515: 193' SE
- ⑫ WELL PERMIT 224012: 638' SW
- ⑬ WELL PERMIT 224011: 1553' SW
- ⑭ WELL PERMIT 169484: 876' SW
- ⑮ WELL PERMIT 48910-MH-: 531' S
- ⑯ WELL PERMIT 69097-F-: 1297' SE
- ⑰ WELL PERMIT 186934: 1423' SW
- ⑱ WELL PERMIT 185465: 1268' SW
- ⑲ WELL PERMIT 134788: 1352' SW

PREPARED FOR:

NGL WATER
SOLUTIONS DJ, LLC

0' 1000'

Acklam, Inc.

HYDROLOGY MAP - NGL APOLLO 11

DATE SURVEYED: 06/26/2015

DATE DRAFTED: 07/02/2015

DRAFTED BY: JAM CHECKED BY: SMF

JOB No. 155082 REVISED:

NGL APOLLO 11

1458' FNL & 699' FEL (SURFACE)

NOTICE: According to Colorado law you must commence any legal action based upon any defect in this survey within three years after you first discover such defect. In no event may any action based upon any defect in this survey be commenced more than ten years from the date of the certification shown hereon.