



Fox Creek 538-2501H
Section 25-T12N-R63W
Weld County, CO

Project: DJ - Hereford Ranch
Site: Fox Creek F25 SESW Pad
Well: Fox Creek 538-2501H
Plan: APD Plan (Plat Cert 5/12/15)

Surface Location

NAD 1927 (NADCON CONUS) Colorado North 501
Ground Elevation: 5407.0 RKB @ 5432.0usft (KB GL+25')
Northing Easting Latitude Longitude
600051.04 2308528.14 40° 58' 30.691 N 104° 22' 57.866 W

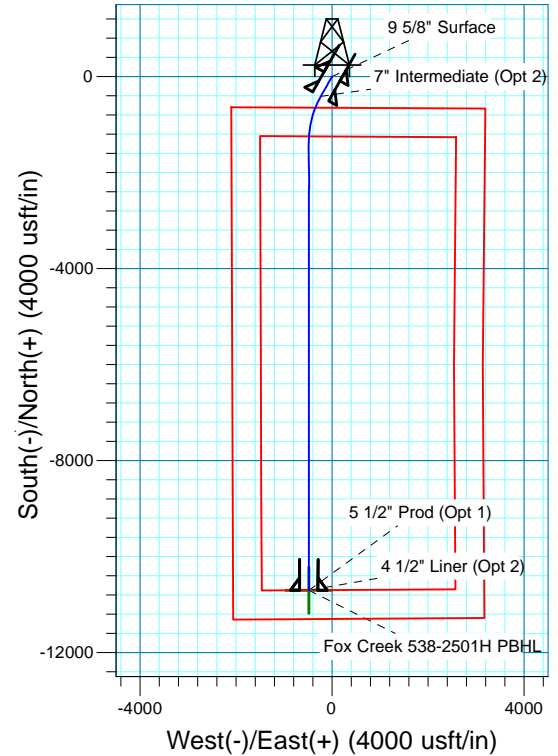
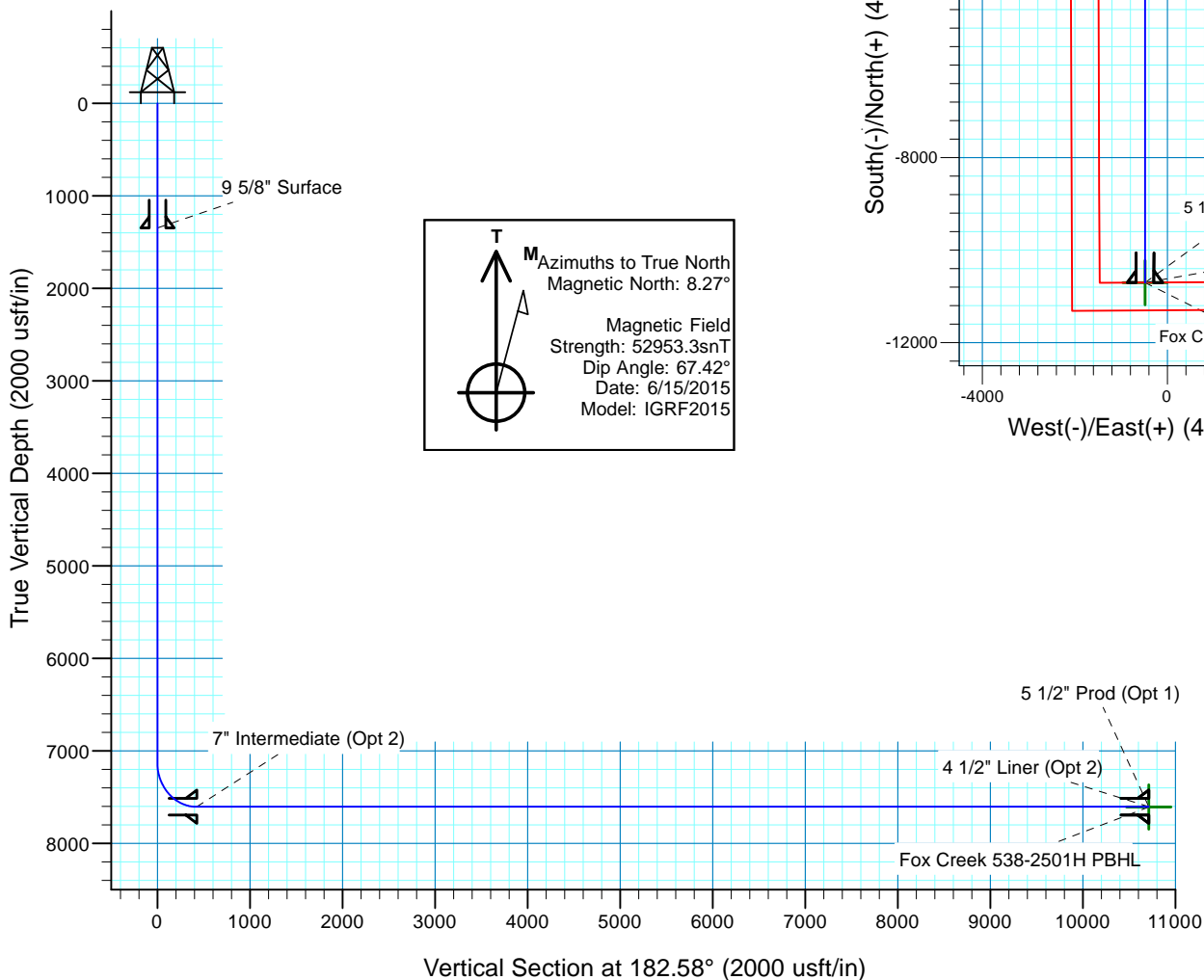

SECTION DETAILS

Sec	MD	Inc	Azi	TVD	+N/-S	+E/-W	Dleg	TFace	VSect	Target
1	0.0	0.00	0.00	0.0	0.0	0.0	0.00	0.00	0.0	
2	7128.5	0.00	0.00	7128.5	0.0	0.0	0.00	0.00	0.0	
3	7878.5	90.00	209.50	7606.0	-415.6	-235.1	12.00	209.50	425.7	
4	8861.8	90.00	180.00	7606.0	-1356.0	-482.7	3.00	-90.00	1376.4	Fox Creek 538-2501H PBHL
5	18208.5	90.00	180.00	7606.0	-10702.7	-482.8	0.00	0.00	10713.6	Fox Creek 538-2501H PBHL

TARGET DETAILS

Name	TVD	+N/-S	+E/-W	Northing	Easting	Latitude	Longitude	Shape
Fox Creek 538-2501H PBHL	7606.0	-10702.7	-482.8	589343.12	2308180.26	40° 56' 44.943 N	104° 23' 4.157 W	Point

Denver Division- Colorado

**DJ - Hereford Ranch
Fox Creek F25 SESW Pad
Fox Creek 538-2501H**

OH

Plan: APD Plan (Plat Cert 5/12/15)

Standard Planning Report

16 June, 2015

EOG Resources, Inc.

Planning Report

Database:	EDM_DENVER	Local Co-ordinate Reference:	Well Fox Creek 538-2501H
Company:	Denver Division- Colorado	TVD Reference:	RKB @ 5432.0usft (KB GL+25')
Project:	DJ - Hereford Ranch	MD Reference:	RKB @ 5432.0usft (KB GL+25')
Site:	Fox Creek F25 SESW Pad	North Reference:	True
Well:	Fox Creek 538-2501H	Survey Calculation Method:	Minimum Curvature
Wellbore:	OH		
Design:	APD Plan (Plat Cert 5/12/15)		

Project	DJ - Hereford Ranch, Weld County		
Map System:	US State Plane 1927 (Exact solution)	System Datum:	Mean Sea Level
Geo Datum:	NAD 1927 (NADCON CONUS)		
Map Zone:	Colorado North 501		

Site	Fox Creek F25 SESW Pad		
Site Position:		Northing:	600,100.00 usft
From:	Map	Easting:	2,308,450.00 usft
Position Uncertainty:	0.0 usft	Slot Radius:	13-3/16 "
		Latitude:	40° 58' 31.185 N
		Longitude:	104° 22' 58.877 W
		Grid Convergence:	0.72 °

Well	Fox Creek 538-2501H		
Well Position	+N/-S	-49.9 usft	Northing:
	+E/-W	77.5 usft	Easting:
Position Uncertainty	0.0 usft	Wellhead Elevation:	0.0 usft
		Latitude:	40° 58' 30.691 N
		Longitude:	104° 22' 57.866 W
		Ground Level:	5,407.0 usft

Wellbore	OH				
Magnetics	Model Name	Sample Date	Declination (°)	Dip Angle (°)	Field Strength (nT)
	IGRF2015	6/15/2015	8.26	67.42	52,953

Design	APD Plan (Plat Cert 5/12/15)			
Audit Notes:				
Version:	Phase:	PROTOTYPE	Tie On Depth:	0.0
Vertical Section:	Depth From (TVD) (usft)	+N/-S (usft)	+E/-W (usft)	Direction (°)
	0.0	0.0	0.0	182.58

Plan Sections										
Measured Depth (usft)	Inclination (°)	Azimuth (°)	Vertical Depth (usft)	+N/-S (usft)	+E/-W (usft)	Dogleg Rate (°/100usft)	Build Rate (°/100usft)	Turn Rate (°/100usft)	TFO (°)	Target
0.0	0.00	0.00	0.0	0.0	0.0	0.00	0.00	0.00	0.00	
7,128.5	0.00	0.00	7,128.5	0.0	0.0	0.00	0.00	0.00	0.00	
7,878.5	90.00	209.50	7,606.0	-415.6	-235.1	12.00	12.00	0.00	209.50	
8,861.8	90.00	180.00	7,606.0	-1,356.0	-482.7	3.00	0.00	-3.00	-90.00	Fox Creek 538-2501H
18,208.5	90.00	180.00	7,606.0	-10,702.7	-482.8	0.00	0.00	0.00	0.00	Fox Creek 538-2501H

EOG Resources, Inc.

Planning Report

Database:	EDM_DENVER	Local Co-ordinate Reference:	Well Fox Creek 538-2501H
Company:	Denver Division- Colorado	TVD Reference:	RKB @ 5432.0usft (KB GL+25')
Project:	DJ - Hereford Ranch	MD Reference:	RKB @ 5432.0usft (KB GL+25')
Site:	Fox Creek F25 SESW Pad	North Reference:	True
Well:	Fox Creek 538-2501H	Survey Calculation Method:	Minimum Curvature
Wellbore:	OH		
Design:	APD Plan (Plat Cert 5/12/15)		

Planned Survey									
Measured Depth (usft)	Inclination (°)	Azimuth (°)	Vertical Depth (usft)	+N/-S (usft)	+E/-W (usft)	Vertical Section (usft)	Dogleg Rate (°/100usft)	Build Rate (°/100usft)	Turn Rate (°/100usft)
0.0	0.00	0.00	0.0	0.0	0.0	0.0	0.00	0.00	0.00
100.0	0.00	0.00	100.0	0.0	0.0	0.0	0.00	0.00	0.00
200.0	0.00	0.00	200.0	0.0	0.0	0.0	0.00	0.00	0.00
300.0	0.00	0.00	300.0	0.0	0.0	0.0	0.00	0.00	0.00
400.0	0.00	0.00	400.0	0.0	0.0	0.0	0.00	0.00	0.00
500.0	0.00	0.00	500.0	0.0	0.0	0.0	0.00	0.00	0.00
600.0	0.00	0.00	600.0	0.0	0.0	0.0	0.00	0.00	0.00
700.0	0.00	0.00	700.0	0.0	0.0	0.0	0.00	0.00	0.00
800.0	0.00	0.00	800.0	0.0	0.0	0.0	0.00	0.00	0.00
900.0	0.00	0.00	900.0	0.0	0.0	0.0	0.00	0.00	0.00
1,000.0	0.00	0.00	1,000.0	0.0	0.0	0.0	0.00	0.00	0.00
1,100.0	0.00	0.00	1,100.0	0.0	0.0	0.0	0.00	0.00	0.00
1,200.0	0.00	0.00	1,200.0	0.0	0.0	0.0	0.00	0.00	0.00
1,300.0	0.00	0.00	1,300.0	0.0	0.0	0.0	0.00	0.00	0.00
1,346.0	0.00	0.00	1,346.0	0.0	0.0	0.0	0.00	0.00	0.00
9 5/8" Surface									
1,400.0	0.00	0.00	1,400.0	0.0	0.0	0.0	0.00	0.00	0.00
1,500.0	0.00	0.00	1,500.0	0.0	0.0	0.0	0.00	0.00	0.00
1,600.0	0.00	0.00	1,600.0	0.0	0.0	0.0	0.00	0.00	0.00
1,700.0	0.00	0.00	1,700.0	0.0	0.0	0.0	0.00	0.00	0.00
1,800.0	0.00	0.00	1,800.0	0.0	0.0	0.0	0.00	0.00	0.00
1,900.0	0.00	0.00	1,900.0	0.0	0.0	0.0	0.00	0.00	0.00
2,000.0	0.00	0.00	2,000.0	0.0	0.0	0.0	0.00	0.00	0.00
2,100.0	0.00	0.00	2,100.0	0.0	0.0	0.0	0.00	0.00	0.00
2,200.0	0.00	0.00	2,200.0	0.0	0.0	0.0	0.00	0.00	0.00
2,300.0	0.00	0.00	2,300.0	0.0	0.0	0.0	0.00	0.00	0.00
2,400.0	0.00	0.00	2,400.0	0.0	0.0	0.0	0.00	0.00	0.00
2,500.0	0.00	0.00	2,500.0	0.0	0.0	0.0	0.00	0.00	0.00
2,600.0	0.00	0.00	2,600.0	0.0	0.0	0.0	0.00	0.00	0.00
2,700.0	0.00	0.00	2,700.0	0.0	0.0	0.0	0.00	0.00	0.00
2,800.0	0.00	0.00	2,800.0	0.0	0.0	0.0	0.00	0.00	0.00
2,900.0	0.00	0.00	2,900.0	0.0	0.0	0.0	0.00	0.00	0.00
3,000.0	0.00	0.00	3,000.0	0.0	0.0	0.0	0.00	0.00	0.00
3,100.0	0.00	0.00	3,100.0	0.0	0.0	0.0	0.00	0.00	0.00
3,200.0	0.00	0.00	3,200.0	0.0	0.0	0.0	0.00	0.00	0.00
3,300.0	0.00	0.00	3,300.0	0.0	0.0	0.0	0.00	0.00	0.00
3,400.0	0.00	0.00	3,400.0	0.0	0.0	0.0	0.00	0.00	0.00
3,500.0	0.00	0.00	3,500.0	0.0	0.0	0.0	0.00	0.00	0.00
3,600.0	0.00	0.00	3,600.0	0.0	0.0	0.0	0.00	0.00	0.00
3,700.0	0.00	0.00	3,700.0	0.0	0.0	0.0	0.00	0.00	0.00
3,800.0	0.00	0.00	3,800.0	0.0	0.0	0.0	0.00	0.00	0.00
3,900.0	0.00	0.00	3,900.0	0.0	0.0	0.0	0.00	0.00	0.00
4,000.0	0.00	0.00	4,000.0	0.0	0.0	0.0	0.00	0.00	0.00
4,100.0	0.00	0.00	4,100.0	0.0	0.0	0.0	0.00	0.00	0.00
4,200.0	0.00	0.00	4,200.0	0.0	0.0	0.0	0.00	0.00	0.00
4,300.0	0.00	0.00	4,300.0	0.0	0.0	0.0	0.00	0.00	0.00
4,400.0	0.00	0.00	4,400.0	0.0	0.0	0.0	0.00	0.00	0.00
4,500.0	0.00	0.00	4,500.0	0.0	0.0	0.0	0.00	0.00	0.00
4,600.0	0.00	0.00	4,600.0	0.0	0.0	0.0	0.00	0.00	0.00
4,700.0	0.00	0.00	4,700.0	0.0	0.0	0.0	0.00	0.00	0.00
4,800.0	0.00	0.00	4,800.0	0.0	0.0	0.0	0.00	0.00	0.00
4,900.0	0.00	0.00	4,900.0	0.0	0.0	0.0	0.00	0.00	0.00
5,000.0	0.00	0.00	5,000.0	0.0	0.0	0.0	0.00	0.00	0.00
5,100.0	0.00	0.00	5,100.0	0.0	0.0	0.0	0.00	0.00	0.00

EOG Resources, Inc.

Planning Report

Database:	EDM_DENVER	Local Co-ordinate Reference:	Well Fox Creek 538-2501H
Company:	Denver Division- Colorado	TVD Reference:	RKB @ 5432.0usft (KB GL+25')
Project:	DJ - Hereford Ranch	MD Reference:	RKB @ 5432.0usft (KB GL+25')
Site:	Fox Creek F25 SESW Pad	North Reference:	True
Well:	Fox Creek 538-2501H	Survey Calculation Method:	Minimum Curvature
Wellbore:	OH		
Design:	APD Plan (Plat Cert 5/12/15)		

Planned Survey									
Measured Depth (usft)	Inclination (°)	Azimuth (°)	Vertical Depth (usft)	+N/-S (usft)	+E/-W (usft)	Vertical Section (usft)	Dogleg Rate (°/100usft)	Build Rate (°/100usft)	Turn Rate (°/100usft)
5,200.0	0.00	0.00	5,200.0	0.0	0.0	0.0	0.00	0.00	0.00
5,300.0	0.00	0.00	5,300.0	0.0	0.0	0.0	0.00	0.00	0.00
5,400.0	0.00	0.00	5,400.0	0.0	0.0	0.0	0.00	0.00	0.00
5,500.0	0.00	0.00	5,500.0	0.0	0.0	0.0	0.00	0.00	0.00
5,600.0	0.00	0.00	5,600.0	0.0	0.0	0.0	0.00	0.00	0.00
5,700.0	0.00	0.00	5,700.0	0.0	0.0	0.0	0.00	0.00	0.00
5,800.0	0.00	0.00	5,800.0	0.0	0.0	0.0	0.00	0.00	0.00
5,900.0	0.00	0.00	5,900.0	0.0	0.0	0.0	0.00	0.00	0.00
6,000.0	0.00	0.00	6,000.0	0.0	0.0	0.0	0.00	0.00	0.00
6,100.0	0.00	0.00	6,100.0	0.0	0.0	0.0	0.00	0.00	0.00
6,200.0	0.00	0.00	6,200.0	0.0	0.0	0.0	0.00	0.00	0.00
6,300.0	0.00	0.00	6,300.0	0.0	0.0	0.0	0.00	0.00	0.00
6,400.0	0.00	0.00	6,400.0	0.0	0.0	0.0	0.00	0.00	0.00
6,500.0	0.00	0.00	6,500.0	0.0	0.0	0.0	0.00	0.00	0.00
6,600.0	0.00	0.00	6,600.0	0.0	0.0	0.0	0.00	0.00	0.00
6,700.0	0.00	0.00	6,700.0	0.0	0.0	0.0	0.00	0.00	0.00
6,800.0	0.00	0.00	6,800.0	0.0	0.0	0.0	0.00	0.00	0.00
6,900.0	0.00	0.00	6,900.0	0.0	0.0	0.0	0.00	0.00	0.00
7,000.0	0.00	0.00	7,000.0	0.0	0.0	0.0	0.00	0.00	0.00
7,100.0	0.00	0.00	7,100.0	0.0	0.0	0.0	0.00	0.00	0.00
7,128.5	0.00	0.00	7,128.5	0.0	0.0	0.0	0.00	0.00	0.00
7,200.0	8.58	209.50	7,199.7	-4.7	-2.6	4.8	12.00	12.00	0.00
7,300.0	20.58	209.50	7,296.3	-26.5	-15.0	27.2	12.00	12.00	0.00
7,400.0	32.58	209.50	7,385.6	-65.4	-37.0	67.0	12.00	12.00	0.00
7,500.0	44.58	209.50	7,463.6	-119.6	-67.6	122.5	12.00	12.00	0.00
7,600.0	56.58	209.50	7,527.0	-186.7	-105.6	191.3	12.00	12.00	0.00
7,700.0	68.58	209.50	7,573.0	-263.8	-149.3	270.3	12.00	12.00	0.00
7,800.0	80.58	209.50	7,599.5	-347.5	-196.6	356.1	12.00	12.00	0.00
7,878.5	90.00	209.50	7,606.0	-415.6	-235.1	425.7	12.00	12.00	0.00
7,879.0	90.00	209.49	7,606.0	-416.0	-235.4	426.2	3.00	0.00	-3.00
7" Intermediate (Opt 2)									
7,900.0	90.00	208.86	7,606.0	-434.3	-245.6	445.0	3.00	0.00	-3.00
8,000.0	90.00	205.86	7,606.0	-523.1	-291.5	535.7	3.00	0.00	-3.00
8,100.0	90.00	202.86	7,606.0	-614.2	-332.8	628.6	3.00	0.00	-3.00
8,200.0	90.00	199.86	7,606.0	-707.4	-369.2	723.3	3.00	0.00	-3.00
8,300.0	90.00	196.86	7,606.0	-802.3	-400.7	819.5	3.00	0.00	-3.00
8,400.0	90.00	193.86	7,606.0	-898.7	-427.1	917.0	3.00	0.00	-3.00
8,500.0	90.00	190.86	7,606.0	-996.4	-448.5	1,015.6	3.00	0.00	-3.00
8,600.0	90.00	187.86	7,606.0	-1,095.0	-464.8	1,114.8	3.00	0.00	-3.00
8,700.0	90.00	184.86	7,606.0	-1,194.4	-475.9	1,214.6	3.00	0.00	-3.00
8,800.0	90.00	181.86	7,606.0	-1,294.2	-481.7	1,314.6	3.00	0.00	-3.00
8,861.8	90.00	180.00	7,606.0	-1,356.0	-482.7	1,376.4	3.00	0.00	-3.00
8,900.0	90.00	180.00	7,606.0	-1,394.2	-482.7	1,414.5	0.00	0.00	0.00
9,000.0	90.00	180.00	7,606.0	-1,494.2	-482.7	1,514.4	0.00	0.00	0.00
9,100.0	90.00	180.00	7,606.0	-1,594.2	-482.7	1,614.3	0.00	0.00	0.00
9,200.0	90.00	180.00	7,606.0	-1,694.2	-482.7	1,714.2	0.00	0.00	0.00
9,300.0	90.00	180.00	7,606.0	-1,794.2	-482.7	1,814.1	0.00	0.00	0.00
9,400.0	90.00	180.00	7,606.0	-1,894.2	-482.7	1,914.0	0.00	0.00	0.00
9,500.0	90.00	180.00	7,606.0	-1,994.2	-482.7	2,013.9	0.00	0.00	0.00
9,600.0	90.00	180.00	7,606.0	-2,094.2	-482.7	2,113.8	0.00	0.00	0.00
9,700.0	90.00	180.00	7,606.0	-2,194.2	-482.7	2,213.7	0.00	0.00	0.00
9,800.0	90.00	180.00	7,606.0	-2,294.2	-482.7	2,313.6	0.00	0.00	0.00
9,900.0	90.00	180.00	7,606.0	-2,394.2	-482.7	2,413.5	0.00	0.00	0.00

EOG Resources, Inc.

Planning Report

Database:	EDM_DENVER	Local Co-ordinate Reference:	Well Fox Creek 538-2501H
Company:	Denver Division- Colorado	TVD Reference:	RKB @ 5432.0usft (KB GL+25')
Project:	DJ - Hereford Ranch	MD Reference:	RKB @ 5432.0usft (KB GL+25')
Site:	Fox Creek F25 SESW Pad	North Reference:	True
Well:	Fox Creek 538-2501H	Survey Calculation Method:	Minimum Curvature
Wellbore:	OH		
Design:	APD Plan (Plat Cert 5/12/15)		

Planned Survey									
Measured Depth (usft)	Inclination (°)	Azimuth (°)	Vertical Depth (usft)	+N/-S (usft)	+E/-W (usft)	Vertical Section (usft)	Dogleg Rate (°/100usft)	Build Rate (°/100usft)	Turn Rate (°/100usft)
10,000.0	90.00	180.00	7,606.0	-2,494.2	-482.7	2,513.4	0.00	0.00	0.00
10,100.0	90.00	180.00	7,606.0	-2,594.2	-482.7	2,613.3	0.00	0.00	0.00
10,200.0	90.00	180.00	7,606.0	-2,694.2	-482.7	2,713.2	0.00	0.00	0.00
10,300.0	90.00	180.00	7,606.0	-2,794.2	-482.7	2,813.1	0.00	0.00	0.00
10,400.0	90.00	180.00	7,606.0	-2,894.2	-482.7	2,913.0	0.00	0.00	0.00
10,500.0	90.00	180.00	7,606.0	-2,994.2	-482.7	3,012.9	0.00	0.00	0.00
10,600.0	90.00	180.00	7,606.0	-3,094.2	-482.7	3,112.8	0.00	0.00	0.00
10,700.0	90.00	180.00	7,606.0	-3,194.2	-482.7	3,212.7	0.00	0.00	0.00
10,800.0	90.00	180.00	7,606.0	-3,294.2	-482.7	3,312.6	0.00	0.00	0.00
10,900.0	90.00	180.00	7,606.0	-3,394.2	-482.7	3,412.5	0.00	0.00	0.00
11,000.0	90.00	180.00	7,606.0	-3,494.2	-482.7	3,512.4	0.00	0.00	0.00
11,100.0	90.00	180.00	7,606.0	-3,594.2	-482.7	3,612.3	0.00	0.00	0.00
11,200.0	90.00	180.00	7,606.0	-3,694.2	-482.7	3,712.2	0.00	0.00	0.00
11,300.0	90.00	180.00	7,606.0	-3,794.2	-482.7	3,812.1	0.00	0.00	0.00
11,400.0	90.00	180.00	7,606.0	-3,894.2	-482.7	3,912.0	0.00	0.00	0.00
11,500.0	90.00	180.00	7,606.0	-3,994.2	-482.7	4,011.9	0.00	0.00	0.00
11,600.0	90.00	180.00	7,606.0	-4,094.2	-482.7	4,111.8	0.00	0.00	0.00
11,700.0	90.00	180.00	7,606.0	-4,194.2	-482.7	4,211.7	0.00	0.00	0.00
11,800.0	90.00	180.00	7,606.0	-4,294.2	-482.7	4,311.6	0.00	0.00	0.00
11,900.0	90.00	180.00	7,606.0	-4,394.2	-482.7	4,411.5	0.00	0.00	0.00
12,000.0	90.00	180.00	7,606.0	-4,494.2	-482.7	4,511.4	0.00	0.00	0.00
12,100.0	90.00	180.00	7,606.0	-4,594.2	-482.7	4,611.3	0.00	0.00	0.00
12,200.0	90.00	180.00	7,606.0	-4,694.2	-482.7	4,711.2	0.00	0.00	0.00
12,300.0	90.00	180.00	7,606.0	-4,794.2	-482.7	4,811.1	0.00	0.00	0.00
12,400.0	90.00	180.00	7,606.0	-4,894.2	-482.7	4,911.0	0.00	0.00	0.00
12,500.0	90.00	180.00	7,606.0	-4,994.2	-482.7	5,010.9	0.00	0.00	0.00
12,600.0	90.00	180.00	7,606.0	-5,094.2	-482.7	5,110.8	0.00	0.00	0.00
12,700.0	90.00	180.00	7,606.0	-5,194.2	-482.7	5,210.7	0.00	0.00	0.00
12,800.0	90.00	180.00	7,606.0	-5,294.2	-482.7	5,310.6	0.00	0.00	0.00
12,900.0	90.00	180.00	7,606.0	-5,394.2	-482.7	5,410.5	0.00	0.00	0.00
13,000.0	90.00	180.00	7,606.0	-5,494.2	-482.7	5,510.4	0.00	0.00	0.00
13,100.0	90.00	180.00	7,606.0	-5,594.2	-482.7	5,610.3	0.00	0.00	0.00
13,200.0	90.00	180.00	7,606.0	-5,694.2	-482.7	5,710.2	0.00	0.00	0.00
13,300.0	90.00	180.00	7,606.0	-5,794.2	-482.7	5,810.1	0.00	0.00	0.00
13,400.0	90.00	180.00	7,606.0	-5,894.2	-482.7	5,910.0	0.00	0.00	0.00
13,500.0	90.00	180.00	7,606.0	-5,994.2	-482.7	6,009.9	0.00	0.00	0.00
13,600.0	90.00	180.00	7,606.0	-6,094.2	-482.7	6,109.8	0.00	0.00	0.00
13,700.0	90.00	180.00	7,606.0	-6,194.2	-482.7	6,209.7	0.00	0.00	0.00
13,800.0	90.00	180.00	7,606.0	-6,294.2	-482.7	6,309.5	0.00	0.00	0.00
13,900.0	90.00	180.00	7,606.0	-6,394.2	-482.7	6,409.4	0.00	0.00	0.00
14,000.0	90.00	180.00	7,606.0	-6,494.2	-482.7	6,509.3	0.00	0.00	0.00
14,100.0	90.00	180.00	7,606.0	-6,594.2	-482.7	6,609.2	0.00	0.00	0.00
14,200.0	90.00	180.00	7,606.0	-6,694.2	-482.7	6,709.1	0.00	0.00	0.00
14,300.0	90.00	180.00	7,606.0	-6,794.2	-482.7	6,809.0	0.00	0.00	0.00
14,400.0	90.00	180.00	7,606.0	-6,894.2	-482.7	6,908.9	0.00	0.00	0.00
14,500.0	90.00	180.00	7,606.0	-6,994.2	-482.7	7,008.8	0.00	0.00	0.00
14,600.0	90.00	180.00	7,606.0	-7,094.2	-482.7	7,108.7	0.00	0.00	0.00
14,700.0	90.00	180.00	7,606.0	-7,194.2	-482.7	7,208.6	0.00	0.00	0.00
14,800.0	90.00	180.00	7,606.0	-7,294.2	-482.7	7,308.5	0.00	0.00	0.00
14,900.0	90.00	180.00	7,606.0	-7,394.2	-482.7	7,408.4	0.00	0.00	0.00
15,000.0	90.00	180.00	7,606.0	-7,494.2	-482.7	7,508.3	0.00	0.00	0.00
15,100.0	90.00	180.00	7,606.0	-7,594.2	-482.7	7,608.2	0.00	0.00	0.00
15,200.0	90.00	180.00	7,606.0	-7,694.2	-482.7	7,708.1	0.00	0.00	0.00
15,300.0	90.00	180.00	7,606.0	-7,794.2	-482.7	7,808.0	0.00	0.00	0.00

EOG Resources, Inc.

Planning Report

Database:	EDM_DENVER	Local Co-ordinate Reference:	Well Fox Creek 538-2501H
Company:	Denver Division- Colorado	TVD Reference:	RKB @ 5432.0usft (KB GL+25')
Project:	DJ - Hereford Ranch	MD Reference:	RKB @ 5432.0usft (KB GL+25')
Site:	Fox Creek F25 SESW Pad	North Reference:	True
Well:	Fox Creek 538-2501H	Survey Calculation Method:	Minimum Curvature
Wellbore:	OH		
Design:	APD Plan (Plat Cert 5/12/15)		

Planned Survey										
Measured Depth (usft)	Inclination (°)	Azimuth (°)	Vertical Depth (usft)	+N/-S (usft)	+E/-W (usft)	Vertical Section (usft)	Dogleg Rate (°/100usft)	Build Rate (°/100usft)	Turn Rate (°/100usft)	
15,400.0	90.00	180.00	7,606.0	-7,894.2	-482.7	7,907.9	0.00	0.00	0.00	
15,500.0	90.00	180.00	7,606.0	-7,994.2	-482.8	8,007.8	0.00	0.00	0.00	
15,600.0	90.00	180.00	7,606.0	-8,094.2	-482.8	8,107.7	0.00	0.00	0.00	
15,700.0	90.00	180.00	7,606.0	-8,194.2	-482.8	8,207.6	0.00	0.00	0.00	
15,800.0	90.00	180.00	7,606.0	-8,294.2	-482.8	8,307.5	0.00	0.00	0.00	
15,900.0	90.00	180.00	7,606.0	-8,394.2	-482.8	8,407.4	0.00	0.00	0.00	
16,000.0	90.00	180.00	7,606.0	-8,494.2	-482.8	8,507.3	0.00	0.00	0.00	
16,100.0	90.00	180.00	7,606.0	-8,594.2	-482.8	8,607.2	0.00	0.00	0.00	
16,200.0	90.00	180.00	7,606.0	-8,694.2	-482.8	8,707.1	0.00	0.00	0.00	
16,300.0	90.00	180.00	7,606.0	-8,794.2	-482.8	8,807.0	0.00	0.00	0.00	
16,400.0	90.00	180.00	7,606.0	-8,894.2	-482.8	8,906.9	0.00	0.00	0.00	
16,500.0	90.00	180.00	7,606.0	-8,994.2	-482.8	9,006.8	0.00	0.00	0.00	
16,600.0	90.00	180.00	7,606.0	-9,094.2	-482.8	9,106.7	0.00	0.00	0.00	
16,700.0	90.00	180.00	7,606.0	-9,194.2	-482.8	9,206.6	0.00	0.00	0.00	
16,800.0	90.00	180.00	7,606.0	-9,294.2	-482.8	9,306.5	0.00	0.00	0.00	
16,900.0	90.00	180.00	7,606.0	-9,394.2	-482.8	9,406.4	0.00	0.00	0.00	
17,000.0	90.00	180.00	7,606.0	-9,494.2	-482.8	9,506.3	0.00	0.00	0.00	
17,100.0	90.00	180.00	7,606.0	-9,594.2	-482.8	9,606.2	0.00	0.00	0.00	
17,200.0	90.00	180.00	7,606.0	-9,694.2	-482.8	9,706.1	0.00	0.00	0.00	
17,300.0	90.00	180.00	7,606.0	-9,794.2	-482.8	9,806.0	0.00	0.00	0.00	
17,400.0	90.00	180.00	7,606.0	-9,894.2	-482.8	9,905.9	0.00	0.00	0.00	
17,500.0	90.00	180.00	7,606.0	-9,994.2	-482.8	10,005.8	0.00	0.00	0.00	
17,600.0	90.00	180.00	7,606.0	-10,094.2	-482.8	10,105.7	0.00	0.00	0.00	
17,700.0	90.00	180.00	7,606.0	-10,194.2	-482.8	10,205.6	0.00	0.00	0.00	
17,800.0	90.00	180.00	7,606.0	-10,294.2	-482.8	10,305.5	0.00	0.00	0.00	
17,900.0	90.00	180.00	7,606.0	-10,394.2	-482.8	10,405.4	0.00	0.00	0.00	
18,000.0	90.00	180.00	7,606.0	-10,494.2	-482.8	10,505.3	0.00	0.00	0.00	
18,100.0	90.00	180.00	7,606.0	-10,594.2	-482.8	10,605.2	0.00	0.00	0.00	
18,200.0	90.00	180.00	7,606.0	-10,694.2	-482.8	10,705.1	0.00	0.00	0.00	
18,208.0	90.00	180.00	7,606.0	-10,702.2	-482.8	10,713.1	0.00	0.00	0.00	
5 1/2" Prod (Opt 1) - 4 1/2" Liner (Opt 2)										
18,208.5	90.00	180.00	7,606.0	-10,702.7	-482.8	10,713.6	0.00	0.00	0.00	

Design Targets										
Target Name	Dip Angle (°)	Dip Dir. (°)	TVD (usft)	+N/-S (usft)	+E/-W (usft)	Northing (usft)	Easting (usft)	Latitude	Longitude	
- hit/miss target										
- Shape										
Fox Creek 538-2501H P	0.00	0.00	7,606.0	-10,702.7	-482.8	589,343.12	2,308,180.26	40° 56' 44.943 N	104° 23' 4.157 W	
- plan hits target center										
- Point										

Casing Points					
Measured Depth (usft)	Vertical Depth (usft)	Name	Casing Diameter (")	Hole Diameter (")	
1,346.0	1,346.0	9 5/8" Surface	9-5/8	13-1/2	
7,879.0	7,606.0	7" Intermediate (Opt 2)	7	8-3/4	
18,208.0	7,606.0	5 1/2" Prod (Opt 1)	5-1/2	7-7/8	
18,208.0	7,606.0	4 1/2" Liner (Opt 2)	4-1/2	6-1/8	

EOG Resources, Inc.

Planning Report

Database:	EDM_DENVER	Local Co-ordinate Reference:	Well Fox Creek 538-2501H
Company:	Denver Division- Colorado	TVD Reference:	RKB @ 5432.0usft (KB GL+25')
Project:	DJ - Hereford Ranch	MD Reference:	RKB @ 5432.0usft (KB GL+25')
Site:	Fox Creek F25 SESW Pad	North Reference:	True
Well:	Fox Creek 538-2501H	Survey Calculation Method:	Minimum Curvature
Wellbore:	OH		
Design:	APD Plan (Plat Cert 5/12/15)		