

Randall Creek 504-2920H

Surface Location

NAD 1927 (NADCON CONUS) Colorado North 501

Ground Elevation: 5349.0 WELL @ 5374.0usft (Original Well Elev)

Northing: 600188.67 Easting: 2319885.30 Latitude: 40° 58' 30.611 N Longitude: 104° 20' 29.801 W

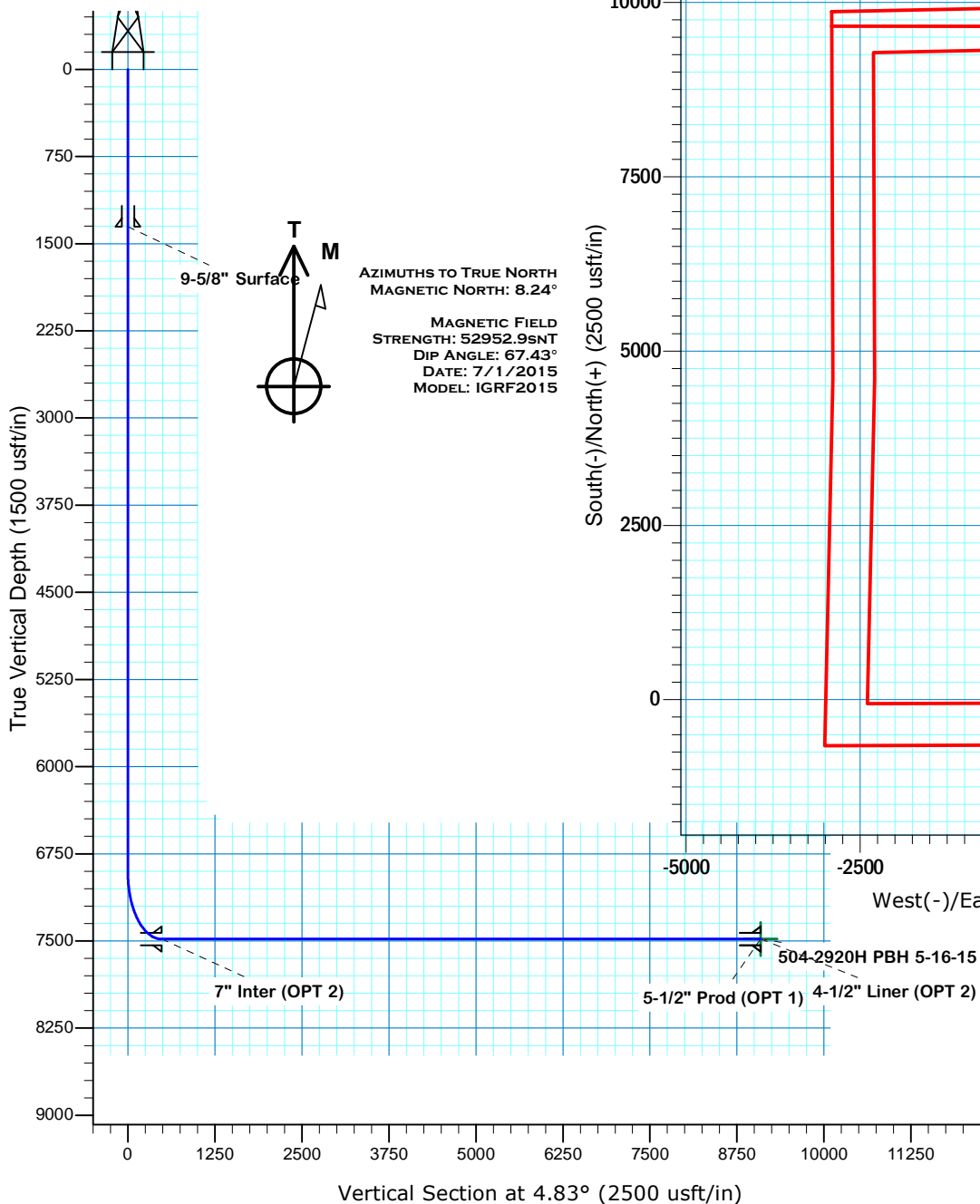

Project: DJ - Hereford Ranch
 Site: Randall Creek R29 SWSE
 Well: Randall Creek 504-2920H
 Planner: M.Thompson
 11:13, July 01 2015

SECTION DETAILS

Sec	MD	Inc	Azi	TVD	+N/-S	+E/-W	Dleg	TFace	Vsect	Target
1	0.0	0.00	0.00	0.0	0.0	0.0	0.00	0.00	0.0	
2	6911.0	0.00	0.00	6911.0	0.0	0.0	0.00	0.00	0.0	
3	7811.0	90.00	37.00	7484.0	457.6	344.8	10.00	37.00	485.0	
4	7870.0	90.00	37.00	7484.0	504.7	380.3	0.00	0.00	534.9	
5	9103.3	90.00	0.00	7484.0	1654.0	764.9	3.00	-90.00	1712.5	504-2920H PBH 5-16-15
6	16507.6	90.00	0.00	7484.0	9058.4	765.1	0.00	0.00	9090.6	504-2920H PBH 5-16-15

TARGET DETAILS

Name	TVD	+N/-S	+E/-W	Northing	Easting	Latitude	Longitude	Shape
504-2920H PBH 5-16-15	7484.0	9058.4	765.1	609256.27	2320532.00	41° 0' 0.112 N	104° 20' 19.824 W	Point

Denver Division- Colorado

**DJ - Hereford Ranch
Randall Creek R29 SWSE
Randall Creek 504-2920H**

Wellbore #1

Plan: APD Plan (Plat 5-15-15)

Standard Planning Report

01 July, 2015

EOG Resources, Inc.

Planning Report

Database:	EDM_DENVER	Local Co-ordinate Reference:	Well Randall Creek 504-2920H
Company:	Denver Division- Colorado	TVD Reference:	WELL @ 5374.0usft (Original Well Elev)
Project:	DJ - Hereford Ranch	MD Reference:	WELL @ 5374.0usft (Original Well Elev)
Site:	Randall Creek R29 SWSE	North Reference:	True
Well:	Randall Creek 504-2920H	Survey Calculation Method:	Minimum Curvature
Wellbore:	Wellbore #1		
Design:	APD Plan (Plat 5-15-15)		

Project	DJ - Hereford Ranch, Weld County		
Map System:	US State Plane 1927 (Exact solution)	System Datum:	Mean Sea Level
Geo Datum:	NAD 1927 (NADCON CONUS)		
Map Zone:	Colorado North 501		

Site	Randall Creek R29 SWSE		
Site Position:		Northing:	600,188.67 usft
From:	Map	Easting:	2,319,885.30 usft
Position Uncertainty:	0.0 usft	Slot Radius:	13-3/16 "
		Latitude:	40° 58' 30.611 N
		Longitude:	104° 20' 29.801 W
		Grid Convergence:	0.75 °

Well	Randall Creek 504-2920H		
Well Position	+N/-S	0.0 usft	Northing: 600,188.67 usft
	+E/-W	0.0 usft	Easting: 2,319,885.30 usft
Position Uncertainty	0.0 usft	Wellhead Elevation:	0.0 usft
		Latitude:	40° 58' 30.611 N
		Longitude:	104° 20' 29.801 W
		Ground Level:	5,349.0 usft

Wellbore	Wellbore #1		
Magnetics	Model Name	Sample Date	Declination (°)
	IGRF2015	7/1/2015	8.24
			Dip Angle (°)
			67.43
			Field Strength (nT)
			52,953

Design	APD Plan (Plat 5-15-15)		
Audit Notes:			
Version:	Phase:	PROTOTYPE	Tie On Depth: 0.0
Vertical Section:	Depth From (TVD) (usft)	+N/-S (usft)	+E/-W (usft)
	0.0	0.0	0.0
			Direction (°)
			4.83

Plan Sections										
Measured Depth (usft)	Inclination (°)	Azimuth (°)	Vertical Depth (usft)	+N/-S (usft)	+E/-W (usft)	Dogleg Rate (°/100usft)	Build Rate (°/100usft)	Turn Rate (°/100usft)	TFO (°)	Target
0.0	0.00	0.00	0.0	0.0	0.0	0.00	0.00	0.00	0.00	
6,911.0	0.00	0.00	6,911.0	0.0	0.0	0.00	0.00	0.00	0.00	
7,811.0	90.00	37.00	7,484.0	457.6	344.8	10.00	10.00	0.00	37.00	
7,870.0	90.00	37.00	7,484.0	504.7	380.3	0.00	0.00	0.00	0.00	
9,103.3	90.00	0.00	7,484.0	1,654.0	764.9	3.00	0.00	-3.00	-90.00	504-2920H PBH 5-16
16,507.6	90.00	0.00	7,484.0	9,058.4	765.1	0.00	0.00	0.00	0.00	504-2920H PBH 5-16

EOG Resources, Inc.

Planning Report

Database:	EDM_DENVER	Local Co-ordinate Reference:	Well Randall Creek 504-2920H
Company:	Denver Division- Colorado	TVD Reference:	WELL @ 5374.0usft (Original Well Elev)
Project:	DJ - Hereford Ranch	MD Reference:	WELL @ 5374.0usft (Original Well Elev)
Site:	Randall Creek R29 SWSE	North Reference:	True
Well:	Randall Creek 504-2920H	Survey Calculation Method:	Minimum Curvature
Wellbore:	Wellbore #1		
Design:	APD Plan (Plat 5-15-15)		

Planned Survey									
Measured Depth (usft)	Inclination (°)	Azimuth (°)	Vertical Depth (usft)	+N/-S (usft)	+E/-W (usft)	Vertical Section (usft)	Dogleg Rate (°/100usft)	Build Rate (°/100usft)	Turn Rate (°/100usft)
0.0	0.00	0.00	0.0	0.0	0.0	0.0	0.00	0.00	0.00
100.0	0.00	0.00	100.0	0.0	0.0	0.0	0.00	0.00	0.00
200.0	0.00	0.00	200.0	0.0	0.0	0.0	0.00	0.00	0.00
300.0	0.00	0.00	300.0	0.0	0.0	0.0	0.00	0.00	0.00
400.0	0.00	0.00	400.0	0.0	0.0	0.0	0.00	0.00	0.00
500.0	0.00	0.00	500.0	0.0	0.0	0.0	0.00	0.00	0.00
600.0	0.00	0.00	600.0	0.0	0.0	0.0	0.00	0.00	0.00
700.0	0.00	0.00	700.0	0.0	0.0	0.0	0.00	0.00	0.00
800.0	0.00	0.00	800.0	0.0	0.0	0.0	0.00	0.00	0.00
900.0	0.00	0.00	900.0	0.0	0.0	0.0	0.00	0.00	0.00
1,000.0	0.00	0.00	1,000.0	0.0	0.0	0.0	0.00	0.00	0.00
1,100.0	0.00	0.00	1,100.0	0.0	0.0	0.0	0.00	0.00	0.00
1,200.0	0.00	0.00	1,200.0	0.0	0.0	0.0	0.00	0.00	0.00
1,300.0	0.00	0.00	1,300.0	0.0	0.0	0.0	0.00	0.00	0.00
1,353.0	0.00	0.00	1,353.0	0.0	0.0	0.0	0.00	0.00	0.00
9-5/8" Surface									
1,400.0	0.00	0.00	1,400.0	0.0	0.0	0.0	0.00	0.00	0.00
1,500.0	0.00	0.00	1,500.0	0.0	0.0	0.0	0.00	0.00	0.00
1,600.0	0.00	0.00	1,600.0	0.0	0.0	0.0	0.00	0.00	0.00
1,700.0	0.00	0.00	1,700.0	0.0	0.0	0.0	0.00	0.00	0.00
1,800.0	0.00	0.00	1,800.0	0.0	0.0	0.0	0.00	0.00	0.00
1,900.0	0.00	0.00	1,900.0	0.0	0.0	0.0	0.00	0.00	0.00
2,000.0	0.00	0.00	2,000.0	0.0	0.0	0.0	0.00	0.00	0.00
2,100.0	0.00	0.00	2,100.0	0.0	0.0	0.0	0.00	0.00	0.00
2,200.0	0.00	0.00	2,200.0	0.0	0.0	0.0	0.00	0.00	0.00
2,300.0	0.00	0.00	2,300.0	0.0	0.0	0.0	0.00	0.00	0.00
2,400.0	0.00	0.00	2,400.0	0.0	0.0	0.0	0.00	0.00	0.00
2,500.0	0.00	0.00	2,500.0	0.0	0.0	0.0	0.00	0.00	0.00
2,600.0	0.00	0.00	2,600.0	0.0	0.0	0.0	0.00	0.00	0.00
2,700.0	0.00	0.00	2,700.0	0.0	0.0	0.0	0.00	0.00	0.00
2,800.0	0.00	0.00	2,800.0	0.0	0.0	0.0	0.00	0.00	0.00
2,900.0	0.00	0.00	2,900.0	0.0	0.0	0.0	0.00	0.00	0.00
3,000.0	0.00	0.00	3,000.0	0.0	0.0	0.0	0.00	0.00	0.00
3,100.0	0.00	0.00	3,100.0	0.0	0.0	0.0	0.00	0.00	0.00
3,200.0	0.00	0.00	3,200.0	0.0	0.0	0.0	0.00	0.00	0.00
3,300.0	0.00	0.00	3,300.0	0.0	0.0	0.0	0.00	0.00	0.00
3,400.0	0.00	0.00	3,400.0	0.0	0.0	0.0	0.00	0.00	0.00
3,500.0	0.00	0.00	3,500.0	0.0	0.0	0.0	0.00	0.00	0.00
3,600.0	0.00	0.00	3,600.0	0.0	0.0	0.0	0.00	0.00	0.00
3,700.0	0.00	0.00	3,700.0	0.0	0.0	0.0	0.00	0.00	0.00
3,800.0	0.00	0.00	3,800.0	0.0	0.0	0.0	0.00	0.00	0.00
3,900.0	0.00	0.00	3,900.0	0.0	0.0	0.0	0.00	0.00	0.00
4,000.0	0.00	0.00	4,000.0	0.0	0.0	0.0	0.00	0.00	0.00
4,100.0	0.00	0.00	4,100.0	0.0	0.0	0.0	0.00	0.00	0.00
4,200.0	0.00	0.00	4,200.0	0.0	0.0	0.0	0.00	0.00	0.00
4,300.0	0.00	0.00	4,300.0	0.0	0.0	0.0	0.00	0.00	0.00
4,400.0	0.00	0.00	4,400.0	0.0	0.0	0.0	0.00	0.00	0.00
4,500.0	0.00	0.00	4,500.0	0.0	0.0	0.0	0.00	0.00	0.00
4,600.0	0.00	0.00	4,600.0	0.0	0.0	0.0	0.00	0.00	0.00
4,700.0	0.00	0.00	4,700.0	0.0	0.0	0.0	0.00	0.00	0.00
4,800.0	0.00	0.00	4,800.0	0.0	0.0	0.0	0.00	0.00	0.00
4,900.0	0.00	0.00	4,900.0	0.0	0.0	0.0	0.00	0.00	0.00
5,000.0	0.00	0.00	5,000.0	0.0	0.0	0.0	0.00	0.00	0.00
5,100.0	0.00	0.00	5,100.0	0.0	0.0	0.0	0.00	0.00	0.00

EOG Resources, Inc.

Planning Report

Database:	EDM_DENVER	Local Co-ordinate Reference:	Well Randall Creek 504-2920H
Company:	Denver Division- Colorado	TVD Reference:	WELL @ 5374.0usft (Original Well Elev)
Project:	DJ - Hereford Ranch	MD Reference:	WELL @ 5374.0usft (Original Well Elev)
Site:	Randall Creek R29 SWSE	North Reference:	True
Well:	Randall Creek 504-2920H	Survey Calculation Method:	Minimum Curvature
Wellbore:	Wellbore #1		
Design:	APD Plan (Plat 5-15-15)		

Planned Survey									
Measured Depth (usft)	Inclination (°)	Azimuth (°)	Vertical Depth (usft)	+N/-S (usft)	+E/-W (usft)	Vertical Section (usft)	Dogleg Rate (°/100usft)	Build Rate (°/100usft)	Turn Rate (°/100usft)
5,200.0	0.00	0.00	5,200.0	0.0	0.0	0.0	0.00	0.00	0.00
5,300.0	0.00	0.00	5,300.0	0.0	0.0	0.0	0.00	0.00	0.00
5,400.0	0.00	0.00	5,400.0	0.0	0.0	0.0	0.00	0.00	0.00
5,500.0	0.00	0.00	5,500.0	0.0	0.0	0.0	0.00	0.00	0.00
5,600.0	0.00	0.00	5,600.0	0.0	0.0	0.0	0.00	0.00	0.00
5,700.0	0.00	0.00	5,700.0	0.0	0.0	0.0	0.00	0.00	0.00
5,800.0	0.00	0.00	5,800.0	0.0	0.0	0.0	0.00	0.00	0.00
5,900.0	0.00	0.00	5,900.0	0.0	0.0	0.0	0.00	0.00	0.00
6,000.0	0.00	0.00	6,000.0	0.0	0.0	0.0	0.00	0.00	0.00
6,100.0	0.00	0.00	6,100.0	0.0	0.0	0.0	0.00	0.00	0.00
6,200.0	0.00	0.00	6,200.0	0.0	0.0	0.0	0.00	0.00	0.00
6,300.0	0.00	0.00	6,300.0	0.0	0.0	0.0	0.00	0.00	0.00
6,400.0	0.00	0.00	6,400.0	0.0	0.0	0.0	0.00	0.00	0.00
6,500.0	0.00	0.00	6,500.0	0.0	0.0	0.0	0.00	0.00	0.00
6,600.0	0.00	0.00	6,600.0	0.0	0.0	0.0	0.00	0.00	0.00
6,700.0	0.00	0.00	6,700.0	0.0	0.0	0.0	0.00	0.00	0.00
6,800.0	0.00	0.00	6,800.0	0.0	0.0	0.0	0.00	0.00	0.00
6,900.0	0.00	0.00	6,900.0	0.0	0.0	0.0	0.00	0.00	0.00
6,911.0	0.00	0.00	6,911.0	0.0	0.0	0.0	0.00	0.00	0.00
7,000.0	8.90	37.00	6,999.6	5.5	4.2	5.8	10.00	10.00	0.00
7,100.0	18.90	37.00	7,096.6	24.7	18.6	26.1	10.00	10.00	0.00
7,200.0	28.90	37.00	7,187.9	57.0	42.9	60.4	10.00	10.00	0.00
7,300.0	38.90	37.00	7,270.8	101.5	76.5	107.5	10.00	10.00	0.00
7,400.0	48.90	37.00	7,342.8	156.8	118.1	166.2	10.00	10.00	0.00
7,500.0	58.90	37.00	7,401.6	221.2	166.7	234.5	10.00	10.00	0.00
7,600.0	68.90	37.00	7,445.5	292.9	220.7	310.4	10.00	10.00	0.00
7,700.0	78.90	37.00	7,473.2	369.5	278.4	391.6	10.00	10.00	0.00
7,800.0	88.90	37.00	7,483.9	448.8	338.2	475.7	10.00	10.00	0.00
7,811.0	90.00	37.00	7,484.0	457.6	344.8	485.0	10.00	10.00	0.00
7" Inter (OPT 2)									
7,870.0	90.00	37.00	7,484.0	504.7	380.3	534.9	0.00	0.00	0.00
7,900.0	90.00	36.10	7,484.0	528.8	398.2	560.4	3.00	0.00	-3.00
8,000.0	90.00	33.10	7,484.0	611.1	455.0	647.2	3.00	0.00	-3.00
8,100.0	90.00	30.10	7,484.0	696.3	507.4	736.5	3.00	0.00	-3.00
8,200.0	90.00	27.10	7,484.0	784.1	555.2	828.0	3.00	0.00	-3.00
8,300.0	90.00	24.10	7,484.0	874.2	598.4	921.5	3.00	0.00	-3.00
8,400.0	90.00	21.10	7,484.0	966.5	636.9	1,016.7	3.00	0.00	-3.00
8,500.0	90.00	18.10	7,484.0	1,060.7	670.4	1,113.4	3.00	0.00	-3.00
8,600.0	90.00	15.10	7,484.0	1,156.6	699.0	1,211.3	3.00	0.00	-3.00
8,700.0	90.00	12.10	7,484.0	1,253.7	722.5	1,310.1	3.00	0.00	-3.00
8,800.0	90.00	9.10	7,484.0	1,352.0	740.9	1,409.6	3.00	0.00	-3.00
8,900.0	90.00	6.10	7,484.0	1,451.1	754.1	1,509.5	3.00	0.00	-3.00
9,000.0	90.00	3.10	7,484.0	1,550.8	762.1	1,609.4	3.00	0.00	-3.00
9,100.0	90.00	0.10	7,484.0	1,650.8	764.9	1,709.3	3.00	0.00	-3.00
9,103.3	90.00	0.00	7,484.0	1,654.0	764.9	1,712.5	3.00	0.00	-3.00
9,200.0	90.00	0.00	7,484.0	1,750.8	764.9	1,808.9	0.00	0.00	0.00
9,300.0	90.00	0.00	7,484.0	1,850.8	764.9	1,908.6	0.00	0.00	0.00
9,400.0	90.00	0.00	7,484.0	1,950.8	764.9	2,008.2	0.00	0.00	0.00
9,500.0	90.00	0.00	7,484.0	2,050.8	764.9	2,107.9	0.00	0.00	0.00
9,600.0	90.00	0.00	7,484.0	2,150.8	764.9	2,207.5	0.00	0.00	0.00
9,700.0	90.00	0.00	7,484.0	2,250.8	764.9	2,307.1	0.00	0.00	0.00
9,800.0	90.00	0.00	7,484.0	2,350.8	764.9	2,406.8	0.00	0.00	0.00
9,900.0	90.00	0.00	7,484.0	2,450.8	764.9	2,506.4	0.00	0.00	0.00

EOG Resources, Inc.

Planning Report

Database:	EDM_DENVER	Local Co-ordinate Reference:	Well Randall Creek 504-2920H
Company:	Denver Division- Colorado	TVD Reference:	WELL @ 5374.0usft (Original Well Elev)
Project:	DJ - Hereford Ranch	MD Reference:	WELL @ 5374.0usft (Original Well Elev)
Site:	Randall Creek R29 SWSE	North Reference:	True
Well:	Randall Creek 504-2920H	Survey Calculation Method:	Minimum Curvature
Wellbore:	Wellbore #1		
Design:	APD Plan (Plat 5-15-15)		

Planned Survey									
Measured Depth (usft)	Inclination (°)	Azimuth (°)	Vertical Depth (usft)	+N/-S (usft)	+E/-W (usft)	Vertical Section (usft)	Dogleg Rate (°/100usft)	Build Rate (°/100usft)	Turn Rate (°/100usft)
10,000.0	90.00	0.00	7,484.0	2,550.8	764.9	2,606.1	0.00	0.00	0.00
10,100.0	90.00	0.00	7,484.0	2,650.8	764.9	2,705.7	0.00	0.00	0.00
10,200.0	90.00	0.00	7,484.0	2,750.8	764.9	2,805.4	0.00	0.00	0.00
10,300.0	90.00	0.00	7,484.0	2,850.8	764.9	2,905.0	0.00	0.00	0.00
10,400.0	90.00	0.00	7,484.0	2,950.8	764.9	3,004.7	0.00	0.00	0.00
10,500.0	90.00	0.00	7,484.0	3,050.8	764.9	3,104.3	0.00	0.00	0.00
10,600.0	90.00	0.00	7,484.0	3,150.8	764.9	3,204.0	0.00	0.00	0.00
10,700.0	90.00	0.00	7,484.0	3,250.8	764.9	3,303.6	0.00	0.00	0.00
10,800.0	90.00	0.00	7,484.0	3,350.8	764.9	3,403.2	0.00	0.00	0.00
10,900.0	90.00	0.00	7,484.0	3,450.8	764.9	3,502.9	0.00	0.00	0.00
11,000.0	90.00	0.00	7,484.0	3,550.8	764.9	3,602.5	0.00	0.00	0.00
11,100.0	90.00	0.00	7,484.0	3,650.8	765.0	3,702.2	0.00	0.00	0.00
11,200.0	90.00	0.00	7,484.0	3,750.8	765.0	3,801.8	0.00	0.00	0.00
11,300.0	90.00	0.00	7,484.0	3,850.8	765.0	3,901.5	0.00	0.00	0.00
11,400.0	90.00	0.00	7,484.0	3,950.8	765.0	4,001.1	0.00	0.00	0.00
11,500.0	90.00	0.00	7,484.0	4,050.8	765.0	4,100.8	0.00	0.00	0.00
11,600.0	90.00	0.00	7,484.0	4,150.8	765.0	4,200.4	0.00	0.00	0.00
11,700.0	90.00	0.00	7,484.0	4,250.8	765.0	4,300.1	0.00	0.00	0.00
11,800.0	90.00	0.00	7,484.0	4,350.8	765.0	4,399.7	0.00	0.00	0.00
11,900.0	90.00	0.00	7,484.0	4,450.8	765.0	4,499.3	0.00	0.00	0.00
12,000.0	90.00	0.00	7,484.0	4,550.8	765.0	4,599.0	0.00	0.00	0.00
12,100.0	90.00	0.00	7,484.0	4,650.8	765.0	4,698.6	0.00	0.00	0.00
12,200.0	90.00	0.00	7,484.0	4,750.8	765.0	4,798.3	0.00	0.00	0.00
12,300.0	90.00	0.00	7,484.0	4,850.8	765.0	4,897.9	0.00	0.00	0.00
12,400.0	90.00	0.00	7,484.0	4,950.8	765.0	4,997.6	0.00	0.00	0.00
12,500.0	90.00	0.00	7,484.0	5,050.8	765.0	5,097.2	0.00	0.00	0.00
12,600.0	90.00	0.00	7,484.0	5,150.8	765.0	5,196.9	0.00	0.00	0.00
12,700.0	90.00	0.00	7,484.0	5,250.8	765.0	5,296.5	0.00	0.00	0.00
12,800.0	90.00	0.00	7,484.0	5,350.8	765.0	5,396.2	0.00	0.00	0.00
12,900.0	90.00	0.00	7,484.0	5,450.8	765.0	5,495.8	0.00	0.00	0.00
13,000.0	90.00	0.00	7,484.0	5,550.8	765.0	5,595.4	0.00	0.00	0.00
13,100.0	90.00	0.00	7,484.0	5,650.8	765.0	5,695.1	0.00	0.00	0.00
13,200.0	90.00	0.00	7,484.0	5,750.8	765.0	5,794.7	0.00	0.00	0.00
13,300.0	90.00	0.00	7,484.0	5,850.8	765.0	5,894.4	0.00	0.00	0.00
13,400.0	90.00	0.00	7,484.0	5,950.8	765.0	5,994.0	0.00	0.00	0.00
13,500.0	90.00	0.00	7,484.0	6,050.8	765.0	6,093.7	0.00	0.00	0.00
13,600.0	90.00	0.00	7,484.0	6,150.8	765.0	6,193.3	0.00	0.00	0.00
13,700.0	90.00	0.00	7,484.0	6,250.8	765.0	6,293.0	0.00	0.00	0.00
13,800.0	90.00	0.00	7,484.0	6,350.8	765.0	6,392.6	0.00	0.00	0.00
13,900.0	90.00	0.00	7,484.0	6,450.8	765.0	6,492.3	0.00	0.00	0.00
14,000.0	90.00	0.00	7,484.0	6,550.8	765.0	6,591.9	0.00	0.00	0.00
14,100.0	90.00	0.00	7,484.0	6,650.8	765.0	6,691.5	0.00	0.00	0.00
14,200.0	90.00	0.00	7,484.0	6,750.8	765.0	6,791.2	0.00	0.00	0.00
14,300.0	90.00	0.00	7,484.0	6,850.8	765.0	6,890.8	0.00	0.00	0.00
14,400.0	90.00	0.00	7,484.0	6,950.8	765.0	6,990.5	0.00	0.00	0.00
14,500.0	90.00	0.00	7,484.0	7,050.8	765.0	7,090.1	0.00	0.00	0.00
14,600.0	90.00	0.00	7,484.0	7,150.8	765.0	7,189.8	0.00	0.00	0.00
14,700.0	90.00	0.00	7,484.0	7,250.8	765.0	7,289.4	0.00	0.00	0.00
14,800.0	90.00	0.00	7,484.0	7,350.8	765.0	7,389.1	0.00	0.00	0.00
14,900.0	90.00	0.00	7,484.0	7,450.8	765.1	7,488.7	0.00	0.00	0.00
15,000.0	90.00	0.00	7,484.0	7,550.8	765.1	7,588.4	0.00	0.00	0.00
15,100.0	90.00	0.00	7,484.0	7,650.8	765.1	7,688.0	0.00	0.00	0.00
15,200.0	90.00	0.00	7,484.0	7,750.8	765.1	7,787.6	0.00	0.00	0.00
15,300.0	90.00	0.00	7,484.0	7,850.8	765.1	7,887.3	0.00	0.00	0.00

EOG Resources, Inc.

Planning Report

Database:	EDM_DENVER	Local Co-ordinate Reference:	Well Randall Creek 504-2920H
Company:	Denver Division- Colorado	TVD Reference:	WELL @ 5374.0usft (Original Well Elev)
Project:	DJ - Hereford Ranch	MD Reference:	WELL @ 5374.0usft (Original Well Elev)
Site:	Randall Creek R29 SWSE	North Reference:	True
Well:	Randall Creek 504-2920H	Survey Calculation Method:	Minimum Curvature
Wellbore:	Wellbore #1		
Design:	APD Plan (Plat 5-15-15)		

Planned Survey										
Measured Depth (usft)	Inclination (°)	Azimuth (°)	Vertical Depth (usft)	+N/-S (usft)	+E/-W (usft)	Vertical Section (usft)	Dogleg Rate (°/100usft)	Build Rate (°/100usft)	Turn Rate (°/100usft)	
15,400.0	90.00	0.00	7,484.0	7,950.8	765.1	7,986.9	0.00	0.00	0.00	
15,500.0	90.00	0.00	7,484.0	8,050.8	765.1	8,086.6	0.00	0.00	0.00	
15,600.0	90.00	0.00	7,484.0	8,150.8	765.1	8,186.2	0.00	0.00	0.00	
15,700.0	90.00	0.00	7,484.0	8,250.8	765.1	8,285.9	0.00	0.00	0.00	
15,800.0	90.00	0.00	7,484.0	8,350.8	765.1	8,385.5	0.00	0.00	0.00	
15,900.0	90.00	0.00	7,484.0	8,450.8	765.1	8,485.2	0.00	0.00	0.00	
16,000.0	90.00	0.00	7,484.0	8,550.8	765.1	8,584.8	0.00	0.00	0.00	
16,100.0	90.00	0.00	7,484.0	8,650.8	765.1	8,684.5	0.00	0.00	0.00	
16,200.0	90.00	0.00	7,484.0	8,750.8	765.1	8,784.1	0.00	0.00	0.00	
16,300.0	90.00	0.00	7,484.0	8,850.8	765.1	8,883.7	0.00	0.00	0.00	
16,400.0	90.00	0.00	7,484.0	8,950.8	765.1	8,983.4	0.00	0.00	0.00	
16,500.0	90.00	0.00	7,484.0	9,050.8	765.1	9,083.0	0.00	0.00	0.00	
16,507.6	90.00	0.00	7,484.0	9,058.4	765.1	9,090.6	0.00	0.00	0.00	
5-1/2" Prod (OPT 1) - 4-1/2" Liner (OPT 2)										

Design Targets										
Target Name	Dip Angle (°)	Dip Dir. (°)	TVD (usft)	+N/-S (usft)	+E/-W (usft)	Northing (usft)	Easting (usft)	Latitude	Longitude	
504-2920H PBH 5-16-15 - hit/miss target - Shape - plan hits target center - Point	0.00	0.00	7,484.0	9,058.4	765.1	609,256.27	2,320,532.00	41° 0' 0.112 N	104° 20' 19.824 W	

Casing Points						
Measured Depth (usft)	Vertical Depth (usft)	Name	Casing Diameter (")	Hole Diameter (")		
1,353.0	1,353.0	9-5/8" Surface	9-5/8	13-1/2		
7,811.0	7,484.0	7" Inter (OPT 2)	7	8-3/4		
16,507.6	7,484.0	5-1/2" Prod (OPT 1)	5-1/2	8-3/4		
16,507.6	7,484.0	4-1/2" Liner (OPT 2)	4-1/2	6		