

# Randall Creek 506-2905H

Surface Location			
NAD 1927 (NADCON CONUS) Colorado North 501			
Ground Elevation: 5349.0 RKB @ 5374.0usft (KB GL+25')			
Northing	Easting	Latitude	Longitude
60062.49	232137.69	40° 58' 29.179 N	104° 20' 11.152 W

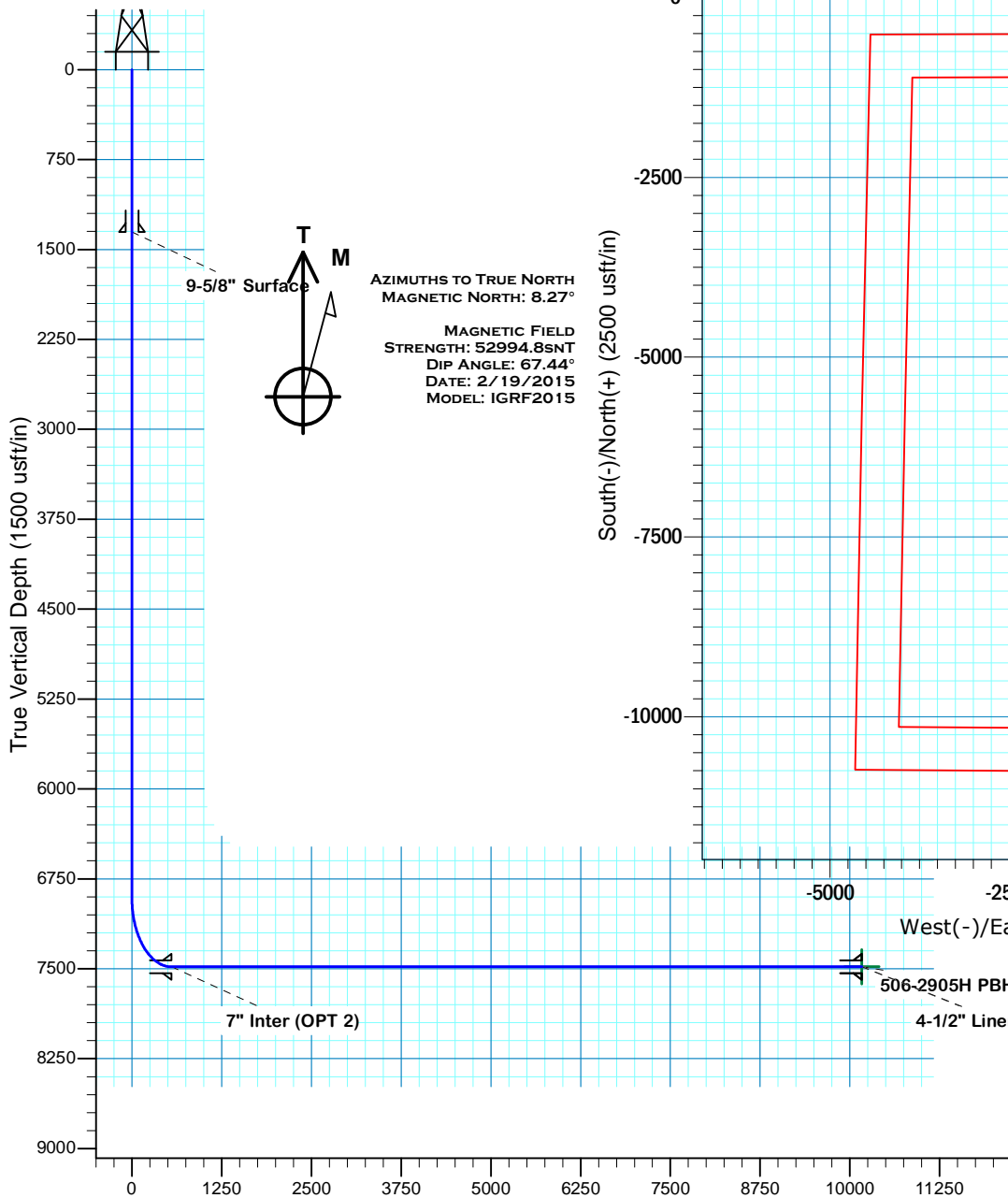

AZIMUTHS TO TRUE NORTH  
 MAGNETIC NORTH: 8.27°  
 MAGNETIC FIELD  
 STRENGTH: 52994.8sNT  
 DIP ANGLE: 67.44°  
 DATE: 2/19/2015  
 MODEL: IGRF2015

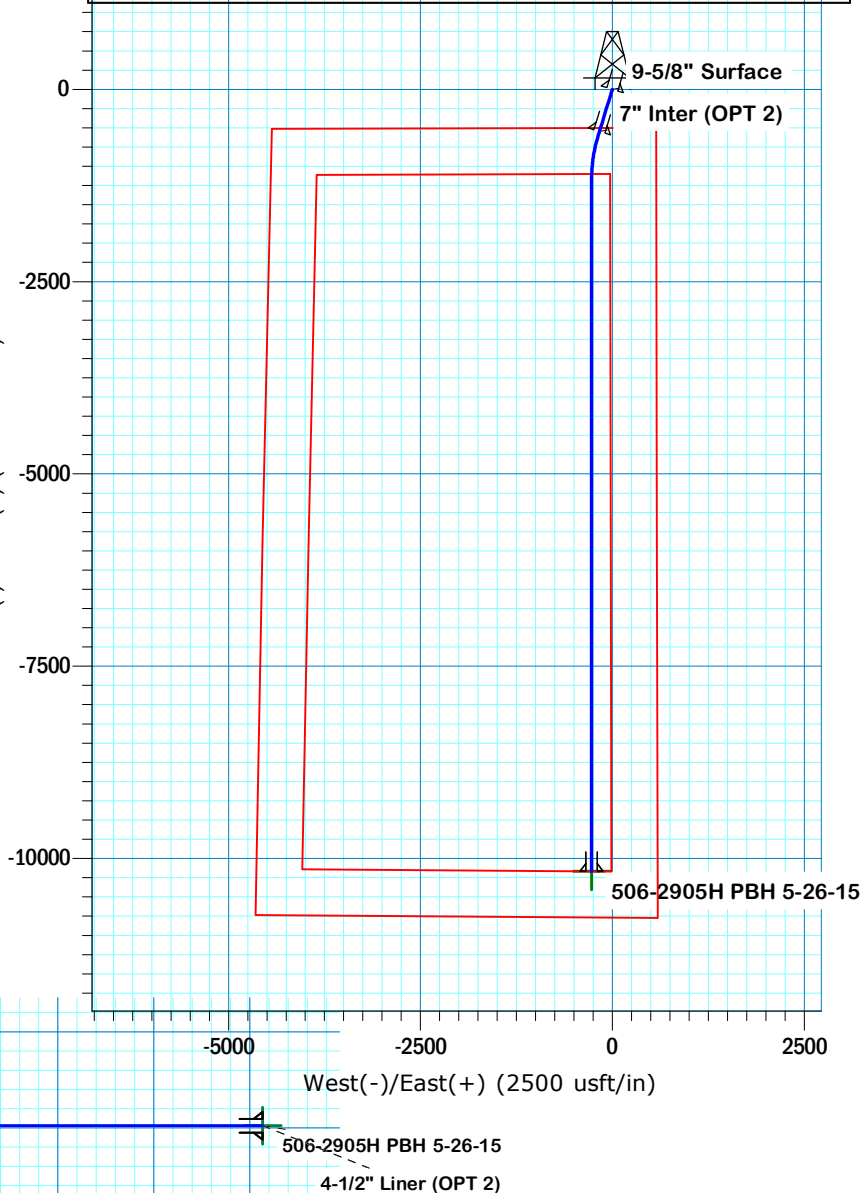

Project: DJ - Hereford Ranch  
 Site: Randall Creek R29 SESE Pad  
 Well: Randall Creek 506-2905H  
 Planner: M.Thompson  
 10:52, July 01 2015

## SECTION DETAILS

Sec	MD	Inc	Azi	TVD	+N/-S	+E/-W	Dleg	TFace	Vsect	Target
1	0.0	0.00	0.00	0.0	0.0	0.0	0.00	0.00	0.0	
2	6911.0	0.00	0.00	6911.0	0.0	0.0	0.00	0.00	0.0	
3	7811.0	90.00	197.00	7484.0	-547.9	-167.5	10.00	197.00	552.2	
4	7876.0	90.00	197.00	7484.0	-610.1	-186.5	0.00	0.00	614.8	
5	8442.6	90.00	180.00	7484.0	-1168.4	-270.0	3.00	-90.00	1175.2	506-2905H PBH 5-26-15
6	17440.4	90.00	180.00	7484.0	-10166.2	-270.1	0.00	0.00	10169.8	506-2905H PBH 5-26-15

## TARGET DETAILS

Name	TVD	+N/-S	+E/-W	Northing	Easting	Latitude	Longitude	Shape
506-2905H PBH 5-26-15	7484.0	-10166.2	-270.1	589893.62	2321180.99	40° 56' 48.732 N	104° 20' 14.671 W	Point

# **Denver Division- Colorado**

**DJ - Hereford Ranch  
Randall Creek R29 SESE Pad  
Randall Creek 506-2905H**

**OH**

**Plan: APD Plan (Plat 5-26-15)**

## **Standard Planning Report**

**01 July, 2015**

# EOG Resources, Inc.

## Planning Report

<b>Database:</b>	EDM_DENVER	<b>Local Co-ordinate Reference:</b>	Well Randall Creek 506-2905H
<b>Company:</b>	Denver Division- Colorado	<b>TVD Reference:</b>	RKB @ 5374.0usft (KB GL+25')
<b>Project:</b>	DJ - Hereford Ranch	<b>MD Reference:</b>	RKB @ 5374.0usft (KB GL+25')
<b>Site:</b>	Randall Creek R29 SESE Pad	<b>North Reference:</b>	True
<b>Well:</b>	Randall Creek 506-2905H	<b>Survey Calculation Method:</b>	Minimum Curvature
<b>Wellbore:</b>	OH		
<b>Design:</b>	APD Plan (Plat 5-26-15)		

<b>Project</b>	DJ - Hereford Ranch, Weld County		
<b>Map System:</b>	US State Plane 1927 (Exact solution)	<b>System Datum:</b>	Mean Sea Level
<b>Geo Datum:</b>	NAD 1927 (NADCON CONUS)		
<b>Map Zone:</b>	Colorado North 501		

<b>Site</b>	Randall Creek R29 SESE Pad		
<b>Site Position:</b>		<b>Northing:</b>	600,050.00 usft
<b>From:</b>	Map	<b>Easting:</b>	2,321,450.00 usft
<b>Position Uncertainty:</b>	0.0 usft	<b>Slot Radius:</b>	13-3/16 "
		<b>Latitude:</b>	40° 58' 29.039 N
		<b>Longitude:</b>	104° 20' 9.429 W
		<b>Grid Convergence:</b>	0.75 °

<b>Well</b>	Randall Creek 506-2905H		
<b>Well Position</b>	<b>+N/-S</b>	14.2 usft	<b>Northing:</b>
	<b>+E/-W</b>	-132.1 usft	<b>Easting:</b>
<b>Position Uncertainty</b>	0.0 usft	<b>Wellhead Elevation:</b>	0.0 usft
		<b>Latitude:</b>	40° 58' 29.179 N
		<b>Longitude:</b>	104° 20' 11.152 W
		<b>Ground Level:</b>	5,349.0 usft

<b>Wellbore</b>	OH				
<b>Magnetics</b>	<b>Model Name</b>	<b>Sample Date</b>	<b>Declination (°)</b>	<b>Dip Angle (°)</b>	<b>Field Strength (nT)</b>
	IGRF2015	2/19/2015	8.27	67.44	52,995

<b>Design</b>	APD Plan (Plat 5-26-15)			
<b>Audit Notes:</b>				
<b>Version:</b>	<b>Phase:</b>	PROTOTYPE	<b>Tie On Depth:</b>	0.0
<b>Vertical Section:</b>	<b>Depth From (TVD) (usft)</b>	<b>+N/-S (usft)</b>	<b>+E/-W (usft)</b>	<b>Direction (°)</b>
	0.0	0.0	0.0	181.52

<b>Plan Sections</b>										
Measured Depth (usft)	Inclination (°)	Azimuth (°)	Vertical Depth (usft)	+N/-S (usft)	+E/-W (usft)	Dogleg Rate (°/100usft)	Build Rate (°/100usft)	Turn Rate (°/100usft)	TFO (°)	Target
0.0	0.00	0.00	0.0	0.0	0.0	0.00	0.00	0.00	0.00	
6,911.0	0.00	0.00	6,911.0	0.0	0.0	0.00	0.00	0.00	0.00	
7,811.0	90.00	197.00	7,484.0	-547.9	-167.5	10.00	10.00	0.00	197.00	
7,876.0	90.00	197.00	7,484.0	-610.1	-186.5	0.00	0.00	0.00	0.00	
8,442.6	90.00	180.00	7,484.0	-1,168.4	-270.0	3.00	0.00	-3.00	-90.00	506-2905H PBH 5-26
17,440.4	90.00	180.00	7,484.0	-10,166.2	-270.1	0.00	0.00	0.00	0.00	506-2905H PBH 5-26

# EOG Resources, Inc.

## Planning Report

<b>Database:</b>	EDM_DENVER	<b>Local Co-ordinate Reference:</b>	Well Randall Creek 506-2905H
<b>Company:</b>	Denver Division- Colorado	<b>TVD Reference:</b>	RKB @ 5374.0usft (KB GL+25')
<b>Project:</b>	DJ - Hereford Ranch	<b>MD Reference:</b>	RKB @ 5374.0usft (KB GL+25')
<b>Site:</b>	Randall Creek R29 SESE Pad	<b>North Reference:</b>	True
<b>Well:</b>	Randall Creek 506-2905H	<b>Survey Calculation Method:</b>	Minimum Curvature
<b>Wellbore:</b>	OH		
<b>Design:</b>	APD Plan (Plat 5-26-15)		

Planned Survey									
Measured Depth (usft)	Inclination (°)	Azimuth (°)	Vertical Depth (usft)	+N/-S (usft)	+E/-W (usft)	Vertical Section (usft)	Dogleg Rate (°/100usft)	Build Rate (°/100usft)	Turn Rate (°/100usft)
0.0	0.00	0.00	0.0	0.0	0.0	0.0	0.00	0.00	0.00
100.0	0.00	0.00	100.0	0.0	0.0	0.0	0.00	0.00	0.00
200.0	0.00	0.00	200.0	0.0	0.0	0.0	0.00	0.00	0.00
300.0	0.00	0.00	300.0	0.0	0.0	0.0	0.00	0.00	0.00
400.0	0.00	0.00	400.0	0.0	0.0	0.0	0.00	0.00	0.00
500.0	0.00	0.00	500.0	0.0	0.0	0.0	0.00	0.00	0.00
600.0	0.00	0.00	600.0	0.0	0.0	0.0	0.00	0.00	0.00
700.0	0.00	0.00	700.0	0.0	0.0	0.0	0.00	0.00	0.00
800.0	0.00	0.00	800.0	0.0	0.0	0.0	0.00	0.00	0.00
900.0	0.00	0.00	900.0	0.0	0.0	0.0	0.00	0.00	0.00
1,000.0	0.00	0.00	1,000.0	0.0	0.0	0.0	0.00	0.00	0.00
1,100.0	0.00	0.00	1,100.0	0.0	0.0	0.0	0.00	0.00	0.00
1,200.0	0.00	0.00	1,200.0	0.0	0.0	0.0	0.00	0.00	0.00
1,300.0	0.00	0.00	1,300.0	0.0	0.0	0.0	0.00	0.00	0.00
1,353.0	0.00	0.00	1,353.0	0.0	0.0	0.0	0.00	0.00	0.00
9-5/8" Surface									
1,400.0	0.00	0.00	1,400.0	0.0	0.0	0.0	0.00	0.00	0.00
1,500.0	0.00	0.00	1,500.0	0.0	0.0	0.0	0.00	0.00	0.00
1,600.0	0.00	0.00	1,600.0	0.0	0.0	0.0	0.00	0.00	0.00
1,700.0	0.00	0.00	1,700.0	0.0	0.0	0.0	0.00	0.00	0.00
1,800.0	0.00	0.00	1,800.0	0.0	0.0	0.0	0.00	0.00	0.00
1,900.0	0.00	0.00	1,900.0	0.0	0.0	0.0	0.00	0.00	0.00
2,000.0	0.00	0.00	2,000.0	0.0	0.0	0.0	0.00	0.00	0.00
2,100.0	0.00	0.00	2,100.0	0.0	0.0	0.0	0.00	0.00	0.00
2,200.0	0.00	0.00	2,200.0	0.0	0.0	0.0	0.00	0.00	0.00
2,300.0	0.00	0.00	2,300.0	0.0	0.0	0.0	0.00	0.00	0.00
2,400.0	0.00	0.00	2,400.0	0.0	0.0	0.0	0.00	0.00	0.00
2,500.0	0.00	0.00	2,500.0	0.0	0.0	0.0	0.00	0.00	0.00
2,600.0	0.00	0.00	2,600.0	0.0	0.0	0.0	0.00	0.00	0.00
2,700.0	0.00	0.00	2,700.0	0.0	0.0	0.0	0.00	0.00	0.00
2,800.0	0.00	0.00	2,800.0	0.0	0.0	0.0	0.00	0.00	0.00
2,900.0	0.00	0.00	2,900.0	0.0	0.0	0.0	0.00	0.00	0.00
3,000.0	0.00	0.00	3,000.0	0.0	0.0	0.0	0.00	0.00	0.00
3,100.0	0.00	0.00	3,100.0	0.0	0.0	0.0	0.00	0.00	0.00
3,200.0	0.00	0.00	3,200.0	0.0	0.0	0.0	0.00	0.00	0.00
3,300.0	0.00	0.00	3,300.0	0.0	0.0	0.0	0.00	0.00	0.00
3,400.0	0.00	0.00	3,400.0	0.0	0.0	0.0	0.00	0.00	0.00
3,500.0	0.00	0.00	3,500.0	0.0	0.0	0.0	0.00	0.00	0.00
3,600.0	0.00	0.00	3,600.0	0.0	0.0	0.0	0.00	0.00	0.00
3,700.0	0.00	0.00	3,700.0	0.0	0.0	0.0	0.00	0.00	0.00
3,800.0	0.00	0.00	3,800.0	0.0	0.0	0.0	0.00	0.00	0.00
3,900.0	0.00	0.00	3,900.0	0.0	0.0	0.0	0.00	0.00	0.00
4,000.0	0.00	0.00	4,000.0	0.0	0.0	0.0	0.00	0.00	0.00
4,100.0	0.00	0.00	4,100.0	0.0	0.0	0.0	0.00	0.00	0.00
4,200.0	0.00	0.00	4,200.0	0.0	0.0	0.0	0.00	0.00	0.00
4,300.0	0.00	0.00	4,300.0	0.0	0.0	0.0	0.00	0.00	0.00
4,400.0	0.00	0.00	4,400.0	0.0	0.0	0.0	0.00	0.00	0.00
4,500.0	0.00	0.00	4,500.0	0.0	0.0	0.0	0.00	0.00	0.00
4,600.0	0.00	0.00	4,600.0	0.0	0.0	0.0	0.00	0.00	0.00
4,700.0	0.00	0.00	4,700.0	0.0	0.0	0.0	0.00	0.00	0.00
4,800.0	0.00	0.00	4,800.0	0.0	0.0	0.0	0.00	0.00	0.00
4,900.0	0.00	0.00	4,900.0	0.0	0.0	0.0	0.00	0.00	0.00
5,000.0	0.00	0.00	5,000.0	0.0	0.0	0.0	0.00	0.00	0.00
5,100.0	0.00	0.00	5,100.0	0.0	0.0	0.0	0.00	0.00	0.00

# EOG Resources, Inc.

## Planning Report

<b>Database:</b>	EDM_DENVER	<b>Local Co-ordinate Reference:</b>	Well Randall Creek 506-2905H
<b>Company:</b>	Denver Division- Colorado	<b>TVD Reference:</b>	RKB @ 5374.0usft (KB GL+25')
<b>Project:</b>	DJ - Hereford Ranch	<b>MD Reference:</b>	RKB @ 5374.0usft (KB GL+25')
<b>Site:</b>	Randall Creek R29 SESE Pad	<b>North Reference:</b>	True
<b>Well:</b>	Randall Creek 506-2905H	<b>Survey Calculation Method:</b>	Minimum Curvature
<b>Wellbore:</b>	OH		
<b>Design:</b>	APD Plan (Plat 5-26-15)		

Planned Survey									
Measured Depth (usft)	Inclination (°)	Azimuth (°)	Vertical Depth (usft)	+N/-S (usft)	+E/-W (usft)	Vertical Section (usft)	Dogleg Rate (°/100usft)	Build Rate (°/100usft)	Turn Rate (°/100usft)
5,200.0	0.00	0.00	5,200.0	0.0	0.0	0.0	0.00	0.00	0.00
5,300.0	0.00	0.00	5,300.0	0.0	0.0	0.0	0.00	0.00	0.00
5,400.0	0.00	0.00	5,400.0	0.0	0.0	0.0	0.00	0.00	0.00
5,500.0	0.00	0.00	5,500.0	0.0	0.0	0.0	0.00	0.00	0.00
5,600.0	0.00	0.00	5,600.0	0.0	0.0	0.0	0.00	0.00	0.00
5,700.0	0.00	0.00	5,700.0	0.0	0.0	0.0	0.00	0.00	0.00
5,800.0	0.00	0.00	5,800.0	0.0	0.0	0.0	0.00	0.00	0.00
5,900.0	0.00	0.00	5,900.0	0.0	0.0	0.0	0.00	0.00	0.00
6,000.0	0.00	0.00	6,000.0	0.0	0.0	0.0	0.00	0.00	0.00
6,100.0	0.00	0.00	6,100.0	0.0	0.0	0.0	0.00	0.00	0.00
6,200.0	0.00	0.00	6,200.0	0.0	0.0	0.0	0.00	0.00	0.00
6,300.0	0.00	0.00	6,300.0	0.0	0.0	0.0	0.00	0.00	0.00
6,400.0	0.00	0.00	6,400.0	0.0	0.0	0.0	0.00	0.00	0.00
6,500.0	0.00	0.00	6,500.0	0.0	0.0	0.0	0.00	0.00	0.00
6,600.0	0.00	0.00	6,600.0	0.0	0.0	0.0	0.00	0.00	0.00
6,700.0	0.00	0.00	6,700.0	0.0	0.0	0.0	0.00	0.00	0.00
6,800.0	0.00	0.00	6,800.0	0.0	0.0	0.0	0.00	0.00	0.00
6,900.0	0.00	0.00	6,900.0	0.0	0.0	0.0	0.00	0.00	0.00
6,911.0	0.00	0.00	6,911.0	0.0	0.0	0.0	0.00	0.00	0.00
7,000.0	8.90	197.00	6,999.6	-6.6	-2.0	6.6	10.00	10.00	0.00
7,100.0	18.90	197.00	7,096.6	-29.5	-9.0	29.8	10.00	10.00	0.00
7,200.0	28.90	197.00	7,187.9	-68.2	-20.9	68.8	10.00	10.00	0.00
7,300.0	38.90	197.00	7,270.8	-121.5	-37.1	122.4	10.00	10.00	0.00
7,400.0	48.90	197.00	7,342.8	-187.7	-57.4	189.2	10.00	10.00	0.00
7,500.0	58.90	197.00	7,401.6	-264.9	-81.0	267.0	10.00	10.00	0.00
7,600.0	68.90	197.00	7,445.5	-350.7	-107.2	353.4	10.00	10.00	0.00
7,700.0	78.90	197.00	7,473.2	-442.4	-135.3	445.9	10.00	10.00	0.00
7,800.0	88.90	197.00	7,483.9	-537.4	-164.3	541.6	10.00	10.00	0.00
7,811.0	90.00	197.00	7,484.0	-547.9	-167.5	552.2	10.00	10.00	0.00
7" Inter (OPT 2)									
7,876.0	90.00	197.00	7,484.0	-610.1	-186.5	614.8	0.00	0.00	0.00
7,900.0	90.00	196.28	7,484.0	-633.1	-193.4	638.0	3.00	0.00	-3.00
8,000.0	90.00	193.28	7,484.0	-729.8	-218.9	735.3	3.00	0.00	-3.00
8,100.0	90.00	190.28	7,484.0	-827.6	-239.3	833.7	3.00	0.00	-3.00
8,200.0	90.00	187.28	7,484.0	-926.5	-254.6	932.9	3.00	0.00	-3.00
8,300.0	90.00	184.28	7,484.0	-1,025.9	-264.6	1,032.6	3.00	0.00	-3.00
8,400.0	90.00	181.28	7,484.0	-1,125.8	-269.5	1,132.6	3.00	0.00	-3.00
8,442.6	90.00	180.00	7,484.0	-1,168.4	-270.0	1,175.2	3.00	0.00	-3.00
8,500.0	90.00	180.00	7,484.0	-1,225.8	-270.0	1,232.5	0.00	0.00	0.00
8,600.0	90.00	180.00	7,484.0	-1,325.8	-270.0	1,332.5	0.00	0.00	0.00
8,700.0	90.00	180.00	7,484.0	-1,425.8	-270.0	1,432.5	0.00	0.00	0.00
8,800.0	90.00	180.00	7,484.0	-1,525.8	-270.0	1,532.4	0.00	0.00	0.00
8,900.0	90.00	180.00	7,484.0	-1,625.8	-270.0	1,632.4	0.00	0.00	0.00
9,000.0	90.00	180.00	7,484.0	-1,725.8	-270.0	1,732.4	0.00	0.00	0.00
9,100.0	90.00	180.00	7,484.0	-1,825.8	-270.0	1,832.3	0.00	0.00	0.00
9,200.0	90.00	180.00	7,484.0	-1,925.8	-270.0	1,932.3	0.00	0.00	0.00
9,300.0	90.00	180.00	7,484.0	-2,025.8	-270.0	2,032.3	0.00	0.00	0.00
9,400.0	90.00	180.00	7,484.0	-2,125.8	-270.0	2,132.2	0.00	0.00	0.00
9,500.0	90.00	180.00	7,484.0	-2,225.8	-270.0	2,232.2	0.00	0.00	0.00
9,600.0	90.00	180.00	7,484.0	-2,325.8	-270.0	2,332.2	0.00	0.00	0.00
9,700.0	90.00	180.00	7,484.0	-2,425.8	-270.0	2,432.1	0.00	0.00	0.00
9,800.0	90.00	180.00	7,484.0	-2,525.8	-270.0	2,532.1	0.00	0.00	0.00
9,900.0	90.00	180.00	7,484.0	-2,625.8	-270.0	2,632.0	0.00	0.00	0.00

# EOG Resources, Inc.

## Planning Report

<b>Database:</b>	EDM_DENVER	<b>Local Co-ordinate Reference:</b>	Well Randall Creek 506-2905H
<b>Company:</b>	Denver Division- Colorado	<b>TVD Reference:</b>	RKB @ 5374.0usft (KB GL+25')
<b>Project:</b>	DJ - Hereford Ranch	<b>MD Reference:</b>	RKB @ 5374.0usft (KB GL+25')
<b>Site:</b>	Randall Creek R29 SESE Pad	<b>North Reference:</b>	True
<b>Well:</b>	Randall Creek 506-2905H	<b>Survey Calculation Method:</b>	Minimum Curvature
<b>Wellbore:</b>	OH		
<b>Design:</b>	APD Plan (Plat 5-26-15)		

Planned Survey									
Measured Depth (usft)	Inclination (°)	Azimuth (°)	Vertical Depth (usft)	+N/-S (usft)	+E/-W (usft)	Vertical Section (usft)	Dogleg Rate (°/100usft)	Build Rate (°/100usft)	Turn Rate (°/100usft)
10,000.0	90.00	180.00	7,484.0	-2,725.8	-270.0	2,732.0	0.00	0.00	0.00
10,100.0	90.00	180.00	7,484.0	-2,825.8	-270.0	2,832.0	0.00	0.00	0.00
10,200.0	90.00	180.00	7,484.0	-2,925.8	-270.0	2,931.9	0.00	0.00	0.00
10,300.0	90.00	180.00	7,484.0	-3,025.8	-270.0	3,031.9	0.00	0.00	0.00
10,400.0	90.00	180.00	7,484.0	-3,125.8	-270.0	3,131.9	0.00	0.00	0.00
10,500.0	90.00	180.00	7,484.0	-3,225.8	-270.0	3,231.8	0.00	0.00	0.00
10,600.0	90.00	180.00	7,484.0	-3,325.8	-270.0	3,331.8	0.00	0.00	0.00
10,700.0	90.00	180.00	7,484.0	-3,425.8	-270.0	3,431.8	0.00	0.00	0.00
10,800.0	90.00	180.00	7,484.0	-3,525.8	-270.0	3,531.7	0.00	0.00	0.00
10,900.0	90.00	180.00	7,484.0	-3,625.8	-270.0	3,631.7	0.00	0.00	0.00
11,000.0	90.00	180.00	7,484.0	-3,725.8	-270.0	3,731.7	0.00	0.00	0.00
11,100.0	90.00	180.00	7,484.0	-3,825.8	-270.0	3,831.6	0.00	0.00	0.00
11,200.0	90.00	180.00	7,484.0	-3,925.8	-270.0	3,931.6	0.00	0.00	0.00
11,300.0	90.00	180.00	7,484.0	-4,025.8	-270.0	4,031.6	0.00	0.00	0.00
11,400.0	90.00	180.00	7,484.0	-4,125.8	-270.0	4,131.5	0.00	0.00	0.00
11,500.0	90.00	180.00	7,484.0	-4,225.8	-270.0	4,231.5	0.00	0.00	0.00
11,600.0	90.00	180.00	7,484.0	-4,325.8	-270.0	4,331.5	0.00	0.00	0.00
11,700.0	90.00	180.00	7,484.0	-4,425.8	-270.0	4,431.4	0.00	0.00	0.00
11,800.0	90.00	180.00	7,484.0	-4,525.8	-270.0	4,531.4	0.00	0.00	0.00
11,900.0	90.00	180.00	7,484.0	-4,625.8	-270.0	4,631.3	0.00	0.00	0.00
12,000.0	90.00	180.00	7,484.0	-4,725.8	-270.0	4,731.3	0.00	0.00	0.00
12,100.0	90.00	180.00	7,484.0	-4,825.8	-270.0	4,831.3	0.00	0.00	0.00
12,200.0	90.00	180.00	7,484.0	-4,925.8	-270.0	4,931.2	0.00	0.00	0.00
12,300.0	90.00	180.00	7,484.0	-5,025.8	-270.0	5,031.2	0.00	0.00	0.00
12,400.0	90.00	180.00	7,484.0	-5,125.8	-270.0	5,131.2	0.00	0.00	0.00
12,500.0	90.00	180.00	7,484.0	-5,225.8	-270.0	5,231.1	0.00	0.00	0.00
12,600.0	90.00	180.00	7,484.0	-5,325.8	-270.0	5,331.1	0.00	0.00	0.00
12,700.0	90.00	180.00	7,484.0	-5,425.8	-270.0	5,431.1	0.00	0.00	0.00
12,800.0	90.00	180.00	7,484.0	-5,525.8	-270.0	5,531.0	0.00	0.00	0.00
12,900.0	90.00	180.00	7,484.0	-5,625.8	-270.0	5,631.0	0.00	0.00	0.00
13,000.0	90.00	180.00	7,484.0	-5,725.8	-270.0	5,731.0	0.00	0.00	0.00
13,100.0	90.00	180.00	7,484.0	-5,825.8	-270.0	5,830.9	0.00	0.00	0.00
13,200.0	90.00	180.00	7,484.0	-5,925.8	-270.0	5,930.9	0.00	0.00	0.00
13,300.0	90.00	180.00	7,484.0	-6,025.8	-270.1	6,030.9	0.00	0.00	0.00
13,400.0	90.00	180.00	7,484.0	-6,125.8	-270.1	6,130.8	0.00	0.00	0.00
13,500.0	90.00	180.00	7,484.0	-6,225.8	-270.1	6,230.8	0.00	0.00	0.00
13,600.0	90.00	180.00	7,484.0	-6,325.8	-270.1	6,330.7	0.00	0.00	0.00
13,700.0	90.00	180.00	7,484.0	-6,425.8	-270.1	6,430.7	0.00	0.00	0.00
13,800.0	90.00	180.00	7,484.0	-6,525.8	-270.1	6,530.7	0.00	0.00	0.00
13,900.0	90.00	180.00	7,484.0	-6,625.8	-270.1	6,630.6	0.00	0.00	0.00
14,000.0	90.00	180.00	7,484.0	-6,725.8	-270.1	6,730.6	0.00	0.00	0.00
14,100.0	90.00	180.00	7,484.0	-6,825.8	-270.1	6,830.6	0.00	0.00	0.00
14,200.0	90.00	180.00	7,484.0	-6,925.8	-270.1	6,930.5	0.00	0.00	0.00
14,300.0	90.00	180.00	7,484.0	-7,025.8	-270.1	7,030.5	0.00	0.00	0.00
14,400.0	90.00	180.00	7,484.0	-7,125.8	-270.1	7,130.5	0.00	0.00	0.00
14,500.0	90.00	180.00	7,484.0	-7,225.8	-270.1	7,230.4	0.00	0.00	0.00
14,600.0	90.00	180.00	7,484.0	-7,325.8	-270.1	7,330.4	0.00	0.00	0.00
14,700.0	90.00	180.00	7,484.0	-7,425.8	-270.1	7,430.4	0.00	0.00	0.00
14,800.0	90.00	180.00	7,484.0	-7,525.8	-270.1	7,530.3	0.00	0.00	0.00
14,900.0	90.00	180.00	7,484.0	-7,625.8	-270.1	7,630.3	0.00	0.00	0.00
15,000.0	90.00	180.00	7,484.0	-7,725.8	-270.1	7,730.3	0.00	0.00	0.00
15,100.0	90.00	180.00	7,484.0	-7,825.8	-270.1	7,830.2	0.00	0.00	0.00
15,200.0	90.00	180.00	7,484.0	-7,925.8	-270.1	7,930.2	0.00	0.00	0.00
15,300.0	90.00	180.00	7,484.0	-8,025.8	-270.1	8,030.1	0.00	0.00	0.00

# EOG Resources, Inc.

## Planning Report

<b>Database:</b>	EDM_DENVER	<b>Local Co-ordinate Reference:</b>	Well Randall Creek 506-2905H
<b>Company:</b>	Denver Division- Colorado	<b>TVD Reference:</b>	RKB @ 5374.0usft (KB GL+25')
<b>Project:</b>	DJ - Hereford Ranch	<b>MD Reference:</b>	RKB @ 5374.0usft (KB GL+25')
<b>Site:</b>	Randall Creek R29 SESE Pad	<b>North Reference:</b>	True
<b>Well:</b>	Randall Creek 506-2905H	<b>Survey Calculation Method:</b>	Minimum Curvature
<b>Wellbore:</b>	OH		
<b>Design:</b>	APD Plan (Plat 5-26-15)		

Planned Survey										
Measured Depth (usft)	Inclination (°)	Azimuth (°)	Vertical Depth (usft)	+N/-S (usft)	+E/-W (usft)	Vertical Section (usft)	Dogleg Rate (°/100usft)	Build Rate (°/100usft)	Turn Rate (°/100usft)	
15,400.0	90.00	180.00	7,484.0	-8,125.8	-270.1	8,130.1	0.00	0.00	0.00	
15,500.0	90.00	180.00	7,484.0	-8,225.8	-270.1	8,230.1	0.00	0.00	0.00	
15,600.0	90.00	180.00	7,484.0	-8,325.8	-270.1	8,330.0	0.00	0.00	0.00	
15,700.0	90.00	180.00	7,484.0	-8,425.8	-270.1	8,430.0	0.00	0.00	0.00	
15,800.0	90.00	180.00	7,484.0	-8,525.8	-270.1	8,530.0	0.00	0.00	0.00	
15,900.0	90.00	180.00	7,484.0	-8,625.8	-270.1	8,629.9	0.00	0.00	0.00	
16,000.0	90.00	180.00	7,484.0	-8,725.8	-270.1	8,729.9	0.00	0.00	0.00	
16,100.0	90.00	180.00	7,484.0	-8,825.8	-270.1	8,829.9	0.00	0.00	0.00	
16,200.0	90.00	180.00	7,484.0	-8,925.8	-270.1	8,929.8	0.00	0.00	0.00	
16,300.0	90.00	180.00	7,484.0	-9,025.8	-270.1	9,029.8	0.00	0.00	0.00	
16,400.0	90.00	180.00	7,484.0	-9,125.8	-270.1	9,129.8	0.00	0.00	0.00	
16,500.0	90.00	180.00	7,484.0	-9,225.8	-270.1	9,229.7	0.00	0.00	0.00	
16,600.0	90.00	180.00	7,484.0	-9,325.8	-270.1	9,329.7	0.00	0.00	0.00	
16,700.0	90.00	180.00	7,484.0	-9,425.8	-270.1	9,429.7	0.00	0.00	0.00	
16,800.0	90.00	180.00	7,484.0	-9,525.8	-270.1	9,529.6	0.00	0.00	0.00	
16,900.0	90.00	180.00	7,484.0	-9,625.8	-270.1	9,629.6	0.00	0.00	0.00	
17,000.0	90.00	180.00	7,484.0	-9,725.8	-270.1	9,729.5	0.00	0.00	0.00	
17,100.0	90.00	180.00	7,484.0	-9,825.8	-270.1	9,829.5	0.00	0.00	0.00	
17,200.0	90.00	180.00	7,484.0	-9,925.8	-270.1	9,929.5	0.00	0.00	0.00	
17,300.0	90.00	180.00	7,484.0	-10,025.8	-270.1	10,029.4	0.00	0.00	0.00	
17,400.0	90.00	180.00	7,484.0	-10,125.8	-270.1	10,129.4	0.00	0.00	0.00	
17,440.4	90.00	180.00	7,484.0	-10,166.2	-270.1	10,169.8	0.00	0.00	0.00	

Design Targets										
Target Name	Dip Angle (°)	Dip Dir. (°)	TVD (usft)	+N/-S (usft)	+E/-W (usft)	Northing (usft)	Easting (usft)	Latitude	Longitude	
506-2905H PBH 5-26-15	0.00	0.00	7,484.0	-10,166.2	-270.1	589,893.62	2,321,180.99	40° 56' 48.732 N	104° 20' 14.671 W	
- hit/miss target										
- Shape										
- plan hits target center										
- Point										

Casing Points					
Measured Depth (usft)	Vertical Depth (usft)	Name	Casing Diameter (")	Hole Diameter (")	
1,353.0	1,353.0	9-5/8" Surface	9-5/8	13-1/2	
7,811.0	7,484.0	7" Inter (OPT 2)	7	8-3/4	
17,440.4	7,484.0	5-1/2" Prod (OPT 1)	5-1/2	8-3/4	
17,440.4	7,484.0	4-1/2" Liner (OPT 2)	4-1/2	6	