

R  
63  
W

PROPOSED LOCATION:  
CRITTER CREEK 17 SESE ON  
EXISTING CRITTER CREEK #13-17H

1,000' BUFFER

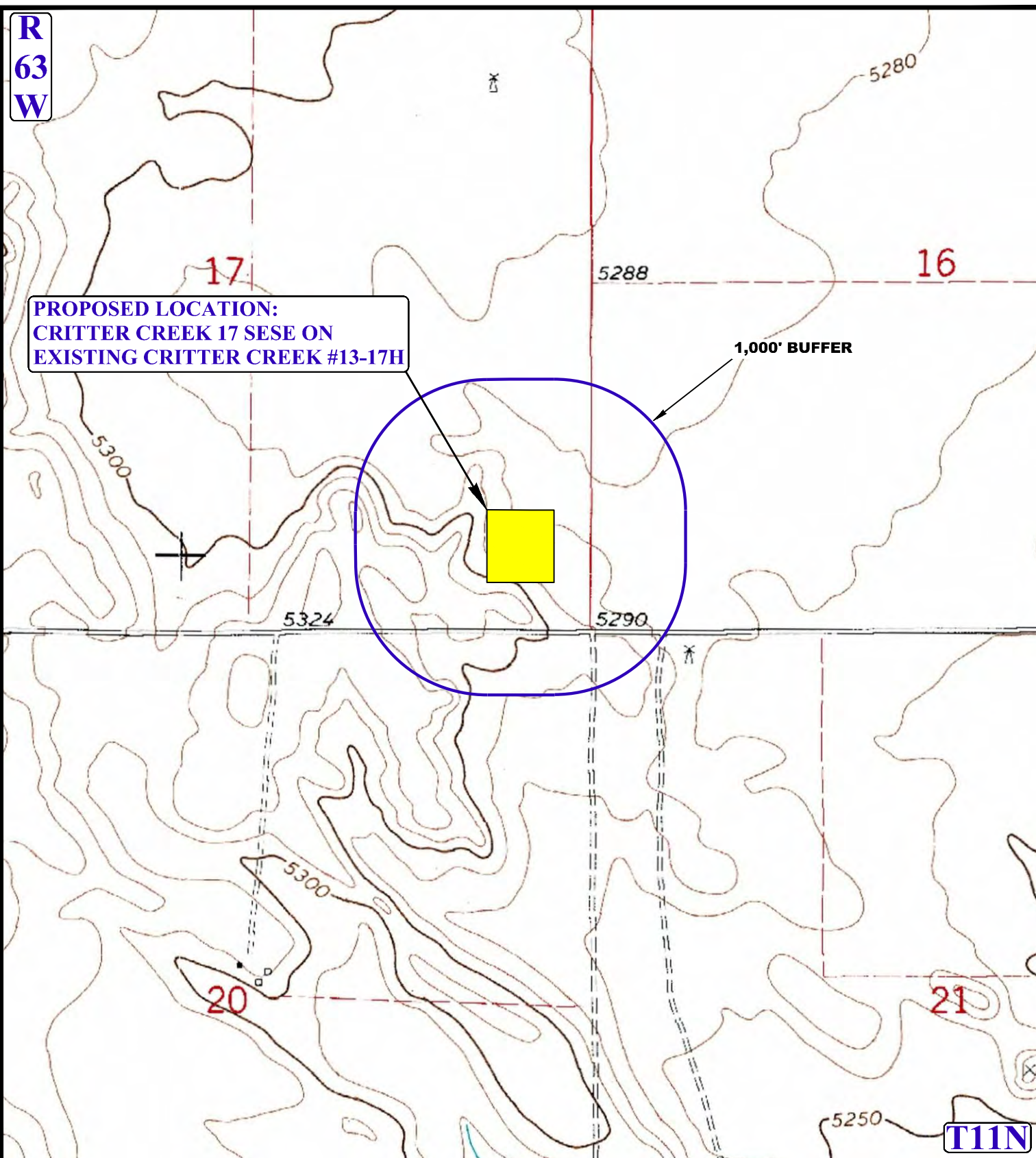

**LEGEND:**

1000' OFFSET BOUNDARY

**EOG RESOURCES, INC.**

CRITTER CREEK 17 SESE ON EXISTING  
CRITTER CREEK #13-17H PAD  
SECTION 17, T11N, R63W, 6th P.M., SE 1/4 SE 1/4  
WELD COUNTY, COLORADO

DRAWN BY: B.R.

DATE DRAWN: 03-31-15

SCALE: 1" = 1000'

REVISED: 00-00-00

**HYDROLOGY MAP**

**TOPO W**



**UELS, LLC**  
Corporate Office \* 85 South 200 East  
Vernal, UT 84078 \* (435) 789-1017

