

PROCEED IN A WESTERLY DIRECTION FROM HEREFORD, COLORADO ALONG COUNTY ROAD 136 APPROXIMATELY 1.5 MILES TO THE JUNCTION OF THIS ROAD AND COUNTY ROAD 77 TO THE SOUTH; TURN LEFT AND PROCEED IN A SOUTHERLY DIRECTION APPROXIMATELY 2.0 MILES TO THE JUNCTION OF THIS ROAD AND COUNTY ROAD 132 TO THE WEST; TURN RIGHT AND PROCEED IN A WESTERLY DIRECTION APPROXIMATELY 4.9 MILES TO THE JUNCTION OF THIS ROAD AND COUNTY ROAD 67 TO THE SOUTH; TURN LEFT AND PROCEED IN A SOUTHERLY DIRECTION APPROXIMATELY 2.0 MILES TO THE JUNCTION OF THIS ROAD AND COUNTY ROAD 128 TO THE WEST; TURN RIGHT AND PROCEED IN A WESTERLY DIRECTION APPROXIMATELY 1.0 MILES TO THE BEGINNING OF THE EXISTING ACCESS ROAD TO THE NORTH; FOLLOW ROAD IN A NORTHERLY, THEN WESTERLY DIRECTION APPROXIMATELY 0.1 MILE TO THE PROPOSED LOCATION.

TOTAL DISTANCE FROM HEREFORD, COLORADO TO THE PROPOSED WELL LOCATION IS APPROXIMATELY 11.5 MILES.

**EOG RESOURCES, INC.**

**CRITTER CREEK 17 SESE ON EXISTING  
CRITTER CREEK #13-17H PAD  
SECTION 17, T11N, R63W, 6th P.M., SE 1/4 SE 1/4  
WELD COUNTY, COLORADO**



**UELS, LLC**  
Corporate Office \* 85 South 200 East  
Vernal, UT 84078 \* (435) 789-1017

DRAWN BY: B.R.

DATE DRAWN: 03-31-15

REVISED: 00-00-00

**ROAD DESCRIPTION**

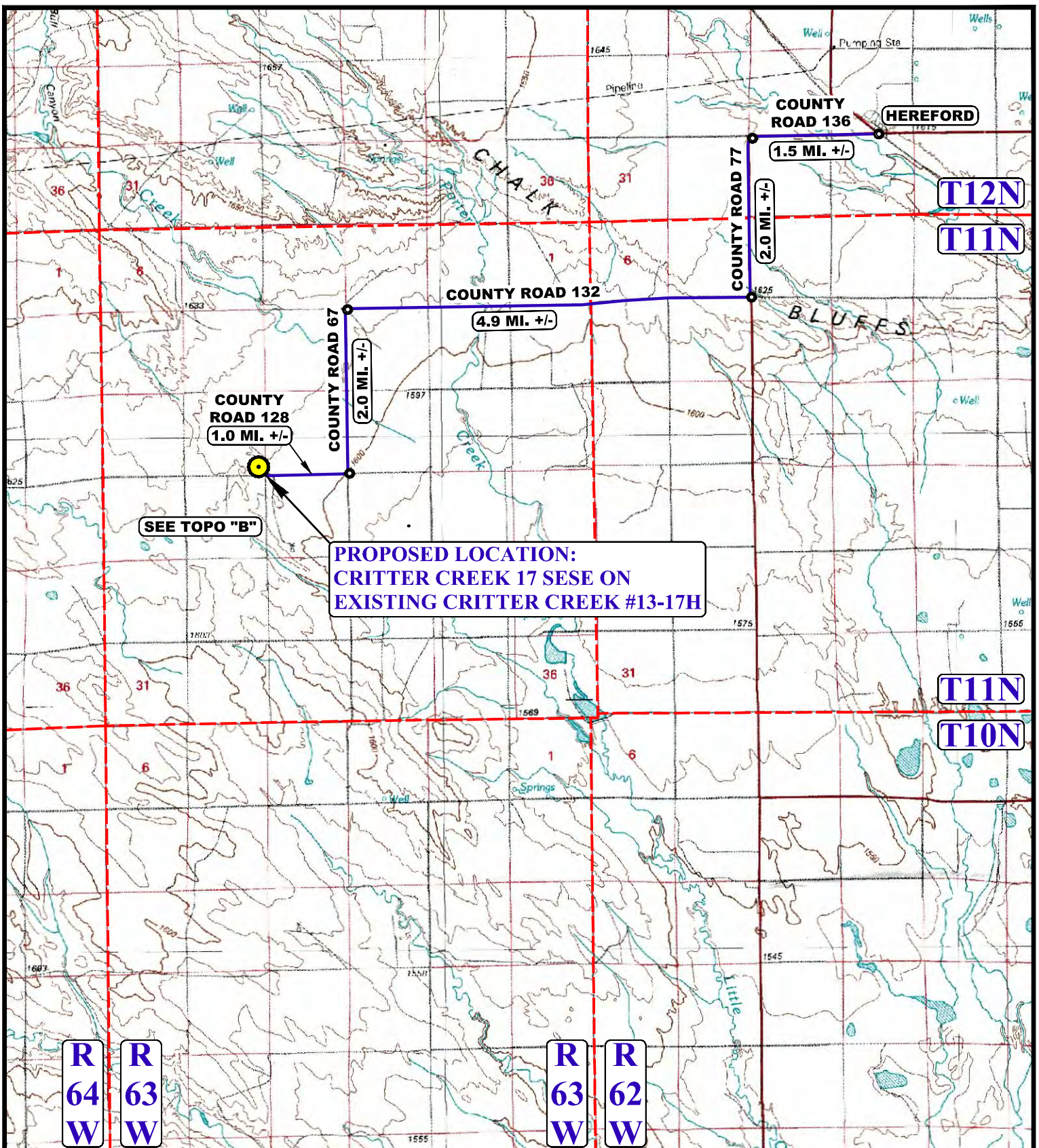

# LEGEND:

 PROPOSED LOCATION

EOG RESOURCES, INC.

CRITTER CREEK 17 SESE ON EXISTING  
CRITTER CREEK #13-17H PAD  
SECTION 17, T11N, R63W, 6th P.M., SE 1/4 SE 1/4  
WELD COUNTY, COLORADO



UELS, LLC  
Corporate Office \* 85 South 200 East  
Vernal, UT 84078 \* (435) 789-1017

DRAWN BY: B.R.	DATE DRAWN: 03-31-15
SCALE: 1:100,000	REVISED: 00-00-00
ACCESS ROAD MAP	TOPO A



R  
63  
W

**PROPOSED LOCATION:  
CRITTER CREEK 17 SESE ON  
EXISTING CRITTER CREEK #13-17H**

17  
**WAHLERT RANCH LLLP**

**SEE DETAIL "A"**

**CRITTER CREEK #13-17H**

**0.1 MI. +/-**

**COUNTY ROAD 128**

**1.0 MI. +/-**

**COUNTY ROAD 67**

**HEREFORD 10.4 MI. +/-**

5265

5252

16

15

22

27

**T11N**

**EXISTING FENCE (TYP.)**

**BURIED EXISTING  
FIBER OPTIC LINE**

**BURIED EXISTING PIPELINE (TYP.)**

**EXISTING POWER LINE (TYP.)**

**DETAIL "A"**

NOTE: PARCEL DATA SHOWN HAS BEEN OBTAINED FROM VARIOUS SOURCES AND SHOULD BE USED FOR MAPPING, GRAPHIC AND PLANNING PURPOSES ONLY. NO WARRANTY IS MADE BY UINTAH ENGINEERING AND LAND SURVEYING (UELS) FOR ACCURACY OF THE PARCEL DATA.

**LEGEND:**

- EXISTING ROAD
- x - EXISTING FENCE
- - - EXISTING PIPELINE
- - - - EXISTING POWER LINE

**EOG RESOURCES, INC.**

**CRITTER CREEK 17 SESE ON EXISTING  
CRITTER CREEK #13-17H PAD  
SECTION 17, T11N, R63W, 6th P.M., SE 1/4 SE 1/4  
WELD COUNTY, COLORADO**

**DRAWN BY: B.R.**

**DATE DRAWN: 03-31-15**

**SCALE: 1" = 2000'**

**REVISED: 00-00-00**

**ACCESS ROAD MAP**

**TOPO B**



**UELS, LLC**  
Corporate Office \* 85 South 200 East  
Vernal, UT 84078 \* (435) 789-1017

