



Lat40°, Inc. 6250 W. 10th St, Unit 2 Greeley, CO 970-515-5294

NOTIFICATION ZONE DRAWING

SPAUR 4N67W10LQ PAD

SECTION: 10
TOWNSHIP: 4N
RANGE: 67W
6TH P.M.
WELD COUNTY, CO

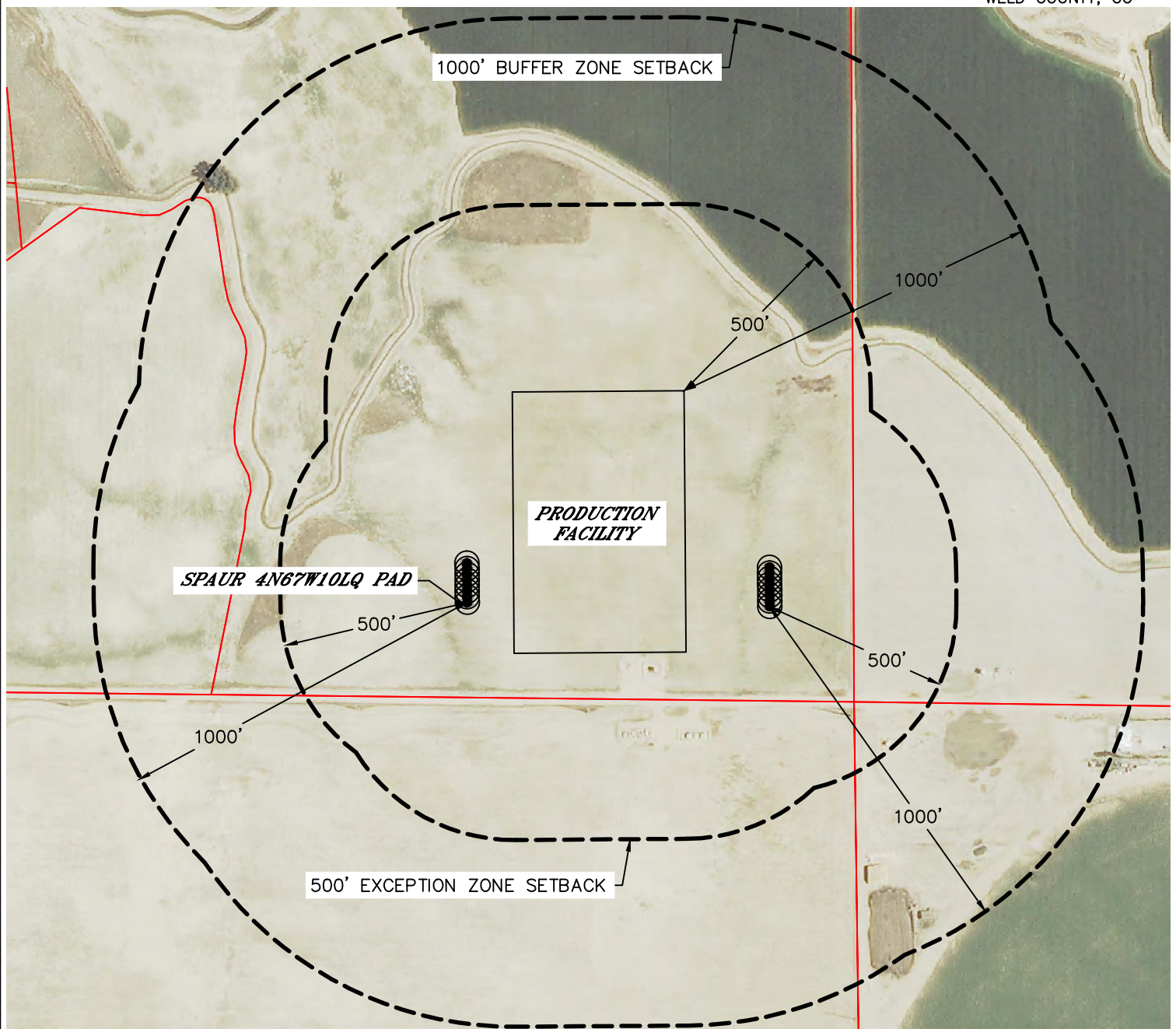

EXCEPTION ZONE:

NO EXISTING BUILDING UNITS WITHIN EXCEPTION ZONE

BUFFER ZONE:

NO EXISTING BUILDING UNITS WITHIN BUFFER ZONE

LEGEND

- PROPERTY LINE
- (BT) BUILDING
- (BU) BUILDING UNIT

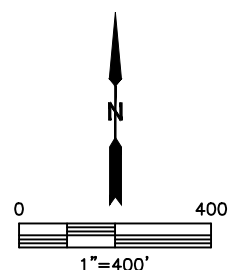

DATE: 5/19/2015
PROJECT#: 2014159