

NOTE: Under Colorado law, you must commence any legal action based upon any defect in this certificate within three years after defect is discovered. In no event, may any action based upon any defect in this survey be commenced more than ten years after date of this certificate shown hereon. (13-80105 C.R.S.)

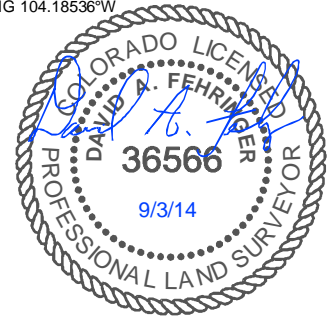

CERTIFICATE OF SURVEYOR

I, David A. Fehringer of Lander, Wyoming hereby certify that this well location certificate was prepared from notes taken during an actual survey on AUGUST 27, 2014; and that it correctly shows the drilling location of BONANZA CREEK ENERGY, INC., PRONGHORN A-E-22HNC as staked during said survey. This map does not represent a boundary survey or an improvement location plat and should not be used for the establishment of boundary lines.

WELL COORDINATES

	NAD 83		COLORADO NORTH NAD83	
A-E-22HNB	LATITUDE	LONGITUDE	NORTHING	EASTING
SURFACE	40.392510	104.200140	1388486	3362051
TARGET 1	40.392130	104.204410	1388328	3360863
BOTTOM HOLE	40.380140	104.204530	1383963	3360894

NOTES:

- All bearings are GRID based upon the Colorado State Plane Coordinate System, North Zone, NAD83(2011) derived from post-processed static GPS observations.
- Distances are at GROUND
- Vertical Datum is NAVD88 based upon GPS observations
- PDOP value equals 2.1.
- GPS operator: John Stoddard.
- Undisturbed ground elevation at wellhead = 4661.8'
- (M) Measured distance; (R) Record distance
- Nearest Cultural Distances
 - Buildings: 5280+
 - Building Unit: 5280+
 - High Occupancy Building Unit: 5280'+
 - Designated Outside Activity Area: 5280'+
 - Public Road: 340' north
 - Above Ground Utility: 5280'+
 - Railroad: 5280'+
 - Property Line: 419' north

SHEET NO:

1 of 1



Drawn By: DAF
Checked By: MAM
Date: 3/14/14
Revision: #2
Date: 9/5/14
Explanation: change well configuration

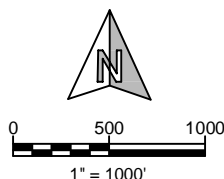

WELL LOCATION CERTIFICATE

PRONGHORN A-E-22HNB
419' FNL, 1198' FWL
NW $\frac{1}{4}$ NW $\frac{1}{4}$, SECTION 22,
T.5N., R.61W., 6th PM
WELD COUNTY, COLORADO

