

T11N

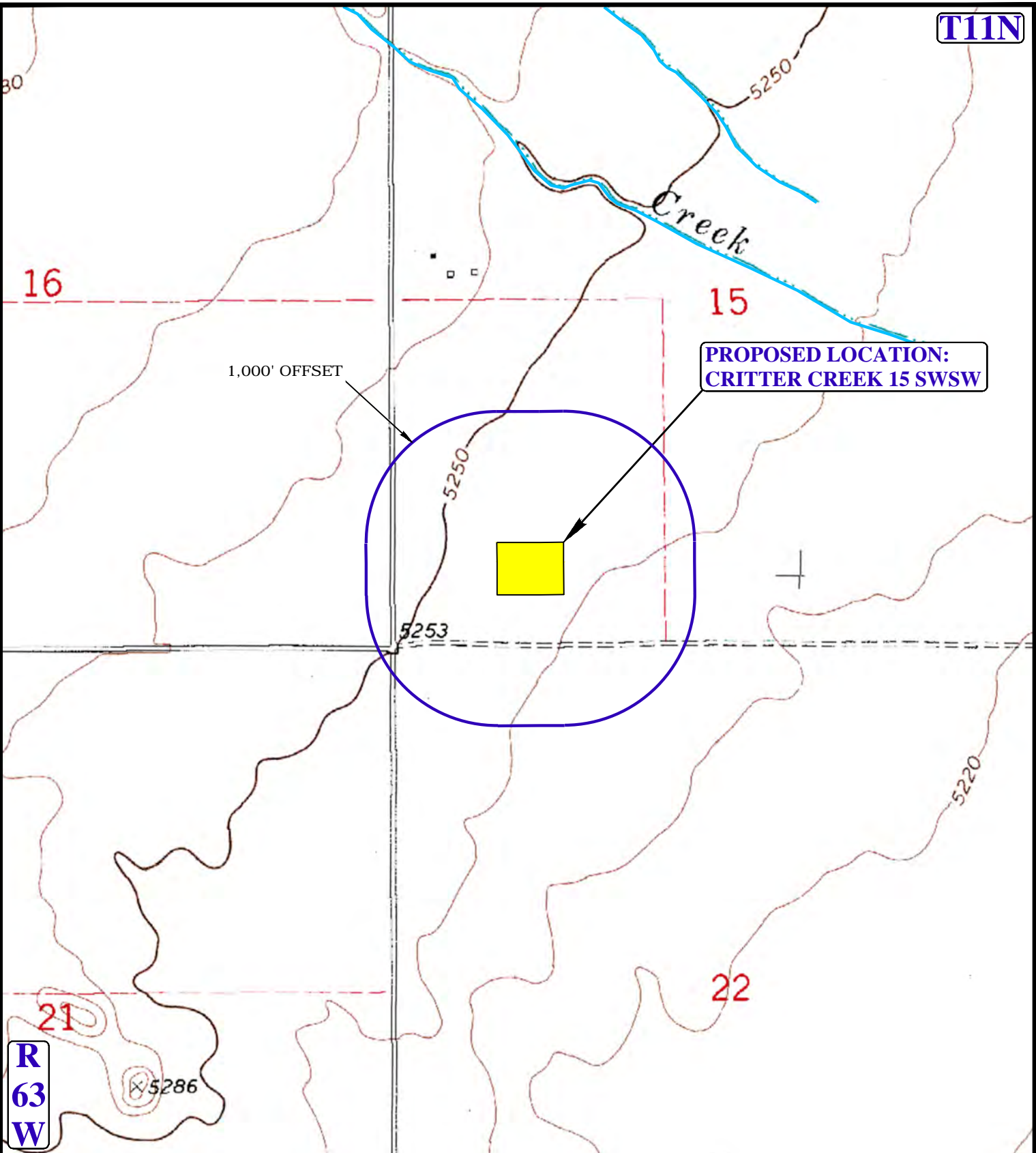

**PROPOSED LOCATION:
CRITTER CREEK 15 SWSW**

1,000' OFFSET

R
63
W

LEGEND:

- EXISTING DRAINAGE
- 1000' OFFSET BOUNDARY

EOG RESOURCES, INC.

**CRITTER CREEK 15 SWSW
SECTION 15, T11N, R63W, 6th P.M.
SW 1/4 SW 1/4
WELD COUNTY, COLORADO**



DRAWN BY: J.D.J.	DATE DRAWN: 04-08-15
SCALE: 1" = 1000'	REVISED: 00-00-00
HYDROLOGY MAP	TOPO W



UELS, LLC
Corporate Office * 85 South 200 East
Vernal, UT 84078 * (435) 789-1017