

PROCEED IN A WESTERLY DIRECTION FROM HEREFORD, COLORADO ALONG COUNTY ROAD 136 APPROXIMATELY 1.5 MILES TO THE JUNCTION OF THIS ROAD AND COUNTY ROAD 77 TO THE SOUTH; TURN LEFT AND PROCEED IN A SOUTHERLY DIRECTION APPROXIMATELY 2.0 MILES TO THE JUNCTION OF THIS ROAD AND COUNTY ROAD 132 TO THE WEST; TURN RIGHT AND PROCEED IN A WESTERLY DIRECTION APPROXIMATELY 4.9 MILES TO THE JUNCTION OF THIS ROAD AND COUNTY ROAD 67 TO THE SOUTH; TURN LEFT AND PROCEED IN A SOUTHERLY DIRECTION APPROXIMATELY 2.0 MILES TO THE JUNCTION OF THIS ROAD AND COUNTY ROAD 128 TO THE EAST; TURN LEFT AND PROCEED IN AN EASTERLY DIRECTION APPROXIMATELY 0.3 MILES TO THE BEGINNING OF THE PROPOSED ACCESS TO THE NORTH; FOLLOW ROAD FLAGS IN A NORTHERLY, THEN WESTERLY DIRECTION APPROXIMATELY 679' TO THE PROPOSED LOCATION.

TOTAL DISTANCE FROM HEREFORD, COLORADO TO THE PROPOSED LOCATION IS APPROXIMATELY 10.8 MILES.

EOG RESOURCES, INC.

CRITTER CREEK 15 SWSW
SECTION 15, T11N, R63W, 6th P.M.
SW 1/4 SW 1/4
WELD COUNTY, COLORADO

DRAWN BY: J.D.J.

DATE DRAWN: 04-08-15

REVISED: 00-00-00

ROAD DESCRIPTION



UELS, LLC

Corporate Office * 85 South 200 East
Vernal, UT 84078 * (435) 789-1017

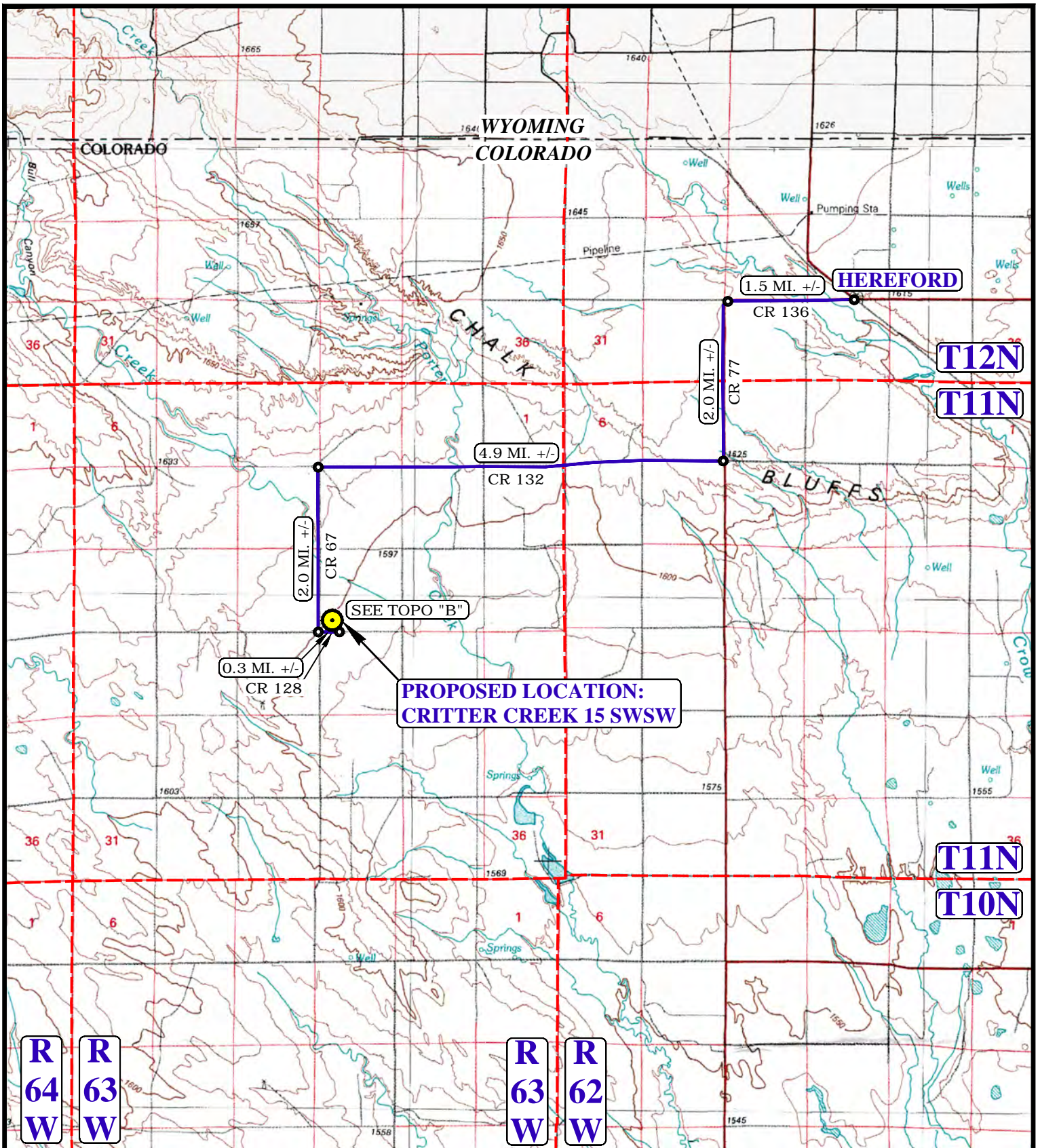

**PROPOSED LOCATION:
CRITTER CREEK 15 SWSW**

SEE TOPO "B"

**R 64
W**

**R 63
W**

**R 63
W**

**R 62
W**

LEGEND:

PROPOSED LOCATION



EOG RESOURCES, INC.

**CRITTER CREEK 15 SWSW
SECTION 15, T11N, R63W, 6th P.M.
SW 1/4 SW 1/4
WELD COUNTY, COLORADO**

DRAWN BY: J.D.J.

DATE DRAWN: 04-08-15

SCALE: 1:100,000

REVISED: 00-00-00

ACCESS ROAD MAP

TOPO A

UELS, LLC

Corporate Office * 85 South 200 East
Vernal, UT 84078 * (435) 789-1017



R
63
W

HEREFORD 8.4 MI. +/-

CR 132

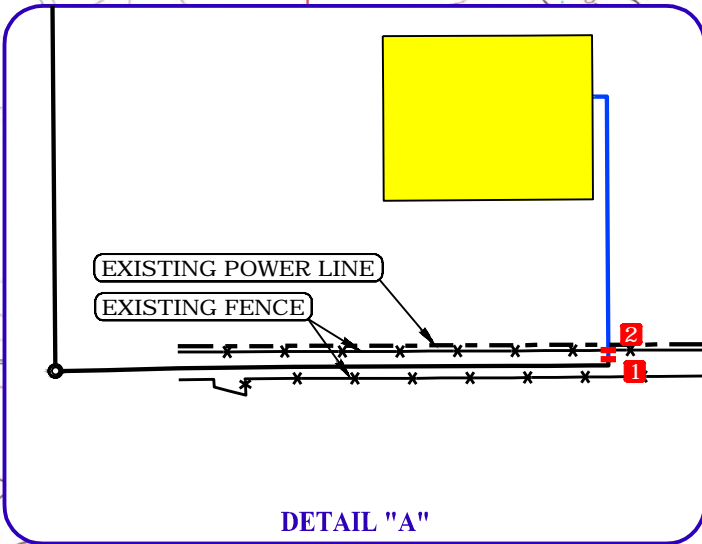

2.0 MI. +/-

CR 67

**PROPOSED LOCATION:
CRITTER CREEK 15 SWSW**

PROPOSED ACCESS 679' +/-

SEE DETAIL "A"

0.3 MI. +/-

CR 128

T11N

LEGEND:

- 1** 18" CULVERT REQUIRED
- 2** INSTALL CATTLE GUARD

NOTE: PARCEL DATA SHOWN HAS BEEN OBTAINED FROM VARIOUS SOURCES AND SHOULD BE USED FOR MAPPING, GRAPHIC AND PLANNING PURPOSES ONLY. NO WARRANTY IS MADE BY UINTAH ENGINEERING AND LAND SURVEYING (UELS) FOR ACCURACY OF THE PARCEL DATA.

LEGEND:

- EXISTING ROAD
- PROPOSED ROAD
- EXISTING POWER LINE
- EXISTING FENCE

EOG RESOURCES, INC.

CRITTER CREEK 15 SWSW
SECTION 15, T11N, R63W, 6th P.M.
SW 1/4 SW 1/4
WELD COUNTY, COLORADO



UELS, LLC
Corporate Office * 85 South 200 East
Vernal, UT 84078 * (435) 789-1017

DRAWN BY: J.D.J.	DATE DRAWN: 04-08-15
SCALE: 1" = 2000'	REVISED: 00-00-00
ACCESS ROAD MAP	TOPO B