

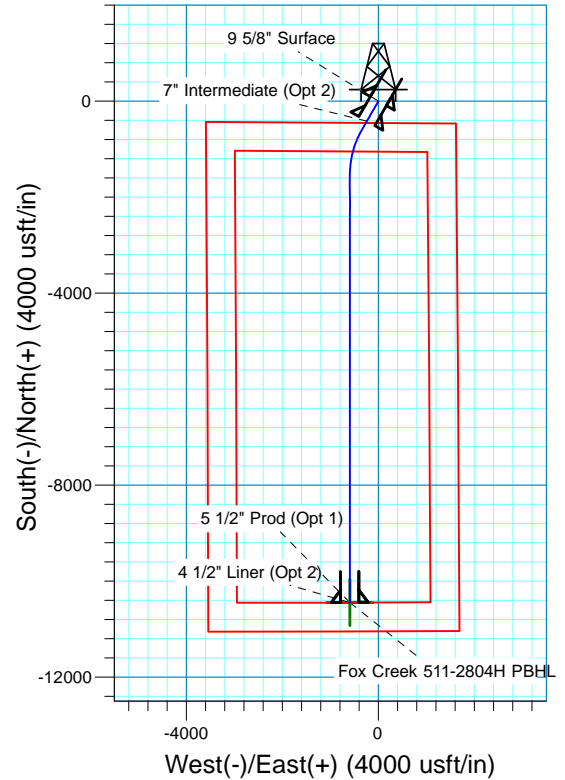

Fox Creek 511-2804H
Section 28-T12N-R63W
Weld County, CO

Surface Location

NAD 1927 (NADCON CONUS) Colorado North 501
Ground Elevation: 5471.0 RKB @ 5496.0usft (KB GL+25')
Northing Easting Latitude Longitude
599589.28 2294353.22 40° 58' 27.853 N 104° 26' 2.712 W

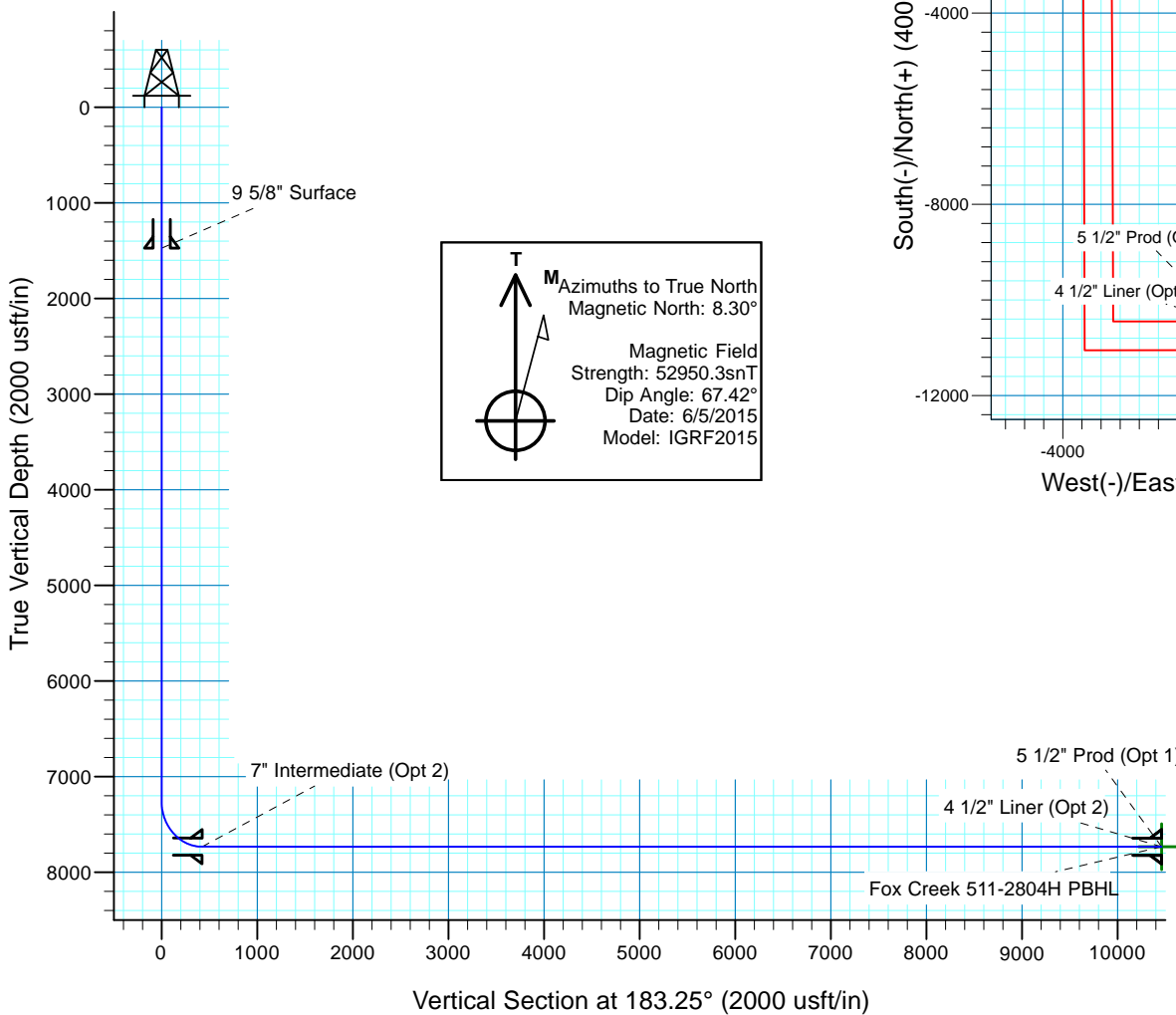

Project: DJ - Hereford Ranch
Site: Fox Creek F28 SWSE
Well: Fox Creek 511-2804H
Plan: APD Plan (Plat Cert 4/28/15)

SECTION DETAILS

Sec	MD	Inc	Azi	TVD	+N/-S	+E/-W	Dleg	TFace	VSect	Target
1	0.0	0.00	0.00	7257.5	0.0	0.0	0.00	0.00	0.0	
2	7257.5	0.00	0.00	7257.5	0.0	0.0	0.00	0.00	0.0	
3	8007.5	90.00	210.00	7735.0	-413.5	-238.7	12.00	210.00	426.4	
4	8206.5	90.00	210.00	7735.0	-585.8	-338.2	0.00	0.00	604.1	
5	9206.6	90.00	180.00	7735.0	-1540.9	-594.1	3.00	-90.00	1572.1	Fox Creek 511-2804H PBHL
6	18109.7	90.00	180.00	7735.0	-10443.9	-593.5	0.00	0.00	10460.8	Fox Creek 511-2804H PBHL

TARGET DETAILS

Name	TVD	+N/-S	+E/-W	Northing	Easting	Latitude	Longitude	Shape
Fox Creek 511-2804H PBHL	7735.0	-10443.9	-593.5	589138.98	2293885.33	40° 56' 44.662 N	104° 26' 10.445 W	Point

Denver Division- Colorado

**DJ - Hereford Ranch
Fox Creek F28 SWSE
Fox Creek 511-2804H**

OH

Plan: APD Plan (Plat Cert 4/28/15)

Standard Planning Report

05 June, 2015

EOG Resources, Inc.

Planning Report

Database:	EDM_DENVER	Local Co-ordinate Reference:	Well Fox Creek 511-2804H
Company:	Denver Division- Colorado	TVD Reference:	RKB @ 5496.0usft (KB GL+25')
Project:	DJ - Hereford Ranch	MD Reference:	RKB @ 5496.0usft (KB GL+25')
Site:	Fox Creek F28 SWSE	North Reference:	True
Well:	Fox Creek 511-2804H	Survey Calculation Method:	Minimum Curvature
Wellbore:	OH		
Design:	APD Plan (Plat Cert 4/28/15)		

Project	DJ - Hereford Ranch, Weld County		
Map System:	US State Plane 1927 (Exact solution)	System Datum:	Mean Sea Level
Geo Datum:	NAD 1927 (NADCON CONUS)		
Map Zone:	Colorado North 501		

Site	Fox Creek F28 SWSE		
Site Position:		Northing:	599,550.00 usft
From:	Map	Easting:	2,294,400.00 usft
Position Uncertainty:	0.0 usft	Slot Radius:	13-3/16 "
		Latitude:	40° 58' 27.460 N
		Longitude:	104° 26' 2.108 W
		Grid Convergence:	0.69 °

Well	Fox Creek 511-2804H		
Well Position	+N/-S	39.8 usft	Northing:
	+E/-W	-46.3 usft	Easting:
Position Uncertainty	0.0 usft	Wellhead Elevation:	0.0 usft
		Latitude:	40° 58' 27.853 N
		Longitude:	104° 26' 2.712 W
		Ground Level:	5,471.0 usft

Wellbore	OH		
Magnetics	Model Name	Sample Date	Declination
			(°)
	IGRF2015	6/5/2015	8.30
			Dip Angle
			(°)
			67.42
			Field Strength
			(nT)
			52,950

Design	APD Plan (Plat Cert 4/28/15)		
Audit Notes:			
Version:	Phase:	PROTOTYPE	Tie On Depth:
			0.0
Vertical Section:	Depth From (TVD)	+N/-S	+E/-W
	(usft)	(usft)	(usft)
	0.0	0.0	0.0
			Direction
			(°)
			183.25

Plan Sections										
Measured	Inclination	Azimuth	Vertical	+N/-S	+E/-W	Dogleg	Build	Turn	TFO	Target
Depth	(°)	(°)	Depth	(usft)	(usft)	Rate	Rate	Rate	(°)	
(usft)			(usft)			(°/100usft)	(°/100usft)	(°/100usft)		
0.0	0.00	0.00	0.0	0.0	0.0	0.00	0.00	0.00	0.00	
7,257.5	0.00	0.00	7,257.5	0.0	0.0	0.00	0.00	0.00	0.00	
8,007.5	90.00	210.00	7,735.0	-413.5	-238.7	12.00	12.00	0.00	210.00	
8,206.5	90.00	210.00	7,735.0	-585.8	-338.2	0.00	0.00	0.00	0.00	
9,206.6	90.00	180.00	7,735.0	-1,540.9	-594.1	3.00	0.00	-3.00	-90.00	Fox Creek 511-2804H
18,109.7	90.00	180.00	7,735.0	-10,443.9	-593.5	0.00	0.00	0.00	0.00	Fox Creek 511-2804H

EOG Resources, Inc.

Planning Report

Database:	EDM_DENVER	Local Co-ordinate Reference:	Well Fox Creek 511-2804H
Company:	Denver Division- Colorado	TVD Reference:	RKB @ 5496.0usft (KB GL+25')
Project:	DJ - Hereford Ranch	MD Reference:	RKB @ 5496.0usft (KB GL+25')
Site:	Fox Creek F28 SWSE	North Reference:	True
Well:	Fox Creek 511-2804H	Survey Calculation Method:	Minimum Curvature
Wellbore:	OH		
Design:	APD Plan (Plat Cert 4/28/15)		

Planned Survey									
Measured Depth (usft)	Inclination (°)	Azimuth (°)	Vertical Depth (usft)	+N/-S (usft)	+E/-W (usft)	Vertical Section (usft)	Dogleg Rate (°/100usft)	Build Rate (°/100usft)	Turn Rate (°/100usft)
0.0	0.00	0.00	0.0	0.0	0.0	0.0	0.00	0.00	0.00
100.0	0.00	0.00	100.0	0.0	0.0	0.0	0.00	0.00	0.00
200.0	0.00	0.00	200.0	0.0	0.0	0.0	0.00	0.00	0.00
300.0	0.00	0.00	300.0	0.0	0.0	0.0	0.00	0.00	0.00
400.0	0.00	0.00	400.0	0.0	0.0	0.0	0.00	0.00	0.00
500.0	0.00	0.00	500.0	0.0	0.0	0.0	0.00	0.00	0.00
600.0	0.00	0.00	600.0	0.0	0.0	0.0	0.00	0.00	0.00
700.0	0.00	0.00	700.0	0.0	0.0	0.0	0.00	0.00	0.00
800.0	0.00	0.00	800.0	0.0	0.0	0.0	0.00	0.00	0.00
900.0	0.00	0.00	900.0	0.0	0.0	0.0	0.00	0.00	0.00
1,000.0	0.00	0.00	1,000.0	0.0	0.0	0.0	0.00	0.00	0.00
1,100.0	0.00	0.00	1,100.0	0.0	0.0	0.0	0.00	0.00	0.00
1,200.0	0.00	0.00	1,200.0	0.0	0.0	0.0	0.00	0.00	0.00
1,300.0	0.00	0.00	1,300.0	0.0	0.0	0.0	0.00	0.00	0.00
1,400.0	0.00	0.00	1,400.0	0.0	0.0	0.0	0.00	0.00	0.00
1,475.0	0.00	0.00	1,475.0	0.0	0.0	0.0	0.00	0.00	0.00
9 5/8" Surface									
1,500.0	0.00	0.00	1,500.0	0.0	0.0	0.0	0.00	0.00	0.00
1,600.0	0.00	0.00	1,600.0	0.0	0.0	0.0	0.00	0.00	0.00
1,700.0	0.00	0.00	1,700.0	0.0	0.0	0.0	0.00	0.00	0.00
1,800.0	0.00	0.00	1,800.0	0.0	0.0	0.0	0.00	0.00	0.00
1,900.0	0.00	0.00	1,900.0	0.0	0.0	0.0	0.00	0.00	0.00
2,000.0	0.00	0.00	2,000.0	0.0	0.0	0.0	0.00	0.00	0.00
2,100.0	0.00	0.00	2,100.0	0.0	0.0	0.0	0.00	0.00	0.00
2,200.0	0.00	0.00	2,200.0	0.0	0.0	0.0	0.00	0.00	0.00
2,300.0	0.00	0.00	2,300.0	0.0	0.0	0.0	0.00	0.00	0.00
2,400.0	0.00	0.00	2,400.0	0.0	0.0	0.0	0.00	0.00	0.00
2,500.0	0.00	0.00	2,500.0	0.0	0.0	0.0	0.00	0.00	0.00
2,600.0	0.00	0.00	2,600.0	0.0	0.0	0.0	0.00	0.00	0.00
2,700.0	0.00	0.00	2,700.0	0.0	0.0	0.0	0.00	0.00	0.00
2,800.0	0.00	0.00	2,800.0	0.0	0.0	0.0	0.00	0.00	0.00
2,900.0	0.00	0.00	2,900.0	0.0	0.0	0.0	0.00	0.00	0.00
3,000.0	0.00	0.00	3,000.0	0.0	0.0	0.0	0.00	0.00	0.00
3,100.0	0.00	0.00	3,100.0	0.0	0.0	0.0	0.00	0.00	0.00
3,200.0	0.00	0.00	3,200.0	0.0	0.0	0.0	0.00	0.00	0.00
3,300.0	0.00	0.00	3,300.0	0.0	0.0	0.0	0.00	0.00	0.00
3,400.0	0.00	0.00	3,400.0	0.0	0.0	0.0	0.00	0.00	0.00
3,500.0	0.00	0.00	3,500.0	0.0	0.0	0.0	0.00	0.00	0.00
3,600.0	0.00	0.00	3,600.0	0.0	0.0	0.0	0.00	0.00	0.00
3,700.0	0.00	0.00	3,700.0	0.0	0.0	0.0	0.00	0.00	0.00
3,800.0	0.00	0.00	3,800.0	0.0	0.0	0.0	0.00	0.00	0.00
3,900.0	0.00	0.00	3,900.0	0.0	0.0	0.0	0.00	0.00	0.00
4,000.0	0.00	0.00	4,000.0	0.0	0.0	0.0	0.00	0.00	0.00
4,100.0	0.00	0.00	4,100.0	0.0	0.0	0.0	0.00	0.00	0.00
4,200.0	0.00	0.00	4,200.0	0.0	0.0	0.0	0.00	0.00	0.00
4,300.0	0.00	0.00	4,300.0	0.0	0.0	0.0	0.00	0.00	0.00
4,400.0	0.00	0.00	4,400.0	0.0	0.0	0.0	0.00	0.00	0.00
4,500.0	0.00	0.00	4,500.0	0.0	0.0	0.0	0.00	0.00	0.00
4,600.0	0.00	0.00	4,600.0	0.0	0.0	0.0	0.00	0.00	0.00
4,700.0	0.00	0.00	4,700.0	0.0	0.0	0.0	0.00	0.00	0.00
4,800.0	0.00	0.00	4,800.0	0.0	0.0	0.0	0.00	0.00	0.00
4,900.0	0.00	0.00	4,900.0	0.0	0.0	0.0	0.00	0.00	0.00
5,000.0	0.00	0.00	5,000.0	0.0	0.0	0.0	0.00	0.00	0.00
5,100.0	0.00	0.00	5,100.0	0.0	0.0	0.0	0.00	0.00	0.00

EOG Resources, Inc.

Planning Report

Database:	EDM_DENVER	Local Co-ordinate Reference:	Well Fox Creek 511-2804H
Company:	Denver Division- Colorado	TVD Reference:	RKB @ 5496.0usft (KB GL+25')
Project:	DJ - Hereford Ranch	MD Reference:	RKB @ 5496.0usft (KB GL+25')
Site:	Fox Creek F28 SWSE	North Reference:	True
Well:	Fox Creek 511-2804H	Survey Calculation Method:	Minimum Curvature
Wellbore:	OH		
Design:	APD Plan (Plat Cert 4/28/15)		

Planned Survey									
Measured Depth (usft)	Inclination (°)	Azimuth (°)	Vertical Depth (usft)	+N/-S (usft)	+E/-W (usft)	Vertical Section (usft)	Dogleg Rate (°/100usft)	Build Rate (°/100usft)	Turn Rate (°/100usft)
5,200.0	0.00	0.00	5,200.0	0.0	0.0	0.0	0.00	0.00	0.00
5,300.0	0.00	0.00	5,300.0	0.0	0.0	0.0	0.00	0.00	0.00
5,400.0	0.00	0.00	5,400.0	0.0	0.0	0.0	0.00	0.00	0.00
5,500.0	0.00	0.00	5,500.0	0.0	0.0	0.0	0.00	0.00	0.00
5,600.0	0.00	0.00	5,600.0	0.0	0.0	0.0	0.00	0.00	0.00
5,700.0	0.00	0.00	5,700.0	0.0	0.0	0.0	0.00	0.00	0.00
5,800.0	0.00	0.00	5,800.0	0.0	0.0	0.0	0.00	0.00	0.00
5,900.0	0.00	0.00	5,900.0	0.0	0.0	0.0	0.00	0.00	0.00
6,000.0	0.00	0.00	6,000.0	0.0	0.0	0.0	0.00	0.00	0.00
6,100.0	0.00	0.00	6,100.0	0.0	0.0	0.0	0.00	0.00	0.00
6,200.0	0.00	0.00	6,200.0	0.0	0.0	0.0	0.00	0.00	0.00
6,300.0	0.00	0.00	6,300.0	0.0	0.0	0.0	0.00	0.00	0.00
6,400.0	0.00	0.00	6,400.0	0.0	0.0	0.0	0.00	0.00	0.00
6,500.0	0.00	0.00	6,500.0	0.0	0.0	0.0	0.00	0.00	0.00
6,600.0	0.00	0.00	6,600.0	0.0	0.0	0.0	0.00	0.00	0.00
6,700.0	0.00	0.00	6,700.0	0.0	0.0	0.0	0.00	0.00	0.00
6,800.0	0.00	0.00	6,800.0	0.0	0.0	0.0	0.00	0.00	0.00
6,900.0	0.00	0.00	6,900.0	0.0	0.0	0.0	0.00	0.00	0.00
7,000.0	0.00	0.00	7,000.0	0.0	0.0	0.0	0.00	0.00	0.00
7,100.0	0.00	0.00	7,100.0	0.0	0.0	0.0	0.00	0.00	0.00
7,200.0	0.00	0.00	7,200.0	0.0	0.0	0.0	0.00	0.00	0.00
7,257.5	0.00	0.00	7,257.5	0.0	0.0	0.0	0.00	0.00	0.00
7,300.0	5.10	210.00	7,299.9	-1.6	-0.9	1.7	12.00	12.00	0.00
7,400.0	17.10	210.00	7,397.9	-18.3	-10.6	18.8	12.00	12.00	0.00
7,500.0	29.10	210.00	7,489.7	-52.2	-30.1	53.8	12.00	12.00	0.00
7,600.0	41.10	210.00	7,571.4	-101.9	-58.8	105.1	12.00	12.00	0.00
7,700.0	53.10	210.00	7,639.3	-165.2	-95.4	170.4	12.00	12.00	0.00
7,800.0	65.10	210.00	7,690.6	-239.4	-138.2	246.9	12.00	12.00	0.00
7,900.0	77.10	210.00	7,722.9	-321.2	-185.4	331.2	12.00	12.00	0.00
8,000.0	89.10	210.00	7,734.9	-407.0	-235.0	419.7	12.00	12.00	0.00
8,007.0	89.94	210.00	7,735.0	-413.1	-238.5	425.9	12.00	12.00	0.00
7" Intermediate (Opt 2)									
8,007.5	90.00	210.00	7,735.0	-413.5	-238.7	426.4	12.00	12.00	0.00
8,100.0	90.00	210.00	7,735.0	-493.6	-285.0	509.0	0.00	0.00	0.00
8,200.0	90.00	210.00	7,735.0	-580.2	-335.0	598.3	0.00	0.00	0.00
8,206.5	90.00	210.00	7,735.0	-585.8	-338.2	604.1	0.00	0.00	0.00
8,300.0	90.00	207.20	7,735.0	-667.9	-383.0	688.6	3.00	0.00	-3.00
8,400.0	90.00	204.20	7,735.0	-758.0	-426.3	781.0	3.00	0.00	-3.00
8,500.0	90.00	201.20	7,735.0	-850.3	-464.9	875.3	3.00	0.00	-3.00
8,600.0	90.00	198.20	7,735.0	-944.4	-498.6	971.2	3.00	0.00	-3.00
8,700.0	90.00	195.20	7,735.0	-1,040.2	-527.3	1,068.4	3.00	0.00	-3.00
8,800.0	90.00	192.20	7,735.0	-1,137.3	-551.0	1,166.8	3.00	0.00	-3.00
8,900.0	90.00	189.20	7,735.0	-1,235.6	-569.6	1,265.9	3.00	0.00	-3.00
9,000.0	90.00	186.20	7,735.0	-1,334.7	-583.0	1,365.6	3.00	0.00	-3.00
9,100.0	90.00	183.20	7,735.0	-1,434.3	-591.1	1,465.5	3.00	0.00	-3.00
9,200.0	90.00	180.20	7,735.0	-1,534.3	-594.1	1,565.5	3.00	0.00	-3.00
9,206.6	90.00	180.00	7,735.0	-1,540.9	-594.1	1,572.1	3.00	0.00	-3.00
9,300.0	90.00	180.00	7,735.0	-1,634.3	-594.1	1,665.3	0.00	0.00	0.00
9,400.0	90.00	180.00	7,735.0	-1,734.3	-594.1	1,765.2	0.00	0.00	0.00
9,500.0	90.00	180.00	7,735.0	-1,834.3	-594.1	1,865.0	0.00	0.00	0.00
9,600.0	90.00	180.00	7,735.0	-1,934.3	-594.1	1,964.9	0.00	0.00	0.00
9,700.0	90.00	180.00	7,735.0	-2,034.3	-594.1	2,064.7	0.00	0.00	0.00
9,800.0	90.00	180.00	7,735.0	-2,134.3	-594.1	2,164.5	0.00	0.00	0.00

EOG Resources, Inc.

Planning Report

Database:	EDM_DENVER	Local Co-ordinate Reference:	Well Fox Creek 511-2804H
Company:	Denver Division- Colorado	TVD Reference:	RKB @ 5496.0usft (KB GL+25')
Project:	DJ - Hereford Ranch	MD Reference:	RKB @ 5496.0usft (KB GL+25')
Site:	Fox Creek F28 SWSE	North Reference:	True
Well:	Fox Creek 511-2804H	Survey Calculation Method:	Minimum Curvature
Wellbore:	OH		
Design:	APD Plan (Plat Cert 4/28/15)		

Planned Survey									
Measured Depth (usft)	Inclination (°)	Azimuth (°)	Vertical Depth (usft)	+N/-S (usft)	+E/-W (usft)	Vertical Section (usft)	Dogleg Rate (°/100usft)	Build Rate (°/100usft)	Turn Rate (°/100usft)
9,900.0	90.00	180.00	7,735.0	-2,234.3	-594.1	2,264.4	0.00	0.00	0.00
10,000.0	90.00	180.00	7,735.0	-2,334.3	-594.0	2,364.2	0.00	0.00	0.00
10,100.0	90.00	180.00	7,735.0	-2,434.3	-594.0	2,464.0	0.00	0.00	0.00
10,200.0	90.00	180.00	7,735.0	-2,534.3	-594.0	2,563.9	0.00	0.00	0.00
10,300.0	90.00	180.00	7,735.0	-2,634.3	-594.0	2,663.7	0.00	0.00	0.00
10,400.0	90.00	180.00	7,735.0	-2,734.3	-594.0	2,763.6	0.00	0.00	0.00
10,500.0	90.00	180.00	7,735.0	-2,834.3	-594.0	2,863.4	0.00	0.00	0.00
10,600.0	90.00	180.00	7,735.0	-2,934.3	-594.0	2,963.2	0.00	0.00	0.00
10,700.0	90.00	180.00	7,735.0	-3,034.3	-594.0	3,063.1	0.00	0.00	0.00
10,800.0	90.00	180.00	7,735.0	-3,134.3	-594.0	3,162.9	0.00	0.00	0.00
10,900.0	90.00	180.00	7,735.0	-3,234.3	-594.0	3,262.8	0.00	0.00	0.00
11,000.0	90.00	180.00	7,735.0	-3,334.3	-594.0	3,362.6	0.00	0.00	0.00
11,100.0	90.00	180.00	7,735.0	-3,434.3	-594.0	3,462.4	0.00	0.00	0.00
11,200.0	90.00	180.00	7,735.0	-3,534.3	-594.0	3,562.3	0.00	0.00	0.00
11,300.0	90.00	180.00	7,735.0	-3,634.3	-594.0	3,662.1	0.00	0.00	0.00
11,400.0	90.00	180.00	7,735.0	-3,734.3	-593.9	3,761.9	0.00	0.00	0.00
11,500.0	90.00	180.00	7,735.0	-3,834.3	-593.9	3,861.8	0.00	0.00	0.00
11,600.0	90.00	180.00	7,735.0	-3,934.3	-593.9	3,961.6	0.00	0.00	0.00
11,700.0	90.00	180.00	7,735.0	-4,034.3	-593.9	4,061.5	0.00	0.00	0.00
11,800.0	90.00	180.00	7,735.0	-4,134.3	-593.9	4,161.3	0.00	0.00	0.00
11,900.0	90.00	180.00	7,735.0	-4,234.3	-593.9	4,261.1	0.00	0.00	0.00
12,000.0	90.00	180.00	7,735.0	-4,334.3	-593.9	4,361.0	0.00	0.00	0.00
12,100.0	90.00	180.00	7,735.0	-4,434.3	-593.9	4,460.8	0.00	0.00	0.00
12,200.0	90.00	180.00	7,735.0	-4,534.3	-593.9	4,560.7	0.00	0.00	0.00
12,300.0	90.00	180.00	7,735.0	-4,634.3	-593.9	4,660.5	0.00	0.00	0.00
12,400.0	90.00	180.00	7,735.0	-4,734.3	-593.9	4,760.3	0.00	0.00	0.00
12,500.0	90.00	180.00	7,735.0	-4,834.3	-593.9	4,860.2	0.00	0.00	0.00
12,600.0	90.00	180.00	7,735.0	-4,934.3	-593.9	4,960.0	0.00	0.00	0.00
12,700.0	90.00	180.00	7,735.0	-5,034.3	-593.9	5,059.8	0.00	0.00	0.00
12,800.0	90.00	180.00	7,735.0	-5,134.3	-593.8	5,159.7	0.00	0.00	0.00
12,900.0	90.00	180.00	7,735.0	-5,234.3	-593.8	5,259.5	0.00	0.00	0.00
13,000.0	90.00	180.00	7,735.0	-5,334.3	-593.8	5,359.4	0.00	0.00	0.00
13,100.0	90.00	180.00	7,735.0	-5,434.3	-593.8	5,459.2	0.00	0.00	0.00
13,200.0	90.00	180.00	7,735.0	-5,534.3	-593.8	5,559.0	0.00	0.00	0.00
13,300.0	90.00	180.00	7,735.0	-5,634.3	-593.8	5,658.9	0.00	0.00	0.00
13,400.0	90.00	180.00	7,735.0	-5,734.3	-593.8	5,758.7	0.00	0.00	0.00
13,500.0	90.00	180.00	7,735.0	-5,834.3	-593.8	5,858.6	0.00	0.00	0.00
13,600.0	90.00	180.00	7,735.0	-5,934.3	-593.8	5,958.4	0.00	0.00	0.00
13,700.0	90.00	180.00	7,735.0	-6,034.3	-593.8	6,058.2	0.00	0.00	0.00
13,800.0	90.00	180.00	7,735.0	-6,134.3	-593.8	6,158.1	0.00	0.00	0.00
13,900.0	90.00	180.00	7,735.0	-6,234.3	-593.8	6,257.9	0.00	0.00	0.00
14,000.0	90.00	180.00	7,735.0	-6,334.3	-593.8	6,357.7	0.00	0.00	0.00
14,100.0	90.00	180.00	7,735.0	-6,434.3	-593.8	6,457.6	0.00	0.00	0.00
14,200.0	90.00	180.00	7,735.0	-6,534.3	-593.7	6,557.4	0.00	0.00	0.00
14,300.0	90.00	180.00	7,735.0	-6,634.3	-593.7	6,657.3	0.00	0.00	0.00
14,400.0	90.00	180.00	7,735.0	-6,734.3	-593.7	6,757.1	0.00	0.00	0.00
14,500.0	90.00	180.00	7,735.0	-6,834.3	-593.7	6,856.9	0.00	0.00	0.00
14,600.0	90.00	180.00	7,735.0	-6,934.3	-593.7	6,956.8	0.00	0.00	0.00
14,700.0	90.00	180.00	7,735.0	-7,034.3	-593.7	7,056.6	0.00	0.00	0.00
14,800.0	90.00	180.00	7,735.0	-7,134.3	-593.7	7,156.5	0.00	0.00	0.00
14,900.0	90.00	180.00	7,735.0	-7,234.3	-593.7	7,256.3	0.00	0.00	0.00
15,000.0	90.00	180.00	7,735.0	-7,334.3	-593.7	7,356.1	0.00	0.00	0.00
15,100.0	90.00	180.00	7,735.0	-7,434.3	-593.7	7,456.0	0.00	0.00	0.00
15,200.0	90.00	180.00	7,735.0	-7,534.3	-593.7	7,555.8	0.00	0.00	0.00

EOG Resources, Inc.

Planning Report

Database:	EDM_DENVER	Local Co-ordinate Reference:	Well Fox Creek 511-2804H
Company:	Denver Division- Colorado	TVD Reference:	RKB @ 5496.0usft (KB GL+25')
Project:	DJ - Hereford Ranch	MD Reference:	RKB @ 5496.0usft (KB GL+25')
Site:	Fox Creek F28 SWSE	North Reference:	True
Well:	Fox Creek 511-2804H	Survey Calculation Method:	Minimum Curvature
Wellbore:	OH		
Design:	APD Plan (Plat Cert 4/28/15)		

Planned Survey										
Measured Depth (usft)	Inclination (°)	Azimuth (°)	Vertical Depth (usft)	+N/-S (usft)	+E/-W (usft)	Vertical Section (usft)	Dogleg Rate (°/100usft)	Build Rate (°/100usft)	Turn Rate (°/100usft)	
15,300.0	90.00	180.00	7,735.0	-7,634.3	-593.7	7,655.7	0.00	0.00	0.00	
15,400.0	90.00	180.00	7,735.0	-7,734.3	-593.7	7,755.5	0.00	0.00	0.00	
15,500.0	90.00	180.00	7,735.0	-7,834.3	-593.7	7,855.3	0.00	0.00	0.00	
15,600.0	90.00	180.00	7,735.0	-7,934.3	-593.6	7,955.2	0.00	0.00	0.00	
15,700.0	90.00	180.00	7,735.0	-8,034.3	-593.6	8,055.0	0.00	0.00	0.00	
15,800.0	90.00	180.00	7,735.0	-8,134.3	-593.6	8,154.8	0.00	0.00	0.00	
15,900.0	90.00	180.00	7,735.0	-8,234.3	-593.6	8,254.7	0.00	0.00	0.00	
16,000.0	90.00	180.00	7,735.0	-8,334.3	-593.6	8,354.5	0.00	0.00	0.00	
16,100.0	90.00	180.00	7,735.0	-8,434.3	-593.6	8,454.4	0.00	0.00	0.00	
16,200.0	90.00	180.00	7,735.0	-8,534.3	-593.6	8,554.2	0.00	0.00	0.00	
16,300.0	90.00	180.00	7,735.0	-8,634.3	-593.6	8,654.0	0.00	0.00	0.00	
16,400.0	90.00	180.00	7,735.0	-8,734.3	-593.6	8,753.9	0.00	0.00	0.00	
16,500.0	90.00	180.00	7,735.0	-8,834.3	-593.6	8,853.7	0.00	0.00	0.00	
16,600.0	90.00	180.00	7,735.0	-8,934.3	-593.6	8,953.6	0.00	0.00	0.00	
16,700.0	90.00	180.00	7,735.0	-9,034.3	-593.6	9,053.4	0.00	0.00	0.00	
16,800.0	90.00	180.00	7,735.0	-9,134.3	-593.6	9,153.2	0.00	0.00	0.00	
16,900.0	90.00	180.00	7,735.0	-9,234.3	-593.6	9,253.1	0.00	0.00	0.00	
17,000.0	90.00	180.00	7,735.0	-9,334.3	-593.5	9,352.9	0.00	0.00	0.00	
17,100.0	90.00	180.00	7,735.0	-9,434.3	-593.5	9,452.7	0.00	0.00	0.00	
17,200.0	90.00	180.00	7,735.0	-9,534.3	-593.5	9,552.6	0.00	0.00	0.00	
17,300.0	90.00	180.00	7,735.0	-9,634.3	-593.5	9,652.4	0.00	0.00	0.00	
17,400.0	90.00	180.00	7,735.0	-9,734.3	-593.5	9,752.3	0.00	0.00	0.00	
17,500.0	90.00	180.00	7,735.0	-9,834.3	-593.5	9,852.1	0.00	0.00	0.00	
17,600.0	90.00	180.00	7,735.0	-9,934.3	-593.5	9,951.9	0.00	0.00	0.00	
17,700.0	90.00	180.00	7,735.0	-10,034.3	-593.5	10,051.8	0.00	0.00	0.00	
17,800.0	90.00	180.00	7,735.0	-10,134.3	-593.5	10,151.6	0.00	0.00	0.00	
17,900.0	90.00	180.00	7,735.0	-10,234.3	-593.5	10,251.5	0.00	0.00	0.00	
18,000.0	90.00	180.00	7,735.0	-10,334.3	-593.5	10,351.3	0.00	0.00	0.00	
18,100.0	90.00	180.00	7,735.0	-10,434.3	-593.5	10,451.1	0.00	0.00	0.00	
18,109.0	90.00	180.00	7,735.0	-10,443.3	-593.5	10,460.1	0.00	0.00	0.00	
5 1/2" Prod (Opt 1) - 4 1/2" Liner (Opt 2)										
18,109.7	90.00	180.00	7,735.0	-10,443.9	-593.5	10,460.8	0.00	0.00	0.00	

Design Targets										
Target Name	Dip Angle (°)	Dip Dir. (°)	TVD (usft)	+N/-S (usft)	+E/-W (usft)	Northing (usft)	Easting (usft)	Latitude		Longitude
- hit/miss target										
- Shape										
Fox Creek 511-2804H P	0.00	0.00	7,735.0	-10,443.9	-593.5	589,138.98	2,293,885.33	40° 56' 44.662 N		104° 26' 10.445 W
- plan hits target center										
- Point										

Casing Points					
Measured Depth (usft)	Vertical Depth (usft)	Name	Casing Diameter (")	Hole Diameter (")	
1,475.0	1,475.0	9 5/8" Surface	9-5/8	13-1/2	
8,007.0	7,735.0	7" Intermediate (Opt 2)	7	8-3/4	
18,109.0	7,735.0	5 1/2" Prod (Opt 1)	5-1/2	7-7/8	
18,109.0	7,735.0	4 1/2" Liner (Opt 2)	4-1/2	6-1/8	

EOG Resources, Inc.

Planning Report

Database:	EDM_DENVER	Local Co-ordinate Reference:	Well Fox Creek 511-2804H
Company:	Denver Division- Colorado	TVD Reference:	RKB @ 5496.0usft (KB GL+25')
Project:	DJ - Hereford Ranch	MD Reference:	RKB @ 5496.0usft (KB GL+25')
Site:	Fox Creek F28 SWSE	North Reference:	True
Well:	Fox Creek 511-2804H	Survey Calculation Method:	Minimum Curvature
Wellbore:	OH		
Design:	APD Plan (Plat Cert 4/28/15)		