

PROCEED IN A WESTERLY DIRECTION FROM HEREFORD, COLORADO ALONG COUNTY ROAD 136 APPROXIMATELY 1.5 MILES TO THE JUNCTION OF COUNTY THIS ROAD AND COUNTY ROAD 77 TO THE SOUTH; TURN LEFT AND PROCEED IN A SOUTHERLY DIRECTION APPROXIMATELY 2.0 MILES TO THE JUNCTION OF THIS ROAD AND COUNTY ROAD 132 TO THE WEST; TURN RIGHT AND PROCEED IN A WESTERLY DIRECTION APPROXIMATELY 4.9 MILES TO THE JUNCTION OF THIS ROAD AND COUNTY ROAD 67 TO THE SOUTH; TURN LEFT AND PROCEED IN A SOUTHERLY DIRECTION APPROXIMATELY 2.0 MILES TO THE JUNCTION OF THIS ROAD AND COUNTY ROAD 128 TO THE WEST; TURN RIGHT AND PROCEED IN A WESTERLY DIRECTION APPROXIMATELY 0.3 MILES TO THE BEGINNING OF THE PROPOSED ACCESS ROAD FOR THE CRITTER CREEK 21 NWNE TO THE SOUTH; FOLLOW ROAD FLAGS IN A SOUTHERLY, THEN WESTERLY DIRECTION APPROXIMATELY 648' TO THE BEGINNING OF THE PROPOSED ACCESS TO THE EAST; FOLLOW ROAD FLAGS IN AN EASTERLY DIRECTION APPROXIMATELY 67' TO THE PROPOSED LOCATION.

TOTAL DISTANCE FROM HEREFORD, COLORADO TO THE PROPOSED LOCATION IS APPROXIMATELY 10.8 MILES.

EOG RESOURCES, INC.

CRITTER CREEK 21 NENE
SECTION 21, T11N, R63W, 6th P.M.
NE 1/4 NE 1/4
WELD COUNTY, COLORADO



UELS, LLC
Corporate Office * 85 South 200 East
Vernal, UT 84078 * (435) 789-1017

DRAWN BY: J.D.J.

DATE DRAWN: 04-02-15

REVISED: 00-00-00

ROAD DESCRIPTION

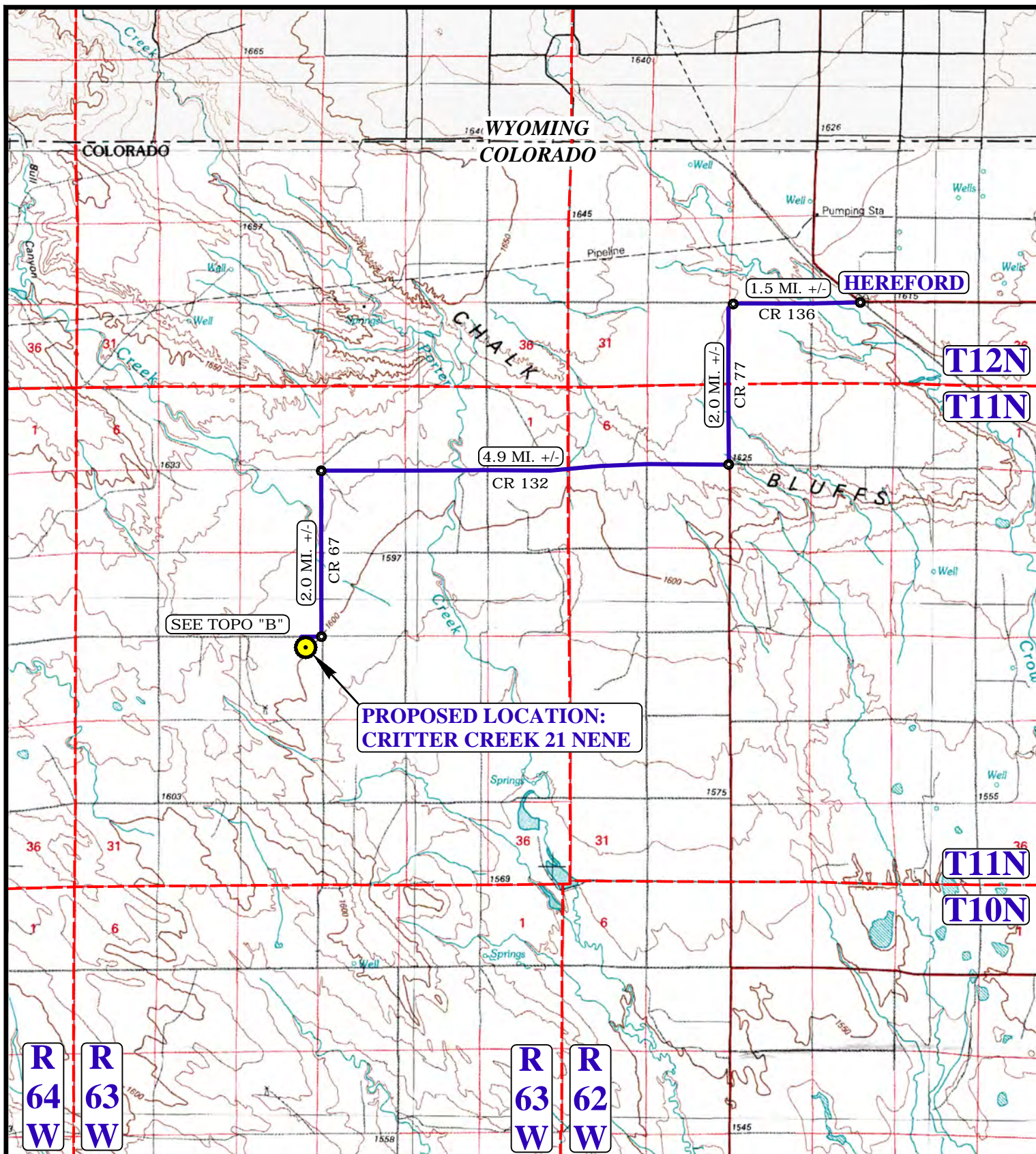

LEGEND:

 PROPOSED LOCATION

EOG RESOURCES, INC.

CRITTER CREEK 21 NENE
SECTION 21, T11N, R63W, 6th P.M.
NE 1/4 NE 1/4
WELD COUNTY, COLORADO



UELS, LLC
Corporate Office * 85 South 200 East
Vernal, UT 84078 * (435) 789-1017

| | |
|------------------------|----------------------|
| DRAWN BY: J.D.J. | DATE DRAWN: 04-02-15 |
| SCALE: 1:100,000 | REVISED: 00-00-00 |
| ACCESS ROAD MAP | TOPO A |

R
63
W

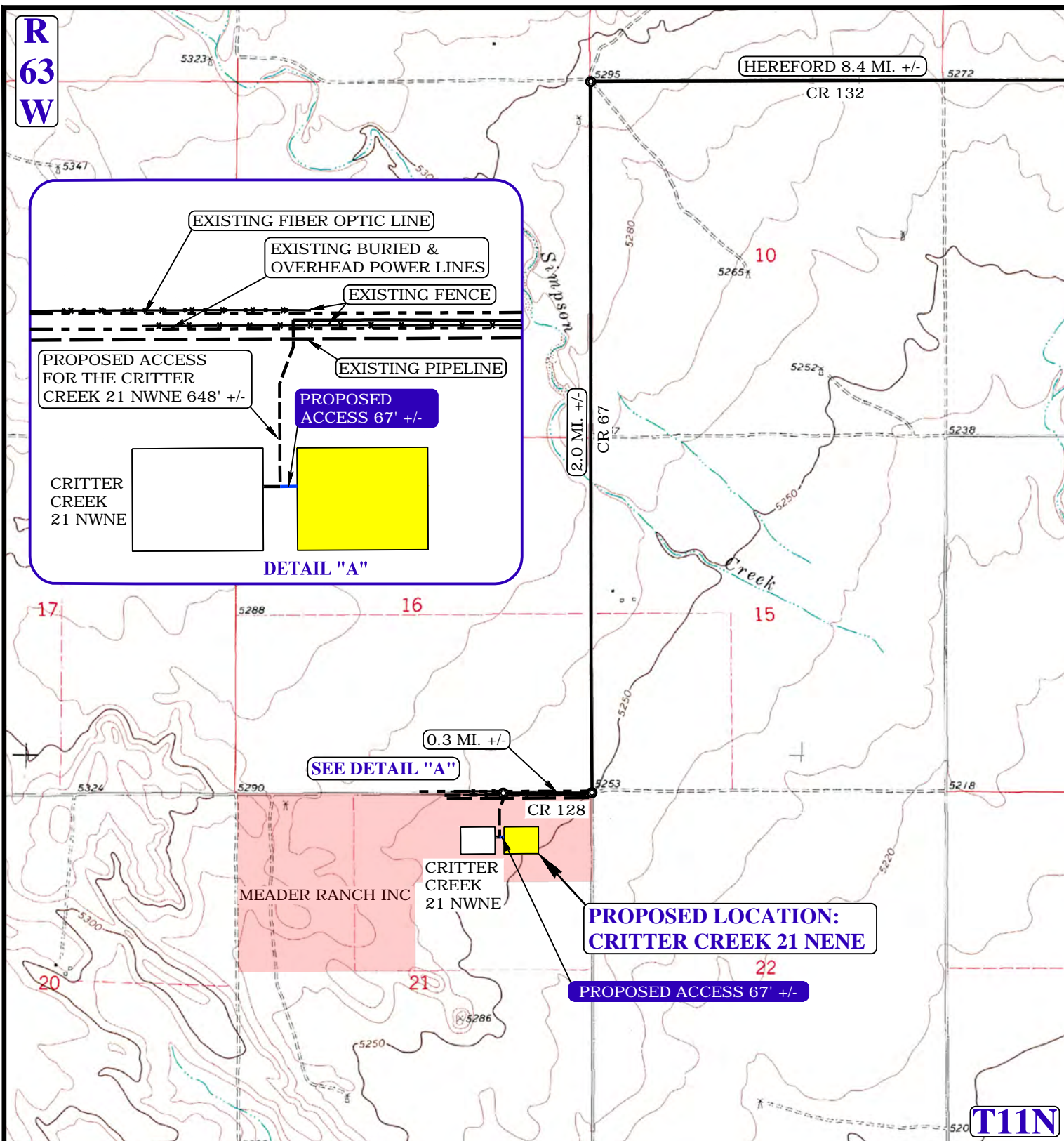

NOTE: PARCEL DATA SHOWN HAS BEEN OBTAINED FROM VARIOUS SOURCES AND SHOULD BE USED FOR MAPPING, GRAPHIC AND PLANNING PURPOSES ONLY. NO WARRANTY IS MADE BY UINTAH ENGINEERING AND LAND SURVEYING (UELS) FOR ACCURACY OF THE PARCEL DATA.

LEGEND:

- EXISTING ROAD
- PROPOSED ROAD
- EXISTING POWER LINE
- EXISTING PIPELINE
- EXISTING FENCE

EOG RESOURCES, INC.

CRITTER CREEK 21 NENE
SECTION 21, T11N, R63W, 6th P.M.
NE 1/4 NE 1/4
WELD COUNTY, COLORADO



UELS, LLC
Corporate Office * 85 South 200 East
Vernal, UT 84078 * (435) 789-1017



| | |
|-------------------|----------------------|
| DRAWN BY: J.D.J. | DATE DRAWN: 04-02-15 |
| SCALE: 1" = 2000' | REVISED: 00-00-00 |
| ACCESS ROAD MAP | TOPO B |