

# **EXTRACTION OIL & GAS**

**WELD COUNTY, COLORADO (NAD 83)**

**NW SW SEC. 5 T2N R68W 6th P.M.**

**FAIRVIEW 5**

**ORIGINAL WELLBORE**

**10 August, 2015**

**Plan: PROPOSAL #3**





Project: WELD COUNTY, COLORADO (NAD 83)  
Site: NW SW SEC. 5 T2N R68W 6th P.M.  
Well: FAIRVIEW 5  
Wellbore: ORIGINAL WELLBORE  
Design: PROPOSAL #3

ANNOTATIONS									
TVD	MD	Inc	Azi	+N/-S	+E/-W	VSect	Dep	Annotation	
1000.0	1000.0	0.00	0.00	0.0	0.0	0.0	0.0	START NUDDGE (2°/100ft BUR)	
1500.0	1502.6	10.05	204.94	-39.9	-18.5	-11.3	44.0	9 5/8" SURFACE CASING	
1564.0	1567.6	10.05	204.94	-50.2	-23.3	-14.2	55.3	END OF TANGENT	
1834.5	1845.1	15.60	204.94	-106.0	-49.3	-30.0	116.9	EOB TO 15.6° INC	
5738.5	5898.5	15.60	204.94	-1094.6	-508.9	-309.5	1207.1	END OF TANGENT	
6509.0	6678.6	0.00	0.00	-1190.3	-553.4	-336.6	1312.7	EOD TO VERTICAL	
6539.0	6708.6	0.00	0.00	-1190.3	-553.4	-336.6	1312.7	KOP (10°/100ft BUR)	
7112.0	7608.6	90.00	90.53	-1195.6	19.6	228.5	1885.6	LANDING PNT - FAIRVIEW 5 (P3)	
7112.0	14688.1	90.00	90.54	-1261.6	7098.7	7209.9	8965.1	BHL - FAIRVIEW 5 (P3)	

WELLBORE TARGET DETAILS (LAT/LONG)					
Name	TVD	+N/-S	+E/-W	Latitude	Longitude
KOP - FAIRVIEW 5 (P3)	6539.0	-1190.3	-553.4	40.162495	-105.037047
LANDING PNT - FAIRVIEW 5 (P3)	7112.0	-1195.6	19.6	40.162480	-105.034997
BHL - FAIRVIEW 5 (P3)	7112.0	-1261.6	7098.7	40.162296	-105.009669

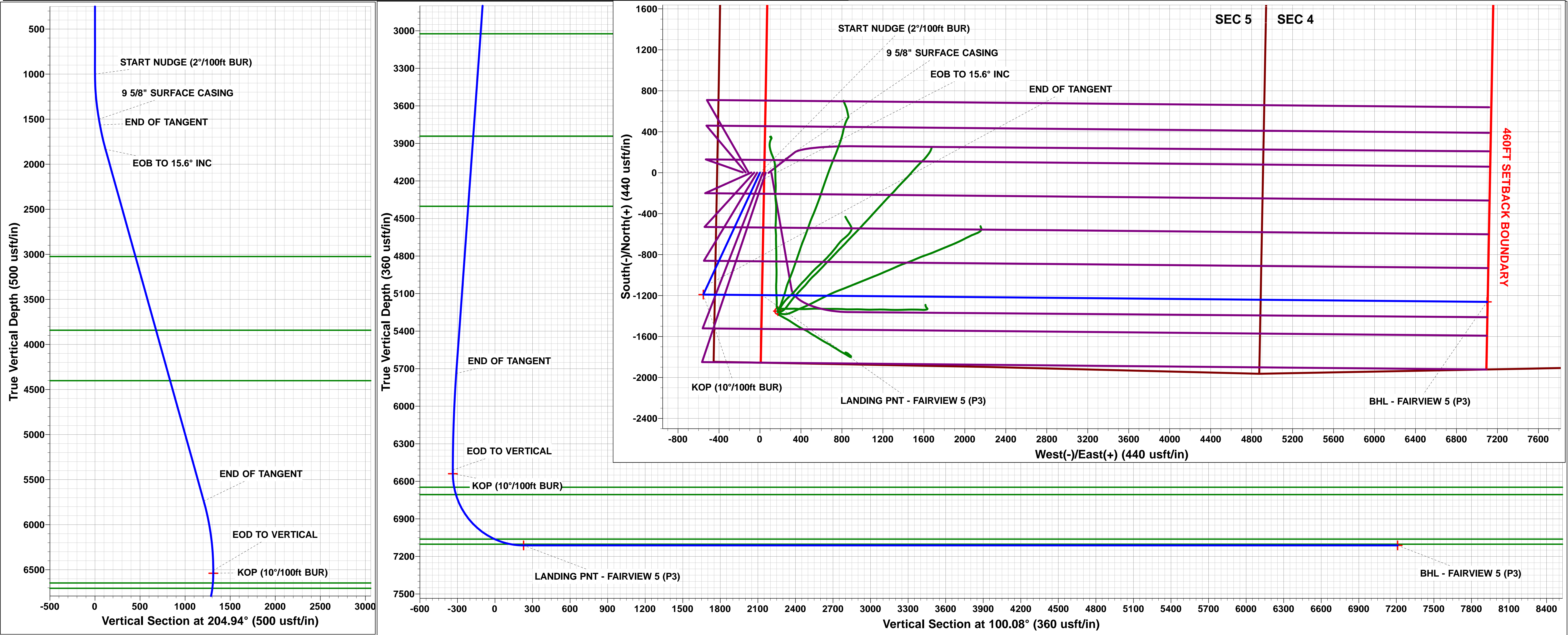
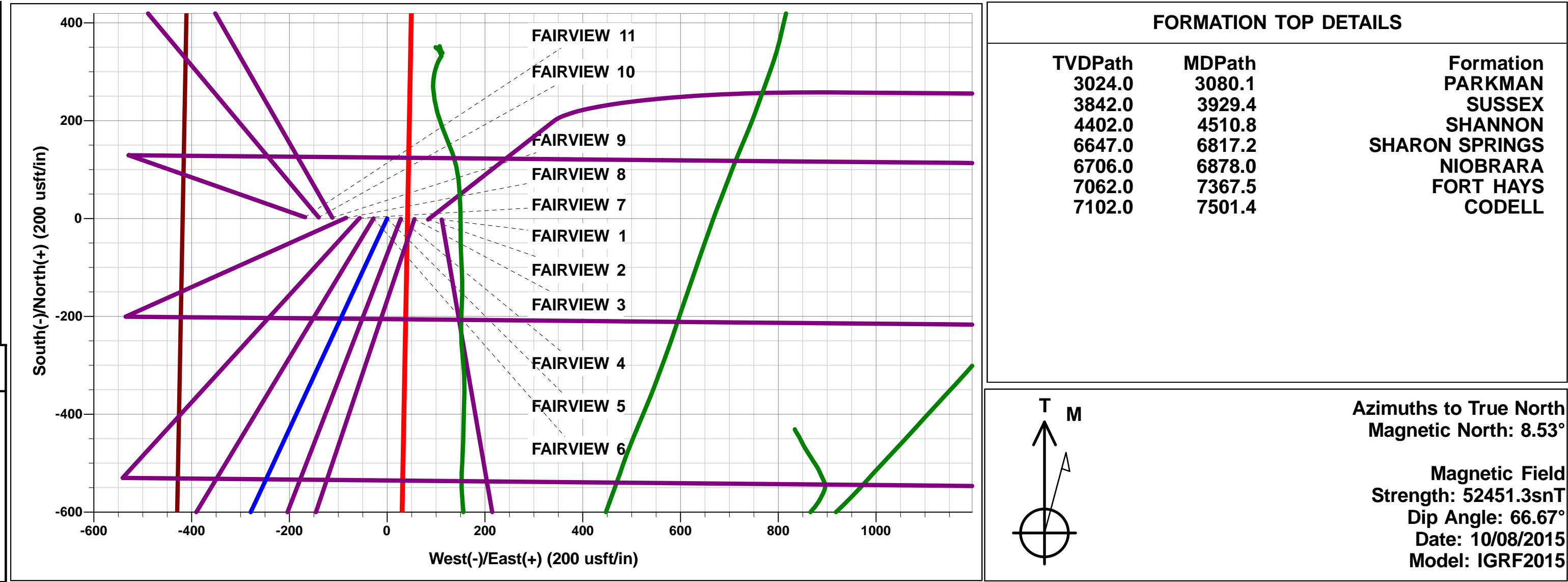

# Planning Report



<b>Database:</b>	EDM 5000.1 Single User Db	<b>Local Co-ordinate Reference:</b>	Well FAIRVIEW 5
<b>Company:</b>	EXTRACTION OIL & GAS	<b>TVD Reference:</b>	KB-EST @ 4960.0usft
<b>Project:</b>	WELD COUNTY, COLORADO (NAD 83)	<b>MD Reference:</b>	KB-EST @ 4960.0usft
<b>Site:</b>	NW SW SEC. 5 T2N R68W 6th P.M.	<b>North Reference:</b>	True
<b>Well:</b>	FAIRVIEW 5	<b>Survey Calculation Method:</b>	Minimum Curvature
<b>Wellbore:</b>	ORIGINAL WELLBORE		
<b>Design:</b>	PROPOSAL #3		

<b>Project</b>	WELD COUNTY, COLORADO (NAD 83)		
<b>Map System:</b>	US State Plane 1983	<b>System Datum:</b>	Mean Sea Level
<b>Geo Datum:</b>	North American Datum 1983		
<b>Map Zone:</b>	Colorado Northern Zone		Using geodetic scale factor

<b>Site</b>	NW SW SEC. 5 T2N R68W 6th P.M.		
<b>Site Position:</b>		<b>Northing:</b>	1,303,569.20 usft
<b>From:</b>	Lat/Long	<b>Easting:</b>	3,130,047.26 usft
<b>Position Uncertainty:</b>	0.0 usft	<b>Slot Radius:</b>	1.10000 ft
		<b>Latitude:</b>	40.165756
		<b>Longitude:</b>	-105.034667
		<b>Grid Convergence:</b>	0.30 °

<b>Well</b>	FAIRVIEW 5		
<b>Well Position</b>	<b>+N/-S</b>	2.2 usft	<b>Northing:</b>
	<b>+E/-W</b>	-111.8 usft	<b>Easting:</b>
<b>Position Uncertainty</b>	0.0 usft	<b>Wellhead Elevation:</b>	usft
		<b>Latitude:</b>	40.165762
		<b>Longitude:</b>	-105.035067
		<b>Ground Level:</b>	4,944.0 usft

<b>Wellbore</b>	ORIGINAL WELLBORE				
<b>Magnetics</b>	<b>Model Name</b>	<b>Sample Date</b>	<b>Declination (°)</b>	<b>Dip Angle (°)</b>	<b>Field Strength (nT)</b>
	IGRF2015	10/08/2015	8.53	66.67	52,451

<b>Design</b>	PROPOSAL #3			
<b>Audit Notes:</b>				
<b>Version:</b>	<b>Phase:</b>	PROTOTYPE	<b>Tie On Depth:</b>	0.0
<b>Vertical Section:</b>	<b>Depth From (TVD) (usft)</b>	<b>+N/-S (usft)</b>	<b>+E/-W (usft)</b>	<b>Direction (°)</b>
	7,112.0	0.0	0.0	100.08

<b>Plan Sections</b>											
MD (usft)	Inc (°)	Azi (°)	Vertical Depth	SS (usft)	+N/-S (usft)	+E/-W (usft)	Dogleg Rate (°/100usf)	Build Rate (°/100usf)	Turn Rate (°/100usf)	TFO (°)	Target
0.0	0.00	0.00	0.0	-4,960.0	0.0	0.0	0.00	0.00	0.00	0.00	
1,000.0	0.00	0.00	1,000.0	-3,960.0	0.0	0.0	0.00	0.00	0.00	0.00	
1,502.6	10.05	204.94	1,500.0	-3,460.0	-39.9	-18.5	2.00	2.00	0.00	204.94	
1,567.6	10.05	204.94	1,564.0	-3,396.0	-50.2	-23.3	0.00	0.00	0.00	0.00	
1,845.1	15.60	204.94	1,834.5	-3,125.5	-106.0	-49.3	2.00	2.00	0.00	0.00	
5,898.5	15.60	204.94	5,738.5	778.5	-1,094.6	-508.9	0.00	0.00	0.00	0.00	
6,678.6	0.00	0.00	6,509.0	1,549.0	-1,190.3	-553.4	2.00	-2.00	0.00	180.00	
6,708.6	0.00	0.00	6,539.0	1,579.0	-1,190.3	-553.4	0.00	0.00	0.00	0.00	KOP - FAIRVIEW 5
7,608.6	90.00	90.53	7,112.0	2,152.0	-1,195.6	19.6	10.00	10.00	10.06	90.53	LANDING PNT - FAIRVIEW 5
14,688.1	90.00	90.54	7,112.0	2,152.0	-1,261.6	7,098.7	0.00	0.00	0.00	80.91	BHL - FAIRVIEW 5

## Planning Report



<b>Database:</b>	EDM 5000.1 Single User Db	<b>Local Co-ordinate Reference:</b>	Well FAIRVIEW 5
<b>Company:</b>	EXTRACTION OIL & GAS	<b>TVD Reference:</b>	KB-EST @ 4960.0usft
<b>Project:</b>	WELD COUNTY, COLORADO (NAD 83)	<b>MD Reference:</b>	KB-EST @ 4960.0usft
<b>Site:</b>	NW SW SEC. 5 T2N R68W 6th P.M.	<b>North Reference:</b>	True
<b>Well:</b>	FAIRVIEW 5	<b>Survey Calculation Method:</b>	Minimum Curvature
<b>Wellbore:</b>	ORIGINAL WELLBORE		
<b>Design:</b>	PROPOSAL #3		

## Planned Survey

MD (usft)	Inc (°)	Azi (°)	TVD (usft)	SS (usft)	+N/-S (usft)	+E/-W (usft)	Vertical Section (usft)	Dogleg Rate (°/100usft)	Build Rate (°/100usft)	Turn Rate (°/100usft)
0.0	0.00	0.00	0.0	4,960.00	0.0	0.0	0.0	0.00	0.00	0.00
100.0	0.00	0.00	100.0	4,860.00	0.0	0.0	0.0	0.00	0.00	0.00
200.0	0.00	0.00	200.0	4,760.00	0.0	0.0	0.0	0.00	0.00	0.00
300.0	0.00	0.00	300.0	4,660.00	0.0	0.0	0.0	0.00	0.00	0.00
400.0	0.00	0.00	400.0	4,560.00	0.0	0.0	0.0	0.00	0.00	0.00
500.0	0.00	0.00	500.0	4,460.00	0.0	0.0	0.0	0.00	0.00	0.00
600.0	0.00	0.00	600.0	4,360.00	0.0	0.0	0.0	0.00	0.00	0.00
700.0	0.00	0.00	700.0	4,260.00	0.0	0.0	0.0	0.00	0.00	0.00
800.0	0.00	0.00	800.0	4,160.00	0.0	0.0	0.0	0.00	0.00	0.00
900.0	0.00	0.00	900.0	4,060.00	0.0	0.0	0.0	0.00	0.00	0.00
<b>START NUDGE (2°/100ft BUR)</b>										
1,000.0	0.00	0.00	1,000.0	3,960.00	0.0	0.0	0.0	0.00	0.00	0.00
1,100.0	2.00	204.94	1,100.0	3,860.02	-1.6	-0.7	-0.4	2.00	2.00	0.00
1,200.0	4.00	204.94	1,199.8	3,760.16	-6.3	-2.9	-1.8	2.00	2.00	0.00
1,300.0	6.00	204.94	1,299.5	3,660.55	-14.2	-6.6	-4.0	2.00	2.00	0.00
1,400.0	8.00	204.94	1,398.7	3,561.30	-25.3	-11.8	-7.2	2.00	2.00	0.00
1,500.0	10.00	204.94	1,497.5	3,462.53	-39.5	-18.4	-11.2	2.00	2.00	0.00
<b>9 5/8" SURFACE CASING</b>										
1,502.6	10.05	204.94	1,500.0	3,460.00	-39.9	-18.5	-11.3	2.00	2.00	0.00
<b>END OF TANGENT</b>										
1,567.6	10.05	204.94	1,564.0	3,396.00	-50.2	-23.3	-14.2	0.00	0.00	-0.01
1,600.0	10.70	204.94	1,595.9	3,364.10	-55.5	-25.8	-15.7	2.00	2.00	0.00
1,700.0	12.70	204.94	1,693.8	3,266.18	-73.8	-34.3	-20.9	2.00	2.00	0.00
1,800.0	14.70	204.94	1,791.0	3,169.03	-95.3	-44.3	-27.0	2.00	2.00	0.00
<b>EOB TO 15.6° INC</b>										
1,845.1	15.60	204.94	1,834.5	3,125.48	-106.0	-49.3	-30.0	2.00	2.00	0.00
1,900.0	15.60	204.94	1,887.4	3,072.63	-119.4	-55.5	-33.8	0.00	0.00	0.00
2,000.0	15.60	204.94	1,983.7	2,976.31	-143.8	-66.9	-40.7	0.00	0.00	0.00
2,100.0	15.60	204.94	2,080.0	2,880.00	-168.2	-78.2	-47.6	0.00	0.00	0.00
2,200.0	15.60	204.94	2,176.3	2,783.68	-192.6	-89.5	-54.5	0.00	0.00	0.00
2,300.0	15.60	204.94	2,272.6	2,687.37	-216.9	-100.9	-61.4	0.00	0.00	0.00
2,400.0	15.60	204.94	2,368.9	2,591.05	-241.3	-112.2	-68.2	0.00	0.00	0.00
2,500.0	15.60	204.94	2,465.3	2,494.73	-265.7	-123.5	-75.1	0.00	0.00	0.00
2,600.0	15.60	204.94	2,561.6	2,398.42	-290.1	-134.9	-82.0	0.00	0.00	0.00
2,700.0	15.60	204.94	2,657.9	2,302.10	-314.5	-146.2	-88.9	0.00	0.00	0.00
2,800.0	15.60	204.94	2,754.2	2,205.79	-338.9	-157.6	-95.8	0.00	0.00	0.00
2,900.0	15.60	204.94	2,850.5	2,109.47	-363.3	-168.9	-102.7	0.00	0.00	0.00
3,000.0	15.60	204.94	2,946.8	2,013.16	-387.7	-180.2	-109.6	0.00	0.00	0.00
<b>PARKMAN</b>										
3,080.1	15.60	204.94	3,024.0	1,936.00	-407.2	-189.3	-115.2	0.00	0.00	0.00
3,100.0	15.60	204.94	3,043.2	1,916.84	-412.1	-191.6	-116.5	0.00	0.00	0.00
3,200.0	15.60	204.94	3,139.5	1,820.53	-436.4	-202.9	-123.4	0.00	0.00	0.00
3,300.0	15.60	204.94	3,235.8	1,724.21	-460.8	-214.3	-130.3	0.00	0.00	0.00
3,400.0	15.60	204.94	3,332.1	1,627.90	-485.2	-225.6	-137.2	0.00	0.00	0.00
3,500.0	15.60	204.94	3,428.4	1,531.58	-509.6	-236.9	-144.1	0.00	0.00	0.00
3,600.0	15.60	204.94	3,524.7	1,435.27	-534.0	-248.3	-151.0	0.00	0.00	0.00
3,700.0	15.60	204.94	3,621.0	1,338.95	-558.4	-259.6	-157.9	0.00	0.00	0.00
3,800.0	15.60	204.94	3,717.4	1,242.64	-582.8	-271.0	-164.8	0.00	0.00	0.00
3,900.0	15.60	204.94	3,813.7	1,146.32	-607.2	-282.3	-171.7	0.00	0.00	0.00
<b>SUSSEX</b>										
3,929.4	15.60	204.94	3,842.0	1,118.00	-614.3	-285.6	-173.7	0.00	0.00	0.00
4,000.0	15.60	204.94	3,910.0	1,050.01	-631.6	-293.6	-178.6	0.00	0.00	0.00
4,100.0	15.60	204.94	4,006.3	953.69	-655.9	-305.0	-185.5	0.00	0.00	0.00

# Planning Report



<b>Database:</b>	EDM 5000.1 Single User Db	<b>Local Co-ordinate Reference:</b>	Well FAIRVIEW 5
<b>Company:</b>	EXTRACTION OIL & GAS	<b>TVD Reference:</b>	KB-EST @ 4960.0usft
<b>Project:</b>	WELD COUNTY, COLORADO (NAD 83)	<b>MD Reference:</b>	KB-EST @ 4960.0usft
<b>Site:</b>	NW SW SEC. 5 T2N R68W 6th P.M.	<b>North Reference:</b>	True
<b>Well:</b>	FAIRVIEW 5	<b>Survey Calculation Method:</b>	Minimum Curvature
<b>Wellbore:</b>	ORIGINAL WELLBORE		
<b>Design:</b>	PROPOSAL #3		

## Planned Survey

MD (usft)	Inc (°)	Azi (°)	TVD (usft)	SS (usft)	+N/-S (usft)	+E/-W (usft)	Vertical Section (usft)	Dogleg Rate (°/100usft)	Build Rate (°/100usft)	Turn Rate (°/100usft)
4,200.0	15.60	204.94	4,102.6	857.38	-680.3	-316.3	-192.4	0.00	0.00	0.00
4,300.0	15.60	204.94	4,198.9	761.06	-704.7	-327.7	-199.3	0.00	0.00	0.00
4,400.0	15.60	204.94	4,295.3	664.75	-729.1	-339.0	-206.2	0.00	0.00	0.00
4,500.0	15.60	204.94	4,391.6	568.43	-753.5	-350.3	-213.1	0.00	0.00	0.00
<b>SHANNON</b>										
<b>4,510.8</b>	<b>15.60</b>	<b>204.94</b>	<b>4,402.0</b>	<b>558.00</b>	<b>-756.1</b>	<b>-351.6</b>	<b>-213.8</b>	<b>0.00</b>	<b>0.00</b>	<b>0.00</b>
4,600.0	15.60	204.94	4,487.9	472.12	-777.9	-361.7	-220.0	0.00	0.00	0.00
4,700.0	15.60	204.94	4,584.2	375.80	-802.3	-373.0	-226.9	0.00	0.00	0.00
4,800.0	15.60	204.94	4,680.5	279.49	-826.7	-384.3	-233.8	0.00	0.00	0.00
4,900.0	15.60	204.94	4,776.8	183.17	-851.1	-395.7	-240.7	0.00	0.00	0.00
5,000.0	15.60	204.94	4,873.1	86.86	-875.5	-407.0	-247.6	0.00	0.00	0.00
5,100.0	15.60	204.94	4,969.5	-9.46	-899.8	-418.4	-254.5	0.00	0.00	0.00
5,200.0	15.60	204.94	5,065.8	-105.77	-924.2	-429.7	-261.3	0.00	0.00	0.00
5,300.0	15.60	204.94	5,162.1	-202.09	-948.6	-441.0	-268.2	0.00	0.00	0.00
5,400.0	15.60	204.94	5,258.4	-298.40	-973.0	-452.4	-275.1	0.00	0.00	0.00
5,500.0	15.60	204.94	5,354.7	-394.72	-997.4	-463.7	-282.0	0.00	0.00	0.00
5,600.0	15.60	204.94	5,451.0	-491.03	-1,021.8	-475.1	-288.9	0.00	0.00	0.00
5,700.0	15.60	204.94	5,547.3	-587.35	-1,046.2	-486.4	-295.8	0.00	0.00	0.00
5,800.0	15.60	204.94	5,643.7	-683.66	-1,070.6	-497.7	-302.7	0.00	0.00	0.00
<b>END OF TANGENT</b>										
<b>5,898.5</b>	<b>15.60</b>	<b>204.94</b>	<b>5,738.5</b>	<b>-778.49</b>	<b>-1,094.6</b>	<b>-508.9</b>	<b>-309.5</b>	<b>0.00</b>	<b>0.00</b>	<b>0.00</b>
5,900.0	15.57	204.94	5,740.0	-779.98	-1,094.9	-509.1	-309.6	2.00	-2.00	0.00
6,000.0	13.57	204.94	5,836.8	-876.76	-1,117.8	-519.7	-316.1	2.00	-2.00	0.00
6,100.0	11.57	204.94	5,934.4	-974.36	-1,137.5	-528.9	-321.7	2.00	-2.00	0.00
6,200.0	9.57	204.94	6,032.7	-1,072.65	-1,154.1	-536.6	-326.4	2.00	-2.00	0.00
6,300.0	7.57	204.94	6,131.5	-1,171.53	-1,167.6	-542.9	-330.2	2.00	-2.00	0.00
6,400.0	5.57	204.94	6,230.9	-1,270.87	-1,178.0	-547.7	-333.1	2.00	-2.00	0.00
6,500.0	3.57	204.94	6,330.5	-1,370.55	-1,185.3	-551.1	-335.2	2.00	-2.00	0.00
6,600.0	1.57	204.94	6,430.4	-1,470.44	-1,189.3	-553.0	-336.3	2.00	-2.00	0.00
<b>EOD TO VERTICAL</b>										
<b>6,678.6</b>	<b>0.00</b>	<b>0.00</b>	<b>6,509.0</b>	<b>-1,549.00</b>	<b>-1,190.3</b>	<b>-553.4</b>	<b>-336.6</b>	<b>2.00</b>	<b>-2.00</b>	<b>0.00</b>
6,700.0	0.00	0.00	6,530.4	-1,570.43	-1,190.3	-553.4	-336.6	0.00	0.00	0.00
<b>KOP (10°/100ft BUR)</b>										
<b>6,708.6</b>	<b>0.00</b>	<b>0.00</b>	<b>6,539.0</b>	<b>-1,579.00</b>	<b>-1,190.3</b>	<b>-553.4</b>	<b>-336.6</b>	<b>0.00</b>	<b>0.00</b>	<b>0.00</b>
6,800.0	9.14	90.53	6,630.0	-1,670.04	-1,190.4	-546.1	-329.4	10.00	10.00	0.00
<b>SHARON SPRINGS</b>										
<b>6,817.2</b>	<b>10.86</b>	<b>90.53</b>	<b>6,647.0</b>	<b>-1,687.00</b>	<b>-1,190.4</b>	<b>-543.1</b>	<b>-326.5</b>	<b>10.00</b>	<b>10.00</b>	<b>0.00</b>
<b>NIOBRARA</b>										
<b>6,878.0</b>	<b>16.94</b>	<b>90.53</b>	<b>6,706.0</b>	<b>-1,746.00</b>	<b>-1,190.5</b>	<b>-528.5</b>	<b>-312.1</b>	<b>10.00</b>	<b>10.00</b>	<b>0.00</b>
6,900.0	19.14	90.53	6,726.9	-1,766.89	-1,190.6	-521.7	-305.3	10.00	10.00	0.00
7,000.0	29.14	90.53	6,818.0	-1,858.03	-1,191.0	-480.9	-265.1	10.00	10.00	0.00
7,100.0	39.14	90.53	6,900.7	-1,940.69	-1,191.5	-424.8	-209.8	10.00	10.00	0.00
7,200.0	49.14	90.53	6,972.4	-2,012.36	-1,192.1	-355.3	-141.2	10.00	10.00	0.00
7,300.0	59.14	90.53	7,030.9	-2,070.87	-1,192.9	-274.3	-61.4	10.00	10.00	0.00
<b>FORT HAYS</b>										
<b>7,367.5</b>	<b>65.89</b>	<b>90.53</b>	<b>7,062.0</b>	<b>-2,102.00</b>	<b>-1,193.4</b>	<b>-214.5</b>	<b>-2.4</b>	<b>10.00</b>	<b>10.00</b>	<b>0.00</b>
7,400.0	69.14	90.53	7,074.4	-2,114.43	-1,193.7	-184.5	27.2	10.00	10.00	0.00
7,500.0	79.14	90.53	7,101.7	-2,141.73	-1,194.6	-88.4	122.0	10.00	10.00	0.00
<b>CODELL</b>										
<b>7,501.4</b>	<b>79.28</b>	<b>90.53</b>	<b>7,102.0</b>	<b>-2,142.00</b>	<b>-1,194.6</b>	<b>-87.0</b>	<b>123.4</b>	<b>10.00</b>	<b>10.00</b>	<b>0.00</b>
7,600.0	89.14	90.53	7,111.9	-2,151.93	-1,195.5	10.9	220.0	10.00	10.00	0.00
<b>LANDING PNT - FAIRVIEW 5 (P3)</b>										
<b>7,608.6</b>	<b>90.00</b>	<b>90.53</b>	<b>7,112.0</b>	<b>-2,152.00</b>	<b>-1,195.6</b>	<b>19.6</b>	<b>228.5</b>	<b>10.00</b>	<b>10.00</b>	<b>0.00</b>



# Planning Report



<b>Database:</b>	EDM 5000.1 Single User Db	<b>Local Co-ordinate Reference:</b>	Well FAIRVIEW 5
<b>Company:</b>	EXTRACTION OIL & GAS	<b>TVD Reference:</b>	KB-EST @ 4960.0usft
<b>Project:</b>	WELD COUNTY, COLORADO (NAD 83)	<b>MD Reference:</b>	KB-EST @ 4960.0usft
<b>Site:</b>	NW SW SEC. 5 T2N R68W 6th P.M.	<b>North Reference:</b>	True
<b>Well:</b>	FAIRVIEW 5	<b>Survey Calculation Method:</b>	Minimum Curvature
<b>Wellbore:</b>	ORIGINAL WELLBORE		
<b>Design:</b>	PROPOSAL #3		

Planned Survey										
MD (usft)	Inc (°)	Azi (°)	TVD (usft)	SS (usft)	+N/-S (usft)	+E/-W (usft)	Vertical Section (usft)	Dogleg Rate (°/100usft)	Build Rate (°/100usft)	Turn Rate (°/100usft)
7,700.0	90.00	90.53	7,112.0	-2,152.00	-1,196.5	110.9	318.6	0.00	0.00	0.00
7,800.0	90.00	90.53	7,112.0	-2,152.00	-1,197.4	210.9	417.2	0.00	0.00	0.00
7,900.0	90.00	90.53	7,112.0	-2,152.00	-1,198.3	310.9	515.8	0.00	0.00	0.00
8,000.0	90.00	90.53	7,112.0	-2,152.00	-1,199.2	410.9	614.4	0.00	0.00	0.00
8,100.0	90.00	90.53	7,112.0	-2,152.00	-1,200.2	510.9	713.0	0.00	0.00	0.00
8,200.0	90.00	90.53	7,112.0	-2,152.00	-1,201.1	610.9	811.7	0.00	0.00	0.00
8,300.0	90.00	90.53	7,112.0	-2,152.01	-1,202.0	710.9	910.3	0.00	0.00	0.00
8,400.0	90.00	90.53	7,112.0	-2,152.01	-1,203.0	810.9	1,008.9	0.00	0.00	0.00
8,500.0	90.00	90.53	7,112.0	-2,152.01	-1,203.9	910.9	1,107.5	0.00	0.00	0.00
8,600.0	90.00	90.53	7,112.0	-2,152.01	-1,204.8	1,010.9	1,206.1	0.00	0.00	0.00
8,700.0	90.00	90.53	7,112.0	-2,152.01	-1,205.7	1,110.9	1,304.7	0.00	0.00	0.00
8,800.0	90.00	90.53	7,112.0	-2,152.01	-1,206.7	1,210.9	1,403.3	0.00	0.00	0.00
8,900.0	90.00	90.53	7,112.0	-2,152.01	-1,207.6	1,310.9	1,502.0	0.00	0.00	0.00
9,000.0	90.00	90.53	7,112.0	-2,152.01	-1,208.5	1,410.9	1,600.6	0.00	0.00	0.00
9,100.0	90.00	90.53	7,112.0	-2,152.01	-1,209.5	1,510.9	1,699.2	0.00	0.00	0.00
9,200.0	90.00	90.53	7,112.0	-2,152.01	-1,210.4	1,610.9	1,797.8	0.00	0.00	0.00
9,300.0	90.00	90.53	7,112.0	-2,152.01	-1,211.3	1,710.9	1,896.4	0.00	0.00	0.00
9,400.0	90.00	90.53	7,112.0	-2,152.01	-1,212.2	1,810.9	1,995.0	0.00	0.00	0.00
9,500.0	90.00	90.53	7,112.0	-2,152.01	-1,213.2	1,910.9	2,093.7	0.00	0.00	0.00
9,600.0	90.00	90.53	7,112.0	-2,152.01	-1,214.1	2,010.8	2,192.3	0.00	0.00	0.00
9,700.0	90.00	90.53	7,112.0	-2,152.01	-1,215.0	2,110.8	2,290.9	0.00	0.00	0.00
9,800.0	90.00	90.53	7,112.0	-2,152.01	-1,216.0	2,210.8	2,389.5	0.00	0.00	0.00
9,900.0	90.00	90.53	7,112.0	-2,152.01	-1,216.9	2,310.8	2,488.1	0.00	0.00	0.00
10,000.0	90.00	90.53	7,112.0	-2,152.01	-1,217.8	2,410.8	2,586.7	0.00	0.00	0.00
10,100.0	90.00	90.53	7,112.0	-2,152.01	-1,218.8	2,510.8	2,685.4	0.00	0.00	0.00
10,200.0	90.00	90.53	7,112.0	-2,152.01	-1,219.7	2,610.8	2,784.0	0.00	0.00	0.00
10,300.0	90.00	90.53	7,112.0	-2,152.01	-1,220.6	2,710.8	2,882.6	0.00	0.00	0.00
10,400.0	90.00	90.53	7,112.0	-2,152.01	-1,221.5	2,810.8	2,981.2	0.00	0.00	0.00
10,500.0	90.00	90.53	7,112.0	-2,152.01	-1,222.5	2,910.8	3,079.8	0.00	0.00	0.00
10,600.0	90.00	90.53	7,112.0	-2,152.01	-1,223.4	3,010.8	3,178.4	0.00	0.00	0.00
10,700.0	90.00	90.53	7,112.0	-2,152.01	-1,224.3	3,110.8	3,277.0	0.00	0.00	0.00
10,800.0	90.00	90.53	7,112.0	-2,152.01	-1,225.3	3,210.8	3,375.7	0.00	0.00	0.00
10,900.0	90.00	90.53	7,112.0	-2,152.01	-1,226.2	3,310.8	3,474.3	0.00	0.00	0.00
11,000.0	90.00	90.53	7,112.0	-2,152.01	-1,227.1	3,410.8	3,572.9	0.00	0.00	0.00
11,100.0	90.00	90.53	7,112.0	-2,152.01	-1,228.1	3,510.8	3,671.5	0.00	0.00	0.00
11,200.0	90.00	90.53	7,112.0	-2,152.01	-1,229.0	3,610.8	3,770.1	0.00	0.00	0.00
11,300.0	90.00	90.53	7,112.0	-2,152.01	-1,229.9	3,710.8	3,868.7	0.00	0.00	0.00
11,400.0	90.00	90.53	7,112.0	-2,152.01	-1,230.9	3,810.8	3,967.4	0.00	0.00	0.00
11,500.0	90.00	90.53	7,112.0	-2,152.01	-1,231.8	3,910.8	4,066.0	0.00	0.00	0.00
11,600.0	90.00	90.53	7,112.0	-2,152.01	-1,232.7	4,010.8	4,164.6	0.00	0.00	0.00
11,700.0	90.00	90.53	7,112.0	-2,152.01	-1,233.7	4,110.8	4,263.2	0.00	0.00	0.00
11,800.0	90.00	90.53	7,112.0	-2,152.01	-1,234.6	4,210.8	4,361.8	0.00	0.00	0.00
11,900.0	90.00	90.53	7,112.0	-2,152.01	-1,235.5	4,310.7	4,460.4	0.00	0.00	0.00
12,000.0	90.00	90.54	7,112.0	-2,152.01	-1,236.5	4,410.7	4,559.1	0.00	0.00	0.00
12,100.0	90.00	90.54	7,112.0	-2,152.01	-1,237.4	4,510.7	4,657.7	0.00	0.00	0.00
12,200.0	90.00	90.54	7,112.0	-2,152.01	-1,238.3	4,610.7	4,756.3	0.00	0.00	0.00
12,300.0	90.00	90.54	7,112.0	-2,152.01	-1,239.3	4,710.7	4,854.9	0.00	0.00	0.00
12,400.0	90.00	90.54	7,112.0	-2,152.01	-1,240.2	4,810.7	4,953.5	0.00	0.00	0.00
12,500.0	90.00	90.54	7,112.0	-2,152.01	-1,241.1	4,910.7	5,052.1	0.00	0.00	0.00
12,600.0	90.00	90.54	7,112.0	-2,152.01	-1,242.1	5,010.7	5,150.8	0.00	0.00	0.00
12,700.0	90.00	90.54	7,112.0	-2,152.01	-1,243.0	5,110.7	5,249.4	0.00	0.00	0.00
12,800.0	90.00	90.54	7,112.0	-2,152.01	-1,243.9	5,210.7	5,348.0	0.00	0.00	0.00
12,900.0	90.00	90.54	7,112.0	-2,152.01	-1,244.9	5,310.7	5,446.6	0.00	0.00	0.00
13,000.0	90.00	90.54	7,112.0	-2,152.01	-1,245.8	5,410.7	5,545.2	0.00	0.00	0.00

<b>Database:</b>	EDM 5000.1 Single User Db	<b>Local Co-ordinate Reference:</b>	Well FAIRVIEW 5
<b>Company:</b>	EXTRACTION OIL & GAS	<b>TVD Reference:</b>	KB-EST @ 4960.0usft
<b>Project:</b>	WELD COUNTY, COLORADO (NAD 83)	<b>MD Reference:</b>	KB-EST @ 4960.0usft
<b>Site:</b>	NW SW SEC. 5 T2N R68W 6th P.M.	<b>North Reference:</b>	True
<b>Well:</b>	FAIRVIEW 5	<b>Survey Calculation Method:</b>	Minimum Curvature
<b>Wellbore:</b>	ORIGINAL WELLBORE		
<b>Design:</b>	PROPOSAL #3		

## Planned Survey

MD (usft)	Inc (°)	Azi (°)	TVD (usft)	SS (usft)	+N/-S (usft)	+E/-W (usft)	Vertical Section (usft)	Dogleg Rate (°/100usft)	Build Rate (°/100usft)	Turn Rate (°/100usft)
13,100.0	90.00	90.54	7,112.0	-2,152.01	-1,246.7	5,510.7	5,643.8	0.00	0.00	0.00
13,200.0	90.00	90.54	7,112.0	-2,152.01	-1,247.7	5,610.7	5,742.5	0.00	0.00	0.00
13,300.0	90.00	90.54	7,112.0	-2,152.01	-1,248.6	5,710.7	5,841.1	0.00	0.00	0.00
13,400.0	90.00	90.54	7,112.0	-2,152.01	-1,249.6	5,810.7	5,939.7	0.00	0.00	0.00
13,500.0	90.00	90.54	7,112.0	-2,152.01	-1,250.5	5,910.7	6,038.3	0.00	0.00	0.00
13,600.0	90.00	90.54	7,112.0	-2,152.01	-1,251.4	6,010.7	6,136.9	0.00	0.00	0.00
13,700.0	90.00	90.54	7,112.0	-2,152.01	-1,252.4	6,110.7	6,235.5	0.00	0.00	0.00
13,800.0	90.00	90.54	7,112.0	-2,152.01	-1,253.3	6,210.7	6,334.2	0.00	0.00	0.00
13,900.0	90.00	90.54	7,112.0	-2,152.01	-1,254.2	6,310.7	6,432.8	0.00	0.00	0.00
14,000.0	90.00	90.54	7,112.0	-2,152.01	-1,255.2	6,410.7	6,531.4	0.00	0.00	0.00
14,100.0	90.00	90.54	7,112.0	-2,152.00	-1,256.1	6,510.7	6,630.0	0.00	0.00	0.00
14,200.0	90.00	90.54	7,112.0	-2,152.00	-1,257.0	6,610.6	6,728.6	0.00	0.00	0.00
14,300.0	90.00	90.54	7,112.0	-2,152.00	-1,258.0	6,710.6	6,827.2	0.00	0.00	0.00
14,400.0	90.00	90.54	7,112.0	-2,152.00	-1,258.9	6,810.6	6,925.9	0.00	0.00	0.00
14,500.0	90.00	90.54	7,112.0	-2,152.00	-1,259.9	6,910.6	7,024.5	0.00	0.00	0.00
14,600.0	90.00	90.54	7,112.0	-2,152.00	-1,260.8	7,010.6	7,123.1	0.00	0.00	0.00
<b>BHL - FAIRVIEW 5 (P3)</b>										
<b>14,688.1</b>	<b>90.00</b>	<b>90.54</b>	<b>7,112.0</b>	<b>-2,152.00</b>	<b>-1,261.6</b>	<b>7,098.7</b>	<b>7,209.9</b>	<b>0.00</b>	<b>0.00</b>	<b>0.00</b>

## Formations

MD (usft)	TVD (usft)	Name	Lithology	Dip (°)	Dip Direction (°)
3,080.1	3,024.0	PARKMAN		0.00	
3,929.4	3,842.0	SUSSEX		0.00	
4,510.8	4,402.0	SHANNON		0.00	
6,817.2	6,647.0	SHARON SPRINGS		0.00	
6,878.0	6,706.0	NIOBRARA		0.00	
7,367.5	7,062.0	FORT HAYS		0.00	
7,501.4	7,102.0	CODELL		0.00	

## Plan Annotations

MD (usft)	TVD (usft)	Local Coordinates		Comment
		+N/-S (usft)	+E/-W (usft)	
1,000.0	1,000.0	0.0	0.0	START NUDGE (2°/100ft BUR)
1,502.6	1,500.0	-39.9	-18.5	9 5/8" SURFACE CASING
1,567.6	1,564.0	-50.2	-23.3	END OF TANGENT
1,845.1	1,834.5	-106.0	-49.3	EOB TO 15.6° INC
5,898.5	5,738.5	-1,094.6	-508.9	END OF TANGENT
6,678.6	6,509.0	-1,190.3	-553.4	EOD TO VERTICAL
6,708.6	6,539.0	-1,190.3	-553.4	KOP (10°/100ft BUR)
7,608.6	7,112.0	-1,195.6	19.6	LANDING PNT - FAIRVIEW 5 (P3)
14,688.1	7,112.0	-1,261.6	7,098.7	BHL - FAIRVIEW 5 (P3)