

COGCC GISOnline

Layers

☒ Buffer 1

☐ DEM_10m

☒ O&G Facilities

☒ Wells

☐ Well Name

☐ Well API #

☐ Misc Facilities

☐ Pits

☒ Active

☒ Closed

☐ Unknown

☐ Permits

☒ Pending Permits

☐ Pending2As (Diamond)

☐ Well Status

☐ Spud Notice

☐ UIC Active

☐ SC

☐ Anomalies

☐ Surface Casing

☒ COGCC Data

☒ COGCCAlert_v4

☒ COGCCAlert

☒ COGCCOnsite

☐ Samples

☐ Remediation

☐ O&G Locations

☐ Directionals

☒ COGCC Rules

☐ O&G Fields

☒ Field Insp Unit

☐ SeismicPermits

☒ Historic Wells

☒ Roads & RRs

☒ Water Resources

☒ Environmental Sites

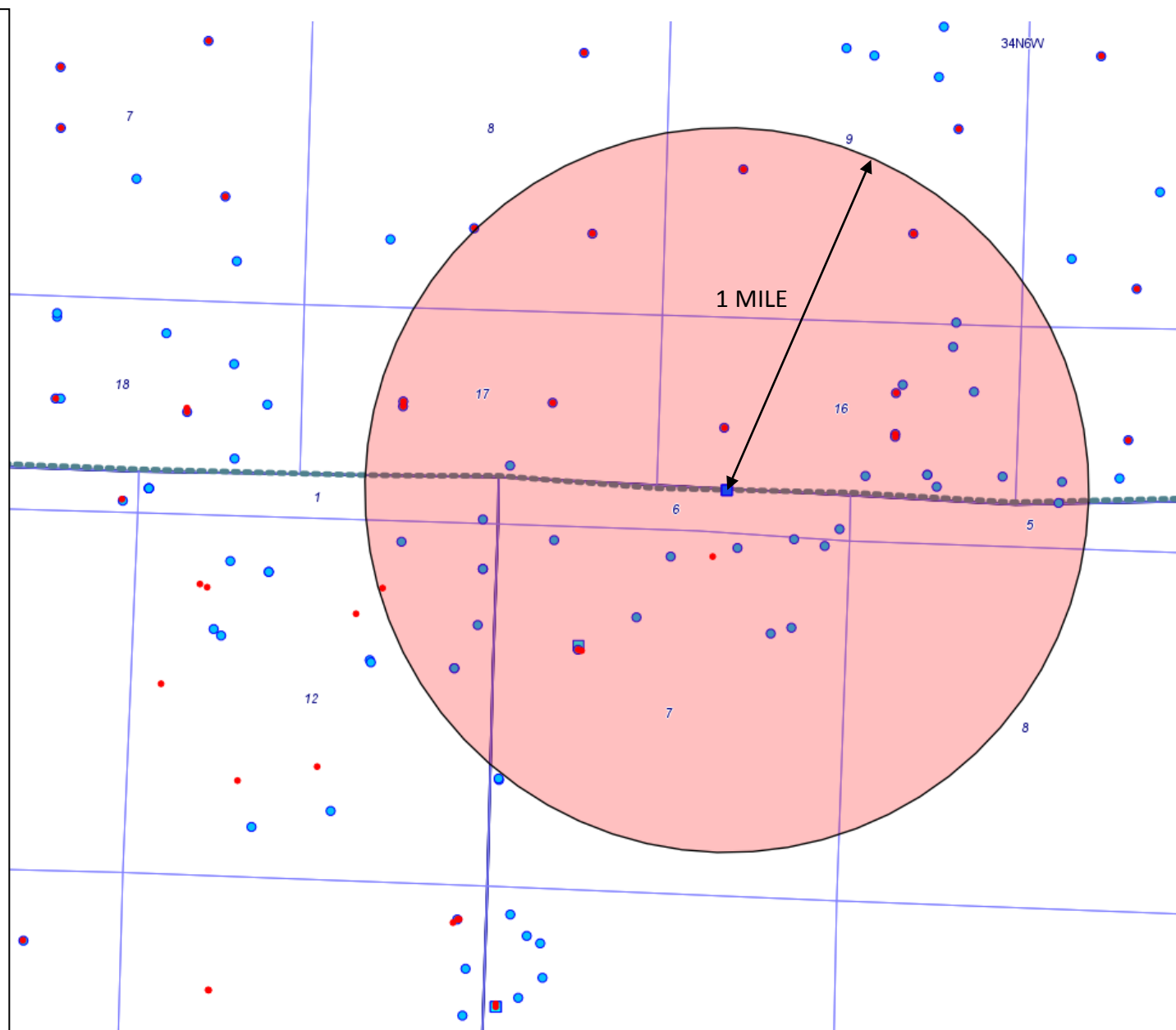

Selected Items Report

Oil and Gas Wells Selected

Filter Results by Formation Include Filter

WELL DESCRIPTION	LOCATION ID	LOCATION	WELL INFORMATION
------------------	-------------	----------	------------------

Water Wells Selected From Map

Filter Results by Depth Greater than Filter

WELL DESCRIPTION	LOCATION	WELL INFORMATION			
		Depth	Top Perf	Bottom Perf	Aquifer
Receipt=1503623, Permit=0070891-F- BP AMERICA PRODUCTION CO	SWNW 7 34 N-6W	0	0	0	GW
Receipt=1503553, Permit=0070780-F- BP AMERICA PRODUCTION CO	SESE 8 34 N-6W	0	0	0	GW
Receipt=0429370, Permit=0208570-- MONTGOMERY SHILO & KRISTY	SESE 9 34 N-6W	140	0	0	GW
Receipt=1503550, Permit=0070777-F- BP AMERICA PRODUCTION CO	SWSE 9 34 N-6W	0	0	0	GW
Receipt=1503593, Permit=0070820-F- BP AMERICA PRODUCTION CO	NWSW 9 34 N-6W	0	0	0	GW
Receipt=9123249, Permit=0077848-- ICE JOSEPH L. JR.	SWNW 15 34 N-6W	108	0	0	GW
Receipt=9703625, Permit=0165688--A BARK BEETLE RANCH	SWSW 15 34 N-6W	0	0	0	GW
Receipt=0097369, Permit=0101873-- ROMERO BOB & PAM	NENE 16 34 N-6W	180	100	170	GW
Receipt=9700406, Permit=0232464-- IVERS DANA	NWNE 16 34 N-6W	0	0	0	GW
Receipt=1503544, Permit=0070765-F- BP AMERICA PRODUCTION CO	NWNE 16 34 N-6W	0	0	0	GW
Receipt=0086483, Permit=0097157-- HARRIS F	SENE 16 34 N-6W	140	20	140	GW
Receipt=0245279, Permit=0027495-F- BOYLE F W	SENE 16 34 N-6W	150	80	150	GW
Receipt=9123931, Permit=0102218--	SENE 16	0	0	0	GW

HOOVER WALTER R & MARILYN V	34 N-6W				
Receipt=1505182, Permit=0075345-F- BP AMERICA PRODUCTION COMPANY	SWNE 16 34 N-6W	0	0	0	GW
Receipt=1505183, Permit=0075346-F- BP AMERICA PRODUCTION COMPANY	SWNE 16 34 N-6W	0	0	0	GW
Receipt=0419820, Permit=0204024-- IVERS DANA	SESE 16 34 N-6W	150	80	150	GW
Receipt=0349532, Permit=0168759-- GAGE JIM A	SESE 16 34 N-6W	0	0	0	GW
Receipt=0502938, Permit=0246526-- DUNHAM DON D	SWSE 16 34 N-6W	300	80	280	GW
Receipt=1503548, Permit=0070769-F- BP AMERICA PRODUCTION CO	SWNE 17 34 N-6W	0	0	0	GW
Receipt=1503609, Permit=0070838-F- BP AMERICA PRODUCTION CO	SENE 17 34 N-6W	0	0	0	GW
Receipt=1505207, Permit=0075349-F- BP AMERICA PRODUCTION COMPANY	SWNW 17 34 N-6W	0	0	0	GW
Receipt=9703081, Permit=0283843-- MORRISON GREGORY F	SWSE 17 34 N-6W	200	60	*180	GW 6650'
Receipt=0233472, Permit=0129225-- MERRY PAUL R	NENE 6 U 34 N-6W	0	0	0	GW
Receipt=0387338, Permit=0187369-- CRISTIANO DAVID & CHRISTY	NENE 7 U 34 N-6W	140	30	140	GW 6745
Receipt=0372780, Permit=0121830--A SHAFFER JOHN W	NENE 7 U 34 N-6W	135	30	135	GW
Receipt=0354375, Permit=0171596-- CRISTIANO DAVID & CHRISTY	NENE 7 U 34 N-6W	150	80	150	GW
Receipt=0440524, Permit=0214664-- ANDERSON ROBERT F	NWNE 7 U 34 N-6W	140	0	0	GW
Receipt=9700426, Permit=0232484-- TATE SHARON A	NWNE 7 U 34 N-6W	70	0	0	GW
Receipt=0218002, Permit=0121830-- RHODES BOB	SENE 7 U 34 N-6W	0	0	0	GW
Receipt=0359249, Permit=0173770-- TRAUSCH JERILYN	NENW 7 U 34 N-6W	140	30	140	GW
Receipt=0907227, Permit=0063690-- MORRISON HUBERT R	NWNW 7 U 34 N-6W	0	0	0	GW
Receipt=1503599, Permit=0070826-F- BP AMERICA PRODUCTION CO	SENE 7 U 34 N-6W	0	0	0	GW
Receipt=9122955, Permit=0065557-- SPRINGFIELD GARY	SESE 1 U 34 N-7W	131	50	120	GW

Receipt=9701834, Permit=0260470-- CLOUDT FRANZ	NENE 12 U 34 N-7W	320	30	320	GW
Receipt=0340348B, Permit=0164984-- CLOUDT FRANZ	NENE 12 U 34 N-7W	320	30	320	GW
Receipt=9123771, Permit=0096186-- MYORE MARTHA	NWNE 12 U 34 N-7W	125	0	0	GW
Receipt=9702588, Permit=0274530-- HILL ELLEN M	SENE 12 U 34 N-7W	140	80	140	GW
Receipt=0215488, Permit=0120066--A LEE W E	SENE 12 U 34 N-7W	130	100	130	GW
Receipt=0387334, Permit=0187365-- PRITCHETT ROBERT & PENELOPE	SENE 12 U 34 N-7W	140	80	140	GW

Layers

- ☒ Buffer 1
- ☒ DEM_10m
- ☒ O&G Facilities
 - ☒ Wells
 - ☐ Well Name
 - ☐ Well API #
 - ☐ Misc Facilities
 - ☐ Pits
- ☐ Active
- ☐ Closed
- ☐ Unknown
- ☐ Permits
 - ☒ Pending Permits
 - ☐ Pending2As (Diamond)
- ☐ Well Status
 - ☐ Spud Notice
 - ☐ UIC Active
 - ☐ SC Anomalies
- ☐ Surface Casing
- ☒ COGCC Data
 - ☒ COGCCAlert_v4
 - ☒ COGCCAlert
 - ☒ COGCCOnsite
 - ☐ Samples
 - ☐ Remediation
- ☐ O&G Locations
- ☐ Directionals
- ☒ COGCC Rules
- ☐ O&G Fields
- ☒ Field Insp Unit
- ☐ SeismicPermits
- ☒ Historic Wells
- ☒ Roads & RRs
- ☒ Water Resources
- ☒ Environmental_Sites
- ☒ SecTwpRng
- ☒ LGDS
- ☒ Wildlife CPW
- ☒ State Lands
- ☒ Indian Lands
- ☒ BLM Lands
- ☒ Surface Lands
 - ☐ Places
 - ☐ Counties_Zoom
 - ☒ CityPolygons
- ☐ Surface Owner
- ☒ Special Projects

X: 273599, Y: 4121918 (METER)

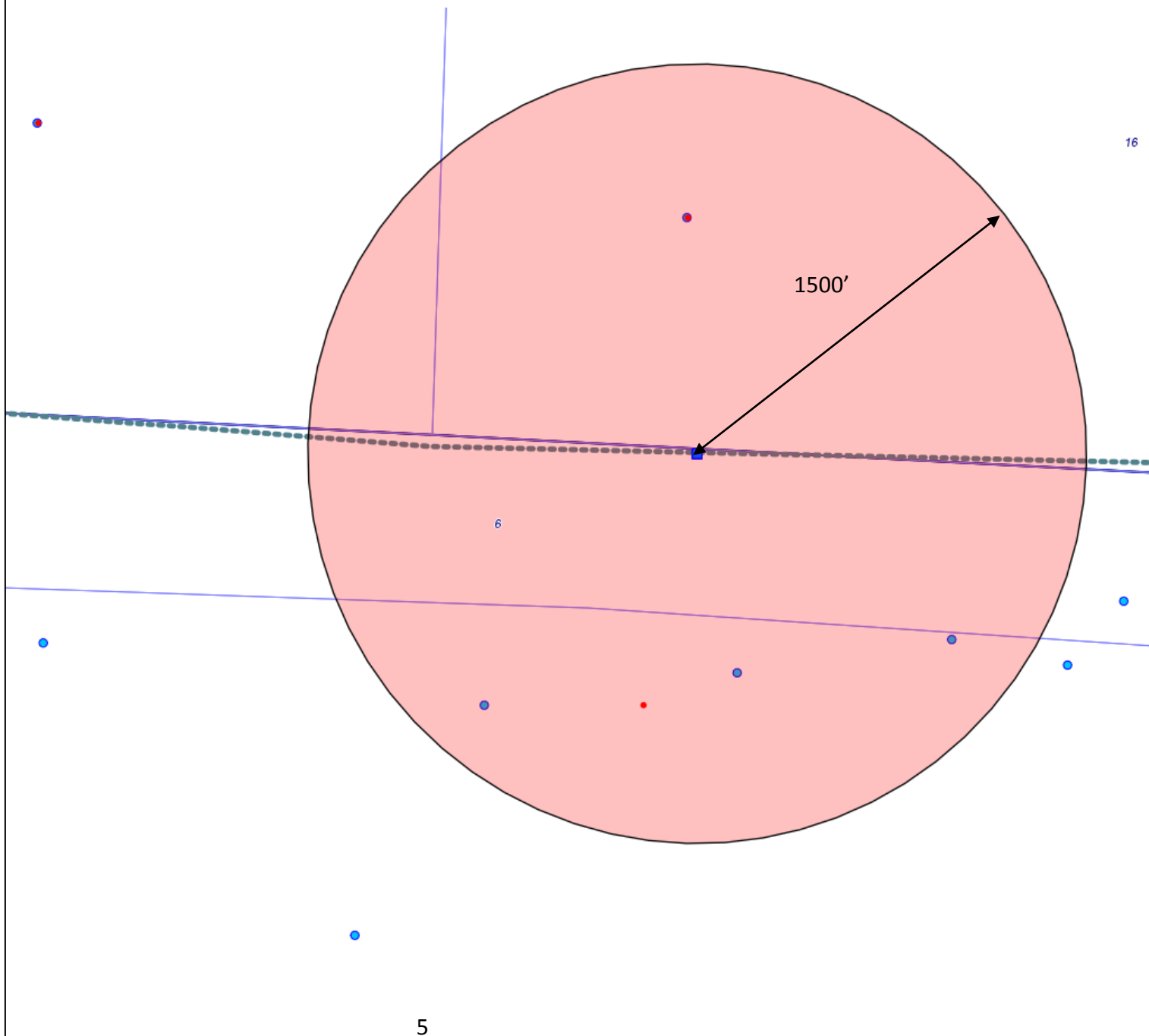

Selected Items Report

Oil and Gas Wells Selected

<div style="display: flex; justify-content: space-between; align-items: center;"> Filter Results by Formation <div style="display: flex; align-items: center;"> <div style="border: 1px solid #ccc; padding: 2px 5px;">Include ▼</div> <div style="border: 1px solid #ccc; padding: 2px 5px; margin-left: 5px;">FRLD FRLDC</div> <div style="border: 1px solid #ccc; padding: 2px 5px; margin-left: 5px;">Filter</div> </div> </div>			
WELL DESCRIPTION	LOCATION ID	LOCATION	WELL INFORMATION
05-067-05554, SPRING CREEK 4-7 CONSOLIDATED OIL & GAS INC	385412	NWNE 7 34N -6W (M)	Sidetrack TD Formation Status 00 250 FRLD AB
05-067-09445, IVERS 01-16 2 BP AMERICA PRODUCTION COMPANY	307002	SWNW 16 34N -6W (N)	Sidetrack TD Formation Status 00 2603 FRLDC PR

NO SHALLOW RESISTIVITY LOGS IN ANY WELL WITHIN 1500'. THE OPERATOR WILL BE REQUIRED TO RUN RESISTIVITY LOGS IN THE PROPOSED MORALES 34-6-6U #1 PILOT WELL FROM TD TO THE SURFACE CASING SHOE.

COGIS - WELL Information

Scout Card

 [Related](#)

 [Insp.](#)

 [1 Mile](#)

 [MIT](#)

 [NOAV](#)

 [GIS](#)

 [Doc](#)

 [Review](#)

 [COA](#)

 [Wellbore](#)

 [Orders](#)

Surface Location Data for API # 05-067-05554

Status: DA

8/26/1960

Well Name/No: [SPRING CREEK #4-7](#) (click well name for production)

Operator: CONSOLIDATED OIL & GAS INC - 19650

Status Date: 8/26/1960 Federal or State Lease #:

County: LA PLATA #067 Location: NWNE 7 34N 6W M PM

Field: WILDCAT - #99999 Elevation: Unknown ft.

Planned Location 330 FNL 1980 FEL [Lat/Long:](#) 37.211758/-107.539299 Lat/Long Calculated From Footages

Wellbore Data for Sidetrack #00

Status: AB

8/26/1960

Wellbore Permit

Permit #: 590320 Expiration Date: 7/20/1959

Prop Depth/Form: Surface Mineral Owner Same:

Mineral Owner: FEE Surface Owner:

Unit: Unit Number:

Formation and Spacing: Code: FRLD , Formation: FRUITLAND , Order: 0 , Unit Acreage: 0, Drill Unit:

Wellbore Completed

Completion Date: 8/26/1960

Measured TD: 250 Measured PB depth: 0

True Vertical TD: 0 True Vertical PB depth:

Formation	Log Top	Log Bottom	Cored	DSTs
-----------	---------	------------	-------	------

Completed information for formation FRLD

Status: AB

8/26/1960

1st Production Date: N/A Choke Size: 0.000

Status Date: 8/26/1960 Open Hole Completion:

Commingled: Production Method:

Formation Name: FRUITLAND Status: AB

Tubing Size: Tubing Setting Depth:

Tubing Packer Depth: Tubing Multiple Packer:

Open Hole Top: Open Hole Bottom:

No Initial Test Data was found for formation FRLD .

No Perforation Data was found for formation FRLD .