

EXTRACTION OIL & GAS

Location: COLORADO Slot: SLOT#02 VARRA #2(1719FSL & 791FWL,SEC.05)
Field: WELD COUNTY (NAD83/TRUE NORTH) Well: VARRA #2
Facility: SEC.05-T06N-R67W Wellbore: VARRA #2 PWB

Plot reference wellpath is VARRA #2 PWP (REV-B.0)

True vertical depths are referenced to SAVANNA 802 (15KB) (RKB)	Grid System: NAD83 / Lambert Colorado SP, Northern Zone (501), US feet
Measured depths are referenced to SAVANNA 802 (15KB) (RKB)	North Reference: True north
SAVANNA 802 (15KB) (RKB) to Mean Sea Level: 4889 feet	Scale: True distance
Mean Sea Level to Mud line (At Slot: SLOT#02 VARRA #2(1719FSL & 791FWL,SEC.05)): 0 feet	Depths are in feet
Coordinates are in feet referenced to Slot	Created by: ingjamr on 7/31/2015

Location Information

Facility Name				Grid East (US ft)	Grid North (US ft)	Latitude	Longitude
SEC.05-T06N-R67W				3160186.786	1430380.222	40°30'48.118"N	104°55'25.957"W
Slot	Local N (ft)	Local E (ft)	Grid East (US ft)	Grid North (US ft)	Latitude	Longitude	
SLOT#02 VARRA #2(1719FSL & 791FWL,SEC.05)	-25.91	-0.31	3160186.646	1430354.314	40°30'47.862"N	104°55'25.961"W	
SAVANNA 802 (15KB) (RKB) to Mud line (At Slot: SLOT#02 VARRA #2(1719FSL & 791FWL,SEC.05))						4889ft	
Mean Sea Level to Mud line (At Slot: SLOT#02 VARRA #2(1719FSL & 791FWL,SEC.05))						0ft	
SAVANNA 802 (15KB) (RKB) to Mean Sea Level						4889ft	

Targets

Name	MD (ft)	TVD (ft)	Local N (ft)	Local E (ft)	Grid East (US ft)	Grid North (US ft)	Latitude	Longitude
VARRA PAD SECTION 04		-9.00	25.87	0.29	3160186.77	1430380.18	40°30'48.118"N	104°55'25.957"W
VARRA PAD SECTION 05		-9.00	25.87	0.29	3160186.77	1430380.18	40°30'48.118"N	104°55'25.957"W
VARRA #2 BHL ON PLAT REV-1(2440FSL & 460FEL,SEC.04)	17362.39	7267.00	878.29	9263.07	3169443.50	1431292.74	40°30'56.524"N	104°53'26.027"W
VARRA #2 LANDING POINT	7751.20	7267.00	899.87	-348.10	3159832.72	1431251.87	40°30'56.754"N	104°55'30.468"W
VARRA PAD CENTER HARDLINES(460' SETBACKS)		7411.00	25.87	0.29	3160186.77	1430380.18	40°30'48.118"N	104°55'25.957"W

Survey Program

Start MD (ft)	End MD (ft)	Tool	Model	Log Name/Comment	Wellbore
15.00	17362.39	NaviTrak	NaviTrak (Standard)		VARRA #2 PWB

Well Profile Data

Design Comment	MD (ft)	Inc (°)	Az (°)	TVD (ft)	Local N (ft)	Local E (ft)	DLS (°/100ft)	VS (ft)
Tie On	15.00	0.000	310.911	15.00	0.00	0.00	0.00	0.00
End of Tangent	1500.00	0.000	310.911	1500.00	0.00	0.00	0.00	0.00
End of Build	2213.98	14.280	310.911	2206.61	57.96	-66.89	2.00	-61.12
End of Tangent	6743.55	14.280	310.911	6596.24	789.62	-911.22	0.00	-832.62
End of 3D Arc	7751.20	90.000	90.129	7267.00	899.87	-348.10	10.00	-261.60
End of Tangent	17362.39	90.000	90.129	7267.00	878.29	9263.07	0.00	9304.62

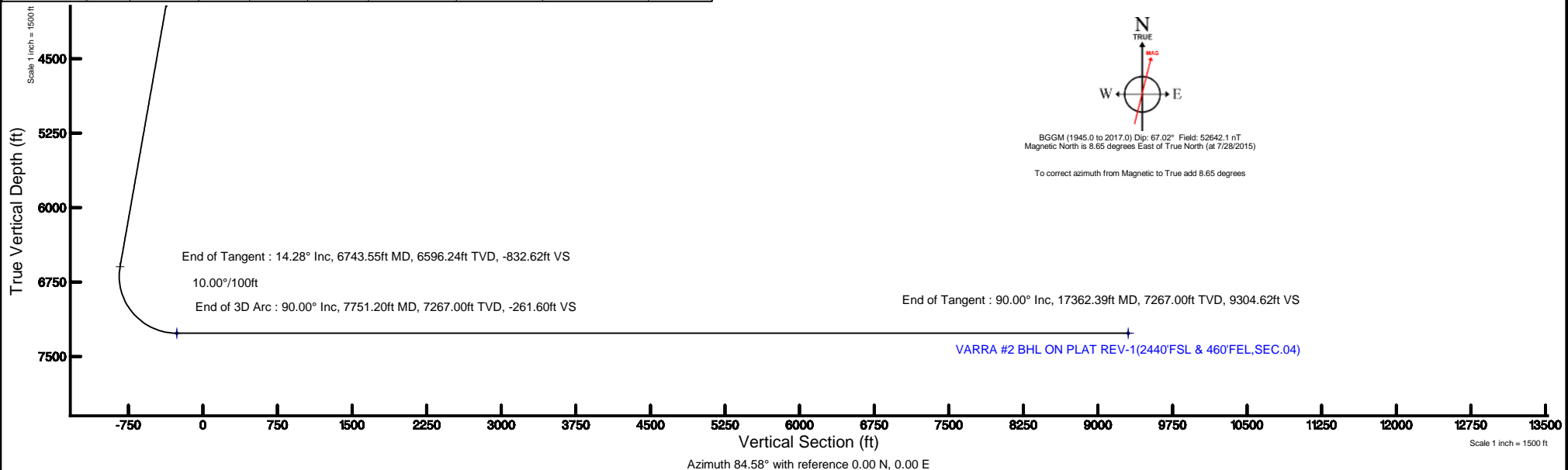



Planned Wellpath Report

VARRA #2 PWP (REV-B.0)

Page 1 of 8



REFERENCE WELLPATH IDENTIFICATION

Operator	EXTRACTION OIL & GAS	Slot	SLOT#02 VARRA #2(1719'FSL & 791'FWL,SEC.05)
Area	COLORADO	Well	VARRA #2
Field	WELD COUNTY (NAD83/TRUE NORTH)	Wellbore	VARRA #2 PWB
Facility	SEC.05-T06N-R67W		

REPORT SETUP INFORMATION

Projection System	NAD83 / Lambert Colorado SP, Northern Zone (501), US feet	Software System	WellArchitect® 4.1.1
North Reference	True	User	Ingmjmr
Scale	0.999967	Report Generated	7/31/2015 at 2:50:29 PM
Convergence at slot	0.37° East	Database/Source file	Denver/VARRA_#2_PWB.xml

WELLPATH LOCATION

	Local coordinates		Grid coordinates		Geographic coordinates	
	North[ft]	East[ft]	Easting[US ft]	Northing[US ft]	Latitude	Longitude
Slot Location	-25.91	-0.31	3160186.65	1430354.31	40°30'47.862"N	104°55'25.961"W
Facility Reference Pt			3160186.79	1430380.22	40°30'48.118"N	104°55'25.957"W
Field Reference Pt			3185481.27	1419166.81	40°28'55.560"N	104°49'59.556"W

WELLPATH DATUM

Calculation method	Minimum curvature	SAVANNA 802 (15'KB) (RKB) to Facility Vertical Datum	4889.00ft
Horizontal Reference Pt	Slot	SAVANNA 802 (15'KB) (RKB) to Mean Sea Level	4889.00ft
Vertical Reference Pt	SAVANNA 802 (15'KB) (RKB)	SAVANNA 802 (15'KB) (RKB) to Mud Line at Slot (SLOT#02 VARRA #2(1719'FSL & 791'FWL,SEC.05))	4889.00ft
MD Reference Pt	SAVANNA 802 (15'KB) (RKB)	Section Origin	N 0.00, E 0.00 ft
Field Vertical Reference	Mean Sea Level	Section Azimuth	84.58°



Planned Wellpath Report

VARRA #2 PWP (REV-B.0)

Page 2 of 8



REFERENCE WELLPATH IDENTIFICATION

Operator	EXTRACTION OIL & GAS	Slot	SLOT#02 VARRA #2(1719'FSL & 791'FWL,SEC.05)
Area	COLORADO	Well	VARRA #2
Field	WELD COUNTY (NAD83/TRUE NORTH)	Wellbore	VARRA #2 PWB
Facility	SEC.05-T06N-R67W		

WELLPATH DATA (180 stations) † = interpolated/extrapolated station

MD [ft]	Inclination [°]	Azimuth [°]	TVD [ft]	Vert Sect [ft]	North [ft]	East [ft]	DLS [°/100ft]	Comments
0.00†	0.000	310.911	0.00	0.00	0.00	0.00	0.00	
15.00	0.000	310.911	15.00	0.00	0.00	0.00	0.00	Tie On
115.00†	0.000	310.911	115.00	0.00	0.00	0.00	0.00	
215.00†	0.000	310.911	215.00	0.00	0.00	0.00	0.00	
315.00†	0.000	310.911	315.00	0.00	0.00	0.00	0.00	
415.00†	0.000	310.911	415.00	0.00	0.00	0.00	0.00	
515.00†	0.000	310.911	515.00	0.00	0.00	0.00	0.00	
615.00†	0.000	310.911	615.00	0.00	0.00	0.00	0.00	
715.00†	0.000	310.911	715.00	0.00	0.00	0.00	0.00	
815.00†	0.000	310.911	815.00	0.00	0.00	0.00	0.00	
915.00†	0.000	310.911	915.00	0.00	0.00	0.00	0.00	
1015.00†	0.000	310.911	1015.00	0.00	0.00	0.00	0.00	
1115.00†	0.000	310.911	1115.00	0.00	0.00	0.00	0.00	
1215.00†	0.000	310.911	1215.00	0.00	0.00	0.00	0.00	
1315.00†	0.000	310.911	1315.00	0.00	0.00	0.00	0.00	
1415.00†	0.000	310.911	1415.00	0.00	0.00	0.00	0.00	
1500.00	0.000	310.911	1500.00	0.00	0.00	0.00	0.00	End of Tangent
1515.00†	0.300	310.911	1515.00	-0.03	0.03	-0.03	2.00	
1615.00†	2.300	310.911	1614.97	-1.59	1.51	-1.74	2.00	
1715.00†	4.300	310.911	1714.80	-5.57	5.28	-6.09	2.00	
1815.00†	6.300	310.911	1814.37	-11.95	11.33	-13.07	2.00	
1915.00†	8.300	310.911	1913.55	-20.72	19.65	-22.68	2.00	
2015.00†	10.300	310.911	2012.23	-31.88	30.23	-34.89	2.00	
2115.00†	12.300	310.911	2110.29	-45.41	43.06	-49.70	2.00	
2213.98	14.280	310.911	2206.61	-61.12	57.96	-66.89	2.00	End of Build
2215.00†	14.280	310.911	2207.60	-61.29	58.13	-67.08	0.00	
2315.00†	14.280	310.911	2304.51	-78.33	74.28	-85.72	0.00	
2415.00†	14.280	310.911	2401.42	-95.36	90.44	-104.36	0.00	
2515.00†	14.280	310.911	2498.33	-112.39	106.59	-123.00	0.00	
2615.00†	14.280	310.911	2595.24	-129.42	122.74	-141.64	0.00	



Planned Wellpath Report

VARRA #2 PWP (REV-B.0)

Page 3 of 8



REFERENCE WELLPATH IDENTIFICATION

Operator	EXTRACTION OIL & GAS	Slot	SLOT#02 VARRA #2(1719'FSL & 791'FWL,SEC.05)
Area	COLORADO	Well	VARRA #2
Field	WELD COUNTY (NAD83/TRUE NORTH)	Wellbore	VARRA #2 PWB
Facility	SEC.05-T06N-R67W		

WELLPATH DATA (180 stations) † = interpolated/extrapolated station

MD [ft]	Inclination [°]	Azimuth [°]	TVD [ft]	Vert Sect [ft]	North [ft]	East [ft]	DLS [°/100ft]	Comments
2715.00†	14.280	310.911	2692.15	-146.46	138.89	-160.28	0.00	
2815.00†	14.280	310.911	2789.06	-163.49	155.05	-178.92	0.00	
2915.00†	14.280	310.911	2885.97	-180.52	171.20	-197.56	0.00	
3015.00†	14.280	310.911	2982.88	-197.55	187.35	-216.20	0.00	
3115.00†	14.280	310.911	3079.79	-214.59	203.51	-234.84	0.00	
3215.00†	14.280	310.911	3176.70	-231.62	219.66	-253.48	0.00	
3315.00†	14.280	310.911	3273.61	-248.65	235.81	-272.13	0.00	
3415.00†	14.280	310.911	3370.52	-265.68	251.96	-290.77	0.00	
3515.00†	14.280	310.911	3467.43	-282.72	268.12	-309.41	0.00	
3615.00†	14.280	310.911	3564.35	-299.75	284.27	-328.05	0.00	
3715.00†	14.280	310.911	3661.26	-316.78	300.42	-346.69	0.00	
3815.00†	14.280	310.911	3758.17	-333.81	316.58	-365.33	0.00	
3915.00†	14.280	310.911	3855.08	-350.85	332.73	-383.97	0.00	
4015.00†	14.280	310.911	3951.99	-367.88	348.88	-402.61	0.00	
4115.00†	14.280	310.911	4048.90	-384.91	365.04	-421.25	0.00	
4215.00†	14.280	310.911	4145.81	-401.94	381.19	-439.89	0.00	
4315.00†	14.280	310.911	4242.72	-418.98	397.34	-458.53	0.00	
4415.00†	14.280	310.911	4339.63	-436.01	413.49	-477.17	0.00	
4515.00†	14.280	310.911	4436.54	-453.04	429.65	-495.81	0.00	
4615.00†	14.280	310.911	4533.45	-470.07	445.80	-514.45	0.00	
4715.00†	14.280	310.911	4630.36	-487.11	461.95	-533.09	0.00	
4815.00†	14.280	310.911	4727.27	-504.14	478.11	-551.73	0.00	
4915.00†	14.280	310.911	4824.18	-521.17	494.26	-570.37	0.00	
5015.00†	14.280	310.911	4921.09	-538.20	510.41	-589.01	0.00	
5115.00†	14.280	310.911	5018.00	-555.24	526.56	-607.65	0.00	
5215.00†	14.280	310.911	5114.91	-572.27	542.72	-626.29	0.00	
5315.00†	14.280	310.911	5211.82	-589.30	558.87	-644.93	0.00	
5415.00†	14.280	310.911	5308.73	-606.33	575.02	-663.57	0.00	
5515.00†	14.280	310.911	5405.64	-623.36	591.18	-682.21	0.00	
5615.00†	14.280	310.911	5502.55	-640.40	607.33	-700.85	0.00	



Planned Wellpath Report

VARRA #2 PWP (REV-B.0)

Page 4 of 8



REFERENCE WELLPATH IDENTIFICATION

Operator	EXTRACTION OIL & GAS	Slot	SLOT#02 VARRA #2(1719'FSL & 791'FWL,SEC.05)
Area	COLORADO	Well	VARRA #2
Field	WELD COUNTY (NAD83/TRUE NORTH)	Wellbore	VARRA #2 PWB
Facility	SEC.05-T06N-R67W		

WELLPATH DATA (180 stations) † = interpolated/extrapolated station

MD [ft]	Inclination [°]	Azimuth [°]	TVD [ft]	Vert Sect [ft]	North [ft]	East [ft]	DLS [°/100ft]	Comments
5715.00†	14.280	310.911	5599.46	-657.43	623.48	-719.49	0.00	
5815.00†	14.280	310.911	5696.37	-674.46	639.63	-738.14	0.00	
5915.00†	14.280	310.911	5793.28	-691.49	655.79	-756.78	0.00	
6015.00†	14.280	310.911	5890.19	-708.53	671.94	-775.42	0.00	
6115.00†	14.280	310.911	5987.10	-725.56	688.09	-794.06	0.00	
6215.00†	14.280	310.911	6084.01	-742.59	704.25	-812.70	0.00	
6315.00†	14.280	310.911	6180.93	-759.62	720.40	-831.34	0.00	
6415.00†	14.280	310.911	6277.84	-776.66	736.55	-849.98	0.00	
6515.00†	14.280	310.911	6374.75	-793.69	752.71	-868.62	0.00	
6615.00†	14.280	310.911	6471.66	-810.72	768.86	-887.26	0.00	
6715.00†	14.280	310.911	6568.57	-827.75	785.01	-905.90	0.00	
6743.55	14.280	310.911	6596.24	-832.62	789.62	-911.22	0.00	End of Tangent
6815.00†	10.103	339.035	6666.12	-840.39	801.26	-920.13	10.00	
6915.00†	11.377	34.417	6764.61	-836.42	817.63	-917.69	10.00	
7015.00†	18.841	60.971	6861.19	-815.25	833.64	-897.95	10.00	
7115.00†	27.904	71.832	6952.93	-777.54	848.81	-861.50	10.00	
7215.00†	37.421	77.579	7037.04	-724.42	862.68	-809.47	10.00	
7315.00†	47.115	81.246	7110.97	-657.52	874.82	-743.42	10.00	
7415.00†	56.895	83.906	7172.46	-578.87	884.87	-665.36	10.00	
7515.00†	66.719	86.027	7219.65	-490.85	892.52	-577.68	10.00	
7615.00†	76.568	87.853	7251.11	-396.14	897.53	-483.02	10.00	
7715.00†	86.429	89.534	7265.87	-297.62	899.77	-384.27	10.00	
7751.20	90.000	90.129	7267.00 ¹	-261.60	899.87	-348.10	10.00	End of 3D Arc
7815.00†	90.000	90.129	7267.00	-198.09	899.73	-284.29	0.00	
7915.00†	90.000	90.129	7267.00	-98.56	899.50	-184.29	0.00	
8015.00†	90.000	90.129	7267.00	0.97	899.28	-84.29	0.00	
8115.00†	90.000	90.129	7267.00	100.50	899.05	15.71	0.00	
8215.00†	90.000	90.129	7267.00	200.03	898.83	115.71	0.00	
8315.00†	90.000	90.129	7267.00	299.57	898.61	215.71	0.00	
8415.00†	90.000	90.129	7267.00	399.10	898.38	315.71	0.00	



Planned Wellpath Report

VARRA #2 PWP (REV-B.0)

Page 5 of 8



REFERENCE WELLPATH IDENTIFICATION

Operator	EXTRACTION OIL & GAS	Slot	SLOT#02 VARRA #2(1719'FSL & 791'FWL,SEC.05)
Area	COLORADO	Well	VARRA #2
Field	WELD COUNTY (NAD83/TRUE NORTH)	Wellbore	VARRA #2 PWB
Facility	SEC.05-T06N-R67W		

WELLPATH DATA (180 stations) † = interpolated/extrapolated station

MD [ft]	Inclination [°]	Azimuth [°]	TVD [ft]	Vert Sect [ft]	North [ft]	East [ft]	DLS [°/100ft]	Comments
8515.00†	90.000	90.129	7267.00	498.63	898.16	415.71	0.00	
8615.00†	90.000	90.129	7267.00	598.16	897.93	515.71	0.00	
8715.00†	90.000	90.129	7267.00	697.69	897.71	615.71	0.00	
8815.00†	90.000	90.129	7267.00	797.23	897.48	715.71	0.00	
8915.00†	90.000	90.129	7267.00	896.76	897.26	815.70	0.00	
9015.00†	90.000	90.129	7267.00	996.29	897.03	915.70	0.00	
9115.00†	90.000	90.129	7267.00	1095.82	896.81	1015.70	0.00	
9215.00†	90.000	90.129	7267.00	1195.35	896.58	1115.70	0.00	
9315.00†	90.000	90.129	7267.00	1294.89	896.36	1215.70	0.00	
9415.00†	90.000	90.129	7267.00	1394.42	896.14	1315.70	0.00	
9515.00†	90.000	90.129	7267.00	1493.95	895.91	1415.70	0.00	
9615.00†	90.000	90.129	7267.00	1593.48	895.69	1515.70	0.00	
9715.00†	90.000	90.129	7267.00	1693.01	895.46	1615.70	0.00	
9815.00†	90.000	90.129	7267.00	1792.55	895.24	1715.70	0.00	
9915.00†	90.000	90.129	7267.00	1892.08	895.01	1815.70	0.00	
10015.00†	90.000	90.129	7267.00	1991.61	894.79	1915.70	0.00	
10115.00†	90.000	90.129	7267.00	2091.14	894.56	2015.70	0.00	
10215.00†	90.000	90.129	7267.00	2190.67	894.34	2115.70	0.00	
10315.00†	90.000	90.129	7267.00	2290.21	894.12	2215.70	0.00	
10415.00†	90.000	90.129	7267.00	2389.74	893.89	2315.70	0.00	
10515.00†	90.000	90.129	7267.00	2489.27	893.67	2415.70	0.00	
10615.00†	90.000	90.129	7267.00	2588.80	893.44	2515.70	0.00	
10715.00†	90.000	90.129	7267.00	2688.33	893.22	2615.70	0.00	
10815.00†	90.000	90.129	7267.00	2787.87	892.99	2715.70	0.00	
10915.00†	90.000	90.129	7267.00	2887.40	892.77	2815.70	0.00	
11015.00†	90.000	90.129	7267.00	2986.93	892.54	2915.70	0.00	
11115.00†	90.000	90.129	7267.00	3086.46	892.32	3015.70	0.00	
11215.00†	90.000	90.129	7267.00	3186.00	892.09	3115.70	0.00	
11315.00†	90.000	90.129	7267.00	3285.53	891.87	3215.70	0.00	
11415.00†	90.000	90.129	7267.00	3385.06	891.65	3315.70	0.00	



Planned Wellpath Report

VARRA #2 PWP (REV-B.0)

Page 6 of 8



REFERENCE WELLPATH IDENTIFICATION

Operator	EXTRACTION OIL & GAS	Slot	SLOT#02 VARRA #2(1719'FSL & 791'FWL,SEC.05)
Area	COLORADO	Well	VARRA #2
Field	WELD COUNTY (NAD83/TRUE NORTH)	Wellbore	VARRA #2 PWB
Facility	SEC.05-T06N-R67W		

WELLPATH DATA (180 stations) † = interpolated/extrapolated station

MD [ft]	Inclination [°]	Azimuth [°]	TVD [ft]	Vert Sect [ft]	North [ft]	East [ft]	DLS [°/100ft]	Comments
11515.00†	90.000	90.129	7267.00	3484.59	891.42	3415.70	0.00	
11615.00†	90.000	90.129	7267.00	3584.12	891.20	3515.70	0.00	
11715.00†	90.000	90.129	7267.00	3683.66	890.97	3615.70	0.00	
11815.00†	90.000	90.129	7267.00	3783.19	890.75	3715.70	0.00	
11915.00†	90.000	90.129	7267.00	3882.72	890.52	3815.70	0.00	
12015.00†	90.000	90.129	7267.00	3982.25	890.30	3915.70	0.00	
12115.00†	90.000	90.129	7267.00	4081.78	890.07	4015.70	0.00	
12215.00†	90.000	90.129	7267.00	4181.32	889.85	4115.70	0.00	
12315.00†	90.000	90.129	7267.00	4280.85	889.62	4215.70	0.00	
12415.00†	90.000	90.129	7267.00	4380.38	889.40	4315.70	0.00	
12515.00†	90.000	90.129	7267.00	4479.91	889.18	4415.70	0.00	
12615.00†	90.000	90.129	7267.00	4579.44	888.95	4515.70	0.00	
12715.00†	90.000	90.129	7267.00	4678.98	888.73	4615.70	0.00	
12815.00†	90.000	90.129	7267.00	4778.51	888.50	4715.70	0.00	
12915.00†	90.000	90.129	7267.00	4878.04	888.28	4815.69	0.00	
13015.00†	90.000	90.129	7267.00	4977.57	888.05	4915.69	0.00	
13115.00†	90.000	90.129	7267.00	5077.10	887.83	5015.69	0.00	
13215.00†	90.000	90.129	7267.00	5176.64	887.60	5115.69	0.00	
13315.00†	90.000	90.129	7267.00	5276.17	887.38	5215.69	0.00	
13415.00†	90.000	90.129	7267.00	5375.70	887.16	5315.69	0.00	
13515.00†	90.000	90.129	7267.00	5475.23	886.93	5415.69	0.00	
13615.00†	90.000	90.129	7267.00	5574.76	886.71	5515.69	0.00	
13715.00†	90.000	90.129	7267.00	5674.30	886.48	5615.69	0.00	
13815.00†	90.000	90.129	7267.00	5773.83	886.26	5715.69	0.00	
13915.00†	90.000	90.129	7267.00	5873.36	886.03	5815.69	0.00	
14015.00†	90.000	90.129	7267.00	5972.89	885.81	5915.69	0.00	
14115.00†	90.000	90.129	7267.00	6072.42	885.58	6015.69	0.00	
14215.00†	90.000	90.129	7267.00	6171.96	885.36	6115.69	0.00	
14315.00†	90.000	90.129	7267.00	6271.49	885.13	6215.69	0.00	
14415.00†	90.000	90.129	7267.00	6371.02	884.91	6315.69	0.00	



Planned Wellpath Report

VARRA #2 PWP (REV-B.0)

Page 7 of 8



REFERENCE WELLPATH IDENTIFICATION

Operator	EXTRACTION OIL & GAS	Slot	SLOT#02 VARRA #2(1719'FSL & 791'FWL,SEC.05)
Area	COLORADO	Well	VARRA #2
Field	WELD COUNTY (NAD83/TRUE NORTH)	Wellbore	VARRA #2 PWB
Facility	SEC.05-T06N-R67W		

WELLPATH DATA (180 stations) † = interpolated/extrapolated station

MD [ft]	Inclination [°]	Azimuth [°]	TVD [ft]	Vert Sect [ft]	North [ft]	East [ft]	DLS [°/100ft]	Comments
14515.00†	90.000	90.129	7267.00	6470.55	884.69	6415.69	0.00	
14615.00†	90.000	90.129	7267.00	6570.08	884.46	6515.69	0.00	
14715.00†	90.000	90.129	7267.00	6669.62	884.24	6615.69	0.00	
14815.00†	90.000	90.129	7267.00	6769.15	884.01	6715.69	0.00	
14915.00†	90.000	90.129	7267.00	6868.68	883.79	6815.69	0.00	
15015.00†	90.000	90.129	7267.00	6968.21	883.56	6915.69	0.00	
15115.00†	90.000	90.129	7267.00	7067.75	883.34	7015.69	0.00	
15215.00†	90.000	90.129	7267.00	7167.28	883.11	7115.69	0.00	
15315.00†	90.000	90.129	7267.00	7266.81	882.89	7215.69	0.00	
15415.00†	90.000	90.129	7267.00	7366.34	882.66	7315.69	0.00	
15515.00†	90.000	90.129	7267.00	7465.87	882.44	7415.69	0.00	
15615.00†	90.000	90.129	7267.00	7565.41	882.22	7515.69	0.00	
15715.00†	90.000	90.129	7267.00	7664.94	881.99	7615.69	0.00	
15815.00†	90.000	90.129	7267.00	7764.47	881.77	7715.69	0.00	
15915.00†	90.000	90.129	7267.00	7864.00	881.54	7815.69	0.00	
16015.00†	90.000	90.129	7267.00	7963.53	881.32	7915.69	0.00	
16115.00†	90.000	90.129	7267.00	8063.07	881.09	8015.69	0.00	
16215.00†	90.000	90.129	7267.00	8162.60	880.87	8115.69	0.00	
16315.00†	90.000	90.129	7267.00	8262.13	880.64	8215.69	0.00	
16415.00†	90.000	90.129	7267.00	8361.66	880.42	8315.69	0.00	
16515.00†	90.000	90.129	7267.00	8461.19	880.20	8415.69	0.00	
16615.00†	90.000	90.129	7267.00	8560.73	879.97	8515.69	0.00	
16715.00†	90.000	90.129	7267.00	8660.26	879.75	8615.69	0.00	
16815.00†	90.000	90.129	7267.00	8759.79	879.52	8715.68	0.00	
16915.00†	90.000	90.129	7267.00	8859.32	879.30	8815.68	0.00	
17015.00†	90.000	90.129	7267.00	8958.85	879.07	8915.68	0.00	
17115.00†	90.000	90.129	7267.00	9058.39	878.85	9015.68	0.00	
17215.00†	90.000	90.129	7267.00	9157.92	878.62	9115.68	0.00	
17315.00†	90.000	90.129	7267.00	9257.45	878.40	9215.68	0.00	
17362.39	90.000	90.129	7267.00 ²	9304.62	878.29	9263.07	0.00	End of Tangent

HOLE & CASING SECTIONS - Ref Wellbore: VARRA #2 PWB Ref Wellpath: VARRA #2 PWP (REV-B.0)

String/Diameter	Start MD [ft]	End MD [ft]	Interval [ft]	Start TVD [ft]	End TVD [ft]	Start N/S [ft]	Start E/W [ft]	End N/S [ft]	End E/W [ft]
7.875in Open Hole	1500.00	17362.39	15862.39	1500.00	N/A	0.00	0.00	N/A	N/A
5.5in Casing Production	15.00	17362.39	17347.39	15.00	N/A	0.00	0.00	N/A	N/A

TARGETS

Name	MD [ft]	TVD [ft]	North [ft]	East [ft]	Grid East [US ft]	Grid North [US ft]	Latitude	Longitude	Shape
VARRA PAD SECTION 04		-9.00	25.87	0.29	3160186.77	1430380.18	40°30'48.118"N	104°55'25.957"W	polygon
VARRA PAD SECTION 05		-9.00	25.87	0.29	3160186.77	1430380.18	40°30'48.118"N	104°55'25.957"W	polygon
2) VARRA #2 BHL ON PLAT	17362.39	7267.00	878.29	9263.07	3169443.50	1431292.74	40°30'56.524"N	104°53'26.027"W	point

REV-1(2440'FSL & 460'FEL,SEC.04)										
1) VARRA #2 LANDING POINT	7751.20	7267.00	899.87	-348.10	3159832.72	1431251.87	40°30'56.754"N	104°55'30.468"W	point	
VARRA PAD CENTER HARDLINES(460' SETBACKS)		7411.00	25.87	0.29	3160186.77	1430380.18	40°30'48.118"N	104°55'25.957"W	polygon	

SURVEY PROGRAM - Ref Wellbore: VARRA #2 PWB					Ref Wellpath: VARRA #2 PWP (REV-B.0)				
Start MD [ft]	End MD [ft]	Positional Uncertainty Model			Log Name/Comment			Wellbore	
15.00	17362.39	NaviTrak (Standard)						VARRA #2 PWB	



Planned Wellpath Report

VARRA #2 PWP (REV-B.0)
Page 8 of 8



REFERENCE WELLPATH IDENTIFICATION

Operator	EXTRACTION OIL & GAS	Slot	SLOT#02 VARRA #2(1719'FSL & 791'FWL,SEC.05)
Area	COLORADO	Well	VARRA #2
Field	WELD COUNTY (NAD83/TRUE NORTH)	Wellbore	VARRA #2 PWB
Facility	SEC.05-T06N-R67W		

DESIGN COMMENTS

MD [ft]	Inclination [°]	Azimuth [°]	TVD [ft]	Comment
15.00	0.000	310.911	15.00	Tie On
1500.00	0.000	310.911	1500.00	End of Tangent
2213.98	14.280	310.911	2206.61	End of Build
6743.55	14.280	310.911	6596.24	End of Tangent
7751.20	90.000	90.129	7267.00	End of 3D Arc
17362.39	90.000	90.129	7267.00	End of Tangent