

# State of Colorado Oil and Gas Conservation Commission

1120 Lincoln Street, Suite 801, Denver, Colorado 80203 (303)894-2100 Fax:(303)894-2109



FOR OGCC USE ONLY

Date 07/28/2015

REM 9192

Doc 2495246

## SITE INVESTIGATION AND REMEDIATION WORKPLAN

This form shall be submitted to the Director for approval prior to the initiation of site investigation and remediation activities. Form 27 is intended to be used whenever possible. Additional documentation will be required when large volumes of soil and groundwater have been impacted or involve large facilities with multiple source areas. See Rule 910. Attach as many pages as needed to fully describe the proposed work.

### CAUSE OF CONDITION BEING INVESTIGATED AND REMEDIATED

☐ Spill or Release ☐ Plug & Abandon ☐ Central Facility Closure ☒ Site/Facility Closure ☐ Other (describe): \_\_\_\_\_

OGCC Employee:

☐ Spill ☐ Complaint☐ Inspection ☐ NOAV

Tracking No:

OGCC Operator Number: 10316

Name of Operator: Mesa Energy Partners, LLC

Address: 1001 17th St., Ste. 1140

City: Denver State: CO Zip: 80202

Contact Name and Telephone:

Dave Cesark

No: 970-549-0956

Fax: \_\_\_\_\_

API Number: 05-103-11760

County: Rio Blanco

Facility Name: \_\_\_\_\_

Facility Number: 418325

Well Name: BDU

Well Number: 13-8-199

Location: (QtrQtr, Sec, Twp, Rng, Meridian): SENE 13-1S-99W, 6th Latitude: \_\_\_\_\_ Longitude: \_\_\_\_\_

### TECHNICAL CONDITIONS

Type of Waste Causing Impact (crude oil, condensate, produced water, etc): RESERVE PIT CONTENTS

Site Conditions: Is location within a sensitive area (according to Rule 901e)? ☒ Y ☐ N If yes, attach evaluation.

Adjacent land use (cultivated, irrigated, dry land farming, industrial, residential, etc.): RANGELAND

Soil type, if not previously identified on Form 2A or Federal Surface Use Plan: SEE FORM 2A

Potential receptors (water wells within 1/4 mi, surface waters, etc.): NEAREST DRAINAGE (INTERMITTENT) 300' AWAY

Description of Impact (if previously provided, refer to that form or document):

Impacted Media (check):

Extent of Impact:

How Determined:



Soils

NOT YET DETERMINED



Vegetation



Groundwater



Surface Water

### REMEDIALATION WORKPLAN

Describe initial action taken (if previously provided, refer to that form or document):

INTERIM RECLAMATION INCLUDING PIT CLOSURE NOTICE PREVIOUSLY-PROVIDED; SEE FORM 2 (DOCUMENT # 400873397). PIT CONTENTS STABILIZATION/REMOVAL ANTICIPATED TO START AS EARLY AS 7/29/15. ADVANCE NOTICE WILL BE PROVIDED PRIOR TO REMOVING PIT LINER.

Describe how source is to be removed:

PIT CONTENTS WILL BE STABILIZED AND EXCAVATED FROM LINER AND PLACED IN ONSITE BERMED CONTAINMENT AREA FOR TREATMENT. LINER WILL BE INSPECTED FOR INTEGRITY, REMOVED AND STOCKPILED TEMPORARILY ONSITE AWAITING TESTING RESULTS.

Describe how remediation of existing impacts is to be accomplished, including removal and disposal at an injection well or licensed facility, land treatment on site, removal of impacted groundwater, insitu bioremediation, burning of oily vegetation, etc.:

PIT CONTENTS WILL BE LANDFARMED ONSITE. FOLLOWING INDEPENDENT CONFIRMATION TESTING OF BOTH CONTENTS AND PIT FLOOR/SIDEWALLS, TREATED SOIL WILL BE USED ONSITE. FOLLOWING INDEPENDENT CONFIRMATION TESTING, PIT LINER WILL BE DISPOSED OF OFFSITE AT THE RIO BLANCO COUNTY LANDFILL.



Tracking Number: \_\_\_\_\_  
Name of Operator: \_\_\_\_\_  
OGCC Operator No: \_\_\_\_\_  
Received Date: \_\_\_\_\_  
Well Name & No: \_\_\_\_\_  
Facility Name & No: \_\_\_\_\_

Page 2

**REMEDATION WORKPLAN (Cont.)**

OGCC Employee: \_\_\_\_\_

**If groundwater has been impacted, describe proposed monitoring plan** (# of wells or sample points, sampling schedule, analytical methods, etc.):

N/A

**Describe reclamation plan.** Discuss existing and new grade recontouring; method and testing of compaction alleviation; and reseeding program, including location of new seed, seed mix and noxious weed prevention. Attach diagram or drawing. Use additional sheet for description if required.

EXCAVATED PIT WILL BE BACKFILLED WITH REMEDIATED PIT CONTENTS/SOIL FOLLOWING INDEPENDENT CONFIRMATION TESTING (IN ACCORDANCE WITH 910 STANDARDS) OF BOTH TREATED MATERIAL AND FLOOR/SIDEWALLS OF PIT. WELL PAD WILL BE RESHAPED/RECONTOURED IN ACCORDANCE WITH PREVIOUSLY-APPROVED FORM 2A FOR SUBJECT LOCATION (SEE ATTACHED "PRODUCTION SCHEMATIC" DIAGRAM). SEEDING WILL TAKE PLACE USING BLM NATIVE SEED MIX #3 AS PRESCRIBED BY SURFACE/MINERAL OWNER.

**Attach samples and analytical results taken to verify remediation of impacts. Show locations of samples on an onsite schematic or drawing.**

**Is further site investigation required?** ☐ Y ☐ N If yes, describe:

**Final disposition of E&P waste** (landtreated and disposed onsite, name of licensed disposal facility, recycling, reuse, etc.):

IMPACTED PIT CONTENTS/SOIL WILL BE LANDFARMED ONSITE AND WILL BE RE-INCORPORATED INTO REMEDIATED PIT FOLLOWING CONFIRMATION SAMPLING. MINIMUM OF 3' OF FILL WILL BE PLACED ON REMEDIATED PIT CONTENTS DURING INTERIM RECLAMATION. PIT LINER WILL BE DISPOSED OF OFFSITE AT A LICENSED DISPOSAL FACILITY (RIO BLANCO COUNTY LANDFILL) FOLLOWING TESTING.

**IMPLEMENTATION SCHEDULE**

Date Site Investigation Began: \_\_\_\_\_ Date Site Investigation Completed: \_\_\_\_\_ Date Remediation Plan Submitted: \_\_\_\_\_  
Remediation Start Date: \_\_\_\_\_ Anticipated Completion Date: \_\_\_\_\_ Actual Completion Date: \_\_\_\_\_

I hereby certify that the statements made in this form are, to the best of my knowledge, true, correct, and complete.

Print Name: DAVID CESARK

Signed: \_\_\_\_\_

Title: VP- ENVIRONMENTAL &REGULATORY AFFAIRS

Date: 7/28/15

OGCC Approved: \_\_\_\_\_ Title: EPS Northwest Date: 7/29/15

# PRODUCTION SCHEMATIC

BDU 13-8-199 PAD

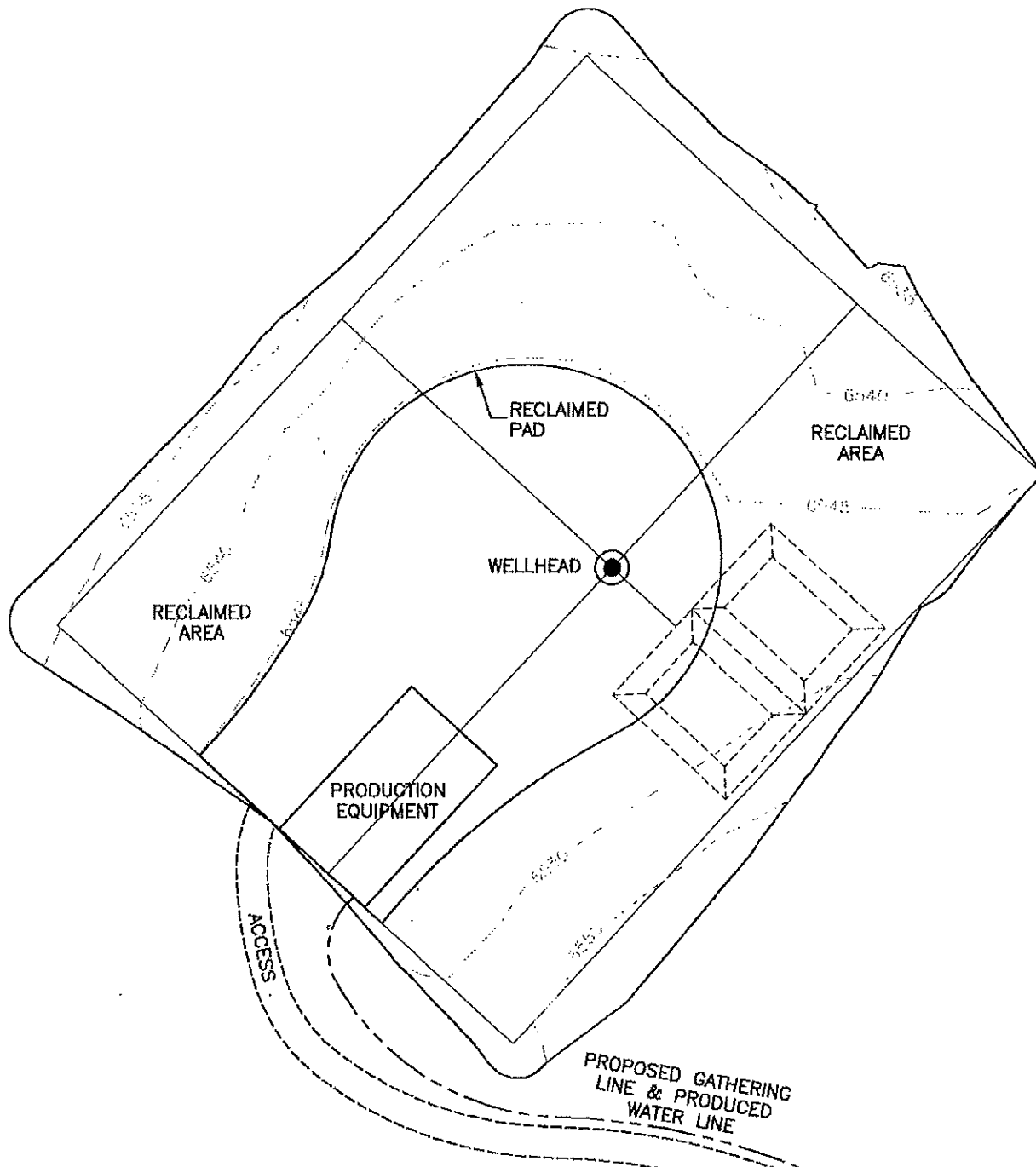

DISTURBANCE ACREAGE:  
5.5± DRILLING OPERATIONS  
1.2± INTERIM RECLAIM

7 OF 12 5/28/10



North

0 80 160  
Graphic Scale in Feet  
1 inch = 80 feet

  
LAND SURVEYING AND MAPPING  
LAFAYETTE - WINTER PARK  
Ph 303 666 0379 Fx 303 665 6320

MESA ENERGY PARTNERS, LLC  
BDU 13-8-199

SE1/4 NE1/4 SEC. 13 T1S R99W  
6th PM RIO BLANCO COUNTY COLORADO