

KERR-MCGEE OIL & GAS ONSHORE LP (WA)

Location: COLORADO Slot: SLOT#13 HUNZIKER 27N-28HZ (433'FSL & 1653'FEL, SEC.28)
 Field: WELD COUNTY (UTM/TRUE NORTH) Well: HUNZIKER 27N-28HZ
 Facility: SEC.28-T2N-R67W Wellbore: HUNZIKER 27N-28HZ PWB

Plot reference wellpath is HUNZIKER 27N-28HZ (REV-B.0) PWP

True vertical depths are referenced to PRECISION 460 (20'KB) (RKB)	Grid System: NAD83 / UTM Zone 13 North, US feet
Measured depths are referenced to PRECISION 460 (20'KB) (RKB)	North Reference: True north
PRECISION 460 (20'KB) (RKB) to Mean Sea Level: 5069 feet	Scale: True distance
Mean Sea Level to Mud line (At Slot: SLOT#13 HUNZIKER 27N-28HZ (433'FSL & 1653'FEL, SEC.28)): 0 feet	Depths are in feet
Coordinates are in feet referenced to Slot	Created by: amarcar on 06/May/2015

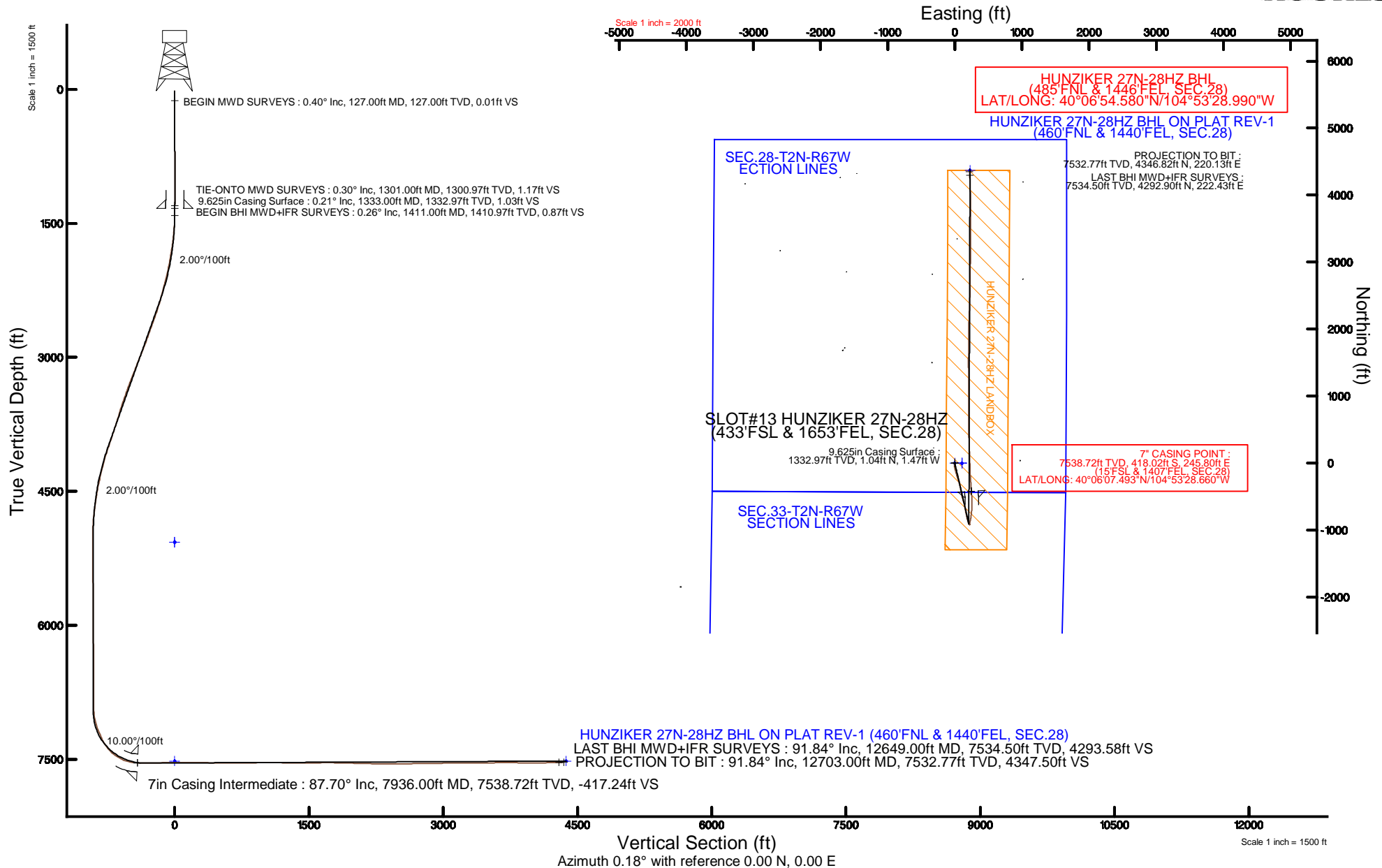



Actual Wellpath Report

HUNZIKER 27N-28HZ AWP

Page 1 of 6



REFERENCE WELLPATH IDENTIFICATION			
Operator	KERR-MCGEE OIL & GAS ONSHORE LP (WA)	Slot	SLOT#13 HUNZIKER 27N-28HZ (433'FSL & 1653'FEL, SEC.28)
Area	COLORADO	Well	HUNZIKER 27N-28HZ
Field	WELD COUNTY (UTM/TRUE NORTH)	Wellbore	HUNZIKER 27N-28HZ AWB <12703>
Facility	SEC.28-T2N-R67W		

REPORT SETUP INFORMATION			
Projection System	NAD83 / UTM Zone 13 North, US feet	Software System	WellArchitect® 4.1.1
North Reference	True	User	Amarcar
Scale	0.999601	Report Generated	05/May/2015 at 16:38
Convergence at slot	0.07° East	Database/Source file	KERR MCGEE UTM/HUNZIKER_27N-28HZ_AWB_12703_.xml

WELLPATH LOCATION						
	Local coordinates		Grid coordinates		Geographic coordinates	
	North[ft]	East[ft]	Easting[US ft]	Northing[US ft]	Latitude	Longitude
Slot Location	-4193.40	-1005.13	1670568.19	14564341.90	40°06'11.624"N	104°53'31.823"W
Facility Reference Pt			1671567.66	14568534.88	40°06'53.064"N	104°53'18.888"W
Field Reference Pt			1698235.31	14552047.82	40°04'09.600"N	104°47'36.000"W

WELLPATH DATUM			
Calculation method	Minimum curvature	PRECISION 460 (20'KB) (RKB) to Facility Vertical Datum	5069.00ft
Horizontal Reference Pt	Slot	PRECISION 460 (20'KB) (RKB) to Mean Sea Level	5069.00ft
Vertical Reference Pt	PRECISION 460 (20'KB) (RKB)	PRECISION 460 (20'KB) (RKB) to Mud Line at Slot (SLOT#13 HUNZIKER 27N-28HZ (433'FSL & 1653'FEL, SEC.28))	5069.00ft
MD Reference Pt	PRECISION 460 (20'KB) (RKB)	Section Origin	N 0.00, E 0.00 ft
Field Vertical Reference	Mean Sea Level	Section Azimuth	0.18°

REFERENCE WELLPATH IDENTIFICATION			
Operator	KERR-MCGEE OIL & GAS ONSHORE LP (WA)	Slot	SLOT#13 HUNZIKER 27N-28HZ (433'FSL & 1653'FEL, SEC.28)
Area	COLORADO	Well	HUNZIKER 27N-28HZ
Field	WELD COUNTY (UTM/TRUE NORTH)	Wellbore	HUNZIKER 27N-28HZ AWP <12703>
Facility	SEC.28-T2N-R67W		

WELLPATH DATA (134 stations) † = interpolated/extrapolated station										
MD [ft]	Inclination [°]	Azimuth [°]	TVD [ft]	Vert Sect [ft]	North [ft]	East [ft]	Latitude	Longitude	DLS [°/100ft]	Comments
0.00†	0.000	88.800	0.00	0.00	0.00	0.00	40°06'11.624"N	104°53'31.823"W	0.00	
20.00	0.000	88.800	20.00	0.00	0.00	0.00	40°06'11.624"N	104°53'31.823"W	0.00	
127.00	0.400	88.800	127.00	0.01	0.01	0.37	40°06'11.624"N	104°53'31.818"W	0.37	BEGIN MWD SURVEYS
217.00	0.700	108.000	216.99	-0.15	-0.16	1.21	40°06'11.622"N	104°53'31.807"W	0.39	
302.00	0.500	75.400	301.99	-0.22	-0.22	2.06	40°06'11.622"N	104°53'31.796"W	0.46	
390.00	0.300	3.400	389.99	0.11	0.10	2.45	40°06'11.625"N	104°53'31.791"W	0.57	
480.00	0.300	292.100	479.99	0.44	0.43	2.24	40°06'11.628"N	104°53'31.794"W	0.39	
575.00	0.500	287.600	574.99	0.65	0.65	1.62	40°06'11.630"N	104°53'31.802"W	0.21	
670.00	0.600	304.600	669.98	1.06	1.05	0.81	40°06'11.634"N	104°53'31.813"W	0.20	
766.00	0.600	304.900	765.98	1.63	1.63	-0.01	40°06'11.640"N	104°53'31.823"W	0.00	
861.00	0.500	268.900	860.97	1.90	1.90	-0.84	40°06'11.643"N	104°53'31.834"W	0.37	
954.00	0.300	159.300	953.97	1.66	1.67	-1.16	40°06'11.640"N	104°53'31.838"W	0.71	
1050.00	0.100	3.200	1049.97	1.51	1.52	-1.06	40°06'11.639"N	104°53'31.837"W	0.41	
1143.00	0.200	258.300	1142.97	1.56	1.56	-1.22	40°06'11.639"N	104°53'31.839"W	0.26	
1239.00	0.200	221.500	1238.97	1.40	1.40	-1.49	40°06'11.638"N	104°53'31.842"W	0.13	
1301.00	0.300	158.200	1300.97	1.17	1.17	-1.50	40°06'11.636"N	104°53'31.842"W	0.44	TIE-ONTO MWD SURVEYS
1411.00	0.260	263.650	1410.97	0.87	0.88	-1.64	40°06'11.633"N	104°53'31.844"W	0.41	BEGIN BHI MWD+IFR SURVEYS
1474.00	2.570	198.300	1473.95	-0.49	-0.48	-2.23	40°06'11.619"N	104°53'31.852"W	3.93	
1564.00	4.480	181.410	1563.77	-5.92	-5.91	-2.95	40°06'11.566"N	104°53'31.861"W	2.39	
1654.00	6.240	180.620	1653.38	-14.32	-14.31	-3.09	40°06'11.483"N	104°53'31.863"W	1.96	
1743.00	8.170	180.960	1741.67	-25.49	-25.48	-3.25	40°06'11.372"N	104°53'31.865"W	2.17	
1833.00	9.600	183.300	1830.59	-39.37	-39.36	-3.79	40°06'11.235"N	104°53'31.872"W	1.64	
1923.00	10.520	173.280	1919.21	-55.03	-55.02	-3.26	40°06'11.080"N	104°53'31.865"W	2.19	
2013.00	11.300	167.720	2007.58	-71.79	-71.79	-0.42	40°06'10.915"N	104°53'31.828"W	1.45	
2103.00	13.740	167.830	2095.44	-90.85	-90.86	3.71	40°06'10.726"N	104°53'31.775"W	2.71	
2193.00	14.760	162.700	2182.67	-112.22	-112.25	9.37	40°06'10.515"N	104°53'31.702"W	1.80	
2283.00	15.870	164.050	2269.47	-134.98	-135.03	16.16	40°06'10.290"N	104°53'31.615"W	1.30	
2373.00	16.950	164.320	2355.81	-159.42	-159.50	23.09	40°06'10.048"N	104°53'31.526"W	1.20	
2462.00	18.250	163.420	2440.64	-185.25	-185.34	30.57	40°06'09.792"N	104°53'31.430"W	1.49	
2552.00	19.980	163.890	2525.67	-213.50	-213.63	38.86	40°06'09.513"N	104°53'31.323"W	1.93	
2642.00	20.710	162.100	2610.06	-243.39	-243.54	48.02	40°06'09.217"N	104°53'31.205"W	1.07	
2732.00	20.670	161.490	2694.25	-273.56	-273.75	57.95	40°06'08.919"N	104°53'31.077"W	0.24	
2822.00	20.330	162.940	2778.56	-303.54	-303.76	67.58	40°06'08.622"N	104°53'30.953"W	0.68	
2912.00	21.130	165.530	2862.73	-334.17	-334.41	76.22	40°06'08.319"N	104°53'30.842"W	1.35	
3002.00	22.320	169.450	2946.34	-366.66	-366.92	83.41	40°06'07.998"N	104°53'30.750"W	2.08	
3092.00	22.560	170.520	3029.53	-400.47	-400.75	89.38	40°06'07.664"N	104°53'30.673"W	0.53	
3181.00	21.520	169.330	3112.02	-433.33	-433.63	95.21	40°06'07.339"N	104°53'30.598"W	1.27	
3271.00	22.060	168.020	3195.59	-466.06	-466.39	101.78	40°06'07.015"N	104°53'30.513"W	0.81	
3361.00	20.710	166.740	3279.39	-498.07	-498.41	108.94	40°06'06.699"N	104°53'30.421"W	1.59	
3451.00	20.980	164.320	3363.50	-529.04	-529.42	116.94	40°06'06.392"N	104°53'30.318"W	1.00	
3541.00	21.140	161.370	3447.49	-559.90	-560.31	126.48	40°06'06.087"N	104°53'30.195"W	1.19	
3631.00	18.530	160.920	3532.15	-588.77	-589.21	136.34	40°06'05.801"N	104°53'30.068"W	2.90	
3720.00	17.160	164.710	3616.87	-614.78	-615.24	144.43	40°06'05.544"N	104°53'29.964"W	2.02	
3810.00	17.780	171.340	3702.72	-641.15	-641.63	150.00	40°06'05.283"N	104°53'29.893"W	2.31	
3900.00	18.440	172.220	3788.27	-668.83	-669.32	154.00	40°06'05.010"N	104°53'29.841"W	0.79	

REFERENCE WELLPATH IDENTIFICATION			
Operator	KERR-MCGEE OIL & GAS ONSHORE LP (WA)	Slot	SLOT#13 HUNZIKER 27N-28HZ (433'FSL & 1653'FEL, SEC.28)
Area	COLORADO	Well	HUNZIKER 27N-28HZ
Field	WELD COUNTY (UTM/TRUE NORTH)	Wellbore	HUNZIKER 27N-28HZ AWP <12703>
Facility	SEC.28-T2N-R67W		

WELLPATH DATA (134 stations) † = interpolated/extrapolated station										
MD [ft]	Inclination [°]	Azimuth [°]	TVD [ft]	Vert Sect [ft]	North [ft]	East [ft]	Latitude	Longitude	DLS [°/100ft]	Comments
3990.00	17.990	172.040	3873.76	-696.68	-697.19	157.85	40°06'04.734"N	104°53'29.792"W	0.50	
4080.00	18.620	169.150	3959.20	-724.55	-725.07	162.48	40°06'04.459"N	104°53'29.732"W	1.23	
4170.00	18.790	168.740	4044.45	-752.86	-753.39	168.01	40°06'04.179"N	104°53'29.661"W	0.24	
4260.00	16.280	167.610	4130.26	-779.38	-779.93	173.55	40°06'03.917"N	104°53'29.590"W	2.81	
4349.00	14.490	166.260	4216.07	-802.36	-802.94	178.87	40°06'03.689"N	104°53'29.521"W	2.05	
4439.00	13.650	166.330	4303.37	-823.60	-824.19	184.05	40°06'03.479"N	104°53'29.454"W	0.93	
4529.00	13.270	165.630	4390.89	-843.91	-844.52	189.13	40°06'03.278"N	104°53'29.389"W	0.46	
4619.00	10.750	160.800	4478.92	-861.83	-862.45	194.45	40°06'03.101"N	104°53'29.321"W	3.01	
4709.00	9.410	155.200	4567.53	-876.42	-877.06	200.30	40°06'02.957"N	104°53'29.245"W	1.84	
4799.00	8.600	156.230	4656.42	-889.24	-889.90	206.10	40°06'02.830"N	104°53'29.171"W	0.92	
4889.00	6.960	159.730	4745.59	-900.50	-901.17	210.70	40°06'02.718"N	104°53'29.112"W	1.90	
4978.00	5.050	153.030	4834.10	-909.04	-909.72	214.35	40°06'02.634"N	104°53'29.065"W	2.28	
5068.00	3.120	140.650	4923.87	-914.45	-915.15	217.69	40°06'02.580"N	104°53'29.022"W	2.35	
5158.00	1.560	100.240	5013.79	-916.55	-917.26	220.45	40°06'02.560"N	104°53'28.986"W	2.42	
5248.00	0.760	69.050	5103.78	-916.55	-917.26	222.22	40°06'02.559"N	104°53'28.963"W	1.10	
5338.00	0.820	48.820	5193.77	-915.91	-916.63	223.26	40°06'02.566"N	104°53'28.950"W	0.32	
5517.00	0.490	340.840	5372.76	-914.34	-915.06	223.97	40°06'02.581"N	104°53'28.941"W	0.44	
5787.00	1.430	335.060	5642.72	-910.20	-910.91	222.17	40°06'02.622"N	104°53'28.964"W	0.35	
5877.00	0.410	261.020	5732.71	-909.24	-909.95	221.38	40°06'02.632"N	104°53'28.974"W	1.53	
6056.00	0.350	280.900	5911.70	-909.24	-909.94	220.21	40°06'02.632"N	104°53'28.989"W	0.08	
6326.00	0.630	338.620	6181.69	-907.70	-908.40	218.86	40°06'02.647"N	104°53'29.007"W	0.20	
6506.00	0.400	309.490	6361.69	-906.39	-907.08	218.01	40°06'02.660"N	104°53'29.017"W	0.19	
6774.00	0.340	358.910	6629.68	-905.00	-905.69	217.28	40°06'02.674"N	104°53'29.027"W	0.12	
7044.00	0.060	259.710	6899.68	-904.22	-904.92	217.12	40°06'02.681"N	104°53'29.029"W	0.13	
7133.00	4.270	21.500	6988.60	-901.14	-901.84	218.29	40°06'02.712"N	104°53'29.014"W	4.83	
7223.00	15.480	18.460	7077.12	-886.57	-887.28	223.34	40°06'02.856"N	104°53'28.949"W	12.46	
7313.00	22.830	10.300	7162.10	-857.93	-858.67	230.28	40°06'03.138"N	104°53'28.860"W	8.67	
7403.00	23.040	10.200	7244.98	-823.40	-824.16	236.52	40°06'03.480"N	104°53'28.779"W	0.24	
7493.00	31.690	8.080	7324.84	-782.56	-783.34	242.97	40°06'03.883"N	104°53'28.696"W	9.67	
7583.00	41.840	6.080	7396.84	-729.15	-729.95	249.49	40°06'04.411"N	104°53'28.612"W	11.35	
7672.00	54.970	0.360	7455.83	-662.86	-663.67	252.88	40°06'05.066"N	104°53'28.569"W	15.50	
7762.00	64.130	0.740	7501.39	-585.36	-586.17	253.63	40°06'05.831"N	104°53'28.559"W	10.18	
7852.00	77.900	356.550	7530.61	-500.52	-501.32	251.50	40°06'06.670"N	104°53'28.587"W	15.92	
7892.00	85.870	355.880	7536.25	-461.05	-461.84	248.88	40°06'07.060"N	104°53'28.620"W	19.99	
7936.00†	87.695	356.081	7538.72	-417.24	-418.02	245.80	40°06'07.493"N	104°53'28.660"W	4.17	7" CASING POINT
7973.00	89.230	356.250	7539.71	-380.34	-381.12	243.33	40°06'07.858"N	104°53'28.692"W	4.17	
8063.00	89.930	356.110	7540.37	-290.56	-291.32	237.34	40°06'08.745"N	104°53'28.769"W	0.79	
8153.00	91.010	357.000	7539.63	-200.75	-201.49	231.93	40°06'09.633"N	104°53'28.838"W	1.55	
8243.00	91.590	358.260	7537.59	-110.86	-111.59	228.21	40°06'10.521"N	104°53'28.886"W	1.54	
8332.00	90.830	357.450	7535.71	-21.96	-22.67	224.88	40°06'11.400"N	104°53'28.929"W	1.25	
8422.00	90.210	358.200	7534.90	67.96	67.26	221.46	40°06'12.289"N	104°53'28.973"W	1.08	
8512.00	88.730	357.770	7535.73	157.89	157.20	218.30	40°06'13.177"N	104°53'29.014"W	1.71	
8602.00	89.720	357.800	7536.95	247.80	247.12	214.82	40°06'14.066"N	104°53'29.058"W	1.10	
8692.00	89.230	358.300	7537.77	337.73	337.06	211.76	40°06'14.955"N	104°53'29.098"W	0.78	
8781.00	89.380	357.720	7538.85	426.66	426.00	208.67	40°06'15.834"N	104°53'29.138"W	0.67	

Actual Wellpath Report

HUNZIKER 27N-28HZ AWP
Page 4 of 6

REFERENCE WELLPATH IDENTIFICATION			
Operator	KERR-MCGEE OIL & GAS ONSHORE LP (WA)	Slot	SLOT#13 HUNZIKER 27N-28HZ (433'FSL & 1653'FEL, SEC.28)
Area	COLORADO	Well	HUNZIKER 27N-28HZ
Field	WELD COUNTY (UTM/TRUE NORTH)	Wellbore	HUNZIKER 27N-28HZ AWP <12703>
Facility	SEC.28-T2N-R67W		

WELLPATH DATA (134 stations)										
MD [ft]	Inclination [°]	Azimuth [°]	TVD [ft]	Vert Sect [ft]	North [ft]	East [ft]	Latitude	Longitude	DLS [°/100ft]	Comments
8871.00	89.320	0.530	7539.87	516.63	515.98	207.29	40°06'16.723"N	104°53'29.155"W	3.12	
8961.00	89.900	0.020	7540.48	606.63	605.97	207.72	40°06'17.612"N	104°53'29.150"W	0.86	
9051.00	91.040	0.180	7539.75	696.63	695.97	207.88	40°06'18.502"N	104°53'29.148"W	1.28	
9141.00	89.720	0.110	7539.15	786.62	785.96	208.11	40°06'19.391"N	104°53'29.145"W	1.47	
9230.00	90.730	0.040	7538.80	875.62	874.96	208.23	40°06'20.270"N	104°53'29.143"W	1.14	
9320.00	91.560	359.570	7537.00	965.60	964.94	207.92	40°06'21.160"N	104°53'29.143"W	1.06	
9410.00	90.000	359.340	7535.78	1055.58	1054.93	207.06	40°06'22.049"N	104°53'29.158"W	1.75	
9500.00	88.450	0.060	7536.99	1145.57	1144.91	206.59	40°06'22.938"N	104°53'29.164"W	1.90	
9590.00	88.800	359.760	7539.15	1235.54	1234.89	206.45	40°06'23.827"N	104°53'29.166"W	0.51	
9680.00	89.470	359.240	7540.51	1325.52	1324.87	205.67	40°06'24.717"N	104°53'29.176"W	0.94	
9769.00	90.550	358.730	7540.50	1414.50	1413.86	204.09	40°06'25.596"N	104°53'29.196"W	1.34	
9859.00	90.670	0.290	7539.54	1504.49	1503.85	203.32	40°06'26.485"N	104°53'29.206"W	1.74	
9949.00	90.550	1.260	7538.58	1594.47	1593.83	204.54	40°06'27.374"N	104°53'29.191"W	1.09	
10039.00	90.730	0.260	7537.57	1684.46	1683.82	205.73	40°06'28.264"N	104°53'29.175"W	1.13	
10129.00	88.670	0.140	7538.05	1774.46	1773.81	206.04	40°06'29.153"N	104°53'29.171"W	2.29	
10219.00	89.070	359.700	7539.82	1864.44	1863.79	205.92	40°06'30.042"N	104°53'29.173"W	0.66	
10309.00	88.180	1.570	7541.98	1954.40	1953.76	206.92	40°06'30.931"N	104°53'29.160"W	2.30	
10398.00	88.950	0.980	7544.21	2043.36	2042.71	208.90	40°06'31.810"N	104°53'29.134"W	1.09	
10488.00	88.150	2.430	7546.49	2133.30	2132.63	211.57	40°06'32.699"N	104°53'29.100"W	1.84	
10578.00	89.160	2.210	7548.60	2223.21	2222.53	215.21	40°06'33.587"N	104°53'29.053"W	1.15	
10668.00	90.180	2.060	7549.12	2313.15	2312.47	218.57	40°06'34.476"N	104°53'29.010"W	1.15	
10757.00	90.180	1.820	7548.84	2402.11	2401.42	221.58	40°06'35.355"N	104°53'28.971"W	0.27	
10847.00	90.150	1.710	7548.58	2492.07	2491.37	224.35	40°06'36.244"N	104°53'28.936"W	0.13	
10938.00	90.060	1.140	7548.41	2583.05	2582.35	226.61	40°06'37.143"N	104°53'28.906"W	0.63	
11027.00	90.210	1.030	7548.20	2672.04	2671.33	228.30	40°06'38.022"N	104°53'28.885"W	0.21	
11117.00	90.670	0.780	7547.51	2762.03	2761.32	229.72	40°06'38.912"N	104°53'28.866"W	0.58	
11207.00	90.950	0.170	7546.24	2852.02	2851.30	230.47	40°06'39.801"N	104°53'28.857"W	0.75	
11297.00	91.500	0.000	7544.31	2942.00	2941.28	230.60	40°06'40.690"N	104°53'28.855"W	0.64	
11387.00	91.010	0.610	7542.34	3031.98	3031.26	231.08	40°06'41.579"N	104°53'28.849"W	0.87	
11476.00	90.030	0.230	7541.54	3120.97	3120.25	231.73	40°06'42.459"N	104°53'28.840"W	1.18	
11566.00	90.640	359.920	7541.01	3210.97	3210.25	231.85	40°06'43.348"N	104°53'28.839"W	0.76	
11656.00	89.750	1.370	7540.70	3300.96	3300.24	232.86	40°06'44.237"N	104°53'28.826"W	1.89	
11746.00	90.520	1.040	7540.49	3390.95	3390.22	234.76	40°06'45.127"N	104°53'28.802"W	0.93	
11835.00	90.610	0.440	7539.61	3479.94	3479.21	235.91	40°06'46.006"N	104°53'28.787"W	0.68	
11925.00	90.920	359.940	7538.41	3569.93	3569.20	236.20	40°06'46.895"N	104°53'28.783"W	0.65	
12015.00	91.350	359.520	7536.63	3659.91	3659.18	235.78	40°06'47.784"N	104°53'28.788"W	0.67	
12105.00	88.640	359.680	7536.64	3749.90	3749.17	235.15	40°06'48.674"N	104°53'28.796"W	3.02	
12194.00	89.130	359.610	7538.37	3838.87	3838.15	234.60	40°06'49.553"N	104°53'28.803"W	0.56	
12284.00	89.470	359.010	7539.47	3928.86	3928.14	233.52	40°06'50.442"N	104°53'28.817"W	0.77	
12374.00	90.210	358.620	7539.72	4018.83	4018.11	231.66	40°06'51.332"N	104°53'28.841"W	0.93	
12464.00	90.860	358.300	7538.88	4108.79	4108.08	229.24	40°06'52.221"N	104°53'28.872"W	0.80	
12554.00	91.350	357.860	7537.14	4198.71	4198.01	226.22	40°06'53.109"N	104°53'28.911"W	0.73	
12649.00	91.840	357.560	7534.50	4293.58	4292.90	222.43	40°06'54.047"N	104°53'28.960"W	0.60	LAST BHI MWD+IFR SURVEYS
12703.00	91.840	357.560	7532.77	4347.50	4346.82	220.13	40°06'54.580"N	104°53'28.990"W	0.00	PROJECTION TO BIT

REFERENCE WELLPATH IDENTIFICATION			
Operator	KERR-MCGEE OIL & GAS ONSHORE LP (WA)	Slot	SLOT#13 HUNZIKER 27N-28HZ (433'FSL & 1653'FEL, SEC.28)
Area	COLORADO	Well	HUNZIKER 27N-28HZ
Field	WELD COUNTY (UTM/TRUE NORTH)	Wellbore	HUNZIKER 27N-28HZ AWB <12703>
Facility	SEC.28-T2N-R67W		

HOLE & CASING SECTIONS - Ref Wellbore: HUNZIKER 27N-28HZ AWB <12703> Ref Wellpath: HUNZIKER 27N-28HZ AWP									
String/Diameter	Start MD [ft]	End MD [ft]	Interval [ft]	Start TVD [ft]	End TVD [ft]	Start N/S [ft]	Start E/W [ft]	End N/S [ft]	End E/W [ft]
13.5in Open Hole	20.00	1342.00	1322.00	20.00	1341.97	0.00	0.00	1.01	-1.47
9.625in Casing Surface	20.00	1333.00	1313.00	20.00	1332.97	0.00	0.00	1.04	-1.47
8.75in Open Hole	1342.00	7947.00	6605.00	1341.97	7539.12	1.01	-1.47	-407.05	245.06
7in Casing Intermediate	20.00	7936.00	7916.00	20.00	7538.72	0.00	0.00	-418.02	245.80
6.125in Open Hole	7947.00	12703.00	4756.00	7539.12	7532.77	-407.05	245.06	4346.82	220.13

TARGETS								
Name	TVD [ft]	North [ft]	East [ft]	Grid East [US ft]	Grid North [US ft]	Latitude	Longitude	Shape
SEC.04-T1N-R67W SECTION LINES	5069.00	-0.68	105.20	1670673.34	14564341.34	40°06'11.617"N	104°53'30.469"W	polygon
SEC.28-T2N-R67W SECTION LINES	5069.00	-0.68	105.20	1670673.34	14564341.34	40°06'11.617"N	104°53'30.469"W	polygon
SEC.33-T2N-R67W SECTION LINES	5069.00	-0.68	105.20	1670673.34	14564341.34	40°06'11.617"N	104°53'30.469"W	polygon
HUNZIKER 27N-28HZ BHL ON PLAT REV-1 (460'FNL & 1440'FEL, SEC.28)	7519.00	4371.93	226.29	1670789.08	14568712.35	40°06'54.828"N	104°53'28.910"W	point
HUNZIKER 27N-28HZ LANDBOX	7519.00	0.00	0.00	1670568.19	14564341.90	40°06'11.624"N	104°53'31.823"W	polygon

WELLPATH COMPOSITION - Ref Wellbore: HUNZIKER 27N-28HZ AWB <12703> Ref Wellpath: HUNZIKER 27N-28HZ AWP					
Start MD [ft]	End MD [ft]	Positional Uncertainty Model	Log Name/Comment	Wellbore	
20.00	1301.00	ISCWSA MWD, Rev. 2 (Standard)	CATHEDRAL MWD SURVEYS 13.5" <127-1301>	HUNZIKER 27N-28HZ AWB <12703>	
1301.00	7892.00	Custom APC ISCWSA REV 2 MWD+IFR1+SC (approximation)	BHI MWD+IFR SURVEYS 8.75' <1411-7892>	HUNZIKER 27N-28HZ AWB <12703>	
7892.00	12649.00	Custom APC ISCWSA REV 2 MWD+IFR1+SC (approximation)	BHI MWD+IFR SURVEYS 6.125" <7973-12649>	HUNZIKER 27N-28HZ AWB <12703>	
12649.00	12703.00	Blind Drilling (std)	Projection to bit	HUNZIKER 27N-28HZ AWB <12703>	



Actual Wellpath Report

HUNZIKER 27N-28HZ AWP
Page 6 of 6



REFERENCE WELLPATH IDENTIFICATION			
Operator	KERR-MCGEE OIL & GAS ONSHORE LP (WA)	Slot	SLOT#13 HUNZIKER 27N-28HZ (433'FSL & 1653'FEL, SEC.28)
Area	COLORADO	Well	HUNZIKER 27N-28HZ
Field	WELD COUNTY (UTM/TRUE NORTH)	Wellbore	HUNZIKER 27N-28HZ AWB <12703>
Facility	SEC.28-T2N-R67W		

WELLPATH COMMENTS					
MD [ft]	Inclination [°]	Azimuth [°]	TVD [ft]	Comment	
127.00	0.400	88.800	127.00	BEGIN MWD SURVEYS	
1301.00	0.300	158.200	1300.97	TIE-ONTO MWD SURVEYS	
1411.00	0.260	263.650	1410.97	BEGIN BHI MWD+IFR SURVEYS	
7936.00	87.695	356.081	7538.72	7" CASING POINT	
12649.00	91.840	357.560	7534.50	LAST BHI MWD+IFR SURVEYS	
12703.00	91.840	357.560	7532.77	PROJECTION TO BIT	