

Location:	COLORADO	Slot:	SLOT#11 HUNZIKER 1N-28HZ (433'FSL & 1623'FEL, SEC.28)
Field:	WELD COUNTY (UTM/TRUE NORTH)	Well:	HUNZIKER 1N-28HZ
Facility:	SEC.28-T2N-R67W	Wellbore:	HUNZIKER 1N-28HZ PWB

Plot reference wellpath is HUNZIKER 1N-28HZ (REV-B.0) PWP	
True vertical depths are referenced to PRECISION 460 (20'KB) (RKB)	Grid System: NAD83 / UTM Zone 13 North, US feet
Measured depths are referenced to PRECISION 460 (20'KB) (RKB)	North Reference: True north
PRECISION 460 (20'KB) (RKB) to Mean Sea Level: 5069 feet	Scale: True distance
Mean Sea Level to Mud line (At Slot: SLOT#11 HUNZIKER 1N-28HZ (433'FSL & 1623'FEL, SEC.28)): 0 feet	Depths are in feet
Coordinates are in level referenced to Slot	Created by: amarcos on 04/May/2015

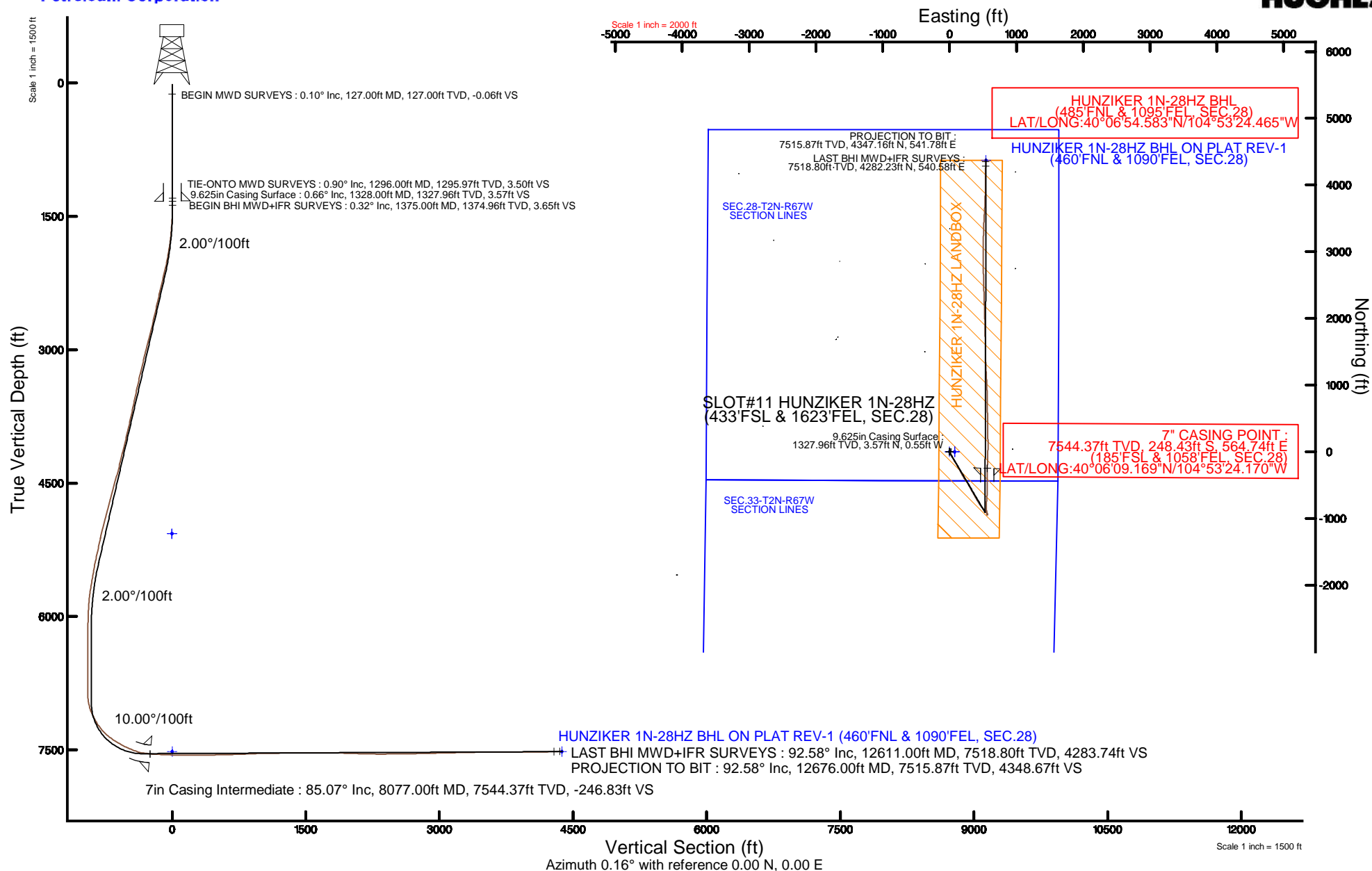



Actual Wellpath Report

HUNZIKER 1N-28HZ AWP

Page 1 of 6



REFERENCE WELLPATH IDENTIFICATION

Operator	KERR-MCGEE OIL & GAS ONSHORE LP (WA)	Slot	SLOT#11 HUNZIKER 1N-28HZ (433'FSL & 1623'FEL, SEC.28)
Area	COLORADO	Well	HUNZIKER 1N-28HZ
Field	WELD COUNTY (UTM/TRUE NORTH)	Wellbore	HUNZIKER 1N-28HZ AWP <12676>
Facility	SEC.28-T2N-R67W		

REPORT SETUP INFORMATION

Projection System	NAD83 / UTM Zone 13 North, US feet	Software System	WellArchitect® 4.1.1
North Reference	True	User	Amarcar
Scale	0.999601	Report Generated	04/May/2015 at 16:03
Convergence at slot	0.07° East	Database/Source file	KERR MCGEE UTM/ _HUNZIKER_ 1N-28HZ_AWP_ 12676_.xml

WELLPATH LOCATION

	Local coordinates		Grid coordinates		Geographic coordinates	
	North[ft]	East[ft]	Easting[US ft]	Northing[US ft]	Latitude	Longitude
Slot Location	-4193.41	-975.21	1670598.09	14564341.93	40°06'11.624"N	104°53'31.438"W
Facility Reference Pt			1671567.66	14568534.88	40°06'53.064"N	104°53'18.888"W
Field Reference Pt			1698235.31	14552047.82	40°04'09.600"N	104°47'36.000"W

WELLPATH DATUM

Calculation method	Minimum curvature	PRECISION 460 (20'KB) (RKB) to Facility Vertical Datum	5069.00ft
Horizontal Reference Pt	Slot	PRECISION 460 (20'KB) (RKB) to Mean Sea Level	5069.00ft
Vertical Reference Pt	PRECISION 460 (20'KB) (RKB)	PRECISION 460 (20'KB) (RKB) to Mud Line at Slot (SLOT#11 HUNZIKER 1N-28HZ (433'FSL & 1623'FEL, SEC.28))	5069.00ft
MD Reference Pt	PRECISION 460 (20'KB) (RKB)	Section Origin	N 0.00, E 0.00 ft
Field Vertical Reference	Mean Sea Level	Section Azimuth	0.16°

REFERENCE WELLPATH IDENTIFICATION			
Operator	KERR-MCGEE OIL & GAS ONSHORE LP (WA)	Slot	SLOT#11 HUNZIKER 1N-28HZ (433'FSL & 1623'FEL, SEC.28)
Area	COLORADO	Well	HUNZIKER 1N-28HZ
Field	WELD COUNTY (UTM/TRUE NORTH)	Wellbore	HUNZIKER 1N-28HZ AWB <12676>
Facility	SEC.28-T2N-R67W		

WELLPATH DATA (115 stations) † = interpolated/extrapolated station										
MD [ft]	Inclination [°]	Azimuth [°]	TVD [ft]	Vert Sect [ft]	North [ft]	East [ft]	Latitude	Longitude	DLS [°/100ft]	Comments
0.00†	0.000	227.400	0.00	0.00	0.00	0.00	40°06'11.624"N	104°53'31.438"W	0.00	
20.00	0.000	227.400	20.00	0.00	0.00	0.00	40°06'11.624"N	104°53'31.438"W	0.00	
127.00	0.100	227.400	127.00	-0.06	-0.06	-0.07	40°06'11.623"N	104°53'31.439"W	0.09	BEGIN MWD SURVEYS
245.00	0.100	48.000	245.00	-0.06	-0.06	-0.07	40°06'11.623"N	104°53'31.439"W	0.17	
330.00	0.200	98.400	330.00	-0.04	-0.04	0.13	40°06'11.624"N	104°53'31.436"W	0.18	
420.00	0.200	21.100	420.00	0.09	0.09	0.35	40°06'11.625"N	104°53'31.434"W	0.28	
511.00	0.200	55.600	511.00	0.33	0.33	0.53	40°06'11.627"N	104°53'31.431"W	0.13	
605.00	0.500	50.400	605.00	0.68	0.68	0.99	40°06'11.631"N	104°53'31.425"W	0.32	
700.00	0.400	50.500	699.99	1.16	1.15	1.56	40°06'11.635"N	104°53'31.418"W	0.11	
796.00	0.600	30.000	795.99	1.81	1.80	2.07	40°06'11.642"N	104°53'31.411"W	0.28	
891.00	0.700	28.100	890.98	2.75	2.75	2.59	40°06'11.651"N	104°53'31.405"W	0.11	
987.00	0.100	264.500	986.98	3.26	3.26	2.79	40°06'11.656"N	104°53'31.402"W	0.79	
1083.00	0.500	255.400	1082.98	3.15	3.14	2.30	40°06'11.655"N	104°53'31.408"W	0.42	
1177.00	0.700	283.400	1176.98	3.17	3.17	1.34	40°06'11.655"N	104°53'31.421"W	0.37	
1272.00	0.700	283.100	1271.97	3.44	3.44	0.21	40°06'11.658"N	104°53'31.435"W	0.00	
1296.00	0.900	278.400	1295.97	3.50	3.50	-0.12	40°06'11.659"N	104°53'31.440"W	0.88	TIE-ONTO MWD SURVEYS
1375.00	0.320	287.060	1374.96	3.65	3.65	-0.94	40°06'11.660"N	104°53'31.450"W	0.74	BEGIN BHI MWD+IFR SURVEYS
1469.00	1.790	170.970	1468.95	2.28	2.28	-0.96	40°06'11.647"N	104°53'31.450"W	2.08	
1559.00	3.790	174.760	1558.84	-2.07	-2.07	-0.47	40°06'11.604"N	104°53'31.444"W	2.23	
1649.00	5.030	153.340	1648.57	-8.55	-8.56	1.57	40°06'11.539"N	104°53'31.418"W	2.27	
1739.00	7.410	149.380	1738.04	-17.06	-17.08	6.30	40°06'11.455"N	104°53'31.357"W	2.69	
1829.00	9.520	152.560	1827.05	-28.65	-28.68	12.69	40°06'11.341"N	104°53'31.275"W	2.40	
1919.00	10.790	151.790	1915.64	-42.65	-42.71	20.10	40°06'11.202"N	104°53'31.179"W	1.42	
2008.00	13.060	150.280	2002.71	-58.71	-58.79	29.02	40°06'11.043"N	104°53'31.065"W	2.57	
2098.00	14.300	148.940	2090.16	-77.03	-77.14	39.80	40°06'10.862"N	104°53'30.926"W	1.42	
2188.00	16.010	151.630	2177.03	-97.44	-97.58	51.43	40°06'10.660"N	104°53'30.776"W	2.05	
2278.00	15.280	151.510	2263.69	-118.75	-118.93	62.99	40°06'10.449"N	104°53'30.627"W	0.81	
2368.00	14.140	148.400	2350.74	-138.51	-138.72	74.40	40°06'10.253"N	104°53'30.481"W	1.54	
2458.00	15.240	147.630	2437.80	-157.83	-158.07	86.50	40°06'10.062"N	104°53'30.325"W	1.24	
2548.00	14.530	146.440	2524.78	-177.19	-177.47	99.07	40°06'09.870"N	104°53'30.163"W	0.86	
2638.00	15.070	149.880	2611.79	-196.68	-197.00	111.18	40°06'09.677"N	104°53'30.007"W	1.15	
2728.00	14.320	148.410	2698.85	-216.25	-216.60	122.89	40°06'09.484"N	104°53'29.857"W	0.93	
2817.00	16.660	152.260	2784.61	-236.89	-237.27	134.59	40°06'09.279"N	104°53'29.706"W	2.87	
2907.00	16.240	153.460	2870.93	-259.53	-259.95	146.22	40°06'09.055"N	104°53'29.556"W	0.60	
2997.00	15.970	153.110	2957.40	-281.80	-282.25	157.44	40°06'08.835"N	104°53'29.412"W	0.32	
3087.00	15.340	152.870	3044.06	-303.41	-303.89	168.47	40°06'08.621"N	104°53'29.270"W	0.70	
3177.00	14.610	152.730	3131.00	-324.06	-324.57	179.10	40°06'08.417"N	104°53'29.133"W	0.81	
3357.00	15.340	151.320	3304.89	-365.07	-365.64	200.93	40°06'08.011"N	104°53'28.852"W	0.45	
3536.00	13.410	147.990	3478.28	-403.38	-404.01	223.30	40°06'07.631"N	104°53'28.564"W	1.17	
3626.00	15.530	143.720	3565.42	-421.91	-422.58	235.96	40°06'07.448"N	104°53'28.401"W	2.64	
3716.00	14.690	141.700	3652.31	-440.54	-441.25	250.16	40°06'07.264"N	104°53'28.219"W	1.10	
3806.00	14.800	146.970	3739.35	-459.09	-459.84	263.50	40°06'07.080"N	104°53'28.047"W	1.49	
3896.00	14.040	151.550	3826.52	-478.30	-479.08	274.97	40°06'06.890"N	104°53'27.899"W	1.52	
3986.00	15.400	149.930	3913.56	-498.21	-499.02	286.16	40°06'06.693"N	104°53'27.756"W	1.58	
4075.00	14.480	148.840	3999.55	-517.92	-518.77	297.84	40°06'06.497"N	104°53'27.605"W	1.08	

REFERENCE WELLPATH IDENTIFICATION			
Operator	KERR-MCGEE OIL & GAS ONSHORE LP (WA)	Slot	SLOT#11 HUNZIKER 1N-28HZ (433'FSL & 1623'FEL, SEC.28)
Area	COLORADO	Well	HUNZIKER 1N-28HZ
Field	WELD COUNTY (UTM/TRUE NORTH)	Wellbore	HUNZIKER 1N-28HZ AWB <12676>
Facility	SEC.28-T2N-R67W		

WELLPATH DATA (115 stations) † = interpolated/extrapolated station										
MD [ft]	Inclination [°]	Azimuth [°]	TVD [ft]	Vert Sect [ft]	North [ft]	East [ft]	Latitude	Longitude	DLS [°/100ft]	Comments
4165.00	15.550	155.700	4086.48	-538.52	-539.39	308.62	40°06'06.294"N	104°53'27.466"W	2.30	
4255.00	14.670	154.180	4173.37	-559.74	-560.65	318.55	40°06'06.084"N	104°53'27.339"W	1.07	
4345.00	16.930	147.550	4259.97	-581.03	-581.97	330.55	40°06'05.873"N	104°53'27.184"W	3.21	
4435.00	16.580	146.700	4346.15	-602.78	-603.76	344.63	40°06'05.658"N	104°53'27.003"W	0.47	
4525.00	18.270	152.770	4432.03	-626.02	-627.04	358.14	40°06'05.427"N	104°53'26.829"W	2.76	
4704.00	15.750	150.160	4603.19	-671.98	-673.07	383.07	40°06'04.973"N	104°53'26.508"W	1.47	
4794.00	18.030	150.140	4689.30	-694.62	-695.75	396.08	40°06'04.749"N	104°53'26.341"W	2.53	
4974.00	17.520	149.250	4860.70	-741.99	-743.19	423.80	40°06'04.280"N	104°53'25.984"W	0.32	
5243.00	14.740	145.190	5119.10	-804.78	-806.10	464.05	40°06'03.658"N	104°53'25.466"W	1.11	
5423.00	16.360	137.730	5292.52	-842.26	-843.66	494.18	40°06'03.287"N	104°53'25.079"W	1.43	
5513.00	16.160	134.020	5378.92	-860.30	-861.75	511.71	40°06'03.108"N	104°53'24.853"W	1.18	
5603.00	14.710	136.900	5465.68	-877.30	-878.80	528.53	40°06'02.940"N	104°53'24.637"W	1.82	
5693.00	11.590	143.500	5553.31	-892.88	-894.41	541.72	40°06'02.785"N	104°53'24.467"W	3.84	
5782.00	11.260	145.830	5640.55	-907.22	-908.79	551.91	40°06'02.643"N	104°53'24.336"W	0.64	
5872.00	9.460	151.170	5729.08	-920.95	-922.54	560.42	40°06'02.507"N	104°53'24.226"W	2.26	
5962.00	5.360	154.050	5818.31	-931.20	-932.80	565.83	40°06'02.406"N	104°53'24.157"W	4.57	
6052.00	4.450	147.560	5907.98	-937.91	-939.53	569.54	40°06'02.339"N	104°53'24.109"W	1.18	
6142.00	1.950	203.150	5997.85	-942.27	-943.88	570.81	40°06'02.296"N	104°53'24.093"W	4.13	
6501.00	0.770	263.850	6356.75	-948.16	-949.76	566.01	40°06'02.238"N	104°53'24.154"W	0.48	
6859.00	0.530	280.190	6714.73	-948.13	-949.72	561.99	40°06'02.239"N	104°53'24.206"W	0.08	
6999.00	0.400	241.080	6854.73	-948.26	-949.85	560.92	40°06'02.237"N	104°53'24.220"W	0.24	
7085.00	7.370	353.550	6940.49	-942.92	-944.50	560.04	40°06'02.290"N	104°53'24.231"W	8.76	
7129.00	12.530	357.120	6983.82	-935.34	-936.93	559.48	40°06'02.365"N	104°53'24.238"W	11.81	
7174.00	16.460	353.840	7027.38	-924.12	-925.71	558.55	40°06'02.476"N	104°53'24.250"W	8.92	
7219.00	22.420	353.290	7069.79	-909.26	-910.83	556.86	40°06'02.623"N	104°53'24.272"W	13.25	
7264.00	26.790	353.280	7110.70	-890.66	-892.23	554.67	40°06'02.807"N	104°53'24.300"W	9.71	
7309.00	28.230	351.920	7150.61	-870.06	-871.62	551.99	40°06'03.010"N	104°53'24.335"W	3.49	
7353.00	30.270	352.280	7189.00	-848.77	-850.33	549.04	40°06'03.221"N	104°53'24.373"W	4.65	
7398.00	33.730	358.290	7227.16	-825.04	-826.59	547.14	40°06'03.456"N	104°53'24.397"W	10.44	
7443.00	39.200	4.900	7263.35	-798.35	-799.90	547.98	40°06'03.719"N	104°53'24.386"W	14.95	
7488.00	44.300	5.300	7296.91	-768.50	-770.06	550.65	40°06'04.014"N	104°53'24.352"W	11.35	
7533.00	49.380	5.270	7327.69	-735.82	-737.39	553.67	40°06'04.337"N	104°53'24.313"W	11.29	
7578.00	51.660	5.720	7356.30	-701.24	-702.82	557.00	40°06'04.679"N	104°53'24.270"W	5.13	
7623.00	55.290	3.520	7383.08	-665.19	-666.78	559.90	40°06'05.035"N	104°53'24.233"W	8.97	
7668.00	58.100	1.750	7407.78	-627.63	-629.22	561.62	40°06'05.406"N	104°53'24.211"W	7.06	
7713.00	59.930	1.670	7430.95	-589.06	-590.66	562.77	40°06'05.787"N	104°53'24.196"W	4.07	
7758.00	62.680	0.450	7452.56	-549.60	-551.20	563.49	40°06'06.177"N	104°53'24.187"W	6.56	
7803.00	65.320	359.450	7472.28	-509.16	-510.75	563.45	40°06'06.577"N	104°53'24.187"W	6.20	
7848.00	67.130	359.050	7490.42	-467.98	-469.58	562.91	40°06'06.983"N	104°53'24.194"W	4.10	
7893.00	69.290	358.400	7507.12	-426.22	-427.81	561.98	40°06'07.396"N	104°53'24.206"W	4.98	
7937.00	73.040	0.850	7521.33	-384.58	-386.17	561.72	40°06'07.808"N	104°53'24.209"W	10.02	
8027.00	83.630	1.310	7539.50	-296.58	-298.17	563.38	40°06'08.677"N	104°53'24.188"W	11.78	
8037.00	84.040	1.370	7540.57	-286.64	-288.24	563.62	40°06'08.776"N	104°53'24.185"W	4.14	
8077.00†	85.066	1.849	7544.37	-246.83	-248.43	564.74	40°06'09.169"N	104°53'24.170"W	2.83	7" CASING POINT
8145.00	86.810	2.660	7549.19	-179.05	-180.66	567.40	40°06'09.839"N	104°53'24.136"W	2.83	

Actual Wellpath Report

HUNZIKER 1N-28HZ AWP
Page 4 of 6

REFERENCE WELLPATH IDENTIFICATION			
Operator	KERR-MCGEE OIL & GAS ONSHORE LP (WA)	Slot	SLOT#11 HUNZIKER 1N-28HZ (433'FSL & 1623'FEL, SEC.28)
Area	COLORADO	Well	HUNZIKER 1N-28HZ
Field	WELD COUNTY (UTM/TRUE NORTH)	Wellbore	HUNZIKER 1N-28HZ AWB <12676>
Facility	SEC.28-T2N-R67W		

WELLPATH DATA (115 stations)										
MD [ft]	Inclination [°]	Azimuth [°]	TVD [ft]	Vert Sect [ft]	North [ft]	East [ft]	Latitude	Longitude	DLS [°/100ft]	Comments
8325.00	88.330	1.050	7556.82	0.69	-0.93	573.22	40°06'11.615"N	104°53'24.061"W	1.23	
8504.00	90.030	359.240	7559.38	179.66	178.04	573.68	40°06'13.383"N	104°53'24.055"W	1.39	
8684.00	90.640	358.850	7558.33	359.62	358.01	570.68	40°06'15.162"N	104°53'24.094"W	0.40	
8864.00	91.350	359.220	7555.20	539.56	537.96	567.64	40°06'16.940"N	104°53'24.133"W	0.44	
9043.00	92.000	359.380	7549.97	718.46	716.87	565.46	40°06'18.708"N	104°53'24.161"W	0.37	
9223.00	92.550	357.850	7542.83	898.25	896.67	561.11	40°06'20.485"N	104°53'24.217"W	0.90	
9312.00	91.160	357.710	7539.95	987.12	985.55	557.67	40°06'21.363"N	104°53'24.261"W	1.57	
9582.00	90.730	356.720	7535.49	1256.73	1255.19	544.55	40°06'24.028"N	104°53'24.430"W	0.40	
9762.00	90.090	358.940	7534.20	1436.56	1435.04	537.73	40°06'25.805"N	104°53'24.517"W	1.28	
9941.00	91.040	359.820	7532.44	1615.53	1614.02	535.80	40°06'27.574"N	104°53'24.542"W	0.72	
10031.00	89.530	358.260	7531.99	1705.51	1704.00	534.29	40°06'28.463"N	104°53'24.562"W	2.41	
10301.00	88.120	358.700	7537.53	1975.33	1973.84	527.13	40°06'31.130"N	104°53'24.654"W	0.55	
10570.00	88.540	357.820	7545.37	2244.06	2242.60	518.96	40°06'33.786"N	104°53'24.759"W	0.36	
10750.00	91.070	358.600	7545.98	2423.94	2422.50	513.34	40°06'35.563"N	104°53'24.831"W	1.47	
10930.00	90.670	358.470	7543.25	2603.85	2602.42	508.74	40°06'37.341"N	104°53'24.890"W	0.23	
11109.00	91.230	358.050	7540.28	2782.72	2781.31	503.31	40°06'39.109"N	104°53'24.960"W	0.39	
11286.00	91.380	0.650	7536.25	2959.64	2958.24	501.30	40°06'40.858"N	104°53'24.986"W	1.47	
11469.00	91.230	1.480	7532.08	3142.57	3141.16	504.70	40°06'42.665"N	104°53'24.942"W	0.46	
11648.00	91.530	1.240	7527.77	3321.48	3320.05	508.95	40°06'44.433"N	104°53'24.887"W	0.21	
11828.00	89.750	3.820	7525.76	3501.29	3499.84	516.89	40°06'46.210"N	104°53'24.785"W	1.74	
12007.00	90.460	3.070	7525.43	3679.99	3678.52	527.65	40°06'47.976"N	104°53'24.647"W	0.58	
12187.00	89.440	0.980	7525.59	3859.89	3858.39	534.01	40°06'49.753"N	104°53'24.565"W	1.29	
12366.00	90.580	0.750	7525.56	4038.87	4037.37	536.71	40°06'51.522"N	104°53'24.530"W	0.65	
12611.00	92.580	1.060	7518.80	4283.74	4282.23	540.58	40°06'53.942"N	104°53'24.480"W	0.83	LAST BHI MWD+IFR SURVEYS
12676.00	92.580	1.060	7515.87	4348.67	4347.16	541.78	40°06'54.583"N	104°53'24.465"W	0.00	PROJECTION TO BIT

HOLE & CASING SECTIONS - Ref Wellbore: HUNZIKER 1N-28HZ AWB <12676> Ref Wellpath: HUNZIKER 1N-28HZ AWP									
String/Diameter	Start MD [ft]	End MD [ft]	Interval [ft]	Start TVD [ft]	End TVD [ft]	Start N/S [ft]	Start E/W [ft]	End N/S [ft]	End E/W [ft]
13.5in Open Hole	20.00	1340.00	1320.00	20.00	1339.96	0.00	0.00	3.59	-0.68
9.625in Casing Surface	20.00	1328.00	1308.00	20.00	1327.96	0.00	0.00	3.57	-0.55
8.75in Open Hole	1340.00	8087.00	6747.00	1339.96	7545.21	3.59	-0.68	-238.47	565.07
7in Casing Intermediate	20.00	8077.00	8057.00	20.00	7544.37	0.00	0.00	-248.43	564.74
6.125in Open Hole	8087.00	12676.00	4589.00	7545.21	7515.87	-238.47	565.07	4347.16	541.78



Actual Wellpath Report

HUNZIKER 1N-28HZ AWP

Page 5 of 6



REFERENCE WELLPATH IDENTIFICATION			
Operator	KERR-MCGEE OIL & GAS ONSHORE LP (WA)	Slot	SLOT#11 HUNZIKER 1N-28HZ (433'FSL & 1623'FEL, SEC.28)
Area	COLORADO	Well	HUNZIKER 1N-28HZ
Field	WELD COUNTY (UTM/TRUE NORTH)	Wellbore	HUNZIKER 1N-28HZ AWB <12676>
Facility	SEC.28-T2N-R67W		

TARGETS								
Name	TVD [ft]	North [ft]	East [ft]	Grid East [US ft]	Grid North [US ft]	Latitude	Longitude	Shape
SEC.04-T1N-R67W SECTION LINES	5069.00	-0.68	75.28	1670673.34	14564341.34	40°06'11.617"N	104°53'30.469"W	polygon
SEC.28-T2N-R67W SECTION LINES	5069.00	-0.68	75.28	1670673.34	14564341.34	40°06'11.617"N	104°53'30.469"W	polygon
SEC.33-T2N-R67W SECTION LINES	5069.00	-0.68	75.28	1670673.34	14564341.34	40°06'11.617"N	104°53'30.469"W	polygon
HUNZIKER 1N-28HZ BHL ON PLAT REV-1 (460'FNL & 1090'FEL, SEC.28)	7519.00	4372.30	546.27	1671138.84	14568713.14	40°06'54.832"N	104°53'24.407"W	point
HUNZIKER 1N-28HZ LANDBOX	7519.00	0.00	0.00	1670598.09	14564341.93	40°06'11.624"N	104°53'31.438"W	polygon

WELLPATH COMPOSITION - Ref Wellbore: HUNZIKER 1N-28HZ AWB <12676>				Ref Wellpath: HUNZIKER 1N-28HZ AWP	
Start MD [ft]	End MD [ft]	Positional Uncertainty Model	Log Name/Comment		Wellbore
20.00	1296.00	ISCWSA MWD, Rev. 2 (Standard)	CATHEDRAL MWD SURVEYS 13.5" <127-1296>		HUNZIKER 1N-28HZ AWB <12676>
1296.00	8037.00	Custom APC ISCWSA REV 2 MWD+IFR1+SC (approximation)	BHI MWD+IFR SURVEYS 8.75" <1375-8037>		HUNZIKER 1N-28HZ AWB <12676>
8037.00	12611.00	Custom APC ISCWSA REV 2 MWD+IFR1+SC (approximation)	BHI MWD+IFR 6.125" <8145-12611>		HUNZIKER 1N-28HZ AWB <12676>
12611.00	12676.00	Blind Drilling (std)	Projection to bit		HUNZIKER 1N-28HZ AWB <12676>



Actual Wellpath Report

HUNZIKER 1N-28HZ AWP
Page 6 of 6



REFERENCE WELLPATH IDENTIFICATION			
Operator	KERR-MCGEE OIL & GAS ONSHORE LP (WA)	Slot	SLOT#11 HUNZIKER 1N-28HZ (433'FSL & 1623'FEL, SEC.28)
Area	COLORADO	Well	HUNZIKER 1N-28HZ
Field	WELD COUNTY (UTM/TRUE NORTH)	Wellbore	HUNZIKER 1N-28HZ AWB <12676>
Facility	SEC.28-T2N-R67W		

WELLPATH COMMENTS					
MD [ft]	Inclination [°]	Azimuth [°]	TVD [ft]	Comment	
127.00	0.100	227.400	127.00	BEGIN MWD SURVEYS	
1296.00	0.900	278.400	1295.97	TIE-ONTO MWD SURVEYS	
1375.00	0.320	287.060	1374.96	BEGIN BHI MWD+IFR SURVEYS	
8077.00	85.066	1.849	7544.37	7" CASING POINT	
12611.00	92.580	1.060	7518.80	LAST BHI MWD+IFR SURVEYS	
12676.00	92.580	1.060	7515.87	PROJECTION TO BIT	