

Location:	COLORADO	Slot:	SLOT#04 DT-HABITAT C4-5-6 (398'FNL & 1684'FEL, SEC.05)
Field:	WELD COUNTY (NAD83/TRUE NORTH)	Well:	DT-HABITAT C4-5-6
Facility:	SEC.05-T05N-R65W	Wellbore:	DT-HABITAT C4-5-6 PWB



BGGM (1945.0 to 2017.0) Dip: 67.01° Field: 52661 nT  
Magnetic North is 8.53 degrees East of True North (at 5/28/2015)

To correct azimuth from Magnetic to True add 8.53 degrees

Plot reference wellpath is DT-HABITAT C4-5-6 PWP (REV-B.0)	
True vertical depths are referenced to SAVANNA 802 (15KB) (RKB)	Grid System: NAD83 / Lambert Colorado SP. Northern Zone (501), US feet
Measured depths are referenced to SAVANNA 802 (15KB) (RKB)	North Reference: True north
SAVANNA 802 (15KB) (RKB) to Mean Sea Level: 4655 feet	Scale: True distance
Mean Sea Level to Mud line (At Slot: SLOTR04 DT-HABITAT C4-5-6 (398°FNL & 1684°FEL, SEC.05): 0 feet	Depths are in feet
Coordinates are in feet referenced to Slot	Created by: ingmjmr on 6/26/2015

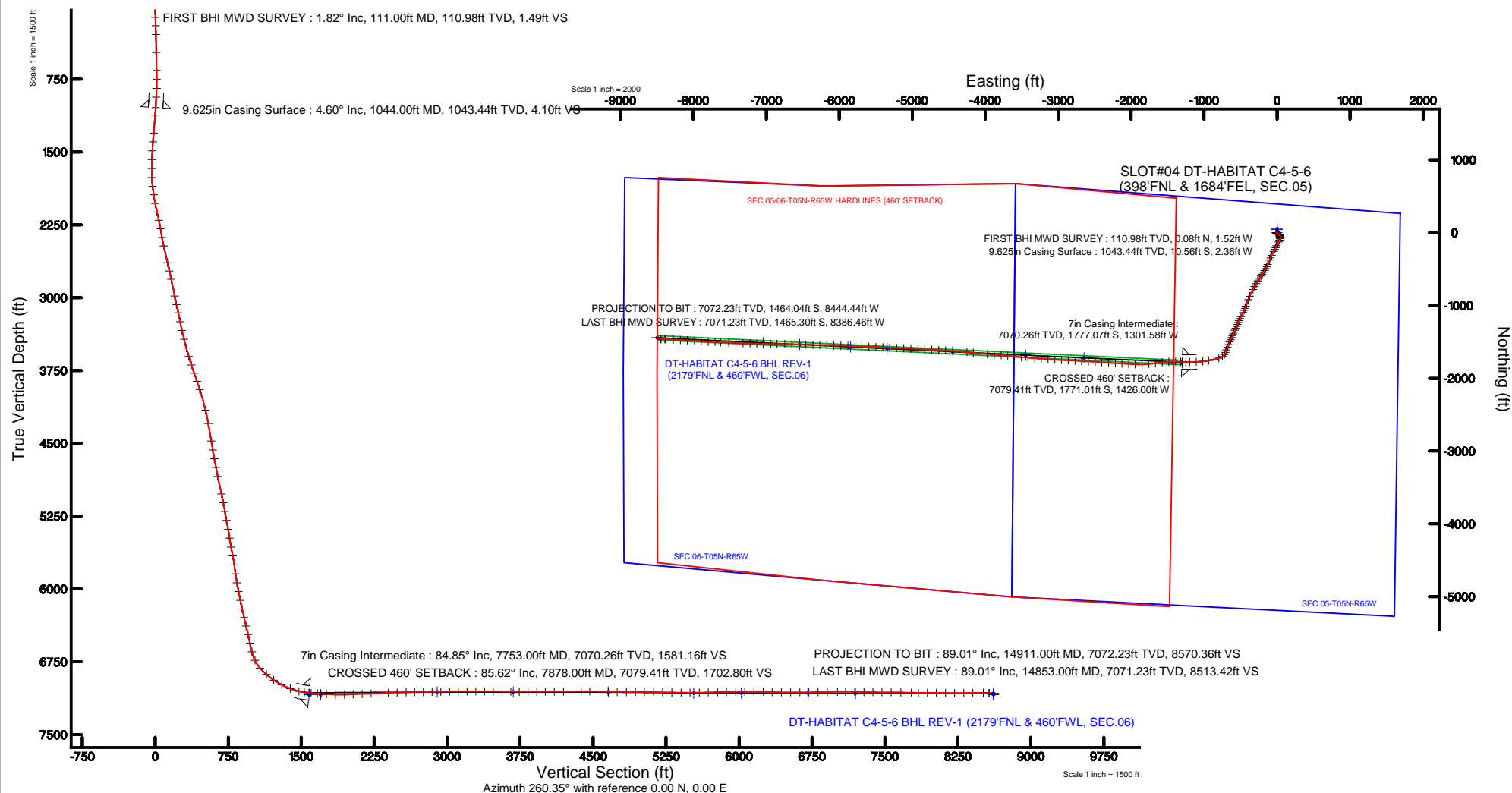



# Actual Wellpath Report

DT-HABITAT C4-5-6 AWP

Page 1 of 7



## REFERENCE WELLPATH IDENTIFICATION

Operator	EXTRACTION OIL & GAS	Slot	SLOT#04 DT-HABITAT C4-5-6 (398'FNL & 1684'FEL, SEC.05)
Area	COLORADO	Well	DT-HABITAT C4-5-6
Field	WELD COUNTY (NAD83/TRUE NORTH)	Wellbore	DT-HABITAT C4-5-6 AWB
Facility	SEC.05-T05N-R65W		

## REPORT SETUP INFORMATION

Projection System	NAD83 / Lambert Colorado SP, Northern Zone (501), US feet	Software System	WellArchitect® 4.1.1
North Reference	True	User	Ingmjmr
Scale	0.999962	Report Generated	6/26/2015 at 9:20:11 AM
Convergence at slot	0.53° East	Database/Source file	Denver/DT-HABITAT_C4-5-6_AWB.xml

## WELLPATH LOCATION

	Local coordinates		Grid coordinates		Geographic coordinates	
	North[ft]	East[ft]	Easting[US ft]	Northing[US ft]	Latitude	Longitude
Slot Location	-149.37	228.27	3227217.73	1402502.35	40°26'07.440"N	104°41'01.428"W
Facility Reference Pt			3226988.10	1402649.61	40°26'08.916"N	104°41'04.380"W
Field Reference Pt			3185481.27	1419166.81	40°28'55.560"N	104°49'59.556"W

## WELLPATH DATUM

Calculation method	Minimum curvature	SAVANNA 802 (15'KB) (RKB) to Facility Vertical Datum	4655.00ft
Horizontal Reference Pt	Slot	SAVANNA 802 (15'KB) (RKB) to Mean Sea Level	4655.00ft
Vertical Reference Pt	SAVANNA 802 (15'KB) (RKB)	SAVANNA 802 (15'KB) (RKB) to Mud Line at Slot (SLOT#04 DT-HABITAT C4-5-6 (398'FNL & 1684'FEL, SEC.05))	4655.00ft
MD Reference Pt	SAVANNA 802 (15'KB) (RKB)	Section Origin	N 0.00, E 0.00 ft
Field Vertical Reference	Mean Sea Level	Section Azimuth	260.35°



# Actual Wellpath Report

DT-HABITAT C4-5-6 AWP

Page 2 of 7



## REFERENCE WELLPATH IDENTIFICATION

Operator	EXTRACTION OIL & GAS	Slot	SLOT#04 DT-HABITAT C4-5-6 (398'FNL & 1684'FEL, SEC.05)
Area	COLORADO	Well	DT-HABITAT C4-5-6
Field	WELD COUNTY (NAD83/TRUE NORTH)	Wellbore	DT-HABITAT C4-5-6 AWB
Facility	SEC.05-T05N-R65W		

## WELLPATH DATA (150 stations) † = interpolated/extrapolated station

MD [ft]	Inclination [°]	Azimuth [°]	TVD [ft]	Vert Sect [ft]	North [ft]	East [ft]	DLS [°/100ft]	Comments
0.00†	0.000	273.020	0.00	0.00	0.00	0.00	0.00	
15.00	0.000	273.020	15.00	0.00	0.00	0.00	0.00	
111.00	1.820	273.020	110.98	1.49	0.08	-1.52	1.90	FIRST BHI MWD SURVEY
200.00	2.080	279.450	199.93	4.39	0.42	-4.53	0.38	
291.00	1.110	253.990	290.90	6.83	0.45	-7.00	1.30	
475.00	0.970	245.020	474.87	10.10	-0.70	-10.13	0.12	
659.00	1.460	232.270	658.83	13.67	-2.79	-13.39	0.30	
751.00	0.740	167.910	750.81	14.68	-4.09	-14.20	1.44	
844.00	1.970	117.640	843.79	13.38	-5.42	-12.65	1.72	
936.00	3.210	114.550	935.69	10.00	-7.22	-8.91	1.36	
1121.00	5.600	120.460	1120.13	-1.19	-13.95	3.58	1.31	
1306.00	6.230	119.120	1304.14	-15.92	-23.41	20.13	0.35	
1398.00	6.090	119.420	1395.61	-23.60	-28.24	28.75	0.16	
1490.00	5.250	132.940	1487.17	-29.95	-33.51	36.08	1.71	
1582.00	6.180	152.630	1578.72	-34.01	-40.77	41.44	2.34	
1675.00	7.760	167.760	1671.03	-35.82	-51.35	45.07	2.59	
1767.00	10.150	182.540	1761.92	-34.39	-65.53	46.03	3.59	
1859.00	12.950	198.290	1852.07	-27.84	-83.42	42.43	4.56	
1951.00	14.970	204.360	1941.35	-16.36	-104.04	34.29	2.71	
2044.00	17.040	209.930	2030.75	-0.96	-126.79	22.54	2.77	
2136.00	20.620	210.430	2117.81	18.07	-152.45	7.60	3.90	
2228.00	19.450	207.190	2204.24	37.69	-180.04	-7.60	1.75	
2320.00	16.690	204.360	2291.70	54.27	-205.71	-20.05	3.15	
2413.00	16.830	203.320	2380.75	69.06	-230.24	-30.89	0.36	
2505.00	21.160	208.610	2467.72	86.61	-257.06	-44.12	5.06	
2689.00	20.640	205.720	2639.62	125.95	-315.43	-74.10	0.63	
2781.00	22.100	204.450	2725.30	145.04	-345.80	-88.30	1.66	
2874.00	21.560	204.060	2811.63	164.33	-377.33	-102.51	0.60	
3058.00	20.420	201.330	2983.42	199.62	-438.10	-127.97	0.82	
3150.00	20.140	209.350	3069.73	217.86	-466.86	-141.57	3.03	



# Actual Wellpath Report

DT-HABITAT C4-5-6 AWP

Page 3 of 7



## REFERENCE WELLPATH IDENTIFICATION

Operator	EXTRACTION OIL & GAS	Slot	SLOT#04 DT-HABITAT C4-5-6 (398'FNL & 1684'FEL, SEC.05)
Area	COLORADO	Well	DT-HABITAT C4-5-6
Field	WELD COUNTY (NAD83/TRUE NORTH)	Wellbore	DT-HABITAT C4-5-6 AWB
Facility	SEC.05-T05N-R65W		

## WELLPATH DATA (150 stations)

MD [ft]	Inclination [°]	Azimuth [°]	TVD [ft]	Vert Sect [ft]	North [ft]	East [ft]	DLS [°/100ft]	Comments
3242.00	18.450	209.300	3156.56	236.98	-493.37	-156.46	1.84	
3338.00	17.740	208.080	3247.81	255.48	-519.52	-170.78	0.84	
3433.00	18.260	216.130	3338.18	275.01	-544.31	-186.37	2.67	
3529.00	18.960	212.610	3429.16	296.28	-569.60	-203.64	1.38	
3625.00	21.860	213.740	3519.12	319.05	-597.60	-221.98	3.05	
3720.00	23.970	212.990	3606.62	344.28	-628.50	-242.31	2.24	
3816.00	26.650	211.060	3693.40	371.54	-663.31	-264.04	2.92	
3912.00	27.870	210.160	3778.74	399.95	-701.15	-286.42	1.34	
4007.00	28.900	208.650	3862.32	428.40	-740.50	-308.59	1.32	
4103.00	28.720	207.970	3946.43	456.86	-781.23	-330.53	0.39	
4340.00	22.520	204.060	4160.04	516.87	-873.06	-375.78	2.71	
4486.00	19.210	201.050	4296.45	544.67	-921.02	-395.82	2.38	
4678.00	19.640	199.180	4477.53	576.36	-980.97	-417.76	0.39	
4774.00	18.320	198.710	4568.30	591.30	-1010.50	-427.90	1.38	
4870.00	19.890	203.500	4659.02	607.41	-1039.77	-439.26	2.31	
4966.00	18.380	203.900	4749.71	624.70	-1068.59	-451.90	1.58	
5062.00	18.610	206.540	4840.76	642.11	-1096.13	-464.88	0.90	
5254.00	21.080	206.800	5021.34	680.73	-1154.37	-494.14	1.29	
5349.00	17.310	205.400	5111.04	699.00	-1182.39	-507.91	4.00	
5445.00	17.290	203.910	5202.70	715.09	-1208.34	-519.82	0.46	
5542.00	18.300	206.080	5295.06	731.96	-1235.19	-532.35	1.25	
5638.00	18.270	203.680	5386.21	749.03	-1262.51	-545.02	0.78	
5734.00	15.560	201.870	5478.05	764.03	-1288.25	-555.87	2.88	
5829.00	17.680	205.210	5569.08	778.94	-1313.13	-566.76	2.45	
5925.00	19.610	206.270	5660.04	796.73	-1340.76	-580.10	2.04	
6021.00	15.150	200.320	5751.64	812.46	-1366.99	-591.59	5.00	
6117.00	15.530	199.300	5844.22	824.95	-1390.88	-600.20	0.49	
6213.00	17.170	206.610	5936.34	839.55	-1415.68	-610.79	2.74	
6309.00	17.930	205.250	6027.87	856.39	-1441.72	-623.44	0.90	
6404.00	20.230	204.770	6117.65	874.05	-1469.86	-636.56	2.43	



# Actual Wellpath Report

DT-HABITAT C4-5-6 AWP

Page 4 of 7



## REFERENCE WELLPATH IDENTIFICATION

Operator	EXTRACTION OIL & GAS	Slot	SLOT#04 DT-HABITAT C4-5-6 (398'FNL & 1684'FEL, SEC.05)
Area	COLORADO	Well	DT-HABITAT C4-5-6
Field	WELD COUNTY (NAD83/TRUE NORTH)	Wellbore	DT-HABITAT C4-5-6 AWB
Facility	SEC.05-T05N-R65W		

## WELLPATH DATA (150 stations) † = interpolated/extrapolated station

MD [ft]	Inclination [°]	Azimuth [°]	TVD [ft]	Vert Sect [ft]	North [ft]	East [ft]	DLS [°/100ft]	Comments
6500.00	22.860	202.380	6206.94	893.32	-1502.18	-650.62	2.89	
6596.00	23.750	200.590	6295.10	912.95	-1537.52	-664.52	1.18	
6692.00	24.520	203.260	6382.71	933.51	-1573.92	-679.19	1.39	
6787.00	23.500	202.100	6469.49	954.19	-1609.58	-694.10	1.18	
6883.00	21.000	201.390	6558.34	973.14	-1643.34	-707.57	2.62	
6979.00	20.760	210.800	6648.06	993.06	-1673.98	-722.56	3.50	
7074.00	28.170	235.540	6734.69	1024.46	-1701.24	-749.78	13.16	
7170.00	40.670	251.860	6813.89	1076.28	-1723.94	-798.49	16.09	
7265.00	49.280	257.290	6881.06	1143.00	-1741.53	-863.17	9.92	
7360.00	55.850	260.390	6938.78	1218.35	-1756.04	-937.14	7.38	
7456.00	62.520	263.150	6987.94	1300.72	-1767.76	-1018.69	7.37	
7552.00	70.280	267.320	7026.36	1388.27	-1774.97	-1106.27	9.01	
7647.00	75.640	268.120	7054.19	1478.31	-1778.57	-1196.99	5.70	
7703.00	82.560	270.460	7064.77	1532.59	-1779.24	-1251.94	13.02	
7774.00	85.820	276.220	7071.97	1601.38	-1775.11	-1322.42	9.28	
7843.00	86.040	270.720	7076.87	1668.38	-1770.95	-1391.09	7.96	
7878.00†	85.622	269.101	7079.41	1702.80	-1771.01	-1426.00	4.77	CROSSED 460' SETBACK
7935.00	84.950	266.460	7084.10	1759.12	-1773.20	-1482.76	4.77	
8028.00	87.550	263.980	7090.18	1851.57	-1780.94	-1575.22	3.86	
8120.00	92.420	261.080	7090.20	1943.47	-1792.90	-1666.40	6.16	
8212.00	92.590	264.420	7086.18	2035.29	-1804.49	-1757.56	3.63	
8304.00	92.560	268.560	7082.05	2126.65	-1810.12	-1849.28	4.50	
8397.00	92.560	272.940	7077.89	2218.00	-1808.90	-1942.16	4.70	
8489.00	92.870	273.250	7073.53	2307.64	-1803.94	-2033.92	0.48	
8581.00	91.360	273.120	7070.14	2397.27	-1798.83	-2125.71	1.65	
8673.00	92.220	272.950	7067.26	2486.98	-1793.96	-2217.54	0.95	
8766.00	91.880	274.160	7063.94	2577.46	-1788.20	-2310.30	1.35	
8858.00	90.960	274.350	7061.66	2666.73	-1781.38	-2402.01	1.02	
8950.00	89.480	273.560	7061.30	2756.15	-1775.03	-2493.79	1.82	
9042.00	91.200	273.760	7060.76	2845.67	-1769.16	-2585.60	1.88	



# Actual Wellpath Report

DT-HABITAT C4-5-6 AWP

Page 5 of 7



## REFERENCE WELLPATH IDENTIFICATION

Operator	EXTRACTION OIL & GAS	Slot	SLOT#04 DT-HABITAT C4-5-6 (398'FNL & 1684'FEL, SEC.05)
Area	COLORADO	Well	DT-HABITAT C4-5-6
Field	WELD COUNTY (NAD83/TRUE NORTH)	Wellbore	DT-HABITAT C4-5-6 AWB
Facility	SEC.05-T05N-R65W		

## WELLPATH DATA (150 stations)

MD [ft]	Inclination [°]	Azimuth [°]	TVD [ft]	Vert Sect [ft]	North [ft]	East [ft]	DLS [°/100ft]	Comments
9134.00	91.450	273.020	7058.63	2935.27	-1763.72	-2677.41	0.85	
9227.00	91.510	272.540	7056.23	3026.06	-1759.21	-2770.27	0.52	
9319.00	90.620	272.600	7054.52	3115.96	-1755.09	-2862.16	0.97	
9411.00	89.600	273.750	7054.34	3205.66	-1749.99	-2954.02	1.67	
9503.00	90.310	273.500	7054.41	3295.20	-1744.18	-3045.83	0.82	
9596.00	89.310	273.250	7054.72	3385.80	-1738.70	-3138.67	1.11	
9688.00	89.820	273.330	7055.42	3475.46	-1733.42	-3230.51	0.56	
9780.00	88.950	275.020	7056.41	3564.78	-1726.72	-3322.26	2.07	
9872.00	89.350	275.170	7057.77	3653.74	-1718.55	-3413.89	0.46	
9964.00	89.810	275.280	7058.45	3742.65	-1710.18	-3505.50	0.51	
10057.00	89.970	275.180	7058.63	3832.53	-1701.70	-3598.11	0.20	
10149.00	90.060	275.290	7058.60	3921.44	-1693.31	-3689.73	0.15	
10240.00	90.210	275.250	7058.39	4009.37	-1684.95	-3780.35	0.17	
10336.00	90.120	275.130	7058.11	4102.17	-1676.26	-3875.95	0.16	
10432.00	90.560	275.510	7057.54	4194.91	-1667.36	-3971.54	0.61	
10623.00	90.770	274.900	7055.32	4379.51	-1650.04	-4161.74	0.34	
10712.00	89.440	275.420	7055.16	4465.55	-1642.03	-4250.37	1.60	
10908.00	88.100	274.310	7059.37	4655.24	-1625.41	-4445.61	0.89	
11004.00	89.880	273.730	7061.06	4748.50	-1618.68	-4541.36	1.95	
11100.00	89.850	273.100	7061.29	4842.01	-1612.97	-4637.19	0.66	
11195.00	89.780	273.040	7061.59	4934.68	-1607.88	-4732.05	0.10	
11291.00	89.880	272.620	7061.88	5028.41	-1603.14	-4827.93	0.45	
11387.00	89.010	273.010	7062.81	5122.14	-1598.42	-4923.81	0.99	
11483.00	88.980	272.850	7064.49	5215.82	-1593.52	-5019.67	0.17	
11578.00	89.230	272.690	7065.98	5308.58	-1588.93	-5114.55	0.31	
11675.00	88.670	272.240	7067.75	5403.40	-1584.76	-5211.44	0.74	
11771.00	90.030	272.730	7068.84	5497.25	-1580.59	-5307.34	1.51	
11867.00	91.400	273.090	7067.64	5590.94	-1575.72	-5403.21	1.48	
11963.00	91.320	272.370	7065.37	5684.68	-1571.15	-5499.07	0.75	
12058.00	91.790	272.280	7062.79	5777.57	-1567.30	-5593.96	0.50	



# Actual Wellpath Report

DT-HABITAT C4-5-6 AWP

Page 6 of 7



## REFERENCE WELLPATH IDENTIFICATION

Operator	EXTRACTION OIL & GAS	Slot	SLOT#04 DT-HABITAT C4-5-6 (398'FNL & 1684'FEL, SEC.05)
Area	COLORADO	Well	DT-HABITAT C4-5-6
Field	WELD COUNTY (NAD83/TRUE NORTH)	Wellbore	DT-HABITAT C4-5-6 AWB
Facility	SEC.05-T05N-R65W		

## WELLPATH DATA (150 stations)

MD [ft]	Inclination [°]	Azimuth [°]	TVD [ft]	Vert Sect [ft]	North [ft]	East [ft]	DLS [°/100ft]	Comments
12154.00	90.340	272.370	7061.00	5871.46	-1563.40	-5689.86	1.51	
12250.00	90.430	272.420	7060.36	5965.35	-1559.39	-5785.77	0.11	
12346.00	90.710	272.080	7059.40	6059.28	-1555.62	-5881.70	0.46	
12442.00	91.050	271.770	7057.93	6153.31	-1552.40	-5977.63	0.48	
12538.00	88.450	271.680	7058.35	6247.42	-1549.51	-6073.58	2.71	
12634.00	88.210	271.540	7061.15	6341.53	-1546.81	-6169.50	0.29	
12730.00	88.030	270.940	7064.29	6435.75	-1544.74	-6265.42	0.65	
12826.00	90.280	272.200	7065.71	6529.89	-1542.11	-6361.37	2.69	
12922.00	90.460	272.070	7065.09	6623.86	-1538.53	-6457.30	0.23	
13018.00	90.800	271.970	7064.04	6717.87	-1535.15	-6553.23	0.37	
13114.00	90.990	271.710	7062.54	6811.94	-1532.07	-6649.17	0.34	
13210.00	90.490	271.070	7061.30	6906.15	-1529.74	-6745.14	0.85	
13317.00	90.620	270.970	7060.26	7011.29	-1527.83	-6852.11	0.15	
13401.00	89.910	270.120	7059.87	7093.96	-1527.03	-6936.11	1.32	
13497.00	89.320	269.650	7060.52	7188.63	-1527.23	-7032.10	0.79	
13593.00	88.980	272.100	7061.94	7283.00	-1525.76	-7128.08	2.58	
13688.00	89.350	271.980	7063.32	7376.02	-1522.38	-7223.01	0.41	
13784.00	89.690	272.890	7064.13	7469.88	-1518.30	-7318.91	1.01	
13880.00	89.290	271.780	7064.98	7563.78	-1514.39	-7414.83	1.23	
13982.00	89.540	271.620	7066.02	7663.78	-1511.36	-7516.78	0.29	
14091.00	88.780	273.760	7067.62	7770.24	-1506.25	-7625.64	2.08	
14166.00	88.370	273.080	7069.49	7843.28	-1501.78	-7700.48	1.06	
14262.00	90.120	274.020	7070.75	7936.73	-1495.83	-7796.28	2.07	
14357.00	89.880	273.380	7070.75	8029.16	-1489.70	-7891.09	0.72	
14452.00	89.510	273.050	7071.26	8121.77	-1484.37	-7985.94	0.52	
14548.00	90.000	272.940	7071.67	8215.44	-1479.36	-8081.80	0.52	
14644.00	90.310	273.140	7071.41	8309.09	-1474.27	-8177.67	0.38	
14740.00	90.490	272.800	7070.74	8402.77	-1469.29	-8273.54	0.40	
14853.00	89.010	271.250	7071.23	8513.42	-1465.30	-8386.46	1.90	LAST BHI MWD SURVEY
14911.00	89.010	271.250	7072.23	8570.36	-1464.04	-8444.44	0.00	PROJECTION TO BIT

## HOLE & CASING SECTIONS - Ref Wellbore: DT-HABITAT C4-5-6 AWB Ref Wellpath: DT-HABITAT C4-5-6 AWP

String/Diameter	Start MD [ft]	End MD [ft]	Interval [ft]	Start TVD [ft]	End TVD [ft]	Start N/S [ft]	Start E/W [ft]	End N/S [ft]	End E/W [ft]
9.625in Casing Surface	15.00	1044.00	1029.00	15.00	1043.44	0.00	0.00	-10.56	-2.36
8.75in Open Hole	1044.00	7806.00	6762.00	1043.44	7074.27	-10.56	-2.36	-1772.36	-1354.21
7in Casing Intermediate	15.00	7753.00	7738.00	15.00	7070.26	0.00	0.00	-1777.07	-1301.58
6.125in Open Hole	7806.00	14911.00	7105.00	7074.27	7072.23	-1772.36	-1354.21	-1464.04	-8444.44

## TARGETS

Name	TVD [ft]	North [ft]	East [ft]	Grid East [US ft]	Grid North [US ft]	Latitude	Longitude	Shape
SEC.05-T05N-R65W	0.00	47.36	0.00	3227217.29	1402549.71	40°26'07.908"N	104°41'01.428"W	polygon
	0.00	47.36	0.00	3227217.29	1402549.71	40°26'07.908"N	104°41'01.428"W	polygon



SEC.06-T05N-R65W								
DT-HABITAT C4-5-6 TARGET 2	7062.00	-1720.53	-2646.47	3224587.31	1400757.60	40°25'50.437"N	104°41'35.650"W	point
DT-HABITAT C4-5-6 TARGET 3	7062.00	-1682.85	-3445.58	3223787.92	1400787.92	40°25'50.808"N	104°41'45.984"W	point
DT-HABITAT C4-5-6 TARGET 4	7062.00	-1635.76	-4444.47	3222788.68	1400825.82	40°25'51.272"N	104°41'58.901"W	point
DT-HABITAT C4-5-6 TARGET 5	7073.00	-1593.38	-5343.47	3221889.36	1400859.92	40°25'51.689"N	104°42'10.526"W	point
DT-HABITAT C4-5-6 TARGET 6	7073.00	-1569.83	-5842.92	3221389.74	1400878.87	40°25'51.921"N	104°42'16.985"W	point
DT-HABITAT C4-5-6 TARGET 7	7073.00	-1536.87	-6542.14	3220690.27	1400905.39	40°25'52.245"N	104°42'26.027"W	point
DT-HABITAT C4-5-6 BHL REV-1 (2179'FNL & 460'FWL, SEC.06)	7076.00	-1444.87	-8493.75	3218737.98	1400979.42	40°25'53.148"N	104°42'51.264"W	point
DT-HABITAT C4-5-6 TARGET 8	7076.00	-1513.33	-7041.58	3220190.66	1400924.33	40°25'52.476"N	104°42'32.485"W	point
DT-HABITAT C4-5-6 BHL ON PLAT (2179'FNL & 460'FWL, SEC.06)	7090.00	-1444.87	-8493.75	3218737.98	1400979.42	40°25'53.148"N	104°42'51.264"W	point
DT-HABITAT C4-5-6 DRILLING CORRIDOR (60')	7090.00	0.00	0.00	3227217.73	1402502.35	40°26'07.440"N	104°41'01.428"W	polygon

<b>TARGETS</b>								
<b>Name</b>	<b>TVD [ft]</b>	<b>North [ft]</b>	<b>East [ft]</b>	<b>Grid East [US ft]</b>	<b>Grid North [US ft]</b>	<b>Latitude</b>	<b>Longitude</b>	<b>Shape</b>
<b>DT-HABITAT C4-5-6 LANDING POINT</b>	7090.00	-1785.10	-1419.82	3225814.46	1400704.33	<b>40°25'49.800"N</b>	<b>104°41'19.788"W</b>	point
<b>DT-HABITAT C4-5-6 LANDING POINT REV-2</b>	7090.00	-1785.10	-1300.00	3225934.27	1400705.43	40°25'49.800"N	104°41'18.239"W	point
<b>SEC.05/06-T05N-R65W HARDLINES (460' SETBACK)</b>	7090.00	47.36	0.00	3227217.29	1402549.71	40°26'07.908"N	104°41'01.428"W	polygon

<b>WELLPATH COMPOSITION - Ref Wellbore: DT-HABITAT C4-5-6 AWB    Ref Wellpath: DT-HABITAT C4-5-6 AWP</b>				
<b>Start MD [ft]</b>	<b>End MD [ft]</b>	<b>Positional Uncertainty Model</b>	<b>Log Name/Comment</b>	<b>Wellbore</b>
15.00	936.00	NaviTrak (MagCorr)	BHI MWD/NAVITRAK (MAGCORR) 13.5" HOLE <111-936>	DT-HABITAT C4-5-6 AWB
936.00	4103.00	NaviTrak (MagCorr)	BHI MWD/ NAVITRAK (MAGCORR) 8.75" HOLE <1121-4103>	DT-HABITAT C4-5-6 AWB
4103.00	7703.00	NaviTrak (Standard)	BHI MWD/NAVITRAK (STD) 8.75" HOLE <4340-7703>	DT-HABITAT C4-5-6 AWB
7703.00	14853.00	NaviTrak (Standard)	BHI MWD/NAVITRAK (STD) 6.125" HOLE <7774-14853>	DT-HABITAT C4-5-6 AWB
14853.00	14911.00	Blind Drilling (std)	Projection to bit	DT-HABITAT C4-5-6 AWB





# Actual Wellpath Report

DT-HABITAT C4-5-6 AWP

Page 7 of 7



## REFERENCE WELLPATH IDENTIFICATION

Operator	EXTRACTION OIL & GAS	Slot	SLOT#04 DT-HABITAT C4-5-6 (398'FNL & 1684'FEL, SEC.05)
Area	COLORADO	Well	DT-HABITAT C4-5-6
Field	WELD COUNTY (NAD83/TRUE NORTH)	Wellbore	DT-HABITAT C4-5-6 AWB
Facility	SEC.05-T05N-R65W		

## WELLPATH COMMENTS

MD [ft]	Inclination [°]	Azimuth [°]	TVD [ft]	Comment
111.00	1.820	273.020	110.98	FIRST BHI MWD SURVEY
7878.00	85.622	269.101	7079.41	CROSSED 460' SETBACK
14853.00	89.010	271.250	7071.23	LAST BHI MWD SURVEY
14911.00	89.010	271.250	7072.23	PROJECTION TO BIT